

# TRAFFIC CRASH REPORT

\*DENOTES MANDATORY FIELD FOR SUPPLEMENT REPORT

LOCAL REPORT NUMBER\*

<input checked="" type="checkbox"/> PHOTOS TAKEN <input type="checkbox"/> SECONDARY CRASH	<input checked="" type="checkbox"/> OH-2 <input checked="" type="checkbox"/> OH-1P <input type="checkbox"/> PRIVATE PROPERTY	<input type="checkbox"/> OH-3 <input type="checkbox"/> OTHER	LOCAL INFORMATION REPORTING AGENCY NAME* <b>Fairfield Police Department</b>	NCIC* <b>0,0,9,0,1</b>	LOCAL REPORT NUMBER* <b>2,2,0,7,8,9,9,6</b>
--	--	---	---	---------------------------	--

COUNTY* <b>0,9</b>	LOCALITY* 1-CITY <b>1</b> 2-VILLAGE 3-TOWNSHIP	LOCATION: CITY, VILLAGE, TOWNSHIP* <b>City of Fairfield</b>	CRASH DATE / TIME* <b>10,2,8,20,22, 1,2,5,0</b>	NUMBER OF UNITS <b>0,2</b>	UNIT IN ERROR 98-ANIMAL 99-UNKNOWN <b>0,1</b>
-----------------------	--	--	--	-------------------------------	--

ROUTE TYPE <input type="checkbox"/> 1-NORTH <input type="checkbox"/> 2-SOUTH <input type="checkbox"/> 3-EAST <input type="checkbox"/> 4-WEST	ROUTE NUMBER <input type="checkbox"/> 1-NORTH <input type="checkbox"/> 2-SOUTH <input type="checkbox"/> 3-EAST <input type="checkbox"/> 4-WEST	PREFIX 1-NORTH 2-SOUTH 3-EAST 4-WEST	LOCATION ROAD NAME <b>South Gilmore</b>	ROAD TYPE <b>R, D</b>	LATITUDE DECIMAL DEGREES <b>39,3,1,8,3,0,3</b>
ROUTE TYPE <input type="checkbox"/> 1-NORTH <input type="checkbox"/> 2-SOUTH <input type="checkbox"/> 3-EAST <input type="checkbox"/> 4-WEST	ROUTE NUMBER <input type="checkbox"/> 1-NORTH <input type="checkbox"/> 2-SOUTH <input type="checkbox"/> 3-EAST <input type="checkbox"/> 4-WEST	PREFIX 1-NORTH 2-SOUTH 3-EAST 4-WEST	REFERENCE ROAD NAME (ROAD, MILEPOST, HOUSE #) <b>Annandale</b>	ROAD TYPE <b>D, R</b>	LONGITUDE DECIMAL DEGREES <b>84,5,2,2,3,8,9</b>

REFERENCE POINT 1- INTERSECTION <b>1</b> 2- MILE POST 3- HOUSE #	DIRECTION FROM REFERENCE 1-NORTH 2-SOUTH 3-EAST 4-WEST	ROUTE TYPE IR-INTERSTATE ROUTE(TP) US-FEDERAL US ROUTE SR-STATE ROUTE CR-NUMBERED COUNTY ROUTE TR-NUMBERED TOWNSHIP ROUTE	ROAD TYPE AL-ALLEY HW-HIGHWAY RD-ROAD AV-AVENUE LA-LANE SQ-SQUARE BL-BOULEVARD MP-MILEPOST ST-STREET CR-CIRCLE OV-OVAL TE-TERRACE CT-COURT PK-PARKWAY TL-TRAIL DR-DRIVE PI-PIKE WA-WAY HE-HEIGHTS PL-PLACE	INTERSECTION RELATED <input checked="" type="checkbox"/> WITHIN INTERSECTION OR ON APPROACH <input type="checkbox"/> WITHIN INTERCHANGE AREA NUMBER OF APPROACHES <b>4</b> <input type="checkbox"/> ROADWAY DIVIDED
--	--	--	---	---

LOCATION OF FIRST HARMFUL EVENT 1- ON ROADWAY <b>0,1</b> 2- ON SHOULDER 3- IN MEDIAN 4- ON ROADSIDE 5- ON GORE 6- OUTSIDE TRAFFIC WAY 7- ON RAMP 8- OFF RAMP	MANNER OF CRASH COLLISION/IMPACT 1- NOT COLLISION BETWEEN TWO MOTOR VEHICLES IN TRANSPORT <b>6</b> 2- REAR-END 3- HEAD-ON 4- REAR-TO-REAR 5- BACKING 6- ANGLE 7- SIDESWIPE, SAME DIRECTION 8- SIDESWIPE, OPPOSITE DIRECTION 9- OTHER / UNKNOWN	DIRECTION OF TRAVEL 1-NORTH 2-SOUTH 3-EAST 4-WEST	MEDIAN TYPE 1-DIVIDED FLUSH MEDIAN (<4 FEET) 2-DIVIDED FLUSH MEDIAN (≥4 FEET) 3-DIVIDED, DEPRESSED MEDIAN 4-DIVIDED, RAISED MEDIAN (ANY TYPE) 9-OTHER/UNKNOWN
---	--	---	--

<input type="checkbox"/> WORK ZONE RELATED <input type="checkbox"/> WORKERS PRESENT <input type="checkbox"/> LAW ENFORCEMENT PRESENT <input type="checkbox"/> ACTIVE SCHOOL ZONE	WORK ZONE TYPE 1-LANE CLOSURE 2-LANE SHIFT/CROSSOVER 3-WORK ON SHOULDER OR MEDIAN 4-INTERMITTENT OR MOVING WORK 5-OTHER	LOCATION OF CRASH IN WORK ZONE 1-BEFORE THE 1ST WORK ZONE WARNING SIGN 2-ADVANCE WARNING AREA 3-TRANSITION AREA 4-ACTIVITY AREA 5-TERMINATION AREA	CONTOUR <b>2</b> 1-STRAIGHT LEVEL 2-STRAIGHT GRADE 3-CURVE LEVEL 4-CURVE GRADE 9-OTHER/UNKNOWN	CONDITIONS <b>1</b> 1-DRY 2-WET 3-SNOW 4-ICE 5-SAND, MUD, DIRT, OIL, GRAVEL 6-WATER (STANDING, MOVING) 7-SLUSH 9-OTHER/UNKNOWN	SURFACE <b>2</b> 1-CONCRETE 2-BLACKTOP, BITUMINOUS, ASPHALT 3-BRICK/BLOCK 4-SLAG, GRAVEL, STONE 5-DIRT 9-OTHER/UNKNOWN
---	--	---	--	---	---

LIGHT CONDITION <b>1</b> 1-DAYLIGHT 2-DAWN/DUSK 3-DARK - LIGHTED ROADWAY 4-DARK - ROADWAY NOT LIGHTED 5-DARK - UNKNOWN ROADWAY LIGHTING 9-OTHER / UNKNOWN	WEATHER <b>0,1</b> 1-CLEAR 2-CLOUDY 3-FOG, SMOG, SMOKE 4-RAIN 5-SLEET, HAIL 6-SNOW 7-SEVERE CROSSWINDS 8-BLOWING SAND, SOIL, DIRT, SNOW 9-FREEZING RAIN OR FREEZING DRIZZLE 99-OTHER / UNKNOWN	DIRECTION OF TRAVEL 1-NORTH 2-SOUTH 3-EAST 4-WEST
--	---	---

NARRATIVE On October 28, 2022 at about 12:50 P.M. Unit #1 was traveling north on South Gilmore Road and when at Annandale Drive failed to obey the red traffic signal and in so doing collided with Unit #2 which was making a left turn from Annandale Drive to travel south on South Gilmore Road.	 <p>Indicate the north direction with an "N" on the compass diagram.</p> <p style="font-size: 2em; opacity: 0.5;">See OH-2 Diagram</p>
---	---

CRASH REPORTED DATE / TIME <b>1,0,2,8,2,0,2,2, 1,2,5,2</b>	DISPATCH DATE / TIME <b>1,0,2,8,2,0,2,2, 1,2,5,3</b>	ARRIVAL DATE / TIME <b>1,0,2,8,2,0,2,2, 1,3,0,0</b>	SCENE CLEARED DATE / TIME <b>1,0,2,8,2,0,2,2, 1,3,4,1</b>	REPORT TAKEN BY <input checked="" type="checkbox"/> POLICE AGENCY <input type="checkbox"/> MOTORIST <input type="checkbox"/> SUPPLEMENT (CORRECTION OR ADDITION TO AN EXISTING REPORT SENT TO OHS)		
TOTAL TIME ROADWAY CLOSED <b>4,0</b>	OTHER INVESTIGATION TIME <b>1,0</b>	TOTAL MINUTES <b>5,8</b>	OFFICER'S NAME* <b>E. Knizner</b>	OFFICER'S BADGE NUMBER* <b>0,8,3</b>	CHECKED BY OFFICER'S NAME* <b>Sgt. J Sprague</b>	CHECKED BY OFFICER'S BADGE NUMBER* <b>8,4</b>

LOCAL REPORT NUMBER  
 2, 2, 0, 7, 8, 9, 9, 6

**OWNER**

UNIT # 011 OWNER NAME: LAST, FIRST, MIDDLE (☑ SAME AS DRIVER) OWNER PHONE: INCLUDE AREA CODE (☑ SAME AS DRIVER)

OWNER ADDRESS: STREET, CITY, STATE, ZIP (☑ SAME AS DRIVER)

COMMERCIAL CARRIER: NAME, ADDRESS, CITY, STATE, ZIP COMMERCIAL CARRIER PHONE: INCLUDE AREA CODE

**DAMAGE**

DAMAGE SCALE

3 1 - NONE 3 - FUNCTIONAL DAMAGE  
 2 - MINOR DAMAGE 4 - DISABLING DAMAGE  
 9 - UNKNOWN

**VEHICLE**

LP STATE IN LICENSE PLATE # XUT651 VEHICLE IDENTIFICATION # 21C131C1D1X1J1G101G1H131101618121 VEHICLE YEAR 2016 VEHICLE MAKE Dodge

INSURANCE VERIFIED  INSURANCE COMPANY American Family INSURANCE POLICY # 41062-48858-00 COLOR Silver VEHICLE MODEL Charger

TYPE OF USE:  COMMERCIAL  GOVERNMENT  IN EMERGENCY RESPONSE US DOT # \_\_\_\_\_ TOWED BY: COMPANY NAME \_\_\_\_\_

INTERLOCK DEVICE EQUIPPED  HIT/SKIP UNIT  #OCCUPANTS 011 VEHICLE WEIGHT GVWR/GCWR: 1 - ≤10K LBS., 2 - 10,001 - 26K LBS., 3 - >26K LBS. HAZARDOUS MATERIAL:  MATERIAL RELEASED CLASS # \_\_\_\_\_ PLACARD ID # \_\_\_\_\_

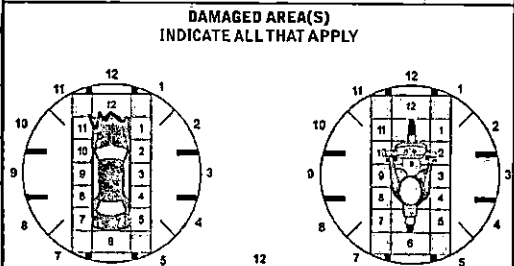

UNIT TYPE 011

1 - PASSENGER CAR 7 - MOTORCYCLE 2-WHEELED 12 - GOLF CART 18 - LIMO (LIVERY VEHICLE) 23 - PEDESTRIAN / SKATER  
 2 - PASSENGER VAN (MINIVAN) 8 - MOTORCYCLE 3-WHEELED 13 - SNOWMOBILE 19 - BUS (16+ PASSENGERS) 24 - WHEELCHAIR (ANY TYPE)  
 3 - SPORT UTILITY VEHICLE 9 - AUTOCYCLE 14 - SINGLE UNIT TRUCK 20 - OTHER VEHICLE 25 - OTHER NON-MOTORIST  
 4 - PICK UP 10 - MOPED OR MOTORIZED BICYCLE 15 - SEMI-TRACTOR 21 - HEAVY EQUIPMENT 26 - BICYCLE  
 5 - CARGO VAN 11 - ALL TERRAIN VEHICLE (ATV/UTV) 16 - FARM EQUIPMENT 22 - ANIMAL WITH RIDER OR ANIMAL-DRAWN VEHICLE 27 - TRAIN  
 6 - VAN (9-15 SEATS) 99 - UNKNOWN OR HIT/SKIP

# OF TRAILING UNITS 0

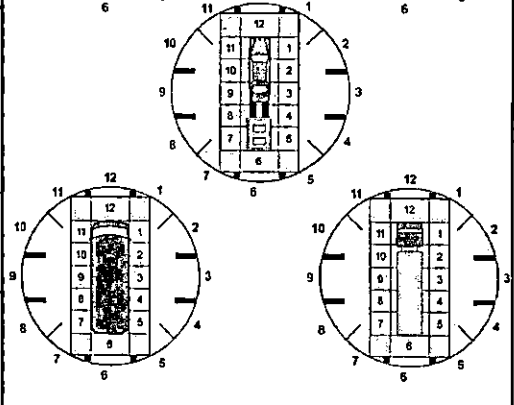

WAS VEHICLE OPERATING IN AUTONOMOUS MODE WHEN CRASH OCCURRED? 2

1 - YES 2 - NO 9 - OTHER / UNKNOWN AUTONOMOUS MODE LEVEL: 0 - NO AUTOMATION, 1 - DRIVER ASSISTANCE, 2 - PARTIAL AUTOMATION, 3 - CONDITIONAL AUTOMATION, 4 - HIGH AUTOMATION, 5 - FULL AUTOMATION, 9 - UNKNOWN

SPECIAL FUNCTION 011

1 - NONE 6 - BUS - CHARTER/TOUR 11 - FIRE 16 - FARM 21 - MAIL CARRIER  
 2 - TAXI 7 - BUS - INTERCITY 12 - MILITARY 17 - MOWING 99 - OTHER / UNKNOWN  
 3 - ELECTRONIC RIDE SHARING 8 - BUS - SHUTTLE 13 - POLICE 18 - SNOW REMOVAL  
 4 - SCHOOL TRANSPORT 9 - BUS - OTHER 14 - PUBLIC UTILITY 19 - TOWING  
 5 - BUS - TRANSIT/COMMUTER 10 - AMBULANCE 15 - CONSTRUCTION EQUIPMENT 20 - SAFETY SERVICE PATROL

CARGO BODY TYPE 011

1 - NO CARGO BODY TYPE / NOT APPLICABLE 3 - VEHICLE TOWING ANOTHER MOTOR VEHICLE 5 - INTERMODAL CONTAINER CHASSIS 8 - POLE 12 - CONCRETE MIXER  
 2 - BUS 4 - LOGGING 6 - CARGO VAN/ENCLOSED BOX 9 - CARGO TANK 13 - AUTO TRANSPORTER  
 7 - GRAIN/CHIPS/GRAVEL 11 - DUMP 10 - FLAT BED 14 - GARBAGE/REFUSE 99 - OTHER / UNKNOWN

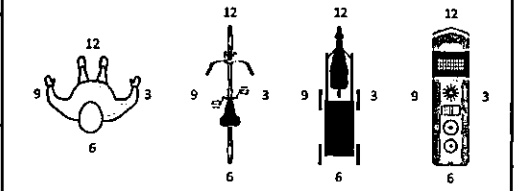

VEHICLE DEFECTS 011

1 - TURN SIGNALS 4 - BRAKES 7 - WORN OR SLICK TIRES 9 - MOTOR TROUBLE 99 - OTHER / UNKNOWN  
 2 - HEAD LAMPS 5 - STEERING 8 - TRAILER EQUIPMENT DEFECTIVE 10 - DISABLED FROM PRIOR ACCIDENT  
 3 - TAIL LAMPS 6 - TIRE BLOWOUT

NON-MOTORIST LOCATION AT IMPACT 011

1 - INTERSECTION - MARKED CROSSWALK 3 - INTERSECTION - OTHER 6 - BICYCLE LANE 9 - MEDIAN/CROSSING ISLAND 12 - FIRST RESPONDER AT INCIDENT SCENE  
 2 - INTERSECTION - UNMARKED CROSSWALK 4 - MIDDLEBLOCK - MARKED CROSSWALK 7 - SHOULDER / ROADSIDE 10 - DRIVEWAY ACCESS 99 - OTHER / UNKNOWN  
 5 - TRAVEL LANE - OTHER LOCATION 8 - SIDEWALK 11 - SHARED USE PATHS OR TRAILS

- NO DAMAGE [0]  - UNDERCARRIAGE [14]  
 - TOP [13]  - ALL AREAS [15]  
 - UNIT NOT AT SCENE [16]

ACTION 3

1 - NON-CONTACT 1 - STRAIGHT AHEAD 7 - MAKING U-TURN 13 - NEGOTIATING A CURVE 18 - APPROACHING OR LEAVING VEHICLE  
 2 - NON-COLLISION 2 - BACKING 8 - ENTERING TRAFFIC LANE 14 - ENTERING OR CROSSING SPECIFIED LOCATION 19 - STANDING  
 3 - STRIKING 011 3 - CHANGING LANES 9 - LEAVING TRAFFIC LANE 15 - WALKING, RUNNING, JOGGING, PLAYING 20 - OTHER NON-MOTORIST  
 4 - STRUCK PRE-CRASH ACTIONS 4 - OVERTAKING/PASSING 10 - PARKED 16 - WORKING 21 - STANDING OUTSIDE DISABLED VEHICLE  
 5 - BOTH STRIKING & STRUCK 5 - MAKING RIGHT TURN 11 - SLOWING OR STOPPED IN TRAFFIC 17 - PUSHING VEHICLE 99 - OTHER / UNKNOWN  
 9 - OTHER / UNKNOWN 6 - MAKING LEFT TURN 12 - DRIVERLESS

INITIAL POINT OF CONTACT

1, 2 0 - NO DAMAGE 14 - UNDERCARRIAGE  
 1-12 - REFER TO UNIT DIAGRAM 15 - VEHICLE NOT AT SCENE  
 13 - TOP 99 - UNKNOWN

CONTRIBUTING CIRCUMSTANCES 03

1 - NONE 7 - LEFT OF CENTER 13 - IMPROPER START FROM A PARKED POSITION 17 - VISION OBSTRUCTION 21 - LYING IN ROADWAY  
 2 - FAILURE TO YIELD 8 - FOLLOWING TOO CLOSE / ACDA 14 - STOPPED OR PARKED ILLEGALLY 18 - OPERATING DEFECTIVE EQUIPMENT 22 - NOT DISCERNIBLE  
 3 - RAN RED LIGHT 9 - IMPROPER LANE CHANGE 15 - SWERVING TO AVOID 19 - LOAD SHIFTING/FALLING/SPILLING 23 - OPENING DOOR INTO ROADWAY  
 4 - RAN STOP SIGN 10 - IMPROPER PASSING 11 - DROVE OFF ROAD 20 - IMPROPER CROSSING 99 - OTHER IMPROPER ACTION  
 5 - UNSAFE SPEED 12 - IMPROPER BACKING 16 - WRONG WAY

TRAFFIC

TRAFFICWAY FLOW: 1 - ONE-WAY 2, 2 - TWO-WAY 2

TRAFFIC CONTROL: 1 - ROUNDABOUT 4 - STOP SIGN 2, 2 - SIGNAL 5 - YIELD SIGN, 3 - FLASHER 6 - NO CONTROL

SEQUENCE OF EVENTS

1 2, 0

1 - OVERTURN/ROLLOVER 6 - EQUIPMENT FAILURE 11 - CROSS CENTERLINE - OPPOSITE DIRECTION OF TRAVEL 16 - RAILWAY VEHICLE 22 - WORK ZONE MAINTENANCE EQUIPMENT  
 2 - FIRE/EXPLOSION 7 - SEPARATION OF UNITS 12 - DOWNHILL RUNAWAY 17 - ANIMAL - FARM 23 - STRUCK BY FALLING, SHIFTING CARGO OR ANYTHING SET IN MOTION BY A MOTOR VEHICLE  
 3 - IMMERSION 8 - RAN OFF ROAD RIGHT 13 - OTHER NON-COLLISION 18 - ANIMAL - DEER 24 - OTHER MOVABLE OBJECT  
 4 - JACKKNIFE 9 - RAN OFF ROAD LEFT 14 - PEDESTRIAN 19 - ANIMAL - OTHER 20 - MOTOR VEHICLE IN TRANSPORT  
 5 - CARGO / EQUIPMENT LOSS OR SHIFT 10 - CROSS MEDIAN 15 - PEDAL CYCLE 21 - PARKED MOTOR VEHICLE

# OF THROUGH LANES ON ROAD 5

RAIL GRADE CROSSING: 1 - NOT INVOLVED 1, 2 - INVOLVED-ACTIVE CROSSING, 3 - INVOLVED-PASSIVE CROSSING

COLLISION WITH FIXED OBJECT - STRUCK

25 - IMPACT ATTENUATOR / CRASH CUSHION 31 - GUARDRAIL END 37 - TRAFFIC SIGN POST 43 - CURB 50 - WORK ZONE MAINTENANCE EQUIPMENT  
 26 - BRIDGE OVERHEAD STRUCTURE 32 - PORTABLE BARRIER 38 - OVERHEAD SIGN POST 44 - DITCH 51 - WALL  
 27 - BRIDGE PIER OR ABUTMENT BARRIER 33 - MEDIUM CABLE BARRIER 39 - LIGHT / LUMINARIES SUPPORT 45 - EMBANKMENT 52 - BUILDING  
 28 - BRIDGE PARAPET 34 - MEDIUM GUARDRAIL BARRIER 40 - UTILITY POLE 46 - FENCE 53 - TUNNEL  
 29 - BRIDGE RAIL 35 - MEDIUM CONCRETE BARRIER 41 - OTHER POST, POLE OR SUPPORT 47 - MAILBOX 54 - OTHER FIXED OBJECT  
 30 - GUARDRAIL FACE 36 - MEDIUM OTHER BARRIER 42 - CULVERT 48 - TREE 99 - OTHER / UNKNOWN  
 49 - FIRE HYDRANT

FIRST HARMFUL EVENT 1 MOST HARMFUL EVENT 1

UNIT / NON-MOTORIST DIRECTION

FROM 2 TO 1

1 - NORTH 5 - NORTHEAST  
 2 - SOUTH 6 - NORTHWEST  
 3 - EAST 7 - SOUTHEAST  
 4 - WEST 8 - SOUTHWEST  
 9 - OTHER / UNKNOWN

UNIT SPEED 35

POSTED SPEED 35

DETECTED SPEED: 1 - STATED / ESTIMATED SPEED 1, 2 - CALCULATED / EDR, 3 - UNDETERMINED

**OWNER**

UNIT # 02 OWNER NAME: LAST, FIRST, MIDDLE (SAME AS DRIVER) Past, Wallace L. OWNER PHONE: INCLUDE AREA CODE (SAME AS DRIVER) \_\_\_\_\_

OWNER ADDRESS: STREET, CITY, STATE, ZIP (SAME AS DRIVER) 4608 Heritage Manor Crestwood, KY 40014

COMMERCIAL CARRIER: NAME, ADDRESS, CITY, STATE, ZIP \_\_\_\_\_ COMMERCIAL CARRIER PHONE: INCLUDE AREA CODE \_\_\_\_\_

**VEHICLE**

LP STATE KY LICENSE PLATE # 9441GP VEHICLE IDENTIFICATION # 2G161M15S137E91175973 VEHICLE YEAR 2014 VEHICLE MAKE Cadillac

INSURANCE VERIFIED INSURANCE COMPANY \_\_\_\_\_ INSURANCE POLICY # \_\_\_\_\_ COLOR Black VEHICLE MODEL XTS

COMMERCIAL  GOVERNMENT  IN EMERGENCY RESPONSE

TYPE OF USE \_\_\_\_\_ US DOT # \_\_\_\_\_ TOWED BY: COMPANY NAME Fox Towing

INTERLOCK DEVICE EQUIPPED  HIT/SKIP UNIT #OCCUPANTS 02 VEHICLE WEIGHT GVWR/GCWR 1 - <10K LBS. 2 - 10,001 - 26K LBS. 3 - >26K LBS. HAZARDOUS MATERIAL CLASS # PLACARD ID # \_\_\_\_\_

UNIT TYPE 01

1 - PASSENGER CAR 7 - MOTORCYCLE 2-WHEELED 12 - GOLF CART 18 - LIMO (LIVERY VEHICLE) 23 - PEDESTRIAN / SKATER  
 2 - PASSENGER VAN (MINIVAN) 8 - MOTORCYCLE 3-WHEELED 13 - SNOWMOBILE 19 - BUS (16+ PASSENGERS) 24 - WHEELCHAIR (ANY TYPE)  
 3 - SPORT UTILITY VEHICLE 9 - AUTOCYCLE 14 - SINGLE UNIT TRUCK 20 - OTHER VEHICLE 25 - OTHER NON-MOTORIST  
 4 - PICK UP 10 - HOPEL OR MOTORIZED BICYCLE 15 - SEMI-TRACTOR 21 - HEAVY EQUIPMENT 26 - BICYCLE  
 5 - CARGO VAN 11 - ALL TERRAIN VEHICLE (ATV/UTV) 16 - FARM EQUIPMENT 22 - ANIMAL WITH RIDER OR ANIMAL-DRAWN VEHICLE 27 - TRAIN  
 6 - VAN (9-15 SEATS) 17 - MOTORHOME

# of TRAILING UNITS 0

WAS VEHICLE OPERATING IN AUTONOMOUS MODE WHEN CRASH OCCURRED? 2

1 - YES 2 - NO 9 - OTHER / UNKNOWN

AUTONOMOUS MODE LEVEL

0 - NO AUTOMATION 3 - CONDITIONAL AUTOMATION 9 - UNKNOWN  
 1 - DRIVER ASSISTANCE 4 - HIGH AUTOMATION  
 2 - PARTIAL AUTOMATION 5 - FULL AUTOMATION

SPECIAL FUNCTION 01

1 - NONE 6 - BUS - CHARTER/TOUR 11 - FIRE 16 - FARM 21 - MAIL CARRIER  
 2 - TAXI 7 - BUS - INTERCITY 12 - MILITARY 17 - MOWING 99 - OTHER / UNKNOWN  
 3 - ELECTRONIC RIDE SHARING 8 - BUS - SHUTTLE 13 - POLICE 18 - SNOW REMOVAL  
 4 - SCHOOL TRANSPORT 9 - BUS - OTHER 14 - PUBLIC UTILITY 19 - TOWING  
 5 - BUS - TRANSIT/COMMUTER 10 - AMBULANCE 15 - CONSTRUCTION EQUIPMENT 20 - SAFETY SERVICE PATROL

CARGO BODY TYPE 01

1 - NO CARGO BODY TYPE / NOT APPLICABLE 3 - VEHICLE TOWING ANOTHER MOTOR VEHICLE 5 - INTERMODAL CONTAINER CHASSIS 8 - POLE 12 - CONCRETE MIXER  
 2 - BUS 4 - LOGGING 6 - CARGO VAN/ENCLOSED BOX 9 - CARGO TANK 13 - AUTO TRANSPORTER  
 7 - GRAVICHIPS/GRAVEL 11 - DUMP 10 - FLAT BED 14 - GARBAGE/REFUSE 99 - OTHER / UNKNOWN

VEHICLE DEFECTS 3

1 - TURN SIGNALS 4 - BRAKES 7 - WORN OR SLICK TIRES 9 - MOTOR TROUBLE 99 - OTHER / UNKNOWN  
 2 - HEAD LAMPS 5 - STEERING 8 - TRAILER EQUIPMENT DEFECTIVE 10 - DISABLED FROM PRIOR ACCIDENT  
 3 - TAIL LAMPS 6 - TIRE BLOWOUT

NON-MOTORIST LOCATION AT IMPACT 1

1 - INTERSECTION - MARKED CROSSWALK 3 - INTERSECTION - OTHER 6 - BICYCLE LANE 9 - MEDIAN/CROSSING ISLAND 12 - FIRST RESPONDER AT INCIDENT SCENE  
 2 - INTERSECTION - UNMARKED CROSSWALK 4 - HOBLOCK - MARKED CROSSWALK 7 - SHOULDER / ROADSIDE 10 - DRIVEWAY ACCESS 99 - OTHER / UNKNOWN  
 5 - TRAVEL LANE - OTHER LOCATION 8 - SIDEWALK 11 - SHARED USE PATHS OR TRAILS

ACTION 4

1 - NON-CONTACT 1 - STRAIGHT AHEAD 7 - MAKING U-TURN 13 - NEGOTIATING A CURVE 18 - APPROACHING OR LEAVING VEHICLE  
 2 - NON-COLLISION 2 - BACKING 8 - ENTERING TRAFFIC LANE 14 - ENTERING OR CROSSING SPECIFIED LOCATION 19 - STANDING  
 3 - STRIKING 06 3 - CHANGING LANES 9 - LEAVING TRAFFIC LANE 15 - WALKING, RUNNING, JOGGING, PLAYING 20 - OTHER NON-MOTORIST  
 4 - STRUCK PRE-CRASH ACTIONS 10 - PARKED 16 - WORKING 21 - STANDING OUTSIDE DISABLED VEHICLE  
 5 - BOTH STRIKING & STRUCK 5 - MAKING RIGHT TURN 11 - SLOWING OR STOPPED IN TRAFFIC 17 - PUSHING VEHICLE 99 - OTHER / UNKNOWN  
 9 - OTHER / UNKNOWN 6 - MAKING LEFT TURN 12 - DRIVERLESS

CONTRIBUTING CIRCUMSTANCES 01

1 - NONE 7 - LEFT OF CENTER 13 - IMPROPER START FROM A PARKED POSITION 17 - VISION OBSTRUCTION 21 - LYING IN ROADWAY  
 2 - FAILURE TO YIELD 8 - FOLLOWING TOO CLOSE / ACDA 14 - STOPPED OR PARKED ILLEGALLY 18 - OPERATING DEFECTIVE EQUIPMENT 22 - NOT DISCERNIBLE  
 3 - RAN RED LIGHT 9 - IMPROPER LANE CHANGE 15 - SWERVING TO AVOID 19 - LOAD SHIFTING/FALLING/SPILLING 23 - OPENING DOOR INTO ROADWAY  
 4 - RAN STOP SIGN 10 - IMPROPER PASSING 16 - WRONG WAY 20 - IMPROPER CROSSING 99 - OTHER IMPROPER ACTION  
 5 - UNSAFE SPEED 11 - DROVE OFF ROAD  
 6 - IMPROPER TURN 12 - IMPROPER BACKING

SEQUENCE OF EVENTS

1 20 1 - OVERTURN/RULLOVER 6 - EQUIPMENT FAILURE NON-COLLISION 16 - RAILWAY VEHICLE 22 - WORK ZONE MAINTENANCE EQUIPMENT  
 2 1 2 - FIRE/EXPLOSION 7 - SEPARATION OF UNITS 11 - CROSS CENTERLINE - OPPOSITE DIRECTION OF TRAVEL 17 - ANIMAL - FARM 23 - STRUCK BY FALLING, SHIFTING CARGO OR ANYTHING SET IN MOTION BY A MOTOR VEHICLE  
 3 1 3 - IMMERSION 8 - RAN OFF ROAD RIGHT 12 - DOWNHILL RUNAWAY 18 - ANIMAL - DEER 24 - OTHER MOVABLE OBJECT  
 4 1 4 - JACKKNIFE 9 - RAN OFF ROAD LEFT 13 - OTHER NON-COLLISION 19 - ANIMAL - OTHER 25 - WORK ZONE MAINTENANCE EQUIPMENT  
 5 1 5 - CARGO / EQUIPMENT LOSS OR SHIFT 10 - CROSS MEDIAN 14 - PEDESTRIAN 20 - MOTOR VEHICLE IN TRANSPORT 51 - WALL  
 6 1 6 - IMPROPER TURN 12 - IMPROPER BACKING 15 - PEDALCYCLE 21 - PARKED MOTOR VEHICLE 52 - BUILDING  
 27 - BRIDGE PIER OR ABUTMENT 28 - BRIDGE PARAPET 29 - BRIDGE RAIL 30 - GUARDRAIL FACE 31 - GUARDRAIL END 32 - PORTABLE BARRIER 33 - MEDIUM CABLE BARRIER 34 - MEDIUM GUARDRAIL BARRIER 35 - MEDIUM CONCRETE BARRIER 36 - MEDIUM OTHER BARRIER 37 - TRAFFIC SIGN POST 38 - OVERHEAD SIGN POST 39 - LIGHT / LUMINARIES SUPPORT 40 - UTILITY POLE 41 - OTHER POST, POLE OR SUPPORT 42 - CULVERT 43 - CURB 44 - DITCH 45 - EMBANKMENT 46 - FENCE 47 - MAILBOX 48 - TREE 49 - FIRE HYDRANT 50 - WORK ZONE MAINTENANCE EQUIPMENT 53 - TUNNEL 54 - OTHER FIXED OBJECT 99 - OTHER / UNKNOWN

FIRST HARMFUL EVENT 1 MOST HARMFUL EVENT 1

LOCAL REPORT NUMBER 2, 2, 0, 7, 8, 9, 9, 6

DAMAGE

DAMAGE SCALE

4 1 - NONE 3 - FUNCTIONAL DAMAGE  
 2 - MINOR DAMAGE 4 - DISABLING DAMAGE  
 9 - UNKNOWN

DAMAGED AREA(S) INDICATE ALL THAT APPLY

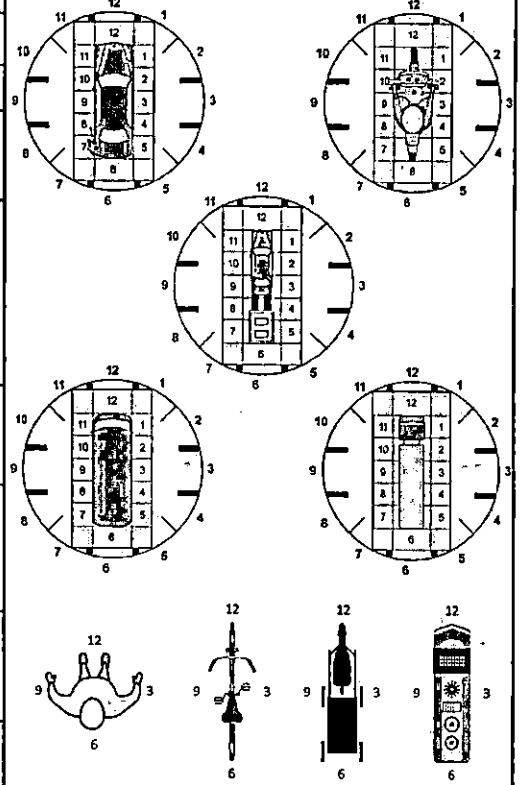

- NO DAMAGE [0]  - UNDERCARRIAGE [14]  
 - TOP [13]  - ALL AREAS [15]  
 - UNIT NOT AT SCENE [16]

INITIAL POINT OF CONTACT

08 0 - NO DAMAGE 14 - UNDERCARRIAGE  
 1 - 12 - REFER TO UNIT DIAGRAM 15 - VEHICLE NOT AT SCENE  
 13 - TOP 99 - UNKNOWN

TRAFFIC

TRAFFICWAY FLOW 2 1 - ONE-WAY 2 - TWO-WAY

TRAFFIC CONTROL 2 1 - ROUNDABOUT 4 - STOP SIGN 2 - SIGNAL 5 - YIELD SIGN 3 - FLASHER 6 - NO CONTROL

# OF THROUGH LANES ON ROAD 5

RAIL GRADE CROSSING 1 1 - NOT INVOLVED 2 - INVOLVED-ACTIVE CROSSING 3 - INVOLVED-PASSIVE CROSSING

UNIT / NON-MOTORIST DIRECTION

FROM 3 TO 2

1 - NORTH 5 - NORTHEAST  
 2 - SOUTH 6 - NORTHWEST  
 3 - EAST 7 - SOUTHEAST  
 4 - WEST 8 - SOUTHWEST  
 9 - OTHER / UNKNOWN

UNIT SPEED 10

POSTED SPEED 35

DETECTED SPEED 1 1 - STATED / ESTIMATED SPEED 2 - CALCULATED / EDR 3 - UNDETERMINED



# MOTORIST / Non-MOTORIST

LOCAL REPORT NUMBER  
2 2 0 7 8 9 9 6

UNIT # 0 1	NAME: LAST, FIRST, MIDDLE Lane, Mark Anthony	DATE OF BIRTH 0 4 0 9 1 9 6 7	AGE 5 5	GENDER M
---------------	---	----------------------------------	------------	-------------

ADDRESS: STREET, CITY, STATE, ZIP 4777 Tall Oak Drive Aurora, IN 47001	CONTACT PHONE - INCLUDE AREA CODE
---	-----------------------------------

INJURIES 5	INJURED TAKEN BY	EMS AGENCY (NAME) Fairfield F.D.	INJURED TAKEN TO: MEDICAL FACILITY (NAME, CITY)	SAFETY EQUIPMENT USED 0 4	<input type="checkbox"/> DOT-COMPLIANT MC HELMET	SEATING POSITION 0 1	AIR BAG USAGE 1	EJECTION 1	TRAPPED 1
OL STATE I N	OPERATOR LICENSE NUMBER	OFFENSE CHARGED 313.01A	LOCAL CODE <input checked="" type="checkbox"/>	OFFENSE DESCRIPTION Traffic Control Device	CITATION NUMBER 255514				
OL CLASS 4	ENDORSEMENT SELECT UP TO 2	RESTRICTION SELECT UP TO 3	DRIVER DISTRACTED BY 1	ALCOHOL / DRUG SUSPECTED <input type="checkbox"/> ALCOHOL <input type="checkbox"/> MARIJUANA <input type="checkbox"/> OTHER DRUG	CONDITION 1	ALCOHOL TEST STATUS 1 TYPE 1 VALUE	DRUG TEST(S) STATUS 1 TYPE 1 RESULT		

UNIT # 0 2	NAME: LAST, FIRST, MIDDLE Wroot Annette E.	DATE OF BIRTH 1 0 2 5 1 9 6 0	AGE 6 2	GENDER F
---------------	---	----------------------------------	------------	-------------

ADDRESS: STREET, CITY, STATE, ZIP 4380 Haverland Drive Hamilton, Ohio 45015	CONTACT PHONE - INCLUDE AREA CODE
--	-----------------------------------

INJURIES 4	INJURED TAKEN BY 1	EMS AGENCY (NAME) Fairfield F.D.	INJURED TAKEN TO: MEDICAL FACILITY (NAME, CITY)	SAFETY EQUIPMENT USED 0 4	<input type="checkbox"/> DOT-COMPLIANT MC HELMET	SEATING POSITION 0 1	AIR BAG USAGE 3	EJECTION 1	TRAPPED 1
OL STATE O H	OPERATOR LICENSE NUMBER	OFFENSE CHARGED	LOCAL CODE <input type="checkbox"/>	OFFENSE DESCRIPTION	CITATION NUMBER				
OL CLASS 4	ENDORSEMENT SELECT UP TO 2	RESTRICTION SELECT UP TO 3	DRIVER DISTRACTED BY 1	ALCOHOL / DRUG SUSPECTED <input type="checkbox"/> ALCOHOL <input type="checkbox"/> MARIJUANA <input type="checkbox"/> OTHER DRUG	CONDITION 1	ALCOHOL TEST STATUS 1 TYPE 1 VALUE	DRUG TEST(S) STATUS 1 TYPE 1 RESULT		

UNIT #	NAME: LAST, FIRST, MIDDLE	DATE OF BIRTH	AGE 0	GENDER
--------	---------------------------	---------------	----------	--------

ADDRESS: STREET, CITY, STATE, ZIP	CONTACT PHONE - INCLUDE AREA CODE
-----------------------------------	-----------------------------------

INJURIES	INJURED TAKEN BY	EMS AGENCY (NAME)	INJURED TAKEN TO: MEDICAL FACILITY (NAME, CITY)	SAFETY EQUIPMENT USED	<input type="checkbox"/> DOT-COMPLIANT MC HELMET	SEATING POSITION	AIR BAG USAGE	EJECTION	TRAPPED
OL STATE	OPERATOR LICENSE NUMBER	OFFENSE CHARGED	LOCAL CODE <input type="checkbox"/>	OFFENSE DESCRIPTION	CITATION NUMBER				
OL CLASS	ENDORSEMENT SELECT UP TO 2	RESTRICTION SELECT UP TO 3	DRIVER DISTRACTED BY	ALCOHOL / DRUG SUSPECTED <input type="checkbox"/> ALCOHOL <input type="checkbox"/> MARIJUANA <input type="checkbox"/> OTHER DRUG	CONDITION	ALCOHOL TEST STATUS TYPE VALUE	DRUG TEST(S) STATUS TYPE RESULT		

INJURIES	SEATING POSITION	AIR BAG	OL CLASS	OL RESTRICTION(S)	DRIVER DISTRACTION	TEST STATUS
1 - FATAL	1 - FRONT - LEFT SIDE (MOTORCYCLE DRIVER)	1 - NOT DEPLOYED	1 - CLASS A	1 - ALCOHOL INTERLOCK DEVICE	1 - NOT DISTRACTED	1 - NONE GIVEN
2 - SUSPECTED SERIOUS INJURY	2 - FRONT - MIDDLE	2 - DEPLOYED FRONT	2 - CLASS B	2 - CDL INTRASTATE ONLY	2 - MANUALLY OPERATING AN ELECTRONIC COMMUNICATION DEVICE (TEXTING, TYPING, DIALING)	2 - TEST REFUSED
3 - SUSPECTED MILD INJURY	3 - FRONT - RIGHT SIDE	3 - DEPLOYED SIDE	3 - CLASS C	3 - CORRECTIVE LENSES	3 - TALKING ON HANDS-FREE COMMUNICATION DEVICE	3 - TEST GIVEN, CONTAMINATED SAMPLE / UNUSABLE
4 - POSSIBLE INJURY	4 - SECOND - LEFT SIDE (MOTORCYCLE PASSENGER)	4 - DEPLOYED BOTH FRONT / SIDE	4 - REGULAR CLASS (OHIO = D)	4 - FARM WAIVER	4 - TALKING ON HAND-HELD COMMUNICATION DEVICE	4 - TEST GIVEN, RESULTS KNOWN
5 - NO APPARENT INJURY	5 - SECOND - MIDDLE	5 - NOT APPLICABLE	5 - MIC MOPED ONLY	5 - EXCEPT CLASS A BUS	5 - OTHER ACTIVITY WITH AN ELECTRONIC DEVICE	5 - TEST GIVEN, RESULTS UNKNOWN
<b>INJURED TAKEN BY</b>	6 - SECOND - RIGHT SIDE	9 - DEPLOYMENT UNKNOWN	6 - NO VALID OL	6 - EXCEPT CLASS A & CLASS B BUS	6 - PASSENGER	<b>ALCOHOL TEST TYPE</b>
1 - NOT TRANSPORTED / TREATED AT SCENE	7 - THIRD - LEFT SIDE (MOTORCYCLE SIDE CAR)	<b>EJECTION</b>	<b>OL ENDORSEMENT</b>	7 - EXCEPT TRACTOR-TRAILER	7 - OTHER DISTRACTION INSIDE THE VEHICLE	1 - NONE
2 - EMS	8 - THIRD - MIDDLE	1 - NOT EJECTED	H - HAZMAT	8 - INTERMEDIATE LICENSE RESTRICTIONS	8 - OTHER DISTRACTION OUTSIDE THE VEHICLE	2 - BLOOD
3 - POLICE	9 - THIRD - RIGHT SIDE	2 - PARTIALLY EJECTED	M - MOTORCYCLE	9 - LEARNER'S PERMIT RESTRICTIONS	9 - OTHER / UNKNOWN	3 - URINE
9 - OTHER / UNKNOWN	10 - SLEEPER SECTION OF TRUCK CAB	3 - TOTALLY EJECTED	P - PASSENGER	10 - LIMITED TO DAYLIGHT ONLY	<b>DRUG TEST TYPE</b>	4 - BREATH
<b>SAFETY EQUIPMENT</b>	11 - PASSENGER IN OTHER ENCLOSED CARGO AREA (NON-TRAILING UNIT, BUS, PICK-UP WITH CAP)	4 - NOT APPLICABLE	N - TANKER	11 - LIMITED TO EMPLOYMENT	1 - NONE	5 - OTHER
1 - NONE USED	12 - PASSENGER IN UNENCLOSED CARGO AREA	<b>TRAPPED</b>	Q - MOTOR SCOOTER	12 - LIMITED - OTHER	2 - BLOOD	<b>DRUG TEST RESULT(S)</b>
2 - SHOULDER BELT ONLY USED	13 - TRAILING UNIT	1 - NOT TRAPPED	R - THREE-WHEEL MOTORCYCLE	13 - MECHANICAL DEVICES (SPECIAL BRAKES, HAND CONTROLS, OR OTHER ADAPTIVE DEVICES)	3 - URINE	1 - AMPHETAMINES
3 - LAP BELT ONLY USED	14 - RIDING ON VEHICLE EXTERIOR (NON-TRAILING UNIT)	2 - EXTRICATED BY MECHANICAL MEANS	S - SCHOOL BUS	14 - MILITARY VEHICLES ONLY	4 - OTHER	2 - BARBITURATES
4 - SHOULDER & LAP BELT USED	15 - NON-MOTORIST	3 - FREED BY NON-MECHANICAL MEANS	T - DOUBLE & TRIPLE TRAILERS	15 - MOTOR VEHICLES WITHOUT AIR BRAKES	<b>CONDITION</b>	3 - BENZODIAZEPINES
5 - CHILD RESTRAINT SYSTEM - FORWARD FACING	99 - OTHER / UNKNOWN		X - TANKER / HAZMAT	16 - OUTSIDE MIRROR	1 - APPARENTLY NORMAL	4 - CANNABINOIDS
6 - CHILD RESTRAINT SYSTEM - REAR FACING				17 - PROSTHETIC AID	2 - PHYSICAL IMPAIRMENT	5 - COCAINE
7 - BOOSTER SEAT			<b>GENDER</b>	18 - OTHER	3 - EMOTIONAL (E.G. DEPRESSED, ANGRY, DISTURBED)	6 - OPIATES / OPIOIDS
8 - HELMET USED			F - FEMALE		4 - ILLNESS	7 - OTHER
9 - PROTECTIVE PADS USED (ELBOW, KNEES, ETC.)			M - MALE		5 - FELL ASLEEP, FAINTED, FATIGUED, ETC.	8 - NEGATIVE RESULTS
10 - REFLECTIVE CLOTHING			U - OTHER / UNKNOWN		6 - UNDER THE INFLUENCE OF MEDICATIONS / DRUGS / ALCOHOL	
11 - LIGHTING - PEDESTRIAN / BICYCLE ONLY					9 - OTHER / UNKNOWN	
99 - OTHER / UNKNOWN						



# OCCUPANT / WITNESS ADDENDUM

LOCAL REPORT NUMBER  
2 2 0 7 8 9 9 6

<b>OCCUPANT</b>	UNIT # 2	NAME: LAST, FIRST, MIDDLE Langevin, Roni	DATE OF BIRTH 1 0 0 3 1 9 5 8	AGE 6 4	GENDER F
	ADDRESS: STREET, CITY, STATE, ZIP 7 Brians Lane Fairfield, Ohio 45014		CONTACT PHONE - INCLUDE AREA CODE		

INJURIES 4	INJURED TAKEN BY 2	EMS AGENCY (NAME) Fairfield F.D.	INJURED TAKEN TO: MEDICAL FACILITY (NAME, CITY) Mercy - Fairfield	SAFETY EQUIPMENT USED 0 4	<input type="checkbox"/> DOT-COMPLIANT MC HELMET	SEATING POSITION 0 3	AIR BAG USAGE 3	EJECTION 1	TRAPPED 1
---------------	-----------------------	-------------------------------------	--	------------------------------	--	-------------------------	--------------------	---------------	--------------

<b>OCCUPANT</b>	UNIT #	NAME: LAST, FIRST, MIDDLE	DATE OF BIRTH	AGE 0	GENDER
	ADDRESS: STREET, CITY, STATE, ZIP		CONTACT PHONE - INCLUDE AREA CODE		

INJURIES	INJURED TAKEN BY	EMS AGENCY (NAME)	INJURED TAKEN TO: MEDICAL FACILITY (NAME, CITY)	SAFETY EQUIPMENT USED	<input type="checkbox"/> DOT-COMPLIANT MC HELMET	SEATING POSITION	AIR BAG USAGE	EJECTION	TRAPPED
----------	------------------	-------------------	---	-----------------------	--	------------------	---------------	----------	---------

<b>OCCUPANT</b>	UNIT #	NAME: LAST, FIRST, MIDDLE	DATE OF BIRTH	AGE 0	GENDER
	ADDRESS: STREET, CITY, STATE, ZIP		CONTACT PHONE - INCLUDE AREA CODE		

INJURIES	INJURED TAKEN BY	EMS AGENCY (NAME)	INJURED TAKEN TO: MEDICAL FACILITY (NAME, CITY)	SAFETY EQUIPMENT USED	<input type="checkbox"/> DOT-COMPLIANT MC HELMET	SEATING POSITION	AIR BAG USAGE	EJECTION	TRAPPED
----------	------------------	-------------------	---	-----------------------	--	------------------	---------------	----------	---------

<b>OCCUPANT</b>	UNIT #	NAME: LAST, FIRST, MIDDLE	DATE OF BIRTH	AGE 0	GENDER
	ADDRESS: STREET, CITY, STATE, ZIP		CONTACT PHONE - INCLUDE AREA CODE		

INJURIES	INJURED TAKEN BY	EMS AGENCY (NAME)	INJURED TAKEN TO: MEDICAL FACILITY (NAME, CITY)	SAFETY EQUIPMENT USED	<input type="checkbox"/> DOT-COMPLIANT MC HELMET	SEATING POSITION	AIR BAG USAGE	EJECTION	TRAPPED
----------	------------------	-------------------	---	-----------------------	--	------------------	---------------	----------	---------

INJURIES	SAFETY EQUIPMENT USED	SEATING POSITION	AIR BAG USAGE
1 - FATAL	1 - NONE USED - VEHICLE OCCUPANT	1 - FRONT - LEFT SIDE (MOTORCYCLE DRIVER)	1 - NOT DEPLOYED
2 - SUSPECTED SERIOUS INJURY	2 - SHOULDER BELT ONLY USED	2 - FRONT - MIDDLE	2 - DEPLOYED FRONT
3 - SUSPECTED MINOR INJURY	3 - LAP BELT ONLY USED	3 - FRONT - RIGHT SIDE	3 - DEPLOYED SIDE
4 - POSSIBLE INJURY	4 - SHOULDER & LAP BELT USED	4 - SECOND - LEFT SIDE (MOTORCYCLE PASSENGER)	4 - DEPLOYED BOTH FRONT/SIDE
5 - NO APPARENT INJURY	5 - CHILD RESTRAINT SYSTEM - FORWARD FACING	5 - SECOND - MIDDLE	5 - NOT APPLICABLE
	6 - CHILD RESTRAINT SYSTEM - REAR FACING	6 - SECOND - RIGHT SIDE	9 - DEPLOYMENT UNKNOWN
	7 - BOOSTER SEAT	7 - THIRD - LEFT SIDE (MOTORCYCLE SIDE CAR)	
	8 - HELMET USED	8 - THIRD - MIDDLE	
	9 - PROTECTIVE PADS USED (ELBOW, KNEES, ETC.)	9 - THIRD - RIGHT SIDE	
	10 - REFLECTIVE CLOTHING	10 - SLEEPER SECTION OF TRUCK CAB	
	11 - LIGHTING - PEDESTRIAN / BICYCLE ONLY	11 - PASSENGER IN OTHER ENCLOSED CARGO AREA (NON-TRAILING UNIT, BUS, PICK-UP WITH CAP)	
	99 - OTHER / UNKNOWN	12 - PASSENGER IN UNENCLOSED CARGO AREA	
		13 - TRAILING UNIT	
		14 - RIDING ON VEHICLE EXTERIOR (NON-TRAILING UNIT)	
		15 - NON-MOTORIST	
		99 - OTHER / UNKNOWN	

<b>WITNESS</b>	NAME: LAST, FIRST, MIDDLE	DATE OF BIRTH	AGE 0	GENDER
	ADDRESS: STREET, CITY, STATE, ZIP	CONTACT PHONE - INCLUDE AREA CODE		

<b>WITNESS</b>	NAME: LAST, FIRST, MIDDLE	DATE OF BIRTH	AGE 0	GENDER
	ADDRESS: STREET, CITY, STATE, ZIP	CONTACT PHONE - INCLUDE AREA CODE		

<b>WITNESS</b>	NAME: LAST, FIRST, MIDDLE	DATE OF BIRTH	AGE 0	GENDER
	ADDRESS: STREET, CITY, STATE, ZIP	CONTACT PHONE - INCLUDE AREA CODE		

LOCAL REPORT NUMBER 22-078996

REPORTING AGENCY FAIRFIELD P.D. 00901

DATE OF ACCIDENT M 10 10 28 12 2022

IN COUNTY OF BUTLER

ACCIDENT LOCATION South Gilmore Rd. Annandale Drive

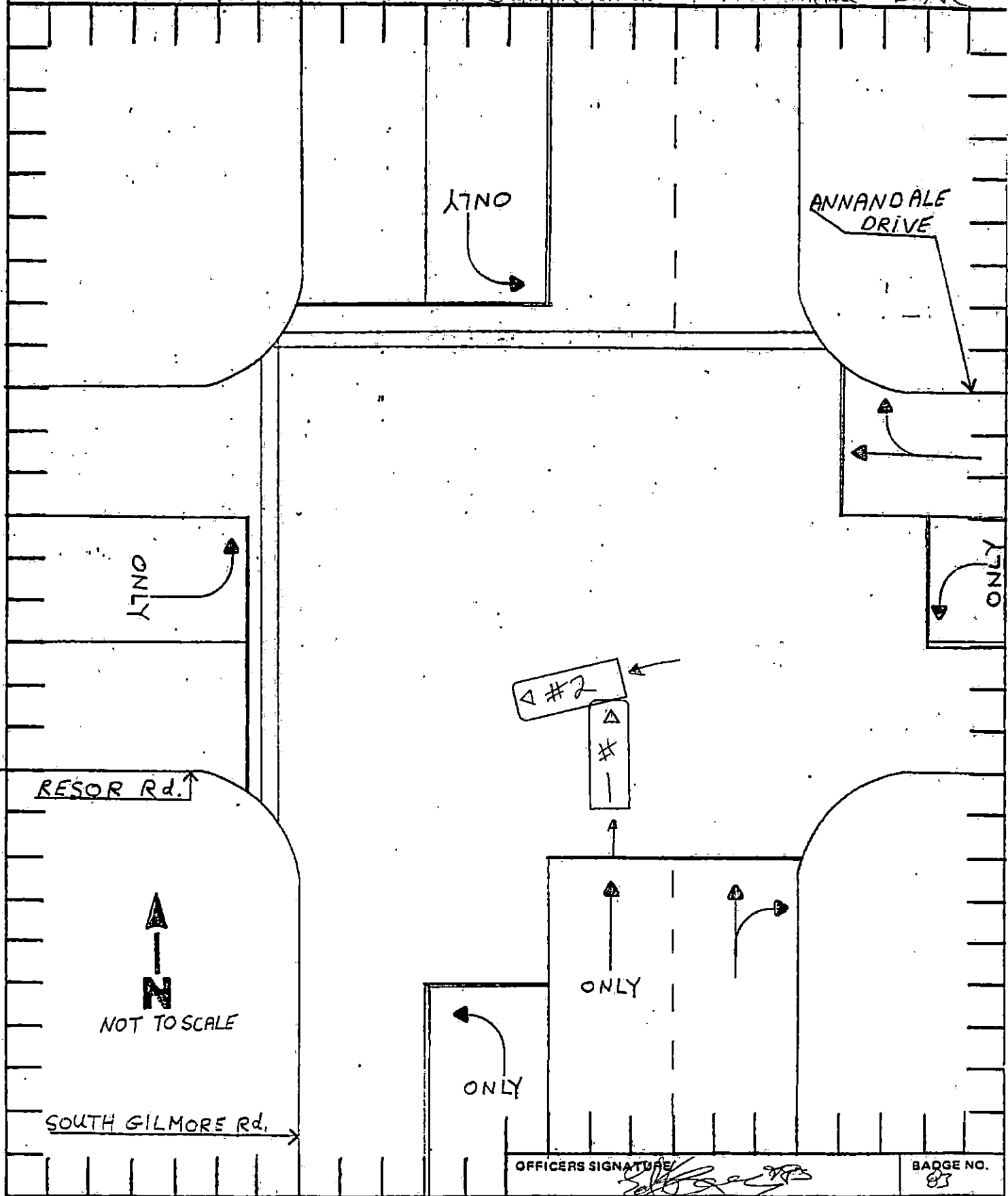

OFFICERS SIGNATURE *[Signature]*

BARGE NO. 83