



TRAFFIC CRASH REPORT

*DENOTES MANDATORY FIELD FOR SUPPLEMENT REPORT

LOCAL REPORT NUMBER*

<input checked="" type="checkbox"/> PHOTOSTAKEN	<input checked="" type="checkbox"/> OH-2	<input type="checkbox"/> OH-3	LOCAL INFORMATION	2 2 0 7 9 9 1 4		
<input type="checkbox"/> SECONDARY CRASH	<input checked="" type="checkbox"/> OH-1P	<input type="checkbox"/> OTHER	REPORTING AGENCY NAME*	NCIC*	HIT/SKIP	NUMBER OF UNITS
<input type="checkbox"/> PRIVATE PROPERTY			Fairfield Police Department	0 0 9 0 1	1 - SOLVED	0 2
					2 - UNSOLVED	UNIT IN ERROR
						9 9 98 - ANIMAL
						99 - UNKNOWN

COUNTY*	LOCALITY*	LOCATION: CITY, VILLAGE, TOWNSHIP*	CRASH DATE / TIME*	CRASH SEVERITY
0 9	1	City of Fairfield	1 1 0 1 2 0 2 2 1 2 3 4	5

ROUTE TYPE	ROUTE NUMBER	PREFIX	LOCATION ROAD NAME	ROAD TYPE	LATITUDE DECIMAL DEGREES
			Michael	L N	3 9 . 3 3 7 0 7 5
ROUTE TYPE	ROUTE NUMBER	PREFIX	REFERENCE ROAD NAME (ROAD, MILEPOST, HOUSE #)	ROAD TYPE	LONGITUDE DECIMAL DEGREES
			8781		- 8 4 . 5 2 7 8 7 6

REFERENCE POINT	DIRECTION FROM REFERENCE	ROUTE TYPE	ROAD TYPE	INTERSECTION RELATED
1 - INTERSECTION	1 - NORTH	IR - INTERSTATE ROUTE (TP)	AL - ALLEY	<input type="checkbox"/> WITHIN INTERSECTION OR ON APPROACH
2 - MILE POST	2 - SOUTH	US - FEDERAL US ROUTE	AV - AVENUE	<input type="checkbox"/> WITHIN INTERCHANGE AREA
3 - HOUSE #	3 - EAST	SR - STATE ROUTE	BL - BOULEVARD	NUMBER OF APPROACHES
	4 - WEST	CR - NUMBERED COUNTY ROUTE	CR - CIRCLE	
		TR - NUMBERED TOWNSHIP ROUTE	DR - DRIVE	
			HE - HEIGHTS	
			PL - PLACE	
			RD - ROAD	
			SO - SQUARE	
			ST - STREET	
			TE - TERRACE	
			TL - TRAIL	
			VA - WAY	
				<input type="checkbox"/> ROADWAY DIVIDED

LOCATION OF FIRST HARMFUL EVENT	MANNER OF CRASH COLLISION/IMPACT	DIRECTION OF TRAVEL	MEDIAN TYPE
1 - ON ROADWAY	1 - NOT COLLISION BETWEEN TWO MOTOR VEHICLES IN TRANSPORT	1 - NORTH	1 - DIVIDED FLUSH MEDIAN (<4 FEET)
2 - ON SHOULDER	2 - REAR-END	2 - SOUTH	2 - DIVIDED FLUSH MEDIAN (≥4 FEET)
3 - IN MEDIAN	3 - HEAD-ON	3 - EAST	3 - DIVIDED, DEPRESSED MEDIAN
4 - ON ROADSIDE	4 - REAR-TO-REAR	4 - WEST	4 - DIVIDED, RAISED MEDIAN (ANY TYPE)
5 - ON GORE	5 - BACKING		9 - OTHER/UNKNOWN
6 - OUTSIDE TRAFFIC WAY	6 - ANGLE		
7 - ON RAMP	7 - SIDESWIPE, SAME DIRECTION		
8 - OFF RAMP	8 - SIDESWIPE, OPPOSITE DIRECTION		
9 - CROSSOVER	9 - OTHER / UNKNOWN		
10 - DRIVEWAY/ALLEY ACCESS			
11 - RAILWAY GRADE CROSSING			
12 - SHARED USE PATHS OR TRAILS			
13 - BIKE LANE			
14 - TOLL BOOTH			
99 - OTHER / UNKNOWN			

<input type="checkbox"/> WORK ZONE RELATED	WORK ZONE TYPE	LOCATION OF CRASH IN WORK ZONE	CONTOUR	CONDITIONS	SURFACE
<input type="checkbox"/> WORKERS PRESENT	1 - LANE CLOSURE	1 - BEFORE THE 1ST WORK ZONE WARNING SIGN	1	1 - DRY	1 - CONCRETE
<input type="checkbox"/> LAW ENFORCEMENT PRESENT	2 - LANE SHIFT/CROSSOVER	2 - ADVANCE WARNING AREA		2 - WET	2 - BLACKTOP, BITUMINOUS, ASPHALT
<input type="checkbox"/> ACTIVE SCHOOL ZONE	3 - WORK ON SHOULDER OR MEDIAN	3 - TRANSITION AREA		3 - SNOW	3 - BRICK/BLOCK
	4 - INTERMITTENT OR MOVING WORK	4 - ACTIVITY AREA		4 - ICE	4 - SLAG, GRAVEL, STONE
	5 - OTHER	5 - TERMINATION AREA		5 - SAND, MUD, DIRT, OIL, GRAVEL	5 - DIRT
				6 - WATER (STANDING, MOVING)	9 - OTHER/UNKNOWN
				7 - SLUSH	
				9 - OTHER/UNKNOWN	

LIGHT CONDITION	WEATHER
1 - DAYLIGHT	1 - CLEAR
2 - DAWN/DUSK	2 - CLOUDY
3 - DARK - LIGHTED ROADWAY	3 - FOG, SMOG, SMOKE
4 - DARK - ROADWAY NOT LIGHTED	4 - RAIN
5 - DARK - UNKNOWN ROADWAY LIGHTING	5 - SLEET, HAIL
9 - OTHER / UNKNOWN	6 - SNOW
	7 - SEVERE CROSSWINDS
	8 - BLOWING SAND, SOIL, DIRT, SNOW
	9 - FREEZING RAIN OR FREEZING DRIZZLE
	99 - OTHER / UNKNOWN

NARRATIVE	Indicate the north direction with an "N" on the compass diagram.
On 11-01-22, at 12:34 p.m. Unit 1 was traveling south on Michael Ln behind Unit 2. The driver of Unit 1 stated that Unit 2 moved to the right side of the road as to continue straight and he pulled up to turn left when Unit 2 began to turn left, striking Unit 1. The driver of Unit 2 stated that Unit 1 crossed the double yellow line and began to turn left as he was turning left.	SEE OH-2

CRASH REPORTED DATE / TIME	DISPATCH DATE / TIME	ARRIVAL DATE / TIME	SCENE CLEARED DATE / TIME	REPORT TAKEN BY
1 1 0 1 2 0 2 2 1 2 3 4	1 1 0 1 2 0 2 2 1 2 3 7	1 1 0 1 2 0 2 2 1 2 4 6	1 1 0 1 2 0 2 2 1 3 1 4	<input checked="" type="checkbox"/> POLICE AGENCY
TOTAL TIME ROADWAY CLOSED	OTHER INVESTIGATION TIME	TOTAL MINUTES	OFFICER'S NAME*	CHECKED BY OFFICER'S NAME*
		3 7	D. Setterstrom	Sgt. J. Frago
			OFFICER'S BADGE NUMBER*	CHECKED BY OFFICER'S BADGE NUMBER*
			1 2 1	2 4
				<input type="checkbox"/> SUPPLEMENT (CORRECTION OR ADDITION TO AN EXISTING REPORT SENT TO OHS)

LOCAL REPORT NUMBER
 2, 2, 0, 7, 9, 9, 1, 4

OWNER

UNIT # 01 OWNER NAME: LAST, FIRST, MIDDLE (SAME AS DRIVER)
 OWNER ADDRESS: STREET, CITY, STATE, ZIP (SAME AS DRIVER)
 COMMERCIAL CARRIER: NAME, ADDRESS, CITY, STATE, ZIP
 COMMERCIAL CARRIER PHONE: INCLUDE AREA CODE

DAMAGE

DAMAGE SCALE
 1 - NONE 3 - FUNCTIONAL DAMAGE
 2 - MINOR DAMAGE 4 - DISABLING DAMAGE
 9 - UNKNOWN

VEHICLE

LP STATE OH LICENSE PLATE # FAU2989 VEHICLE IDENTIFICATION # 1C4NJCB7H1D157023 VEHICLE YEAR 2017 VEHICLE MAKE Jeep
 INSURANCE VERIFIED INSURANCE COMPANY State Farm INSURANCE POLICY # 20626405FP35 COLOR Red VEHICLE MODEL Compass

DAMAGED AREA(S)
 INDICATE ALL THAT APPLY

TYPE OF USE
 COMMERCIAL GOVERNMENT IN EMERGENCY RESPONSE
 INTERLOCK DEVICE EQUIPPED HIT/SKIP UNIT # OCCUPANTS 01
 US DOT # _____ VEHICLE WEIGHT GVWR/GCWR
 1 - ≤10K LBS.
 2 - 10,001 - 26K LBS.
 3 - >26K LBS.
 TOWED BY: COMPANY NAME _____
 HAZARDOUS MATERIAL
 MATERIAL RELEASED CLASS # _____ PLACARD ID # _____
 PLACARD _____

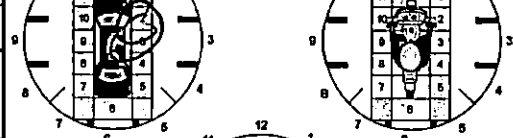

UNIT TYPE 03
 1 - PASSENGER CAR 7 - MOTORCYCLE 2-WHEELED 12 - GOLF CART 18 - LIMO (LIVERY VEHICLE) 23 - PEDESTRIAN / SKATER
 2 - PASSENGER VAN (MINIVAN) 8 - MOTORCYCLE 3-WHEELED 13 - SNOWMOBILE 19 - BUS (16+ PASSENGERS) 24 - WHEELCHAIR (ANY TYPE)
 3 - SPORT UTILITY VEHICLE 9 - AUTOCYCLE 14 - SINGLE UNIT TRUCK 20 - OTHER VEHICLE 25 - OTHER NON-MOTORIST
 4 - PICK UP 10 - MOPED OR MOTORIZED BICYCLE 15 - SEMI-TRACTOR 21 - HEAVY EQUIPMENT 26 - BICYCLE
 5 - CARGO VAN 11 - ALL TERRAIN VEHICLE (ATV / UTV) 16 - FARM EQUIPMENT 22 - ANIMAL WITH RIDER OR ANIMAL-DRAWN VEHICLE 27 - TRAIN
 6 - VAN (9-15 SEATS) 17 - MOTORHOME

OF TRAILING UNITS 0

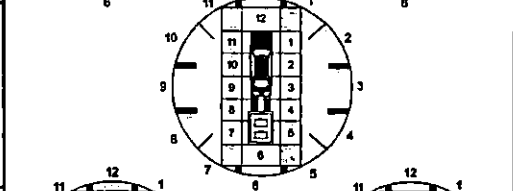

WAS VEHICLE OPERATING IN AUTONOMOUS MODE WHEN CRASH OCCURRED?
2 1 - YES 2 - NO 9 - OTHER / UNKNOWN AUTONOMOUS MODE LEVEL 0
 0 - NO AUTOMATION 1 - DRIVER ASSISTANCE 2 - PARTIAL AUTOMATION 3 - CONDITIONAL AUTOMATION 4 - HIGH AUTOMATION 5 - FULL AUTOMATION 9 - UNKNOWN

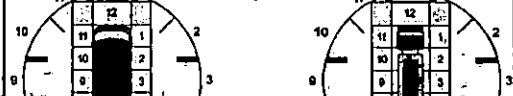

SPECIAL FUNCTION 01
 1 - NONE 6 - BUS - CHARTER/TOUR 11 - FIRE 16 - FARM 21 - MAIL CARRIER
 2 - TAXI 7 - BUS - INTERCITY 12 - MILITARY 17 - MOWING 99 - OTHER / UNKNOWN
 3 - ELECTRONIC RIDE SHARING 8 - BUS - SHUTTLE 13 - POLICE 18 - SNOW REMOVAL
 4 - SCHOOL TRANSPORT 9 - BUS - OTHER 14 - PUBLIC UTILITY 19 - TOWING
 5 - BUS - TRANSPORT/COMMUTER 10 - AMBULANCE 15 - CONSTRUCTION EQUIPMENT 20 - SAFETY SERVICE PATROL

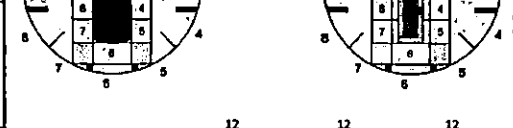

CARGO BODY TYPE 01
 1 - NO CARGO BODY TYPE / NOT APPLICABLE 3 - VEHICLE TOWING ANOTHER MOTORVEHICLE 5 - INTERMODAL CONTAINER CHASSIS 8 - POLE 12 - CONCRETE MIXER
 2 - BUS 4 - LOGGING 6 - CARGO VAN/ENCLOSED BOX 9 - CARGO TANK 13 - AUTO TRANSPORTER
 7 - GRAIN/CHIPS/GRAVEL 11 - DUMP 10 - FLAT BED 14 - GARBAGE/REFUSE 99 - OTHER / UNKNOWN

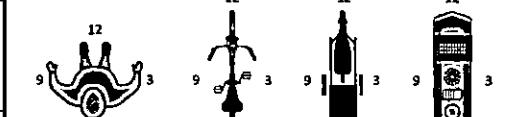

VEHICLE DEFECTS
 1 - TURN SIGNALS 4 - BRAKES 7 - WORN OR SLICK TIRES 9 - MOTOR TROUBLE 99 - OTHER / UNKNOWN
 2 - HEAD LAMPS 5 - STEERING 8 - TRAILER EQUIPMENT DEFECTIVE 10 - DISABLED FROM PRIOR ACCIDENT
 3 - TAIL LAMPS 6 - TIRE BLOWOUT

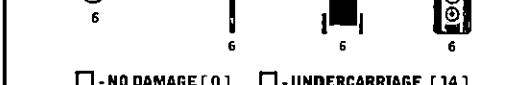

NON-MOTORIST LOCATION AT IMPACT
 1 - INTERSECTION - MARKED CROSSWALK 3 - INTERSECTION - OTHER 6 - BICYCLE LANE 9 - MEDIAN/CROSSING ISLAND 12 - FIRST RESPONDER AT INCIDENT SCENE
 2 - INTERSECTION - UNMARKED CROSSWALK 4 - MIDDLEBLOCK - MARKED CROSSWALK 7 - SHOULDER / ROADSIDE 10 - DRIVEWAY ACCESS 11 - SHARED USE PATHS OR TRAILS 99 - OTHER / UNKNOWN
 5 - TRAVEL LANE - OTHER LOCATION 8 - SIDEWALK

INITIAL POINT OF CONTACT
 0 - NO DAMAGE 14 - UNDERCARRIAGE
02 1-12 - REFER TO UNIT DIAGRAM 15 - VEHICLE NOT AT SCENE
 13 - TOP 99 - UNKNOWN

ACTION 4
 1 - NON-CONTACT 1 - STRAIGHT AHEAD 7 - MAKING U-TURN 13 - NEGOTIATING A CURVE 18 - APPROACHING OR LEAVING VEHICLE
 2 - NON-COLLISION 2 - BACKING 8 - ENTERING TRAFFIC LANE 14 - ENTERING OR CROSSING SPECIFIED LOCATION 19 - STANDING
 3 - STRIKING 06 3 - CHANGING LANES 9 - LEAVING TRAFFIC LANE 15 - WALKING, RUNNING, JOGGING, PLAYING 20 - OTHER NON-MOTORIST
 4 - STRUCK PRE-CRASH ACTIONS 4 - OVERTAKING/PASSING 10 - PARKED 11 - SLOWING OR STOPPED IN TRAFFIC 16 - WORKING 21 - STANDING OUTSIDE DISABLED VEHICLE
 5 - BOTH STRIKING & STRUCK 5 - MAKING RIGHT TURN 12 - DRIVERLESS 17 - PUSHING VEHICLE 99 - OTHER / UNKNOWN
 9 - OTHER / UNKNOWN 6 - MAKING LEFT TURN

TRAFFIC
 TRAFFICWAY FLOW
2 1 - ONE-WAY 2 - TWO-WAY
 TRAFFIC CONTROL
6 1 - ROUNDABOUT 4 - STOP SIGN 2 - SIGNAL 5 - YIELD SIGN 3 - FLASHER 6 - NO CONTROL

CONTRIBUTING CIRCUMSTANCES 99
 1 - NONE 7 - LEFT OF CENTER 13 - IMPROPER START FROM A PARKED POSITION 17 - VISION OBSTRUCTION 21 - LYING IN ROADWAY
 2 - FAILURE TO YIELD 8 - FOLLOWING TOO CLOSE / ACDA 14 - STOPPED OR PARKED ILLEGALLY 18 - OPERATING DEFECTIVE EQUIPMENT 22 - NOT DISCERNIBLE
 3 - RAN RED LIGHT 9 - IMPROPER LANE CHANGE 15 - SWERVING TO AVOID 19 - LOAD SHIFTING/FALLING/SPILLING 23 - OPENING DOOR INTO ROADWAY
 4 - RAN STOP SIGN 10 - IMPROPER PASSING 16 - WRONG WAY 20 - IMPROPER CROSSING 99 - OTHER IMPROPER ACTION
 5 - UNSAFE SPEED 11 - DROVE OFF ROAD 17 - VISION OBSTRUCTION 21 - LYING IN ROADWAY
 6 - IMPROPER TURN 12 - IMPROPER BACKING

OF THROUGH LANES ON ROAD 2
 RAIL GRADE CROSSING
1 1 - NOT INVOLVED 2 - INVOLVED-ACTIVE CROSSING 3 - INVOLVED-PASSIVE CROSSING

SEQUENCE OF EVENTS
120 1 - OVERTURN/ROLLOVER 6 - EQUIPMENT FAILURE 11 - CROSS CENTERLINE - OPPOSITE DIRECTION OF TRAVEL 16 - RAILWAY VEHICLE 22 - WORK ZONE MAINTENANCE EQUIPMENT
2 2 - FIRE/EXPLOSION 7 - SEPARATION OF UNITS 12 - DOWNHILL RUNAWAY 17 - ANIMAL - FARM 23 - STRUCK BY FALLING, SHIFTING CARGO OR ANYTHING SET IN MOTION BY A MOTORVEHICLE
2 3 - IMMERSION 8 - RAN OFF ROAD RIGHT 13 - OTHER NON-COLLISION 18 - ANIMAL - DEER 24 - OTHER MOVABLE OBJECT
3 4 - JACKKNIFE 9 - RAN OFF ROAD LEFT 14 - PEDESTRIAN 19 - ANIMAL - OTHER 20 - MOTORVEHICLE IN TRANSPORT
3 5 - CARGO / EQUIPMENT LOSS OR SHIFT 10 - CROSS MEDIAN 15 - PEDALCYCLE 21 - PARKED MOTORVEHICLE

UNIT / NON-MOTORIST DIRECTION
 FROM 1 TO 3
 1 - NORTH 5 - NORTHEAST
 2 - SOUTH 6 - NORTHWEST
 3 - EAST 7 - SOUTHEAST
 4 - WEST 8 - SOUTHWEST
 9 - OTHER / UNKNOWN

COLLISION WITH FIXED OBJECT / STRUCK
4 25 - IMPACT ATTENUATOR / CRASH CUSHION 31 - GUARDRAIL END 37 - TRAFFIC SIGN POST 43 - CURB 50 - WORK ZONE MAINTENANCE EQUIPMENT
5 26 - BRIDGE OVERHEAD STRUCTURE 32 - PORTABLE BARRIER 38 - OVERHEAD SIGN POST 44 - DITCH 51 - WALL
5 27 - BRIDGE PIER OR ABUTMENT BARRIER 33 - MEDIUM CABLE BARRIER 39 - LIGHT / LUMINARIES SUPPORT 45 - EMBANKMENT 52 - BUILDING
6 28 - BRIDGE PARAPET 34 - MEDIUM GUARDRAIL BARRIER 40 - UTILITY POLE 46 - FENCE 53 - TUNNEL
 29 - BRIDGE RAIL 35 - MEDIUM CONCRETE BARRIER 41 - OTHER POST, POLE OR SUPPORT 47 - MAILBOX 48 - TREE 54 - OTHER FIXED OBJECT
 30 - GUARDRAIL FACE 36 - MEDIUM OTHER BARRIER 42 - CULVERT 49 - FIRE HYDRANT 99 - OTHER / UNKNOWN

UNIT SPEED 10
 POSTED SPEED 25
 DETECTED SPEED
1 1 - STATED / ESTIMATED SPEED 2 - CALCULATED / EDR 3 - UNDETERMINED

FIRST HARMFUL EVENT 1 MOST HARMFUL EVENT 1

OWNER

UNIT # 012 OWNER NAME: LAST, FIRST, MIDDLE (SAME AS DRIVER) _____ OWNER PHONE: INCLUDE AREA CODE (SAME AS DRIVER) _____

OWNER ADDRESS: STREET, CITY, STATE, ZIP (SAME AS DRIVER) _____ COMMERCIAL CARRIER PHONE: INCLUDE AREA CODE _____

COMMERCIAL CARRIER: NAME, ADDRESS, CITY, STATE, ZIP _____

VEHICLE

LP STATE OH LICENSE PLATE # JVR7817 VEHICLE IDENTIFICATION # 1C14PJMJCS10F1W15121915104 VEHICLE YEAR 2015 VEHICLE MAKE Jeep

INSURANCE VERIFIED INSURANCE COMPANY Nationwide INSURANCE POLICY # 92347376188 COLOR Black VEHICLE MODEL Cherokee

COMMERCIAL GOVERNMENT IN EMERGENCY RESPONSE TYPE OF USE US DOT # TOWED BY: COMPANY NAME

INTERLOCK DEVICE EQUIPPED HIT/SKIP UNIT # OCCUPANTS 03 VEHICLE WEIGHT GVWR/GCWV 1 - <10K LBS. 2 - 10,001 - 26K LBS. 3 - >26K LBS. HAZARDOUS MATERIAL CLASS # PLACARD ID #

UNIT TYPE 03 # of TRAILING UNITS 0

1 - PASSENGER CAR	7 - MOTORCYCLE 2-WHEELED	12 - GOLF CART	18 - LIMO (LIVERY VEHICLE)	23 - PEDESTRIAN / SKATER
2 - PASSENGER VAN (MINIVAN)	8 - MOTORCYCLE 3-WHEELED	13 - SNOWMOBILE	19 - BUS (16+ PASSENGERS)	24 - WHEELCHAIR (ANY TYPE)
3 - SPORT UTILITY VEHICLE	9 - AUTOCYCLE	14 - SINGLE UNIT TRUCK	20 - OTHER VEHICLE	25 - OTHER NON-MOTORIST
4 - PICK UP	10 - MOPED OR MOTORIZED BICYCLE	15 - SEMI-TRACTOR	21 - HEAVY EQUIPMENT	26 - BICYCLE
5 - CARGO VAN	11 - ALL TERRAIN VEHICLE (ATV / UTV)	16 - FARM EQUIPMENT	22 - ANIMAL WITH RIDER OR ANIMAL-DRAWN VEHICLE	27 - TRAIN
6 - VAN (9-15 SEATS)		17 - MOTORHOME		99 - UNKNOWN OR HIT/SKIP

WAS VEHICLE OPERATING IN AUTONOMOUS MODE WHEN CRASH OCCURRED? 0

3 1 - YES 2 - NO 9 - OTHER / UNKNOWN AUTONOMOUS MODE LEVEL 0 - NO AUTOMATION 1 - DRIVER ASSISTANCE 2 - PARTIAL AUTOMATION 3 - CONDITIONAL AUTOMATION 4 - HIGH AUTOMATION 5 - FULL AUTOMATION 9 - UNKNOWN

SPECIAL FUNCTION 01

1 - NONE	6 - BUS - CHARTER/TOUR	11 - FIRE	16 - FARM	21 - MAIL CARRIER
2 - TAXI	7 - BUS - INTERCITY	12 - MILITARY	17 - MOWING	99 - OTHER / UNKNOWN
3 - ELECTRONIC RIDE SHARING	8 - BUS - SHUTTLE	13 - POLICE	18 - SNOW REMOVAL	
4 - SCHOOL TRANSPORT	9 - BUS - OTHER	14 - PUBLIC UTILITY	19 - TOWING	
5 - BUS - TRANSIT/COMMUTER	10 - AMBULANCE	15 - CONSTRUCTION EQUIPMENT	20 - SAFETY SERVICE PATROL	

CARGO BODY TYPE 01

1 - NO CARGO BODY TYPE / NOT APPLICABLE	3 - VEHICLE TOWING ANOTHER MOTOR VEHICLE	5 - INTERMODAL CONTAINER CHASSIS	8 - POLE	12 - CONCRETE MIXER
2 - BUS	4 - LOGGING	6 - CARGO VAN/ENCLOSED BOX	9 - CARGO TANK	13 - AUTO TRANSPORTER
		7 - GRAIN/CHIPS/GRAVEL	10 - FLAT BED	14 - GARBAGE/REFUSE
			11 - DUMP	99 - OTHER / UNKNOWN

VEHICLE DEFECTS

1 - TURN SIGNALS	4 - BRAKES	7 - WORN OR SLICK TIRES	9 - MOTOR TROUBLE	99 - OTHER / UNKNOWN
2 - HEAD LAMPS	5 - STEERING	8 - TRAILER EQUIPMENT DEFECTIVE	10 - DISABLED FROM PRIOR ACCIDENT	
3 - TAIL LAMPS	6 - TIRE BLOWOUT			

NON-MOTORIST LOCATION AT IMPACT

1 - INTERSECTION - MARKED CROSSWALK	3 - INTERSECTION - OTHER	6 - BICYCLE LANE	9 - MEDIAN/CROSSING ISLAND	12 - FIRST RESPONDER AT INCIDENT SCENE
2 - INTERSECTION - UNMARKED CROSSWALK	4 - MIDDLEBLOCK - MARKED CROSSWALK	7 - SHOULDER / ROADSIDE	10 - DRIVEWAY ACCESS	99 - OTHER / UNKNOWN
	5 - TRAVEL LANE - OTHER LOCATION	8 - SIDEWALK	11 - SHARED USE PATHS OR TRAILS	

ACTION 3 PRE-CRASH ACTIONS 06

1 - NON-CONTACT	1 - STRAIGHT AHEAD	7 - MAKING U-TURN	13 - NEGOTIATING A CURVE	18 - APPROACHING OR LEAVING VEHICLE
2 - NON-COLLISION	2 - BACKING	8 - ENTERING TRAFFIC LANE	14 - ENTERING OR CROSSING SPECIFIED LOCATION	19 - STANDING
3 - STRIKING	3 - CHANGING LANES	9 - LEAVING TRAFFIC LANE	15 - WALKING, RUNNING, JOGGING, PLAYING	20 - OTHER NON-MOTORIST
4 - STRUCK	4 - OVERTAKING/PASSING	10 - PARKED	16 - WORKING	21 - STANDING OUTSIDE DISABLED VEHICLE
5 - BOTH STRIKING & STRUCK	5 - MAKING RIGHT TURN	11 - SLOWING OR STOPPED IN TRAFFIC	17 - PUSHING VEHICLE	99 - OTHER / UNKNOWN
9 - OTHER / UNKNOWN	6 - MAKING LEFT TURN	12 - DRIVERLESS		

CONTRIBUTING CIRCUMSTANCES 99

1 - NONE	7 - LEFT OF CENTER	13 - IMPROPER START FROM A PARKED POSITION	17 - VISION OBSTRUCTION	21 - LYING IN ROADWAY
2 - FAILURE TO YIELD	8 - FOLLOWING TOO CLOSE / ACDA	14 - STOPPED OR PARKED ILLEGALLY	18 - OPERATING DEFECTIVE EQUIPMENT	22 - NOT DISCERNIBLE
3 - RAN RED LIGHT	9 - IMPROPER LANE CHANGE	15 - SWERVING TO AVOID	19 - LOAD SHIFTING/FALLING/SPILLING	23 - OPENING DOOR INTO ROADWAY
4 - RAN STOP SIGN	10 - IMPROPER PASSING	16 - WRONG WAY	20 - IMPROPER CROSSING	99 - OTHER IMPROPER ACTION
5 - UNSAFE SPEED	11 - DROVE OFF ROAD			
6 - IMPROPER TURN	12 - IMPROPER BACKING			

SEQUENCE OF EVENTS

1 2 0

1 - OVERTURN/ROLLOVER	6 - EQUIPMENT FAILURE	11 - CROSS CENTERLINE - OPPOSITE DIRECTION OF TRAVEL	16 - RAILWAY VEHICLE	22 - WORK ZONE MAINTENANCE EQUIPMENT
2 - FIRE/EXPLOSION	7 - SEPARATION OF UNITS	12 - DOWNHILL RUNAWAY	17 - ANIMAL - FARM	23 - STRUCK BY FALLING, SHIFTING CARGO OR ANYTHING SET IN MOTION BY A MOTOR VEHICLE
3 - IMMERSION	8 - RAN OFF ROAD RIGHT	13 - OTHER NON-COLLISION	18 - ANIMAL - DEER	24 - OTHER MOVABLE OBJECT
4 - JACKKNIFE	9 - RAN OFF ROAD LEFT	14 - PEDESTRIAN	19 - ANIMAL - OTHER	
5 - CARGO / EQUIPMENT LOSS OR SHIFT	10 - CROSS MEDIAN	15 - PEDALCYCLE	20 - MOTOR VEHICLE IN TRANSPORT	
			21 - PARKED MOTOR VEHICLE	

COLLISION WITH FIXED OBJECT STRUCK

25 - IMPACT ATTENUATOR / CRASH CUSHION	31 - GUARDRAIL END	37 - TRAFFIC SIGN POST	43 - CURB	50 - WORK ZONE MAINTENANCE EQUIPMENT
26 - BRIDGE OVERHEAD STRUCTURE	32 - PORTABLE BARRIER	38 - OVERHEAD SIGN POST	44 - DITCH	51 - WALL
27 - BRIDGE PIER OR ABUTMENT	33 - MEDIAN CABLE BARRIER	39 - LIGHT / LUMINARIES SUPPORT	45 - EMBANKMENT	52 - BUILDING
28 - BRIDGE PARAPET	34 - MEDIAN GUARDRAIL BARRIER	40 - UTILITY POLE	46 - FENCE	53 - TUNNEL
29 - BRIDGE RAIL	35 - MEDIAN CONCRETE BARRIER	41 - OTHER POST, POLE OR SUPPORT	47 - MAILBOX	54 - OTHER FIXED OBJECT
30 - GUARDRAIL FACE	36 - MEDIAN OTHER BARRIER	42 - CULVERT	48 - TREE	99 - OTHER / UNKNOWN
			49 - FIRE HYDRANT	

FIRST HARMFUL EVENT 1 MOST HARMFUL EVENT 1

LOCAL REPORT NUMBER 2, 2, 0, 7, 9, 9, 1, 4

DAMAGE

DAMAGE SCALE 2

1 - NONE 3 - FUNCTIONAL DAMAGE
 2 - MINOR DAMAGE 4 - DISABLING DAMAGE
 9 - UNKNOWN

DAMAGED AREA(S) INDICATE ALL THAT APPLY

NO DAMAGE [0] UNDERCARRIAGE [14]
 TOP [13] ALL AREAS [15]
 UNIT NOT AT SCENE [16]

INITIAL POINT OF CONTACT 1, 1

0 - NO DAMAGE 14 - UNDERCARRIAGE
 1-12 - REFER TO UNIT DIAGRAM 15 - VEHICLE NOT AT SCENE
 13 - TOP 99 - UNKNOWN

TRAFFIC

TRAFFICWAY FLOW 2

1 - ONE-WAY 2 - TWO-WAY

TRAFFIC CONTROL 6

1 - ROUNDABOUT 4 - STOP SIGN
 2 - SIGNAL 5 - YIELD SIGN
 3 - FLASHER 6 - NO CONTROL

OF THROUGH LANES ON ROAD 2

RAIL GRADE CROSSING 1

1 - NOT INVOLVED
 2 - INVOLVED-ACTIVE CROSSING
 3 - INVOLVED-PASSIVE CROSSING

UNIT / NON-MOTORIST DIRECTION

FROM 1 TO 3

1 - NORTH 5 - NORTHEAST
 2 - SOUTH 6 - NORTHWEST
 3 - EAST 7 - SOUTHEAST
 4 - WEST 8 - SOUTHWEST
 9 - OTHER / UNKNOWN

UNIT SPEED 10

POSTED SPEED 25

DETECTED SPEED 1

1 - STATED / ESTIMATED SPEED
 2 - CALCULATED / EDR
 3 - UNDETERMINED



MOTORIST / Non-MOTORIST

LOCAL REPORT NUMBER
2 2 0 7 9 9 1 4

UNIT # 0 1	NAME: LAST, FIRST, MIDDLE Hamm Jr., Ronald S.	DATE OF BIRTH 0 3 1 0 1 9 6 2	AGE 6 0	GENDER M
ADDRESS: STREET, CITY, STATE, ZIP 3895 Mack Rd #112 Fairfield, OH 45014		CONTACT PHONE - INCLUDE AREA CODE 5 1 3 6 4 6 4 9 3 0		
INJURIES 5	INJURED TAKEN BY	EMS AGENCY (NAME)	INJURED TAKEN TO: MEDICAL FACILITY (NAME, CITY)	SAFETY EQUIPMENT USED 0 4
OL STATE OH	OPERATOR LICENSE NUMBER RQ623743	OFFENSE CHARGED	LOCAL CODE	OFFENSE DESCRIPTION
OL CLASS 4	ENDORSEMENT SELECT UP TO 2	RESTRICTION SELECT UP TO 3	DRIVER DISTRACTED BY 1	ALCOHOL / DRUG SUSPECTED <input type="checkbox"/> ALCOHOL <input type="checkbox"/> MARIJUANA <input type="checkbox"/> OTHER DRUG
CONDITION		ALCOHOL TEST STATUS TYPE VALUE		DRUG TEST(S) STATUS TYPE RESULT SELECT UP TO 4

UNIT # 0 2	NAME: LAST, FIRST, MIDDLE Biswa, Om Nath	DATE OF BIRTH 0 4 2 8 1 9 7 9	AGE 4 3	GENDER M
ADDRESS: STREET, CITY, STATE, ZIP 8494 Ethan Ct Fairfield, OH 45014		CONTACT PHONE - INCLUDE AREA CODE 6 0 8 7 7 0 5 2 5 1		
INJURIES 5	INJURED TAKEN BY	EMS AGENCY (NAME)	INJURED TAKEN TO: MEDICAL FACILITY (NAME, CITY)	SAFETY EQUIPMENT USED 0 4
OL STATE OH	OPERATOR LICENSE NUMBER VM752376	OFFENSE CHARGED	LOCAL CODE	OFFENSE DESCRIPTION
OL CLASS 4	ENDORSEMENT SELECT UP TO 2	RESTRICTION SELECT UP TO 3	DRIVER DISTRACTED BY 1	ALCOHOL / DRUG SUSPECTED <input type="checkbox"/> ALCOHOL <input type="checkbox"/> MARIJUANA <input type="checkbox"/> OTHER DRUG
CONDITION		ALCOHOL TEST STATUS TYPE VALUE		DRUG TEST(S) STATUS TYPE RESULT SELECT UP TO 4

UNIT #	NAME: LAST, FIRST, MIDDLE	DATE OF BIRTH	AGE	GENDER
ADDRESS: STREET, CITY, STATE, ZIP		CONTACT PHONE - INCLUDE AREA CODE		
INJURIES	INJURED TAKEN BY	EMS AGENCY (NAME)	INJURED TAKEN TO: MEDICAL FACILITY (NAME, CITY)	SAFETY EQUIPMENT USED
OL STATE	OPERATOR LICENSE NUMBER	OFFENSE CHARGED	LOCAL CODE	OFFENSE DESCRIPTION
OL CLASS	ENDORSEMENT SELECT UP TO 2	RESTRICTION SELECT UP TO 3	DRIVER DISTRACTED BY	ALCOHOL / DRUG SUSPECTED
CONDITION		ALCOHOL TEST STATUS TYPE VALUE		DRUG TEST(S) STATUS TYPE RESULT SELECT UP TO 4

INJURIES	SEATING POSITION	AIR BAG	OL CLASS	OL RESTRICTION(S)	DRIVER DISTRACTION	TEST STATUS
1-FATAL	1-FRONT - LEFT SIDE (MOTORCYCLE DRIVER)	1-NOT DEPLOYED	1-CLASS A	1-ALCOHOL INTERLOCK DEVICE	1-NOT DISTRACTED	1-NONE GIVEN
2-SUSPECTED SERIOUS INJURY	2-FRONT - MIDDLE	2-DEPLOYED FRONT	2-CLASS B	2-COL INTRASTATE ONLY	2-MANUALLY OPERATING AN ELECTRONIC COMMUNICATION DEVICE (TEXTING, TYPING, DIALING)	2-TEST REFUSED
3-SUSPECTED MINOR INJURY	3-FRONT - RIGHT SIDE	3-DEPLOYED SIDE	3-CLASS C	3-CORRECTIVE LENSES	3-TALKING ON HANDS-FREE COMMUNICATION DEVICE	3-TEST GIVEN, CONTAMINATED SAMPLE / UNUSABLE
4-POSSIBLE INJURY	4-SECOND - LEFT SIDE (MOTORCYCLE PASSENGER)	4-DEPLOYED BOTH FRONT / SIDE	4-REGULAR CLASS (OHIO = D)	4-FARM WAIVER	4-TALKING ON HAND-HELD COMMUNICATION DEVICE	4-TEST GIVEN, RESULTS KNOWN
5-NO APPARENT INJURY	5-SECOND - MIDDLE	5-NOT APPLICABLE	5-M/C MOPED ONLY	5-EXCEPT CLASS A BUS & CLASS B BUS	5-OTHER ACTIVITY WITH AN ELECTRONIC DEVICE	5-TEST GIVEN, RESULTS UNKNOWN
INJURED TAKEN BY	6-SECOND - RIGHT SIDE	9-DEPLOYMENT UNKNOWN	6-NO VALID OL	7-EXCEPT TRACTOR-TRAILER	7-OTHER DISTRACTION INSIDE THE VEHICLE	ALCOHOL TEST TYPE
1-NOT TRANSPORTED / TREATED AT SCENE	7-THIRD - LEFT SIDE (MOTORCYCLE SIDE CAR)	EJECTION	H-HAZMAT	8-INTERMEDIATE LICENSE RESTRICTIONS	8-OTHER DISTRACTION OUTSIDE THE VEHICLE	1-NONE
2-EMS	8-THIRD - MIDDLE	1-NOT EJECTED	M-MOTORCYCLE	9-LEARNER'S PERMIT RESTRICTIONS	9-OTHER / UNKNOWN	2-BLOOD
3-POLICE	9-THIRD - RIGHT SIDE	2-PARTIALLY EJECTED	P-PASSENGER	10-LIMITED TO DAYLIGHT ONLY	10-OTHER / UNKNOWN	3-URINE
9-OTHER / UNKNOWN	10-SLEEPER SECTION OF TRUCK CAB	3-TOTALLY EJECTED	N-TANKER	11-LIMITED TO EMPLOYMENT	11-OTHER / UNKNOWN	4-BREATH
SAFETY EQUIPMENT	11-PASSENGER IN OTHER ENCLOSED CARGO AREA (NON-TRAILING UNIT, BUS, PICK-UP WITH CAP)	4-NOT APPLICABLE	Q-MOTOR SCOOTER	12-LIMITED-OTHER	12-OTHER / UNKNOWN	5-OTHER
1-NONE USED	12-PASSENGER IN UNENCLOSED CARGO AREA	TRAPPED	R-THREE-WHEEL MOTORCYCLE	13-MECHANICAL DEVICES (SPECIAL BRAKES, HAND CONTROLS, OR OTHER ADAPTIVE DEVICES)	13-OTHER / UNKNOWN	DRUG TEST TYPE
2-SHOULDER BELT ONLY USED	13-TRAILING UNIT	1-NOT TRAPPED	S-SCHOOL BUS	14-MILITARY VEHICLES ONLY	14-OTHER / UNKNOWN	1-NONE
3-LAP BELT ONLY USED	14-RIDING ON VEHICLE EXTERIOR (NON-TRAILING UNIT)	2-EXTRICATED BY MECHANICAL MEANS	T-DOUBLE & TRIPLE TRAILERS	15-MOTOR VEHICLES WITHOUT AIR BRAKES	15-OTHER / UNKNOWN	2-BLOOD
4-SHOULDER & LAP BELT USED	15-NON-MOTORIST	3-FREED BY NON-MECHANICAL MEANS	X-TANKER / HAZMAT	16-OUTSIDE MIRROR	16-OTHER / UNKNOWN	3-URINE
5-CHILD RESTRAINT SYSTEM FORWARD FACING	99-OTHER / UNKNOWN			17-PROSTHETIC AID	17-OTHER / UNKNOWN	4-OTHER
6-CHILD RESTRAINT SYSTEM REAR FACING				18-OTHER	18-OTHER / UNKNOWN	DRUG TEST RESULT(S)
7-BOOSTER SEAT						1-AMPHETAMINES
8-HELMET USED						2-BARBITURATES
9-PROTECTIVE PADS USED (ELBOW, KNEES, ETC.)						3-BENZODIAZEPINES
10-REFLECTIVE CLOTHING						4-CANNABINOIDS
11-LIGHTING - PEDESTRIAN / BICYCLE ONLY						5-COCAINE
99-OTHER / UNKNOWN						6-OPIATES / OPIOIDS
						7-OTHER
						8-NEGATIVE RESULTS



OCCUPANT / WITNESS ADDENDUM

LOCAL REPORT NUMBER
2 2 0 7 9 9 1 4

OCCUPANT	UNIT # 2	NAME: LAST, FIRST, MIDDLE Biswa, Bishnu	DATE OF BIRTH 0 7 2 6 1 9 8 1	AGE 4 1	GENDER F					
	ADDRESS: STREET, CITY, STATE, ZIP 8494 Ethan Ct Fairfield, OH 45014			CONTACT PHONE - INCLUDE AREA CODE 6 0 8 7 7 0 5 2 5 1						
	INJURIES 5	INJURED TAKEN BY	EMS AGENCY (NAME)	INJURED TAKEN TO: MEDICAL FACILITY (NAME, CITY)	SAFETY EQUIPMENT USED 0 4	<input type="checkbox"/> DOT-COMPLIANT MC HELMET	SEATING POSITION 0 6	AIR BAG USAGE 0 1	EJECTION 1	TRAPPED 1

OCCUPANT	UNIT # 2	NAME: LAST, FIRST, MIDDLE Biswa, Bihan	DATE OF BIRTH 0 6 0 9 2 0 2 2	AGE 0	GENDER M					
	ADDRESS: STREET, CITY, STATE, ZIP 8494 Ethan Ct Fairfield, OH 45014			CONTACT PHONE - INCLUDE AREA CODE 6 0 8 7 7 0 5 2 5 1						
	INJURIES 5	INJURED TAKEN BY	EMS AGENCY (NAME)	INJURED TAKEN TO: MEDICAL FACILITY (NAME, CITY)	SAFETY EQUIPMENT USED 0 6	<input type="checkbox"/> DOT-COMPLIANT MC HELMET	SEATING POSITION 0 5	AIR BAG USAGE 0 5	EJECTION 1	TRAPPED 1

OCCUPANT	UNIT #	NAME: LAST, FIRST, MIDDLE	DATE OF BIRTH	AGE 0	GENDER					
	ADDRESS: STREET, CITY, STATE, ZIP			CONTACT PHONE - INCLUDE AREA CODE						
	INJURIES	INJURED TAKEN BY	EMS AGENCY (NAME)	INJURED TAKEN TO: MEDICAL FACILITY (NAME, CITY)	SAFETY EQUIPMENT USED	<input type="checkbox"/> DOT-COMPLIANT MC HELMET	SEATING POSITION	AIR BAG USAGE	EJECTION	TRAPPED

OCCUPANT	UNIT #	NAME: LAST, FIRST, MIDDLE	DATE OF BIRTH	AGE 0	GENDER					
	ADDRESS: STREET, CITY, STATE, ZIP			CONTACT PHONE - INCLUDE AREA CODE						
	INJURIES	INJURED TAKEN BY	EMS AGENCY (NAME)	INJURED TAKEN TO: MEDICAL FACILITY (NAME, CITY)	SAFETY EQUIPMENT USED	<input type="checkbox"/> DOT-COMPLIANT MC HELMET	SEATING POSITION	AIR BAG USAGE	EJECTION	TRAPPED

INJURIES	SAFETY EQUIPMENT USED	SEATING POSITION	AIR BAG USAGE
1- FATAL	1- NONE USED - VEHICLE OCCUPANT	1- FRONT - LEFT SIDE (MOTORCYCLE DRIVER)	1- NOT DEPLOYED
2- SUSPECTED SERIOUS INJURY	2- SHOULDER BELT ONLY USED	2- FRONT - MIDDLE	2- DEPLOYED FRONT
3- SUSPECTED MINOR INJURY	3- LAP BELT ONLY USED	3- FRONT - RIGHT SIDE	3- DEPLOYED SIDE
4- POSSIBLE INJURY	4- SHOULDER & LAP BELT USED	4- SECOND - LEFT SIDE (MOTORCYCLE PASSENGER)	4- DEPLOYED BOTH FRONT/SIDE
5- NO APPARENT INJURY	5- CHILD RESTRAINT SYSTEM - FORWARD FACING	5- SECOND - MIDDLE	5- NOT APPLICABLE
	6- CHILD RESTRAINT SYSTEM - REAR FACING	6- SECOND - RIGHT SIDE	9- DEPLOYMENT UNKNOWN
	7- BOOSTER SEAT	7- THIRD - LEFT SIDE (MOTORCYCLE SIDE CAR)	
	8- HELMET USED	8- THIRD - MIDDLE	
	9- PROTECTIVE PADS USED (ELBOW, KNEES, ETC.)	9- THIRD - RIGHT SIDE	
	10- REFLECTIVE CLOTHING	10- SLEEPER SECTION OF TRUCK CAB	
	11- LIGHTING - PEDESTRIAN / BICYCLE ONLY	11- PASSENGER IN OTHER ENCLOSED CARGO AREA (NON-TRAILING UNIT, BUS, PICK-UP WITH CAP)	
	99- OTHER / UNKNOWN	12- PASSENGER IN UNENCLOSED CARGO AREA	
		13- TRAILING UNIT	
		14- RIDING ON VEHICLE EXTERIOR (NON-TRAILING UNIT)	
		15- NON-MOTORIST	
		99- OTHER / UNKNOWN	

WITNESS	NAME: LAST, FIRST, MIDDLE	DATE OF BIRTH	AGE 0	GENDER
	ADDRESS: STREET, CITY, STATE, ZIP	CONTACT PHONE - INCLUDE AREA CODE		

WITNESS	NAME: LAST, FIRST, MIDDLE	DATE OF BIRTH	AGE 0	GENDER
	ADDRESS: STREET, CITY, STATE, ZIP	CONTACT PHONE - INCLUDE AREA CODE		

WITNESS	NAME: LAST, FIRST, MIDDLE	DATE OF BIRTH	AGE 0	GENDER
	ADDRESS: STREET, CITY, STATE, ZIP	CONTACT PHONE - INCLUDE AREA CODE		

LOCAL REPORT NUMBER 22-079914	REPORTING AGENCY Fairfield Police Department	DATE OF ACCIDENT 11-04-22
IN COUNTY OF Butler	ACCIDENT LOCATION Michael Ln/8781	

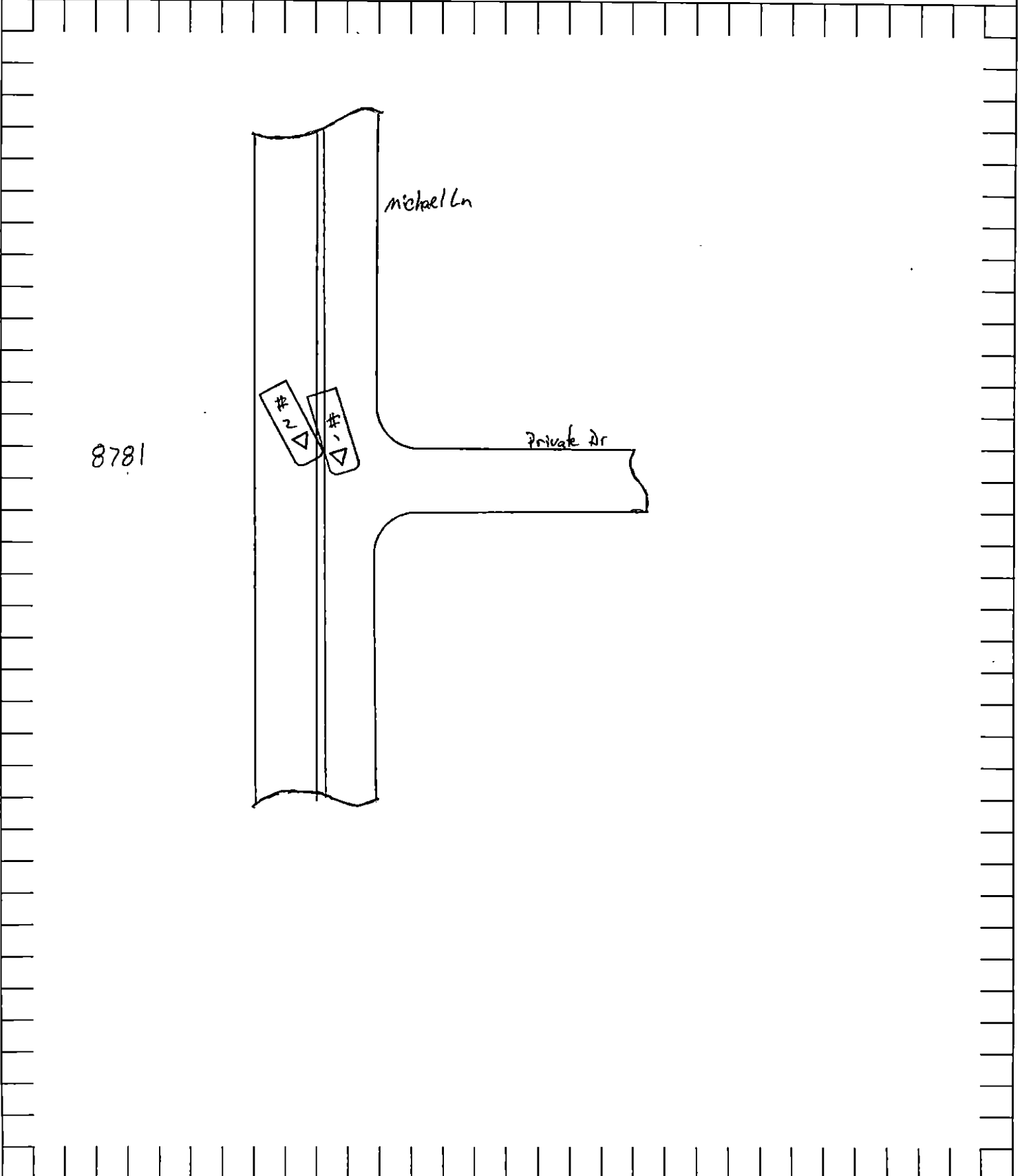

	OFFICER'S SIGNATURE D. Setterstrom	BADGE NO. 121
--	---------------------------------------	------------------