



TRAFFIC CRASH REPORT

*DENOTES MANDATORY FIELD FOR SUPPLEMENT REPORT

LOCAL REPORT NUMBER*

<input checked="" type="checkbox"/> PHOTOS TAKEN	<input checked="" type="checkbox"/> OH-2	<input type="checkbox"/> OH-3	LOCAL INFORMATION	2, 2, 0, 8, 2, 3, 7, 1
<input type="checkbox"/> SECONDARY CRASH	<input type="checkbox"/> OH-1P	<input type="checkbox"/> OTHER	REPORTING AGENCY NAME*	HIT/SKIP
<input type="checkbox"/> PRIVATE PROPERTY			Fairfield Police Department	1 - SOLVED
				2 - UNSOLVED
			0, 0, 9, 0, 1	NUMBER OF UNITS
				0, 2
				UNIT IN ERROR
				98 - ANIMAL
				99 - UNKNOWN

COUNTY*	LOCALITY*	LOCATION: CITY, VILLAGE, TOWNSHIP*	CRASH DATE / TIME*	CRASH SEVERITY
0, 9	1	City of Fairfield	11102022, 1849	3

ROUTE TYPE	ROUTE NUMBER	PREFIX	1 - NORTH 2 - SOUTH 3 - EAST 4 - WEST	LOCATION ROAD NAME	ROAD TYPE	LATITUDE DECIMAL DEGREES	CRASH SEVERITY 1 - FATAL 2 - SERIOUS INJURY SUSPECTED 3 - MINOR INJURY SUSPECTED 4 - INJURY POSSIBLE 5 - PROPERTY DAMAGE ONLY
				Symmes	R, D	39, 349, 28, 7	
ROUTE TYPE	ROUTE NUMBER	PREFIX	1 - NORTH 2 - SOUTH 3 - EAST 4 - WEST	REFERENCE ROAD NAME (ROAD, MILEPOST, HOUSE #)	ROAD TYPE	LONGITUDE DECIMAL DEGREES	
				Industry	D, R	84, 531, 00, 5	

REFERENCE POINT	DIRECTION FROM REFERENCE	ROUTE TYPE	ROAD TYPE	INTERSECTION RELATED
1 - INTERSECTION	1 - NORTH	IR - INTERSTATE ROUTE (TP)	AL - ALLEY	<input checked="" type="checkbox"/> WITHIN INTERSECTION OR ON APPROACH
2 - MILE POST	2 - SOUTH	US - FEDERAL US ROUTE	AV - AVENUE	<input type="checkbox"/> WITHIN INTERCHANGE AREA
3 - HOUSE #	3 - EAST	SR - STATE ROUTE	BL - BOULEVARD	NUMBER OF APPROACHES
	4 - WEST	CR - NUMBERED COUNTY ROUTE	MP - MILEPOST	3
DISTANCE FROM REFERENCE	DISTANCE UNIT OF MEASURE	TR - NUMBERED TOWNSHIP ROUTE	ST - STREET	
	1 - MILES		OV - OVAL	
	2 - FEET		TE - TERRACE	
	3 - YARDS		CT - COURT	
			PK - PARKWAY	
			TL - TRAIL	
			DR - DRIVE	
			PI - PIKE	
			WA - WAY	
			HE - HEIGHTS	
			PL - PLACE	

LOCATION OF FIRST HARMFUL EVENT	MANNER OF CRASH COLLISION/IMPACT	DIRECTION OF TRAVEL	MEDIAN TYPE
0, 1	6	1 - NORTH 2 - SOUTH 3 - EAST 4 - WEST	1 - DIVIDED FLUSH MEDIAN (<4 FEET) 2 - DIVIDED FLUSH MEDIAN (>4 FEET) 3 - DIVIDED, DEPRESSED MEDIAN 4 - DIVIDED, RAISED MEDIAN (ANY TYPE) 9 - OTHER/UNKNOWN

<input type="checkbox"/> WORK ZONE RELATED	WORK ZONE TYPE	LOCATION OF CRASH IN WORK ZONE	CONTOUR	CONDITIONS	SURFACE
<input type="checkbox"/> WORKERS PRESENT	1 - LANE CLOSURE	1 - BEFORE THE 1ST WORK ZONE WARNING SIGN	1	1 - DRY	1 - CONCRETE
<input type="checkbox"/> LAW ENFORCEMENT PRESENT	2 - LANE SHIFT/CROSSOVER	2 - ADVANCE WARNING AREA		2 - WET	2 - BLACKTOP, BITUMINOUS, ASPHALT
<input type="checkbox"/> ACTIVE SCHOOL ZONE	3 - WORK ON SHOULDER OR MEDIAN	3 - TRANSITION AREA		3 - SNOW	3 - BRICK/BLOCK
	4 - INTERMITTENT OR MOVING WORK	4 - ACTIVITY AREA		4 - ICE	4 - SLAG, GRAVEL, STONE
	5 - OTHER	5 - TERMINATION AREA		5 - SAND, MUD, DIRT, OIL, GRAVEL	5 - DIRT
				6 - WATER (STANDING, MOVING)	9 - OTHER/UNKNOWN
				7 - SLUSH	
				9 - OTHER/UNKNOWN	

LIGHT CONDITION	WEATHER
4	0, 1

NARRATIVE

On 11/10/22 at 6:49 P.M. Unit 2 was traveling Southeast on Symmes Rd. near Industry Dr. Unit 1 was traveling Northwest on Symmes Rd. near Industry Dr. to turn Southwest on Industry Dr. Unit 1 failed to yield to the right of way of Unit 2. Unit 2 struck Unit 1 on the front.

See OH-2



Indicate the north direction with an "N" on the compass diagram.

CRASH REPORTED DATE / TIME	DISPATCH DATE / TIME	ARRIVAL DATE / TIME	SCENE CLEARED DATE / TIME	REPORT TAKEN BY
11102022, 1849	11102022, 1849	11102022, 1856	11102022, 1925	<input checked="" type="checkbox"/> POLICE AGENCY
TOTAL TIME ROADWAY CLOSED	OTHER INVESTIGATION TIME	TOTAL MINUTES	OFFICER'S NAME*	<input type="checkbox"/> MOTORIST
0	30	66	D. Miller	<input type="checkbox"/> SUPPLEMENT (CORRECTION OR ADDITION TO AN EXISTING REPORT SENT TO GPS)
			OFFICER'S BADGE NUMBER*	
			167	
			CHECKED BY OFFICER'S NAME*	
			Sgt. Aaron Meyer	
			CHECKED BY OFFICER'S BADGE NUMBER*	
			132	

LOCAL REPORT NUMBER
 2 2 0 8 2 3 7 1

OWNER

UNIT # 01 OWNER NAME: LAST, FIRST, MIDDLE (SAME AS DRIVER) Schwab, Christopher
 OWNER ADDRESS: STREET, CITY, STATE, ZIP (SAME AS DRIVER)
 10187 Cherokee Ln., Aurora, IN 47001
 COMMERCIAL CARRIER: NAME, ADDRESS, CITY, STATE, ZIP
 COMMERCIAL CARRIER PHONE: INCLUDE AREA CODE

DAMAGE

DAMAGE SCALE
 1 - NONE 3 - FUNCTIONAL DAMAGE
 2 - MINOR DAMAGE 4 - DISABLING DAMAGE
 9 - UNKNOWN
4

VEHICLE

LP STATE IN LICENSE PLATE # SCHWAB2 VEHICLE IDENTIFICATION # 1C6RR1K1KN614210 VEHICLE YEAR 2019 VEHICLE MAKE Ram
 INSURANCE VERIFIED INSURANCE COMPANY Shelter INSURANCE POLICY # 341104169575 COLOR White VEHICLE MODEL 1500

DAMAGED AREA(S)
 INDICATE ALL THAT APPLY

TYPE OF USE
 COMMERCIAL GOVERNMENT IN EMERGENCY RESPONSE
 INTERLOCK DEVICE EQUIPPED HIT/SKIP UNIT # OCCUPANTS 01 VEHICLE WEIGHT GVWR/GCWR
 1 - <10K LBS.
 2 - 10,001 - 26K LBS.
 3 - >26K LBS.
 TOWED BY: COMPANY NAME Wayne's
 MATERIAL RELEASED PLACARD HAZARDOUS MATERIAL CLASS # PLACARD ID #

UNIT TYPE 04
 1 - PASSENGER CAR 7 - MOTORCYCLE 2-WHEELED 12 - GOLF CART 18 - LIMO (LIVERY VEHICLE) 23 - PEDESTRIAN / SKATER
 2 - PASSENGER VAN (MINIVAN) 8 - MOTORCYCLE 3-WHEELED 13 - SNOWMOBILE 19 - BUS (16+ PASSENGERS) 24 - WHEELCHAIR (ANY TYPE)
 3 - SPORT UTILITY VEHICLE 9 - AUTOCYCLE 14 - SINGLE UNIT TRUCK 20 - OTHER VEHICLE 25 - OTHER NON-MOTORIST
 4 - PICK UP 10 - MOPED OR MOTORIZED BICYCLE 15 - SEMI-TRACTOR 21 - HEAVY EQUIPMENT 26 - BICYCLE
 5 - CARGOVAN 11 - ALL TERRAIN VEHICLE (ATV/UTV) 16 - FARM EQUIPMENT 22 - ANIMAL WITH RIDER OR ANIMAL-DRAWN VEHICLE 27 - TRAIN
 6 - VAN (9-15 SEATS) 17 - MOTORHOME 99 - UNKNOWN OR HIT/SKIP

OF TRAILING UNITS 0
 WAS VEHICLE OPERATING IN AUTONOMOUS MODE WHEN CRASH OCCURRED?
 1 - YES 2 - NO 9 - OTHER / UNKNOWN
 AUTONOMOUS MODE LEVEL
 0 - NO AUTOMATION 1 - DRIVER ASSISTANCE 2 - PARTIAL AUTOMATION 3 - CONDITIONAL AUTOMATION 4 - HIGH AUTOMATION 5 - FULL AUTOMATION 9 - UNKNOWN

SPECIAL FUNCTION 01
 1 - NONE 6 - BUS - CHARTER/TOUR 11 - FIRE 16 - FARM 21 - MAIL CARRIER
 2 - TAXI 7 - BUS - INTERCITY 12 - MILITARY 17 - MOWING 99 - OTHER / UNKNOWN
 3 - ELECTRONIC RIDE SHARING 8 - BUS - SHUTTLE 13 - POLICE 18 - SNOW REMOVAL
 4 - SCHOOL TRANSPORT 9 - BUS - OTHER 14 - PUBLIC UTILITY 19 - TOWING
 5 - BUS - TRANSIT/COMMUTER 10 - AMBULANCE 15 - CONSTRUCTION EQUIPMENT 20 - SAFETY SERVICE PATROL

CARGO BODY TYPE 01
 1 - NO CARGO BODY TYPE / NOT APPLICABLE 3 - VEHICLE TOWING ANOTHER MOTOR VEHICLE 5 - INTERMODAL CONTAINER CHASSIS 8 - POLE 12 - CONCRETE MIXER
 2 - BUS 4 - LOGGING 6 - CARGO VAN/ENCLOSED BOX 10 - FLAT BED 14 - GARBAGE/REFUSE
 7 - GRAIN/CHIPS/GRAVEL 11 - DUMP 99 - OTHER / UNKNOWN

VEHICLE DEFECTS
 1 - TURN SIGNALS 4 - BRAKES 7 - WORN OR SLICK TIRES 9 - MOTOR TROUBLE 99 - OTHER / UNKNOWN
 2 - HEAD LAMPS 5 - STEERING 8 - TRAILER EQUIPMENT DEFECTIVE 10 - DISABLED FROM PRIOR ACCIDENT
 3 - TAIL LAMPS 6 - TIRE BLOWOUT

NON-MOTORIST LOCATION AT IMPACT
 1 - INTERSECTION - MARKED CROSSWALK 3 - INTERSECTION - OTHER 6 - BICYCLE LANE 9 - MEDIAN/CROSSING ISLAND 12 - FIRST RESPONDER AT INCIDENT SCENE
 2 - INTERSECTION - UNMARKED CROSSWALK 4 - MIDBLOCK - MARKED CROSSWALK 7 - SHOULDER / ROADSIDE 10 - DRIVEWAY ACCESS 14 - GARBAGE/REFUSE
 5 - TRAVEL LANE - OTHER LOCATION 8 - SIDEWALK 11 - SHARED USE PATHS OR TRAILS 99 - OTHER / UNKNOWN

ACTION 4
 1 - NON-CONTACT 1 - STRAIGHT AHEAD 7 - MAKING U-TURN 13 - NEGOTIATING A CURVE 18 - APPROACHING OR LEAVING VEHICLE
 2 - NON-COLLISION 2 - BACKING 8 - ENTERING TRAFFIC LANE 14 - ENTERING OR CROSSING SPECIFIED LOCATION 19 - STANDING
 3 - STRIKING 06 3 - CHANGING LANES 9 - LEAVING TRAFFIC LANE 15 - WALKING, RUNNING, JOGGING, PLAYING 20 - OTHER NON-MOTORIST
 4 - STRUCK PRE-CRASH ACTIONS 4 - OVERTAKING/PASSING 10 - PARKED 16 - WORKING 21 - STANDING OUTSIDE DISABLED VEHICLE
 5 - BOTH STRIKING & STRUCK 5 - MAKING RIGHT TURN 11 - SLOWING OR STOPPED IN TRAFFIC 17 - PUSHING VEHICLE 99 - OTHER / UNKNOWN
 9 - OTHER / UNKNOWN 6 - MAKING LEFT TURN 12 - DRIVERLESS

- NO DAMAGE [0] - UNDERCARRIAGE [14]
 - TOP [13] - ALL AREAS [15]
 - UNIT NOT AT SCENE [16]

INITIAL POINT OF CONTACT
 0 - NO DAMAGE 14 - UNDERCARRIAGE
 1-12 - REFER TO UNIT DIAGRAM 15 - VEHICLE NOT AT SCENE
 13 - TOP 99 - UNKNOWN

CONTRIBUTING CIRCUMSTANCES 02
 1 - NONE 7 - LEFT OF CENTER 13 - IMPROPER START FROM A PARKED POSITION 17 - VISION OBSTRUCTION 21 - LYING IN ROADWAY
 2 - FAILURE TO YIELD 8 - FOLLOWING TOO CLOSE / ACCA 14 - STOPPED OR PARKED ILLEGALLY 18 - OPERATING DEFECTIVE EQUIPMENT 22 - NOT DISCERNIBLE
 3 - RAN RED LIGHT 9 - IMPROPER LANE CHANGE 15 - SWERVING TO AVOID 19 - LOAD SHIFTING/FALLING/SPILLING 23 - OPENING DOOR INTO ROADWAY
 4 - RAN STOP SIGN 10 - IMPROPER PASSING 16 - WRONGWAY 20 - IMPROPER CROSSING 99 - OTHER IMPROPER ACTION
 5 - UNSAFE SPEED 11 - DROVE OFF ROAD 17 - VISION OBSTRUCTION 21 - LYING IN ROADWAY
 6 - IMPROPER TURN 12 - IMPROPER BACKING

TRAFFIC

TRAFFICWAY FLOW
 1 - ONE-WAY
 2 - TWO-WAY
2

TRAFFIC CONTROL
 1 - ROUNDABOUT 4 - STOP SIGN
 2 - SIGNAL 5 - YIELD SIGN
 3 - FLASHER 6 - NO CONTROL
6

SEQUENCE OF EVENTS
 1 20
 1 - OVERTURN/ROLLOVER 6 - EQUIPMENT FAILURE 11 - CROSS CENTERLINE - OPPOSITE DIRECTION OF TRAVEL 16 - RAILWAY VEHICLE 22 - WORK ZONE MAINTENANCE EQUIPMENT
 2 - FIRE/EXPLOSION 7 - SEPARATION OF UNITS 12 - DOWNHILL RUNAWAY 17 - ANIMAL - FARM 23 - STRUCK BY FALLING, SHIFTING CARGO OR ANYTHING SET IN MOTION BY A MOTOR VEHICLE
 3 - IMMERSION 8 - RAN OFF ROAD RIGHT 13 - OTHER NON-COLLISION 18 - ANIMAL - DEER 24 - OTHER MOVABLE OBJECT
 4 - JACKKNIFE 9 - RAN OFF ROAD LEFT 14 - PEDESTRIAN 19 - ANIMAL - OTHER 20 - MOTOR VEHICLE IN TRANSPORT
 5 - CARGO/EQUIPMENT LOSS OR SHIFT 10 - CROSS MEDIAN 15 - PEDALCYCLE 21 - PARKED MOTOR VEHICLE

OF THROUGH LANES ON ROAD 2
 RAIL GRADE CROSSING
 1 - NOT INVOLVED
 2 - INVOLVED-ACTIVE CROSSING
 3 - INVOLVED-PASSIVE CROSSING
1

UNIT / NON-MOTORIST DIRECTION
 FROM 7 TO 8
 1 - NORTH 5 - NORTHEAST
 2 - SOUTH 6 - NORTHWEST
 3 - EAST 7 - SOUTHEAST
 4 - WEST 8 - SOUTHWEST
 9 - OTHER / UNKNOWN

COLLISION WITH FIXED OBJECT
 25 - IMPACT ATTENUATOR / CRASH CUSHION 31 - GUARDRAIL END 37 - TRAFFIC SIGN POST 43 - CURB 50 - WORK ZONE MAINTENANCE EQUIPMENT
 26 - BRIDGE OVERHEAD STRUCTURE 32 - PORTABLE BARRIER 38 - OVERHEAD SIGN POST 44 - DITCH 51 - WALL
 27 - BRIDGE PIER OR ABUTMENT 33 - MEDIAN CABLE BARRIER 39 - LIGHT / LUMINARIES SUPPORT 45 - EMBANKMENT 52 - BUILDING
 28 - BRIDGE PARAPET 34 - MEDIAN GUARDRAIL BARRIER 40 - UTILITY POLE 46 - FENCE 53 - TUNNEL
 29 - BRIDGE RAIL 35 - MEDIAN CONCRETE BARRIER 41 - OTHER POST, POLE OR SUPPORT 47 - MAILBOX 54 - OTHER FIXED OBJECT
 30 - GUARDRAIL FACE 36 - MEDIAN OTHER BARRIER 42 - CULVERT 48 - TREE 99 - OTHER / UNKNOWN
 49 - FIRE HYDRANT

UNIT SPEED 20
 POSTED SPEED 35
 DETECTED SPEED
 1 - STATED / ESTIMATED SPEED
 2 - CALCULATED / EDR
 3 - UNDETERMINED
1

LOCAL REPORT NUMBER
2, 2, 0, 8, 2, 3, 7, 1

OWNER

UNIT # 012 OWNER NAME: LAST, FIRST, MIDDLE (☐ SAME AS DRIVER)
Coffey, Johnathan

OWNER ADDRESS: STREET, CITY, STATE, ZIP (☐ SAME AS DRIVER)

COMMERCIAL CARRIER: NAME, ADDRESS, CITY, STATE, ZIP

COMMERCIAL CARRIER PHONE: INCLUDE AREA CODE

DAMAGE

DAMAGE SCALE

4 1 - NONE 3 - FUNCTIONAL DAMAGE
2 - MINOR DAMAGE 4 - DISABLING DAMAGE
9 - UNKNOWN

LP STATE OH LICENSE PLATE # JSD9611 VEHICLE IDENTIFICATION # 4T1SK13E17NU01742136 VEHICLE YEAR 1992 VEHICLE MAKE Toyota

INSURANCE VERIFIED INSURANCE COMPANY Statefarm INSURANCE POLICY # 1583907752 COLOR Gray VEHICLE MODEL Camry

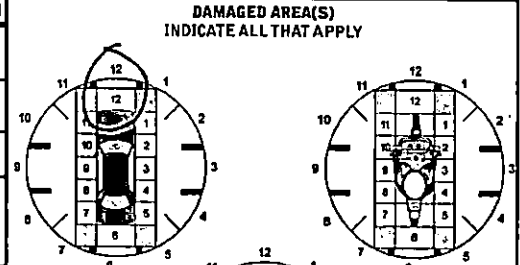

TYPE OF USE: COMMERCIAL GOVERNMENT IN EMERGENCY RESPONSE

US DOT # _____ TOWED BY: COMPANY NAME Fox

HAZARDOUS MATERIAL: MATERIAL RELEASED PLACARD

UNIT TYPE: 01

1 - PASSENGER CAR 7 - MOTORCYCLE 2-WHEELED 12 - GOLF CART 18 - LIMO (LIVERY VEHICLE) 23 - PEDESTRIAN / SKATER
2 - PASSENGER VAN (MINIVAN) 8 - MOTORCYCLE 3-WHEELED 13 - SNOWMOBILE 19 - BUS (16+ PASSENGERS) 24 - WHEELCHAIR (ANY TYPE)
3 - SPORT UTILITY VEHICLE 9 - AUTOCYCLE 14 - SINGLE UNIT TRUCK 20 - OTHER VEHICLE 25 - OTHER NON-MOTORIST
4 - PICKUP 10 - MOPED OR MOTORIZED BICYCLE 15 - SEMI-TRACTOR 21 - HEAVY EQUIPMENT 26 - BICYCLE
5 - CARGO VAN 11 - ALL TERRAIN VEHICLE (ATV / UTV) 16 - FARM EQUIPMENT 22 - ANIMAL WITH RIDER OR ANIMAL-DRAWN VEHICLE 99 - UNKNOWN OR HIT/SKIP
6 - VAN (9-15 SEATS) 17 - MOTORHOME

OF TRAILING UNITS 0

WAS VEHICLE OPERATING IN AUTONOMOUS MODE WHEN CRASH OCCURRED? 2

1 - YES 2 - NO 9 - OTHER / UNKNOWN

AUTONOMOUS MODE LEVEL 0

0 - NO AUTOMATION 3 - CONDITIONAL AUTOMATION 9 - UNKNOWN
1 - DRIVER ASSISTANCE 4 - HIGH AUTOMATION
2 - PARTIAL AUTOMATION 5 - FULL AUTOMATION

SPECIAL FUNCTION: 01

1 - NONE 6 - BUS - CHARTER/TOUR 11 - FIRE 16 - FARM 21 - MAIL CARRIER
2 - TAXI 7 - BUS - INTERCITY 12 - MILITARY 17 - MOWING 99 - OTHER / UNKNOWN
3 - ELECTRONIC RIDE SHARING 8 - BUS - SHUTTLE 13 - POLICE 18 - SNOW REMOVAL
4 - SCHOOL TRANSPORT 9 - BUS - OTHER 14 - PUBLIC UTILITY 19 - TOWING
5 - BUS - TRANSPORT/MUTER 10 - AMBULANCE 15 - CONSTRUCTION EQUIPMENT 20 - SAFETY SERVICE PATROL

CARGO BODY TYPE: 01

1 - NO CARGO BODY TYPE / NOT APPLICABLE 3 - VEHICLE TOWING ANOTHER MOTOR VEHICLE 5 - INTERMODAL CONTAINER CHASSIS 8 - POLE 12 - CONCRETE MIXER
2 - BUS 4 - LOGGING 6 - CARGO VAN/ENCLOSED BOX 10 - FLAT BED 13 - AUTO TRANSPORTER
7 - GRAIN/CHIPS/GRAVEL 11 - DUMP 14 - GARBAGE/REFUSE 99 - OTHER / UNKNOWN

VEHICLE DEFECTS: _____

1 - TURN SIGNALS 4 - BRAKES 7 - WORN OR SLICK TIRES 9 - MOTOR TROUBLE 99 - OTHER / UNKNOWN
2 - HEAD LAMPS 5 - STEERING 8 - TRAILER EQUIPMENT DEFECTIVE 10 - DISABLED FROM PRIOR ACCIDENT
3 - TAIL LAMPS 6 - TIRE BLOWOUT

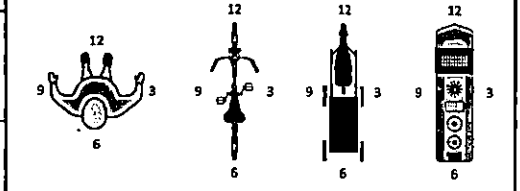
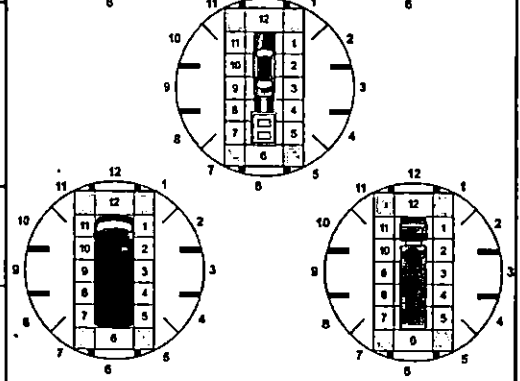

- NO DAMAGE [0] - UNDERCARRIAGE [14]
 - TOP [13] - ALL AREAS [15]
 - UNIT NOT AT SCENE [16]

NON-MOTORIST LOCATION AT IMPACT: _____

1 - INTERSECTION - MARKED CROSSWALK 3 - INTERSECTION - OTHER 6 - BICYCLE LANE 9 - MEDIAN/CROSSING ISLAND 12 - FIRST RESPONDER AT INCIDENT SCENE
2 - INTERSECTION - UNMARKED CROSSWALK 4 - SHOULDER - MARKED CROSSWALK 7 - SHOULDER / ROADSIDE 10 - DRIVEWAY ACCESS 99 - OTHER / UNKNOWN
5 - TRAVEL LANE - OTHER LOCATION 8 - SIDEWALK 11 - SHARED USE PATHS OR TRAILS

ACTION: 3

1 - NON-CONTACT 1 - STRAIGHT AHEAD 7 - MAKING U-TURN 13 - NEGOTIATING A CURVE 18 - APPROACHING OR LEAVING VEHICLE
2 - NON-COLLISION 2 - BACKING 8 - ENTERING TRAFFIC LANE 14 - ENTERING OR CROSSING SPECIFIED LOCATION 19 - STANDING
3 - STRIKING 01 3 - CHANGING LANES 9 - LEAVING TRAFFIC LANE 15 - WALKING, RUNNING, JOGGING, PLAYING 20 - OTHER NON-MOTORIST
4 - STRUCK PRE-CRASH ACTIONS 4 - OVERTAKING/PASSING 10 - PARKED 16 - WORKING 21 - STANDING OUTSIDE DISABLED VEHICLE
5 - BOTH STRIKING & STRUCK 5 - MAKING RIGHT TURN 11 - SLOWING OR STOPPED IN TRAFFIC 17 - PUSHING VEHICLE 99 - OTHER / UNKNOWN
9 - OTHER / UNKNOWN 6 - MAKING LEFT TURN 12 - DRIVELESS

INITIAL POINT OF CONTACT

0 - NO DAMAGE 14 - UNDERCARRIAGE
1-12 - REFER TO UNIT DIAGRAM 15 - VEHICLE NOT AT SCENE
13 - TOP 99 - UNKNOWN

CONTRIBUTING CIRCUMSTANCES: 01

1 - NONE 7 - LEFT OF CENTER 13 - IMPROPER START FROM A PARKED POSITION 17 - VISION OBSTRUCTION 21 - LYING IN ROADWAY
2 - FAILURE TO YIELD 8 - FOLLOWING TOO CLOSE / ACDA 14 - STOPPED OR PARKED ILLEGALLY 18 - OPERATING DEFECTIVE EQUIPMENT 22 - NOT DISCERNIBLE
3 - RAN RED LIGHT 9 - IMPROPER LANE CHANGE 15 - SWERVING TO AVOID 19 - LOAD SHIFTING/FALLING/SPILLING 23 - OPENING DOOR INTO ROADWAY
4 - RAN STOP SIGN 10 - IMPROPER PASSING 16 - WRONG WAY 20 - IMPROPER CROSSING 99 - OTHER IMPROPER ACTION
5 - UNSAFE SPEED 11 - DROVE OFF ROAD 17 - VISION OBSTRUCTION 21 - LYING IN ROADWAY
6 - IMPROPER TURN 12 - IMPROPER BACKING

TRAFFIC

TRAFFICWAY FLOW: 2

1 - ONE-WAY 2 - TWO-WAY

TRAFFIC CONTROL: 6

1 - ROUNDABOUT 4 - STOP SIGN
2 - SIGNAL 5 - YIELD SIGN
3 - FLASHER 6 - NO CONTROL

SEQUENCE OF EVENTS

1 2 0

1 - OVERTURN/ROLLOVER 6 - EQUIPMENT FAILURE 11 - CROSS CENTERLINE - OPPOSITE DIRECTION OF TRAVEL 16 - RAILWAY VEHICLE 22 - WORK ZONE MAINTENANCE EQUIPMENT
2 - FIRE/EXPLOSION 7 - SEPARATION OF UNITS 12 - DOWNHILL RUNAWAY 17 - ANIMAL - FARM 23 - STRUCK BY FALLING, SHIFTING CARGO OR ANYTHING SET IN MOTION BY A MOTOR VEHICLE
3 - IMMERSION 8 - RAN OFF ROAD RIGHT 13 - OTHER NON-COLLISION 18 - ANIMAL - DEER 24 - OTHER MOVABLE OBJECT
4 - JACKKNIFE 9 - RAN OFF ROAD LEFT 14 - PEDESTRIAN 19 - ANIMAL - OTHER 20 - MOTOR VEHICLE IN TRANSPORT
5 - CARGO / EQUIPMENT LOSS OR SHIFT 10 - CROSS MEDIAN 15 - PEDALCYCLE 21 - PARKED MOTOR VEHICLE

OF THROUGH LANES ON ROAD: 2

RAIL GRADE CROSSING: 1

1 - NOT INVOLVED
2 - INVOLVED-ACTIVE CROSSING
3 - INVOLVED-PASSIVE CROSSING

COLLISION WITH FIXED OBJECT STRUCK BY

25 - IMPACT ATTENUATOR / CRASH CUSHION 31 - GUARDRAIL END 37 - TRAFFIC SIGN POST 43 - CURB 50 - WORK ZONE MAINTENANCE EQUIPMENT
26 - BRIDGE OVERHEAD STRUCTURE 32 - PORTABLE BARRIER 38 - OVERHEAD SIGN POST 44 - DITCH 51 - WALL
27 - BRIDGE PIER OR ABUTMENT 33 - MEDIAN CABLE BARRIER 39 - LIGHT / LUMINARIES SUPPORT 45 - EMBANKMENT 52 - BUILDING
28 - BRIDGE PARAPET 34 - MEDIAN GUARDRAIL BARRIER 40 - UTILITY POLE 46 - FENCE 53 - TUNNEL
29 - BRIDGE RAIL 35 - MEDIAN CONCRETE BARRIER 41 - OTHER POST, POLE OR SUPPORT 47 - MAILBOX 54 - OTHER FIXED OBJECT
30 - GUARDRAIL FACE 36 - MEDIAN OTHER BARRIER 42 - CULVERT 48 - TREE 99 - OTHER / UNKNOWN
49 - FIRE HYDRANT

UNIT / NON-MOTORIST DIRECTION

FROM 6 TO 7

1 - NORTH 5 - NORTHEAST
2 - SOUTH 6 - NORTHWEST
3 - EAST 7 - SOUTHEAST
4 - WEST 8 - SOUTHWEST
9 - OTHER / UNKNOWN

FIRST HARMFUL EVENT 1 MOST HARMFUL EVENT 1

UNIT SPEED: 35

DETECTED SPEED: 1

1 - STATED / ESTIMATED SPEED
2 - CALCULATED / EDR
3 - UNDETERMINED

POSTED SPEED: 35



MOTORIST / Non-MOTORIST

LOCAL REPORT NUMBER
2 2 0 8 2 3 7 1

UNIT # 0 1	NAME: LAST, FIRST, MIDDLE Plaisted, Jedediah	DATE OF BIRTH 0 9 2 0 1 9 8 3	AGE 3 9	GENDER M
ADDRESS: STREET, CITY, STATE, ZIP 8004 Tuliptree Cir., West Chester, OH 45069		CONTACT PHONE - INCLUDE AREA CODE		

INJURIES 5	INJURED TAKEN BY	EMS AGENCY (NAME)	INJURED TAKEN TO: MEDICAL FACILITY (NAME, CITY)	SAFETY EQUIPMENT USED 0, 4	<input type="checkbox"/> DOT-COMPLIANT MC HELMET	SEATING POSITION 0 1	AIR BAG USAGE 2	EJECTION 1	TRAPPED 1
OL STATE OH	OPERATOR LICENSE NUMBER		OFFENSE CHARGED 331.17 a	LOCAL CODE <input checked="" type="checkbox"/>	OFFENSE DESCRIPTION ROW Turning Left		CITATION NUMBER 252484		
OL CLASS 4	ENDORSEMENT SELECT UP TO 2	RESTRICTION SELECT UP TO 3	DRIVER DISTRACTED BY 1	ALCOHOL / DRUG SUSPECTED <input type="checkbox"/> ALCOHOL <input type="checkbox"/> MARIJUANA <input type="checkbox"/> OTHER DRUG		CONDITION 1	ALCOHOL TEST STATUS: 1, TYPE: 1, VALUE: .		DRUG TEST(S) STATUS: 1, TYPE: 1, RESULT: .

UNIT # 0 2	NAME: LAST, FIRST, MIDDLE Coffey, Christopher	DATE OF BIRTH 0 5 2 9 1 9 9 6	AGE 2 6	GENDER M
ADDRESS: STREET, CITY, STATE, ZIP 16 Waco Way, Hamilton, OH 45015		CONTACT PHONE - INCLUDE AREA CODE		

INJURIES 3	INJURED TAKEN BY 2	EMS AGENCY (NAME) Fairfield	INJURED TAKEN TO: MEDICAL FACILITY (NAME, CITY) Mercy	SAFETY EQUIPMENT USED 0 4	<input type="checkbox"/> DOT-COMPLIANT MC HELMET	SEATING POSITION 0 1	AIR BAG USAGE 2	EJECTION 1	TRAPPED 1
OL STATE OH	OPERATOR LICENSE NUMBER		OFFENSE CHARGED	LOCAL CODE <input type="checkbox"/>	OFFENSE DESCRIPTION		CITATION NUMBER		
OL CLASS 4	ENDORSEMENT SELECT UP TO 2	RESTRICTION SELECT UP TO 3	DRIVER DISTRACTED BY 1	ALCOHOL / DRUG SUSPECTED <input type="checkbox"/> ALCOHOL <input type="checkbox"/> MARIJUANA <input type="checkbox"/> OTHER DRUG		CONDITION 1	ALCOHOL TEST STATUS: 1, TYPE: 1, VALUE: .		DRUG TEST(S) STATUS: 1, TYPE: 1, RESULT: .

UNIT #	NAME: LAST, FIRST, MIDDLE	DATE OF BIRTH	AGE 0	GENDER
ADDRESS: STREET, CITY, STATE, ZIP		CONTACT PHONE - INCLUDE AREA CODE		

INJURIES	INJURED TAKEN BY	EMS AGENCY (NAME)	INJURED TAKEN TO: MEDICAL FACILITY (NAME, CITY)	SAFETY EQUIPMENT USED	<input type="checkbox"/> DOT-COMPLIANT MC HELMET	SEATING POSITION	AIR BAG USAGE	EJECTION	TRAPPED
OL STATE	OPERATOR LICENSE NUMBER		OFFENSE CHARGED	LOCAL CODE <input type="checkbox"/>	OFFENSE DESCRIPTION		CITATION NUMBER		
OL CLASS	ENDORSEMENT SELECT UP TO 2	RESTRICTION SELECT UP TO 3	DRIVER DISTRACTED BY	ALCOHOL / DRUG SUSPECTED <input type="checkbox"/> ALCOHOL <input type="checkbox"/> MARIJUANA <input type="checkbox"/> OTHER DRUG		CONDITION	ALCOHOL TEST STATUS: , TYPE: , VALUE: .		DRUG TEST(S) STATUS: , TYPE: , RESULT: .

INJURIES	SEATING POSITION	AIR BAG	OL CLASS	OL RESTRICTION(S)	DRIVER DISTRACTION	TEST STATUS
1-FATAL 2-SUSPECTED SERIOUS INJURY 3-SUSPECTED MINOR INJURY 4-POSSIBLE INJURY 5-NO APPARENT INJURY	1-FRONT-LEFT SIDE (MOTORCYCLE DRIVER) 2-FRONT-MIDDLE 3-FRONT-RIGHT SIDE 4-SECOND-LEFT SIDE (MOTORCYCLE PASSENGER) 5-SECOND-MIDDLE 6-SECOND-RIGHT SIDE 7-THIRD-LEFT SIDE (MOTORCYCLE SIDE CAR) 8-THIRD-MIDDLE 9-THIRD-RIGHT SIDE 10-SLEEPER SECTION OF TRUCK CAB 11-PASSENGER IN OTHER ENCLOSED CARGO AREA (NON-TRAILING UNIT, BUS, PICK-UP WITH CAP) 12-PASSENGER IN UNENCLOSED CARGO AREA 13-TRAILING UNIT 14-RIDING ON VEHICLE EXTERIOR (NON-TRAILING UNIT) 15-NON-MOTORIST 99-OTHER/UNKNOWN	1-NOT DEPLOYED 2-DEPLOYED FRONT 3-DEPLOYED SIDE 4-DEPLOYED BOTH FRONT/SIDE 5-NOT APPLICABLE 9-DEPLOYMENT UNKNOWN	1-CLASS A 2-CLASS B 3-CLASS C 4-REGULAR CLASS (OHIO-D) 5-MC MOPED ONLY 6-INVALID OL	1-ALCOHOL INTERLOCK DEVICE 2-CDL INTRASTATE ONLY 3-CORRECTIVE LENSES 4-FARM WAIVER 5-EXCEPT CLASS A BUS 6-EXCEPT CLASS A & CLASS B BUS 7-EXCEPT TRACTOR-TRAILER 8-INTERMEDIATE LICENSE RESTRICTIONS 9-LEARNER'S PERMIT RESTRICTIONS 10-LIMITED TO DAYLIGHT ONLY 11-LIMITED TO EMPLOYMENT 12-LIMITED-OTHER 13-MECHANICAL DEVICES (SPECIAL BRAKES, HAND CONTROLS, OR OTHER ADAPTIVE DEVICES) 14-MILITARY VEHICLES ONLY 15-MOTOR VEHICLES WITHOUT AIR BRAKES 16-OUTSIDE MIRROR 17-PROSTHETIC AID 18-OTHER	1-NOT DISTRACTED 2-MANUALLY OPERATING AN ELECTRONIC COMMUNICATION DEVICE (TEXTING, TYPING, DIALING) 3-TALKING ON HANDS-FREE COMMUNICATION DEVICE 4-TALKING ON HAND-HELD COMMUNICATION DEVICE 5-OTHER ACTIVITY WITH AN ELECTRONIC DEVICE 6-PASSENGER 7-OTHER DISTRACTION INSIDE THE VEHICLE 8-OTHER DISTRACTION OUTSIDE THE VEHICLE 9-OTHER/UNKNOWN	1-NONE GIVEN 2-TEST REFUSED 3-TEST GIVEN, CONTAMINATED, SAMPLE/UNUSABLE 4-TEST GIVEN, RESULTS KNOWN 5-TEST GIVEN, RESULTS UNKNOWN
INJURED TAKEN BY	EJECTION	TRAPPED	OL ENDORSEMENT	CONDITION	ALCOHOL TEST TYPE	DRUG TEST TYPE
1-NOT TRANSPORTED / TREATED AT SCENE 2-EMS 3-POLICE 9-OTHER/UNKNOWN	1-NOT EJECTED 2-PARTIALLY EJECTED 3-TOTALLY EJECTED 4-NOT APPLICABLE	1-NOT TRAPPED 2-EXTRICATED BY MECHANICAL MEANS 3-FREED BY NON-MECHANICAL MEANS	H-HAZMAT M-MOTORCYCLE P-PASSENGER N-TANKER Q-MOTOR SCOOTER R-THREE-WHEEL MOTORCYCLE S-SCHOOL BUS T-DOUBLE & TRIPLE TRAILERS X-TANKER/HAZMAT	1-APPARENTLY NORMAL 2-PHYSICAL IMPAIRMENT 3-EMOTIONAL (E.G. DEPRESSED, ANGRY, DISTURBED) 4-ILLNESS 5-FELL ASLEEP, FAINTED, FATIGUED, ETC. 6-UNDER THE INFLUENCE OF MEDICATIONS/DRUGS/ALCOHOL 9-OTHER/UNKNOWN	1-NONE 2-BLOOD 3-URINE 4-BREATH 5-OTHER	1-NONE 2-BLOOD 3-URINE 4-OTHER
SAFETY EQUIPMENT	TRAPPED	TRAPPED	GENDER	CONDITION	DRUG TEST RESULT(S)	
1-NONE USED 2-SHOULDER BELT ONLY USED 3-LAP BELT ONLY USED 4-SHOULDER & LAP BELT USED 5-CHILD RESTRAINT SYSTEM FORWARD FACING 6-CHILD RESTRAINT SYSTEM REAR FACING 7-BOOSTER SEAT 8-HELMET USED 9-PROTECTIVE PADS USED (ELBOW, KNEES, ETC.) 10-REFLECTIVE CLOTHING 11-LIGHTING - PEDESTRIAN / BICYCLE ONLY 99-OTHER/UNKNOWN	1-NOT TRAPPED 2-EXTRICATED BY MECHANICAL MEANS 3-FREED BY NON-MECHANICAL MEANS	1-NOT TRAPPED 2-EXTRICATED BY MECHANICAL MEANS 3-FREED BY NON-MECHANICAL MEANS	F-FEMALE M-MALE U-OTHER/UNKNOWN	1-APPARENTLY NORMAL 2-PHYSICAL IMPAIRMENT 3-EMOTIONAL (E.G. DEPRESSED, ANGRY, DISTURBED) 4-ILLNESS 5-FELL ASLEEP, FAINTED, FATIGUED, ETC. 6-UNDER THE INFLUENCE OF MEDICATIONS/DRUGS/ALCOHOL 9-OTHER/UNKNOWN	1-AMPHETAMINES 2-BARBITURATES 3-BENZODIAZEPINES 4-CANNABINOIDS 5-COCAINE 6-OPIATES/OPIOIDS 7-OTHER 8-NEGATIVE RESULTS	

LOCAL REPORT NUMBER PD-22-082371	REPORTING AGENCY Fairfield Police Department	DATE OF ACCIDENT 11/10/22
IN COUNTY OF Butler	ACCIDENT LOCATION Symmes Rd.// Industry Dr.	



Not to Scale

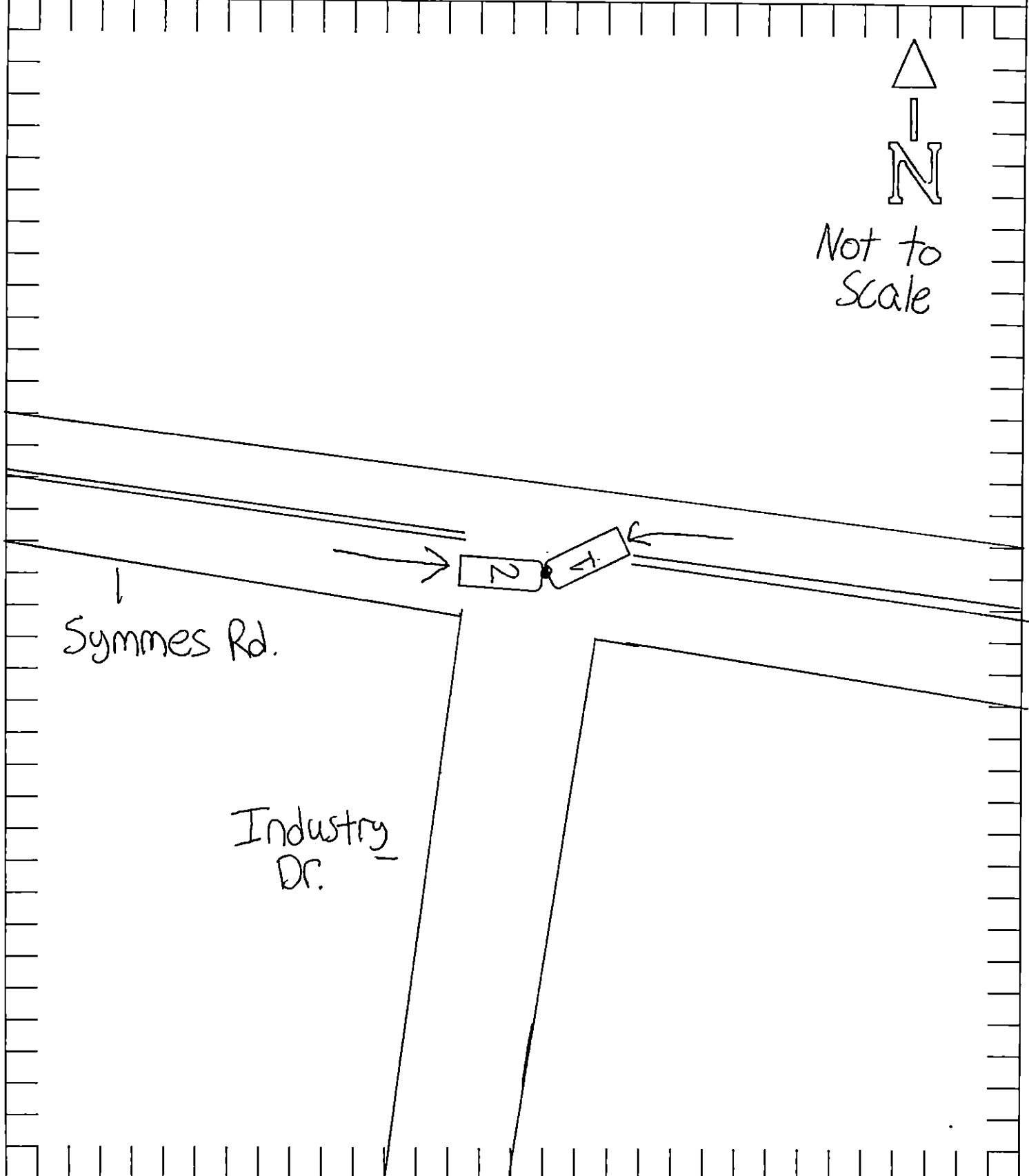

	OFFICER'S SIGNATURE D. Miller	BADGE NO. 167
--	----------------------------------	------------------