



TRAFFIC CRASH REPORT

*DENOTES MANDATORY FIELD FOR SUPPLEMENT REPORT

LOCAL REPORT NUMBER*

<input checked="" type="checkbox"/> PHOTOS TAKEN	<input type="checkbox"/> OH-2	<input type="checkbox"/> OH-3	LOCAL INFORMATION	2 2 0 8 5 6 5 2			
<input type="checkbox"/> SECONDARY CRASH	<input checked="" type="checkbox"/> OH-1P	<input type="checkbox"/> OTHER	REPORTING AGENCY NAME*	NCIC*	HIT/SKIP	NUMBER OF UNITS	UNIT IN ERROR
<input type="checkbox"/> PRIVATE PROPERTY			Fairfield Police Department	0 0 9 0 1	1 - SOLVED	0 2	9 9 98 - ANIMAL
					2 - UNSOLVED		99 - UNKNOWN

COUNTY* 0 9	LOCALITY* 1 - CITY 2 - VILLAGE 3 - TOWNSHIP 1	LOCATION: CITY, VILLAGE, TOWNSHIP* City of Fairfield	CRASH DATE / TIME* 1 1 2 3 2 0 2 2 1 8 2 4	CRASH SEVERITY 5 1 - FATAL 2 - SERIOUS INJURY SUSPECTED 3 - MINOR INJURY SUSPECTED 4 - INJURY POSSIBLE 5 - PROPERTY DAMAGE ONLY
----------------	---	---	---	---

ROUTE TYPE	ROUTE NUMBER	PREFIX	1 - NORTH 2 - SOUTH 3 - EAST 4 - WEST	LOCATION ROAD NAME MACK	ROAD TYPE R D	LATITUDE DECIMAL DEGREES 3 9 . 3 1 1 1 5 9	INTERSECTION RELATED <input checked="" type="checkbox"/> WITHIN INTERSECTION OR ON APPROACH <input type="checkbox"/> WITHIN INTERCHANGE AREA NUMBER OF APPROACHES 0 3
ROUTE TYPE	ROUTE NUMBER	PREFIX	1 - NORTH 2 - SOUTH 3 - EAST 4 - WEST	REFERENCE ROAD NAME (ROAD, MILEPOST, HOUSE #) KOLB	ROAD TYPE D R	LONGITUDE DECIMAL DEGREES - 8 4 . 5 2 7 6 4 3	

REFERENCE POINT 1 - INTERSECTION 2 - MILE POST 3 - HOUSE # 1	DIRECTION FROM REFERENCE 1 - NORTH 2 - SOUTH 3 - EAST 4 - WEST	ROUTE TYPE IR - INTERSTATE ROUTE(TP) US - FEDERAL US ROUTE SR - STATE ROUTE CR - NUMBERED COUNTY ROUTE TR - NUMBERED TOWNSHIP ROUTE	ROAD TYPE AL - ALLEY AV - AVENUE BL - BOULEVARD CR - CIRCLE CT - COURT DR - DRIVE HE - HEIGHTS HW - HIGHWAY LA - LANE MP - MILEPOST OV - OVAL PK - PARKWAY PI - PIKE PL - PLACE RD - ROAD SQ - SQUARE ST - STREET TE - TERRACE TL - TRAIL WA - WAY	INTERSECTION RELATED <input checked="" type="checkbox"/> WITHIN INTERSECTION OR ON APPROACH <input type="checkbox"/> WITHIN INTERCHANGE AREA NUMBER OF APPROACHES 0 3
DISTANCE FROM REFERENCE	DISTANCE UNIT OF MEASURE 1 - MILES 2 - FEET 3 - YARDS			ROADWAY <input type="checkbox"/> ROADWAY DIVIDED

LOCATION OF FIRST HARMFUL EVENT 1 - ON ROADWAY 2 - ON SHOULDER 3 - IN MEDIAN 4 - ON ROADSIDE 5 - ON GORE 6 - OUTSIDE TRAFFIC WAY 7 - ON RAMP 8 - OFF RAMP 0 1	9 - CROSSOVER 10 - DRIVEWAY/ALLEY ACCESS 11 - RAILWAY GRADE CROSSING 12 - SHARED USE PATHS OR TRAILS 13 - BIKE LANE 14 - TOLL BOOTH 99 - OTHER / UNKNOWN 6	MANNER OF CRASH COLLISION/IMPACT 1 - NOT COLLISION BETWEEN TWO MOTOR VEHICLES IN TRANSPORT 2 - REAR-END 3 - HEAD-ON 4 - REAR-TO-REAR 5 - BACKING 6 - ANGLE 7 - SIDESWIPE, SAME DIRECTION 8 - SIDESWIPE, OPPOSITE DIRECTION 9 - OTHER / UNKNOWN	DIRECTION OF TRAVEL 1 - NORTH 2 - SOUTH 3 - EAST 4 - WEST	MEDIAN TYPE 1 - DIVIDED FLUSH MEDIAN (<4 FEET) 2 - DIVIDED FLUSH MEDIAN (≥4 FEET) 3 - DIVIDED, DEPRESSED MEDIAN 4 - DIVIDED, RAISED MEDIAN (ANY TYPE) 9 - OTHER/UNKNOWN
--	---	---	---	--

<input type="checkbox"/> WORK ZONE RELATED <input type="checkbox"/> WORKERS PRESENT <input type="checkbox"/> LAW ENFORCEMENT PRESENT <input type="checkbox"/> ACTIVE SCHOOL ZONE	WORK ZONE TYPE 1 - LANE CLOSURE 2 - LANE SHIFT/CROSSOVER 3 - WORK ON SHOULDER OR MEDIAN 4 - INTERMITTENT OR MOVING WORK 5 - OTHER	LOCATION OF CRASH IN WORK ZONE 1 - BEFORE THE 1ST WORK ZONE WARNING SIGN 2 - ADVANCE WARNING AREA 3 - TRANSITION AREA 4 - ACTIVITY AREA 5 - TERMINATION AREA	CONTOUR 1 1 - STRAIGHT LEVEL 2 - STRAIGHT GRADE 3 - CURVE LEVEL 4 - CURVE GRADE 9 - OTHER/UNKNOWN	CONDITIONS 1 1 - DRY 2 - WET 3 - SNOW 4 - ICE 5 - SAND, MUD, DIRT, OIL, GRAVEL 6 - WATER (STANDING, MOVING) 7 - SLUSH 9 - OTHER/UNKNOWN	SURFACE 2 1 - CONCRETE 2 - BLACKTOP, BITUMINOUS, ASPHALT 3 - BRICK/BLOCK 4 - SLAG, GRAVEL, STONE 5 - DIRT 9 - OTHER/UNKNOWN
---	--	---	---	--	--

LIGHT CONDITION 1 - DAYLIGHT 2 - DAWN/DUSK 3 - DARK - LIGHTED ROADWAY 4 - DARK - ROADWAY NOT LIGHTED 5 - DARK - UNKNOWN ROADWAY LIGHTING 9 - OTHER / UNKNOWN 3	WEATHER 1 - CLEAR 2 - CLOUDY 3 - FOG, SMOG, SMOKE 4 - RAIN 5 - SLEET, HAIL 6 - SNOW 7 - SEVERE CROSSWINDS 8 - BLOWING SAND, SOIL, DIRT, SNOW 9 - FREEZING RAIN OR FREEZING DRIZZLE 99 - OTHER / UNKNOWN 0 1
---	--

NARRATIVE
On November 23, 2022 at approximately 6:24 PM, Unit 1 was exiting the parking lot of 2796 Mack Road traveling southbound across Mack Road onto Kolb Drive. Unit 2 was traveling northbound on Kolb Drive turning left onto Mack Road. Both Units then collided with each other in the intersection. It was unable to be determined which Unit had the right of way.

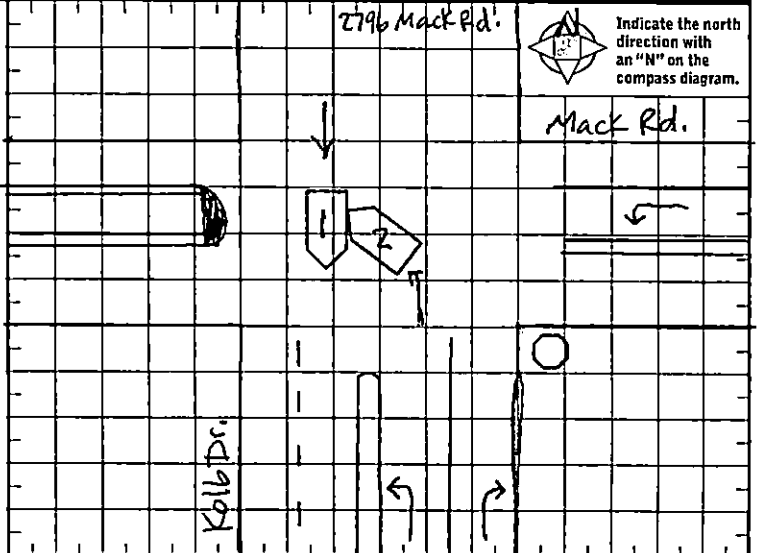

CRASH REPORTED DATE / TIME 1 1 2 3 2 0 2 2 1 8 2 5	DISPATCH DATE / TIME 1 1 2 3 2 0 2 2 1 8 2 7	ARRIVAL DATE / TIME 1 1 2 3 2 0 2 2 1 8 3 6	SCENE CLEARED DATE / TIME 1 1 2 3 2 0 2 2 1 8 4 6	REPORT TAKEN BY <input checked="" type="checkbox"/> POLICE AGENCY <input type="checkbox"/> MOTORIST
TOTAL TIME ROADWAY CLOSED 0	OTHER INVESTIGATION TIME 3 0	TOTAL MINUTES 4 9	OFFICER'S NAME* A. ROUSH	CHECKED BY OFFICER'S NAME* Sgt. Aaron Meyer
			OFFICER'S BADGE NUMBER* 1 7 0	CHECKED BY OFFICER'S BADGE NUMBER* 1 3 2
				<input type="checkbox"/> SUPPLEMENT (CORRECTION OR ADDITION TO AN EXISTING REPORT SENT TO ODP)

LOCAL REPORT NUMBER
2, 2, 0, 8, 5, 6, 5, 2

OWNER

UNIT # 01 OWNER NAME: LAST, FIRST, MIDDLE (☒ SAME AS DRIVER)
OWNER ADDRESS: STREET, CITY, STATE, ZIP (☒ SAME AS DRIVER)
COMMERCIAL CARRIER: NAME, ADDRESS, CITY, STATE, ZIP
COMMERCIAL CARRIER PHONE: INCLUDE AREA CODE

DAMAGE

DAMAGE SCALE

1 - NONE
2 - MINOR DAMAGE
3 - FUNCTIONAL DAMAGE
4 - DISABLING DAMAGE
9 - UNKNOWN

VEHICLE

LP STATE OH LICENSE PLATE # HET7304 VEHICLE IDENTIFICATION # 3VWR7A7AJXA1M060089 VEHICLE YEAR 2010 VEHICLE MAKE VOLKSWAGEN
INSURANCE VERIFIED INSURANCE COMPANY PROGRESSIVE INSURANCE POLICY # 908510009 COLOR RED VEHICLE MODEL JETTA

DAMAGED AREA(S)
INDICATE ALL THAT APPLY

TYPE OF USE
 COMMERCIAL GOVERNMENT IN EMERGENCY RESPONSE
US DOT # _____
HAZARDOUS MATERIAL
 MATERIAL RELEASED CLASS # _____ PLACARD ID # _____
 INTERLOCK DEVICE EQUIPPED HIT/SKIP UNIT #OCCUPANTS 01
VEHICLE WEIGHT GVWR/GCWR
1 - ≤10K LBS.
2 - 10,001 - 26K LBS.
3 - >26K LBS.

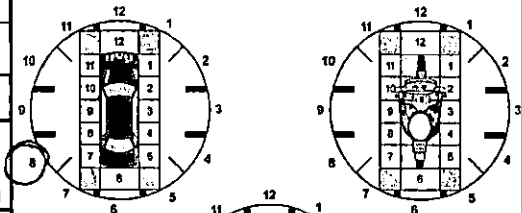

UNIT TYPE 01
OF TRAILING UNITS 00

1 - PASSENGER CAR
2 - PASSENGER VAN (MINIVAN)
3 - SPORT UTILITY VEHICLE
4 - PICK UP
5 - CARGO VAN
6 - VAN (9-15 SEATS)
7 - MOTORCYCLE 2-WHEELED
8 - MOTORCYCLE 3-WHEELED
9 - AUTOCYCLE
10 - MOPED OR MOTORIZED BICYCLE
11 - ALL TERRAIN VEHICLE (ATV/UTV)
12 - GOLF CART
13 - SNOWMOBILE
14 - SINGLE UNIT TRUCK
15 - SEMI-TRACTOR
16 - FARM EQUIPMENT
17 - MOTORHOME
18 - LIMO (LIVERY VEHICLE)
19 - BUS (16+ PASSENGERS)
20 - OTHER VEHICLE
21 - HEAVY EQUIPMENT
22 - ANIMAL WITH RIDER OR ANIMAL-DRAWN VEHICLE
23 - PEDESTRIAN / SKATER
24 - WHEELCHAIR (ANY TYPE)
25 - OTHER NON-MOTORIST
26 - BICYCLE
27 - TRAIN
99 - UNKNOWN OR HIT/SKIP

WAS VEHICLE OPERATING IN AUTONOMOUS MODE WHEN CRASH OCCURRED?
02 1 - YES 2 - NO 9 - OTHER / UNKNOWN
AUTONOMOUS MODE LEVEL 0
0 - NO AUTOMATION
1 - DRIVER ASSISTANCE
2 - PARTIAL AUTOMATION
3 - CONDITIONAL AUTOMATION
4 - HIGH AUTOMATION
5 - FULL AUTOMATION
9 - UNKNOWN

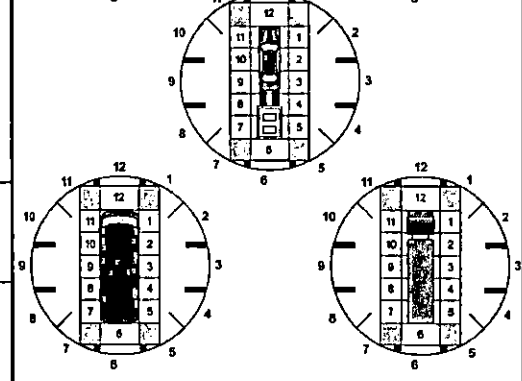

SPECIAL FUNCTION 01

1 - NONE
2 - TAXI
3 - ELECTRONIC RIDE SHARING
4 - SCHOOL TRANSPORT
5 - BUS - TRANSIT/COMMUTER
6 - BUS - CHARTER/TOUR
7 - BUS - INTERCITY
8 - BUS - SHUTTLE
9 - BUS - OTHER
10 - AMBULANCE
11 - FIRE
12 - MILITARY
13 - POLICE
14 - PUBLIC UTILITY
15 - CONSTRUCTION EQUIPMENT
16 - FARM
17 - MOWING
18 - SNOW REMOVAL
19 - TOWING
20 - SAFETY SERVICE PATROL
21 - MAIL CARRIER
99 - OTHER / UNKNOWN

CARGO BODY TYPE 01

1 - NO CARGO BODY TYPE / NOT APPLICABLE
2 - BUS
3 - VEHICLE TOWING ANOTHER MOTOR VEHICLE
4 - LOGGING
5 - INTERMODAL CONTAINER CHASSIS
6 - CARGO VAN/ENCLOSED BOX
7 - GRAINCHIPS/GRAVEL
8 - POLE
9 - CARGO TANK
10 - FLAT BED
11 - DUMP
12 - CONCRETE MIXER
13 - AUTO TRANSPORTER
14 - GARBAGE/REFUSE
99 - OTHER / UNKNOWN

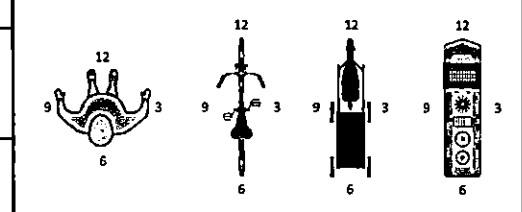

VEHICLE DEFECTS

1 - TURN SIGNALS
2 - HEAD LAMPS
3 - TAIL LAMPS
4 - BRAKES
5 - STEERING
6 - TIRE BLOWOUT
7 - WORN OR SLICK TIRES
8 - TRAILER EQUIPMENT DEFECTIVE
9 - MOTOR TROUBLE
10 - DISABLED FROM PRIOR ACCIDENT
99 - OTHER / UNKNOWN

- NO DAMAGE [0] - UNDERCARRIAGE [14]
 - TOP [13] - ALL AREAS [15]
 - UNIT NOT AT SCENE [16]

NON-MOTORIST LOCATION AT IMPACT

1 - INTERSECTION - MARKED CROSSWALK
2 - INTERSECTION - UNMARKED CROSSWALK
3 - INTERSECTION - OTHER
4 - MIDBLOCK - MARKED CROSSWALK
5 - TRAVEL LANE - OTHER LOCATION
6 - BICYCLE LANE
7 - SHOULDER / ROADSIDE
8 - SIDEWALK
9 - MEDIAN/CROSSING ISLAND
10 - DRIVEWAY ACCESS
11 - SHARED USE PATHS OR TRAILS
12 - FIRST RESPONDER AT INCIDENT SCENE
99 - OTHER / UNKNOWN

ACTION 04

1 - NON-CONTACT
2 - NON-COLLISION
3 - STRIKING
4 - STRUCK
5 - BOTH STRIKING & STRUCK
9 - OTHER / UNKNOWN
1 - STRAIGHT AHEAD
2 - BACKING
3 - CHANGING LANES
4 - OVERTAKING/PASSING
5 - MAKING RIGHT TURN
6 - MAKING LEFT TURN
7 - MAKING U-TURN
8 - ENTERING TRAFFIC LANE
9 - LEAVING TRAFFIC LANE
10 - PARKED
11 - SLOWING OR STOPPED IN TRAFFIC
12 - DRIVERLESS
13 - NEGOTIATING A CURVE OR LEAVING VEHICLE
14 - ENTERING OR CROSSING SPECIFIED LOCATION
15 - WALKING, RUNNING, JOGGING, PLAYING
16 - WORKING
17 - PUSHING VEHICLE
18 - APPROACHING OR LEAVING VEHICLE
19 - STANDING
20 - OTHER NON-MOTORIST
21 - STANDING OUTSIDE DISABLED VEHICLE
99 - OTHER / UNKNOWN

INITIAL POINT OF CONTACT

0 - NO DAMAGE
1-12 - REFER TO UNIT DIAGRAM
13 - TOP
14 - UNDERCARRIAGE
15 - VEHICLE NOT AT SCENE
99 - UNKNOWN

CONTRIBUTING CIRCUMSTANCES 22

1 - NONE
2 - FAILURE TO YIELD
3 - RAN RED LIGHT
4 - RAN STOP SIGN
5 - UNSAFE SPEED
6 - IMPROPER TURN
7 - LEFT OF CENTER
8 - FOLLOWING TOO CLOSE / ACDA
9 - IMPROPER LANE CHANGE
10 - IMPROPER PASSING
11 - DROVE OFF ROAD
12 - IMPROPER BACKING
13 - IMPROPER START FROM A PARKED POSITION
14 - STOPPED OR PARKED ILLEGALLY
15 - SWERVING TO AVOID
16 - WRONG WAY
17 - VISION OBSTRUCTION
18 - OPERATING DEFECTIVE EQUIPMENT
19 - LOAD SHIFTING/FALLING/SPILLING
20 - IMPROPER CROSSING
21 - LYING IN ROADWAY
22 - NOT DISCERNIBLE
23 - OPENING DOOR INTO ROADWAY
99 - OTHER IMPROPER ACTION

TRAFFIC

TRAFFICWAY FLOW
1 - ONE-WAY
2 - TWO-WAY
TRAFFIC CONTROL
1 - ROUNDABOUT
2 - SIGNAL
3 - FLASHER
4 - STOP SIGN
5 - YIELD SIGN
6 - NO CONTROL

SEQUENCE OF EVENTS

1 20 1 - OVERTURN/ROLLOVER
2 11 2 - FIRE/EXPLOSION
3 11 3 - IMMERSION
4 11 4 - JACKKNIFE
5 11 5 - CARGO/EQUIPMENT LOSS OR SHIFT
6 11 6 - EQUIPMENT FAILURE
7 11 7 - SEPARATION OF UNITS
8 11 8 - RAN OFF ROAD RIGHT
9 11 9 - RAN OFF ROAD LEFT
10 11 10 - CROSS MEDIAN
11 11 11 - CROSS CENTERLINE - OPPOSITE DIRECTION OF TRAVEL
12 11 12 - DOWNHILL RUNAWAY
13 11 13 - OTHER NON-COLLISION
14 11 14 - PEDESTRIAN
15 11 15 - PEDALCYCLE
16 11 16 - RAILWAY VEHICLE
17 11 17 - ANIMAL - FARM
18 11 18 - ANIMAL - DEER
19 11 19 - ANIMAL - OTHER
20 11 20 - MOTOR VEHICLE IN TRANSPORT
21 11 21 - PARKED MOTOR VEHICLE
22 11 22 - WORK ZONE MAINTENANCE EQUIPMENT
23 11 23 - STRUCK BY FALLING, SHIFTING CARGO OR ANYTHING SET IN MOTION BY A MOTOR VEHICLE
24 11 24 - OTHER MOVABLE OBJECT

OF THROUGH LANES ON ROAD 2

RAIL GRADE CROSSING 1

1 - NOT INVOLVED
2 - INVOLVED-ACTIVE CROSSING
3 - INVOLVED-PASSIVE CROSSING

COLLISION WITH FIXED OBJECT STRUCK BY

25 - IMPACT ATTENUATOR / CRASH CUSHION
26 - BRIDGE OVERHEAD STRUCTURE
27 - BRIDGE PIER OR ABUTMENT
28 - BRIDGE PARAPET
29 - BRIDGE RAIL
30 - GUARDRAIL FACE
31 - GUARDRAIL END
32 - PORTABLE BARRIER
33 - MEDIAN CABLE BARRIER
34 - MEDIAN GUARDRAIL BARRIER
35 - MEDIAN CONCRETE BARRIER
36 - MEDIAN OTHER BARRIER
37 - TRAFFIC SIGN POST
38 - OVERHEAD SIGN POST
39 - LIGHT / LUMINARIES SUPPORT
40 - UTILITY POLE
41 - OTHER POST, POLE OR SUPPORT
42 - CULVERT
43 - CURB
44 - DITCH
45 - EMBANKMENT
46 - FENCE
47 - MAILBOX
48 - TREE
49 - FIRE HYDRANT
50 - WORK ZONE MAINTENANCE EQUIPMENT
51 - WALL
52 - BUILDING
53 - TUNNEL
54 - OTHER FIXED OBJECT
99 - OTHER / UNKNOWN

UNIT / NON-MOTORIST DIRECTION

FROM 1 TO 2

1 - NORTH
2 - SOUTH
3 - EAST
4 - WEST
5 - NORTHEAST
6 - NORTHWEST
7 - SOUTHEAST
8 - SOUTHWEST
9 - OTHER / UNKNOWN

FIRST HARMFUL EVENT 1 MOST HARMFUL EVENT 1

UNIT SPEED 10

POSTED SPEED 25

DETECTED SPEED 1

1 - STATED / ESTIMATED SPEED
2 - CALCULATED / EDR
3 - UNDETERMINED

OWNER # 0 2 | **OWNER NAME: LAST, FIRST, MIDDLE** (SAME AS DRIVER) | **OWNER PHONE: INCLUDE AREA CODE** (SAME AS DRIVER)

OWNER ADDRESS: STREET, CITY, STATE, ZIP (SAME AS DRIVER) | **COMMERCIAL CARRIER PHONE: INCLUDE AREA CODE**

COMMERCIAL CARRIER: NAME, ADDRESS, CITY, STATE, ZIP | **COMMERCIAL CARRIER PHONE: INCLUDE AREA CODE**

DAMAGE

DAMAGE SCALE

1 - NONE | 3 - FUNCTIONAL DAMAGE
 2 - MINOR DAMAGE | 4 - DISABLING DAMAGE
 9 - UNKNOWN

LP STATE OH | **LICENSE PLATE #** JSJ4039 | **VEHICLE IDENTIFICATION #** 3N11C1P5CVXN1L482793 | **VEHICLE YEAR** 2022 | **VEHICLE MAKE** NISSAN

INSURANCE VERIFIED | **INSURANCE COMPANY** STATE FARM | **INSURANCE POLICY #** C925798F3035A | **COLOR** WHITE | **VEHICLE MODEL** KICKS

DAMAGED AREA(S) INDICATE ALL THAT APPLY

COMMERCIAL | **GOVERNMENT** | **IN EMERGENCY RESPONSE**

INTERLOCK DEVICE EQUIPPED | **HIT/SKIP UNIT** | **#OCCUPANTS** 0 2

US DOT # | **VEHICLE WEIGHT GVWR/GCWR**
 1 - ≤10K LBS.
 2 - 10,001 - 26K LBS.
 3 - >26K LBS.

TOWED BY: COMPANY NAME | **HAZARDOUS MATERIAL**
 MATERIAL RELEASED | **PLACARD** | **CLASS #** | **PLACARD ID #**

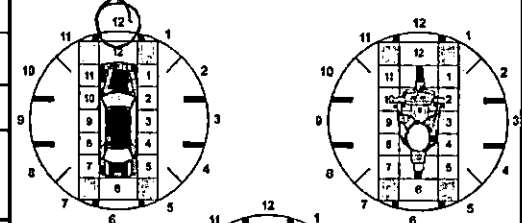

UNIT TYPE 0 3

1 - PASSENGER CAR	7 - MOTORCYCLE 2-WHEELED	12 - GOLF CART	18 - LIMO (LIVERY VEHICLE)	23 - PEDESTRIAN / SKATER
2 - PASSENGER VAN (MINIVAN)	8 - MOTORCYCLE 3-WHEELED	13 - SNOWMOBILE	19 - BUS (16+ PASSENGERS)	24 - WHEELCHAIR (ANY TYPE)
3 - SPORT UTILITY VEHICLE	9 - AUTOCYCLE	14 - SINGLE UNIT TRUCK	20 - OTHER VEHICLE	25 - OTHER NON-MOTORIST
4 - PICK UP	10 - MOPED OR MOTORIZED BICYCLE	15 - SEMI-TRACTOR	21 - HEAVY EQUIPMENT	26 - BICYCLE
5 - CARGO VAN	11 - ALL TERRAIN VEHICLE (ATV/UTV)	16 - FARM EQUIPMENT	22 - ANIMAL WITH RIDER OR ANIMAL-DRAWN VEHICLE	27 - TRAIN
6 - VAN (9-15 SEATS)		17 - MOTORHOME		99 - UNKNOWN OR HIT/SKIP

OF TRAILING UNITS 0 0

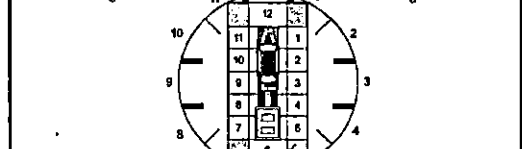

WAS VEHICLE OPERATING IN AUTONOMOUS MODE WHEN CRASH OCCURRED?
 1 - YES 2 - NO 9 - OTHER / UNKNOWN

AUTONOMOUS MODE LEVEL 0

0 - NO AUTOMATION | 1 - DRIVER ASSISTANCE | 2 - PARTIAL AUTOMATION | 3 - CONDITIONAL AUTOMATION | 4 - HIGH AUTOMATION | 5 - FULL AUTOMATION | 9 - UNKNOWN

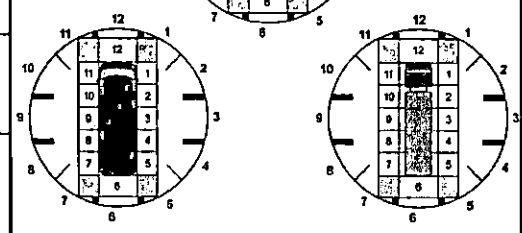

SPECIAL FUNCTION 0 1

1 - NONE	6 - BUS - CHARTER/TOUR	11 - FIRE	16 - FARM	21 - MAIL CARRIER
2 - TAXI	7 - BUS - INTERCITY	12 - MILITARY	17 - MOWING	99 - OTHER / UNKNOWN
3 - ELECTRONIC RIDE SHARING	8 - BUS - SHUTTLE	13 - POLICE	18 - SNOW REMOVAL	
4 - SCHOOL TRANSPORT	9 - BUS - OTHER	14 - PUBLIC UTILITY	19 - TOWING	
5 - BUS - TRANSIT/COMMUTER	10 - AMBULANCE	15 - CONSTRUCTION EQUIPMENT	20 - SAFETY SERVICE PATROL	

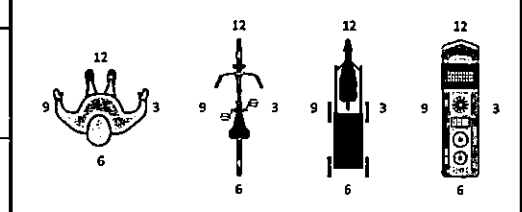

CARGO BODY TYPE 0 1

1 - NO CARGO BODY TYPE / NOT APPLICABLE	3 - VEHICLE TOWING ANOTHER MOTOR VEHICLE	5 - INTERMODAL CONTAINER CHASSIS	8 - POLE	12 - CONCRETE MIXER
2 - BUS	4 - LOGGING	6 - CARGO VAN/ENCLOSED BOX	9 - CARGO TANK	13 - AUTO TRANSPORTER
		7 - GRAIN/CHIPS/GRAVEL	10 - FLAT BED	14 - GARBAGE/REFUSE
			11 - DUMP	99 - OTHER / UNKNOWN

- NO DAMAGE [0] | - UNDERCARRIAGE [14]
 - TOP [13] | - ALL AREAS [15]
 - UNIT NOT AT SCENE [16]

VEHICLE DEFECTS

1 - TURN SIGNALS	4 - BRAKES	7 - WORN OR SLICK TIRES	9 - MOTOR TROUBLE	99 - OTHER / UNKNOWN
2 - HEAD LAMPS	5 - STEERING	8 - TRAILER EQUIPMENT DEFECTIVE	10 - DISABLED FROM PRIOR ACCIDENT	
3 - TAIL LAMPS	6 - TIRE BLOWOUT			

NON-MOTORIST LOCATION AT IMPACT

1 - INTERSECTION - MARKED CROSSWALK	3 - INTERSECTION - OTHER	6 - BICYCLE LANE	9 - MEDIUM CROSSING ISLAND	12 - FIRST RESPONDER AT INCIDENT SCENE
2 - INTERSECTION - UNMARKED CROSSWALK	4 - MIDBLOCK - MARKED CROSSWALK	7 - SHOULDER / ROADSIDE	10 - DRIVEWAY ACCESS	99 - OTHER / UNKNOWN
	5 - TRAVEL LANE - OTHER LOCATION	8 - SIDEWALK	11 - SHARED USE PATHS OR TRAILS	

INITIAL POINT OF CONTACT

0 - NO DAMAGE | 14 - UNDERCARRIAGE
 1-12 - REFER TO UNIT DIAGRAM | 15 - VEHICLE NOT AT SCENE
 13 - TOP | 99 - UNKNOWN

ACTION 0 3

1 - NON-CONTACT	1 - STRAIGHT AHEAD	7 - MAKING U-TURN	13 - NEGOTIATING A CURVE	18 - APPROACHING OR LEAVING VEHICLE
2 - NON-COLLISION	2 - BACKING	8 - ENTERING TRAFFIC LANE	14 - ENTERING OR CROSSING SPECIFIED LOCATION	19 - STANDING
3 - STRIKING	3 - CHANGING LANES	9 - LEAVING TRAFFIC LANE	15 - WALKING, RUNNING, JOGGING, PLAYING	20 - OTHER NON-MOTORIST
4 - STRUCK	4 - OVERTAKING/PASSING	10 - PARKED	16 - WORKING	21 - STANDING OUTSIDE DISABLED VEHICLE
5 - BOTH STRIKING & STRUCK	5 - MAKING RIGHT TURN	11 - SLOWING OR STOPPED IN TRAFFIC	17 - PUSHING VEHICLE	99 - OTHER / UNKNOWN
9 - OTHER / UNKNOWN	6 - MAKING LEFT TURN	12 - DRIVERLESS		

TRAFFIC

TRAFFICWAY FLOW
 1 - ONE-WAY | 2 - TWO-WAY

TRAFFIC CONTROL
 1 - ROUNDABOUT | 4 - STOP SIGN
 2 - SIGNAL | 5 - YIELD SIGN
 3 - FLASHER | 6 - NO CONTROL

CONTRIBUTING CIRCUMSTANCES 2 2

1 - NONE	7 - LEFT OF CENTER	13 - IMPROPER START FROM A PARKED POSITION	17 - VISION OBSTRUCTION	21 - LYING IN ROADWAY
2 - FAILURE TO YIELD	8 - FOLLOWING TOO CLOSE / ACCA	14 - STOPPED OR PARKED ILLEGALLY	18 - OPERATING DEFECTIVE EQUIPMENT	22 - NOT DISCERNIBLE
3 - RAN RED LIGHT	9 - IMPROPER LANE CHANGE	15 - SWERVING TO AVOID	19 - LOAD SHIFTING/FALLING/SPILLING	23 - OPENING DOOR INTO ROADWAY
4 - RAN STOP SIGN	10 - IMPROPER PASSING	16 - WRONG WAY	20 - IMPROPER CROSSING	99 - OTHER (IMPROPER ACTION)
5 - UNSAFE SPEED	11 - DROVE OFF ROAD			
6 - IMPROPER TURN	12 - IMPROPER BACKING			

OF THROUGH LANES ON ROAD 3

RAIL GRADE CROSSING
 1 - NOT INVOLVED
 2 - INVOLVED-ACTIVE CROSSING
 3 - INVOLVED-PASSIVE CROSSING

SEQUENCE OF EVENTS

1 2 0

1 - OVERTURN/ROLLOVER	6 - EQUIPMENT FAILURE	11 - CROSS CENTERLINE - OPPOSITE DIRECTION OF TRAVEL	16 - RAILWAY VEHICLE	22 - WORK ZONE MAINTENANCE EQUIPMENT
2 - FIRE/EXPLOSION	7 - SEPARATION OF UNITS	12 - DOWNHILL RUNAWAY	17 - ANIMAL - FARM	23 - STRUCK BY FALLING, SHIFTING CARGO OR ANYTHING SET IN MOTION BY A MOTOR VEHICLE
3 - IMMERSION	8 - RAN OFF ROAD RIGHT	13 - OTHER NON-COLLISION	18 - ANIMAL - DEER	24 - OTHER MOVABLE OBJECT
4 - JACKKNIFE	9 - RAN OFF ROAD LEFT	14 - PEDESTRIAN	19 - ANIMAL - OTHER	
5 - CARGO/EQUIPMENT LOSS OR SHIFT	10 - CROSS MEDIAN	15 - PEDALCYCLE	20 - MOTOR VEHICLE IN TRANSPORT	
			21 - PARKED MOTOR VEHICLE	

UNIT / NON-MOTORIST DIRECTION

FROM 2 TO 4

1 - NORTH	5 - NORTHEAST
2 - SOUTH	6 - NORTHWEST
3 - EAST	7 - SOUTHEAST
4 - WEST	8 - SOUTHWEST
	9 - OTHER / UNKNOWN

COLLISION WITH FIXED OBJECT STRUCK

25 - IMPACT ATTENUATOR / CRASH CUSHION	31 - GUARDRAIL END	37 - TRAFFIC SIGN POST	43 - CURB	50 - WORK ZONE MAINTENANCE EQUIPMENT
26 - BRIDGE OVERHEAD STRUCTURE	32 - PORTABLE BARRIER	38 - OVERHEAD SIGN POST	44 - DITCH	51 - WALL
27 - BRIDGE PIER OR ABUTMENT	33 - MEDIUM CABLE BARRIER	39 - LIGHT / LUMINARIES SUPPORT	45 - EMBANKMENT	52 - BUILDING
28 - BRIDGE PARAPET	34 - MEDIUM GUARDRAIL BARRIER	40 - UTILITY POLE	46 - FENCE	53 - TUNNEL
29 - BRIDGE RAIL	35 - MEDIUM CONCRETE BARRIER	41 - OTHER POST, POLE OR SUPPORT	47 - MAILBOX	54 - OTHER FIXED OBJECT
30 - GUARDRAIL FACE	36 - MEDIUM OTHER BARRIER	42 - CULVERT	48 - TREE	99 - OTHER / UNKNOWN
			49 - FIRE HYDRANT	

UNIT SPEED 1 0

POSTED SPEED 2 5

DETECTED SPEED
 1 - STATED / ESTIMATED SPEED
 2 - CALCULATED / EDR
 3 - UNDETERMINED



MOTORIST / Non-MOTORIST

LOCAL REPORT NUMBER
2 2 0 8 5 6 5 2

UNIT # 0 1	NAME: LAST, FIRST, MIDDLE SCHEHL, MARY KATHERINE	DATE OF BIRTH 0 8 1 6 1 9 7 4	AGE 4 8	GENDER F
---------------	---	----------------------------------	------------	-------------

ADDRESS: STREET, CITY, STATE, ZIP 10148 ARBORWOOD DR, CINCINNATI, OH 45251	CONTACT PHONE - INCLUDE AREA CODE
---	-----------------------------------

INJURIES 5	INJURED TAKEN BY	EMS AGENCY (NAME)	INJURED TAKEN TO: MEDICAL FACILITY (NAME, CITY)	SAFETY EQUIPMENT USED 0 4	<input type="checkbox"/> DOT-COMPLIANT MC HELMET	SEATING POSITION 0 1	AIR BAG USAGE 1	EJECTION 1	TRAPPED 1
---------------	------------------	-------------------	---	------------------------------	--	-------------------------	--------------------	---------------	--------------

OL STATE OH	OPERATOR LICENSE NUMBER	OFFENSE CHARGED	LOCAL CODE <input type="checkbox"/>	OFFENSE DESCRIPTION	CITATION NUMBER
----------------	-------------------------	-----------------	--	---------------------	-----------------

OL CLASS 4	ENDORSEMENT SELECT UP TO 2	RESTRICTION SELECT UP TO 3	DRIVER DISTRACTED BY 1	ALCOHOL / DRUG SUSPECTED <input type="checkbox"/> ALCOHOL <input type="checkbox"/> MARIJUANA <input type="checkbox"/> OTHER DRUG	CONDITION 1	ALCOHOL TEST STATUS TYPE VALUE			DRUG TEST(S) STATUS TYPE RESULT SELECT UP TO 4		
---------------	----------------------------	----------------------------	---------------------------	--	----------------	-----------------------------------	--	--	---	--	--

UNIT # 0 2	NAME: LAST, FIRST, MIDDLE LOWE, STEPHENEY EVONNE	DATE OF BIRTH 1 0 1 7 1 9 8 2	AGE 4 0	GENDER F
---------------	---	----------------------------------	------------	-------------

ADDRESS: STREET, CITY, STATE, ZIP 5 BRITTANY LN, FAIRFIELD, OH 45014	CONTACT PHONE - INCLUDE AREA CODE
---	-----------------------------------

INJURIES 5	INJURED TAKEN BY	EMS AGENCY (NAME)	INJURED TAKEN TO: MEDICAL FACILITY (NAME, CITY)	SAFETY EQUIPMENT USED 0 4	<input type="checkbox"/> DOT-COMPLIANT MC HELMET	SEATING POSITION 0 1	AIR BAG USAGE 1	EJECTION 1	TRAPPED 1
---------------	------------------	-------------------	---	------------------------------	--	-------------------------	--------------------	---------------	--------------

OL STATE OH	OPERATOR LICENSE NUMBER	OFFENSE CHARGED	LOCAL CODE <input type="checkbox"/>	OFFENSE DESCRIPTION	CITATION NUMBER
----------------	-------------------------	-----------------	--	---------------------	-----------------

OL CLASS 4	ENDORSEMENT SELECT UP TO 2	RESTRICTION SELECT UP TO 3	DRIVER DISTRACTED BY 1	ALCOHOL / DRUG SUSPECTED <input type="checkbox"/> ALCOHOL <input type="checkbox"/> MARIJUANA <input type="checkbox"/> OTHER DRUG	CONDITION 1	ALCOHOL TEST STATUS TYPE VALUE			DRUG TEST(S) STATUS TYPE RESULT SELECT UP TO 4		
---------------	----------------------------	----------------------------	---------------------------	--	----------------	-----------------------------------	--	--	---	--	--

UNIT #	NAME: LAST, FIRST, MIDDLE	DATE OF BIRTH	AGE 0	GENDER
--------	---------------------------	---------------	----------	--------

ADDRESS: STREET, CITY, STATE, ZIP	CONTACT PHONE - INCLUDE AREA CODE
-----------------------------------	-----------------------------------

INJURIES	INJURED TAKEN BY	EMS AGENCY (NAME)	INJURED TAKEN TO: MEDICAL FACILITY (NAME, CITY)	SAFETY EQUIPMENT USED	<input type="checkbox"/> DOT-COMPLIANT MC HELMET	SEATING POSITION	AIR BAG USAGE	EJECTION	TRAPPED
----------	------------------	-------------------	---	-----------------------	--	------------------	---------------	----------	---------

OL STATE	OPERATOR LICENSE NUMBER	OFFENSE CHARGED	LOCAL CODE <input type="checkbox"/>	OFFENSE DESCRIPTION	CITATION NUMBER
----------	-------------------------	-----------------	--	---------------------	-----------------

OL CLASS	ENDORSEMENT SELECT UP TO 2	RESTRICTION SELECT UP TO 3	DRIVER DISTRACTED BY	ALCOHOL / DRUG SUSPECTED <input type="checkbox"/> ALCOHOL <input type="checkbox"/> MARIJUANA <input type="checkbox"/> OTHER DRUG	CONDITION	ALCOHOL TEST STATUS TYPE VALUE			DRUG TEST(S) STATUS TYPE RESULT SELECT UP TO 4		
----------	----------------------------	----------------------------	----------------------	--	-----------	-----------------------------------	--	--	---	--	--

INJURIES	SEATING POSITION	AIR BAG	OL CLASS	OL RESTRICTION(S)	DRIVER DISTRACTION	TEST STATUS
1- FATAL 2- SUSPECTED SERIOUS INJURY 3- SUSPECTED MINOR INJURY 4- POSSIBLE INJURY 5- NO APPARENT INJURY	1- FRONT - LEFT SIDE (MOTORCYCLE DRIVER) 2- FRONT - MIDDLE 3- FRONT - RIGHT SIDE 4- SECOND - LEFT SIDE (MOTORCYCLE PASSENGER) 5- SECOND - MIDDLE 6- SECOND - RIGHT SIDE 7- THIRD - LEFT SIDE (MOTORCYCLE SIDE CAR) 8- THIRD - MIDDLE 9- THIRD - RIGHT SIDE 10- SLEEPER SECTION OF TRUCK CAB	1- NOT DEPLOYED 2- DEPLOYED FRONT 3- DEPLOYED SIDE 4- DEPLOYED BOTH FRONT / SIDE 5- NOT APPLICABLE 9- DEPLOYMENT UNKNOWN	1- CLASS A 2- CLASS B 3- CLASS C 4- REGULAR CLASS (OHIO = D) 5- MC MOPED ONLY 6- NO VALID OL	1- ALCOHOL INTERLOCK DEVICE 2- CDL INTRASTATE ONLY 3- CORRECTIVE LENSES 4- FARM WAIVER 5- EXCEPT CLASS A BUS 6- EXCEPT CLASS A & CLASS B BUS 7- EXCEPT TRACTOR-TRAILER 8- INTERMEDIATE LICENSE RESTRICTIONS 9- LEARNER'S PERMIT RESTRICTIONS 10- LIMITED TO DAYLIGHT ONLY 11- LIMITED TO EMPLOYMENT 12- LIMITED - OTHER 13- MECHANICAL DEVICES (SPECIAL BRAKES, HAND CONTROLS, OR OTHER ADAPTIVE DEVICES) 14- MILITARY VEHICLES ONLY 15- MOTOR VEHICLES WITHOUT AIR BRAKES 16- OUTSIDE MIRROR 17- PROSTHETIC AID 18- OTHER	1- NOT DISTRACTED 2- MANUALLY OPERATING AN ELECTRONIC COMMUNICATION DEVICE (TEXTING, TYPING, DIALING) 3- TALKING ON HANDS-FREE COMMUNICATION DEVICE 4- TALKING ON HAND-HELD COMMUNICATION DEVICE 5- OTHER ACTIVITY WITH AN ELECTRONIC DEVICE 6- PASSENGER 7- OTHER DISTRACTION INSIDE THE VEHICLE 8- OTHER DISTRACTION OUTSIDE THE VEHICLE 9- OTHER / UNKNOWN	1- NONE GIVEN 2- TEST REFUSED 3- TEST GIVEN, CONTAMINATED SAMPLE / UNUSABLE 4- TEST GIVEN, RESULTS KNOWN 5- TEST GIVEN, RESULTS UNKNOWN
INJURED TAKEN BY	EJECTION	OL ENDORSEMENT	TRAPPED	CONDITION	DRUG TEST TYPE	ALCOHOL TEST TYPE
1- NOT TRANSPORTED / TREATED AT SCENE 2- EMS 3- POLICE 9- OTHER / UNKNOWN	1- NOT EJECTED 2- PARTIALLY EJECTED 3- TOTALLY EJECTED 4- NOT APPLICABLE	H- HAZMAT M- MOTORCYCLE P- PASSENGER N- TANKER O- MOTOR SCOOTER R- THREE-WHEEL MOTORCYCLE S- SCHOOL BUS T- DOUBLE & TRIPLE TRAILERS X- TANKER / HAZMAT	1- NOT TRAPPED 2- EXTRICATED BY MECHANICAL MEANS 3- FREED BY NON-MECHANICAL MEANS	1- APPARENTLY NORMAL 2- PHYSICAL IMPAIRMENT 3- EMOTIONAL (E.G. DEPRESSED, ANGRY, DISTURBED) 4- ILLNESS 5- FELL ASLEEP, FAINTED, FATIGUED, ETC. 6- UNDER THE INFLUENCE OF MEDICATIONS / DRUGS / ALCOHOL 9- OTHER / UNKNOWN	1- NONE 2- BLOOD 3- URINE 4- BREATH 5- OTHER	1- NONE 2- BLOOD 3- URINE 4- BREATH 5- OTHER
SAFETY EQUIPMENT	TRAPPED	CONDITION	DRUG TEST TYPE	DRUG TEST RESULT(S)		
1- NONE USED 2- SHOULDER BELT ONLY USED 3- LAP BELT ONLY USED 4- SHOULDER & LAP BELT USED 5- CHILD RESTRAINT SYSTEM - FORWARD FACING 6- CHILD RESTRAINT SYSTEM - REAR FACING 7- BOOSTER SEAT 8- HELMET USED 9- PROTECTIVE PADS USED (ELBOW, KNEES, ETC.) 10- REFLECTIVE CLOTHING 11- LIGHTING - PEDESTRIAN / BICYCLE ONLY 99- OTHER / UNKNOWN	1- NOT TRAPPED 2- EXTRICATED BY MECHANICAL MEANS 3- FREED BY NON-MECHANICAL MEANS	1- APPARENTLY NORMAL 2- PHYSICAL IMPAIRMENT 3- EMOTIONAL (E.G. DEPRESSED, ANGRY, DISTURBED) 4- ILLNESS 5- FELL ASLEEP, FAINTED, FATIGUED, ETC. 6- UNDER THE INFLUENCE OF MEDICATIONS / DRUGS / ALCOHOL 9- OTHER / UNKNOWN	1- NONE 2- BLOOD 3- URINE 4- BREATH 5- OTHER	1- AMPHETAMINES 2- BARBITURATES 3- BENZODIAZEPINES 4- CANNABINOIDS 5- COCAINE 6- OPIATES / OPIOIDS 7- OTHER 8- NEGATIVE RESULTS		



OCCUPANT / WITNESS ADDENDUM

LOCAL REPORT NUMBER
2 2 0 8 5 6 5 2

OCCUPANT	UNIT # 2	NAME: LAST, FIRST, MIDDLE JOHNSON, TEA 'SHAI	DATE OF BIRTH 1 1 0 4 2 0 0 3	AGE 1 9	GENDER F
	ADDRESS: STREET, CITY, STATE, ZIP 5 BRITTANY LN, FAIRFIELD, OH 45014			CONTACT PHONE - INCLUDE AREA CODE	

INJURIES 5	INJURED TAKEN BY	EMS AGENCY (NAME)	INJURED TAKEN TO: MEDICAL FACILITY (NAME, CITY)	SAFETY EQUIPMENT USED 0 4	<input type="checkbox"/> DOT-COMPLIANT MC HELMET	SEATING POSITION 0 3	AIR BAG USAGE 0 1	EJECTION 1	TRAPPED 1
---------------	------------------	-------------------	---	------------------------------	--	-------------------------	----------------------	---------------	--------------

OCCUPANT	UNIT #	NAME: LAST, FIRST, MIDDLE	DATE OF BIRTH	AGE 0	GENDER
	ADDRESS: STREET, CITY, STATE, ZIP			CONTACT PHONE - INCLUDE AREA CODE	

INJURIES	INJURED TAKEN BY	EMS AGENCY (NAME)	INJURED TAKEN TO: MEDICAL FACILITY (NAME, CITY)	SAFETY EQUIPMENT USED	<input type="checkbox"/> DOT-COMPLIANT MC HELMET	SEATING POSITION	AIR BAG USAGE	EJECTION	TRAPPED
----------	------------------	-------------------	---	-----------------------	--	------------------	---------------	----------	---------

OCCUPANT	UNIT #	NAME: LAST, FIRST, MIDDLE	DATE OF BIRTH	AGE 0	GENDER
	ADDRESS: STREET, CITY, STATE, ZIP			CONTACT PHONE - INCLUDE AREA CODE	

INJURIES	INJURED TAKEN BY	EMS AGENCY (NAME)	INJURED TAKEN TO: MEDICAL FACILITY (NAME, CITY)	SAFETY EQUIPMENT USED	<input type="checkbox"/> DOT-COMPLIANT MC HELMET	SEATING POSITION	AIR BAG USAGE	EJECTION	TRAPPED
----------	------------------	-------------------	---	-----------------------	--	------------------	---------------	----------	---------

OCCUPANT	UNIT #	NAME: LAST, FIRST, MIDDLE	DATE OF BIRTH	AGE 0	GENDER
	ADDRESS: STREET, CITY, STATE, ZIP			CONTACT PHONE - INCLUDE AREA CODE	

INJURIES	INJURED TAKEN BY	EMS AGENCY (NAME)	INJURED TAKEN TO: MEDICAL FACILITY (NAME, CITY)	SAFETY EQUIPMENT USED	<input type="checkbox"/> DOT-COMPLIANT MC HELMET	SEATING POSITION	AIR BAG USAGE	EJECTION	TRAPPED
----------	------------------	-------------------	---	-----------------------	--	------------------	---------------	----------	---------

INJURIES	SAFETY EQUIPMENT USED	SEATING POSITION	AIR BAG USAGE
1 - FATAL	1 - NONE USED - VEHICLE OCCUPANT	1 - FRONT - LEFT SIDE (MOTORCYCLE DRIVER)	1 - NOT DEPLOYED
2 - SUSPECTED SERIOUS INJURY	2 - SHOULDER BELT ONLY USED	2 - FRONT - MIDDLE	2 - DEPLOYED FRONT
3 - SUSPECTED MINOR INJURY	3 - LAP BELT ONLY USED	3 - FRONT - RIGHT SIDE	3 - DEPLOYED SIDE
4 - POSSIBLE INJURY	4 - SHOULDER & LAP BELT USED	4 - SECOND - LEFT SIDE (MOTORCYCLE PASSENGER)	4 - DEPLOYED BOTH FRONT/SIDE
5 - NO APPARENT INJURY	5 - CHILD RESTRAINT SYSTEM - FORWARD FACING	5 - SECOND - MIDDLE	5 - NOT APPLICABLE
	6 - CHILD RESTRAINT SYSTEM - REAR FACING	6 - SECOND - RIGHT SIDE	9 - DEPLOYMENT UNKNOWN
	7 - BOOSTER SEAT	7 - THIRD - LEFT SIDE (MOTORCYCLE SIDE CAR)	
	8 - HELMET USED	8 - THIRD - MIDDLE	
	9 - PROTECTIVE PADS USED (ELBOW, KNEES, ETC.)	9 - THIRD - RIGHT SIDE	
	10 - REFLECTIVE CLOTHING	10 - SLEEPER SECTION OF TRUCK CAB	
	11 - LIGHTING - PEDESTRIAN / BICYCLE ONLY	11 - PASSENGER IN OTHER ENCLOSED CARGO AREA (NON-TRAILING UNIT, BUS, PICK-UP WITH CAP)	
	99 - OTHER / UNKNOWN	12 - PASSENGER IN UNENCLOSED CARGO AREA	
		13 - TRAILING UNIT	
		14 - RIDING ON VEHICLE EXTERIOR (NON-TRAILING UNIT)	
		15 - NON-MOTORIST	
		99 - OTHER / UNKNOWN	

WITNESS	NAME: LAST, FIRST, MIDDLE	DATE OF BIRTH	AGE 0	GENDER
	ADDRESS: STREET, CITY, STATE, ZIP	CONTACT PHONE - INCLUDE AREA CODE		

WITNESS	NAME: LAST, FIRST, MIDDLE	DATE OF BIRTH	AGE 0	GENDER
	ADDRESS: STREET, CITY, STATE, ZIP	CONTACT PHONE - INCLUDE AREA CODE		

WITNESS	NAME: LAST, FIRST, MIDDLE	DATE OF BIRTH	AGE 0	GENDER
	ADDRESS: STREET, CITY, STATE, ZIP	CONTACT PHONE - INCLUDE AREA CODE		