



# TRAFFIC CRASH REPORT

\*DENOTES MANDATORY FIELD FOR SUPPLEMENT REPORT

LOCAL REPORT NUMBER\*

<input type="checkbox"/> PHOTOS TAKEN	<input checked="" type="checkbox"/> OH-2	<input type="checkbox"/> OH-3	LOCAL INFORMATION	2 2 0 8 7 2 4 5		
<input type="checkbox"/> SECONDARY CRASH	<input type="checkbox"/> OH-1P	<input type="checkbox"/> OTHER	REPORTING AGENCY NAME*	NGIC*	HIT/SKIP	NUMBER OF UNITS
<input type="checkbox"/> PRIVATE PROPERTY			Fairfield Police Department	0,0,9,0,1	1 - SOLVED	0,1
					2 - UNSOLVED	0,1

COUNTY*	LOCALITY*	LOCATION: CITY, VILLAGE, TOWNSHIP*	CRASH DATE / TIME*	CRASH SEVERITY
09	1	City of Fairfield	11302022 0537	5

ROUTE TYPE	ROUTE NUMBER	PREFIX	1 - NORTH 2 - SOUTH 3 - EAST 4 - WEST	LOCATION ROAD NAME	ROAD TYPE	LATITUDE DECIMAL DEGREES	CRASH SEVERITY 1 - FATAL 2 - SERIOUS INJURY SUSPECTED 3 - MINOR INJURY SUSPECTED 4 - INJURY POSSIBLE 5 - PROPERTY DAMAGE ONLY
				River	R D	39.36168	
ROUTE TYPE	ROUTE NUMBER	PREFIX	1 - NORTH 2 - SOUTH 3 - EAST 4 - WEST	REFERENCE ROAD NAME (ROAD, MILEPOST, HOUSE #)	ROAD TYPE	LONGITUDE DECIMAL DEGREES	
				3532		-84.56199	

REFERENCE POINT	DIRECTION FROM REFERENCE	ROUTE TYPE	ROAD TYPE	INTERSECTION RELATED
3	1 - NORTH 2 - SOUTH 3 - EAST 4 - WEST	IR - INTERSTATE ROUTE (I/P)	AL - ALLEY HW - HIGHWAY RD - ROAD	<input type="checkbox"/> WITHIN INTERSECTION OR ON APPROACH
DISTANCE FROM REFERENCE	DISTANCE UNIT OF MEASURE	US - FEDERAL US ROUTE	AV - AVENUE LA - LANE SQ - SQUARE	<input type="checkbox"/> WITHIN INTERCHANGE AREA
	1 - MILES 2 - FEET 3 - YARDS	SR - STATE ROUTE	BL - BOULEVARD MP - MILEPOST ST - STREET	NUMBER OF APPROACHES
		CR - NUMBERED COUNTY ROUTE	CR - CIRCLE OV - OVAL TE - TERRACE	ROADWAY
		TR - NUMBERED TOWNSHIP ROUTE	CT - COURT PK - PARKWAY TL - TRAIL	<input type="checkbox"/> ROADWAY DIVIDED
			DR - DRIVE PI - PIKE WA - WAY	
			HE - HEIGHTS PL - PLACE	

LOCATION OF FIRST HARMFUL EVENT	MANNER OF CRASH COLLISION/IMPACT	DIRECTION OF TRAVEL	MEDIAN TYPE
0,1	1 - NOT COLLISION BETWEEN TWO MOTOR VEHICLES IN TRANSPORT 2 - REAR-END 3 - HEAD-ON	1 - NORTH 1	1 - DIVIDED FLUSH MEDIAN (<4 FEET) 2 - DIVIDED FLUSH MEDIAN (≥4 FEET) 3 - DIVIDED, DEPRESSED MEDIAN 4 - DIVIDED, RAISED MEDIAN (ANY TYPE) 9 - OTHER/UNKNOWN
9 - CROSSOVER 10 - DRIVEWAY/ALLEY ACCESS 11 - RAILWAY GRADE CROSSING 12 - SHARED USE PATHS OR TRAILS 13 - BIKE LANE 14 - TOLL BOOTH 99 - OTHER / UNKNOWN	4 - REAR-TO-REAR 5 - BACKING 6 - ANGLE 7 - SIDESWIPE, SAME DIRECTION 8 - SIDESWIPE, OPPOSITE DIRECTION 9 - OTHER / UNKNOWN	2 - SOUTH 3 - EAST 4 - WEST	

<input type="checkbox"/> WORK ZONE RELATED	WORK ZONE TYPE	LOCATION OF CRASH IN WORK ZONE	CONTOUR	CONDITIONS	SURFACE
<input type="checkbox"/> WORKERS PRESENT	1 - LANE CLOSURE 2 - LANE SHIFT/CROSSOVER 3 - WORK ON SHOULDER OR MEDIAN 4 - INTERMITTENT OR MOVING WORK 5 - OTHER	1 - BEFORE THE 1ST WORK ZONE WARNING SIGN 2 - ADVANCE WARNING AREA 3 - TRANSITION AREA 4 - ACTIVITY AREA 5 - TERMINATION AREA	1	2	2
<input type="checkbox"/> LAW ENFORCEMENT PRESENT			1 - STRAIGHT LEVEL 2 - STRAIGHT GRADE 3 - CURVE LEVEL 4 - CURVE GRADE 9 - OTHER/UNKNOWN	1 - DRY 2 - WET 3 - SNOW 4 - ICE 5 - SAND, MUD, DIRT, OIL, GRAVEL 6 - WATER (STANDING, MOVING) 7 - SLUSH 9 - OTHER/UNKNOWN	1 - CONCRETE 2 - BLACKTOP, BITUMINOUS, ASPHALT 3 - BRICK/BLOCK 4 - SLAG, GRAVEL, STONE 5 - DIRT 9 - OTHER/UNKNOWN
<input type="checkbox"/> ACTIVE SCHOOL ZONE					

LIGHT CONDITION	WEATHER
3	0,9
1 - DAYLIGHT 2 - DAWN/DUSK 3 - DARK - LIGHTED ROADWAY 4 - DARK - ROADWAY NOT LIGHTED 5 - DARK - UNKNOWN ROADWAY LIGHTING 9 - OTHER / UNKNOWN	1 - CLEAR 2 - CLOUDY 3 - FOG, SMOG, SMOKE 4 - RAIN 5 - SLEET, HAIL 6 - SNOW 7 - SEVERE CROSSWINDS 8 - BLOWING SAND, SOIL, DIRT, SNOW 9 - FREEZING RAIN OR FREEZING DRIZZLE 99 - OTHER / UNKNOWN

NARRATIVE	Indicate the north direction with an "N" on the compass diagram.
On 11-30-22 at about 5:37 A.M., Unit 1 was northbound on River Rd. when he spun out due to the surface of the road being wet and slick. Unit 1 spun across the southbound lane and over a sharp embankment causing it to flip over onto its roof. Road conditions were wet, with temperatures near freezing.	SEE - OH 2

CRASH REPORTED DATE / TIME	DISPATCH DATE / TIME	ARRIVAL DATE / TIME	SCENE CLEARED DATE / TIME	REPORT TAKEN BY
11302022 0537	11302022 0539	11302022 0612	11302022 0638	<input checked="" type="checkbox"/> POLICE AGENCY <input type="checkbox"/> MOTORIST
TOTAL TIME ROADWAY CLOSED	OTHER INVESTIGATION TIME	TOTAL MINUTES	OFFICER'S NAME*	CHECKED BY OFFICER'S NAME*
0	0 3 0	0 8 9	PO Greg Bailes	<i>[Signature]</i>
			OFFICER'S BADGE NUMBER*	CHECKED BY OFFICER'S BADGE NUMBER*
			1 2 2	4

**OWNER**

UNIT # 01 OWNER NAME: LAST, FIRST, MIDDLE (X SAME AS DRIVER)  
 Weekley, Brandon  
 OWNER ADDRESS: STREET, CITY, STATE, ZIP (X SAME AS DRIVER)  
 894 Wesleyan Dr. Fairfield, OH. 45014  
 COMMERCIAL CARRIER: NAME, ADDRESS, CITY, STATE, ZIP  
 OWNER PHONE: (INCLUDE AREA CODE) (X SAME AS DRIVER)  
 LE

**DAMAGE**

DAMAGE SCALE  
 4 1 - NONE 3 - FUNCTIONAL DAMAGE  
 2 - MINOR DAMAGE 4 - DISABLING DAMAGE  
 9 - UNKNOWN

**VEHICLE**

LP STATE OH LICENSE PLATE # HSB8251 VEHICLE IDENTIFICATION # 1F1A1P42T6R1F208634 VEHICLE YEAR 1994 VEHICLE MAKE Ford  
 INSURANCE VERIFIED INSURANCE COMPANY Progressive INSURANCE POLICY # 929568620 COLOR Blue VEHICLE MODEL Mustang  
 COMMERCIAL  GOVERNMENT  IN EMERGENCY RESPONSE  
 INTERLOCK DEVICE EQUIPPED  HIT/SKIP UNIT #OCCUPANTS 01 VEHICLE WEIGHT GVWR/GCWR  
 1 - <10K LBS.  
 2 - 10,001 - 26K LBS.  
 3 - >26K LBS.  
 TOWED BY: COMPANY NAME Fow Towing  
 HAZARDOUS MATERIAL CLASS # PLACARD ID #

**DAMAGED AREA(S)**  
 INDICATE ALL THAT APPLY

NO DAMAGE [0]  UNDERCARRIAGE [14]  
 TOP [13]  ALL AREAS [15]  
 UNIT NOT AT SCENE [16]

UNIT TYPE 01  
 1 - PASSENGER CAR 7 - MOTORCYCLE 2-WHEELED 12 - GOLF CART 18 - LIMO (LIVERY VEHICLE) 23 - PEDESTRIAN / SKATER  
 2 - PASSENGER VAN (MINIVAN) 8 - MOTORCYCLE 3-WHEELED 13 - SNOWMOBILE 19 - BUS (16+ PASSENGERS) 24 - WHEELCHAIR (ANY TYPE)  
 3 - SPORT UTILITY VEHICLE 9 - AUTOCYCLE 14 - SINGLE UNIT TRUCK 20 - OTHER VEHICLE 25 - OTHER NON-MOTORIST  
 4 - PICK UP 10 - MOPED OR MOTORIZED BICYCLE 15 - SEMI-TRACTOR 21 - HEAVY EQUIPMENT 26 - BICYCLE  
 5 - CARGOVAN 11 - ALL TERRAIN VEHICLE (ATV / UTV) 16 - FARM EQUIPMENT 22 - ANIMAL WITH RIDER OR ANIMAL-DRAWN VEHICLE 27 - TRAIN  
 6 - VAN (9-15 SEATS) 17 - MOTORHOME 99 - UNKNOWN OR HIT/SKIP  
 # OF TRAILING UNITS

WAS VEHICLE OPERATING IN AUTONOMOUS MODE WHEN CRASH OCCURRED?  
2 1-YES 2-NO 9-OTHER/UNKNOWN AUTONOMOUS MODE LEVEL  
 0 - NO AUTOMATION 3 - CONDITIONAL AUTOMATION 9 - UNKNOWN  
 1 - DRIVER ASSISTANCE 4 - HIGH AUTOMATION  
 2 - PARTIAL AUTOMATION 5 - FULL AUTOMATION

SPECIAL FUNCTION 01  
 1 - NONE 6 - BUS - CHARTER/TOUR 11 - FIRE 16 - FARM 21 - MAIL CARRIER  
 2 - TAXI 7 - BUS - INTERCITY 12 - MILITARY 17 - MOWING 99 - OTHER / UNKNOWN  
 3 - ELECTRONIC RIDESHARING 8 - BUS - SHUTTLE 13 - POLICE 18 - SNOW REMOVAL  
 4 - SCHOOL TRANSPORT 9 - BUS - OTHER 14 - PUBLIC UTILITY 19 - TOWING  
 5 - BUS - TRANSIT/COMMUTER 10 - AMBULANCE 15 - CONSTRUCTION EQUIPMENT 20 - SAFETY SERVICE PATROL

CARGO BODY TYPE 01  
 1 - NO CARGO BODY TYPE / NOT APPLICABLE 3 - VEHICLE TOWING ANOTHER MOTOR VEHICLE 5 - INTERMODAL CONTAINER CHASSIS 8 - POLE 12 - CONCRETE MIXER  
 2 - BUS 4 - LOGGING 6 - CARGO VAN/ENCLOSED BOX 9 - CARGO TANK 13 - AUTO TRANSPORTER  
 7 - GRAIN/CHIPS/GRAVEL 10 - FLAT BED 11 - DUMP 14 - GARBAGE/REFUSE 99 - OTHER / UNKNOWN

VEHICLE DEFECTS  
 1 - TURN SIGNALS 4 - BRAKES 7 - WORN OR SLICK TIRES 9 - MOTOR TROUBLE 99 - OTHER / UNKNOWN  
 2 - HEAD LAMPS 5 - STEERING 8 - TRAILER EQUIPMENT DEFECTIVE 10 - DISABLED FROM PRIOR ACCIDENT  
 3 - TAIL LAMPS 6 - TIRE BLOWOUT

NON-MOTORIST LOCATION AT IMPACT  
 1 - INTERSECTION - MARKED CROSSWALK 3 - INTERSECTION - OTHER 6 - BICYCLE LANE 9 - MEDIAN/CROSSING ISLAND 12 - FIRST RESPONDER AT INCIDENT SCENE  
 2 - INTERSECTION - UNMARKED CROSSWALK 4 - MIDBLOCK - MARKED CROSSWALK 7 - SHOULDER / ROADSIDE 10 - DRIVEWAY ACCESS 13 - SHARED USE PATHS OR TRAILS 99 - OTHER / UNKNOWN  
 5 - TRAVEL LANE - OTHER LOCATION 8 - SIDEWALK 11 - OTHER / UNKNOWN

ACTION 1 PRE-CRASH ACTIONS 01  
 1 - NON-CONTACT 1 - STRAIGHT AHEAD 7 - MAKING U-TURN 13 - NEGOTIATING A CURVE 18 - APPROACHING OR LEAVING VEHICLE  
 2 - NON-COLLISION 2 - BACKING 8 - ENTERING OR CROSSING SPECIFIED LOCATION 14 - ENTERING OR CROSSING SPECIFIED LOCATION 19 - STANDING  
 3 - STRIKING 3 - CHANGING LANES 9 - LEAVING TRAFFIC LANE 15 - WALKING, RUNNING, JOGGING, PLAYING 20 - OTHER NON-MOTORIST  
 4 - STRUCK 4 - OVERTAKING/PASSING 10 - PARKED 16 - WORKING 21 - STANDING OUTSIDE DISABLED VEHICLE  
 5 - BOTH STRIKING & STRUCK 5 - MAKING RIGHT TURN 11 - SLOWING OR STOPPED IN TRAFFIC 17 - PUSHING VEHICLE 99 - OTHER / UNKNOWN  
 9 - OTHER / UNKNOWN 6 - MAKING LEFT TURN 12 - DRIVERLESS 22 - WORK ZONE MAINTENANCE EQUIPMENT

INITIAL POINT OF CONTACT  
03 0 - NO DAMAGE 14 - UNDERCARRIAGE  
 1-12 - REFER TO UNIT DIAGRAM 15 - VEHICLE NOT AT SCENE  
 13 - TOP 99 - UNKNOWN

CONTROLLING CIRCUMSTANCES 99  
 1 - NONE 7 - LEFT OF CENTER 13 - IMPROPER START FROM A PARKED POSITION 17 - VISION OBSTRUCTION 21 - LYING IN ROADWAY  
 2 - FAILURE TO YIELD 8 - FOLLOWING TOO CLOSE / ACDA 14 - ENTERING DEFECTIVE EQUIPMENT 18 - OPERATING DEFECTIVE EQUIPMENT 22 - NOT DISCERNIBLE  
 3 - RAN RED LIGHT 9 - IMPROPER LANE CHANGE 15 - STOPPED OR PARKED ILLEGALLY 19 - LOAD SHIFTING/FALLING/SPILLING 23 - OPENING DOOR INTO ROADWAY  
 4 - RAN STOP SIGN 10 - IMPROPER PASSING 16 - SWERVING TO AVOID 20 - IMPROPER CROSSING 99 - OTHER IMPROPER ACTION  
 5 - UNSAFE SPEED 11 - DROVE OFF ROAD 17 - WRONG WAY  
 6 - IMPROPER TURN 12 - IMPROPER BACKING

**TRAFFIC**

TRAFFICWAY FLOW  
2 1 - ONE-WAY  
2 2 - TWO-WAY

TRAFFIC CONTROL  
6 1 - ROUNDABOUT 4 - STOP SIGN  
 2 - SIGNAL 5 - YIELD SIGN  
 3 - FLASHER 6 - NO CONTROL

**EVENT(S)**

SEQUENCE OF EVENTS  
 1 1, 1  
 21 0, 9  
 31 4, 8  
 4 1  
 5 1  
 6 1  
 2 1 FIRST HARMFUL EVENT 3 1 MOST HARMFUL EVENT

**NON-COLLISION**  
 1 - OVERTURN/ROLLOVER 6 - EQUIPMENT FAILURE 11 - CROSS CENTERLINE - OPPOSITE DIRECTION OF TRAVEL 16 - RAILWAY VEHICLE 22 - WORK ZONE MAINTENANCE EQUIPMENT  
 2 - FIRE/EXPLOSION 7 - SEPARATION OF UNITS 12 - DOWNHILL RUNAWAY 17 - ANIMAL - FARM 23 - STRUCK BY FALLING, SHIFTING CARGO OR ANYTHING SET IN MOTION BY A MOTOR VEHICLE  
 3 - IMMERSION 8 - RAN OFF ROAD RIGHT 13 - OTHER NON-COLLISION 18 - ANIMAL - OTHER 24 - OTHER MOVABLE OBJECT  
 4 - JACKKNIFE 9 - RAN OFF ROAD LEFT 14 - PEDESTRIAN 19 - MOTOR VEHICLE IN TRANSPORT  
 5 - CARGO / EQUIPMENT LOSS OR SHIFT 10 - CROSS MEDIAN 15 - PEDALCYCLE 20 - PARKED MOTOR VEHICLE  
 25 - IMPACT ATTENUATOR / CRASH CUSHION 31 - GUARDRAIL END 37 - TRAFFIC SIGN POST 43 - CURB 50 - WORK ZONE MAINTENANCE EQUIPMENT  
 26 - BRIDGE OVERHEAD STRUCTURE 32 - PORTABLE BARRIER 38 - OVERHEAD SIGN POST 44 - DITCH 51 - WALL  
 27 - BRIDGE PIER OR ABUTMENT 33 - MEDIAN CABLE BARRIER 39 - LIGHT / LUMINARIES SUPPORT 45 - EMBANKMENT 52 - BUILDING  
 28 - BRIDGE PARAPET 34 - MEDIAN GUARDRAIL BARRIER 40 - UTILITY POLE 46 - FENCE 53 - TUNNEL  
 29 - BRIDGE RAIL 35 - MEDIAN CONCRETE BARRIER 41 - OTHER POST, POLE OR SUPPORT 47 - MAILBOX 54 - OTHER FIXED OBJECT  
 30 - GUARDRAIL FACE 36 - MEDIAN OTHER BARRIER 42 - CULVERT 48 - TREE 99 - OTHER / UNKNOWN

# OF THROUGH LANES ON ROAD 2

RAIL GRADE CROSSING 1  
 1 - NOT INVOLVED  
 2 - INVOLVED-ACTIVE CROSSING  
 3 - INVOLVED-PASSIVE CROSSING

UNIT / NON-MOTORIST DIRECTION  
 FROM 2 TO 1  
 1 - NORTH 5 - NORTHEAST  
 2 - SOUTH 6 - NORTHWEST  
 3 - EAST 7 - SOUTHEAST  
 4 - WEST 8 - SOUTHWEST  
 9 - OTHER / UNKNOWN

UNIT SPEED 035

DETECTED SPEED 1  
 1 - STATED / ESTIMATED SPEED  
 2 - CALCULATED / EDR  
 3 - UNDETERMINED

POSTED SPEED 35



# MOTORIST / Non-MOTORIST

LOCAL REPORT NUMBER  
2 2 0 8 7 2 4 5

<b>UNIT #</b> 0 1	<b>NAME: LAST, FIRST, MIDDLE</b> Weekley, Brandon		<b>DATE OF BIRTH</b> 1 2 2 9 1 9 9 3		<b>AGE</b> 2 8	<b>GENDER</b> M				
<b>ADDRESS: STREET, CITY, STATE, ZIP</b> 894 Wesleyan Dr. Fairfield, OH. 45014				<b>CONTACT PHONE - INCLUDE AREA CODE</b>						
<b>INJURIES</b> 5	<b>INJURED TAKEN BY</b>	<b>EMS AGENCY (NAME)</b>	<b>INJURED TAKEN TO: MEDICAL FACILITY (NAME, CITY)</b>	<b>SAFETY EQUIPMENT USED</b> 0 4	<input type="checkbox"/> DOT-COMPLIANT MC HELMET	<b>SEATING POSITION</b> 0 1	<b>AIR BAG USAGE</b> 1	<b>EJECTION</b> 1	<b>TRAPPED</b> 1	
<b>OL STATE</b> OH	<b>OPERATOR LICENSE NUMBER</b>		<b>OFFENSE CHARGED</b>	<b>LOCAL CODE</b> <input type="checkbox"/>	<b>OFFENSE DESCRIPTION</b>		<b>CITATION NUMBER</b>			
<b>OL CLASS</b> 4	<b>ENDORSEMENT SELECT UP TO 2</b>	<b>RESTRICTION SELECT UP TO 3</b>	<b>DRIVER DISTRACTED BY</b> 1	<b>ALCOHOL / DRUG SUSPECTED</b> <input type="checkbox"/> ALCOHOL <input type="checkbox"/> MARIJUANA <input type="checkbox"/> OTHER DRUG		<b>CONDITION</b> 1	<b>ALCOHOL TEST</b>		<b>DRUG TEST(S)</b>	
						STATUS		TYPE		VALUE
						1		1		1
						1		1		1

<b>UNIT #</b>	<b>NAME: LAST, FIRST, MIDDLE</b>		<b>DATE OF BIRTH</b>		<b>AGE</b>	<b>GENDER</b>				
<b>ADDRESS: STREET, CITY, STATE, ZIP</b>				<b>CONTACT PHONE - INCLUDE AREA CODE</b>						
<b>INJURIES</b>	<b>INJURED TAKEN BY</b>	<b>EMS AGENCY (NAME)</b>	<b>INJURED TAKEN TO: MEDICAL FACILITY (NAME, CITY)</b>	<b>SAFETY EQUIPMENT USED</b>	<input type="checkbox"/> DOT-COMPLIANT MC HELMET	<b>SEATING POSITION</b>	<b>AIR BAG USAGE</b>	<b>EJECTION</b>	<b>TRAPPED</b>	
<b>OL STATE</b>	<b>OPERATOR LICENSE NUMBER</b>		<b>OFFENSE CHARGED</b>	<b>LOCAL CODE</b> <input type="checkbox"/>	<b>OFFENSE DESCRIPTION</b>		<b>CITATION NUMBER</b>			
<b>OL CLASS</b>	<b>ENDORSEMENT SELECT UP TO 2</b>	<b>RESTRICTION SELECT UP TO 3</b>	<b>DRIVER DISTRACTED BY</b>	<b>ALCOHOL / DRUG SUSPECTED</b> <input type="checkbox"/> ALCOHOL <input type="checkbox"/> MARIJUANA <input type="checkbox"/> OTHER DRUG		<b>CONDITION</b>	<b>ALCOHOL TEST</b>		<b>DRUG TEST(S)</b>	
						STATUS		TYPE		RESULT SELECT UP TO 4

<b>UNIT #</b>	<b>NAME: LAST, FIRST, MIDDLE</b>		<b>DATE OF BIRTH</b>		<b>AGE</b>	<b>GENDER</b>				
<b>ADDRESS: STREET, CITY, STATE, ZIP</b>				<b>CONTACT PHONE - INCLUDE AREA CODE</b>						
<b>INJURIES</b>	<b>INJURED TAKEN BY</b>	<b>EMS AGENCY (NAME)</b>	<b>INJURED TAKEN TO: MEDICAL FACILITY (NAME, CITY)</b>	<b>SAFETY EQUIPMENT USED</b>	<input type="checkbox"/> DOT-COMPLIANT MC HELMET	<b>SEATING POSITION</b>	<b>AIR BAG USAGE</b>	<b>EJECTION</b>	<b>TRAPPED</b>	
<b>OL STATE</b>	<b>OPERATOR LICENSE NUMBER</b>		<b>OFFENSE CHARGED</b>	<b>LOCAL CODE</b> <input type="checkbox"/>	<b>OFFENSE DESCRIPTION</b>		<b>CITATION NUMBER</b>			
<b>OL CLASS</b>	<b>ENDORSEMENT SELECT UP TO 2</b>	<b>RESTRICTION SELECT UP TO 3</b>	<b>DRIVER DISTRACTED BY</b>	<b>ALCOHOL / DRUG SUSPECTED</b> <input type="checkbox"/> ALCOHOL <input type="checkbox"/> MARIJUANA <input type="checkbox"/> OTHER DRUG		<b>CONDITION</b>	<b>ALCOHOL TEST</b>		<b>DRUG TEST(S)</b>	
						STATUS		TYPE		RESULT SELECT UP TO 4

INJURIES	SEATING POSITION	AIR BAG	OL CLASS	OL RESTRICTION(S)	DRIVER DISTRACTION	TEST STATUS
1-FATAL	1-FRONT-LEFT SIDE (MOTORCYCLE DRIVER)	1-NOT DEPLOYED	1-CLASS A	1-ALCOHOL INTERLOCK DEVICE	1-NOT DISTRACTED	1-NONE GIVEN
2-SUSPECTED SERIOUS INJURY	2-FRONT-MIDDLE	2-DEPLOYED FRONT	2-CLASS B	2-CDL INTRASTATE ONLY	2-MANUALLY OPERATING AN ELECTRONIC COMMUNICATION DEVICE (TEXTING, TYPING, DIALING)	2-TEST REFUSED
3-SUSPECTED MINDR INJURY	3-FRONT-RIGHT SIDE	3-DEPLOYED SIDE	3-CLASS C	3-CORRECTIVE LENSES	3-TALKING ON HANDS-FREE COMMUNICATION DEVICE	3-TEST GIVEN, CONTAMINATED SAMPLE / UNUSABLE
4-POSSIBLE INJURY	4-SECOND-LEFT SIDE (MOTORCYCLE PASSENGER)	4-DEPLOYED BOTH FRONT / SIDE	4-REGULAR CLASS (OHIO = D)	4-FARM WAIVER	4-TALKING ON HAND-HELD COMMUNICATION DEVICE	4-TEST GIVEN, RESULTS KNOWN
5-NO APPARENT INJURY	5-SECOND-MIDDLE	5-NOT APPLICABLE	5-MC MOPED ONLY	5-EXCEPT CLASS A BUS	5-OTHER ACTIVITY WITH AN ELECTRONIC DEVICE	5-TEST GIVEN, RESULTS UNKNOWN
<b>INJURED TAKEN BY</b>	6-SECOND-RIGHT SIDE	9-DEPLOYMENT UNKNOWN	6-NO VALID OL	6-EXCEPT CLASS A & CLASS B BUS	7-OTHER DISTRACTION INSIDE THE VEHICLE	<b>ALCOHOL TEST TYPE</b>
1-NOT TRANSPORTED, /TREATED AT SCENE	7-THIRD-LEFT SIDE (MOTORCYCLE SIDE CAR)	<b>EJECTION</b>	<b>OL ENDORSEMENT</b>	7-EXCEPT TRACTOR-TRAILER	8-OTHER DISTRACTION OUTSIDE THE VEHICLE	1-NONE
2-EMS	8-THIRD-MIDDLE	1-NOT EJECTED	H-HAZMAT	8-INTERMEDIATE LICENSE RESTRICTIONS	9-OTHER / UNKNOWN	2-BLOOD
3-POLICE	9-THIRD-RIGHT SIDE	2-PARTIALLY EJECTED	M-MOTORCYCLE	9-LEARNER'S PERMIT RESTRICTIONS	<b>CONDITION</b>	3-URINE
9-OTHER / UNKNOWN	10-SLEEPER SECTION OF TRUCK CAB	3-TOTALLY EJECTED	P-PASSENGER	10-LIMITED TO DAYLIGHT ONLY	1-APPARENTLY NORMAL	4-BREATH
<b>SAFETY EQUIPMENT</b>	11-PASSENGER IN OTHER ENCLOSED CARGO AREA (NON-TRAILING UNIT, BUS, PICK-UP WITH CAP)	4-NOT APPLICABLE	N-TANKER	11-LIMITED TO EMPLOYMENT	2-PHYSICAL IMPAIRMENT (e.g., DEPRESSED, ANGRY, DISTURBED)	5-OTHER
1-NONE USED	12-PASSENGER IN UNENCLOSED CARGO AREA	<b>TRAPPED</b>	Q-MOTOR SCOOTER	12-LIMITED-OTHER	4-ILLNESS	<b>DRUG TEST TYPE</b>
2-SHOULDER BELT ONLY USED	13-TRAILING UNIT	1-NOT TRAPPED	R-THREE-WHEEL MOTORCYCLE	13-MECHANICAL DEVICES (SPECIAL BRAKES, HAND CONTROLS, OR OTHER ADAPTIVE DEVICES)	5-FELL ASLEEP, FAINTED, FATIGUED, ETC.	1-NONE
3-LAP BELT ONLY USED	14-RIDING ON VEHICLE EXTERIOR (NON-TRAILING UNIT)	2-EXTRICATED BY MECHANICAL MEANS	S-SCHOOL BUS	14-MILITARY VEHICLES ONLY	6-UNDER THE INFLUENCE OF MEDICATIONS / DRUGS / ALCOHOL	2-BLOOD
4-SHOULDER & LAP BELT USED	15-NON-MOTORIST	3-FREED BY NON-MECHANICAL MEANS	T-DOUBLE & TRIPLE TRAILERS	15-MOTOR VEHICLES WITHOUT AIR BRAKES	9-OTHER / UNKNOWN	3-URINE
5-CHILD RESTRAINT SYSTEM- FORWARD FACING	99-OTHER / UNKNOWN		X-TANKER / HAZMAT	16-OUTSIDE MIRROR	<b>DRUG TEST RESULT(S)</b>	4-BREATH
6-CHILD RESTRAINT SYSTEM- REAR FACING			<b>GENDER</b>	17-PROSTHETIC AID	1-AMPHETAMINES	5-OTHER
7-BOOSTER SEAT			F-FEMALE	18-OTHER	2-BENZODIAZEPINES	6-CANNABINOIDS
8-HELMET USED			M-MALE		3-COCAINE	7-OTHER
9-PROTECTIVE PADS USED (ELBOW, KNEES, ETC.)			U-OTHER / UNKNOWN		6-OPiates / OPioids	8-NEGATIVE RESULTS
10-REFLECTIVE CLOTHING					7-OTHER	
11-LIGHTING - PEDESTRIAN / BICYCLE ONLY					8-NEGATIVE RESULTS	
99-OTHER / UNKNOWN						

LOCAL REPORT NUMBER <b>PD-22-087245</b>	REPORTING AGENCY <b>Fairfield Police Department</b>	DATE OF ACCIDENT <b>11/30/22</b>
IN COUNTY OF <b>Butler</b>	ACCIDENT LOCATION <b>3532 River Rd. Fairfield, OH. 45014</b>	

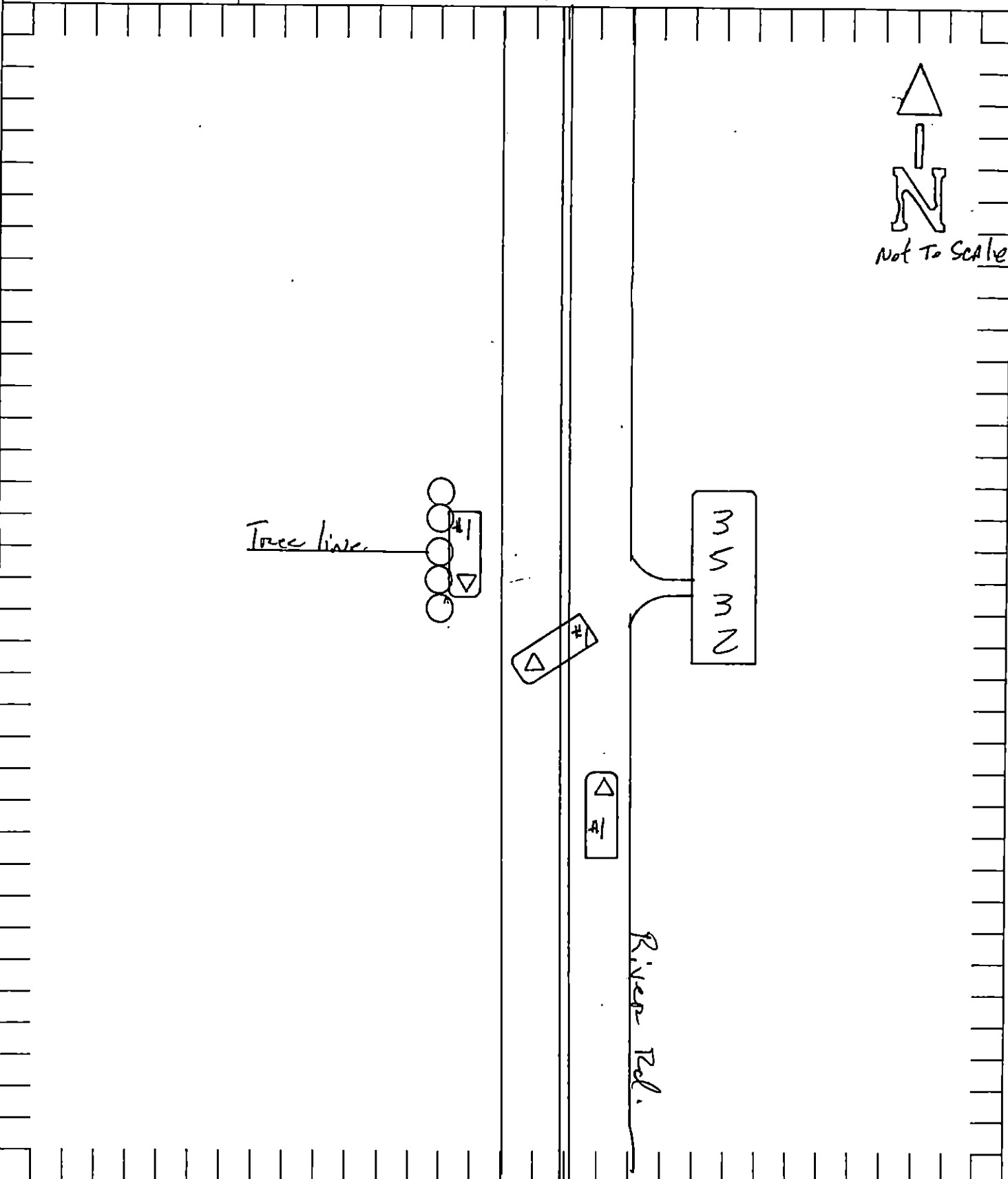

OFFICER'S SIGNATURE 	OFFICER'S SIGNATURE <b>PO Greg Bailes</b>	BADGE NO. <b>122</b>
-------------------------	--	-------------------------