



TRAFFIC CRASH REPORT

*DENOTES MANDATORY FIELD FOR SUPPLEMENT REPORT

LOCAL REPORT NUMBER*

<input checked="" type="checkbox"/> PHOTOS TAKEN	<input checked="" type="checkbox"/> OH-2	<input type="checkbox"/> OH-3	LOCAL INFORMATION	2 2 0 8 8 1 3 9
<input checked="" type="checkbox"/> SECONDARY CRASH	<input type="checkbox"/> OH-1P	<input type="checkbox"/> OTHER	REPORTING AGENCY NAME*	HIT/SKIP
<input type="checkbox"/> PRIVATE PROPERTY			Fairfield Police Department	1 - SOLVED
			NCIC* 0 0 9 0 1	2 - UNSOLVED
				NUMBER OF UNITS
				0 2
				UNIT IN ERROR
				98 - ANIMAL
				0 1 99 - UNKNOWN

COUNTY* 0 9	LOCALITY* 1	LOCATION: CITY, VILLAGE, TOWNSHIP* 1-CITY 2-VILLAGE 3-TOWNSHIP City of Fairfield	CRASH DATE / TIME* 1 2 0 3 2 0 2 2 1 4 0 0	CRASH SEVERITY 1 - FATAL 2 - SERIOUS INJURY SUSPECTED 3 - MINOR INJURY SUSPECTED 4 - INJURY POSSIBLE 5 - PROPERTY DAMAGE ONLY
-------------	-------------	--	---	--

ROUTE TYPE	ROUTE NUMBER	PREFIX 1 - NORTH 2 - SOUTH 3 - EAST 4 - WEST	LOCATION ROAD NAME SOUTH GILMORE	ROAD TYPE R D	LATITUDE DECIMAL DEGREES 3 9 . 3 1 8 1 2 0	CRASH SEVERITY 1 - FATAL 2 - SERIOUS INJURY SUSPECTED 3 - MINOR INJURY SUSPECTED 4 - INJURY POSSIBLE 5 - PROPERTY DAMAGE ONLY
ROUTE TYPE	ROUTE NUMBER	PREFIX 1 - NORTH 2 - SOUTH 3 - EAST 4 - WEST	REFERENCE ROAD NAME (ROAD, MILEPOST, HOUSE #) ANNANDALE	ROAD TYPE D R	LONGITUDE DECIMAL DEGREES - 8 4 . 5 2 2 3 8 8	

REFERENCE POINT 1 - INTERSECTION 2 - MILE POST 3 - HOUSE # 1	DIRECTION FROM REFERENCE 1 - NORTH 2 - SOUTH 3 - EAST 4 - WEST 2	ROUTE TYPE IR - INTERSTATE ROUTE (TP) US - FEDERAL US ROUTE SR - STATE ROUTE CR - NUMBERED COUNTY ROUTE TR - NUMBERED TOWNSHIP ROUTE	ROAD TYPE AL - ALLEY AV - AVENUE BL - BOULEVARD CR - CIRCLE CT - COURT DR - DRIVE HE - HEIGHTS HW - HIGHWAY LA - LANE MP - MILEPOST OV - OVAL PK - PARKWAY PI - PIKE PL - PLACE RD - ROAD SQ - SQUARE ST - STREET TE - TERRACE TL - TRAIL VA - WAY	INTERSECTION RELATED <input checked="" type="checkbox"/> WITHIN INTERSECTION OR ON APPROACH <input type="checkbox"/> WITHIN INTERCHANGE AREA NUMBER OF APPROACHES 0 4
DISTANCE FROM REFERENCE 5 0	DISTANCE UNIT OF MEASURE 1 - MILES 2 - FEET 3 - YARDS 2			ROADWAY <input type="checkbox"/> ROADWAY DIVIDED

LOCATION OF FIRST HARMFUL EVENT 1 - ON ROADWAY 2 - ON SHOULDER 3 - IN MEDIAN 4 - ON ROADSIDE 5 - ON GORE 6 - OUTSIDE TRAFFIC WAY 7 - ON RAMP 8 - OFF RAMP 0 1	9 - CROSSOVER 10 - DRIVEWAY/ALLEY ACCESS 11 - RAILWAY GRADE CROSSING 12 - SHARED USE PATHS OR TRAILS 13 - BIKE LANE 14 - TOLL BOOTH 99 - OTHER / UNKNOWN 2	MANNER OF CRASH COLLISION/IMPACT 1 - NOT COLLISION BETWEEN TWO MOTOR VEHICLES IN TRANSPORT 2 - REAR-END 3 - HEAD-ON 4 - REAR-TO-REAR 5 - BACKING 6 - ANGLE 7 - SIDESWIPE, SAME DIRECTION 8 - SIDESWIPE, OPPOSITE DIRECTION 9 - OTHER / UNKNOWN	DIRECTION OF TRAVEL 1 - NORTH 2 - SOUTH 3 - EAST 4 - WEST	MEDIAN TYPE 1 - DIVIDED FLUSH MEDIAN (<4 FEET) 2 - DIVIDED FLUSH MEDIAN (≥4 FEET) 3 - DIVIDED, DEPRESSED MEDIAN 4 - DIVIDED, RAISED MEDIAN (ANY TYPE) 9 - OTHER/UNKNOWN
--	---	---	---	--

<input type="checkbox"/> WORK ZONE RELATED <input type="checkbox"/> WORKERS PRESENT <input type="checkbox"/> LAW ENFORCEMENT PRESENT <input type="checkbox"/> ACTIVE SCHOOL ZONE	WORK ZONE TYPE 1 - LANE CLOSURE 2 - LANE SHIFT/CROSSOVER 3 - WORK ON SHOULDER OR MEDIAN 4 - INTERMITTENT OR MOVING WORK 5 - OTHER	LOCATION OF CRASH IN WORK ZONE 1 - BEFORE THE 1ST WORK ZONE WARNING SIGN 2 - ADVANCE WARNING AREA 3 - TRANSITION AREA 4 - ACTIVITY AREA 5 - TERMINATION AREA	CONTOUR 1	CONDITIONS 1	SURFACE 2
---	--	---	--------------	-----------------	--------------

LIGHT CONDITION 1 - DAYLIGHT 2 - DAWN/DUSK 3 - DARK - LIGHTED ROADWAY 4 - DARK - ROADWAY NOT LIGHTED 5 - DARK - UNKNOWN ROADWAY LIGHTING 9 - OTHER / UNKNOWN 1	WEATHER 1 - CLEAR 2 - CLOUDY 3 - FOG, SMOG, SMOKE 4 - RAIN 5 - SLEET, HAIL 6 - SNOW 7 - SEVERE CROSSWINDS 8 - BLOWING SAND, SOIL, DIRT, SNOW 9 - FREEZING RAIN OR FREEZING DRIZZLE 99 - OTHER / UNKNOWN 0 1	1 - CONCRETE 2 - BLACKTOP, BITUMINOUS, ASPHALT 3 - BRICK/BLOCK 4 - SLAG, GRAVEL, STONE 5 - DIRT 9 - OTHER/UNKNOWN
---	--	--

NARRATIVE

On December 3, 2022 at approximately 2:00 PM, Units 1 and 2 were traveling northbound on South Gilmore Road approaching Annandale Drive. Unit 2 was at a stop due to just being involved in another crash (PD-22-088148). Unit 1 then rear-ended Unit 2.

SEE OH-2



Indicate the north direction with an "N" on the compass diagram.

CRASH REPORTED DATE / TIME 1 2 0 3 2 0 2 2 1 4 0 0	DISPATCH DATE / TIME 1 2 0 3 2 0 2 2 1 4 1 1	ARRIVAL DATE / TIME 1 2 0 3 2 0 2 2 1 4 1 9	SCENE CLEARED DATE / TIME 1 2 0 3 2 0 2 2 1 4 5 9	REPORT TAKEN BY <input checked="" type="checkbox"/> POLICE AGENCY <input type="checkbox"/> MOTORIST
TOTAL TIME ROADWAY CLOSED 0	OTHER INVESTIGATION TIME 3 0	TOTAL MINUTES 7 8	OFFICER'S NAME* A. ROUSH	CHECKED BY OFFICER'S NAME* D. Potts
			OFFICER'S BADGE NUMBER* 1 7 0	CHECKED BY OFFICER'S BADGE NUMBER* 1 3 0
				<input type="checkbox"/> SUPPLEMENT (CORRECTION OR ADDITION TO AN EXISTING REPORT SENT TO OOPS)

OWNER	UNIT # 01	OWNER NAME: LAST, FIRST, MIDDLE (☑ SAME AS DRIVER) OWNER ADDRESS: STREET, CITY, STATE, ZIP (☑ SAME AS DRIVER)	OWNER PHONE: INCLUDE AREA CODE (☑ SAME AS DRIVER)
VEHICLE	LP STATE OH	LICENSE PLATE # GHS9436	VEHICLE IDENTIFICATION # 4T1B11HKXK1U23361
	INSURANCE VERIFIED ☑	INSURANCE COMPANY CINCINNATI INS	INSURANCE POLICY # A020541162
	TYPE OF USE <input type="checkbox"/> COMMERCIAL <input type="checkbox"/> GOVERNMENT <input type="checkbox"/> IN EMERGENCY RESPONSE	US DOT #	VEHICLE YEAR 2019
	INTERLOCK DEVICE EQUIPPED <input type="checkbox"/>	HIT/SKIP UNIT <input type="checkbox"/>	VEHICLE MAKE TOYOTA
	COMMERCIAL CARRIER: NAME, ADDRESS, CITY, STATE, ZIP	VEHICLE WEIGHT GVWR/GCWR 1 - <10K LBS. 2 - 10,001 - 26K LBS. 3 - >26K LBS.	COLOR SILVER
	VEHICLE IDENTIFICATION #	HAZARDOUS MATERIAL <input type="checkbox"/> MATERIAL RELEASED <input type="checkbox"/> PLACARD	VEHICLE MODEL CAMRY
	UNIT TYPE 01	1 - PASSENGER CAR 2 - PASSENGER VAN (MINIVAN) 3 - SPORT UTILITY VEHICLE 4 - PICK UP 5 - CARGOVAN 6 - VAN (9-15 SEATS)	7 - MOTORCYCLE 2-WHEELED 8 - MOTORCYCLE 3-WHEELED 9 - AUTOCYCLE 10 - MOPED OR MOTORIZED BICYCLE 11 - ALL TERRAIN VEHICLE (ATV/UTV)
	# OF TRAILING UNITS 00	12 - GOLF CART 13 - SNOWMOBILE 14 - SINGLE UNIT TRUCK 15 - SEMI-TRACTOR 16 - FARM EQUIPMENT 17 - MOTORHOME	18 - LIMO (LIVERY VEHICLE) 19 - BUS (16+ PASSENGERS) 20 - OTHER VEHICLE 21 - HEAVY EQUIPMENT 22 - ANIMAL WITH RIDER OR ANIMAL-DRAWN VEHICLE 23 - PEDESTRIAN / SKATER 24 - WHEELCHAIR (ANY TYPE) 25 - OTHER NON-MOTORIST 26 - BICYCLE 27 - TRAIN 99 - UNKNOWN OR HIT/SKIP
	WAS VEHICLE OPERATING IN AUTONOMOUS MODE WHEN CRASH OCCURRED? 02	0 - NO AUTOMATION 1 - DRIVER ASSISTANCE 2 - PARTIAL AUTOMATION	3 - CONDITIONAL AUTOMATION 4 - HIGH AUTOMATION 5 - FULL AUTOMATION 9 - UNKNOWN
	SPECIAL FUNCTION 01	1 - NONE 2 - TAXI 3 - ELECTRONIC RIDE SHARING 4 - SCHOOL TRANSPORT 5 - BUS - TRANSIT/COMMUTER	6 - BUS - CHARTER/TOUR 7 - BUS - INTERCITY 8 - BUS - SHUTTLE 9 - BUS - OTHER 10 - AMBULANCE
	CARGO BODY TYPE 01	1 - NO CARGO BODY TYPE / NOT APPLICABLE 2 - BUS	3 - VEHICLE TOWING ANOTHER MOTORVEHICLE 4 - LOGGING 5 - INTERMODAL CONTAINER CHASSIS 6 - CARGOVAN/ENCLOSED BOX 7 - GRAIN/CHIPS/GRAVEL
	VEHICLE DEFECTS	1 - TURN SIGNALS 2 - HEAD LAMPS 3 - TAIL LAMPS	4 - BRAKES 5 - STEERING 6 - TIRE BLOWOUT 7 - WORN OR SLICK TIRES 8 - TRAILER EQUIPMENT DEFECTIVE 9 - MOTOR TROUBLE 10 - DISABLED FROM PRIOR ACCIDENT 99 - OTHER / UNKNOWN
	NON-MOTORIST LOCATION AT IMPACT	1 - INTERSECTION - MARKED CROSSWALK 2 - INTERSECTION - UNMARKED CROSSWALK	3 - INTERSECTION - OTHER 4 - MIDBLOCK - MARKED CROSSWALK 5 - TRAVEL LANE - OTHER LOCATION 6 - BICYCLE LANE 7 - SHOULDER/ROADSIDE 8 - SIDEWALK 9 - MEDIAN/CROSSING ISLAND 10 - DRIVEWAY ACCESS 11 - SHARED USE PATHS OR TRAILS 12 - FIRST RESPONDER AT INCIDENT SCENE 99 - OTHER / UNKNOWN
	ACTION 03	1 - NON-CONTACT 2 - NON-COLLISION 3 - STRIKING 4 - STRUCK 5 - BOTH STRIKING & STRUCK 9 - OTHER / UNKNOWN	1 - STRAIGHT AHEAD 2 - BACKING 3 - CHANGING LANES 4 - OVERTAKING/PASSING 5 - MAKING RIGHT TURN 6 - MAKING LEFT TURN 7 - MAKING U-TURN 8 - ENTERING TRAFFIC LANE 9 - LEAVING TRAFFIC LANE 10 - PARKED 11 - SLOWING OR STOPPED IN TRAFFIC 12 - DRIVERLESS 13 - NEGOTIATING A CURVE 14 - ENTERING OR CROSSING SPECIFIED LOCATION 15 - WALKING, RUNNING, JOGGING, PLAYING 16 - WORKING 17 - PUSHING VEHICLE 18 - APPROACHING OR LEAVING VEHICLE 19 - STANDING 20 - OTHER NON-MOTORIST 21 - STANDING OUTSIDE DISABLED VEHICLE 99 - OTHER / UNKNOWN
	CONTRIBUTING CIRCUMSTANCES 08	1 - NONE 2 - FAILURE TO YIELD 3 - RAN RED LIGHT 4 - RAN STOP SIGN 5 - UNSAFE SPEED 6 - IMPROPER TURN	7 - LEFT OF CENTER 8 - FOLLOWING TOO CLOSE / ACDA 9 - IMPROPER LANE CHANGE 10 - IMPROPER PASSING 11 - DROVE OFF ROAD 12 - IMPROPER BACKING 13 - IMPROPER START FROM A PARKED POSITION 14 - STOPPED OR PARKED ILLEGALLY 15 - SWERVING TO AVOID 16 - WRONG WAY 17 - VISION OBSTRUCTION 18 - OPERATING DEFECTIVE EQUIPMENT 19 - LOAD SHIFTING/FALLING/ SPILLING 20 - IMPROPER CROSSING 21 - LYING IN ROADWAY 22 - NOT DISCERNIBLE 23 - OPENING DOOR INTO ROADWAY 99 - OTHER IMPROPER ACTION
	SEQUENCE OF EVENTS	NON-COLLISION:	
	1 2 0	1 - OVERTURN/ROLLOVER 2 - FIRE/EXPLOSION 3 - IMMERSION 4 - JACKKNIFE 5 - CARGO/EQUIPMENT LOSS OR SHIFT	11 - CROSS CENTERLINE - OPPOSITE DIRECTION OF TRAVEL 12 - DOWNHILL RUNAWAY 13 - OTHER NON-COLLISION 14 - PEDESTRIAN 15 - PEDALCYCLE 16 - RAILWAY VEHICLE 17 - ANIMAL - FARM 18 - ANIMAL - DEER 19 - ANIMAL - OTHER 20 - MOTOR VEHICLE IN TRANSPORT 21 - PARKED MOTOR VEHICLE 22 - WORK ZONE MAINTENANCE EQUIPMENT 23 - STRUCK BY FALLING, SHIFTING CARGO OR ANYTHING SET IN MOTION BY A MOTOR VEHICLE 24 - OTHER MOVABLE OBJECT
		COLLISION WITH FIXED OBJECT: STRUCK	
	25 - IMPACT ATTENUATOR / CRASH CUSHION 26 - BRIDGE OVERHEAD STRUCTURE 27 - BRIDGE PIER OR ABUTMENT 28 - BRIDGE PARAPET 29 - BRIDGE RAIL 30 - GUARDRAIL FACE	31 - GUARDRAIL END 32 - PORTABLE BARRIER 33 - MEDIAN CABLE BARRIER 34 - MEDIAN GUARDRAIL BARRIER 35 - MEDIAN CONCRETE BARRIER 36 - MEDIAN OTHER BARRIER	37 - TRAFFIC SIGN POST 38 - OVERHEAD SIGN POST 39 - LIGHT / LUMINARIES SUPPORT 40 - UTILITY POLE 41 - OTHER POST, POLE OR SUPPORT 42 - CULVERT 43 - CURB 44 - DITCH 45 - EMBANKMENT 46 - FENCE 47 - MAILBOX 48 - TREE 49 - FIRE HYDRANT 50 - WORK ZONE MAINTENANCE EQUIPMENT 51 - WALL 52 - BUILDING 53 - TUNNEL 54 - OTHER FIXED OBJECT 99 - OTHER / UNKNOWN
	FIRST HARMFUL EVENT	MOST HARMFUL EVENT	

LOCAL REPORT NUMBER 2, 2, 0, 8, 8, 1, 3, 9	
DAMAGE	
DAMAGE SCALE	
2	1 - NONE 2 - MINOR DAMAGE 3 - FUNCTIONAL DAMAGE 4 - DISABLING DAMAGE 9 - UNKNOWN
DAMAGED AREA(S) INDICATE ALL THAT APPLY	
<input type="checkbox"/> - NO DAMAGE [0] <input type="checkbox"/> - UNDERCARRIAGE [14] <input type="checkbox"/> - TOP [13] <input type="checkbox"/> - ALL AREAS [15] <input type="checkbox"/> - UNIT NOT AT SCENE [16]	
INITIAL POINT OF CONTACT	
0 - NO DAMAGE 14 - UNDERCARRIAGE 1-12 - REFER TO UNIT DIAGRAM 15 - VEHICLE NOT AT SCENE 13 - TOP 99 - UNKNOWN	
TRAFFIC	
TRAFFICWAY FLOW 1 - ONE-WAY 2 - TWO-WAY	TRAFFIC CONTROL 1 - ROUNDABOUT 4 - STOP SIGN 2 - SIGNAL 5 - YIELD SIGN 3 - FLASHER 6 - NO CONTROL
# OF THROUGH LANES ON ROAD 3	RAIL GRADE CROSSING 1 - NOT INVOLVED 2 - INVOLVED-ACTIVE CROSSING 3 - INVOLVED-PASSIVE CROSSING
UNIT / NON-MOTORIST DIRECTION	
FROM 2 TO 1 1 - NORTH 5 - NORTHEAST 2 - SOUTH 6 - NORTHWEST 3 - EAST 7 - SOUTHEAST 4 - WEST 8 - SOUTHWEST 9 - OTHER / UNKNOWN	
UNIT SPEED 10	DETECTED SPEED 1 - STATED / ESTIMATED SPEED 2 - CALCULATED / EDR 3 - UNDETERMINED
POSTED SPEED 35	

LOCAL REPORT NUMBER
 2 2 0 8 8 1 3 9

UNIT # 012 **OWNER NAME: LAST, FIRST, MIDDLE** (SAME AS DRIVER)
RIGHTWAY AUTO SALES
OWNER ADDRESS: STREET, CITY, STATE, ZIP (SAME AS DRIVER)
 5221 DIXIE HWY, FAIRFIELD, OH 45014
COMMERCIAL CARRIER: NAME, ADDRESS, CITY, STATE, ZIP
 RIGHTWAY AUTO SALES, 5221 DIXIE HWY, FAIRFIELD, OH 45014
OWNER PHONE: INCLUDE AREA CODE (SAME AS DRIVER)
 513

DAMAGE
DAMAGE SCALE
 1 - NONE 3 - FUNCTIONAL DAMAGE
 2 - MINOR DAMAGE 4 - DISABLING DAMAGE
 9 - UNKNOWN

LP STATE OH **LICENSE PLATE #** 004 4583
VEHICLE IDENTIFICATION # 3N11A1B7A1P4HY1217814172
VEHICLE YEAR 2017 **VEHICLE MAKE** NISSAN
INSURANCE VERIFIED **INSURANCE COMPANY** **INSURANCE POLICY #**
COLOR SILVER **VEHICLE MODEL** SENTRA

DAMAGED AREA(S)
 INDICATE ALL THAT APPLY

COMMERCIAL **GOVERNMENT** **IN EMERGENCY RESPONSE**
US DOT #
VEHICLE WEIGHT GVWR/GCWR
 1 - <10K LBS.
 2 - 10,001 - 26K LBS.
 3 - >26K LBS.
TOWED BY: COMPANY NAME WAYNE'S TOWING
HAZARDOUS MATERIAL
 MATERIAL RELEASED **CLASS #** **PLACARD ID #**
 PLACARD

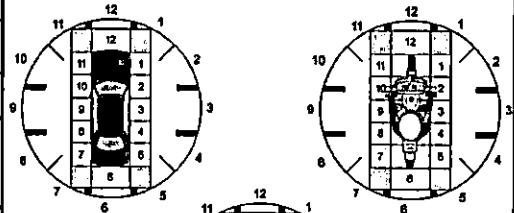

UNIT TYPE 01
 1 - PASSENGER CAR 7 - MOTORCYCLE 2-WHEELED 12 - GOLF CART 18 - LIMO (LIVERY VEHICLE) 23 - PEDESTRIAN / SKATER
 2 - PASSENGER VAN (MINIVAN) 8 - MOTORCYCLE 3-WHEELED 13 - SNOWMOBILE 19 - BUS (16+ PASSENGERS) 24 - WHEELCHAIR (ANY TYPE)
 3 - SPORT UTILITY VEHICLE 9 - AUTOCYCLE 14 - SINGLE UNIT TRUCK 20 - OTHER VEHICLE 25 - OTHER NON-MOTORIST
 4 - PICK UP 10 - MOPED OR MOTORIZED BICYCLE 15 - SEMI-TRACTOR 21 - HEAVY EQUIPMENT 26 - BICYCLE
 5 - CARGO VAN 11 - ALL-TERRAIN VEHICLE (ATV/UTV) 16 - FARM EQUIPMENT 22 - ANIMAL WITH RIDER OR ANIMAL-DRAWN VEHICLE 27 - TRAIN
 6 - VAN (9-15 SEATS) 17 - MOTORHOME 99 - UNKNOWN OR HIT/SKIP

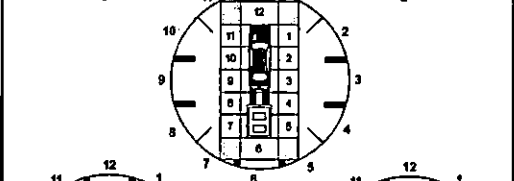

OF TRAILING UNITS 00
WAS VEHICLE OPERATING IN AUTONOMOUS MODE WHEN CRASH OCCURRED?
 1 - YES 2 - NO 9 - OTHER / UNKNOWN
AUTONOMOUS MODE LEVEL
 0 - NO AUTOMATION 3 - CONDITIONAL AUTOMATION 9 - UNKNOWN
 1 - DRIVER ASSISTANCE 4 - HIGH AUTOMATION
 2 - PARTIAL AUTOMATION 5 - FULL AUTOMATION

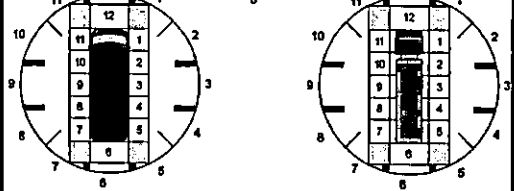

SPECIAL FUNCTION 01
 1 - NONE 6 - BUS - CHARTER/TOUR 11 - FIRE 16 - FARM 21 - MAIL CARRIER
 2 - TAXI 7 - BUS - INTERCITY 12 - MILITARY 17 - MOWING 99 - OTHER / UNKNOWN
 3 - ELECTRONIC RIDE SHARING 8 - BUS - SHUTTLE 13 - POLICE 18 - SNOW REMOVAL
 4 - SCHOOL TRANSPORT 9 - BUS - OTHER 14 - PUBLIC UTILITY 19 - TOWING
 5 - BUS - TRANSIT/COMMUTER 10 - AMBULANCE 15 - CONSTRUCTION EQUIPMENT 20 - SAFETY SERVICE PATROL

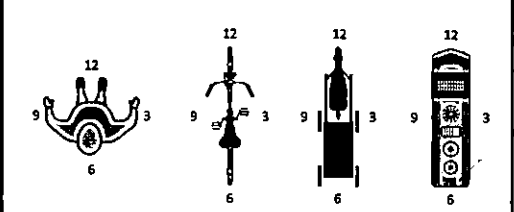

CARGO BODY TYPE 01
 1 - NO CARGO BODY TYPE / NOT APPLICABLE 3 - VEHICLE TOWING ANOTHER MOTORVEHICLE 5 - INTERMODAL CONTAINER CHASSIS 8 - POLE 12 - CONCRETE MIXER
 2 - BUS 4 - LOGGING 6 - CARGO VAN/ENCLOSED BOX 9 - CARGO TANK 13 - AUTO TRANSPORTER
 7 - GRAIN/CHIP/GRAVEL 10 - FLAT BED 14 - GARBAGE/REFUSE
 11 - DUMP 99 - OTHER / UNKNOWN

- NO DAMAGE [0] - UNDERCARRIAGE [14]
 - TOP [13] - ALL AREAS [15]
 - UNIT NOT AT SCENE [16]

VEHICLE DEFECTS
 1 - TURN SIGNALS 4 - BRAKES 7 - WORN OR SLICK TIRES 9 - MOTOR TROUBLE 99 - OTHER / UNKNOWN
 2 - HEAD LAMPS 5 - STEERING 8 - TRAILER EQUIPMENT DEFECTIVE 10 - DISABLED FROM PRIOR ACCIDENT
 3 - TAIL LAMPS 6 - TIRE BLOWOUT

NON-MOTORIST LOCATION AT IMPACT
 1 - INTERSECTION - MARKED CROSSWALK 3 - INTERSECTION - OTHER 6 - BICYCLE LANE 9 - MEDIAN/CROSSING ISLAND 12 - FIRST RESPONDER AT INCIDENT SCENE
 2 - INTERSECTION - UNMARKED CROSSWALK 4 - MIDBLOCK - MARKED CROSSWALK 7 - SHOULDER / ROADSIDE 10 - DRIVEWAY ACCESS
 5 - TRAVEL LANE - OTHER LOCATION 8 - SIDEWALK 11 - SHARED USE PATHS OR TRAILS 99 - OTHER / UNKNOWN

INITIAL POINT OF CONTACT
 0 - NO DAMAGE 14 - UNDERCARRIAGE
 1-12 - REFER TO UNIT DIAGRAM 15 - VEHICLE NOT AT SCENE
 13 - TOP 99 - UNKNOWN

ACTION 04
 1 - NON-CONTACT 1 - STRAIGHT AHEAD 7 - MAKING U-TURN 13 - NEGOTIATING A CURVE 18 - APPROACHING OR LEAVING VEHICLE
 2 - NON-COLLISION 2 - BACKING 8 - ENTERING TRAFFIC LANE 14 - ENTERING OR CROSSING SPECIFIED LOCATION 19 - STANDING
 3 - STRIKING 9, 9 3 - CHANGING LANES 9 - LEAVING TRAFFIC LANE 15 - WALKING, RUNNING, JOGGING, PLAYING 20 - OTHER NON-MOTORIST
 4 - STRUCK PRE-CRASH ACTIONS 4 - OVERTAKING/PASSING 10 - PARKED 16 - WORKING 21 - STANDING OUTSIDE DISABLED VEHICLE
 5 - BOTH STRIKING & STRUCK 5 - MAKING RIGHT TURN 11 - SLOWING OR STOPPED IN TRAFFIC 17 - PUSHING VEHICLE 99 - OTHER / UNKNOWN
 9 - OTHER / UNKNOWN 6 - MAKING LEFT TURN 12 - DRIVERLESS

TRAFFIC
TRAFFICWAY FLOW
 1 - ONE-WAY 2 - TWO-WAY
TRAFFIC CONTROL
 1 - ROUNDABOUT 4 - STOP SIGN
 2 - SIGNAL 5 - YIELD SIGN
 3 - FLASHER 6 - NO CONTROL

CONTRIBUTING CIRCUMSTANCES 01
 1 - NONE 7 - LEFT OF CENTER 13 - IMPROPER START FROM A PARKED POSITION 17 - VISION OBSTRUCTION 21 - LYING IN ROADWAY
 2 - FAILURE TO YIELD 8 - FOLLOWING TOO CLOSE / ACCA 14 - STOPPED OR PARKED ILLEGALLY 18 - OPERATING DEFECTIVE EQUIPMENT 22 - NOT DISCERNIBLE
 3 - RAN RED LIGHT 9 - IMPROPER LANE CHANGE 15 - SWERVING TO AVOID 19 - LOAD SHIFTING/FALLING/SPILLING 23 - OPENING DOOR INTO ROADWAY
 4 - RAN STOP SIGN 10 - IMPROPER PASSING 16 - WRONG WAY 20 - IMPROPER CROSSING 99 - OTHER IMPROPER ACTION
 5 - UNSAFE SPEED 11 - DROVE OFF ROAD 17 - VISION OBSTRUCTION 21 - LYING IN ROADWAY
 6 - IMPROPER TURN 12 - IMPROPER BACKING

OF THROUGH LANES ON ROAD 3
RAIL GRADE CROSSING
 1 - NOT INVOLVED
 2 - INVOLVED-ACTIVE CROSSING
 3 - INVOLVED-PASSIVE CROSSING

SEQUENCE OF EVENTS
 1 2 0
 1 - OVERTURN/ROLLOVER 6 - EQUIPMENT FAILURE 11 - CROSS CENTERLINE - OPPOSITE DIRECTION OF TRAVEL 16 - RAILWAY VEHICLE 22 - WORK ZONE MAINTENANCE EQUIPMENT
 2 - FIRE/EXPLOSION 7 - SEPARATION OF UNITS 12 - DOWNHILL RUNAWAY 17 - ANIMAL - FARM 23 - STRUCK BY FALLING, SHIFTING CARGO OR ANYTHING SET IN MOTION BY A MOTOR VEHICLE
 3 - IMMERSION 8 - RAN OFF ROAD RIGHT 13 - OTHER NON-COLLISION 18 - ANIMAL - DEER 24 - OTHER MOVABLE OBJECT
 4 - JACKKNIFE 9 - RAN OFF ROAD LEFT 14 - PEDESTRIAN 19 - ANIMAL - OTHER 20 - MOTOR VEHICLE IN TRANSPORT
 5 - CARGO / EQUIPMENT LOSS OR SHIFT 10 - CROSS MEDIAN 15 - PEDALCYCLE 21 - PARKED MOTOR VEHICLE

UNIT / NON-MOTORIST DIRECTION
 FROM 2 TO 1
 1 - NORTH 5 - NORTHEAST
 2 - SOUTH 6 - NORTHWEST
 3 - EAST 7 - SOUTHEAST
 4 - WEST 8 - SOUTHWEST
 9 - OTHER / UNKNOWN

COLLISION WITH FIXED OBJECT - STRUCK
 25 - IMPACT ATTENUATOR / CRASH CUSHION 31 - GUARDRAIL END 37 - TRAFFIC SIGN POST 43 - CURB 50 - WORK ZONE MAINTENANCE EQUIPMENT
 26 - BRIDGE OVERHEAD STRUCTURE 32 - PORTABLE BARRIER 38 - OVERHEAD SIGN POST 44 - DITCH 51 - WALL
 27 - BRIDGE PIER OR ABUTMENT 33 - MEDIAN CABLE BARRIER 39 - LIGHT / LUMINARIES SUPPORT 45 - EMBANKMENT 52 - BUILDING
 28 - BRIDGE PARAPET 34 - MEDIAN GUARDRAIL BARRIER 40 - UTILITY POLE 46 - FENCE 53 - TUNNEL
 29 - BRIDGE RAIL 35 - MEDIAN CONCRETE BARRIER 41 - OTHER POST, POLE OR SUPPORT 47 - MAILBOX 54 - OTHER FIXED OBJECT
 30 - GUARDRAIL FACE 36 - MEDIAN OTHER BARRIER 42 - CULVERT 48 - TREE 99 - OTHER / UNKNOWN

UNIT SPEED 0
DETECTED SPEED
 1 - STATED / ESTIMATED SPEED
 2 - CALCULATED / EDR
 3 - UNDETERMINED
POSTED SPEED 3 5



MOTORIST / Non-MOTORIST

LOCAL REPORT NUMBER
2 2 0 8 8 1 3 9

UNIT # 0 1	NAME: LAST, FIRST, MIDDLE CAHILL, DENNIS MICHAEL	DATE OF BIRTH 0 9 0 1 1 9 5 8	AGE 6 4	GENDER M
---------------	---	----------------------------------	------------	-------------

ADDRESS: STREET, CITY, STATE, ZIP
7125 GREENFIELD DR, CINCINNATI, OH 45224

CONTACT PHONE - INCLUDE AREA CODE

INJURIES TAKEN BY 5	INJURED TAKEN BY	EMS AGENCY (NAME)	INJURED TAKEN TO: MEDICAL FACILITY (NAME, CITY)	SAFETY EQUIPMENT USED 0 4	<input type="checkbox"/> DOT-COMPLIANT MC HELMET	SEATING POSITION 0 1	AIR BAG USAGE 1	EJECTION 1	TRAPPED 1
------------------------	------------------	-------------------	---	------------------------------	--	-------------------------	--------------------	---------------	--------------

OL STATE OH	OPERATOR LICENSE NUMBER	OFFENSE CHARGED	LOCAL CODE <input type="checkbox"/>	OFFENSE DESCRIPTION	CITATION NUMBER
----------------	-------------------------	-----------------	--	---------------------	-----------------

OL CLASS 4	ENDORSEMENT SELECT UP TO 2	RESTRICTION SELECT UP TO 3	DRIVER DISTRACTED BY 1	ALCOHOL / DRUG SUSPECTED <input type="checkbox"/> ALCOHOL <input type="checkbox"/> MARIJUANA <input type="checkbox"/> OTHER DRUG	CONDITION 1	ALCOHOL TEST STATUS: 1, TYPE: 1, VALUE: .	DRUG TEST(S) STATUS: 1, TYPE: 1, RESULT: .
---------------	----------------------------	----------------------------	---------------------------	--	----------------	--	---

UNIT # 0 2	NAME: LAST, FIRST, MIDDLE LITTLE, QUEEN-LAKETHA S	DATE OF BIRTH 1 2 0 3 1 9 9 1	AGE 3 1	GENDER F
---------------	--	----------------------------------	------------	-------------

ADDRESS: STREET, CITY, STATE, ZIP
3588 VAN ANTWERP PL, CINCINNATI, OH 45229

CONTACT PHONE - INCLUDE AREA CODE

INJURIES TAKEN BY 5	INJURED TAKEN BY	EMS AGENCY (NAME)	INJURED TAKEN TO: MEDICAL FACILITY (NAME, CITY)	SAFETY EQUIPMENT USED 0 4	<input type="checkbox"/> DOT-COMPLIANT MC HELMET	SEATING POSITION 0 1	AIR BAG USAGE 1	EJECTION 1	TRAPPED 1
------------------------	------------------	-------------------	---	------------------------------	--	-------------------------	--------------------	---------------	--------------

OL STATE OH	OPERATOR LICENSE NUMBER	OFFENSE CHARGED	LOCAL CODE <input type="checkbox"/>	OFFENSE DESCRIPTION	CITATION NUMBER
----------------	-------------------------	-----------------	--	---------------------	-----------------

OL CLASS 4	ENDORSEMENT SELECT UP TO 2	RESTRICTION SELECT UP TO 3	DRIVER DISTRACTED BY 1	ALCOHOL / DRUG SUSPECTED <input type="checkbox"/> ALCOHOL <input type="checkbox"/> MARIJUANA <input type="checkbox"/> OTHER DRUG	CONDITION 1	ALCOHOL TEST STATUS: 1, TYPE: 1, VALUE: .	DRUG TEST(S) STATUS: 1, TYPE: 1, RESULT: .
---------------	----------------------------	----------------------------	---------------------------	--	----------------	--	---

UNIT #	NAME: LAST, FIRST, MIDDLE	DATE OF BIRTH	AGE 0	GENDER
--------	---------------------------	---------------	----------	--------

ADDRESS: STREET, CITY, STATE, ZIP

CONTACT PHONE - INCLUDE AREA CODE

INJURIES TAKEN BY	INJURED TAKEN BY	EMS AGENCY (NAME)	INJURED TAKEN TO: MEDICAL FACILITY (NAME, CITY)	SAFETY EQUIPMENT USED	<input type="checkbox"/> DOT-COMPLIANT MC HELMET	SEATING POSITION	AIR BAG USAGE	EJECTION	TRAPPED
-------------------	------------------	-------------------	---	-----------------------	--	------------------	---------------	----------	---------

OL STATE	OPERATOR LICENSE NUMBER	OFFENSE CHARGED	LOCAL CODE <input type="checkbox"/>	OFFENSE DESCRIPTION	CITATION NUMBER
----------	-------------------------	-----------------	--	---------------------	-----------------

OL CLASS	ENDORSEMENT SELECT UP TO 2	RESTRICTION SELECT UP TO 3	DRIVER DISTRACTED BY	ALCOHOL / DRUG SUSPECTED <input type="checkbox"/> ALCOHOL <input type="checkbox"/> MARIJUANA <input type="checkbox"/> OTHER DRUG	CONDITION	ALCOHOL TEST STATUS: , TYPE: , VALUE: .	DRUG TEST(S) STATUS: , TYPE: , RESULT: .
----------	----------------------------	----------------------------	----------------------	--	-----------	--	---

INJURIES	SEATING POSITION	AIR BAG	OL CLASS	OL RESTRICTION(S)	DRIVER DISTRACTION	TEST STATUS
1-FATAL 2-SUSPECTED SERIOUS INJURY 3-SUSPECTED MINOR INJURY 4-POSSIBLE INJURY 5-NO APPARENT INJURY	1-FRONT-LEFT SIDE (MOTORCYCLE DRIVER) 2-FRONT-MIDDLE 3-FRONT-RIGHT SIDE 4-SECOND-LEFT SIDE (MOTORCYCLE PASSENGER) 5-SECOND-MIDDLE 6-SECOND-RIGHT SIDE 7-THIRD-LEFT SIDE (MOTORCYCLE SIDE CAR) 8-THIRD-MIDDLE 9-THIRD-RIGHT SIDE 10-SLEEPER SECTION OF TRUCK CAB	1-NOT DEPLOYED 2-DEPLOYED FRONT 3-DEPLOYED SIDE 4-DEPLOYED BOTH FRONT / SIDE 5-NOT APPLICABLE 9-DEPLOYMENT UNKNOWN	1-CLASS A 2-CLASS B 3-CLASS C 4-REGULAR CLASS (OHIO-D) 5-M/C MOPED ONLY 6-NO VALID OL	1-ALCOHOL INTERLOCK DEVICE 2-CORRECTIVE LENSES 3-CORRECTIVE LENSES 4-FARM WAIVER 5-EXCEPT CLASS A BUS 6-EXCEPT CLASS A & CLASS B BUS 7-EXCEPT TRACTOR-TRAILER 8-INTERMEDIATE LICENSE RESTRICTIONS 9-LEARNER'S PERMIT RESTRICTIONS 10-LIMITED TO DAYLIGHT ONLY 11-LIMITED TO EMPLOYMENT 12-LIMITED-OTHER 13-MECHANICAL DEVICES (SPECIAL BRAKES, HAND CONTROLS, OR OTHER ADAPTIVE DEVICES) 14-MILITARY VEHICLES ONLY 15-MOTOR VEHICLES WITHOUT AIR BRAKES 16-OUTSIDE MIRROR 17-PROSTHETIC AID 18-OTHER	1-NOT DISTRACTED 2-MANUALLY OPERATING AN ELECTRONIC COMMUNICATION DEVICE (TEXTING, TYPING, DIALING) 3-TALKING ON HANDS-FREE COMMUNICATION DEVICE 4-TALKING ON HAND-HELD COMMUNICATION DEVICE 5-OTHER ACTIVITY WITH AN ELECTRONIC DEVICE 6-PASSENGER 7-OTHER DISTRACTION INSIDE THE VEHICLE 8-OTHER DISTRACTION OUTSIDE THE VEHICLE 9-OTHER / UNKNOWN	1-NONE GIVEN 2-TEST REFUSED 3-TEST GIVEN, CONTAMINATED SAMPLE / UNUSABLE 4-TEST GIVEN, RESULTS KNOWN 5-TEST GIVEN, RESULTS UNKNOWN
INJURED TAKEN BY 1-NOT TRANSPORTED / TREATED AT SCENE 2-EMS 3-POLICE 9-OTHER / UNKNOWN		EJECTION 1-NOT EJECTED 2-PARTIALLY EJECTED 3-TOTALLY EJECTED 4-NOT APPLICABLE	OL ENDORSEMENT H-HAZMAT M-MOTORCYCLE P-PASSENGER N-TANKER Q-MOTOR SCOOTER R-THREE-WHEEL MOTORCYCLE S-SCHOOL BUS T-DOUBLE & TRIPLE TRAILERS X-TANKER / HAZMAT			ALCOHOL TEST TYPE 1-NONE 2-BLOOD 3-URINE 4-BREATH 5-OTHER
SAFETY EQUIPMENT 1-NONE USED 2-SHOULDER BELT ONLY USED 3-LAP BELT ONLY USED 4-SHOULDER & LAP BELT USED 5-CHILD RESTRAINT SYSTEM FORWARD FACING 6-CHILD RESTRAINT SYSTEM REAR FACING 7-BOOSTER SEAT 8-HELMET USED 9-PROTECTIVE PADS USED (ELBOW, KNEES, ETC.) 10-REFLECTIVE CLOTHING 11-LIGHTING - PEDESTRIAN / BICYCLE ONLY 99-OTHER / UNKNOWN	11-PASSENGER IN OTHER ENCLOSED CARGO AREA (NON-TRAILING UNIT, BUS, PICK-UP WITH CAP) 12-PASSENGER IN UNENCLOSED CARGO AREA 13-TRAILING UNIT 14-RIDING ON VEHICLE EXTERIOR (NON-TRAILING UNIT) 15-NON-MOTORIST 99-OTHER / UNKNOWN	TRAPPED 1-NOT TRAPPED 2-EXTRICATED BY MECHANICAL MEANS 3-FREED BY NON-MECHANICAL MEANS	GENDER F-FEMALE M-MALE U-OTHER / UNKNOWN			DRUG TEST TYPE 1-NONE 2-BLOOD 3-URINE 4-OTHER
					CONDITION 1-APPARENTLY NORMAL 2-PHYSICAL IMPAIRMENT 3-EMOTIONAL (E.G. DEPRESSED, ANGRY, DISTURBED) 4-ILLNESS 5-FELL ASLEEP, FAINTED, FATIGUED, ETC. 6-UNDER THE INFLUENCE OF MEDICATIONS / DRUGS / ALCOHOL 9-OTHER / UNKNOWN	DRUG TEST RESULT(S) 1-AMPHETAMINES 2-BARBITURATES 3-BENZODIAZEPINES 4-CANNABINOIDS 5-COCAINE 6-OPiates / OPIOIDS 7-OTHER 8-NEGATIVE RESULTS

LOCAL REPORT NUMBER 22088139

REPORTING AGENCY FAIRFIELD P.D. 00901

DATE OF ACCIDENT M 12 10 03 19 22

IN COUNTY OF BUTLER

ACCIDENT LOCATION South Gilmore Rd. / Annandale Dr.

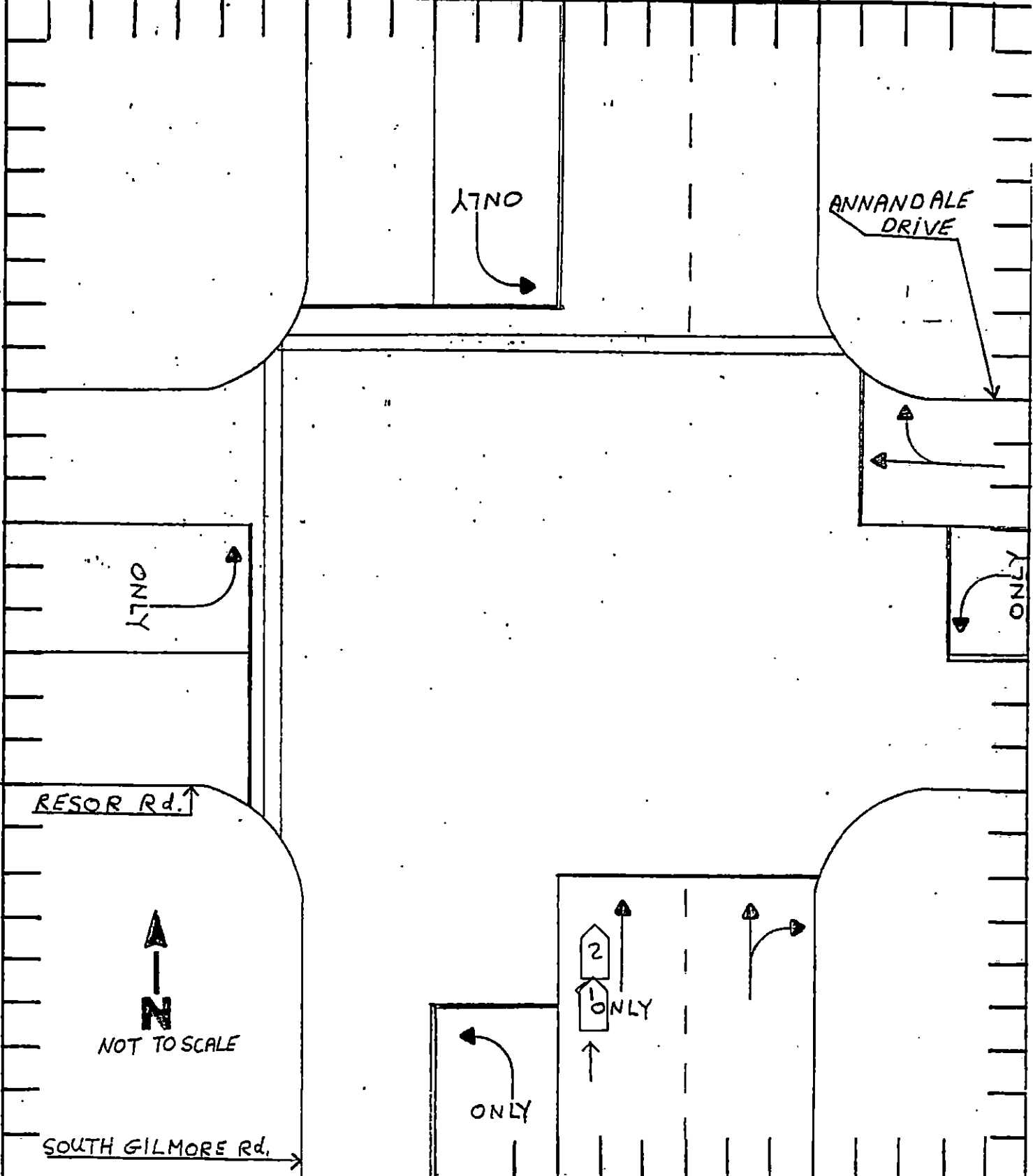

OFFICERS SIGNATURE A. Roush

BADGE NO. 170