

<input checked="" type="checkbox"/> PHOTOS TAKEN	<input checked="" type="checkbox"/> OH-2	<input type="checkbox"/> OH-3	LOCAL INFORMATION	2 2 0 8 9 5 6 0		
<input type="checkbox"/> SECONDARY CRASH	<input type="checkbox"/> OH-1P	<input type="checkbox"/> OTHER	REPORTING AGENCY NAME*	NCIC*	HIT/SKIP 1 - SOLVED 2 - UNSOLVED	NUMBER OF UNITS 0 1
<input checked="" type="checkbox"/> PRIVATE PROPERTY			Fairfield Police Department	0 0 9 0 1		UNIT IN ERROR 98 - ANIMAL 99 - UNKNOWN

COUNTY* 0 9	LOCALITY* 1 - CITY 2 - VILLAGE 3 - TOWNSHIP	LOCATION: CITY, VILLAGE, TOWNSHIP*	CRASH DATE / TIME*	CRASH SEVERITY
	1 2 3	City of Fairfield	12 0 9 2 0 2 2 0 9 3 2	5 1 - FATAL 2 - SERIOUS INJURY SUSPECTED 3 - MINOR INJURY SUSPECTED 4 - INJURY POSSIBLE 5 - PROPERTY DAMAGE ONLY

ROUTE TYPE S R	ROUTE NUMBER 4	PREFIX 1 - NORTH 2 - SOUTH 3 - EAST 4 - WEST	LOCATION ROAD NAME	ROAD TYPE	LATITUDE DECIMAL DEGREES 3 9 3 0 8 0 4 0
ROUTE TYPE	ROUTE NUMBER	PREFIX 1 - NORTH 2 - SOUTH 3 - EAST 4 - WEST	REFERENCE ROAD NAME (ROAD, MILEPOST, HOUSE #) 7255	ROAD TYPE	LONGITUDE DECIMAL DEGREES - 8 4 4 8 8 8 1 0

REFERENCE POINT 1 - INTERSECTION 2 - MILE POST 3 - HOUSE #	DIRECTION FROM REFERENCE 1 - NORTH 2 - SOUTH 3 - EAST 4 - WEST	ROUTE TYPE IR - INTERSTATE ROUTE(TP) US - FEDERAL US ROUTE SR - STATE ROUTE CR - NUMBERED COUNTY ROUTE TR - NUMBERED TOWNSHIP ROUTE	ROAD TYPE AL - ALLEY AV - AVENUE BL - BOULEVARD CR - CIRCLE CT - COURT DR - DRIVE HE - HEIGHTS	ROAD TYPE HW - HIGHWAY LA - LANE MP - MILEPOST OV - OVAL PK - PARKWAY PI - PIKE PL - PLACE	RD - ROAD SQ - SQUARE ST - STREET TE - TERRACE TL - TRAIL WA - WAY	INTERSECTION RELATED <input type="checkbox"/> WITHIN INTERSECTION OR ON APPROACH <input type="checkbox"/> WITHIN INTERCHANGE AREA NUMBER OF APPROACHES
DISTANCE FROM REFERENCE	DISTANCE UNIT OF MEASURE 1 - MILES 2 - FEET 3 - YARDS					<input type="checkbox"/> ROADWAY DIVIDED

LOCATION OF FIRST HARMFUL EVENT 1 - ON ROADWAY 2 - ON SHOULDER 3 - IN MEDIAN 4 - ON ROADSIDE 5 - ON GORE 6 - OUTSIDE TRAFFIC WAY 7 - ON RAMP 8 - OFF RAMP	9 - CROSSOVER 10 - DRIVEWAY/ALLEY ACCESS 11 - RAILWAY GRADE CROSSING 12 - SHARED USE PATHS OR TRAILS 13 - BIKE LANE 14 - TOLL BOOTH 99 - OTHER / UNKNOWN	MANNER OF CRASH COLLISION/IMPACT 1 - NOT COLLISION BETWEEN TWO MOTOR VEHICLES IN TRANSPORT 2 - REAR-END 3 - HEAD-ON 4 - REAR-TO-REAR 5 - BACKING 6 - ANGLE 7 - SIDESWIPE, SAME DIRECTION 8 - SIDESWIPE, OPPOSITE DIRECTION 9 - OTHER / UNKNOWN	DIRECTION OF TRAVEL 1 - NORTH 2 - SOUTH 3 - EAST 4 - WEST	MEDIAN TYPE 1 - DIVIDED FLUSH MEDIAN (<4 FEET) 2 - DIVIDED FLUSH MEDIAN (≥4 FEET) 3 - DIVIDED, DEPRESSED MEDIAN 4 - DIVIDED, RAISED MEDIAN (ANY TYPE) 9 - OTHER/UNKNOWN
---	--	---	---	--

<input type="checkbox"/> WORK ZONE RELATED <input type="checkbox"/> WORKERS PRESENT <input type="checkbox"/> LAW ENFORCEMENT PRESENT <input type="checkbox"/> ACTIVE SCHOOL ZONE	WORK ZONE TYPE 1 - LANE CLOSURE 2 - LANE SHIFT/CROSSOVER 3 - WORK ON SHOULDER OR MEDIAN 4 - INTERMITTENT OR MOVING WORK 5 - OTHER	LOCATION OF CRASH IN WORK ZONE 1 - BEFORE THE 1ST WORK ZONE WARNING SIGN 2 - ADVANCE WARNING AREA 3 - TRANSITION AREA 4 - ACTIVITY AREA 5 - TERMINATION AREA	CONTOUR 1	CONDITIONS 1	SURFACE 2
---	--	---	--------------	-----------------	--------------

LIGHT CONDITION 1 - DAYLIGHT 2 - DAWN/DUSK 3 - DARK - LIGHTED ROADWAY 4 - DARK - ROADWAY NOT LIGHTED 5 - DARK - UNKNOWN ROADWAY LIGHTING 9 - OTHER / UNKNOWN	WEATHER 1 - CLEAR 2 - CLOUDY 3 - FOG, SMOG, SMOKE 4 - RAIN 5 - SLEET, HAIL 6 - SNOW 7 - SEVERE CROSSWINDS 8 - BLOWING SAND, SOIL, DIRT, SNOW 9 - FREEZING RAIN OR FREEZING DRIZZLE 99 - OTHER / UNKNOWN	CONTOUR 9 - OTHER/UNKNOWN	CONDITIONS 5 - SAND, MUD, DIRT, OIL, GRAVEL 6 - WATER (STANDING, MOVING) 7 - SLUSH 9 - OTHER/UNKNOWN	SURFACE 3 - BRICK/BLOCK 4 - SLAG, GRAVEL, STONE 5 - DIRT 9 - OTHER/UNKNOWN
--	---	------------------------------	--	--

NARRATIVE On 12/09/2022 at about 9:32 A.M. Unit 1 was trying to park in a parking spot near 7255 Dixie Hwy. Suite I-J facing northbound. The driver of Unit 1 pressed the gas instead of the brake while thinking the vehicle was in park. The driver ran over a curb, then back onto the pavement and then up another curb/sidewalk and then into the building. The building belongs to: Bhavesh Patel Pat Patel	See OH-2	Indicate the north direction with an "N" on the compass diagram.
---	----------	--

CRASH REPORTED DATE / TIME 12 0 9 2 0 2 2 0 9 3 3	DISPATCH DATE / TIME 12 0 9 2 0 2 2 0 9 3 9	ARRIVAL DATE / TIME 12 0 9 2 0 2 2 0 9 3 9	SCENE CLEARED DATE / TIME 12 0 9 2 0 2 2 1 0 3 6	REPORT TAKEN BY <input checked="" type="checkbox"/> POLICE AGENCY <input type="checkbox"/> MOTORIST
TOTAL TIME ROADWAY CLOSED	OTHER INVESTIGATION TIME	TOTAL MINUTES 5 7	OFFICER'S NAME* P.O. C. Moore	CHECKED BY OFFICER'S NAME* P.O.C. Moore
			OFFICER'S BADGE NUMBER* 1 3 6	CHECKED BY OFFICER'S BADGE NUMBER* 1 3 6

LOCAL REPORT NUMBER
 2, 2, 0, 8, 9, 5, 6, 0

OWNER

UNIT # 011 OWNER NAME: LAST, FIRST, MIDDLE (☒ SAME AS DRIVER)
Flowers, Veronica

OWNER ADDRESS: STREET, CITY, STATE, ZIP (☒ SAME AS DRIVER)
 11565 Norbourne Dr. Cincinnati, OH 45240

COMMERCIAL CARRIER: NAME, ADDRESS, CITY, STATE, ZIP
 COMMERCIAL CARRIER PHONE: INCLUDE AREA CODE

DAMAGE

DAMAGE SCALE

4 1 - NONE 3 - FUNCTIONAL DAMAGE
 2 - MINOR DAMAGE 4 - DISABLING DAMAGE
 9 - UNKNOWN

VEHICLE

LP STATE OH LICENSE PLATE # HTK6409 VEHICLE IDENTIFICATION # JF2S1H16116319H17931916 VEHICLE YEAR 2009 VEHICLE MAKE Subaru

INSURANCE VERIFIED INSURANCE COMPANY State Farm Ins. INSURANCE POLICY # C749703D213S COLOR Gray VEHICLE MODEL Forester

DAMAGED AREA(S)
 INDICATE ALL THAT APPLY

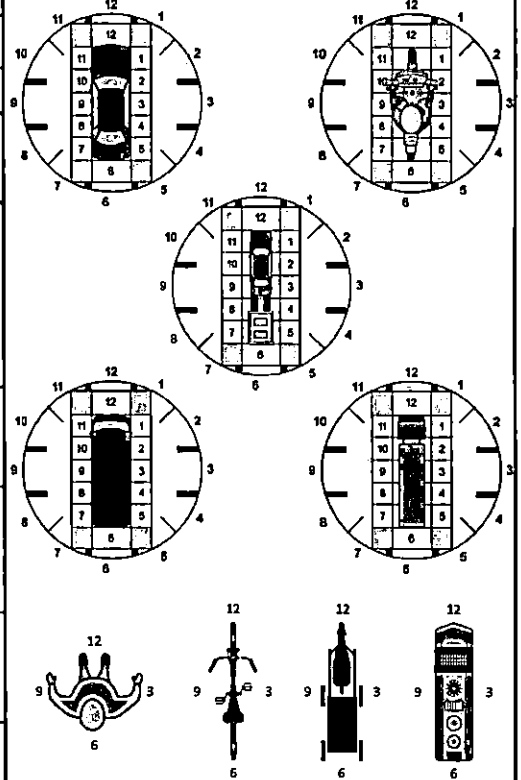

TYPE OF USE: COMMERCIAL GOVERNMENT IN EMERGENCY RESPONSE

US DOT # _____ TOWED BY: COMPANY NAME Wayne's Towing

HAZARDOUS MATERIAL: MATERIAL RELEASED PLACARD CLASS # _____ PLACARD ID # _____

INTERLOCK DEVICE EQUIPPED HIT/SKIP UNIT #OCCUPANTS 01 VEHICLE WEIGHT GVWR/GCWR: 1 - <10K LBS., 2 - 10,001 - 26K LBS., 3 - >26K LBS.

UNIT TYPE: 1 - PASSENGER CAR, 2 - PASSENGER VAN (MINIVAN), 3 - SPORT UTILITY VEHICLE, 4 - PICK UP, 5 - CARGOVAN, 6 - VAN (9-15 SEATS), 7 - MOTORCYCLE 2-WHEELED, 8 - MOTORCYCLE 3-WHEELED, 9 - AUTOCYCLE, 10 - MOPED OR MOTORIZED BICYCLE, 11 - ALL TERRAIN VEHICLE (ATV/UTV), 12 - GOLF CART, 13 - SNOWMOBILE, 14 - SINGLE UNIT TRUCK, 15 - SEMI-TRACTOR, 16 - FARM EQUIPMENT, 17 - MOTORHOME, 18 - LIMO (LIVERY VEHICLE), 19 - BUS (16+ PASSENGERS), 20 - OTHER VEHICLE, 21 - HEAVY EQUIPMENT, 22 - ANIMAL WITH RIDER OR ANIMAL-DRAWN VEHICLE, 23 - PEDESTRIAN / SKATER, 24 - WHEELCHAIR (ANY TYPE), 25 - OTHER NON-MOTORIST, 26 - BICYCLE, 27 - TRAIN, 99 - UNKNOWN OR HIT/SKIP

WAS VEHICLE OPERATING IN AUTONOMOUS MODE WHEN CRASH OCCURRED? 0 1 - YES 2 - NO 9 - OTHER / UNKNOWN

AUTONOMOUS MODE LEVEL: 0 1 - DRIVER ASSISTANCE, 2 - PARTIAL AUTOMATION, 3 - CONDITIONAL AUTOMATION, 4 - HIGH AUTOMATION, 5 - FULL AUTOMATION, 9 - UNKNOWN

SPECIAL FUNCTION: 1 - NONE, 2 - TAXI, 3 - ELECTRONIC RIDE SHARING, 4 - SCHOOL TRANSPORT, 5 - BUS - TRANSIT/COMMUTER, 6 - BUS - CHARTER/TOUR, 7 - BUS - INTERCITY, 8 - BUS - SHUTTLE, 9 - BUS - OTHER, 10 - AMBULANCE, 11 - FIRE, 12 - MILITARY, 13 - POLICE, 14 - PUBLIC UTILITY, 15 - CONSTRUCTION EQUIPMENT, 16 - FARM, 17 - MOWING, 18 - SNOW REMOVAL, 19 - TOWING, 20 - SAFETY SERVICE PATROL, 21 - MAIL CARRIER, 99 - OTHER / UNKNOWN

CARGO BODY TYPE: 1 - NO CARGO BODY TYPE / NOT APPLICABLE, 2 - BUS, 3 - VEHICLE TOWING ANOTHER MOTOR VEHICLE, 4 - LOGGING, 5 - INTERMODAL CONTAINER CHASSIS, 6 - CARGO VAN/ENCLOSED BOX, 7 - GRAIN/CHIPS/GRAVEL, 8 - POLE, 9 - CARGO TANK, 10 - FLAT BED, 11 - DUMP, 12 - CONCRETE MIXER, 13 - AUTO TRANSPORTER, 14 - GARBAGE/REFUSE, 99 - OTHER / UNKNOWN

VEHICLE DEFECTS: 1 - TURN SIGNALS, 2 - HEAD LAMPS, 3 - TAIL LAMPS, 4 - BRAKES, 5 - STEERING, 6 - TIRE BLOWOUT, 7 - WORN OR SLICK TIRES, 8 - TRAILER EQUIPMENT DEFECTIVE, 9 - MOTOR TROUBLE, 10 - DISABLED FROM PRIOR ACCIDENT, 99 - OTHER / UNKNOWN

NON-MOTORIST LOCATION AT IMPACT: 1 - INTERSECTION - MARKED CROSSWALK, 2 - INTERSECTION - UNMARKED CROSSWALK, 3 - INTERSECTION - OTHER, 4 - MIDBLOCK - MARKED CROSSWALK, 5 - TRAVEL LANE - OTHER LOCATION, 6 - BICYCLE LANE, 7 - SHOULDER / ROADSIDE, 8 - SIDEWALK, 9 - MEDIAN/CROSSING ISLAND, 10 - DRIVEWAY ACCESS, 11 - SHARED USE PATHS OR TRAILS, 12 - FIRST RESPONDER AT INCIDENT SCENE, 99 - OTHER / UNKNOWN

ACTION: 1 - NON-CONTACT, 2 - NON-COLLISION, 3 - STRIKING, 4 - STRUCK, 5 - BOTH STRIKING & STRUCK, 9 - OTHER / UNKNOWN, 1 - STRAIGHT AHEAD, 2 - BACKING, 3 - CHANGING LANES, 4 - OVERTAKING/PASSING, 5 - MAKING RIGHT TURN, 6 - MAKING LEFT TURN, 7 - MAKING U-TURN, 8 - ENTERING TRAFFIC LANE, 9 - LEAVING TRAFFIC LANE, 10 - PARKED, 11 - SLOWING OR STOPPED IN TRAFFIC, 12 - DRIVERLESS, 13 - NEGOTIATING A CURVE OR CROSSING SPECIFIED LOCATION, 14 - ENTERING OR CROSSING SPECIFIED LOCATION, 15 - WALKING, RUNNING, JOGGING, PLAYING, 16 - WORKING, 17 - PUSHING VEHICLE, 18 - APPROACHING OR LEAVING VEHICLE, 19 - STANDING, 20 - OTHER NON-MOTORIST, 21 - STANDING OUTSIDE DISABLED VEHICLE, 99 - OTHER / UNKNOWN

- NO DAMAGE [0] - UNDERCARRIAGE [14]
 - TOP [13] - ALL AREAS [15]
 - UNIT NOT AT SCENE [16]

CONTRIBUTING CIRCUMSTANCES: 1 - NONE, 2 - FAILURE TO YIELD, 3 - RAN RED LIGHT, 4 - RAN STOP SIGN, 5 - UNSAFE SPEED, 6 - IMPROPER TURN, 7 - LEFT OF CENTER, 8 - FOLLOWING TOO CLOSE / ACDA, 9 - IMPROPER LANE CHANGE, 10 - IMPROPER PASSING, 11 - DROVE OFF ROAD, 12 - IMPROPER BACKING, 13 - IMPROPER START FROM A PARKED POSITION, 14 - STOPPED OR PARKED ILLEGALLY, 15 - SWERVING TO AVOID, 16 - WRONG WAY, 17 - VISION OBSTRUCTION, 18 - OPERATING DEFECTIVE EQUIPMENT, 19 - LOAD SHIFTING/FALLING/SPILLING, 20 - IMPROPER CROSSING, 21 - LYING IN ROADWAY, 22 - NOT DISCERNIBLE, 23 - OPENING DOOR INTO ROADWAY, 99 - OTHER IMPROPER ACTION

INITIAL POINT OF CONTACT: 0 - NO DAMAGE, 1-12 - REFER TO UNIT DIAGRAM, 13 - TOP, 14 - UNDERCARRIAGE, 15 - VEHICLE NOT AT SCENE, 99 - UNKNOWN

SEQUENCE OF EVENTS: 1 4, 3, 2 4, 3, 3 5, 2

NON-COLLISION: 1 - OVERTURN/ROLLOVER, 2 - FIRE/EXPLOSION, 3 - IMMERSION, 4 - JACKKNIFE, 5 - CARGO/EQUIPMENT LOSS OR SHIFT, 6 - EQUIPMENT FAILURE, 7 - SEPARATION OF UNITS, 8 - RAN OFF ROAD RIGHT, 9 - RAN OFF ROAD LEFT, 10 - CROSS MEDIAN, 11 - CROSS CENTERLINE - OPPOSITE DIRECTION OF TRAVEL, 12 - DOWNHILL RUNAWAY, 13 - OTHER NON-COLLISION, 14 - PEDESTRIAN, 15 - PEDALCYCLE, 16 - RAILWAY VEHICLE, 17 - ANIMAL - FARM, 18 - ANIMAL - DEER, 19 - ANIMAL - OTHER, 20 - MOTOR VEHICLE IN TRANSPORT, 21 - PARKED MOTOR VEHICLE, 22 - WORK ZONE MAINTENANCE EQUIPMENT, 23 - STRUCK BY FALLING, SHIFTING CARGO OR ANYTHING SET IN MOTION BY A MOTOR VEHICLE, 24 - OTHER MOVABLE OBJECT

TRAFFIC: TRAFFICWAY FLOW: 1 - ONE-WAY, 2 - TWO-WAY, TRAFFIC CONTROL: 1 - ROUNDABOUT, 2 - SIGNAL, 3 - FLASHER, 4 - STOP SIGN, 5 - YIELD SIGN, 6 - NO CONTROL

COLLISION WITH FIXED OBJECT - STRUCK: 25 - IMPACT ATTENUATOR / CRASH CUSHION, 26 - BRIDGE OVERHEAD STRUCTURE, 27 - BRIDGE PIER OR ABUTMENT, 28 - BRIDGE PARAPET, 29 - BRIDGE RAIL, 30 - GUARDRAIL FACE, 31 - GUARDRAIL END, 32 - PORTABLE BARRIER, 33 - MEDIAN CABLE BARRIER, 34 - MEDIAN GUARDRAIL BARRIER, 35 - MEDIAN CONCRETE BARRIER, 36 - MEDIAN OTHER BARRIER, 37 - TRAFFIC SIGN POST, 38 - OVERHEAD SIGN POST, 39 - LIGHT / LUMINARIES SUPPORT, 40 - UTILITY POLE, 41 - OTHER POST, POLE OR SUPPORT, 42 - CULVERT, 43 - CURB, 44 - DITCH, 45 - EMBANKMENT, 46 - FENCE, 47 - MAILBOX, 48 - TREE, 49 - FIRE HYDRANT, 50 - WORK ZONE MAINTENANCE EQUIPMENT, 51 - WALL, 52 - BUILDING, 53 - TUNNEL, 54 - OTHER FIXED OBJECT, 99 - OTHER / UNKNOWN

OF THROUGH LANES ON ROAD: 2 RAIL GRADE CROSSING: 1 - NOT INVOLVED, 2 - INVOLVED-ACTIVE CROSSING, 3 - INVOLVED-PASSIVE CROSSING

UNIT / NON-MOTORIST DIRECTION: FROM 2 TO 1

UNIT SPEED: 20 POSTED SPEED: _____ DETECTED SPEED: 1 1 - STATED / ESTIMATED SPEED, 2 - CALCULATED / EDR, 3 - UNDETERMINED



MOTORIST / Non-MOTORIST

LOCAL REPORT NUMBER
2 2 0 8 9 5 6 0

UNIT # 0 1	NAME: LAST, FIRST, MIDDLE Flowers, Veronica	DATE OF BIRTH 0 6 2 0 1 9 7 0	AGE 5 2	GENDER F
----------------------	---	---	-------------------	--------------------

ADDRESS: STREET, CITY, STATE, ZIP 11565 Norbourne Dr. Cincinnati, OH 45240	CONTACT PHONE - INCLUDE AREA CODE
--	--

INJURIES 5	INJURED TAKEN BY	EMS AGENCY (NAME)	INJURED TAKEN TO: MEDICAL FACILITY (NAME, CITY)	SAFETY EQUIPMENT USED 0 4	<input type="checkbox"/> DOT-COMPLIANT MC HELMET	SEATING POSITION 0 1	AIR BAG USAGE 1	EJECTION 1	TRAPPED 1
----------------------	-------------------------	--------------------------	--	-------------------------------------	--	--------------------------------	---------------------------	----------------------	---------------------

OL STATE O H	OPERATOR LICENSE NUMBER	OFFENSE CHARGED 331.34a	LOCAL CODE <input checked="" type="checkbox"/>	OFFENSE DESCRIPTION Failure To Control	CITATION NUMBER 255542
------------------------	--------------------------------	-----------------------------------	--	--	----------------------------------

OL CLASS 04	ENDORSEMENT SELECT UP TO 2	RESTRICTION SELECT UP TO 3 0 3	DRIVER DISTRACTED BY 1	ALCOHOL / DRUG SUSPECTED <input type="checkbox"/> ALCOHOL <input type="checkbox"/> MARIJUANA <input type="checkbox"/> OTHER DRUG	CONDITION 01	ALCOHOL TEST			DRUG TEST(S)		
STATUS	TYPE	VALUE	STATUS	TYPE	RESULT SELECT UP TO 4						

UNIT #	NAME: LAST, FIRST, MIDDLE	DATE OF BIRTH	AGE 0	GENDER
---------------	----------------------------------	----------------------	-----------------	---------------

ADDRESS: STREET, CITY, STATE, ZIP	CONTACT PHONE - INCLUDE AREA CODE
--	--

INJURIES	INJURED TAKEN BY	EMS AGENCY (NAME)	INJURED TAKEN TO: MEDICAL FACILITY (NAME, CITY)	SAFETY EQUIPMENT USED	<input type="checkbox"/> DOT-COMPLIANT MC HELMET	SEATING POSITION	AIR BAG USAGE	EJECTION	TRAPPED
-----------------	-------------------------	--------------------------	--	------------------------------	--	-------------------------	----------------------	-----------------	----------------

OL STATE	OPERATOR LICENSE NUMBER	OFFENSE CHARGED	LOCAL CODE <input type="checkbox"/>	OFFENSE DESCRIPTION	CITATION NUMBER
-----------------	--------------------------------	------------------------	---	----------------------------	------------------------

OL CLASS	ENDORSEMENT SELECT UP TO 2	RESTRICTION SELECT UP TO 3	DRIVER DISTRACTED BY	ALCOHOL / DRUG SUSPECTED <input type="checkbox"/> ALCOHOL <input type="checkbox"/> MARIJUANA <input type="checkbox"/> OTHER DRUG	CONDITION	ALCOHOL TEST			DRUG TEST(S)		
STATUS	TYPE	VALUE	STATUS	TYPE	RESULT SELECT UP TO 4						

UNIT #	NAME: LAST, FIRST, MIDDLE	DATE OF BIRTH	AGE 0	GENDER
---------------	----------------------------------	----------------------	-----------------	---------------

ADDRESS: STREET, CITY, STATE, ZIP	CONTACT PHONE - INCLUDE AREA CODE
--	--

INJURIES	INJURED TAKEN BY	EMS AGENCY (NAME)	INJURED TAKEN TO: MEDICAL FACILITY (NAME, CITY)	SAFETY EQUIPMENT USED	<input type="checkbox"/> DOT-COMPLIANT MC HELMET	SEATING POSITION	AIR BAG USAGE	EJECTION	TRAPPED
-----------------	-------------------------	--------------------------	--	------------------------------	--	-------------------------	----------------------	-----------------	----------------

OL STATE	OPERATOR LICENSE NUMBER	OFFENSE CHARGED	LOCAL CODE <input type="checkbox"/>	OFFENSE DESCRIPTION	CITATION NUMBER
-----------------	--------------------------------	------------------------	---	----------------------------	------------------------

OL CLASS	ENDORSEMENT SELECT UP TO 2	RESTRICTION SELECT UP TO 3	DRIVER DISTRACTED BY	ALCOHOL / DRUG SUSPECTED <input type="checkbox"/> ALCOHOL <input type="checkbox"/> MARIJUANA <input type="checkbox"/> OTHER DRUG	CONDITION	ALCOHOL TEST			DRUG TEST(S)		
STATUS	TYPE	VALUE	STATUS	TYPE	RESULT SELECT UP TO 4						

INJURIES	SEATING POSITION	AIR BAG	OL CLASS	OL RESTRICTION(S)	DRIVER DISTRACTION	TEST STATUS
1-FATAL 2-SUSPECTED SERIOUS INJURY 3-SUSPECTED MINOR INJURY 4-POSSIBLE INJURY 5-NO APPARENT INJURY	1-FRONT-LEFT SIDE (MOTORCYCLE DRIVER) 2-FRONT-MIDDLE 3-FRONT-RIGHT SIDE 4-SECOND-LEFT SIDE (MOTORCYCLE PASSENGER) 5-SECOND-MIDDLE 6-SECOND-RIGHT SIDE 7-THIRD-LEFT SIDE (MOTORCYCLE SIDE CAR) 8-THIRD-MIDDLE 9-THIRD-RIGHT SIDE 10-SLEEPER SECTION OF TRUCK CAB	1-NOT DEPLOYED 2-DEPLOYED FRONT 3-DEPLOYED SIDE 4-DEPLOYED BOTH FRONT/SIDE 5-NOT APPLICABLE 9-DEPLOYMENT UNKNOWN	1-CLASS A 2-CLASS B 3-CLASS C 4-REGULAR CLASS (OHIO = D) 5-M/C MOPED ONLY 6-NO VALID DL	1-ALCOHOL INTERLOCK DEVICE 2-CDL INTRASTATE ONLY 3-CORRECTIVE LENSES 4-FARM WAIVER 5-EXCEPT CLASS A BUS & CLASS B BUS 6-EXCEPT CLASS A & CLASS B BUS 7-EXCEPT TRACTOR-TRAILER 8-INTERMEDIATE LICENSE RESTRICTIONS 9-LEARNER'S PERMIT RESTRICTIONS 10-LIMITED TO DAYLIGHT ONLY 11-LIMITED TO EMPLOYMENT 12-LIMITED-OTHER 13-MECHANICAL DEVICES (SPECIAL BRAKES, HAND CONTROLS, OR OTHER ADAPTIVE DEVICES) 14-MILITARY VEHICLES ONLY 15-MOTOR VEHICLES WITHOUT AIR BRAKES 16-OUTSIDE MIRROR 17-PROSTHETIC AID 18-OTHER	1-NOT DISTRACTED 2-MANUALLY OPERATING AN ELECTRONIC COMMUNICATION DEVICE (TEXTING, TYPING, DIALING) 3-TALKING ON HANDS-FREE COMMUNICATION DEVICE 4-TALKING ON HAND-HELD COMMUNICATION DEVICE 5-OTHER ACTIVITY WITH AN ELECTRONIC DEVICE 6-PASSENGER 7-OTHER DISTRACTION INSIDE THE VEHICLE 8-OTHER DISTRACTION OUTSIDE THE VEHICLE 9-OTHER/UNKNOWN	1-NONE GIVEN 2-TEST REFUSED 3-TEST GIVEN, CONTAMINATED SAMPLE / UNUSABLE 4-TEST GIVEN, RESULTS KNOWN 5-TEST GIVEN, RESULTS UNKNOWN
INJURED TAKEN BY	EJECTION	TRAPPED	OL ENDORSEMENT	CONDITION	ALCOHOL TEST TYPE	DRUG TEST TYPE
1-NOT TRANSPORTED / TREATED AT SCENE 2-EMS 3-POLICE 9-OTHER / UNKNOWN	1-NOT EJECTED 2-PARTIALLY EJECTED 3-TOTALLY EJECTED 4-NOT APPLICABLE	1-NOT TRAPPED 2-EXTRICATED BY MECHANICAL MEANS 3-FREED BY NON-MECHANICAL MEANS	H-HAZMAT M-MOTORCYCLE P-PASSENGER N-TANKER Q-MOTOR SCOOTER R-THREE-WHEEL MOTORCYCLE S-SCHOOL BUS T-DOUBLE & TRIPLE TRAILERS X-TANKER / HAZMAT	1-APPARENTLY NORMAL 2-PHYSICAL IMPAIRMENT 3-EMOTIONAL (E.G. DEPRESSED, ANGRY, DISTURBED) 4-ILLNESS 5-FELL ASLEEP, FAINTED, FATIGUED, ETC. 6-UNDER THE INFLUENCE OF MEDICATIONS / DRUGS / ALCOHOL 9-OTHER / UNKNOWN	1-NONE 2-BLOOD 3-URINE 4-BREATH 5-OTHER	1-NONE 2-BLOOD 3-URINE 4-OTHER
SAFETY EQUIPMENT	TRAPPED	TRAPPED	GENDER	CONDITION	DRUG TEST RESULT(S)	DRUG TEST RESULT(S)
1-NONE USED 2-SHOULDER BELT ONLY USED 3-LAP BELT ONLY USED 4-SHOULDER & LAP BELT USED 5-CHILD RESTRAINT SYSTEM FORWARD FACING 6-CHILD RESTRAINT SYSTEM REAR FACING 7-BOOSTER SEAT 8-HELMET USED 9-PROTECTIVE PADS USED (ELBOW, KNEES, ETC.) 10-REFLECTIVE CLOTHING 11-LIGHTING-PEDESTRIAN / BICYCLE ONLY 99-OTHER / UNKNOWN	1-NOT TRAPPED 2-EXTRICATED BY MECHANICAL MEANS 3-FREED BY NON-MECHANICAL MEANS	1-NOT TRAPPED 2-EXTRICATED BY MECHANICAL MEANS 3-FREED BY NON-MECHANICAL MEANS	F-FEMALE M-MALE U-OTHER / UNKNOWN	1-APPARENTLY NORMAL 2-PHYSICAL IMPAIRMENT 3-EMOTIONAL (E.G. DEPRESSED, ANGRY, DISTURBED) 4-ILLNESS 5-FELL ASLEEP, FAINTED, FATIGUED, ETC. 6-UNDER THE INFLUENCE OF MEDICATIONS / DRUGS / ALCOHOL 9-OTHER / UNKNOWN	1-NONE 2-BLOOD 3-URINE 4-OTHER	1-AMPHETAMINES 2-BARBITURATES 3-BENZODIAZEPINES 4-CANNABINOIDS 5-COCAINE 6-OPIATES / OPIOIDS 7-OTHER 8-NEGATIVE RESULTS

LOCAL REPORT NUMBER PD-22-089560	REPORTING AGENCY Fairfield Police Department	DATE OF ACCIDENT 12/9/22
--	--	------------------------------------

IN COUNTY OF Butler	ACCIDENT LOCATION 7255 Dixie Hwy. Suite I-J Fairfield, OH 45014
-------------------------------	---

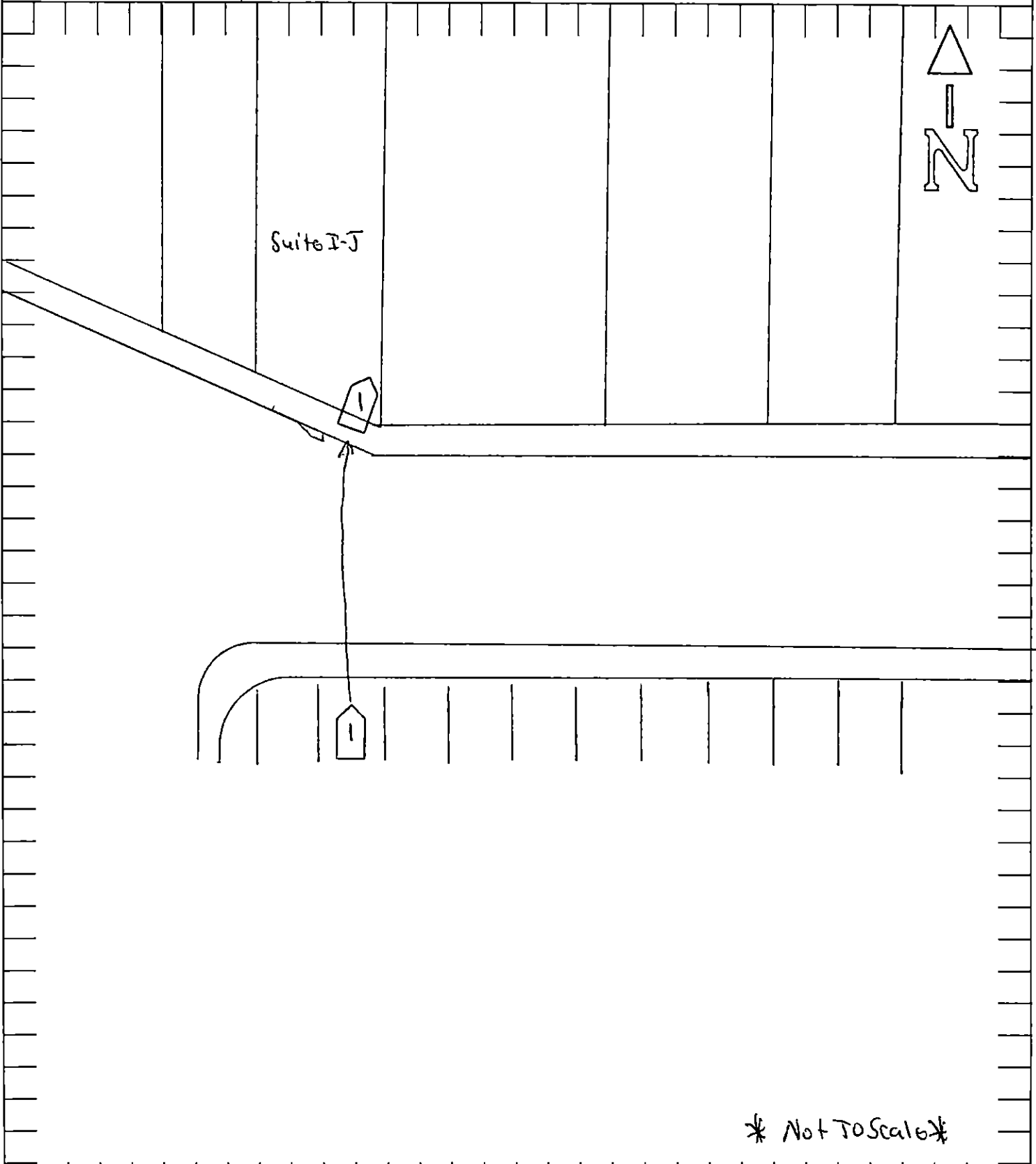

OFFICER'S SIGNATURE [Redacted]	OFFICER'S SIGNATURE P.O. C. Moore	BADGE NO. 136
--	---	-------------------------