

TRAFFIC CRASH REPORT

\*DENOTES MANDATORY FIELD FOR SUPPLEMENT REPORT

LOCAL REPORT NUMBER\*

<input checked="" type="checkbox"/> PHOTOS TAKEN	<input checked="" type="checkbox"/> OH-2	<input type="checkbox"/> OH-3	LOCAL INFORMATION		2 3 0 0 0 8 1 7		
<input type="checkbox"/> SECONDARY CRASH	<input type="checkbox"/> OH-1P	<input type="checkbox"/> OTHER	REPORTING AGENCY NAME*		NCIC*		HIT/SKIP
<input type="checkbox"/> PRIVATE PROPERTY	Fairfield Police Department		0 0 9 0 1		2 1 - SOLVED		NUMBER OF UNITS
						0 2	
						UNIT IN ERROR	
						0 1 99 - UNKNOWN	

COUNTY*	LOCALITY*	LOCATION: CITY, VILLAGE, TOWNSHIP*		CRASH DATE / TIME*	CRASH SEVERITY
0 9	1	City of Fairfield		0 1 0 4 2 0 2 3 1 5 4 8	5

ROUTE TYPE	ROUTE NUMBER	PREFIX	1 - NORTH 2 - SOUTH 3 - EAST 4 - WEST	LOCATION ROAD NAME	ROAD TYPE	LATITUDE DECIMAL DEGREES	1 - FATAL 2 - SERIOUS INJURY SUSPECTED 3 - MINOR INJURY SUSPECTED 4 - INJURY POSSIBLE 5 - PROPERTY DAMAGE ONLY
				Union Centre	B L	3 9 . 3 4 3 8 7 5	
ROUTE TYPE	ROUTE NUMBER	PREFIX	1 - NORTH 2 - SOUTH 3 - EAST 4 - WEST	REFERENCE ROAD NAME (ROAD, MILEPOST, HOUSE #)	ROAD TYPE	LONGITUDE DECIMAL DEGREES	
				Seward	R D	8 4 . 4 9 0 8 2 8	

REFERENCE POINT	DIRECTION FROM REFERENCE	ROUTE TYPE	ROAD TYPE	INTERSECTION RELATED	
1 - INTERSECTION	1 - NORTH	IR - INTERSTATE ROUTE (TP)	AL - ALLEY	<input checked="" type="checkbox"/> WITHIN INTERSECTION OR ON APPROACH	4 NUMBER OF APPROACHES
2 - MILE POST	2 - SOUTH	US - FEDERAL US ROUTE	AV - AVENUE	<input type="checkbox"/> WITHIN INTERCHANGE AREA	
3 - HOUSE #	3 - EAST	SR - STATE ROUTE	BL - BOULEVARD	ROADWAY	
	4 - WEST	CR - NUMBERED COUNTY ROUTE	MP - MILEPOST	<input type="checkbox"/> ROADWAY DIVIDED	
DISTANCE FROM REFERENCE	DISTANCE UNIT OF MEASURE	TR - NUMBERED TOWNSHIP ROUTE	OV - OVAL		
2 0	1 - MILES		PK - PARKWAY		
	2 - FEET		TL - TRAIL		
	3 - YARDS		WA - WAY		

LOCATION OF FIRST HARMFUL EVENT		MANNER OF CRASH COLLISION/IMPACT		DIRECTION OF TRAVEL	MEDIAN TYPE
1 - ON ROADWAY	9 - CROSSOVER	1 - NOT COLLISION BETWEEN TWO MOTOR VEHICLES IN TRANSPORT	4 - REAR-TO-REAR	1 - NORTH	1 - DIVIDED FLUSH MEDIAN (<4 FEET)
2 - ON SHOULDER	10 - DRIVEWAY/ALLEY ACCESS	2 - REAR-END	5 - BACKING	2 - SOUTH	2 - DIVIDED FLUSH MEDIAN (≥4 FEET)
3 - IN MEDIAN	11 - RAILWAY GRADE CROSSING	3 - HEAD-ON	6 - ANGLE	3 - EAST	3 - DIVIDED, DEPRESSED MEDIAN
4 - ON ROADSIDE	12 - SHARED USE PATHS OR TRAILS		7 - SIDESWIPE, SAME DIRECTION	4 - WEST	4 - DIVIDED, RAISED MEDIAN (ANY TYPE)
5 - ON GORE	13 - BIKE LANE		8 - SIDESWIPE, OPPOSITE DIRECTION		9 - OTHER/UNKNOWN
6 - OUTSIDE TRAFFIC WAY	14 - TOLL BOOTH		9 - OTHER / UNKNOWN		
7 - ON RAMP	99 - OTHER / UNKNOWN				
8 - OFF RAMP					

<input type="checkbox"/> WORK ZONE RELATED	<input type="checkbox"/> WORKERS PRESENT	<input type="checkbox"/> LAW ENFORCEMENT PRESENT	<input type="checkbox"/> ACTIVE SCHOOL ZONE	WORK ZONE TYPE	LOCATION OF CRASH IN WORK ZONE	CONTOUR	CONDITIONS	SURFACE
				1 - LANE CLOSURE	1 - BEFORE THE 1ST WORK ZONE WARNING SIGN	1	1	2
				2 - LANE SHIFT/CROSSOVER	2 - ADVANCE WARNING AREA			
				3 - WORK ON SHOULDER OR MEDIAN	3 - TRANSITION AREA			
				4 - INTERMITTENT OR MOVING WORK	4 - ACTIVITY AREA			
				5 - OTHER	5 - TERMINATION AREA			

LIGHT CONDITION	WEATHER
1 - DAYLIGHT	1 - CLEAR
2 - DAWN/DUSK	2 - CLOUDY
3 - DARK - LIGHTED ROADWAY	3 - FOG, SMOG, SMOKE
4 - DARK - ROADWAY NOT LIGHTED	4 - RAIN
5 - DARK - UNKNOWN ROADWAY LIGHTING	5 - SLEET, HAIL
9 - OTHER / UNKNOWN	6 - SNOW
	7 - SEVERE CROSSWINDS
	8 - BLOWING SAND, SOIL, DIRT, SNOW
	9 - FREEZING RAIN OR FREEZING DRIZZLE
	99 - OTHER / UNKNOWN

NARRATIVE	Indicate the north direction with an "N" on the compass diagram.
On 01-04-2023 at 3:48 PM Unit 1 was traveling westbound on Union Center Blvd and when approaching the intersection of Union Center Blvd and Seward Rd. failed to stop within the assured clear distance ahead and collided with Unit 2 who was stopped in the westbound traffic at the light.	SEE OH-2
Unit 1 left the scene without exchanging information with the other unit or police.	

CRASH REPORTED DATE / TIME	DISPATCH DATE / TIME	ARRIVAL DATE / TIME	SCENE CLEARED DATE / TIME	REPORT TAKEN BY
0 1 0 4 2 0 2 3 1 5 4 8	0 1 0 4 2 0 2 3 1 5 5 3	0 1 0 4 2 0 2 3 1 5 5 5	0 1 0 4 2 0 2 3 1 6 0 5	<input checked="" type="checkbox"/> POLICE AGENCY
TOTAL TIME ROADWAY CLOSED	OTHER INVESTIGATION TIME	TOTAL MINUTES	OFFICER'S NAME*	<input type="checkbox"/> MOTORIST
	1 0	2 2	T. King	<input type="checkbox"/> SUPPLEMENT (CORRECTION OR ADDITION TO AN EXISTING REPORT SENT TO OOSP)
			OFFICER'S BADGE NUMBER*	
			1 6 1	
			CHECKED BY OFFICER'S NAME*	
			D. Port	
			CHECKED BY OFFICER'S BADGE NUMBER*	
			1 3 0	

**OWNER**

UNIT # 012 OWNER NAME: LAST, FIRST, MIDDLE (SAME AS DRIVER) \_\_\_\_\_ OWNER PHONE: (INCLUDE AREA CODE) (SAME AS DRIVER) \_\_\_\_\_

OWNER ADDRESS: STREET, CITY, STATE, ZIP (SAME AS DRIVER) \_\_\_\_\_

COMMERCIAL CARRIER: NAME, ADDRESS, CITY, STATE, ZIP \_\_\_\_\_ COMMERCIAL CARRIER PHONE: (INCLUDE AREA CODE) \_\_\_\_\_

**VEHICLE**

LP STATE \_\_\_\_\_ LICENSE PLATE # \_\_\_\_\_ VEHICLE IDENTIFICATION # \_\_\_\_\_ VEHICLE YEAR \_\_\_\_\_ VEHICLE MAKE \_\_\_\_\_

INSURANCE VERIFIED  INSURANCE COMPANY \_\_\_\_\_ INSURANCE POLICY # \_\_\_\_\_ COLOR \_\_\_\_\_ VEHICLE MODEL \_\_\_\_\_

TYPE OF USE:  COMMERCIAL  GOVERNMENT  IN EMERGENCY RESPONSE

US DOT # \_\_\_\_\_ TOWED BY: COMPANY NAME \_\_\_\_\_

HAZARDOUS MATERIAL:  MATERIAL RELEASED  PLACARD CLASS # \_\_\_\_\_ PLACARD ID # \_\_\_\_\_

UNIT TYPE 01

1 - PASSENGER CAR	7 - MOTORCYCLE 2-WHEELED	12 - GOLF CART	18 - LIMO (LIVERY VEHICLE)	23 - PEDESTRIAN / SKATER
2 - PASSENGER VAN (MINIVAN)	8 - MOTORCYCLE 3-WHEELED	13 - SNOWMOBILE	19 - BUS (16+ PASSENGERS)	24 - WHEELCHAIR (ANY TYPE)
3 - SPORT UTILITY VEHICLE	9 - AUTOCYCLE	14 - SINGLE UNIT TRUCK	20 - OTHER VEHICLE	25 - OTHER NON-MOTORIST
4 - PICK UP	10 - MOPED OR MOTORIZED BICYCLE	15 - SEMI-TRACTOR	21 - HEAVY EQUIPMENT	26 - BICYCLE
5 - CARGOVAN	11 - ALL TERRAIN VEHICLE (ATV / UTV)	16 - FARM EQUIPMENT	22 - ANIMAL WITH RIDER OR ANIMAL-DRAWN VEHICLE	27 - TRAIN
6 - VAN (9-15 SEATS)		17 - MOTORHOME		99 - UNKNOWN OR HIT/SKIP

# of TRAILING UNITS 0

WAS VEHICLE OPERATING IN AUTONOMOUS MODE WHEN CRASH OCCURRED? 09

1 - YES 2 - NO 9 - OTHER / UNKNOWN

AUTONOMOUS MODE LEVEL 0

0 - NO AUTOMATION 1 - DRIVER ASSISTANCE 2 - PARTIAL AUTOMATION 3 - CONDITIONAL AUTOMATION 4 - HIGH AUTOMATION 5 - FULL AUTOMATION 9 - UNKNOWN

SPECIAL FUNCTION 01

1 - NONE	6 - BUS - CHARTER/TOUR	11 - FIRE	16 - FARM	21 - MAIL CARRIER
2 - TAXI	7 - BUS - INTERCITY	12 - MILITARY	17 - MOWING	99 - OTHER / UNKNOWN
3 - ELECTRONIC RIDE SHARING	8 - BUS - SHUTTLE	13 - POLICE	18 - SNOW REMOVAL	
4 - SCHOOL TRANSPORT	9 - BUS - OTHER	14 - PUBLIC UTILITY	19 - TOWING	
5 - BUS - TRANSIT/COMMUTER	10 - AMBULANCE	15 - CONSTRUCTION EQUIPMENT	20 - SAFETY SERVICE PATROL	

CARGO BODY TYPE 01

1 - NO CARGO BODY TYPE / NOT APPLICABLE	3 - VEHICLE TOWING ANOTHER MOTOR VEHICLE	5 - INTERMODAL CONTAINER CHASSIS	8 - POLE	12 - CONCRETE MIXER
2 - BUS	4 - LOGGING	6 - CARGO VAN/ENCLOSED BOX	9 - CARGO TANK	13 - AUTO TRANSPORTER
		7 - GRAIN/CHIPS/GRAVEL	10 - FLAT BED	14 - GARBAGE/REFUSE
			11 - DUMP	99 - OTHER / UNKNOWN

VEHICLE DEFECTS

1 - TURN SIGNALS	4 - BRAKES	7 - WORN OR SLICK TIRES	9 - MOTOR TROUBLE	99 - OTHER / UNKNOWN
2 - HEAD LAMPS	5 - STEERING	8 - TRAILER EQUIPMENT DEFECTIVE	10 - DISABLED FROM PRIOR ACCIDENT	
3 - TAIL LAMPS	6 - TIRE BLOWOUT			

NON-MOTORIST LOCATION AT IMPACT

1 - INTERSECTION - MARKED CROSSWALK	3 - INTERSECTION - OTHER	6 - BICYCLE LANE	9 - MEDIAN/CROSSING ISLAND	12 - FIRST RESPONDER AT INCIDENT SCENE
2 - INTERSECTION - UNMARKED CROSSWALK	4 - MIDBLOCK - MARKED CROSSWALK	7 - SHOULDER / ROADSIDE	10 - DRIVEWAY ACCESS	99 - OTHER / UNKNOWN
5 - TRAVEL LANE - OTHER LOCATION	8 - SIDEWALK		11 - SHARED USE PATHS OR TRAILS	

ACTION 03

1 - NON-CONTACT	1 - STRAIGHT AHEAD	7 - MAKING U-TURN	13 - NEGOTIATING A CURVE	18 - APPROACHING OR LEAVING VEHICLE
2 - NON-COLLISION	2 - BACKING	8 - ENTERING TRAFFIC LANE	14 - ENTERING OR CROSSING SPECIFIED LOCATION	19 - STANDING
3 - STRIKING	3 - CHANGING LANES	9 - LEAVING TRAFFIC LANE	15 - WALKING, RUNNING, JOGGING, PLAYING	20 - OTHER NON-MOTORIST
4 - STRUCK	4 - OVERTAKING/PASSING	10 - PARKED	16 - WORKING	21 - STANDING OUTSIDE DISABLED VEHICLE
5 - BOTH STRIKING & STRUCK	5 - MAKING RIGHT TURN	11 - SLOWING OR STOPPED IN TRAFFIC	17 - PUSHING VEHICLE	99 - OTHER / UNKNOWN
9 - OTHER / UNKNOWN	6 - MAKING LEFT TURN	12 - DRIVERLESS		

CONTRIBUTING CIRCUMSTANCES 08

1 - NONE	7 - LEFT OF CENTER	13 - IMPROPER START FROM A PARKED POSITION	17 - VISION OBSTRUCTION	21 - LYING IN ROADWAY
2 - FAILURE TO YIELD	8 - FOLLOWING TOO CLOSE / ACDA	14 - STOPPED OR PARKED ILLEGALLY	18 - OPERATING DEFECTIVE EQUIPMENT	22 - NOT DISCERNIBLE
3 - RAN RED LIGHT	9 - IMPROPER LANE CHANGE	15 - SWERVING TO AVOID	19 - LOAD SHIFTING/FALLING/SPILLING	23 - OPENING DOOR INTO ROADWAY
4 - RAN STOP SIGN	10 - IMPROPER PASSING	16 - WRONG WAY	20 - IMPROPER CROSSING	99 - OTHER IMPROPER ACTION
5 - UNSAFE SPEED	11 - DROVE OFF ROAD			
6 - IMPROPER TURN	12 - IMPROPER BACKING			

SEQUENCE OF EVENTS

1 2 0

2 \_\_\_\_\_

3 \_\_\_\_\_

4 \_\_\_\_\_

5 \_\_\_\_\_

6 \_\_\_\_\_

1 FIRST HARMFUL EVENT 1 MOST HARMFUL EVENT

**NON-COLLISION**

1 - OVERTURN/ROLLOVER	6 - EQUIPMENT FAILURE	11 - CROSS CENTERLINE - OPPOSITE DIRECTION OF TRAVEL	16 - RAILWAY VEHICLE	22 - WORK ZONE MAINTENANCE EQUIPMENT
2 - FIRE/EXPLOSION	7 - SEPARATION OF UNITS	12 - DOWNHILL RUNAWAY	17 - ANIMAL - FARM	23 - STRUCK BY FALLING, SHIFTING CARGO OR ANYTHING SET IN MOTION BY A MOTOR VEHICLE
3 - IMMERSION	8 - RAN OFF ROAD RIGHT	13 - OTHER NON-COLLISION	18 - ANIMAL - DEER	24 - OTHER MOVABLE OBJECT
4 - JACKKNIFE	9 - RAN OFF ROAD LEFT	14 - PEDESTRIAN	19 - ANIMAL - OTHER	
5 - CARGO/EQUIPMENT LOSS OR SHIFT	10 - CROSS MEDIAN	15 - PEDALCYCLE	20 - MOTOR VEHICLE IN TRANSPORT	
			21 - PARKED MOTOR VEHICLE	

**COLLISION WITH FIXED OBJECT - STRUCK**

25 - IMPACT ATTENUATOR / CRASH CUSHION	31 - GUARDRAIL END	37 - TRAFFIC SIGN POST	43 - CURB	50 - WORK ZONE MAINTENANCE EQUIPMENT
26 - BRIDGE OVERHEAD STRUCTURE	32 - PORTABLE BARRIER	38 - OVERHEAD SIGN POST	44 - DITCH	51 - WALL
27 - BRIDGE PIER OR ABUTMENT	33 - MEDIUM CABLE BARRIER	39 - LIGHT / LUMINARIES SUPPORT	45 - EMBANKMENT	52 - BUILDING
28 - BRIDGE PARAPET	34 - MEDIUM GUARDRAIL BARRIER	40 - UTILITY POLE	46 - FENCE	53 - TUNNEL
29 - BRIDGE RAIL	35 - MEDIUM CONCRETE BARRIER	41 - OTHER POST, POLE OR SUPPORT	47 - MAILBOX	54 - OTHER FIXED OBJECT
30 - GUARDRAIL FACE	36 - MEDIUM OTHER BARRIER	42 - CULVERT	48 - TREE	99 - OTHER / UNKNOWN
			49 - FIRE HYDRANT	

LOCAL REPORT NUMBER 2,300,0817

**DAMAGE**

DAMAGE SCALE 9

1 - NONE 3 - FUNCTIONAL DAMAGE  
2 - MINOR DAMAGE 4 - DISABLING DAMAGE  
9 - UNKNOWN

**DAMAGED AREA(S)**  
INDICATE ALL THAT APPLY

- NO DAMAGE [ 0 ]  - UNDERCARRIAGE [ 14 ]  
 - TOP [ 13 ]  - ALL AREAS [ 15 ]  
 - UNIT NOT AT SCENE [ 16 ]

**INITIAL POINT OF CONTACT**

1, 2

0 - NO DAMAGE 14 - UNDERCARRIAGE  
1-12 - REFER TO UNIT DIAGRAM 15 - VEHICLE NOT AT SCENE  
13 - TOP 99 - UNKNOWN

**TRAFFIC**

TRAFFICWAY FLOW 2

1 - ONE-WAY  
2 - TWO-WAY

TRAFFIC CONTROL 2

1 - ROUNDABOUT 4 - STOP SIGN  
2 - SIGNAL 5 - YIELD SIGN  
3 - FLASHER 6 - NO CONTROL

# of THROUGH LANES ON ROAD 4

RAIL GRADE CROSSING 1

1 - NOT INVOLVED  
2 - INVOLVED-ACTIVE CROSSING  
3 - INVOLVED-PASSIVE CROSSING

**UNIT / NON-MOTORIST DIRECTION**

FROM 3 TO 4

1 - NORTH 5 - NORTHEAST  
2 - SOUTH 6 - NORTHWEST  
3 - EAST 7 - SOUTHEAST  
4 - WEST 8 - SOUTHWEST  
9 - OTHER / UNKNOWN

**UNIT SPEED**

5 0

**POSTED SPEED**

5 0

**DETECTED SPEED**

3

1 - STATED / ESTIMATED SPEED  
2 - CALCULATED / EDR  
3 - UNDETERMINED

**OWNER**

UNIT # 02 OWNER NAME: LAST, FIRST, MIDDLE (SAME AS DRIVER) Bailey, Deborah OWNER PHONE: INCLUDE AREA CODE (SAME AS DRIVER) 1

OWNER ADDRESS: STREET, CITY, STATE, ZIP (SAME AS DRIVER)

COMMERCIAL CARRIER: NAME, ADDRESS, CITY, STATE, ZIP COMMERCIAL CARRIER PHONE: INCLUDE AREA CODE

**VEHICLE**

LP STATE OH LICENSE PLATE # HOD4361 VEHICLE IDENTIFICATION # 2GTBK1313518113210264 VEHICLE YEAR 2008 VEHICLE MAKE GMC

INSURANCE VERIFIED INSURANCE COMPANY Geico INSURANCE POLICY # 4445-13-40-10 COLOR Gray VEHICLE MODEL Sierra

COMMERCIAL  GOVERNMENT  IN EMERGENCY RESPONSE

INTERLOCK DEVICE EQUIPPED  HIT/SKIP UNIT #OCCUPANTS 01 VEHICLE WEIGHT GVWR/GCWR  
 1 - ≤10K LBS.  
 2 - 10,001 - 26K LBS.  
 3 - >26K LBS.

HAZARDOUS MATERIAL  
 MATERIAL RELEASED CLASS #          PLACARD ID #           
 PLACARD

UNIT TYPE 04

1 - PASSENGER CAR	7 - MOTORCYCLE 2-WHEELED	12 - GOLF CART	18 - LIMO (LIVERY VEHICLE)	23 - PEDESTRIAN / SKATER
2 - PASSENGER VAN (MINIVAN)	8 - MOTORCYCLE 3-WHEELED	13 - SNOWMOBILE	19 - BUS (16+ PASSENGERS)	24 - WHEELCHAIR (ANY TYPE)
3 - SPORT UTILITY VEHICLE	9 - AUTOCYCLE	14 - SINGLE UNIT TRUCK	20 - OTHER VEHICLE	25 - OTHER NON-MOTORIST
4 - PICK UP	10 - MOPED OR MOTORIZED BICYCLE	15 - SEMI-TRACTOR	21 - HEAVY EQUIPMENT	26 - BICYCLE
5 - CARGO VAN	11 - ALL TERRAIN VEHICLE (ATV / UTV)	16 - FARM EQUIPMENT	22 - ANIMAL WITH RIDER OR ANIMAL-DRAWN VEHICLE	27 - TRAIN
6 - VAN (9-15 SEATS)		17 - MOTORHOME		99 - UNKNOWN OR HITSKIP

# OF TRAILING UNITS 0

WAS VEHICLE OPERATING IN AUTONOMOUS MODE WHEN CRASH OCCURRED? 0

1 - YES	2 - NO	9 - OTHER / UNKNOWN
---------	--------	---------------------

AUTONOMOUS MODE LEVEL

0 - NO AUTOMATION	3 - CONDITIONAL AUTOMATION	9 - UNKNOWN
1 - DRIVER ASSISTANCE	4 - HIGH AUTOMATION	
2 - PARTIAL AUTOMATION	5 - FULL AUTOMATION	

SPECIAL FUNCTION 01

1 - NONE	6 - BUS - CHARTER/TOUR	11 - FIRE	16 - FARM	21 - MAIL CARRIER
2 - TAXI	7 - BUS - INTERCITY	12 - MILITARY	17 - MOWING	99 - OTHER / UNKNOWN
3 - ELECTRONIC RIDE SHARING	8 - BUS - SHUTTLE	13 - POLICE	18 - SNOW REMOVAL	
4 - SCHOOL TRANSPORT	9 - BUS - OTHER	14 - PUBLIC UTILITY	19 - TOWING	
5 - BUS - TRANSIT/COMMUTER	10 - AMBULANCE	15 - CONSTRUCTION EQUIPMENT	20 - SAFETY SERVICE PATROL	

CARGO BODY TYPE 01

1 - NO CARGO BODY TYPE / NOT APPLICABLE	3 - VEHICLE TOWING ANOTHER MOTOR VEHICLE	5 - INTERMODAL CONTAINER CHASSIS	8 - POLE	12 - CONCRETE MIXER
2 - BUS	4 - LOGGING	6 - CARGO VAN/ENCLOSED BOX	9 - CARGO TANK	13 - AUTO TRANSPORTER
		7 - GRAIN/CHIPS/GRAVEL	10 - FLAT BED	14 - GARBAGE/REFUSE
			11 - DUMP	99 - OTHER / UNKNOWN

VEHICLE DEFECTS

1 - TURN SIGNALS	4 - BRAKES	7 - WORN OR SLICK TIRES	9 - MOTOR TROUBLE	99 - OTHER / UNKNOWN
2 - HEAD LAMPS	5 - STEERING	8 - TRAILER EQUIPMENT DEFECTIVE	10 - DISABLED FROM PRIOR ACCIDENT	
3 - TAIL LAMPS	6 - TIRE BLOWOUT			

NON-MOTORIST LOCATION AT IMPACT

1 - INTERSECTION - MARKED CROSSWALK	3 - INTERSECTION - OTHER	6 - BICYCLE LANE	9 - MEDIAN/CROSSING ISLAND	12 - FIRST RESPONDER AT INCIDENT SCENE
2 - INTERSECTION - UNMARKED CROSSWALK	4 - MIDBLOCK - MARKED CROSSWALK	7 - SHOULDER / ROADSIDE	10 - DRIVEWAY ACCESS	99 - OTHER / UNKNOWN
	5 - TRAVEL LANE - OTHER LOCATION	8 - SIDEWALK	11 - SHARED USE PATHS OR TRAILS	

ACTION 04

1 - NON-CONTACT	1 - STRAIGHT AHEAD	7 - MAKING U-TURN	13 - NEGOTIATING A CURVE	18 - APPROACHING OR LEAVING VEHICLE
2 - NON-COLLISION	2 - BACKING	8 - ENTERING TRAFFIC LANE	14 - ENTERING OR CROSSING SPECIFIED LOCATION	19 - STANDING
3 - STRIKING	3 - CHANGING LANES	9 - LEAVING TRAFFIC LANE	15 - WALKING, RUNNING, JOGGING, PLAYING	20 - OTHER NON-MOTORIST
4 - STRUCK	4 - OVERTAKING/PASSING	10 - PARKED	16 - WORKING	21 - STANDING OUTSIDE DISABLED VEHICLE
5 - BOTH STRIKING & STRUCK	5 - MAKING RIGHT TURN	11 - SLOWING OR STOPPED IN TRAFFIC	17 - PUSHING VEHICLE	99 - OTHER / UNKNOWN
9 - OTHER / UNKNOWN	6 - MAKING LEFT TURN	12 - DRIVERLESS		

CONTRIBUTING CIRCUMSTANCES 01

1 - NONE	7 - LEFT OF CENTER	13 - IMPROPER START FROM A PARKED POSITION	17 - VISION OBSTRUCTION	21 - LYING IN ROADWAY
2 - FAILURE TO YIELD	8 - FOLLOWING TOO CLOSE / ACDA	14 - STOPPED OR PARKED ILLEGALLY	18 - OPERATING DEFECTIVE EQUIPMENT	22 - NOT DISCERNIBLE
3 - RAN RED LIGHT	9 - IMPROPER LANE CHANGE	15 - SWERVING TO AVOID	19 - LOAD SHIFTING/FALLING/ SPILLING	23 - OPENING DOOR INTO ROADWAY
4 - RAN STOP SIGN	10 - IMPROPER PASSING	16 - WRONG WAY	20 - IMPROPER CROSSING	99 - OTHER IMPROPER ACTION
5 - UNSAFE SPEED	11 - DROVE OFF ROAD			
6 - IMPROPER TURN	12 - IMPROPER BACKING			

SEQUENCE OF EVENTS

1 <u>2</u> <u>0</u>	1 - OVERTURN/ROLLOVER	6 - EQUIPMENT FAILURE	<b>NON-COLLISION</b>	11 - CROSS CENTERLINE - OPPOSITE DIRECTION OF TRAVEL	16 - RAILWAY VEHICLE	22 - WORK ZONE MAINTENANCE EQUIPMENT
2 <u>        </u>	2 - FIRE/EXPLOSION	7 - SEPARATION OF UNITS	12 - DOWNHILL RUNAWAY	13 - OTHER NON-COLLISION	17 - ANIMAL - FARM	23 - STRUCK BY FALLING, SHIFTING CARGO OR ANYTHING SET IN MOTION BY A MOTOR VEHICLE
3 <u>        </u>	3 - IMMERSION	8 - RAN OFF ROAD RIGHT	14 - PEDESTRIAN	15 - PEDAL CYCLE	18 - ANIMAL - DEER	24 - OTHER MOVABLE OBJECT
4 <u>        </u>	4 - JACKKNIFE	9 - RAN OFF ROAD LEFT	31 - GUARDRAIL END	37 - TRAFFIC SIGN POST	19 - ANIMAL - OTHER	
5 <u>        </u>	5 - CARGO/EQUIPMENT LOSS OR SHIFT	10 - CROSS MEDIAN	32 - PORTABLE BARRIER	38 - OVERHEAD SIGN POST	20 - MOTOR VEHICLE IN TRANSPORT	
6 <u>        </u>			33 - MEDIUM CABLE BARRIER	39 - LIGHT / LUMINARIES SUPPORT	21 - PARKED MOTOR VEHICLE	
			34 - MEDIUM GUARDRAIL BARRIER	40 - UTILITY POLE		
			25 - IMPACT ATTENUATOR / CRASH CUSHION	41 - OTHER POST, POLE OR SUPPORT		
			26 - BRIDGE OVERHEAD STRUCTURE	42 - CULVERT		
			27 - BRIDGE PIER OR ABUTMENT			
			28 - BRIDGE PARAPET			
			29 - BRIDGE RAIL			
			30 - GUARDRAIL FACE			
			31 - GUARDRAIL END			
			32 - PORTABLE BARRIER			
			33 - MEDIUM CABLE BARRIER			
			34 - MEDIUM GUARDRAIL BARRIER			
			35 - MEDIUM CONCRETE BARRIER			
			36 - MEDIUM OTHER BARRIER			
			37 - TRAFFIC SIGN POST			
			38 - OVERHEAD SIGN POST			
			39 - LIGHT / LUMINARIES SUPPORT			
			40 - UTILITY POLE			
			41 - OTHER POST, POLE OR SUPPORT			
			42 - CULVERT			

FIRST HARMFUL EVENT 1 MOST HARMFUL EVENT 1

LOCAL REPORT NUMBER 2,3,0,0,0,8,1,7

**DAMAGE**

DAMAGE SCALE

<u>2</u>	1 - NONE	3 - FUNCTIONAL DAMAGE
	2 - MINOR DAMAGE	4 - DISABLING DAMAGE
		9 - UNKNOWN

**DAMAGED AREA(S)**  
INDICATE ALL THAT APPLY

- NO DAMAGE [ 0 ]  - UNDERCARRIAGE [ 14 ]  
 - TOP [ 13 ]  - ALL AREAS [ 15 ]  
 - UNIT NOT AT SCENE [ 16 ]

INITIAL POINT OF CONTACT

<u>0</u> <u>6</u>	0 - NO DAMAGE	14 - UNDERCARRIAGE
	1-12 - REFER TO UNIT DIAGRAM	15 - VEHICLE NOT AT SCENE
		99 - UNKNOWN

**TRAFFIC**

TRAFFICWAY FLOW	TRAFFIC CONTROL
<u>2</u>	<u>2</u>
1 - ONE-WAY	1 - ROUNDABOUT
2 - TWO-WAY	4 - STOP SIGN
	2 - SIGNAL
	5 - YIELD SIGN
	3 - FLASHER
	6 - NO CONTROL

# OF THROUGH LANES ON ROAD 4

RAIL GRADE CROSSING 1

1 - NOT INVOLVED
2 - INVOLVED-ACTIVE CROSSING
3 - INVOLVED-PASSIVE CROSSING

UNIT / NON-MOTORIST DIRECTION

FROM <u>3</u> TO <u>4</u>	
1 - NORTH	5 - NORTHEAST
2 - SOUTH	6 - NORTHWEST
3 - EAST	7 - SOUTHEAST
4 - WEST	8 - SOUTHWEST
	9 - OTHER / UNKNOWN

UNIT SPEED 0

POSTED SPEED 40

DETECTED SPEED 1

1 - STATED / ESTIMATED SPEED
2 - CALCULATED / EDR
3 - UNDETERMINED



# MOTORIST / Non-MOTORIST

LOCAL REPORT NUMBER  
2 3 0 0 0 8 1 7

UNIT # 0 1	NAME: LAST, FIRST, MIDDLE		DATE OF BIRTH		AGE 0	GENDER U				
ADDRESS: STREET, CITY, STATE, ZIP			CONTACT PHONE - INCLUDE AREA CODE							
INJURIES 5	INJURED TAKEN BY	EMS AGENCY (NAME)	INJURED TAKEN TO: MEDICAL FACILITY (NAME, CITY)	SAFETY EQUIPMENT USED 9 9	<input type="checkbox"/> DOT-COMPLIANT <input type="checkbox"/> MC HELMET	SEATING POSITION 0 1	AIR BAG USAGE 1	EJECTION 1	TRAPPED 1	
OL STATE	OPERATOR LICENSE NUMBER		OFFENSE CHARGED	LOCAL CODE <input type="checkbox"/>	OFFENSE DESCRIPTION		CITATION NUMBER			
OL CLASS	ENDORSEMENT SELECT UP TO 2	RESTRICTION SELECT UP TO 3	DRIVER DISTRACTED BY 9	ALCOHOL / DRUG SUSPECTED <input type="checkbox"/> ALCOHOL <input type="checkbox"/> MARIJUANA <input type="checkbox"/> OTHER DRUG		CONDITION 9	ALCOHOL TEST STATUS TYPE VALUE		DRUG TEST(S) STATUS TYPE RESULT SELECT UP TO 4	

UNIT # 0 2	NAME: LAST, FIRST, MIDDLE Bailey, Roger, Gilbert		DATE OF BIRTH 0 8 2 1 1 9 6 4		AGE 5 8	GENDER M				
ADDRESS: STREET, CITY, STATE, ZIP 4510 Eaton Rd, Hamilton OH 45013			CONTACT PHONE - INCLUDE AREA CODE							
INJURIES 5	INJURED TAKEN BY	EMS AGENCY (NAME)	INJURED TAKEN TO: MEDICAL FACILITY (NAME, CITY)	SAFETY EQUIPMENT USED 0 4	<input type="checkbox"/> DOT-COMPLIANT <input type="checkbox"/> MC HELMET	SEATING POSITION 0 1	AIR BAG USAGE 1	EJECTION 1	TRAPPED 1	
OL STATE OH	OPERATOR LICENSE NUMBER		OFFENSE CHARGED	LOCAL CODE <input type="checkbox"/>	OFFENSE DESCRIPTION		CITATION NUMBER			
OL CLASS 4	ENDORSEMENT M	RESTRICTION SELECT UP TO 3	DRIVER DISTRACTED BY 1	ALCOHOL / DRUG SUSPECTED <input type="checkbox"/> ALCOHOL <input type="checkbox"/> MARIJUANA <input type="checkbox"/> OTHER DRUG		CONDITION 1	ALCOHOL TEST STATUS TYPE VALUE		DRUG TEST(S) STATUS TYPE RESULT SELECT UP TO 4	

UNIT #	NAME: LAST, FIRST, MIDDLE		DATE OF BIRTH		AGE 0	GENDER				
ADDRESS: STREET, CITY, STATE, ZIP			CONTACT PHONE - INCLUDE AREA CODE							
INJURIES	INJURED TAKEN BY	EMS AGENCY (NAME)	INJURED TAKEN TO: MEDICAL FACILITY (NAME, CITY)	SAFETY EQUIPMENT USED	<input type="checkbox"/> DOT-COMPLIANT <input type="checkbox"/> MC HELMET	SEATING POSITION	AIR BAG USAGE	EJECTION	TRAPPED	
OL STATE	OPERATOR LICENSE NUMBER		OFFENSE CHARGED	LOCAL CODE <input type="checkbox"/>	OFFENSE DESCRIPTION		CITATION NUMBER			
OL CLASS	ENDORSEMENT SELECT UP TO 2	RESTRICTION SELECT UP TO 3	DRIVER DISTRACTED BY	ALCOHOL / DRUG SUSPECTED <input type="checkbox"/> ALCOHOL <input type="checkbox"/> MARIJUANA <input type="checkbox"/> OTHER DRUG		CONDITION	ALCOHOL TEST STATUS TYPE VALUE		DRUG TEST(S) STATUS TYPE RESULT SELECT UP TO 4	

INJURIES	SEATING POSITION	AIR BAG	OL CLASS	OL RESTRICTION(S)	DRIVER DISTRACTION	TEST STATUS
1 - FATAL 2 - SUSPECTED SERIOUS INJURY 3 - SUSPECTED MINOR INJURY 4 - POSSIBLE INJURY 5 - NO APPARENT INJURY	1 - FRONT - LEFT SIDE (MOTORCYCLE DRIVER) 2 - FRONT - MIDDLE 3 - FRONT - RIGHT SIDE 4 - SECOND - LEFT SIDE (MOTORCYCLE PASSENGER) 5 - SECOND - MIDDLE 6 - SECOND - RIGHT SIDE 7 - THIRD - LEFT SIDE (MOTORCYCLE SIDE CAR) 8 - THIRD - MIDDLE 9 - THIRD - RIGHT SIDE 10 - SLEEPER SECTION OF TRUCK CAB	1 - NOT DEPLOYED 2 - DEPLOYED FRONT 3 - DEPLOYED SIDE 4 - DEPLOYED BOTH FRONT / SIDE 5 - NOT APPLICABLE 9 - DEPLOYMENT UNKNOWN	1 - CLASS A 2 - CLASS B 3 - CLASS C 4 - REGULAR CLASS 5 - (OHIO - D) 6 - M/C MOPED ONLY 9 - NO VALID OL	1 - ALCOHOL INTERLOCK DEVICE 2 - CDL INTRASTATE ONLY 3 - CORRECTIVE LENSES 4 - FARM WAIVER 5 - EXCEPT CLASS A BUS 6 - EXCEPT CLASS A & CLASS B BUS 7 - EXCEPT TRACTOR-TRAILER 8 - INTERMEDIATE LICENSE RESTRICTIONS 9 - LEARNER'S PERMIT RESTRICTIONS 10 - LIMITED TO DAYLIGHT ONLY 11 - LIMITED TO EMPLOYMENT 12 - LIMITED - OTHER 13 - MECHANICAL DEVICES (SPECIAL BRAKES, HAND CONTROLS, OR OTHER ADAPTIVE DEVICES) 14 - MILITARY VEHICLES ONLY 15 - MOTOR VEHICLES WITHOUT AIR BRAKES 16 - OUTSIDE MIRROR 17 - PROSTHETIC AID 18 - OTHER	1 - NOT DISTRACTED 2 - MANUALLY OPERATING AN ELECTRONIC COMMUNICATION DEVICE (TEXTING, TYPING, DIALING) 3 - TALKING ON HANDS-FREE COMMUNICATION DEVICE 4 - TALKING ON HAND-HELD COMMUNICATION DEVICE 5 - OTHER ACTIVITY WITH AN ELECTRONIC DEVICE 6 - PASSENGER 7 - OTHER DISTRACTION INSIDE THE VEHICLE 8 - OTHER DISTRACTION OUTSIDE THE VEHICLE 9 - OTHER UNKNOWN	1 - NONE GIVEN 2 - TEST REFUSED 3 - TEST GIVEN, CONTAMINATED SAMPLE / UNUSABLE 4 - TEST GIVEN, RESULTS KNOWN 5 - TEST GIVEN, RESULTS UNKNOWN
INJURED TAKEN BY	EJECTION	TRAPPED	OL ENDORSEMENT	CONDITION	DRUG TEST TYPE	DRUG TEST RESULT(S)
1 - NOT TRANSPORTED / TREATED AT SCENE 2 - EMS 3 - POLICE 9 - OTHER / UNKNOWN	1 - NOT EJECTED 2 - PARTIALLY EJECTED 3 - TOTALLY EJECTED 4 - NOT APPLICABLE	1 - NOT TRAPPED 2 - EXTRICATED BY MECHANICAL MEANS 3 - FREED BY NON-MECHANICAL MEANS	H - HAZMAT M - MOTORCYCLE P - PASSENGER T - TANKER O - MOTOR SCOOTER R - THREE-WHEEL MOTORCYCLE S - SCHOOL BUS D - DOUBLE & TRIPLE TRAILERS X - TANKER / HAZMAT	1 - APPARENTLY NORMAL 2 - PHYSICAL IMPAIRMENT 3 - EMOTIONAL (E.G. DEPRESSED, ANGRY, DISTURBED) 4 - ILLNESS 5 - FELL ASLEEP, FAINTED, FATIGUED, ETC. 6 - UNDER THE INFLUENCE OF MEDICATIONS / DRUGS / ALCOHOL 9 - OTHER / UNKNOWN	1 - NONE 2 - BLOOD 3 - URINE 4 - BREATH 5 - OTHER	1 - NONE 2 - BLOOD 3 - URINE 4 - OTHER 5 - OTHER
SAFETY EQUIPMENT	TRAPPED	TRAPPED	GENDER	CONDITION	DRUG TEST TYPE	DRUG TEST RESULT(S)
1 - NONE USED 2 - SHOULDER BELT ONLY USED 3 - LAP BELT ONLY USED 4 - SHOULDER & LAP BELT USED 5 - CHILD RESTRAINT SYSTEM FORWARD FACING 6 - CHILD RESTRAINT SYSTEM REAR FACING 7 - BOOSTER SEAT 8 - HELMET USED 9 - PROTECTIVE PADS USED (ELBOW, KNEES, ETC.) 10 - REFLECTIVE CLOTHING 11 - LIGHTING - PEDESTRIAN / BICYCLE ONLY 99 - OTHER / UNKNOWN	1 - NOT TRAPPED 2 - EXTRICATED BY MECHANICAL MEANS 3 - FREED BY NON-MECHANICAL MEANS	1 - NOT TRAPPED 2 - EXTRICATED BY MECHANICAL MEANS 3 - FREED BY NON-MECHANICAL MEANS	F - FEMALE M - MALE U - OTHER / UNKNOWN	1 - APPARENTLY NORMAL 2 - PHYSICAL IMPAIRMENT 3 - EMOTIONAL (E.G. DEPRESSED, ANGRY, DISTURBED) 4 - ILLNESS 5 - FELL ASLEEP, FAINTED, FATIGUED, ETC. 6 - UNDER THE INFLUENCE OF MEDICATIONS / DRUGS / ALCOHOL 9 - OTHER / UNKNOWN	1 - NONE 2 - BLOOD 3 - URINE 4 - OTHER 5 - OTHER	1 - AMPHETAMINES 2 - BARBITURATES 3 - BENZODIAZEPINES 4 - CANNABINOIDS 5 - COCAINE 6 - OPIATES / OPIOIDS 7 - OTHER 8 - NEGATIVE RESULTS

REPORT NUMBER PD-23-068817

AGENCY FAIRFIELD P.D. 00901

DATE OF ACCIDENT M 1 10 4 19 23

IN COUNTY OF BUTLER

ACCIDENT LOCATION Union Centre Blvd / Seward Rd

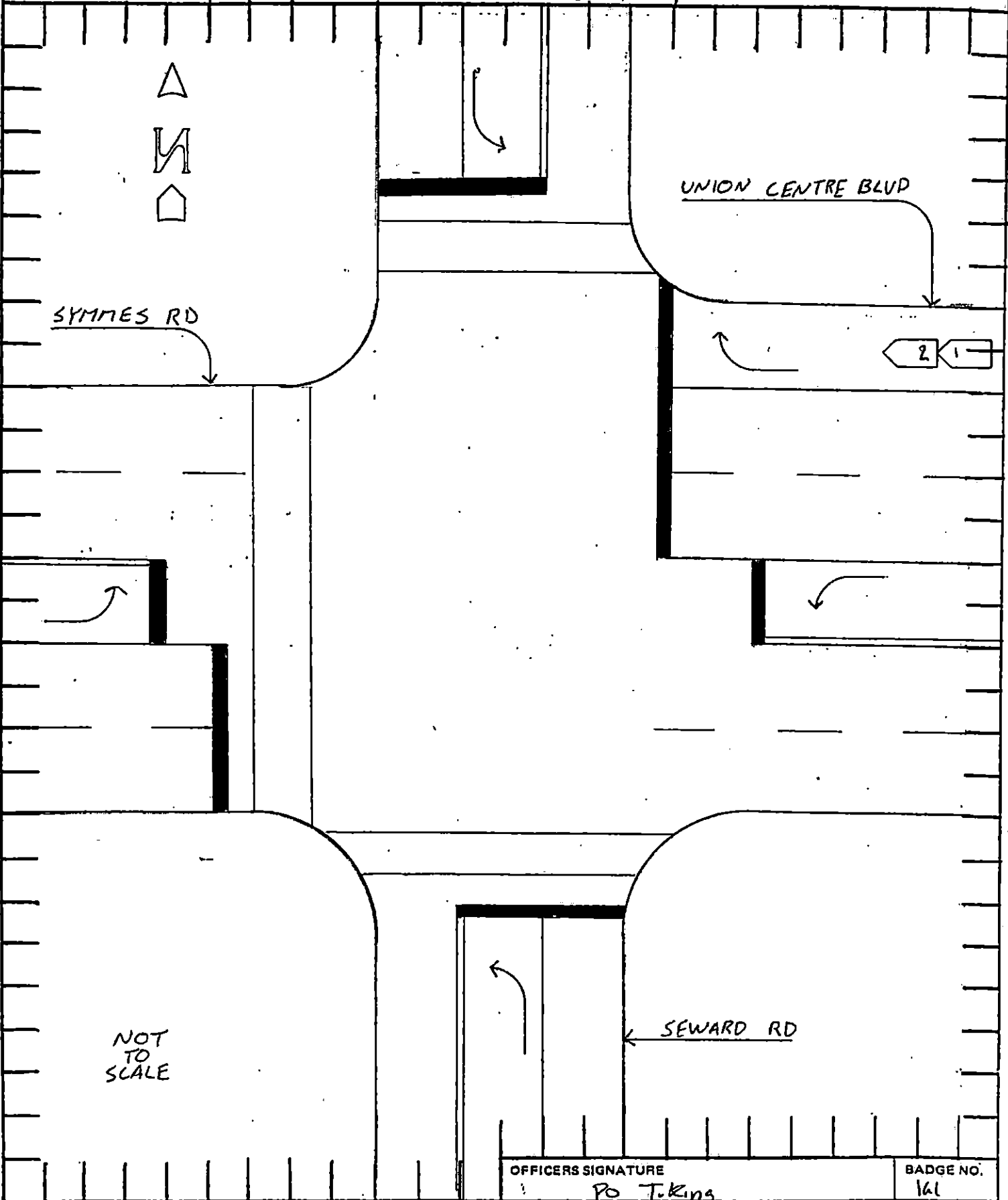

OFFICERS SIGNATURE PO T. King

BADGE NO. 161