

TRAFFIC CRASH REPORT

*DENOTES MANDATORY FIELD FOR SUPPLEMENT REPORT

LOCAL REPORT NUMBER*

PHOTOS TAKEN, SECONDARY CRASH, OH-2, OH-3, OH-1P, OTHER, PRIVATE PROPERTY, LOCAL INFORMATION, REPORTING AGENCY NAME*, NCIC*, HIT/SKIP, NUMBER OF UNITS, UNIT IN ERROR

COUNTY*, LOCALITY*, LOCATION: CITY, VILLAGE, TOWNSHIP*, CRASH DATE / TIME*, CRASH SEVERITY

ROUTE TYPE, ROUTE NUMBER, PREFIX, LOCATION ROAD NAME, ROAD TYPE, LATITUDE, REFERENCE ROAD NAME, REFERENCE ROAD NUMBER, ROAD TYPE, LONGITUDE

REFERENCE POINT, DIRECTION FROM REFERENCE, ROUTE TYPE, ROAD TYPE, INTERSECTION RELATED, ROADWAY DIVIDED

LOCATION OF FIRST HARMFUL EVENT, MANNER OF CRASH COLLISION/IMPACT, DIRECTION OF TRAVEL, MEDIAN TYPE

WORK ZONE RELATED, WORKERS PRESENT, LAW ENFORCEMENT PRESENT, ACTIVE SCHOOL ZONE, WORK ZONE TYPE, LOCATION OF CRASH IN WORK ZONE, CONTOUR, CONDITIONS, SURFACE

LIGHT CONDITION, WEATHER

NARRATIVE, grid area with text 'See OH-2' and a compass diagram

CRASH REPORTED DATE / TIME, DISPATCH DATE / TIME, ARRIVAL DATE / TIME, SCENE CLEARED DATE / TIME, REPORT TAKEN BY, TOTAL TIME ROADWAY CLOSED, OFFICER'S NAME, OFFICER'S BADGE NUMBER, CHECKED BY OFFICER'S NAME, CHECKED BY OFFICER'S BADGE NUMBER, SUPPLEMENT

LOCAL REPORT NUMBER
2,300,2966

OWNER

UNIT # 01 OWNER NAME: LAST, FIRST, MIDDLE (SAME AS DRIVER) Cinci Open Box Outlet LLC OWNER PHONE: INCLUDE AREA CODE (SAME AS DRIVER)

OWNER ADDRESS: STREET, CITY, STATE, ZIP (SAME AS DRIVER)

COMMERCIAL CARRIER: NAME, ADDRESS, CITY, STATE, ZIP COMMERCIAL CARRIER PHONE: INCLUDE AREA CODE

VEHICLE

LP STATE OH LICENSE PLATE # HWH9318 VEHICLE IDENTIFICATION # JTEBU5JR7F52147 VEHICLE YEAR 2015 VEHICLE MAKE Toyota

INSURANCE VERIFIED INSURANCE COMPANY Selective INSURANCE POLICY # S 2298246 COLOR GRAY VEHICLE MODEL 4Runner

TYPE OF USE: COMMERCIAL GOVERNMENT IN EMERGENCY RESPONSE

US DOT # _____ TOWED BY: COMPANY NAME _____

HAZARDOUS MATERIAL: MATERIAL RELEASED CLASS # _____ PLACARD PLACARD ID # _____

UNIT TYPE: 01

1 - PASSENGER CAR 7 - MOTORCYCLE 2-WHEELED 12 - GOLF CART 18 - LIMO (LIVERY VEHICLE) 23 - PEDESTRIAN / SKATER
 2 - PASSENGER VAN (MINIVAN) 8 - MOTORCYCLE 3-WHEELED 13 - SNOWMOBILE 19 - BUS (16+ PASSENGERS) 24 - WHEELCHAIR (ANY TYPE)
 3 - SPORT UTILITY VEHICLE 9 - AUTOCYCLE 14 - SINGLE UNIT TRUCK 20 - OTHER VEHICLE 25 - OTHER NON-MOTORIST
 4 - PICK UP 10 - MOPED OR MOTORIZED BICYCLE 15 - SEMI-TRACTOR 21 - HEAVY EQUIPMENT 26 - BICYCLE
 5 - CARGO VAN 11 - ALL TERRAIN VEHICLE (ATV/UTV) 16 - FARM EQUIPMENT 22 - ANIMAL WITH RIDER OR ANIMAL-DRAWN VEHICLE 27 - TRAIN
 6 - VAN (9-15 SEATS) 17 - MOTORHOME

of TRAILING UNITS 0

WAS VEHICLE OPERATING IN AUTONOMOUS MODE WHEN CRASH OCCURRED? 2

1 - YES 2 - NO 9 - OTHER / UNKNOWN

AUTONOMOUS MODE LEVEL 0

0 - NO AUTOMATION 1 - DRIVER ASSISTANCE 2 - PARTIAL AUTOMATION 3 - CONDITIONAL AUTOMATION 4 - HIGH AUTOMATION 5 - FULL AUTOMATION 9 - UNKNOWN

SPECIAL FUNCTION: 01

1 - NONE 6 - BUS - CHARTER/TOUR 11 - FIRE 16 - FARM 21 - MAIL CARRIER
 2 - TAXI 7 - BUS - INTERCITY 12 - MILITARY 17 - MOWING 99 - OTHER / UNKNOWN
 3 - ELECTRONIC RIDE SHARING 8 - BUS - SHUTTLE 13 - POLICE 18 - SNOW REMOVAL
 4 - SCHOOL TRANSPORT 9 - BUS - OTHER 14 - PUBLIC UTILITY 19 - TOWING
 5 - BUS - TRANSIT/COMMUTER 10 - AMBULANCE 15 - CONSTRUCTION EQUIPMENT 20 - SAFETY SERVICE PATROL

CARGO BODY TYPE: 01

1 - NO CARGO BODY TYPE / NOT APPLICABLE 3 - VEHICLE TOWING ANOTHER MOTORVEHICLE 5 - INTERMODAL CONTAINER CHASSIS 8 - POLE 12 - CONCRETE MIXER
 2 - BUS 4 - LOGGING 6 - CARGO VAN/ENCLOSED BOX 9 - CARGO TANK 13 - AUTO TRANSPORTER
 7 - GRAINCHIPS/GRAVEL 11 - DUMP 10 - FLAT BED 14 - GARBAGE/REFUSE 99 - OTHER / UNKNOWN

VEHICLE DEFECTS: _____

1 - TURN SIGNALS 4 - BRAKES 7 - WORN OR SLICK TIRES 9 - MOTOR TROUBLE 99 - OTHER / UNKNOWN
 2 - HEAD LAMPS 5 - STEERING 8 - TRAILER EQUIPMENT DEFECTIVE 10 - DISABLED FROM PRIOR ACCIDENT
 3 - TAIL LAMPS 6 - TIRE BLOWOUT

NON-MOTORIST LOCATION AT IMPACT: _____

1 - INTERSECTION - MARKED CROSSWALK 3 - INTERSECTION - OTHER 6 - BICYCLE LANE 9 - MEDIAN/CROSSING ISLAND 12 - FIRST RESPONDER AT INCIDENT SCENE
 2 - INTERSECTION - UNMARKED CROSSWALK 4 - MIDDLEBLOCK - MARKED CROSSWALK 7 - SHOULDER / ROADSIDE 10 - DRIVEWAY ACCESS 99 - OTHER / UNKNOWN
 5 - TRAVEL LANE - OTHER LOCATION 8 - SIDEWALK 11 - SHARED USE PATHS OR TRAILS

ACTION: 03

1 - NON-CONTACT 1 - STRAIGHT AHEAD 7 - MAKING U-TURN 13 - NEGOTIATING A CURVE 18 - APPROACHING OR LEAVING VEHICLE
 2 - NON-COLLISION 2 - BACKING 8 - ENTERING TRAFFIC LANE 14 - ENTERING OR CROSSING SPECIFIED LOCATION 19 - STANDING
 3 - STRIKING 01 PRE-CRASH ACTIONS 3 - CHANGING LANES 9 - LEAVING TRAFFIC LANE 15 - WALKING, RUNNING, JOGGING, PLAYING 20 - OTHER NON-MOTORIST
 4 - STRUCK 4 - OVERTAKING/PASSING 10 - PARKED 16 - WORKING 21 - STANDING OUTSIDE DISABLED VEHICLE
 5 - BOTH STRIKING & STRUCK 5 - MAKING RIGHT TURN 11 - SLOWING OR STOPPED IN TRAFFIC 17 - PUSHING VEHICLE 99 - OTHER / UNKNOWN
 9 - OTHER / UNKNOWN 6 - MAKING LEFT TURN 12 - DRIVERLESS

CONTRIBUTING CIRCUMSTANCES: 08

1 - NONE 7 - LEFT OF CENTER 13 - IMPROPER START FROM A PARKED POSITION 17 - VISION OBSTRUCTION 21 - LYING IN ROADWAY
 2 - FAILURE TO YIELD 8 - FOLLOWING TOO CLOSE / ACDA 14 - STOPPED OR PARKED ILLEGALLY 18 - OPERATING DEFECTIVE EQUIPMENT 22 - NOT DISCERNIBLE
 3 - RAN RED LIGHT 9 - IMPROPER LANE CHANGE 15 - SWERVING TO AVOID 19 - LOAD SHIFTING/FALLING/SPILLING 23 - OPENING DOOR INTO ROADWAY
 4 - RAN STOP SIGN 10 - IMPROPER PASSING 16 - WRONG WAY 20 - IMPROPER CROSSING 99 - OTHER IMPROPER ACTION
 5 - UNSAFE SPEED 11 - DROVE OFF ROAD 17 - VISION OBSTRUCTION
 6 - IMPROPER TURN 12 - IMPROPER BACKING

SEQUENCE OF EVENTS: _____

1 20 1 - OVERTURN/ROLLOVER 6 - EQUIPMENT FAILURE **NON-COLLISION** 16 - RAILWAY VEHICLE 22 - WORK ZONE MAINTENANCE EQUIPMENT
 2 - FIRE/EXPLOSION 7 - SEPARATION OF UNITS 11 - CROSS CENTERLINE - OPPOSITE DIRECTION OF TRAVEL 17 - ANIMAL - FARM 23 - STRUCK BY FALLING, SHIFTING CARGO OR ANYTHING SET IN MOTION BY A MOTORVEHICLE
 3 - IMMERSION 8 - RAN OFF ROAD RIGHT 12 - DOWNHILL RUNAWAY 18 - ANIMAL - DEER 24 - OTHER MOVABLE OBJECT
 4 - JACKKNIFE 9 - RAN OFF ROAD LEFT 13 - OTHER NON-COLLISION 19 - ANIMAL - OTHER 20 - MOTORVEHICLE IN TRANSPORT
 5 - CARGO / EQUIPMENT LOSS OR SHIFT 10 - CROSS MEDIAN 14 - PEDESTRIAN 21 - PARKED MOTORVEHICLE
 6 - IMPROPER TURN 11 - DROVE OFF ROAD 15 - PEDALCYCLE

COLLISION WITH FIXED OBJECT / STRUCK

25 - IMPACT ATTENUATOR / CRASH CUSHION 31 - GUARDRAIL END 37 - TRAFFIC SIGN POST 43 - CURB 50 - WORK ZONE MAINTENANCE EQUIPMENT
 26 - BRIDGE OVERHEAD STRUCTURE 32 - PORTABLE BARRIER 38 - OVERHEAD SIGN POST 44 - DITCH 51 - WALL
 27 - BRIDGE PIER OR ABUTMENT 33 - MEDIUM CABLE BARRIER 39 - LIGHT / LUMINARIES SUPPORT 45 - EMBANKMENT 52 - BUILDING
 28 - BRIDGE PARAPET 34 - MEDIUM GUARDRAIL BARRIER 40 - UTILITY POLE 46 - FENCE 53 - TUNNEL
 29 - BRIDGE RAIL 35 - MEDIUM CONCRETE BARRIER 41 - OTHER POST, POLE OR SUPPORT 47 - MAILBOX 54 - OTHER FIXED OBJECT
 30 - GUARDRAIL FACE 36 - MEDIUM OTHER BARRIER 42 - CULVERT 48 - TREE 99 - OTHER / UNKNOWN

FIRST HARMFUL EVENT 1 MOST HARMFUL EVENT 1

DAMAGE

DAMAGE SCALE: 2

1 - NONE 3 - FUNCTIONAL DAMAGE
 2 - MINOR DAMAGE 4 - DISABLING DAMAGE
 9 - UNKNOWN

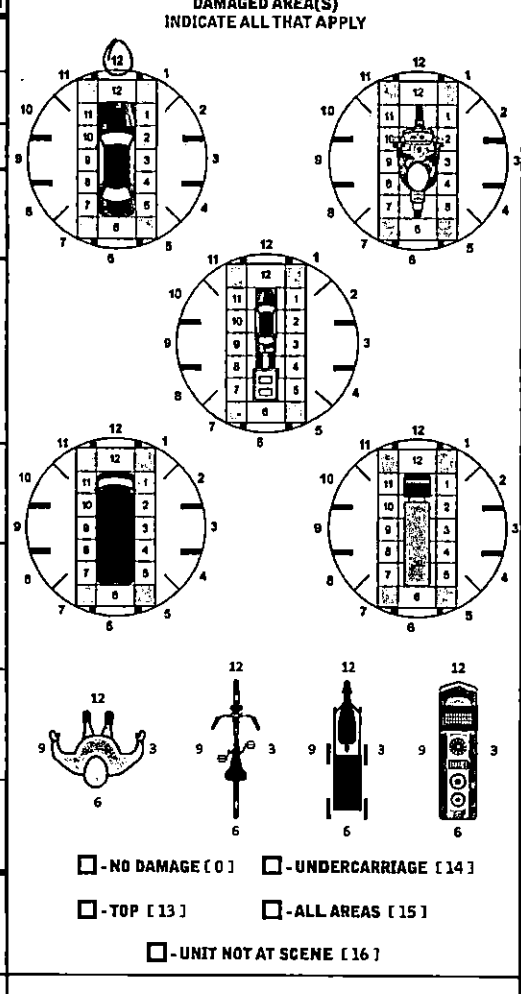

INITIAL POINT OF CONTACT: 1, 2

0 - NO DAMAGE 14 - UNDERCARRIAGE
 1-12 - REFER TO UNIT DIAGRAM 15 - VEHICLE NOT AT SCENE
 13 - TOP 99 - UNKNOWN

TRAFFIC

TRAFFICWAY FLOW: 2

1 - ONE-WAY 2 - TWO-WAY

TRAFFIC CONTROL: 6

1 - ROUNDABOUT 4 - STOP SIGN
 2 - SIGNAL 5 - YIELD SIGN
 3 - FLASHER 6 - NO CONTROL

of THROUGH LANES ON ROAD: 4

RAIL GRADE CROSSING: 1

1 - NOT INVOLVED
 2 - INVOLVED-ACTIVE CROSSING
 3 - INVOLVED-PASSIVE CROSSING

UNIT / NON-MOTORIST DIRECTION

FROM 1 TO 2

1 - NORTH 5 - NORTHEAST
 2 - SOUTH 6 - NORTHWEST
 3 - EAST 7 - SOUTHEAST
 4 - WEST 8 - SOUTHWEST
 9 - OTHER / UNKNOWN

UNIT SPEED: 15

POSTED SPEED: 35

DETECTED SPEED: 1

1 - STATED / ESTIMATED SPEED
 2 - CALCULATED / EDR
 3 - UNDETERMINED

OWNER

UNIT # 012 OWNER NAME: LAST, FIRST, MIDDLE (SAME AS DRIVER) _____ OWNER PHONE: INCLUDE AREA CODE (SAME AS DRIVER) _____

OWNER ADDRESS: STREET, CITY, STATE, ZIP (SAME AS DRIVER) _____

COMMERCIAL CARRIER: NAME, ADDRESS, CITY, STATE, ZIP _____ COMMERCIAL CARRIER PHONE: INCLUDE AREA CODE _____

LOCAL REPORT NUMBER
23002966

LP STATE OH LICENSE PLATE # JWU4354 VEHICLE IDENTIFICATION # 1C4GJ4151383B1156642 VEHICLE YEAR 2003 VEHICLE MAKE Chrysler

INSURANCE VERIFIED INSURANCE COMPANY Safe Auto INSURANCE POLICY # OH01770790A00 COLOR Red VEHICLE MODEL Voyager

COMMERCIAL GOVERNMENT IN EMERGENCY RESPONSE TYPE OF USE US DOT # _____ TOWED BY: COMPANY NAME _____

INTERLOCK DEVICE EQUIPPED HIT/SKIP UNIT #OCCUPANTS 02 VEHICLE WEIGHT GVWR/GCWR 1 - ≤10K LBS. 2 - 10,001 - 26K LBS. 3 - >26K LBS. HAZARDOUS MATERIAL CLASS # PLACARD ID # _____

DAMAGE

DAMAGE SCALE
2 1 - NONE 3 - FUNCTIONAL DAMAGE
2 - MINOR DAMAGE 4 - DISABLING DAMAGE
9 - UNKNOWN

UNIT TYPE 01 # of TRAILING UNITS 1

1 - PASSENGER CAR 7 - MOTORCYCLE 2-WHEELED 12 - GOLF CART 18 - LIMO (LIVERY VEHICLE) 23 - PEDESTRIAN / SKATER
2 - PASSENGER VAN (MINIVAN) 8 - MOTORCYCLE 3-WHEELED 13 - SNOWMOBILE 19 - BUS (16+ PASSENGERS) 24 - WHEELCHAIR (ANY TYPE)
3 - SPORT UTILITY VEHICLE 9 - AUTOCYCLE 14 - SINGLE UNIT TRUCK 20 - OTHER VEHICLE 25 - OTHER NON-MOTORIST
4 - PICK UP 10 - MOPED OR MOTORIZED BICYCLE 15 - SEMI-TRACTOR 21 - HEAVY EQUIPMENT 26 - BICYCLE
5 - CARGO VAN 11 - ALL TERRAIN VEHICLE (ATV/UTV) 16 - FARM EQUIPMENT 22 - ANIMAL WITH RIDER OR ANIMAL-DRAWN VEHICLE 27 - TRAIN
6 - VAN (9-15 SEATS) 17 - MOTORHOME

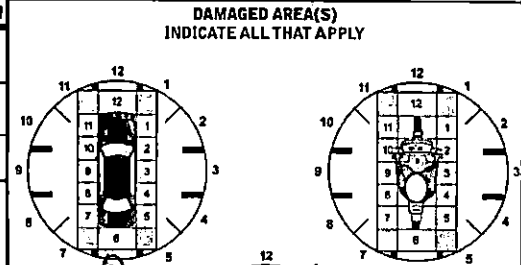

WAS VEHICLE OPERATING IN AUTONOMOUS MODE WHEN CRASH OCCURRED? 0

2 1 - YES 2 - NO 9 - OTHER / UNKNOWN AUTONOMOUS MODE LEVEL 0 1 - NO AUTOMATION 2 - PARTIAL AUTOMATION 3 - CONDITIONAL AUTOMATION 4 - HIGH AUTOMATION 5 - FULL AUTOMATION 9 - UNKNOWN

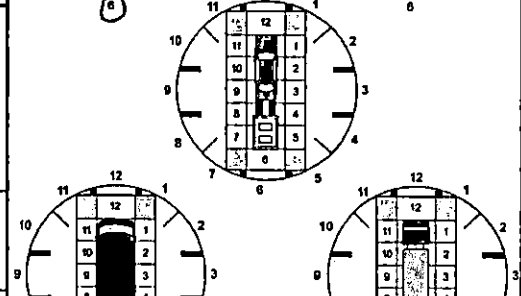

SPECIAL FUNCTION 01

1 - NONE 6 - BUS - CHARTER/TOUR 11 - FIRE 16 - FARM 21 - MAIL CARRIER
2 - TAXI 7 - BUS - INTERCITY 12 - MILITARY 17 - MOWING 99 - OTHER / UNKNOWN
3 - ELECTRONIC RIDE SHARING 8 - BUS - SHUTTLE 13 - POLICE 18 - SNOW REMOVAL
4 - SCHOOL TRANSPORT 9 - BUS - OTHER 14 - PUBLIC UTILITY 19 - TOWING
5 - BUS - TRANSIT/COMMUTER 10 - AMBULANCE 15 - CONSTRUCTION EQUIPMENT 20 - SAFETY SERVICE PATROL

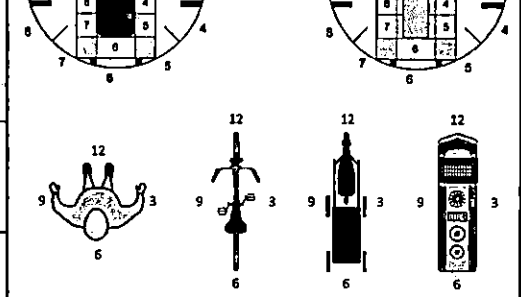

CARGO BODY TYPE 01

1 - NO CARGO BODY TYPE / NOT APPLICABLE 3 - VEHICLE TOWING ANOTHER MOTOR VEHICLE 5 - INTERMODAL CONTAINER CHASSIS 8 - POLE 12 - CONCRETE MIXER
2 - BUS 4 - LOGGING 6 - CARGO VAN/ENCLOSED BOX 9 - CARGO TANK 13 - AUTO TRANSPORTER
7 - GRAIN/CHIPS/GRAVEL 10 - FLAT BED 14 - GARBAGE/REFUSE
11 - DUMP 99 - OTHER / UNKNOWN

- NO DAMAGE [0] - UNDERCARRIAGE [14]
 - TOP [13] - ALL AREAS [15]
 - UNIT NOT AT SCENE [16]

VEHICLE DEFECTS

1 - TURN SIGNALS 4 - BRAKES 7 - WORN OR SLICK TIRES 9 - MOTOR TROUBLE 99 - OTHER / UNKNOWN
2 - HEAD LAMPS 5 - STEERING 8 - TRAILER EQUIPMENT DEFECTIVE 10 - DISABLED FROM PRIOR ACCIDENT
3 - TAIL LAMPS 6 - TIRE BLOWOUT

NON-MOTORIST LOCATION AT IMPACT

1 - INTERSECTION - MARKED CROSSWALK 3 - INTERSECTION - OTHER 6 - BICYCLE LANE 9 - MEDIAN/CROSSING ISLAND 12 - FIRST RESPONDER AT INCIDENT SCENE
2 - INTERSECTION - UNMARKED CROSSWALK 4 - MIDBLOCK - MARKED CROSSWALK 7 - SHOULDER / ROADSIDE 10 - DRIVEWAY ACCESS 99 - OTHER / UNKNOWN
5 - TRAVEL LANE - OTHER LOCATION 8 - SIDEWALK 11 - SHARED USE PATHS OR TRAILS

ACTION 04 PRE-CRASH ACTIONS 11

1 - NON-CONTACT 1 - STRAIGHT AHEAD 7 - MAKING U-TURN 13 - NEGOTIATING A CURVE 18 - APPROACHING OR LEAVING VEHICLE
2 - NON-COLLISION 2 - BACKING 8 - ENTERING TRAFFIC LANE 14 - ENTERING OR CROSSING SPECIFIED LOCATION 19 - STANDING
3 - STRIKING 3 - CHANGING LANES 9 - LEAVING TRAFFIC LANE 15 - WALKING, RUNNING, JOGGING, PLAYING 20 - OTHER NON-MOTORIST
4 - STRUCK 4 - OVERTAKING/PASSING 10 - PARKED 16 - WORKING 21 - STANDING OUTSIDE DISABLED VEHICLE
5 - BOTH STRIKING & STRUCK 5 - MAKING RIGHT TURN 11 - SLOWING OR STOPPED IN TRAFFIC 17 - PUSHING VEHICLE 99 - OTHER / UNKNOWN
9 - OTHER / UNKNOWN 6 - MAKING LEFT TURN 12 - DRIVERLESS

INITIAL POINT OF CONTACT

06 0 - NO DAMAGE 14 - UNDERCARRIAGE
1-12 - REFER TO UNIT DIAGRAM 15 - VEHICLE NOT AT SCENE
13 - TOP 99 - UNKNOWN

CONTRIBUTING CIRCUMSTANCES

1 - NONE 7 - LEFT OF CENTER 13 - IMPROPER START FROM A PARKED POSITION 17 - VISION OBSTRUCTION 21 - LYING IN ROADWAY
2 - FAILURE TO YIELD 8 - FOLLOWING TOO CLOSE / ACDA 14 - STOPPED OR PARKED ILLEGALLY 18 - OPERATING DEFECTIVE EQUIPMENT 22 - NOT DISCERNIBLE
3 - RAN RED LIGHT 9 - IMPROPER LANE CHANGE 15 - SWERVING TO AVOID 19 - LOAD SHIFTING/FALLING/SPILLING 23 - OPENING DOOR INTO ROADWAY
4 - RAN STOP SIGN 10 - IMPROPER PASSING 16 - WRONGWAY 20 - IMPROPER CROSSING 99 - OTHER IMPROPER ACTION
5 - UNSAFE SPEED 11 - DROVE OFF ROAD 17 - VISION OBSTRUCTION 21 - LYING IN ROADWAY
6 - IMPROPER TURN 12 - IMPROPER BACKING

TRAFFIC

TRAFFICWAY FLOW 2 1 - ONE-WAY 2 - TWO-WAY

TRAFFIC CONTROL 6 1 - ROUNDABOUT 4 - STOP SIGN 2 - SIGNAL 5 - YIELD SIGN 3 - FLASHER 6 - NO CONTROL

SEQUENCE OF EVENTS

120 1 - OVERTURN/ROLLOVER 6 - EQUIPMENT FAILURE 11 - CROSS CENTERLINE - OPPOSITE DIRECTION OF TRAVEL 16 - RAILWAY VEHICLE 22 - WORK ZONE MAINTENANCE EQUIPMENT
2 2 - FIRE/EXPLOSION 7 - SEPARATION OF UNITS 12 - DOWNHILL RUNAWAY 17 - ANIMAL - FARM 23 - STRUCK BY FALLING, SHIFTING CARGO OR ANYTHING SET IN MOTION BY A MOTOR VEHICLE
3 3 - IMMERSION 8 - RAN OFF ROAD RIGHT 13 - OTHER NON-COLLISION 18 - ANIMAL - DEER 24 - OTHER MOVABLE OBJECT
4 4 - JACKKNIFE 9 - RAN OFF ROAD LEFT 14 - PEDESTRIAN 19 - ANIMAL - OTHER 25 - WORK ZONE MAINTENANCE EQUIPMENT
5 5 - CARGO / EQUIPMENT LOSS OR SHIFT 10 - CROSS MEDIAN 15 - PEDALCYCLE 20 - MOTOR VEHICLE IN TRANSPORT 51 - WALL
6 27 - BRIDGE PIER OR ABUTMENT 31 - GUARDRAIL END 37 - TRAFFIC SIGN POST 43 - CURB 52 - BUILDING
28 - BRIDGE PARAPET 32 - PORTABLE BARRIER 38 - OVERHEAD SIGN POST 44 - DITCH 53 - TUNNEL
29 - BRIDGE RAIL 33 - MEDIUM CABLE BARRIER 39 - LIGHT LUMINARIES SUPPORT 45 - EMBANKMENT 54 - OTHER FIXED OBJECT
30 - GUARDRAIL FACE 34 - MEDIUM GUARDRAIL BARRIER 40 - UTILITY POLE 46 - FENCE 99 - OTHER / UNKNOWN
35 - MEDIUM CONCRETE BARRIER 41 - OTHER POST, POLE OR SUPPORT 47 - MAILBOX
36 - MEDIUM OTHER BARRIER 42 - CULVERT 48 - TREE 49 - FIRE HYDRANT

OF THROUGH LANES ON ROAD 4 RAIL GRADE CROSSING 1

1 - NOT INVOLVED 2 - INVOLVED-ACTIVE CROSSING 3 - INVOLVED-PASSIVE CROSSING

FIRST HARMFUL EVENT 1 MOST HARMFUL EVENT 1

UNIT / NON-MOTORIST DIRECTION

FROM 1 TO 2

1 - NORTH 5 - NORTHEAST
2 - SOUTH 6 - NORTHWEST
3 - EAST 7 - SOUTHEAST
4 - WEST 8 - SOUTHWEST
9 - OTHER / UNKNOWN

UNIT SPEED 5 POSTED SPEED 35

DETECTED SPEED 1 1 - STATED / ESTIMATED SPEED 2 - CALCULATED / EDR 3 - UNDETERMINED

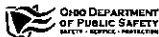

MOTORIST / Non-MOTORIST

LOCAL REPORT NUMBER
2 3 0 0 2 9 6 6

UNIT # 0 1	NAME: LAST, FIRST, MIDDLE Tribble, Amanda, Nicole	DATE OF BIRTH 1 1 0 8 1 9 9 2	AGE 3 0	GENDER F
---------------	--	----------------------------------	------------	-------------

ADDRESS: STREET, CITY, STATE, ZIP 5344 Plover Lane, Cincinnati, Ohio, 45238	CONTACT PHONE - INCLUDE AREA CODE
--	-----------------------------------

INJURIES 5	INJURED TAKEN BY 1	EMS AGENCY (NAME)	INJURED TAKEN TO: MEDICAL FACILITY (NAME, CITY)	SAFETY EQUIPMENT USED 0 4	<input type="checkbox"/> DOT-COMPLIANT MC HELMET	SEATING POSITION 0 1	AIR BAG USAGE 1	EJECTION 1	TRAPPED 1
---------------	-----------------------	-------------------	---	------------------------------	--	-------------------------	--------------------	---------------	--------------

OL STATE OH	OPERATOR LICENSE NUMBER	OFFENSE CHARGED 333.03A	LOCAL CODE <input checked="" type="checkbox"/>	OFFENSE DESCRIPTION ACDA	CITATION NUMBER 253229
----------------	-------------------------	----------------------------	---	-----------------------------	---------------------------

OL CLASS 4	ENDORSEMENT SELECT UP TO 2	RESTRICTION SELECT UP TO 3	DRIVER DISTRACTED BY 7	ALCOHOL / DRUG SUSPECTED <input type="checkbox"/> ALCOHOL <input type="checkbox"/> MARIJUANA <input type="checkbox"/> OTHER DRUG	CONDITION 1	ALCOHOL TEST STATUS TYPE VALUE			DRUG TEST(S) STATUS TYPE RESULT SELECT UP TO 4		
---------------	----------------------------	----------------------------	---------------------------	--	----------------	-----------------------------------	--	--	---	--	--

UNIT # 0 2	NAME: LAST, FIRST, MIDDLE Mendez, Alaina, M	DATE OF BIRTH 0 5 2 6 2 0 0 4	AGE 1 8	GENDER F
---------------	--	----------------------------------	------------	-------------

ADDRESS: STREET, CITY, STATE, ZIP 2056 Logan Avenue, Hamilton, Ohio, 45015	CONTACT PHONE - INCLUDE AREA CODE
---	-----------------------------------

INJURIES 5	INJURED TAKEN BY 1	EMS AGENCY (NAME)	INJURED TAKEN TO: MEDICAL FACILITY (NAME, CITY)	SAFETY EQUIPMENT USED 0 4	<input type="checkbox"/> DOT-COMPLIANT MC HELMET	SEATING POSITION 0 1	AIR BAG USAGE 1	EJECTION 1	TRAPPED 1
---------------	-----------------------	-------------------	---	------------------------------	--	-------------------------	--------------------	---------------	--------------

OL STATE OH	OPERATOR LICENSE NUMBER	OFFENSE CHARGED	LOCAL CODE <input type="checkbox"/>	OFFENSE DESCRIPTION	CITATION NUMBER
----------------	-------------------------	-----------------	--	---------------------	-----------------

OL CLASS 4	ENDORSEMENT SELECT UP TO 2	RESTRICTION SELECT UP TO 3	DRIVER DISTRACTED BY 1	ALCOHOL / DRUG SUSPECTED <input type="checkbox"/> ALCOHOL <input type="checkbox"/> MARIJUANA <input type="checkbox"/> OTHER DRUG	CONDITION 1	ALCOHOL TEST STATUS TYPE VALUE			DRUG TEST(S) STATUS TYPE RESULT SELECT UP TO 4		
---------------	----------------------------	----------------------------	---------------------------	--	----------------	-----------------------------------	--	--	---	--	--

UNIT #	NAME: LAST, FIRST, MIDDLE	DATE OF BIRTH	AGE	GENDER
--------	---------------------------	---------------	-----	--------

ADDRESS: STREET, CITY, STATE, ZIP	CONTACT PHONE - INCLUDE AREA CODE
-----------------------------------	-----------------------------------

INJURIES	INJURED TAKEN BY	EMS AGENCY (NAME)	INJURED TAKEN TO: MEDICAL FACILITY (NAME, CITY)	SAFETY EQUIPMENT USED	<input type="checkbox"/> DOT-COMPLIANT MC HELMET	SEATING POSITION	AIR BAG USAGE	EJECTION	TRAPPED
----------	------------------	-------------------	---	-----------------------	--	------------------	---------------	----------	---------

OL STATE	OPERATOR LICENSE NUMBER	OFFENSE CHARGED	LOCAL CODE <input type="checkbox"/>	OFFENSE DESCRIPTION	CITATION NUMBER
----------	-------------------------	-----------------	--	---------------------	-----------------

OL CLASS	ENDORSEMENT SELECT UP TO 2	RESTRICTION SELECT UP TO 3	DRIVER DISTRACTED BY	ALCOHOL / DRUG SUSPECTED <input type="checkbox"/> ALCOHOL <input type="checkbox"/> MARIJUANA <input type="checkbox"/> OTHER DRUG	CONDITION	ALCOHOL TEST STATUS TYPE VALUE			DRUG TEST(S) STATUS TYPE RESULT SELECT UP TO 4		
----------	----------------------------	----------------------------	----------------------	--	-----------	-----------------------------------	--	--	---	--	--

INJURIES	SEATING POSITION	AIR BAG	OL CLASS	OL RESTRICTION(S)	DRIVER DISTRACTION	TEST STATUS
1 - FATAL	1 - FRONT - LEFT SIDE (MOTORCYCLE DRIVER)	1 - NOT DEPLOYED	1 - CLASS A	1 - ALCOHOL INTERLOCK DEVICE	1 - NOT DISTRACTED	1 - NONE GIVEN
2 - SUSPECTED SERIOUS INJURY	2 - FRONT - MIDDLE	2 - DEPLOYED FRONT	2 - CLASS B	2 - CDL INTRASTATE ONLY	2 - MANUALLY OPERATING AN ELECTRONIC COMMUNICATION DEVICE (TEXTING, TYPING, DIALING)	2 - TEST REFUSED
3 - SUSPECTED MINOR INJURY	3 - FRONT - RIGHT SIDE	3 - DEPLOYED SIDE	3 - CLASS C	3 - CORRECTIVE LENSES	3 - TALKING ON HANDS-FREE COMMUNICATION DEVICE	3 - TEST GIVEN, CONTAMINATED SAMPLE / UNUSABLE
4 - POSSIBLE INJURY	4 - SECOND - LEFT SIDE (MOTORCYCLE PASSENGER)	4 - DEPLOYED BOTH FRONT / SIDE	4 - REGULAR CLASS (OHIO = D)	4 - FARM WAIVER	4 - TALKING ON HAND-HELD COMMUNICATION DEVICE	4 - TEST GIVEN, RESULTS KNOWN
5 - NO APPARENT INJURY	5 - SECOND - MIDDLE	5 - NOT APPLICABLE	5 - MVC MOPED ONLY	5 - EXCEPT CLASS A BUS & CLASS B BUS	5 - OTHER ACTIVITY WITH AN ELECTRONIC DEVICE	5 - TEST GIVEN, RESULTS UNKNOWN
	6 - SECOND - RIGHT SIDE	9 - DEPLOYMENT UNKNOWN	6 - NO VALID OL	7 - EXCEPT TRACTOR-TRAILER	6 - PASSENGER	
	7 - THIRD - LEFT SIDE (MOTORCYCLE SIDE CAR)			8 - INTERMEDIATE LICENSE RESTRICTIONS	7 - OTHER DISTRACTION INSIDE THE VEHICLE	ALCOHOL TEST TYPE
	8 - THIRD - MIDDLE	EJECTION		9 - LEARNER'S PERMIT RESTRICTIONS	8 - OTHER DISTRACTION OUTSIDE THE VEHICLE	1 - NONE
	9 - THIRD - RIGHT SIDE	1 - NOT EJECTED	OL ENDORSEMENT	10 - LIMITED TO DAYLIGHT ONLY	9 - OTHER / UNKNOWN	2 - BLOOD
	10 - SLEEPER SECTION OF TRUCK CAB	2 - PARTIALLY EJECTED	H - HAZMAT	11 - LIMITED TO EMPLOYMENT		3 - URINE
	11 - PASSENGER IN OTHER ENCLOSED CARGO AREA (NON-TRAILING UNIT, BUS, PICK-UP WITH CAP)	3 - TOTALLY EJECTED	M - MOTORCYCLE	12 - LIMITED - OTHER		4 - BREATH
	12 - PASSENGER IN UNENCLOSED CARGO AREA	4 - NOT APPLICABLE	P - PASSENGER	13 - MECHANICAL DEVICES (SPECIAL BRAKES, HAND CONTROLS, OR OTHER ADAPTIVE DEVICES)		5 - OTHER
	13 - TRAILING UNIT		N - TANKER	14 - MILITARY VEHICLES ONLY	CONDITION	DRUG TEST TYPE
	14 - RIDING ON VEHICLE EXTERIOR (NON-TRAILING UNIT)	TRAPPED	Q - MOTOR SCOOTER	15 - MOTOR VEHICLES WITHOUT AIR BRAKES	1 - APPARENTLY NORMAL	1 - NONE
	15 - NON-MOTORIST	1 - NOT TRAPPED	R - THREE-WHEEL MOTORCYCLE	16 - OUTSIDE MIRROR	2 - PHYSICAL IMPAIRMENT	2 - BLOOD
	99 - OTHER / UNKNOWN	2 - EXTRICATED BY MECHANICAL MEANS	S - SCHOOL BUS	17 - PROSTHETIC AID	3 - EMOTIONAL (E.G., DEPRESSED, ANGRY, DISTURBED)	3 - URINE
		3 - FREED BY NON-MECHANICAL MEANS	T - DOUBLE & TRIPLE TRAILERS	18 - OTHER	4 - ILLNESS	4 - OTHER
			X - TANKER / HAZMAT		5 - FELL ASLEEP, FAINTED, FATIGUED, ETC.	
					6 - UNDER THE INFLUENCE OF MEDICATIONS / DRUGS / ALCOHOL	DRUG TEST RESULT(S)
			GENDER		9 - OTHER / UNKNOWN	1 - AMPHETAMINES
			F - FEMALE			2 - BARBITURATES
			M - MALE			3 - BENZODIAZEPINES
			U - OTHER / UNKNOWN			4 - CANNABINOIDS
						5 - COCAINE
						6 - OPIATES / OPIOIDS
						7 - OTHER
						8 - NEGATIVE RESULTS



OCCUPANT / WITNESS ADDENDUM

LOCAL REPORT NUMBER
2 3 0 0 2 9 6 6

OCCUPANT	UNIT # 1	NAME: LAST, FIRST, MIDDLE Tribble, Evelin	DATE OF BIRTH 0 1 1 1 2 0 1 7		AGE 6	GENDER F				
	ADDRESS: STREET, CITY, STATE, ZIP 5344 Plover Lane, Cincinnati, Ohio, 45238			CONTACT PHONE - INCLUDE AREA CODE						
INJURIES 5	INJURED TAKEN BY 1	EMS AGENCY (NAME)	INJURED TAKEN TO: MEDICAL FACILITY (NAME, CITY)	SAFETY EQUIPMENT USED 0 6	<input type="checkbox"/> DOT-COMPLIANT MC HELMET	<table border="1"> <tr> <td>SEATING POSITION 0 4</td> <td>AIR BAG USAGE 0 1</td> <td>EJECTION 1</td> <td>TRAPPED 1</td> </tr> </table>	SEATING POSITION 0 4	AIR BAG USAGE 0 1	EJECTION 1	TRAPPED 1
SEATING POSITION 0 4	AIR BAG USAGE 0 1	EJECTION 1	TRAPPED 1							

OCCUPANT	UNIT # 1	NAME: LAST, FIRST, MIDDLE Tribble, Charlotte	DATE OF BIRTH 0 6 0 5 2 0 1 3		AGE 9	GENDER F				
	ADDRESS: STREET, CITY, STATE, ZIP 5344 Plover Lane, Cincinnati, Ohio, 45238			CONTACT PHONE - INCLUDE AREA CODE						
INJURIES 5	INJURED TAKEN BY 1	EMS AGENCY (NAME)	INJURED TAKEN TO: MEDICAL FACILITY (NAME, CITY)	SAFETY EQUIPMENT USED 0 5	<input type="checkbox"/> DOT-COMPLIANT MC HELMET	<table border="1"> <tr> <td>SEATING POSITION 0 6</td> <td>AIR BAG USAGE 0 1</td> <td>EJECTION 1</td> <td>TRAPPED 1</td> </tr> </table>	SEATING POSITION 0 6	AIR BAG USAGE 0 1	EJECTION 1	TRAPPED 1
SEATING POSITION 0 6	AIR BAG USAGE 0 1	EJECTION 1	TRAPPED 1							

OCCUPANT	UNIT # 2	NAME: LAST, FIRST, MIDDLE Perez, Maria	DATE OF BIRTH 1 1 1 5 1 9 8 2		AGE 4 0	GENDER F				
	ADDRESS: STREET, CITY, STATE, ZIP 1160 Hamilton Avenue, Hamilton, Ohio, 45011			CONTACT PHONE - INCLUDE AREA CODE						
INJURIES 5	INJURED TAKEN BY 1	EMS AGENCY (NAME)	INJURED TAKEN TO: MEDICAL FACILITY (NAME, CITY)	SAFETY EQUIPMENT USED 0 4	<input type="checkbox"/> DOT-COMPLIANT MC HELMET	<table border="1"> <tr> <td>SEATING POSITION 0 3</td> <td>AIR BAG USAGE 0 1</td> <td>EJECTION 1</td> <td>TRAPPED 1</td> </tr> </table>	SEATING POSITION 0 3	AIR BAG USAGE 0 1	EJECTION 1	TRAPPED 1
SEATING POSITION 0 3	AIR BAG USAGE 0 1	EJECTION 1	TRAPPED 1							

OCCUPANT	UNIT #	NAME: LAST, FIRST, MIDDLE	DATE OF BIRTH		AGE 0	GENDER				
	ADDRESS: STREET, CITY, STATE, ZIP			CONTACT PHONE - INCLUDE AREA CODE						
INJURIES	INJURED TAKEN BY	EMS AGENCY (NAME)	INJURED TAKEN TO: MEDICAL FACILITY (NAME, CITY)	SAFETY EQUIPMENT USED	<input type="checkbox"/> DOT-COMPLIANT MC HELMET	<table border="1"> <tr> <td>SEATING POSITION</td> <td>AIR BAG USAGE</td> <td>EJECTION</td> <td>TRAPPED</td> </tr> </table>	SEATING POSITION	AIR BAG USAGE	EJECTION	TRAPPED
SEATING POSITION	AIR BAG USAGE	EJECTION	TRAPPED							

INJURIES	SAFETY EQUIPMENT USED	SEATING POSITION	AIR BAG USAGE
1 - FATAL	1 - NONE USED - VEHICLE OCCUPANT	1 - FRONT - LEFT SIDE (MOTORCYCLE DRIVER)	1 - NOT DEPLOYED
2 - SUSPECTED SERIOUS INJURY	2 - SHOULDER BELT ONLY USED	2 - FRONT - MIDDLE	2 - DEPLOYED FRONT
3 - SUSPECTED MINOR INJURY	3 - LAP BELT ONLY USED	3 - FRONT - RIGHT SIDE	3 - DEPLOYED SIDE
4 - POSSIBLE INJURY	4 - SHOULDER & LAP BELT USED	4 - SECOND - LEFT SIDE (MOTORCYCLE PASSENGER)	4 - DEPLOYED BOTH FRONT/SIDE
5 - NO APPARENT INJURY	5 - CHILD RESTRAINT SYSTEM - FORWARD FACING	5 - SECOND - MIDDLE	5 - NOT APPLICABLE
INJURED TAKEN BY			
1 - NOT TRANSPORTED / TREATED AT SCENE	6 - CHILD RESTRAINT SYSTEM - REAR FACING	6 - SECOND - RIGHT SIDE	9 - DEPLOYMENT UNKNOWN
2 - EMS	7 - BOOSTER SEAT	7 - THIRD - LEFT SIDE (MOTORCYCLE SIDE CAR)	EJECTION
3 - POLICE	8 - HELMET USED	8 - THIRD - MIDDLE	1 - NOT EJECTED
9 - OTHER / UNKNOWN	9 - PROTECTIVE PADS USED (ELBOW, KNEES, ETC.)	9 - THIRD - RIGHT SIDE	2 - PARTIALLY EJECTED
GENDER			
F - FEMALE	10 - REFLECTIVE CLOTHING	10 - SLEEPER SECTION OF TRUCK CAB	3 - TOTALLY EJECTED
M - MALE	11 - LIGHTING - PEDESTRIAN / BICYCLE ONLY	11 - PASSENGER IN OTHER ENCLOSED CARGO AREA (NON-TRAILING UNIT, BUS, PICK-UP WITH CAP)	4 - NOT APPLICABLE
U - OTHER / UNKNOWN	99 - OTHER / UNKNOWN	12 - PASSENGER IN UNENCLOSED CARGO AREA	TRAPPED
		13 - TRAILING UNIT	1 - NOT TRAPPED
		14 - RIDING ON VEHICLE EXTERIOR (NON-TRAILING UNIT)	2 - EXTRICATED BY MECHANICAL MEANS
		15 - NON-MOTORIST	3 - FREED BY NON-MECHANICAL MEANS
		99 - OTHER / UNKNOWN	

WITNESS	NAME: LAST, FIRST, MIDDLE	DATE OF BIRTH		AGE 0	GENDER
	ADDRESS: STREET, CITY, STATE, ZIP			CONTACT PHONE - INCLUDE AREA CODE	

WITNESS	NAME: LAST, FIRST, MIDDLE	DATE OF BIRTH		AGE 0	GENDER
	ADDRESS: STREET, CITY, STATE, ZIP			CONTACT PHONE - INCLUDE AREA CODE	

WITNESS	NAME: LAST, FIRST, MIDDLE	DATE OF BIRTH		AGE 0	GENDER
	ADDRESS: STREET, CITY, STATE, ZIP			CONTACT PHONE - INCLUDE AREA CODE	

LOCAL REPORT NUMBER PD-23-02966	REPORTING AGENCY Fairfield Police Department	DATE OF ACCIDENT 01/12/2022
IN COUNTY OF Butler	ACCIDENT LOCATION South Gilmore Road near 5679 South Gilmore	

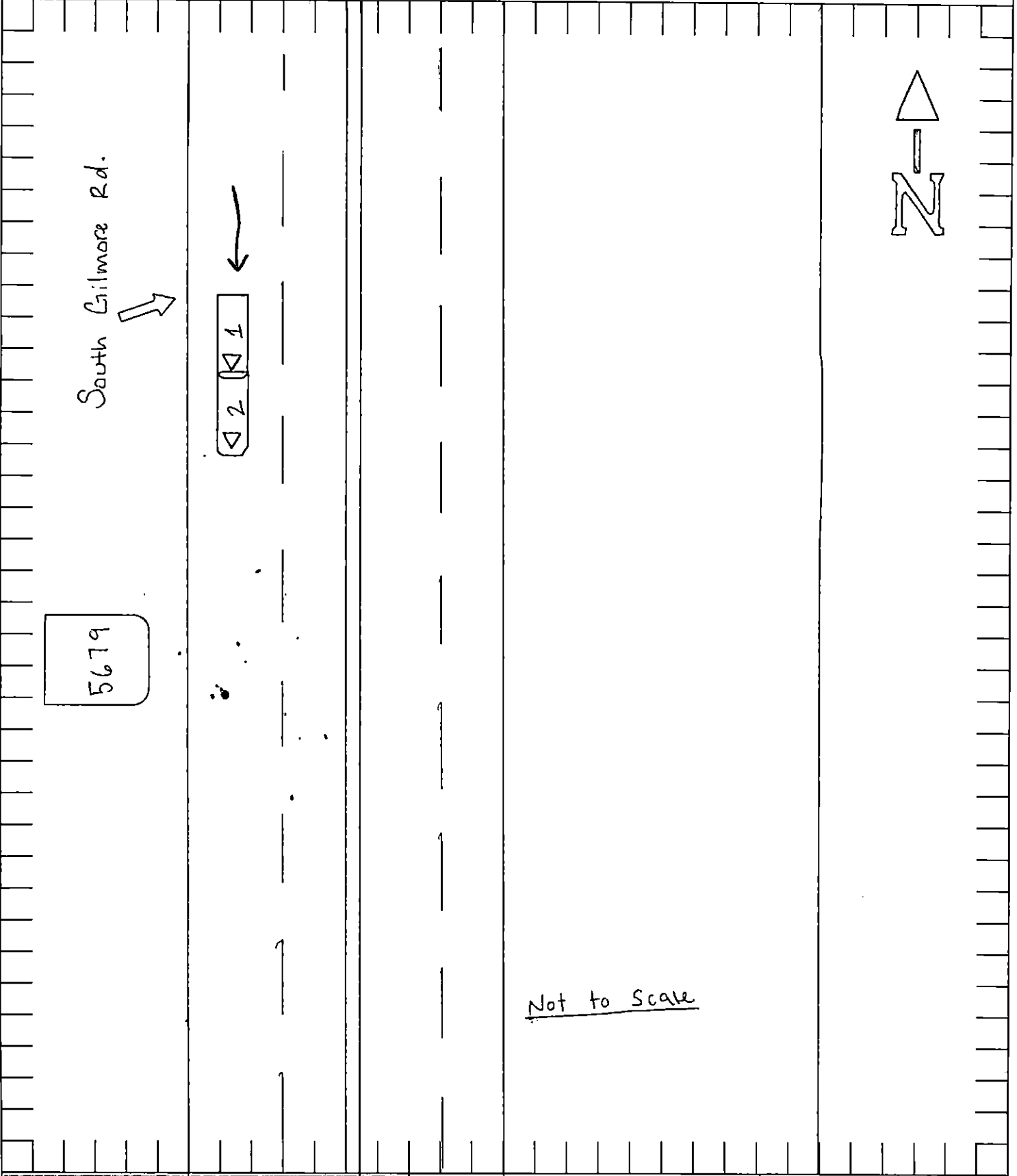

OFFICER'S SIGNATURE <i>Nicholas J. [Signature]</i>	BADGE NO. 175
---	------------------