



# TRAFFIC CRASH REPORT

\*DENOTES MANDATORY FIELD FOR SUPPLEMENT REPORT

LOCAL REPORT NUMBER\*

<input checked="" type="checkbox"/> PHOTOS TAKEN	<input checked="" type="checkbox"/> OH-2	<input type="checkbox"/> OH-3	LOCAL INFORMATION	2 3 0 0 3 9 1 9			
<input type="checkbox"/> SECONDARY CRASH	<input type="checkbox"/> OH-1P	<input type="checkbox"/> OTHER	REPORTING AGENCY NAME*	NCIC*	HIT/SKIP 1 - SOLVED 2 - UNSOLVED	NUMBER OF UNITS 0 2	UNIT IN ERROR 98 - ANIMAL 99 - UNKNOWN
<input type="checkbox"/> PRIVATE PROPERTY	Fairfield Police Department		0 0 9 0 1	0 1 1 6 2 0 2 3 0 8 2 0			5
COUNTY* 0 9	LOCALITY* 1 - CITY 2 - VILLAGE 3 - TOWNSHIP	LOCATION: CITY, VILLAGE, TOWNSHIP* City of Fairfield		CRASH DATE / TIME*			CRASH SEVERITY 1 - FATAL 2 - SERIOUS INJURY SUSPECTED 3 - MINOR INJURY SUSPECTED 4 - INJURY POSSIBLE 5 - PROPERTY DAMAGE ONLY
ROUTE TYPE S R	ROUTE NUMBER 4	PREFIX 1 - NORTH 2 - SOUTH 3 - EAST 4 - WEST	LOCATION ROAD NAME	ROAD TYPE	LATITUDE DECIMAL DEGREES 3 9 . 3 3 6 9 3 8		
ROUTE TYPE	ROUTE NUMBER	PREFIX 1 - NORTH 2 - SOUTH 3 - EAST 4 - WEST	REFERENCE ROAD NAME (ROAD, MILEPOST, HOUSE #) 5300	ROAD TYPE	LONGITUDE DECIMAL DEGREES - 8 4 . 5 2 9 7 9 3		

REFERENCE POINT 1 - INTERSECTION 2 - MILE POST 3 - HOUSE # 3	DIRECTION FROM REFERENCE 1 - NORTH 2 - SOUTH 3 - EAST 4 - WEST	ROUTE TYPE IR - INTERSTATE ROUTE (I.P.) US - FEDERAL US ROUTE SR - STATE ROUTE CR - NUMBERED COUNTY ROUTE TR - NUMBERED TOWNSHIP ROUTE	ROAD TYPE AL - ALLEY AV - AVENUE BL - BOULEVARD CR - CIRCLE CT - COURT DR - DRIVE HE - HEIGHTS HW - HIGHWAY LA - LANE MP - MILEPOST OV - OVAL PK - PARKWAY PI - PIKE PL - PLACE RD - ROAD SQ - SQUARE ST - STREET TE - TERRACE TL - TRAIL WA - WAY	INTERSECTION RELATED <input type="checkbox"/> WITHIN INTERSECTION OR ON APPROACH <input type="checkbox"/> WITHIN INTERCHANGE AREA		NUMBER OF APPROACHES
DISTANCE FROM REFERENCE	DISTANCE UNIT OF MEASURE 1 - MILES 2 - FEET 3 - YARDS			ROADWAY <input type="checkbox"/> ROADWAY DIVIDED		

LOCATION OF FIRST HARMFUL EVENT 1 - ON ROADWAY 2 - ON SHOULDER 3 - IN MEDIAN 4 - ON ROADSIDE 5 - ON GORE 6 - OUTSIDE TRAFFIC WAY 7 - ON RAMP 8 - OFF RAMP 0 1	9 - CROSSOVER 10 - DRIVEWAY/ALLEY ACCESS 11 - RAILWAY GRADE CROSSING 12 - SHARED USE PATHS OR TRAILS 13 - BIKE LANE 14 - TOLL BOOTH 99 - OTHER / UNKNOWN	MANNER OF CRASH COLLISION/IMPACT 1 - NOT COLLISION BETWEEN TWO MOTOR VEHICLES IN TRANSPORT 2 - REAR-END 3 - HEAD-ON 4 - REAR-TO-REAR 5 - BACKING 6 - ANGLE 7 - SIDESWIPE, SAME DIRECTION 8 - SIDESWIPE, OPPOSITE DIRECTION 9 - OTHER / UNKNOWN 2	DIRECTION OF TRAVEL 1 - NORTH 2 - SOUTH 3 - EAST 4 - WEST	MEDIAN TYPE 1 - DIVIDED FLUSH MEDIAN (<4 FEET) 2 - DIVIDED FLUSH MEDIAN (≥4 FEET) 3 - DIVIDED, DEPRESSED MEDIAN 4 - DIVIDED, RAISED MEDIAN (ANY TYPE) 9 - OTHER/UNKNOWN
--	--	--	---	--

<input type="checkbox"/> WORK ZONE RELATED <input type="checkbox"/> WORKERS PRESENT <input type="checkbox"/> LAW ENFORCEMENT PRESENT <input type="checkbox"/> ACTIVE SCHOOL ZONE	WORK ZONE TYPE 1 - LANE CLOSURE 2 - LANE SHIFT/CROSSOVER 3 - WORK ON SHOULDER OR MEDIAN 4 - INTERMITTENT OR MOVING WORK 5 - OTHER	LOCATION OF CRASH IN WORK ZONE 1 - BEFORE THE 1ST WORK ZONE WARNING SIGN 2 - ADVANCE WARNING AREA 3 - TRANSITION AREA 4 - ACTIVITY AREA 5 - TERMINATION AREA	CONTOUR 1	CONDITIONS 1	SURFACE 2
---	--	---	--------------	-----------------	--------------

LIGHT CONDITION 1 - DAYLIGHT 2 - DAWN/DUSK 3 - DARK - LIGHTED ROADWAY 4 - DARK - ROADWAY NOT LIGHTED 5 - DARK - UNKNOWN ROADWAY LIGHTING 9 - OTHER / UNKNOWN 1	WEATHER 1 - CLEAR 2 - CLOUDY 3 - FOG, SMOG, SMOKE 4 - RAIN 5 - SLEET, HAIL 6 - SNOW 7 - SEVERE CROSSWINDS 8 - BLOWING SAND, SOIL, DIRT, SNOW 9 - FREEZING RAIN OR FREEZING DRIZZLE 99 - OTHER / UNKNOWN 0 2	1 - STRAIGHT LEVEL 2 - STRAIGHT GRADE 3 - CURVE LEVEL 4 - CURVE GRADE 9 - OTHER/UNKNOWN	1 - DRY 2 - WET 3 - SNOW 4 - ICE 5 - SAND, MUD, DIRT, OIL, GRAVEL 6 - WATER (STANDING, MOVING) 7 - SLUSH 9 - OTHER/UNKNOWN	1 - CONCRETE 2 - BLACKTOP, BITUMINOUS, ASPHALT 3 - BRICK/BLOCK 4 - SLAG, GRAVEL, STONE 5 - DIRT 9 - OTHER/UNKNOWN
---	--	---	---	--

NARRATIVE

On January 16, 2023 at about 8:20 a.m. Unit 1 was traveling south on S.R. 4 (Dixie Hwy.) and when at 5300 Dixie Hwy. failed to stop within the assured clear distance ahead and collided with Unit 2 which was also southbound and was stopped in traffic.

SEE OH-2

Indicate the north direction with an "N" on the compass diagram.

CRASH REPORTED DATE / TIME 0 1 1 6 2 0 2 3 0 8 2 4	DISPATCH DATE / TIME 0 1 1 6 2 0 2 3 0 8 2 6	ARRIVAL DATE / TIME 0 1 1 6 2 0 2 3 0 8 3 0	SCENE CLEARED DATE / TIME 0 1 1 6 2 0 2 3 0 8 5 8	REPORT TAKEN BY <input checked="" type="checkbox"/> POLICE AGENCY <input type="checkbox"/> MOTORIST
TOTAL TIME ROADWAY CLOSED 0	OTHER INVESTIGATION TIME	TOTAL MINUTES 3 2	OFFICER'S NAME* P.O. RYAN FLEENOR	CHECKED BY OFFICER'S NAME* P.O. C. [Signature]
			OFFICER'S BADGE NUMBER* 1 1 7	CHECKED BY OFFICER'S BADGE NUMBER* 1 3 6
				<input type="checkbox"/> SUPPLEMENT (CORRECTION OR ADDITION TO AN EXISTING REPORT SENT TO OOPS)

<b>UNIT #</b> 011	<b>OWNER NAME: LAST, FIRST, MIDDLE</b> (SAME AS DRIVER)	<b>OWNER PHONE:</b> (INCLUDE AREA CODE) (SAME AS DRIVER)
<b>OWNER ADDRESS: STREET, CITY, STATE, ZIP</b> (SAME AS DRIVER)		
<b>COMMERCIAL CARRIER: NAME, ADDRESS, CITY, STATE, ZIP</b>		<b>COMMERCIAL CARRIER PHONE:</b> (INCLUDE AREA CODE)

<b>LP STATE</b> OH	<b>LICENSE PLATE #</b> JUW-9811	<b>VEHICLE IDENTIFICATION #</b> 1C14RDHAG15F1C12131913171	<b>VEHICLE YEAR</b> 2015	<b>VEHICLE MAKE</b> DODGE
<input checked="" type="checkbox"/> <b>INSURANCE VERIFIED</b>	<b>INSURANCE COMPANY</b> GEICO	<b>INSURANCE POLICY #</b> 60690636199	<b>COLOR</b> BLACK	<b>VEHICLE MODEL</b> DURANGO
<input type="checkbox"/> <b>COMMERCIAL</b>	<input type="checkbox"/> <b>GOVERNMENT</b>	<input type="checkbox"/> <b>IN EMERGENCY RESPONSE</b>	<b>US DOT #</b>	
<input type="checkbox"/> <b>INTERLOCK DEVICE EQUIPPED</b>	<input type="checkbox"/> <b>HIT/SKIP UNIT</b>	<b>#OCCUPANTS</b> 01	<b>VEHICLE WEIGHT GVWR/GCWR</b> 1 - ≤10K LBS. 2 - 10,001 - 26K LBS. 3 - >26K LBS.	
<b>TYPE OF USE</b>			<b>TOWED BY: COMPANY NAME</b>	
<input type="checkbox"/> <b>HAZARDOUS MATERIAL</b>			<input type="checkbox"/> <b>MATERIAL RELEASED</b>	
<input type="checkbox"/> <b>PLACARD</b>			<b>CLASS # PLACARD ID #</b>	

<b>UNIT TYPE</b> 03	1 - PASSENGER CAR 2 - PASSENGER VAN (MINIVAN) 3 - SPORT UTILITY VEHICLE 4 - PICKUP 5 - CARGO VAN 6 - VAN (9-15 SEATS)	7 - MOTORCYCLE 2-WHEELED 8 - MOTORCYCLE 3-WHEELED 9 - AUTOCYCLE 10 - MOPED OR MOTORIZED BICYCLE 11 - ALL TERRAIN VEHICLE (ATV/UTV)	12 - GOLF CART 13 - SNOWMOBILE 14 - SINGLE UNIT TRUCK 15 - SEMI-TRACTOR 16 - FARM EQUIPMENT 17 - MOTORHOME	18 - LIM (LIVERY VEHICLE) 19 - BUS (16+ PASSENGERS) 20 - OTHER VEHICLE 21 - HEAVY EQUIPMENT 22 - ANIMAL WITH RIDER OR ANIMAL-DRAWN VEHICLE	23 - PEDESTRIAN / SKATER 24 - WHEELCHAIR (ANY TYPE) 25 - OTHER NON-MOTORIST 26 - BICYCLE 27 - TRAIN 99 - UNKNOWN OR HIT/SKIP
<b># OF TRAILING UNITS</b>					

<b>WAS VEHICLE OPERATING IN AUTONOMOUS MODE WHEN CRASH OCCURRED?</b> 02	1 - YES 2 - NO 9 - OTHER / UNKNOWN	<b>AUTONOMOUS MODE LEVEL</b>	0 - NO AUTOMATION 1 - DRIVER ASSISTANCE 2 - PARTIAL AUTOMATION 3 - CONDITIONAL AUTOMATION 4 - HIGH AUTOMATION 5 - FULL AUTOMATION 9 - UNKNOWN
--	--	------------------------------	---

<b>SPECIAL FUNCTION</b> 01	1 - NONE 2 - TAXI 3 - ELECTRONIC RIDE SHARING 4 - SCHOOL TRANSPORT 5 - BUS - TRANSIT/COMMUTER	6 - BUS - CHARTER/TOUR 7 - BUS - INTERCITY 8 - BUS - SHUTTLE 9 - BUS - OTHER 10 - AMBULANCE	11 - FIRE 12 - MILITARY 13 - POLICE 14 - PUBLIC UTILITY 15 - CONSTRUCTION EQUIPMENT	16 - FARM 17 - MOWING 18 - SNOW REMOVAL 19 - TOWING 20 - SAFETY SERVICE PATROL	21 - MAIL CARRIER 99 - OTHER / UNKNOWN
-------------------------------	---	---	---	--	---

<b>CARGO BODY TYPE</b> 01	1 - NO CARGO BODY TYPE / NOT APPLICABLE 2 - BUS	3 - VEHICLE TOWING ANOTHER MOTOR VEHICLE 4 - LOGGING	5 - INTERMODAL CONTAINER CHASSIS 6 - CARGO VAN/ENCLOSED BOX 7 - GRAIN/CHIPS/GRAVEL	8 - POLE 9 - CARGO TANK 10 - FLAT BED 11 - DUMP	12 - CONCRETE MIXER 13 - AUTO TRANSPORTER 14 - GARBAGE/REFUSE 99 - OTHER / UNKNOWN
------------------------------	--	---	--	--	---

<b>VEHICLE DEFECTS</b>	1 - TURN SIGNALS 2 - HEAD LAMPS 3 - TAIL LAMPS	4 - BRAKES 5 - STEERING 6 - TIRE BLOWOUT	7 - WORN OR SLICK TIRES 8 - TRAILER EQUIPMENT DEFECTIVE	9 - MOTOR TROUBLE 10 - DISABLED FROM PRIOR ACCIDENT	99 - OTHER / UNKNOWN
------------------------	--	--	--	--	----------------------

<b>NON-MOTORIST LOCATION AT IMPACT</b>	1 - INTERSECTION - MARKED CROSSWALK 2 - INTERSECTION - UNMARKED CROSSWALK	3 - INTERSECTION - OTHER 4 - MIDBLOCK - MARKED CROSSWALK 5 - TRAVEL LANE - OTHER LOCATION	6 - BICYCLE LANE 7 - SHOULDER / ROADSIDE 8 - SIDEWALK	9 - MEDIAN/CROSSING ISLAND 10 - DRIVEWAY ACCESS 11 - SHARED USE PATHS OR TRAILS	12 - FIRST RESPONDER AT INCIDENT SCENE 99 - OTHER / UNKNOWN
--	--	---	---	---	--

<b>ACTION</b> 03	1 - NON-CONTACT 2 - NON-COLLISION 3 - STRIKING 4 - STRUCK 5 - BOTH STRIKING & STRUCK 9 - OTHER / UNKNOWN	<b>PRE-CRASH ACTIONS</b> 01	1 - STRAIGHT AHEAD 2 - BACKING 3 - CHANGING LANES 4 - OVERTAKING/PASSING 5 - MAKING RIGHT TURN 6 - MAKING LEFT TURN	7 - MAKING U-TURN 8 - ENTERING TRAFFIC LANE 9 - LEAVING TRAFFIC LANE 10 - PARKED 11 - SLOWING OR STOPPED IN TRAFFIC 12 - DRIVERLESS	13 - NEGOTIATING A CURVE 14 - ENTERING OR CROSSING SPECIFIED LOCATION 15 - WALKING, RUNNING, JOGGING, PLAYING 16 - WORKING 17 - PUSHING VEHICLE	18 - APPROACHING OR LEAVING VEHICLE 19 - STANDING 20 - OTHER NON-MOTORIST 21 - STANDING OUTSIDE DISABLED VEHICLE 99 - OTHER / UNKNOWN
---------------------	---	--------------------------------	--	--	---	---

<b>CONTRIBUTING CIRCUMSTANCES</b> 08	1 - NONE 2 - FAILURE TO YIELD 3 - RAN RED LIGHT 4 - RAN STOP SIGN 5 - UNSAFE SPEED 6 - IMPROPER TURN	7 - LEFT OF CENTER 8 - FOLLOWING TOO CLOSE / ACDA 9 - IMPROPER LANE CHANGE 10 - IMPROPER PASSING 11 - DROVE OFF ROAD 12 - IMPROPER BACKING	13 - IMPROPER START FROM A PARKED POSITION 14 - STOPPED OR PARKED ILLEGALLY 15 - SWERVING TO AVOID 16 - WRONG WAY	17 - VISION OBSTRUCTION 18 - OPERATING DEFECTIVE EQUIPMENT 19 - LOAD SHIFTING/FALLING/SPILLING 20 - IMPROPER CROSSING	21 - LYING IN ROADWAY 22 - NOT DISCERNIBLE 23 - OPENING DOOR INTO ROADWAY 99 - OTHER IMPROPER ACTION
---	---	---	--	--	---

<b>SEQUENCE OF EVENTS</b>	1 2 0	1 - OVERTURN/Rollover 2 - FIRE/EXPLOSION 3 - IMMERSION 4 - JACKKNIFE 5 - CARGO / EQUIPMENT LOSS OR SHIFT	6 - EQUIPMENT FAILURE 7 - SEPARATION OF UNITS 8 - RAN OFF ROAD RIGHT 9 - RAN OFF ROAD LEFT 10 - CROSS MEDIAN	<b>NON-COLLISION</b>	11 - CROSS CENTERLINE - OPPOSITE DIRECTION OF TRAVEL 12 - DOWNHILL RUNAWAY 13 - OTHER NON-COLLISION 14 - PEDESTRIAN 15 - PEDALCYCLE	16 - RAILWAY VEHICLE 17 - ANIMAL - FARM 18 - ANIMAL - DEER 19 - ANIMAL - OTHER 20 - MOTOR VEHICLE IN TRANSPORT 21 - PARKED MOTOR VEHICLE	22 - WORK ZONE MAINTENANCE EQUIPMENT 23 - STRUCK BY FALLING, SHIFTING CARGO OR ANYTHING SET IN MOTION BY A MOTOR VEHICLE 24 - OTHER MOVABLE OBJECT
---------------------------	-------	--	--	----------------------	---	---	--

<b>COLLISION WITH FIXED OBJECT</b>	25 - IMPACT ATTENUATOR / CRASH CUSHION 26 - BRIDGE OVERHEAD STRUCTURE 27 - BRIDGE PIER OR ABUTMENT 28 - BRIDGE PARAPET 29 - BRIDGE RAIL 30 - GUARDRAIL FACE	31 - GUARDRAIL END 32 - PORTABLE BARRIER 33 - MEDIAN CABLE BARRIER 34 - MEDIAN GUARDRAIL BARRIER 35 - MEDIAN CONCRETE BARRIER 36 - MEDIAN OTHER BARRIER	37 - TRAFFIC SIGN POST 38 - OVERHEAD SIGN POST 39 - LIGHT / LUMINARIES SUPPORT 40 - UTILITY POLE 41 - OTHER POST, POLE OR SUPPORT 42 - CULVERT	43 - CURB 44 - DITCH 45 - EMBANKMENT 46 - FENCE 47 - MAILBOX 48 - TREE 49 - FIRE HYDRANT	50 - WORK ZONE MAINTENANCE EQUIPMENT 51 - WALL 52 - BUILDING 53 - TUNNEL 54 - OTHER FIXED OBJECT 99 - OTHER / UNKNOWN
<b>FIRST HARMFUL EVENT</b>	1	<b>MOST HARMFUL EVENT</b>	1		

**LOCAL REPORT NUMBER**  
2 3 0 0 3 9 1 9

**DAMAGE**

**DAMAGE SCALE**

1 - NONE  
2 - MINOR DAMAGE  
3 - FUNCTIONAL DAMAGE  
4 - DISABLING DAMAGE  
9 - UNKNOWN

3

**DAMAGED AREA(S)**  
INDICATE ALL THAT APPLY

- NO DAMAGE [ 0 ]

- UNDERCARRIAGE [ 14 ]

- TOP [ 13 ]

- ALL AREAS [ 15 ]

- UNIT NOT AT SCENE [ 16 ]

**INITIAL POINT OF CONTACT**

0 - NO DAMAGE  
1-12 - REFER TO UNIT DIAGRAM  
13 - TOP  
14 - UNDERCARRIAGE  
15 - VEHICLE NOT AT SCENE  
99 - UNKNOWN

1 2

**TRAFFIC**

<b>TRAFFICWAY FLOW</b>	<b>TRAFFIC CONTROL</b>
1 - ONE-WAY 2 - TWO-WAY	1 - ROUNDABOUT 2 - SIGNAL 3 - FLASHER 4 - STOP SIGN 5 - YIELD SIGN 6 - NO CONTROL

<b># OF THROUGH LANES ON ROAD</b>	<b>RAIL GRADE CROSSING</b>
4	1 - NOT INVOLVED 2 - INVOLVED-ACTIVE CROSSING 3 - INVOLVED-PASSIVE CROSSING

**UNIT / NON-MOTORIST DIRECTION**

1 - NORTH  
2 - SOUTH  
3 - EAST  
4 - WEST  
5 - NORTHEAST  
6 - NORTHWEST  
7 - SOUTHEAST  
8 - SOUTHWEST  
9 - OTHER / UNKNOWN

FROM 1 TO 2

<b>UNIT SPEED</b>	<b>DETECTED SPEED</b>
20	1 - STATED / ESTIMATED SPEED 2 - CALCULATED / EDR 3 - UNDETERMINED
<b>POSTED SPEED</b>	
35	

**OWNER #** 012 **OWNER NAME: LAST, FIRST, MIDDLE** (SAME AS DRIVER) **OWNER PHONE: INCLUDE AREA CODE** (SAME AS DRIVER)

**OWNER ADDRESS: STREET, CITY, STATE, ZIP** (SAME AS DRIVER)

**COMMERCIAL CARRIER: NAME, ADDRESS, CITY, STATE, ZIP** **COMMERCIAL CARRIER PHONE: INCLUDE AREA CODE**

**DAMAGE**

**DAMAGE SCALE**

3 1 - NONE 3 - FUNCTIONAL DAMAGE  
 2 - MINOR DAMAGE 4 - DISABLING DAMAGE  
 9 - UNKNOWN

**LP STATE** OH **LICENSE PLATE #** HSZ-3906 **VEHICLE IDENTIFICATION #** JA14J14TJA181N1Z1031481716 **VEHICLE YEAR** 2101212 **VEHICLE MAKE** MITSUBISHI

**INSURANCE VERIFIED** **INSURANCE COMPANY** PROGRESSIVE **INSURANCE POLICY #** 45565872 **COLOR** BLACK **VEHICLE MODEL** OUTLANDE

**DAMAGED AREA(S) INDICATE ALL THAT APPLY**

**TYPE OF USE**  COMMERCIAL  GOVERNMENT  IN EMERGENCY RESPONSE

**INTERLOCK DEVICE EQUIPPED**  **HIT/SKIP UNIT** **#OCCUPANTS** 01 **VEHICLE WEIGHT GVWR/GCWR** 1 - <10K LBS. 2 - 10,001 - 26K LBS. 3 - >26K LBS.

**US DOT #** **TOWED BY: COMPANY NAME** **HAZARDOUS MATERIAL**  MATERIAL RELEASED  PLACARD **CLASS #** **PLACARD ID #**

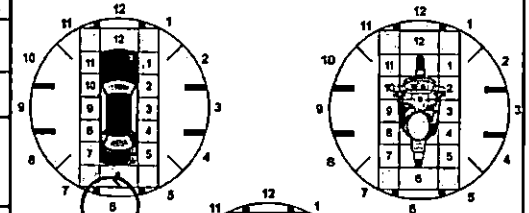

**UNIT TYPE** 03

1 - PASSENGER CAR 7 - MOTORCYCLE 2-WHEELED 12 - GOLF CART 18 - LIMO (LIVERY VEHICLE) 23 - PEDESTRIAN / SKATER  
 2 - PASSENGER VAN (MINIVAN) 8 - MOTORCYCLE 3-WHEELED 13 - SNOWMOBILE 19 - BUS (16+ PASSENGERS) 24 - WHEELCHAIR (ANY TYPE)  
 3 - SPORT UTILITY VEHICLE 9 - AUTOCYCLE 14 - SINGLE UNIT TRUCK 20 - OTHER VEHICLE 25 - OTHER NON-MOTORIST  
 4 - PICKUP 10 - MOPED OR MOTORIZED BICYCLE 15 - SEMI-TRACTOR 21 - HEAVY EQUIPMENT 26 - BICYCLE  
 5 - CARGO VAN 11 - ALL TERRAIN VEHICLE (ATV/UTV) 16 - FARM EQUIPMENT 22 - ANIMAL WITH RIDER OR ANIMAL-DRAWN VEHICLE 27 - TRAIN  
 6 - VAN (9-15 SEATS) 17 - MOTORHOME 99 - UNKNOWN OR HIT/SKIP

**# of TRAILING UNITS**

**WAS VEHICLE OPERATING IN AUTONOMOUS MODE WHEN CRASH OCCURRED?** 02

1 - YES 2 - NO 9 - OTHER / UNKNOWN **AUTONOMOUS MODE LEVEL**

0 - NO AUTOMATION 3 - CONDITIONAL AUTOMATION 9 - UNKNOWN  
 1 - DRIVER ASSISTANCE 4 - HIGH AUTOMATION  
 2 - PARTIAL AUTOMATION 5 - FULL AUTOMATION

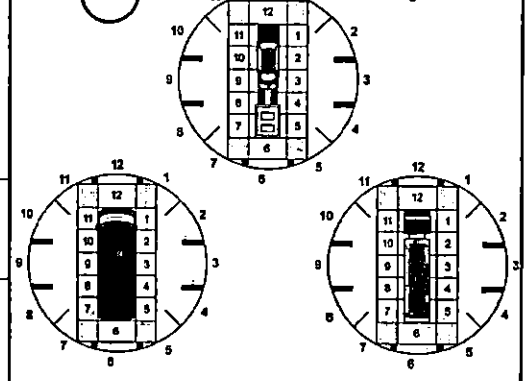

**SPECIAL FUNCTION** 01

1 - NONE 6 - BUS - CHARTER/TOUR 11 - FIRE 16 - FARM 21 - MAIL CARRIER  
 2 - TAXI 7 - BUS - INTERCITY 12 - MILITARY 17 - MOWING 99 - OTHER / UNKNOWN  
 3 - ELECTRONIC RIDE SHARING 8 - BUS - SHUTTLE 13 - POLICE 18 - SNOW REMOVAL  
 4 - SCHOOL TRANSPORT 9 - BUS - OTHER 14 - PUBLIC UTILITY 19 - TOWING  
 5 - BUS - TRANSIT/COMMUTER 10 - AMBULANCE 15 - CONSTRUCTION EQUIPMENT 20 - SAFETY SERVICE PATROL

**CARGO BODY TYPE** 01

1 - NO CARGO BODY TYPE / NOT APPLICABLE 3 - VEHICLE TOWING ANOTHER MOTOR VEHICLE 5 - INTERMODAL CONTAINER CHASSIS 8 - POLE 12 - CONCRETE MIXER  
 2 - BUS 4 - LOGGING 6 - CARGO VAN/ENCLOSED BOX 9 - CARGO TANK 13 - AUTO TRANSPORTER  
 7 - GRAIN/CHIPS/GRAVEL 10 - FLAT BED 11 - DUMP 14 - GARBAGE/REFUSE 99 - OTHER / UNKNOWN

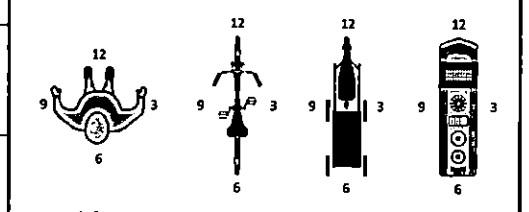

**VEHICLE DEFECTS**

1 - TURN SIGNALS 4 - BRAKES 7 - WORN OR SLICK TIRES 9 - MOTOR TROUBLE 99 - OTHER / UNKNOWN  
 2 - HEAD LAMPS 5 - STEERING 8 - TRAILER EQUIPMENT DEFECTIVE 10 - DISABLED FROM PRIOR ACCIDENT  
 3 - TAIL LAMPS 6 - TIRE BLOWOUT

- NO DAMAGE [ 0 ]  - UNDERCARRIAGE [ 14 ]  
 - TOP [ 13 ]  - ALL AREAS [ 15 ]  
 - UNIT NOT AT SCENE [ 16 ]

**NON-MOTORIST LOCATION AT IMPACT**

1 - INTERSECTION - MARKED CROSSWALK 3 - INTERSECTION - OTHER 6 - BICYCLE LANE 9 - MEDIAN/CROSSING ISLAND 12 - FIRST RESPONDER AT INCIDENT SCENE  
 2 - INTERSECTION - UNMARKED CROSSWALK 4 - MIDBLOCK - MARKED CROSSWALK 7 - SHOULDER / ROADSIDE 10 - DRIVEWAY ACCESS 15 - WALKING, RUNNING, JOGGING, PLAYING  
 5 - TRAVEL LANE - OTHER LOCATION 8 - SIDEWALK 11 - SHARED USE PATHS OR TRAILS 99 - OTHER / UNKNOWN

**ACTION** 04

1 - NON-CONTACT 1 - STRAIGHT AHEAD 7 - MAKING U-TURN 13 - NEGOTIATING A CURVE 18 - APPROACHING OR LEAVING VEHICLE  
 2 - NON-COLLISION 2 - BACKING 8 - ENTERING TRAFFIC LANE 14 - ENTERING OR CROSSING SPECIFIED LOCATION 19 - STANDING  
 3 - STRIKING 111 3 - CHANGING LANES 9 - LEAVING TRAFFIC LANE 15 - WALKING, RUNNING, JOGGING, PLAYING 20 - OTHER NON-MOTORIST  
 4 - STRUCK PRE-CRASH ACTIONS 4 - OVERTAKING/PASSING 10 - PARKED 16 - WORKING 21 - STANDING OUTSIDE DISABLED VEHICLE  
 5 - BOTH STRIKING & STRUCK 5 - MAKING RIGHT TURN 11 - SLOWING OR STOPPED IN TRAFFIC 17 - PUSHING VEHICLE 99 - OTHER / UNKNOWN  
 9 - OTHER / UNKNOWN 6 - MAKING LEFT TURN 12 - DRIVERLESS

**INITIAL POINT OF CONTACT**

0 - NO DAMAGE 14 - UNDERCARRIAGE  
 1-12 - REFER TO UNIT DIAGRAM 15 - VEHICLE NOT AT SCENE  
 13 - TOP 99 - UNKNOWN

**CONTRIBUTING CIRCUMSTANCES** 01

1 - NONE 7 - LEFT OF CENTER 13 - IMPROPER START FROM A PARKED POSITION 17 - VISION OBSTRUCTION 21 - LYING IN ROADWAY  
 2 - FAILURE TO YIELD 8 - FOLLOWING TOO CLOSE / ACDA 14 - STOPPED OR PARKED ILLEGALLY 18 - OPERATING DEFECTIVE EQUIPMENT 22 - NOT DISCERNIBLE  
 3 - RAN RED LIGHT 9 - IMPROPER LANE CHANGE 15 - SWERVING TO AVOID 19 - LOAD SHIFTING/FALLING/ SPILLING 23 - OPENING DOOR INTO ROADWAY  
 4 - RAN STOP SIGN 10 - IMPROPER PASSING 16 - WRONG WAY 20 - IMPROPER CROSSING 99 - OTHER IMPROPER ACTION  
 5 - UNSAFE SPEED 11 - DROVE OFF ROAD 12 - IMPROPER BACKING

**TRAFFICWAY FLOW** 2

1 - ONE-WAY 2 - TWO-WAY

**TRAFFIC CONTROL** 6

1 - ROUNDABOUT 4 - STOP SIGN  
 2 - SIGNAL 5 - YIELD SIGN  
 3 - FLASHER 6 - NO CONTROL

**SEQUENCE OF EVENTS**

1 2 0

1 - OVERTURN/ROLLOVER 6 - EQUIPMENT FAILURE 11 - CROSS CENTERLINE - OPPOSITE DIRECTION OF TRAVEL 16 - RAILWAY VEHICLE 22 - WORK ZONE MAINTENANCE EQUIPMENT  
 2 - FIRE/EXPLOSION 7 - SEPARATION OF UNITS 12 - DOWNHILL RUNAWAY 17 - ANIMAL - FARM 23 - STRUCK BY FALLING, SHIFTING CARGO OR ANYTHING SET IN MOTION BY A MOTOR VEHICLE  
 3 - IMMERSION 8 - RAN OFF ROAD RIGHT 13 - OTHER NON-COLLISION 18 - ANIMAL - DEER 24 - OTHER MOVABLE OBJECT  
 4 - JACKKNIFE 9 - RAN OFF ROAD LEFT 14 - PEDESTRIAN 19 - ANIMAL - OTHER  
 5 - CARGO/EQUIPMENT LOSS OR SHIFT 10 - CROSS MEDIAN 15 - PEDALCYCLE 21 - PARKED MOTOR VEHICLE

**# OF THROUGH LANES ON ROAD** 4

**RAIL GRADE CROSSING** 1

1 - NOT INVOLVED  
 2 - INVOLVED-ACTIVE CROSSING  
 3 - INVOLVED-PASSIVE CROSSING

**COLLISION WITH FIXED OBJECT, STRUCK**

25 - IMPACT ATTENUATOR / CRASH CUSHION 31 - GUARDRAIL END 37 - TRAFFIC SIGN POST 43 - CURB 50 - WORK ZONE MAINTENANCE EQUIPMENT  
 26 - BRIDGE OVERHEAD STRUCTURE 32 - PORTABLE BARRIER 38 - OVERHEAD SIGN POST 44 - DITCH 51 - WALL  
 27 - BRIDGE PIER OR ABUTMENT 33 - MEDIAN CABLE BARRIER 39 - LIGHT / LUMINARIES SUPPORT 45 - EMBANKMENT 52 - BUILDING  
 28 - BRIDGE PARAPET 34 - MEDIAN GUARDRAIL BARRIER 40 - UTILITY POLE 46 - FENCE 53 - TUNNEL  
 29 - BRIDGE RAIL 35 - MEDIAN CONCRETE BARRIER 41 - OTHER POST, POLE OR SUPPORT 47 - MAILBOX 54 - OTHER FIXED OBJECT  
 30 - GUARDRAIL FACE 36 - MEDIAN OTHER BARRIER 42 - CULVERT 48 - TREE 99 - OTHER / UNKNOWN  
 49 - FIRE HYDRANT

**UNIT / NON-MOTORIST DIRECTION**

FROM 1 TO 2

1 - NORTH 5 - NORTHEAST  
 2 - SOUTH 6 - NORTHWEST  
 3 - EAST 7 - SOUTHEAST  
 4 - WEST 8 - SOUTHWEST  
 9 - OTHER / UNKNOWN

**FIRST HARMFUL EVENT** 1 **MOST HARMFUL EVENT** 1

**UNIT SPEED** 0

**DETECTED SPEED** 1

1 - STATED / ESTIMATED SPEED  
 2 - CALCULATED / EDR  
 3 - UNDETERMINED

**POSTED SPEED** 3 5



# MOTORIST / Non-MOTORIST

LOCAL REPORT NUMBER  
2 3 0 0 3 9 1 9

UNIT # 0 1	NAME: LAST, FIRST, MIDDLE BENEDICT, PACY AMERICUS	DATE OF BIRTH 0 7 0 2 2 0 0 2	AGE 2 0	GENDER F
ADDRESS: STREET, CITY, STATE, ZIP 1325 DALTON CT. FAIRFIELD, OH 45014-3307		CONTACT PHONE - INCLUDE AREA CODE		

INJURIES TAKEN BY 5	INJURED TAKEN BY	EMS AGENCY (NAME)	INJURED TAKEN TO: MEDICAL FACILITY (NAME, CITY)	SAFETY EQUIPMENT USED 0 4	<input type="checkbox"/> DOT-COMPLIANT MC HELMET	SEATING POSITION 0 1	AIR BAG USAGE 1	EJECTION 1	TRAPPED 1
OL STATE OH	OPERATOR LICENSE NUMBER	OFFENSE CHARGED 333.03 (A)	LOCAL CODE <input checked="" type="checkbox"/>	OFFENSE DESCRIPTION ACDA	CITATION NUMBER 253036				
OL CLASS 4	ENDORSEMENT SELECT UP TO 2	RESTRICTION SELECT UP TO 3	DRIVER DISTRACTED BY 1	ALCOHOL / DRUG SUSPECTED <input type="checkbox"/> ALCOHOL <input type="checkbox"/> MARIJUANA <input type="checkbox"/> OTHER DRUG	CONDITION 1	ALCOHOL TEST STATUS TYPE VALUE		DRUG TEST(S) STATUS TYPE RESULT SELECT UP TO 4	

UNIT # 0 2	NAME: LAST, FIRST, MIDDLE TRUE, JENNIFER MARIE	DATE OF BIRTH 0 6 1 6 1 9 7 0	AGE 5 2	GENDER F
ADDRESS: STREET, CITY, STATE, ZIP 5651 JEFFREY PL. FAIRFIELD, OH 45014-3522		CONTACT PHONE - INCLUDE AREA CODE		

INJURIES TAKEN BY 5	INJURED TAKEN BY	EMS AGENCY (NAME)	INJURED TAKEN TO: MEDICAL FACILITY (NAME, CITY)	SAFETY EQUIPMENT USED 0 4	<input type="checkbox"/> DOT-COMPLIANT MC HELMET	SEATING POSITION 0 1	AIR BAG USAGE 1	EJECTION 1	TRAPPED 1
OL STATE OH	OPERATOR LICENSE NUMBER	OFFENSE CHARGED	LOCAL CODE <input type="checkbox"/>	OFFENSE DESCRIPTION	CITATION NUMBER				
OL CLASS 4	ENDORSEMENT SELECT UP TO 2	RESTRICTION SELECT UP TO 3	DRIVER DISTRACTED BY 1	ALCOHOL / DRUG SUSPECTED <input type="checkbox"/> ALCOHOL <input type="checkbox"/> MARIJUANA <input type="checkbox"/> OTHER DRUG	CONDITION 1	ALCOHOL TEST STATUS TYPE VALUE		DRUG TEST(S) STATUS TYPE RESULT SELECT UP TO 4	

UNIT #	NAME: LAST, FIRST, MIDDLE	DATE OF BIRTH	AGE	GENDER
ADDRESS: STREET, CITY, STATE, ZIP		CONTACT PHONE - INCLUDE AREA CODE		

INJURIES TAKEN BY	INJURED TAKEN BY	EMS AGENCY (NAME)	INJURED TAKEN TO: MEDICAL FACILITY (NAME, CITY)	SAFETY EQUIPMENT USED	<input type="checkbox"/> DOT-COMPLIANT MC HELMET	SEATING POSITION	AIR BAG USAGE	EJECTION	TRAPPED
OL STATE	OPERATOR LICENSE NUMBER	OFFENSE CHARGED	LOCAL CODE <input type="checkbox"/>	OFFENSE DESCRIPTION	CITATION NUMBER				
OL CLASS	ENDORSEMENT SELECT UP TO 2	RESTRICTION SELECT UP TO 3	DRIVER DISTRACTED BY	ALCOHOL / DRUG SUSPECTED <input type="checkbox"/> ALCOHOL <input type="checkbox"/> MARIJUANA <input type="checkbox"/> OTHER DRUG	CONDITION	ALCOHOL TEST STATUS TYPE VALUE		DRUG TEST(S) STATUS TYPE RESULT SELECT UP TO 4	

INJURIES	SEATING POSITION	AIR BAG	OL CLASS	OL RESTRICTION(S)	DRIVER DISTRACTION	TEST STATUS
1-FATAL	1-FRONT-LEFT SIDE (MOTORCYCLE DRIVER)	1-NOT DEPLOYED	1-CLASS A	1-ALCOHOL INTERLOCK DEVICE	1-NOT DISTRACTED	1-NONE GIVEN
2-SUSPECTED SERIOUS INJURY	2-FRONT-MIDDLE	2-DEPLOYED FRONT	2-CLASS B	2-CDL INTRASTATE ONLY	2-MANUALLY OPERATING AN ELECTRONIC COMMUNICATION DEVICE (TEXTING, TYPING, DIALING)	2-TEST REFUSED
3-SUSPECTED MINOR INJURY	3-FRONT-RIGHT SIDE	3-DEPLOYED SIDE	3-CLASS C	3-CORRECTIVE LENSES	3-TALKING ON HANDS-FREE COMMUNICATION DEVICE	3-TEST GIVEN, CONTAMINATED SAMPLE / UNUSABLE
4-POSSIBLE INJURY	4-SECOND-LEFT SIDE (MOTORCYCLE PASSENGER)	4-DEPLOYED BOTH FRONT / SIDE	4-REGULAR CLASS (OHIO = D)	4-FARM WAIVER	4-TALKING ON HAND-HELD COMMUNICATION DEVICE	4-TEST GIVEN, RESULTS KNOWN
5-NO APPARENT INJURY	5-SECOND-MIDDLE	5-NOT APPLICABLE	5-N/C MOPED ONLY	5-EXCEPT CLASS A BUS	5-OTHER ACTIVITY WITH AN ELECTRONIC DEVICE	5-TEST GIVEN, RESULTS UNKNOWN
INJURED TAKEN BY	6-SECOND-RIGHT SIDE	9-DEPLOYMENT UNKNOWN	6-NO VALID OL	6-EXCEPT CLASS A & CLASS B BUS	6-PASSENGER	ALCOHOL TEST TYPE
1-NOT TRANSPORTED / TREATED AT SCENE	7-THIRD-LEFT SIDE (MOTORCYCLE SIDE CAR)	<b>EJECTION</b>		7-EXCEPT TRACTOR-TRAILER	7-OTHER DISTRACTION INSIDE THE VEHICLE	1-NONE
2-EMS	8-THIRD-MIDDLE	1-NOT EJECTED	H-HAZMAT	8-INTERMEDIATE LICENSE RESTRICTIONS	8-OTHER DISTRACTION OUTSIDE THE VEHICLE	2-BLOOD
3-POLICE	9-THIRD-RIGHT SIDE	2-PARTIALLY EJECTED	M-MOTORCYCLE	9-LEARNER'S PERMIT RESTRICTIONS	9-OTHER / UNKNOWN	3-URINE
9-OTHER / UNKNOWN	10-SLEEPER SECTION OF TRUCK CAB	3-TOTALLY EJECTED	P-PASSENGER	10-LIMITED TO DAYLIGHT ONLY	<b>DRUG TEST TYPE</b>	
SAFETY EQUIPMENT	11-PASSENGER IN OTHER ENCLOSED CARGO AREA (NON-TRAILING UNIT, BUS, PICK-UP WITH CAP)	4-NOT APPLICABLE	N-TANKER	11-LIMITED TO EMPLOYMENT	1-NONE	2-BLOOD
1-NONE USED	12-PASSENGER IN UNENCLOSED CARGO AREA	<b>TRAPPED</b>		12-LIMITED-OTHER	2-PHYSICAL IMPAIRMENT	3-URINE
2-SHOULDER BELT ONLY USED	13-TRAILING UNIT	1-NOT TRAPPED	Q-MOTOR SCOOTER	13-MECHANICAL DEVICES (SPECIAL BRAKES, HAND CONTROLS, OR OTHER ADAPTIVE DEVICES)	3-EMOTIONAL (E.G., DEPRESSED, ANGRY, DISTURBED)	4-OTHER
3-LAP BELT ONLY USED	14-RIDING ON VEHICLE EXTERIOR (NON-TRAILING UNIT)	2-EXTRICATED BY MECHANICAL MEANS	R-THREE-WHEEL MOTORCYCLE	14-MILITARY VEHICLES ONLY	4-ILLNESS	1-AMPHETAMINES
4-SHOULDER & LAP BELT USED	15-NON-MOTORIST	3-FREED BY NON-MECHANICAL MEANS	S-SCHOOL BUS	15-MOTOR VEHICLES WITHOUT AIR BRAKES	5-PELL ASLEEP, FAINTED, FATIGUED, ETC.	2-BARBITURATES
5-CHILD RESTRAINT SYSTEM - FORWARD FACING	99-OTHER / UNKNOWN		T-DOUBLE & TRIPLE TRAILERS	16-OUTSIDE MIRROR	6-UNDER THE INFLUENCE OF MEDICATIONS / DRUGS / ALCOHOL	3-BENZODIAZEPINES
6-CHILD RESTRAINT SYSTEM - REAR FACING			X-TANKER / HAZMAT	17-PROSTHETIC AID	9-OTHER / UNKNOWN	4-CANNABINOIDS
7-BOOSTER SEAT				18-OTHER		5-COCAINE
8-HELMET USED			<b>GENDER</b>			6-OPIATES / OPIOIDS
9-PROTECTIVE PADS USED (ELBOW, KNEES, ETC.)			F-FEMALE			7-OTHER
10-REFLECTIVE CLOTHING			M-MALE			8-NEGATIVE RESULTS
11-LIGHTING - PEDESTRIAN / BICYCLE ONLY			U-OTHER / UNKNOWN			
99-OTHER / UNKNOWN						

LOCAL REPORT NUMBER 23-003919	REPORTING AGENCY Fairfield Police Department	DATE OF ACCIDENT 01-16-23
IN COUNTY OF Butler	ACCIDENT LOCATION 5300 Dixie Hwy.	

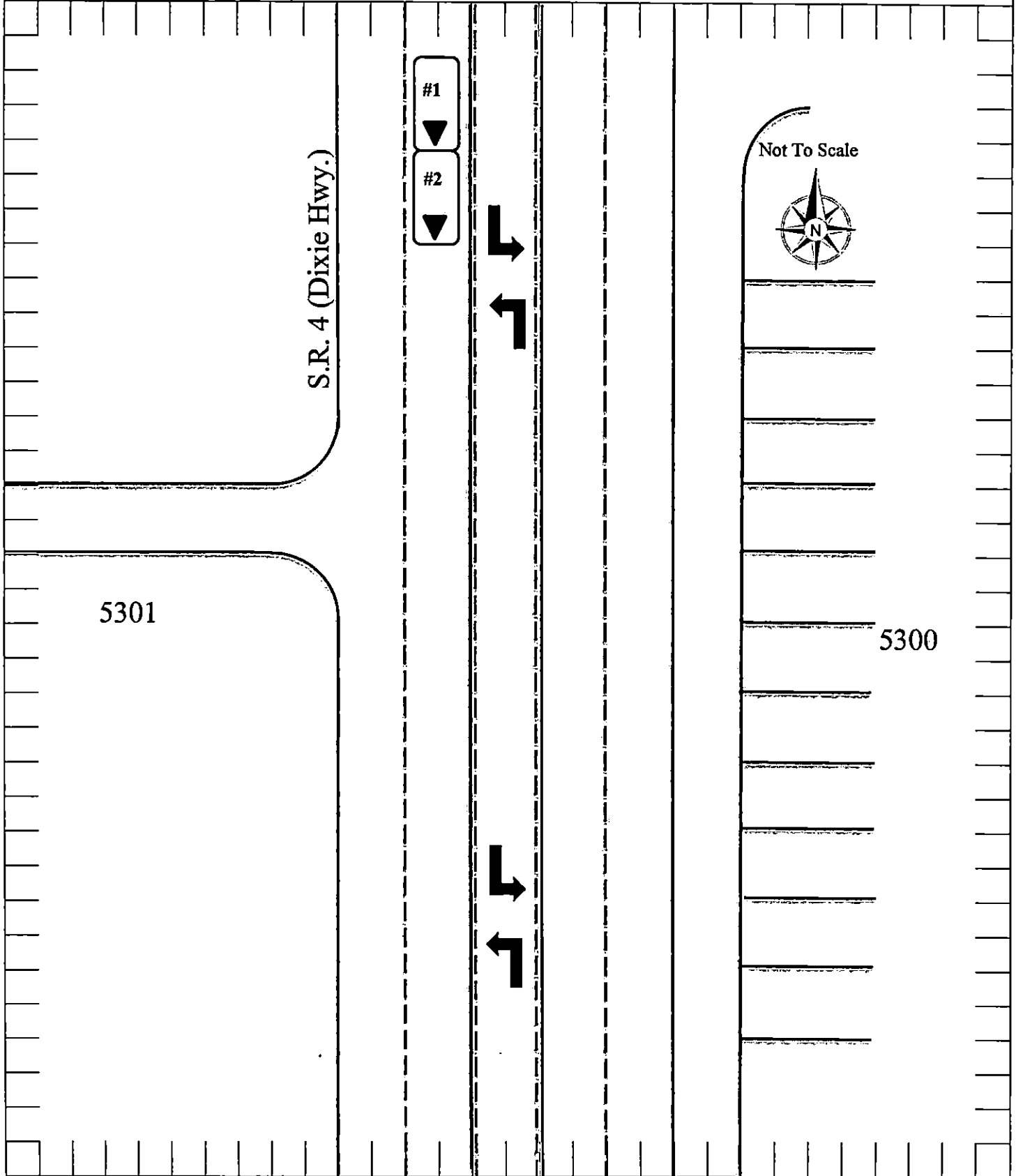

OFFICER'S SIGNATURE P.O. RYAN FLEENOR	BADGE NO. 117
--	------------------