



TRAFFIC CRASH REPORT

*DENOTES MANDATORY FIELD FOR SUPPLEMENT REPORT

LOCAL REPORT NUMBER*

<input checked="" type="checkbox"/> PHOTOS TAKEN	<input checked="" type="checkbox"/> OH-2	<input type="checkbox"/> OH-3	LOCAL INFORMATION		2 3 0 0 4 0 9 0			
<input type="checkbox"/> SECONDARY CRASH	<input type="checkbox"/> OH-1P	<input type="checkbox"/> OTHER	REPORTING AGENCY NAME*		NCIC*	HIT/SKIP	NUMBER OF UNITS	UNIT IN ERROR
<input type="checkbox"/> PRIVATE PROPERTY			Fairfield Police Department		0 0 9 0 1	1 - SOLVED	0 1	0 1 98 - ANIMAL
						2 - UNSOLVED		99 - UNKNOWN

COUNTY*	LOCALITY*	LOCATION: CITY, VILLAGE, TOWNSHIP*		CRASH DATE / TIME*	CRASH SEVERITY
0 9	1	City of Fairfield		0 1 1 6 2 0 2 3 2 3 5 9	5

ROUTE TYPE	ROUTE NUMBER	PREFIX	1 - NORTH 2 - SOUTH 3 - EAST 4 - WEST	LOCATION ROAD NAME	ROAD TYPE	LATITUDE DECIMAL DEGREES	CRASH SEVERITY 1 - FATAL 2 - SERIOUS INJURY SUSPECTED 3 - MINOR INJURY SUSPECTED 4 - INJURY POSSIBLE 5 - PROPERTY DAMAGE ONLY
				Gray	R D	3 9 . 3 2 0 8 7	
ROUTE TYPE	ROUTE NUMBER	PREFIX	1 - NORTH 2 - SOUTH 3 - EAST 4 - WEST	REFERENCE ROAD NAME (ROAD, MILEPOST, HOUSE #)	ROAD TYPE	LONGITUDE DECIMAL DEGREES	
				5861		8 4 . 5 9 2 9 5	

REFERENCE POINT	DIRECTION FROM REFERENCE	ROUTE TYPE	ROAD TYPE	INTERSECTION RELATED		
1 - INTERSECTION 2 - MILE POST 3 - HOUSE #	1 - NORTH 2 - SOUTH 3 - EAST 4 - WEST	IR - INTERSTATE ROUTE(TP) US - FEDERAL US ROUTE SR - STATE ROUTE CR - NUMBERED COUNTY ROUTE TR - NUMBERED TOWNSHIP ROUTE	AL - ALLEY AV - AVENUE BL - BOULEVARD CR - CIRCLE CT - COURT DR - DRIVE HE - HEIGHTS	RD - ROAD LA - LANE MP - MILEPOST OV - OVAL PK - PARKWAY PI - PIKE PL - PLACE	<input type="checkbox"/> WITHIN INTERSECTION OR ON APPROACH <input type="checkbox"/> WITHIN INTERCHANGE AREA NUMBER OF APPROACHES	
DISTANCE FROM REFERENCE	DISTANCE UNIT OF MEASURE			<input type="checkbox"/> ROADWAY DIVIDED		
	1 - MILES 2 - FEET 3 - YARDS					

LOCATION OF FIRST HARMFUL EVENT	MANNER OF CRASH COLLISION/IMPACT	DIRECTION OF TRAVEL	MEDIAN TYPE
1 - ON ROADWAY 2 - ON SHOULDER 3 - IN MEDIAN 4 - ON ROADSIDE 5 - ON GORE 6 - OUTSIDE TRAFFIC WAY 7 - ON RAMP 8 - OFF RAMP	1 - NOT COLLISION BETWEEN TWO MOTOR VEHICLES IN TRANSPORT 2 - REAR-END 3 - HEAD-ON 4 - REAR-TO-REAR 5 - BACKING 6 - ANGLE 7 - SIDESWIPE, SAME DIRECTION 8 - SIDESWIPE, OPPOSITE DIRECTION 9 - OTHER / UNKNOWN	1 - NORTH 2 - SOUTH 3 - EAST 4 - WEST	1 - DIVIDED FLUSH MEDIAN (<4 FEET) 2 - DIVIDED FLUSH MEDIAN (>4 FEET) 3 - DIVIDED, DEPRESSED MEDIAN 4 - DIVIDED, RAISED MEDIAN (ANY TYPE) 9 - OTHER/UNKNOWN

<input type="checkbox"/> WORK ZONE RELATED <input type="checkbox"/> WORKERS PRESENT <input type="checkbox"/> LAW ENFORCEMENT PRESENT <input type="checkbox"/> ACTIVE SCHOOL ZONE	WORK ZONE TYPE 1 - LANE CLOSURE 2 - LANE SHIFT/CROSSOVER 3 - WORK ON SHOULDER OR MEDIAN 4 - INTERMITTENT OR MOVING WORK 5 - OTHER	LOCATION OF CRASH IN WORK ZONE 1 - BEFORE THE 1ST WORK ZONE WARNING SIGN 2 - ADVANCE WARNING AREA 3 - TRANSITION AREA 4 - ACTIVITY AREA 5 - TERMINATION AREA	CONTOUR 3	CONDITIONS 1	SURFACE 2
---	--	---	--------------	-----------------	--------------

LIGHT CONDITION 3	WEATHER 4	1 - DAYLIGHT 2 - DAWN/DUSK 3 - DARK - LIGHTED ROADWAY 4 - DARK - ROADWAY NOT LIGHTED 5 - DARK - UNKNOWN ROADWAY LIGHTING 9 - OTHER / UNKNOWN	1 - CLEAR 2 - CLOUDY 3 - FOG, SMOG, SMOKE 4 - RAIN 5 - SLEET, HAIL 6 - SNOW 7 - SEVERE CROSSWINDS 8 - BLOWING SAND, SOIL, DIRT, SNOW 9 - FREEZING RAIN OR FREEZING DRIZZLE 99 - OTHER / UNKNOWN	1 - STRAIGHT LEVEL 2 - STRAIGHT GRADE 3 - CURVE LEVEL 4 - CURVE GRADE 9 - OTHER/UNKNOWN	1 - DRY 2 - WET 3 - SNOW 4 - ICE 5 - SAND, MUD, DIRT, OIL, GRAVEL 6 - WATER (STANDING, MOVING) 7 - SLUSH 9 - OTHER/UNKNOWN	1 - CONCRETE 2 - BLACKTOP, BITUMINOUS, ASPHALT 3 - BRICK/BLOCK 4 - SLAG, GRAVEL, STONE 5 - DIRT 9 - OTHER/UNKNOWN
----------------------	--------------	---	--	---	---	--

NARRATIVE

On 01/16/2023 at 11:59 P.M. unit was traveling northwest on Gray Rd. when it ran off the right side of the road. Unit 1 then lost control as the car started to spin 360 degrees. Unit 1 came to rest in the driveway of 5861 Gray Rd. still facing northwest. Unit 1 then drove backwards through a tree line, striking a guide wire to a utility pole, and driving off the bridge located at that same address. When unit 1 dropped off the bridge, it fell approximately 10 feet, coming to rest in the creek bed. The bridge appeared to not be damaged.

The utility wire belongs Butler Rural Electric Cooperative located at 3888 Stillwell Becket Rd. Oxford, OH. 45056,

Unit 1 was charged with OVI 333.01a1A.

See OH-2

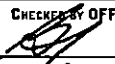

Indicate the north direction with an "N" on the compass diagram.

CRASH REPORTED DATE / TIME	DISPATCH DATE / TIME	ARRIVAL DATE / TIME	SCENE CLEARED DATE / TIME	REPORT TAKEN BY
0 1 1 6 2 0 2 3 2 3 5 9	0 1 1 7 2 0 2 3 0 0 0 1	0 1 1 7 2 0 2 3 0 0 0 7	0 1 1 7 2 0 2 3 0 2 3 5	<input checked="" type="checkbox"/> POLICE AGENCY <input type="checkbox"/> MOTORIST
TOTAL TIME ROADWAY CLOSED	OTHER INVESTIGATION TIME	TOTAL MINUTES	OFFICER'S NAME*	CHECKED BY OFFICER'S NAME*
9 0	0 3 0	1 8 4	PO Greg Bailes	
			OFFICER'S BADGE NUMBER*	CHECKED BY OFFICER'S BADGE NUMBER*
			1 2 2	1 0 3
				<input type="checkbox"/> SUPPLEMENT (CORRECTION OR ADDITION TO AN EXISTING REPORT SENT TO OGD)

LOCAL REPORT NUMBER
2, 3, 0, 0, 4, 0, 9, 0

OWNER
UNIT # 0, 1 OWNER NAME: LAST, FIRST, MIDDLE (SAME AS DRIVER) Baxter, Sterling
OWNER ADDRESS: STREET, CITY, STATE, ZIP (SAME AS DRIVER)
296 Westfield Ave. Hamilton, OH. 45013
COMMERCIAL CARRIER: NAME, ADDRESS, CITY, STATE, ZIP
COMMERCIAL CARRIER PHONE: INCLUDE AREA CODE

LP STATE OH LICENSE PLATE # JWU2077 VEHICLE IDENTIFICATION # 5N1PE1E314A1FX1FH1013181314 VEHICLE YEAR 2011 VEHICLE MAKE Hyundai
INSURANCE VERIFIED INSURANCE COMPANY None INSURANCE POLICY # _____ COLOR Silver VEHICLE MODEL Sonata

TYPE OF USE COMMERCIAL GOVERNMENT IN EMERGENCY RESPONSE
US DOT # _____ TOWED BY: COMPANY NAME Fox Towing
HAZARDOUS MATERIAL CLASS # _____ PLACARD ID # _____
INTERLOCK DEVICE EQUIPPED HIT/SKIP UNIT #OCCUPANTS 0, 2
VEHICLE WEIGHT GVWR/GCWR
1 - <10K LBS.
2 - 10,001 - 26K LBS.
3 - >26K LBS.

UNIT TYPE 0, 1
1 - PASSENGER CAR 7 - MOTORCYCLE 2-WHEELED 12 - GOLF CART 18 - LIMO (LIVERY VEHICLE) 23 - PEDESTRIAN / SKATER
2 - PASSENGER VAN (MINIVAN) 8 - MOTORCYCLE 3-WHEELED 13 - SNOWMOBILE 19 - BUS (16+ PASSENGERS) 24 - WHEELCHAIR (ANY TYPE)
3 - SPORT UTILITY VEHICLE 9 - AUTOCYCLE 14 - SINGLE UNIT TRUCK 20 - OTHER VEHICLE 25 - OTHER NON-MOTORIST
4 - PICK UP 10 - MOPED OR MOTORIZED BICYCLE 15 - SEMI-TRACTOR 21 - HEAVY EQUIPMENT 26 - BICYCLE
5 - CARGO VAN 11 - ALL TERRAIN VEHICLE (ATV/UTV) 16 - FARM EQUIPMENT 22 - ANIMAL WITH RIDER OR ANIMAL-DRAWN VEHICLE 27 - TRAIN
6 - VAN (9-15 SEATS) 17 - MOTORHOME

WAS VEHICLE OPERATING IN AUTONOMOUS MODE WHEN CRASH OCCURRED?
2 1-YES 2-NO 9-OTHER/UNKNOWN AUTONOMOUS MODE LEVEL 0
0 - NO AUTOMATION 3 - CONDITIONAL AUTOMATION 9 - UNKNOWN
1 - DRIVER ASSISTANCE 4 - HIGH AUTOMATION
2 - PARTIAL AUTOMATION 5 - FULL AUTOMATION

SPECIAL FUNCTION 0, 1
1 - NONE 6 - BUS - CHARTER/TOUR 11 - FIRE 16 - FARM 21 - MAIL CARRIER
2 - TAXI 7 - BUS - INTERCITY 12 - MILITARY 17 - MOWING 99 - OTHER / UNKNOWN
3 - ELECTRONIC RIDE SHARING 8 - BUS - SHUTTLE 13 - POLICE 18 - SNOW REMOVAL
4 - SCHOOL TRANSPORT 9 - BUS - OTHER 14 - PUBLIC UTILITY 19 - TOWING
5 - BUS - TRANSIT/COMMUTER 10 - AMBULANCE 15 - CONSTRUCTION EQUIPMENT 20 - SAFETY SERVICE PATROL

CARGO BODY TYPE 0, 1
1 - NO CARGO BODY TYPE / NOT APPLICABLE 3 - VEHICLE TOWING ANOTHER MOTORVEHICLE 5 - INTERMODAL CONTAINER CHASSIS 8 - POLE 12 - CONCRETE MIXER
2 - BUS 4 - LOGGING 6 - CARGO VAN/ENCLOSED BOX 9 - CARGO TANK 13 - AUTO TRANSPORTER
7 - GRAIN/CHIPS&GRAVEL 10 - FLAT BED 14 - GARBAGE/REFUSE 99 - OTHER / UNKNOWN

VEHICLE DEFECTS
1 - TURN SIGNALS 4 - BRAKES 7 - WORN OR SLICK TIRES 9 - MOTOR TROUBLE 99 - OTHER / UNKNOWN
2 - HEAD LAMPS 5 - STEERING 8 - TRAILER EQUIPMENT DEFECTIVE 10 - DISABLED FROM PRIOR ACCIDENT
3 - TAIL LAMPS 6 - TIRE BLOWOUT

NON-MOTORIST LOCATION AT IMPACT
1 - INTERSECTION - MARKED CROSSWALK 3 - INTERSECTION - OTHER 6 - BICYCLE LANE 9 - MEDIAN/CROSSING ISLAND 12 - FIRST RESPONDER AT INCIDENT SCENE
2 - INTERSECTION - UNMARKED CROSSWALK 4 - MIDDLEBLOCK - MARKED CROSSWALK 7 - SHOULDER / ROADSIDE 10 - DRIVEWAY ACCESS 99 - OTHER / UNKNOWN
5 - TRAVEL LANE - OTHER LOCATION 8 - SIDEWALK 11 - SHARED USE PATHS OR TRAILS

ACTION 3
1 - NON-CONTACT 1 - STRAIGHT AHEAD 7 - MAKING U-TURN 13 - NEGOTIATING A CURVE 18 - APPROACHING OR LEAVING VEHICLE
2 - NON-COLLISION 2 - BACKING 8 - ENTERING TRAFFIC LANE 14 - ENTERING OR CROSSING SPECIFIED LOCATION 19 - STANDING
3 - STRIKING 0, 1 3 - CHANGING LANES 9 - LEAVING TRAFFIC LANE 15 - WALKING, RUNNING, JOGGING, PLAYING 20 - OTHER NON-MOTORIST
4 - STRUCK PRE-CRASH ACTIONS 4 - OVERTAKING/PASSING 10 - PARKED 16 - WORKING 21 - STANDING OUTSIDE DISABLED VEHICLE
5 - BOTH STRIKING & STRUCK 5 - MAKING RIGHT TURN 11 - SLOWING OR STOPPED IN TRAFFIC 17 - PUSHING VEHICLE 99 - OTHER / UNKNOWN
9 - OTHER / UNKNOWN 6 - MAKING LEFT TURN 12 - DRIVERLESS

CONTRIBUTING CIRCUMSTANCES 1, 1
1 - NONE 7 - LEFT OF CENTER 13 - IMPROPER START FROM A PARKED POSITION 17 - VISION OBSTRUCTION 21 - LYING IN ROADWAY
2 - FAILURE TO YIELD 8 - FOLLOWING TOO CLOSE / ACDA 14 - STOPPED OR PARKED ILLEGALLY 18 - OPERATING DEFECTIVE EQUIPMENT 22 - NOT DISCERNIBLE
3 - RAN RED LIGHT 9 - IMPROPER LANE CHANGE 15 - DROVE OFF ROAD 19 - LOAD SHIFTING/FALLING/ SPILLING 23 - OPENING DOOR INTO ROADWAY
4 - RAN STOP SIGN 10 - IMPROPER PASSING 16 - WRONG WAY 20 - IMPROPER CROSSING 99 - OTHER IMPROPER ACTION
5 - UNSAFE SPEED 11 - DROVE OFF ROAD
6 - IMPROPER TURN 12 - IMPROPER BACKING

SEQUENCE OF EVENTS
1 0, 8 1 - OVERTURN/ROLLOVER 6 - EQUIPMENT FAILURE 11 - CROSS CENTERLINE - OPPOSITE DIRECTION OF TRAVEL 16 - RAILWAY VEHICLE 22 - WORK ZONE MAINTENANCE EQUIPMENT
2 4, 8 2 - FIRE/EXPLOSION 7 - SEPARATION OF UNITS 12 - DOWNHILL RUNAWAY 17 - ANIMAL - FARM 23 - STRUCK BY FALLING, SHIFTING CARGO OR ANYTHING SET IN MOTION BY A MOTORVEHICLE
3 4, 1 3 - IMMERSION 8 - RAN OFF ROAD RIGHT 13 - OTHER NON-COLLISION 18 - ANIMAL - DEER 24 - OTHER MOVABLE OBJECT
4 5, 4 4 - JACKKNIFE 9 - RAN OFF ROAD LEFT 14 - PEDESTRIAN 19 - ANIMAL - OTHER 50 - WORK ZONE MAINTENANCE EQUIPMENT
5 4 5 - CARGO / EQUIPMENT LOSS OR SHIFT 10 - CROSS MEDIAN 15 - PEDALCYCLE 20 - MOTORVEHICLE IN TRANSPORT 51 - WALL
6 4 6 - IMPROPER TURN 11 - DROVE OFF ROAD 16 - WRONG WAY 21 - PARKED MOTORVEHICLE 52 - BUILDING
7 4 7 - LEFT OF CENTER 12 - IMPROPER BACKING 17 - VISION OBSTRUCTION 22 - NOT DISCERNIBLE 53 - TUNNEL
8 4 8 - FOLLOWING TOO CLOSE / ACDA 13 - IMPROPER START FROM A PARKED POSITION 18 - OPERATING DEFECTIVE EQUIPMENT 23 - OPENING DOOR INTO ROADWAY 54 - OTHER FIXED OBJECT
9 4 9 - IMPROPER LANE CHANGE 14 - STOPPED OR PARKED ILLEGALLY 19 - LOAD SHIFTING/FALLING/ SPILLING 24 - OTHER IMPROPER ACTION 99 - OTHER / UNKNOWN
10 4 10 - IMPROPER PASSING 15 - DROVE OFF ROAD 20 - IMPROPER CROSSING

FIRST HARMFUL EVENT 2 MOST HARMFUL EVENT 4
25 - IMPACT ATTENUATOR / CRASH CUSHION 31 - GUARDRAIL END 37 - TRAFFIC SIGN POST 43 - CURB 50 - WORK ZONE MAINTENANCE EQUIPMENT
26 - BRIDGE OVERHEAD STRUCTURE 32 - PORTABLE BARRIER 38 - OVERHEAD SIGN POST 44 - DITCH 51 - WALL
27 - BRIDGE PIER OR ABUTMENT 33 - MEDIAN CABLE BARRIER 39 - LIGHT / LUMINARIES SUPPORT 45 - EMBANKMENT 52 - BUILDING
28 - BRIDGE PARAPET 34 - MEDIAN GUARDRAIL BARRIER 40 - UTILITY POLE 46 - FENCE 53 - TUNNEL
29 - BRIDGE RAIL 35 - MEDIAN CONCRETE BARRIER 41 - OTHER POST, POLE OR SUPPORT 47 - MAILBOX 54 - OTHER FIXED OBJECT
30 - GUARDRAIL FACE 36 - MEDIAN OTHER BARRIER 42 - CULVERT 48 - TREE 99 - OTHER / UNKNOWN
49 - FIRE HYDRANT

DAMAGE
DAMAGE SCALE
4 1 - NONE 3 - FUNCTIONAL DAMAGE
2 - MINOR DAMAGE 4 - DISABLING DAMAGE
9 - UNKNOWN

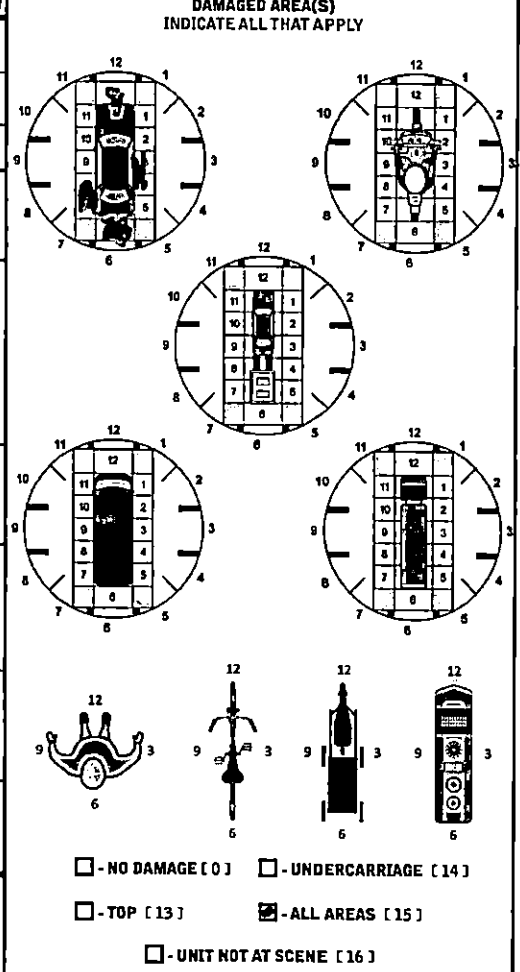

INITIAL POINT OF CONTACT
0, 6 0 - NO DAMAGE 14 - UNDERCARRIAGE
1-12 - REFER TO UNIT DIAGRAM 15 - VEHICLE NOT AT SCENE
13 - TOP 99 - UNKNOWN

TRAFFIC
TRAFFICWAY FLOW 2 1 - ONE-WAY 2 - TWO-WAY
TRAFFIC CONTROL 6 1 - ROUNDABOUT 4 - STOP SIGN
2 - SIGNAL 5 - YIELD SIGN
3 - FLASHER 6 - NO CONTROL

OF THROUGH LANES ON ROAD 2 RAIL GRADE CROSSING 1
1 - NOT INVOLVED
2 - INVOLVED-ACTIVE CROSSING
3 - INVOLVED-PASSIVE CROSSING

UNIT / NON-MOTORIST DIRECTION
FROM 7 TO 6
1 - NORTH 5 - NORTHEAST
2 - SOUTH 6 - NORTHWEST
3 - EAST 7 - SOUTHEAST
4 - WEST 8 - SOUTHWEST
9 - OTHER / UNKNOWN

UNIT SPEED 0, 4, 0 DETECTED SPEED 1
1 - STATED / ESTIMATED SPEED
2 - CALCULATED / EDR
3 - UNDETERMINED
POSTED SPEED 3, 5

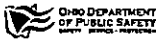

MOTORIST / Non-MOTORIST

LOCAL REPORT NUMBER
2 3 0 0 4 0 9 0

UNIT # 0 1	NAME: LAST, FIRST, MIDDLE Baxter, Sterling		DATE OF BIRTH 0 9 2 1 2 0 0 0		AGE 2 2	GENDER M			
ADDRESS: STREET, CITY, STATE, ZIP 296 Westfield Ave. Hamilton, OH. 45013				CONTACT PHONE - INCLUDE AREA CODE					
INJURIES 5	INJURED TAKEN BY	EMS AGENCY (NAME)	INJURED TAKEN TO: MEDICAL FACILITY (NAME, CITY)	SAFETY EQUIPMENT USED 0 4	<input type="checkbox"/> DOT-COMPLIANT MC HELMET	SEATING POSITION 0 1	AIR BAG USAGE 4	EJECTION 1	TRAPPED 1
OL STATE OH	OPERATOR LICENSE NUMBER		OFFENSE CHARGED 331.34A	LOCAL CODE <input checked="" type="checkbox"/>	OFFENSE DESCRIPTION Failure to Control		CITATION NUMBER 253501		
OL CLASS 4	ENDORSEMENT SELECT UP TO 2	RESTRICTION SELECT UP TO 3	DRIVER DISTRACTED BY 1	ALCOHOL / DRUG SUSPECTED <input checked="" type="checkbox"/> ALCOHOL <input type="checkbox"/> MARIJUANA <input checked="" type="checkbox"/> OTHER DRUG		CONDITION 6	ALCOHOL TEST STATUS 5 TYPE 3 VALUE		DRUG TEST(S) STATUS 5 TYPE 3 RESULT SELECT UP TO 4

UNIT #	NAME: LAST, FIRST, MIDDLE		DATE OF BIRTH		AGE	GENDER			
ADDRESS: STREET, CITY, STATE, ZIP				CONTACT PHONE - INCLUDE AREA CODE					
INJURIES	INJURED TAKEN BY	EMS AGENCY (NAME)	INJURED TAKEN TO: MEDICAL FACILITY (NAME, CITY)	SAFETY EQUIPMENT USED	<input type="checkbox"/> DOT-COMPLIANT MC HELMET	SEATING POSITION	AIR BAG USAGE	EJECTION	TRAPPED
OL STATE	OPERATOR LICENSE NUMBER		OFFENSE CHARGED	LOCAL CODE	OFFENSE DESCRIPTION		CITATION NUMBER		
OL CLASS	ENDORSEMENT SELECT UP TO 2	RESTRICTION SELECT UP TO 3	DRIVER DISTRACTED BY	ALCOHOL / DRUG SUSPECTED <input type="checkbox"/> ALCOHOL <input type="checkbox"/> MARIJUANA <input type="checkbox"/> OTHER DRUG		CONDITION	ALCOHOL TEST STATUS TYPE VALUE		DRUG TEST(S) STATUS TYPE RESULT SELECT UP TO 4

UNIT #	NAME: LAST, FIRST, MIDDLE		DATE OF BIRTH		AGE	GENDER			
ADDRESS: STREET, CITY, STATE, ZIP				CONTACT PHONE - INCLUDE AREA CODE					
INJURIES	INJURED TAKEN BY	EMS AGENCY (NAME)	INJURED TAKEN TO: MEDICAL FACILITY (NAME, CITY)	SAFETY EQUIPMENT USED	<input type="checkbox"/> DOT-COMPLIANT MC HELMET	SEATING POSITION	AIR BAG USAGE	EJECTION	TRAPPED
OL STATE	OPERATOR LICENSE NUMBER		OFFENSE CHARGED	LOCAL CODE	OFFENSE DESCRIPTION		CITATION NUMBER		
OL CLASS	ENDORSEMENT SELECT UP TO 2	RESTRICTION SELECT UP TO 3	DRIVER DISTRACTED BY	ALCOHOL / DRUG SUSPECTED <input type="checkbox"/> ALCOHOL <input type="checkbox"/> MARIJUANA <input type="checkbox"/> OTHER DRUG		CONDITION	ALCOHOL TEST STATUS TYPE VALUE		DRUG TEST(S) STATUS TYPE RESULT SELECT UP TO 4

INJURIES	SEATING POSITION	AIR BAG	OL CLASS	OL RESTRICTION(S)	DRIVER DISTRACTION	TEST STATUS
1-FATAL	1-FRONT-LEFT SIDE (MOTORCYCLE DRIVER)	1-NOT DEPLOYED	1-CLASS A	1-ALCOHOL INTERLOCK DEVICE	1-NOT DISTRACTED	1-NONE GIVEN
2-SUSPECTED SERIOUS INJURY	2-FRONT-MIDDLE	2-DEPLOYED FRONT	2-CLASS B	2-CDL INTRASTATE ONLY	2-MANUALLY OPERATING AN ELECTRONIC COMMUNICATION DEVICE (TEXTING, TYPING, DIALING)	2-TEST REFUSED
3-SUSPECTED MINDR INJURY	3-FRONT-RIGHT SIDE	3-DEPLOYED SIDE	3-CLASS C	3-CORRECTIVE LENSES	3-TALKING ON HANDS-FREE COMMUNICATION DEVICE	3-TEST GIVEN; CONTAMINATED SAMPLE / UNUSABLE
4-POSSIBLE INJURY	4-SECOND-LEFT SIDE (MOTORCYCLE PASSENGER)	4-DEPLOYED BOTH FRONT / SIDE	4-REGULAR CLASS (OHIO=D)	4-FARM WAIVER	4-TALKING ON HAND-HELD COMMUNICATION DEVICE	4-TEST GIVEN, RESULTS KNOWN
5-NO APPARENT INJURY	5-SECOND-MIDDLE	5-NOT APPLICABLE	5-MC MOPED ONLY	5-EXCEPT CLASS A BUS	5-OTHER ACTIVITY WITH AN ELECTRONIC DEVICE	5-TEST GIVEN, RESULTS UNKNOWN
	6-SECOND-RIGHT SIDE	9-DEPLOYMENT UNKNOWN	6-NOVALID OL	6-EXCEPT CLASS A & CLASS B BUS	6-PASSENGER	
	7-THIRD-LEFT SIDE (MOTORCYCLE SIDE CAR)			7-EXCEPT TRACTOR-TRAILER	7-OTHER DISTRACTION INSIDE THE VEHICLE	
	8-THIRD-MIDDLE			8-INTERMEDIATE LICENSE RESTRICTIONS	8-OTHER DISTRACTION OUTSIDE THE VEHICLE	
	9-THIRD-RIGHT SIDE			9-LEARNER'S PERMIT RESTRICTIONS	9-OTHER / UNKNOWN	
	10-SLEEPER SECTION OF TRUCK CAB			10-LIMITED TO DAYLIGHT ONLY		
	11-PASSENGER IN OTHER ENCLOSED CARGO AREA (NON-TRAILING UNIT, BUS, PICK-UP WITH CAP)			11-LIMITED TO EMPLOYMENT		
	12-PASSENGER IN UNENCLOSED CARGO AREA			12-LIMITED - OTHER		
	13-TRAILING UNIT			13-MECHANICAL DEVICES (SPECIAL BRAKES, HAND CONTROLS, OR OTHER ADAPTIVE DEVICES)		
	14-RIDING ON VEHICLE EXTERIOR (NON-TRAILING UNIT)			14-MILITARY VEHICLES ONLY		
	15-NON-MOTORIST			15-MOTOR VEHICLES WITHOUT AIR BRAKES		
	99-OTHER / UNKNOWN			16-OUTSIDE MIRROR		
				17-PROSTHETIC AID		
				18-OTHER		



OCCUPANT / WITNESS ADDENDUM

LOCAL REPORT NUMBER
2 3 0 0 4 0 9 0

OCCUPANT	UNIT # 1	NAME: LAST, FIRST, MIDDLE Redd, Brooklyn	DATE OF BIRTH 0 9 1 2 2 0 0 4		AGE 1 8	GENDER F
	ADDRESS: STREET, CITY, STATE, ZIP 296 Westfield Ave Hamilton OH 45013			CONTACT PHONE - INCLUDE AREA CODE		
	INJURIES 5	INJURED TAKEN BY	EMS AGENCY (NAME)	INJURED TAKEN TO: MEDICAL FACILITY (NAME, CITY)	SAFETY EQUIPMENT USED 0 4	<input type="checkbox"/> DOT-COMPLIANT MC HELMET SEATING POSITION 0 3 AIR BAG USAGE 0 4 EJECTION 1 TRAPPED 1

OCCUPANT	UNIT #	NAME: LAST, FIRST, MIDDLE	DATE OF BIRTH		AGE 0	GENDER
	ADDRESS: STREET, CITY, STATE, ZIP			CONTACT PHONE - INCLUDE AREA CODE		
	INJURIES	INJURED TAKEN BY	EMS AGENCY (NAME)	INJURED TAKEN TO: MEDICAL FACILITY (NAME, CITY)	SAFETY EQUIPMENT USED	<input type="checkbox"/> DOT-COMPLIANT MC HELMET SEATING POSITION AIR BAG USAGE EJECTION TRAPPED

OCCUPANT	UNIT #	NAME: LAST, FIRST, MIDDLE	DATE OF BIRTH		AGE 0	GENDER
	ADDRESS: STREET, CITY, STATE, ZIP			CONTACT PHONE - INCLUDE AREA CODE		
	INJURIES	INJURED TAKEN BY	EMS AGENCY (NAME)	INJURED TAKEN TO: MEDICAL FACILITY (NAME, CITY)	SAFETY EQUIPMENT USED	<input type="checkbox"/> DOT-COMPLIANT MC HELMET SEATING POSITION AIR BAG USAGE EJECTION TRAPPED

OCCUPANT	UNIT #	NAME: LAST, FIRST, MIDDLE	DATE OF BIRTH		AGE 0	GENDER
	ADDRESS: STREET, CITY, STATE, ZIP			CONTACT PHONE - INCLUDE AREA CODE		
	INJURIES	INJURED TAKEN BY	EMS AGENCY (NAME)	INJURED TAKEN TO: MEDICAL FACILITY (NAME, CITY)	SAFETY EQUIPMENT USED	<input type="checkbox"/> DOT-COMPLIANT MC HELMET SEATING POSITION AIR BAG USAGE EJECTION TRAPPED

INJURIES	SAFETY EQUIPMENT USED	SEATING POSITION	AIR BAG USAGE
1 - FATAL	1 - NONE USED - VEHICLE OCCUPANT	1 - FRONT - LEFT SIDE (MOTORCYCLE DRIVER)	1 - NOT DEPLOYED
2 - SUSPECTED SERIOUS INJURY	2 - SHOULDER BELT ONLY USED	2 - FRONT - MIDDLE	2 - DEPLOYED FRONT
3 - SUSPECTED MINOR INJURY	3 - LAP BELT ONLY USED	3 - FRONT - RIGHT SIDE	3 - DEPLOYED SIDE
4 - POSSIBLE INJURY	4 - SHOULDER & LAP BELT USED	4 - SECOND - LEFT SIDE (MOTORCYCLE PASSENGER)	4 - DEPLOYED BOTH FRONT/SIDE
5 - NO APPARENT INJURY	5 - CHILD RESTRAINT SYSTEM - FORWARD FACING	5 - SECOND - MIDDLE	5 - NOT APPLICABLE
	6 - CHILD RESTRAINT SYSTEM - REAR FACING	6 - SECOND - RIGHT SIDE	9 - DEPLOYMENT UNKNOWN
	7 - BOOSTER SEAT	7 - THIRD - LEFT SIDE (MOTORCYCLE SIDE CAR)	EJECTION
	8 - HELMET USED	8 - THIRD - MIDDLE	1 - NOT EJECTED
	9 - PROTECTIVE PADS USED (ELBOW, KNEES, ETC.)	9 - THIRD - RIGHT SIDE	2 - PARTIALLY EJECTED
	10 - REFLECTIVE CLOTHING	10 - SLEEPER SECTION OF TRUCK CAB	3 - TOTALLY EJECTED
	11 - LIGHTING - PEDESTRIAN / BICYCLE ONLY	11 - PASSENGER IN OTHER ENCLOSED CARGO AREA (NON-TRAILING UNIT, BUS, PICK-UP WITH CAP)	4 - NOT APPLICABLE
	99 - OTHER / UNKNOWN	12 - PASSENGER IN UNENCLOSED CARGO AREA	TRAPPED
		13 - TRAILING UNIT	1 - NOT TRAPPED
		14 - RIDING ON VEHICLE EXTERIOR (NON-TRAILING UNIT)	2 - EXTRICATED BY MECHANICAL MEANS
		15 - NON-MOTORIST	3 - FREED BY NON-MECHANICAL MEANS
		99 - OTHER / UNKNOWN	

WITNESS	NAME: LAST, FIRST, MIDDLE	DATE OF BIRTH		AGE 0	GENDER
	ADDRESS: STREET, CITY, STATE, ZIP	CONTACT PHONE - INCLUDE AREA CODE			

WITNESS	NAME: LAST, FIRST, MIDDLE	DATE OF BIRTH		AGE 0	GENDER
	ADDRESS: STREET, CITY, STATE, ZIP	CONTACT PHONE - INCLUDE AREA CODE			

WITNESS	NAME: LAST, FIRST, MIDDLE	DATE OF BIRTH		AGE 0	GENDER
	ADDRESS: STREET, CITY, STATE, ZIP	CONTACT PHONE - INCLUDE AREA CODE			

LOCAL REPORT NUMBER PD-23-004090	REPORTING AGENCY Fairfield Police Department	DATE OF ACCIDENT 1/16/23
IN COUNTY OF Butler	ACCIDENT LOCATION 5861 Gray Rd. Fairfield, OH. 45014	

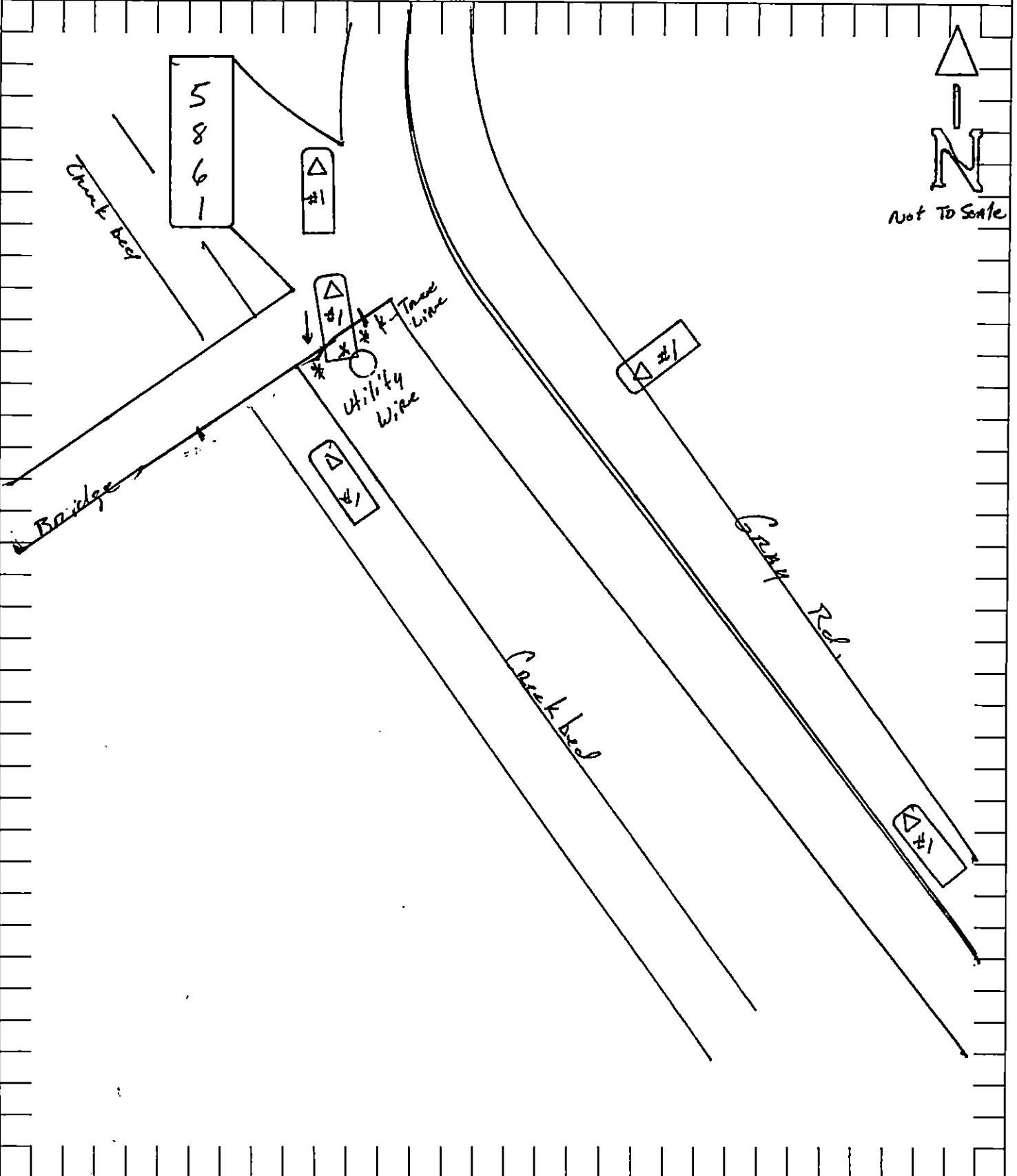

OFFICER'S SIGNATURE PO Greg Bailes	BADGE NO. 122
--	-------------------------