

# TRAFFIC CRASH REPORT

\*DENOTES MANDATORY FIELD FOR SUPPLEMENT REPORT

LOCAL REPORT NUMBER\*

<input checked="" type="checkbox"/> PHOTOSTAKEN	<input checked="" type="checkbox"/> OH-2	<input type="checkbox"/> OH-3	LOCAL INFORMATION		2 3 0 1 2 0 5 5			
<input type="checkbox"/> SECONDARY CRASH	<input type="checkbox"/> OH-1P	<input type="checkbox"/> OTHER	REPORTING AGENCY NAME*		NCIC*		HIT/SKIP	
<input type="checkbox"/> PRIVATE PROPERTY	Fairfield Police Department		0 0 9 0 1		1 - SOLVED		NUMBER OF UNITS	
						2 - UNSOLVED		0 2
								UNIT IN ERROR
								0 1 98 - ANIMAL
								0 1 99 - UNKNOWN

COUNTY*	LOCALITY*	LOCATION: CITY, VILLAGE, TOWNSHIP*		CRASH DATE / TIME*		CRASH SEVERITY	
0 9	1	City of Fairfield		0 2 1 5 2 0 2 3 1 6 4 1		4	

ROUTE TYPE	ROUTE NUMBER	PREFIX	LOCATION ROAD NAME	ROAD TYPE	LATITUDE DECIMAL DEGREES	CRASH SEVERITY 1 - FATAL 2 - SERIOUS INJURY SUSPECTED 3 - MINOR INJURY SUSPECTED 4 - INJURY POSSIBLE 5 - PROPERTY DAMAGE ONLY
			South Gilmore	R D	3 9 . 3 2 4 4 8 0	
REFERENCE	ROUTE TYPE	ROUTE NUMBER	PREFIX	REFERENCE ROAD NAME (ROAD, MILEPOST, HOUSE #)	ROAD TYPE	LONGITUDE DECIMAL DEGREES
				Planet	D R	- 8 4 . 5 2 1 9 0 1

REFERENCE POINT	DIRECTION FROM REFERENCE	ROUTE TYPE	ROAD TYPE	INTERSECTION RELATED	
1 - INTERSECTION	1 - NORTH	IR - INTERSTATE ROUTE (TP)	AL - ALLEY	<input checked="" type="checkbox"/> WITHIN INTERSECTION OR ON APPROACH	
2 - MILE POST	2 - SOUTH	US - FEDERAL US ROUTE	AV - AVENUE	<input type="checkbox"/> WITHIN INTERCHANGE AREA	
3 - HOUSE #	3 - EAST	SR - STATE ROUTE	BL - BOULEVARD	NUMBER OF APPROACHES	
	4 - WEST	CR - NUMBERED COUNTY ROUTE	MP - MILEPOST	3	
DISTANCE FROM REFERENCE	DISTANCE UNIT OF MEASURE	TR - NUMBERED TOWNSHIP ROUTE	OV - OVAL	ROADWAY	
	1 - MILES		CT - COURT	<input type="checkbox"/> ROADWAY DIVIDED	
	2 - FEET		PK - PARKWAY		
	3 - YARDS		TL - TRAIL		
			WA - WAY		
			HE - HEIGHTS		
			PL - PLACE		

LOCATION OF FIRST HARMFUL EVENT		MANNER OF CRASH COLLISION/IMPACT		DIRECTION OF TRAVEL		MEDIAN TYPE	
0 1	1 - ON ROADWAY	2	1 - NOT COLLISION BETWEEN TWO MOTOR VEHICLES IN TRANSPORT	1 - NORTH	1 - DIVIDED FLUSH MEDIAN (<4 FEET)		
	2 - ON SHOULDER		2 - REAR-END	2 - SOUTH	2 - DIVIDED FLUSH MEDIAN (≥4 FEET)		
	3 - IN MEDIAN		3 - HEAD-ON	3 - EAST	3 - DIVIDED, DEPRESSED MEDIAN		
	4 - ON ROADSIDE			4 - WEST	4 - DIVIDED, RAISED MEDIAN (ANY TYPE)		
	5 - ON GORE				9 - OTHER/UNKNOWN		
	6 - OUTSIDE TRAFFIC WAY						
	7 - ON RAMP						
	8 - OFF RAMP						
	9 - CROSSOVER						
	10 - DRIVEWAY/ALLEY ACCESS						
	11 - RAILWAY GRADE CROSSING						
	12 - SHARED USE PATHS OR TRAILS						
	13 - BIKE LANE						
	14 - TOLL BOOTH						
	99 - OTHER / UNKNOWN						

<input type="checkbox"/> WORK ZONE RELATED	WORK ZONE TYPE	LOCATION OF CRASH IN WORK ZONE	CONTOUR	CONDITIONS	SURFACE
<input type="checkbox"/> WORKERS PRESENT	1 - LANE CLOSURE	1 - BEFORE THE 1ST WORK ZONE WARNING SIGN	2	1	2
<input type="checkbox"/> LAW ENFORCEMENT PRESENT	2 - LANE SHIFT/CROSSOVER	2 - ADVANCE WARNING AREA	1 - STRAIGHT LEVEL	1 - DRY	1 - CONCRETE
<input type="checkbox"/> ACTIVE SCHOOL ZONE	3 - WORK ON SHOULDER OR MEDIAN	3 - TRANSITION AREA	2 - STRAIGHT GRADE	2 - WET	2 - BLACKTOP, BITUMINOUS, ASPHALT
	4 - INTERMITTENT OR MOVING WORK	4 - ACTIVITY AREA	3 - CURVE LEVEL	3 - SNOW	3 - BRICK/BLOCK
	5 - OTHER	5 - TERMINATION AREA	4 - CURVE GRADE	4 - ICE	4 - SLAG, GRAVEL, STONE
			9 - OTHER/UNKNOWN	5 - SAND, MUD, DIRT, OIL, GRAVEL	5 - DIRT
				6 - WATER (STANDING, MOVING)	9 - OTHER/UNKNOWN
				7 - SLUSH	
				9 - OTHER/UNKNOWN	

LIGHT CONDITION	WEATHER
1	0 1
1 - DAYLIGHT	1 - CLEAR
2 - DAWN/DUSK	2 - CLOUDY
3 - DARK - LIGHTED ROADWAY	3 - FOG, SMOG, SMOKE
4 - DARK - ROADWAY NOT LIGHTED	4 - RAIN
5 - DARK - UNKNOWN ROADWAY LIGHTING	5 - SLEET, HAIL
9 - OTHER / UNKNOWN	6 - SNOW
	7 - SEVERE CROSSWINDS
	8 - BLOWING SAND, SOIL, DIRT, SNOW
	9 - FREEZING RAIN OR FREEZING DRIZZLE
	99 - OTHER / UNKNOWN

NARRATIVE

On 2/15/2023 at about 4:41 P.M. Unit 1 was traveling north on South Gilmore Road at approximately 35 M.P.H and when at Planet Drive failed to stop within the assured clear distance ahead and collided with Unit 2 which was also northbound and was stopped waiting to make a left turn.

SEE OH-2

Indicate the north direction with an "N" on the compass diagram.

CRASH REPORTED DATE / TIME	DISPATCH DATE / TIME	ARRIVAL DATE / TIME	SCENE CLEARED DATE / TIME	REPORT TAKEN BY
0 2 1 5 2 0 2 3 1 6 4 1	0 2 1 5 2 0 2 3 1 6 4 3	0 2 1 5 2 0 2 3 1 6 5 1	0 2 1 5 2 0 2 3 1 7 3 7	<input checked="" type="checkbox"/> POLICE AGENCY
TOTAL TIME ROADWAY CLOSED	OTHER INVESTIGATION TIME	TOTAL MINUTES	OFFICER'S NAME*	<input type="checkbox"/> MOTORIST
	3 0	8 4	C. Frazier	<input type="checkbox"/> SUPPLEMENT (CORRECTION OR ADDITION TO AN EXISTING REPORT SENT TO 6046)
			OFFICER'S BADGE NUMBER*	
			1 5 8	
			CHECKED BY OFFICER'S NAME*	
			D. Pohl	
			CHECKED BY OFFICER'S BADGE NUMBER*	
			1 3 0	

**OWNER**  
UNIT # **011** OWNER NAME: LAST, FIRST, MIDDLE (SAME AS DRIVER) **DAYTON FREIGHT LINES INC.**  
OWNER PHONE: INCLUDE AREA CODE (SAME AS DRIVER)  
OWNER ADDRESS: STREET, CITY, STATE, ZIP (SAME AS DRIVER)  
**6450 POE AVENUE, VANDALIA, OHIO, 45414**  
COMMERCIAL CARRIER: NAME, ADDRESS, CITY, STATE, ZIP  
**DAYTON FREIGHT LINES INC**  
COMMERCIAL CARRIER PHONE: INCLUDE AREA CODE

**DAMAGE**  
DAMAGE SCALE  
**3** 1 - NONE 3 - FUNCTIONAL DAMAGE  
2 - MINOR DAMAGE 4 - DISABLING DAMAGE  
9 - UNKNOWN

LP STATE **OH** LICENSE PLATE # **PWU8948** VEHICLE IDENTIFICATION # **1HTEUUMN13NH1291275** VEHICLE YEAR **2022** VEHICLE MAKE **INTERNATI**  
INSURANCE VERIFIED  INSURANCE COMPANY **UNITED STATES FIRE** INSURANCE POLICY # **1337515677** COLOR **ORANGE** VEHICLE MODEL **TRUCK**

**DAMAGED AREA(S)**  
INDICATE ALL THAT APPLY

TYPE OF USE  
 COMMERCIAL  GOVERNMENT  IN EMERGENCY RESPONSE  
US DOT # **273301** TOWED BY: COMPANY NAME  
INTERLOCK DEVICE EQUIPPED  HIT/SKIP UNIT  #OCCUPANTS **01**  
VEHICLE WEIGHT GVWR/GCWR  
1 - ≤10K LBS.  
2 - 10,001 - 26K LBS.  
3 - >26K LBS.

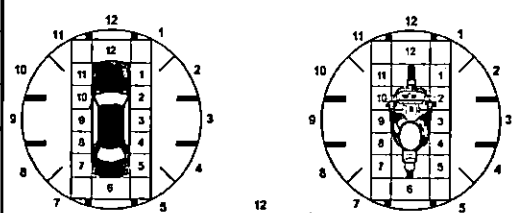

UNIT TYPE  
**14**  
1 - PASSENGER CAR 7 - MOTORCYCLE 2-WHEELED 12 - GOLF CART 18 - LIMO (LIVERY VEHICLE) 23 - PEDESTRIAN / SKATER  
2 - PASSENGER VAN (MINIVAN) 8 - MOTORCYCLE 3-WHEELED 13 - SNOWMOBILE 19 - BUS (16+ PASSENGERS) 24 - WHEELCHAIR (ANY TYPE)  
3 - SPORT UTILITY VEHICLE 9 - AUTOCYCLE 14 - SINGLE UNIT TRUCK 20 - OTHER VEHICLE 25 - OTHER NON-MOTORIST  
4 - PICK UP 10 - MOPED OR MOTORIZED BICYCLE 15 - SEMI-TRACTOR 21 - HEAVY EQUIPMENT 26 - BICYCLE  
5 - CARGO VAN 11 - ALL TERRAIN VEHICLE (ATV/UTV) 16 - FARM EQUIPMENT 22 - ANIMAL WITH RIDER OR ANIMAL-DRAWN VEHICLE 27 - TRAIN  
6 - VAN (9-15 SEATS) 17 - MOTORHOME

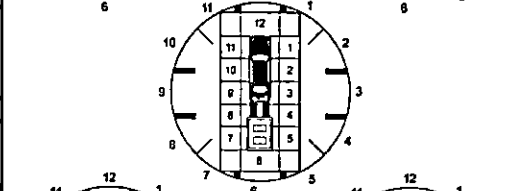

# OF TRAILING UNITS **0**  
WAS VEHICLE OPERATING IN AUTONOMOUS MODE WHEN CRASH OCCURRED?  
**2** 1 - YES 2 - NO 9 - OTHER / UNKNOWN  
AUTONOMOUS MODE LEVEL  
**0** 0 - NO AUTOMATION 1 - DRIVER ASSISTANCE 2 - PARTIAL AUTOMATION 3 - CONDITIONAL AUTOMATION 4 - HIGH AUTOMATION 5 - FULL AUTOMATION 9 - UNKNOWN

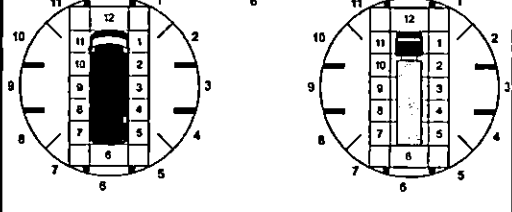

SPECIAL FUNCTION  
**01**  
1 - NONE 6 - BUS - CHARTER/TOUR 11 - FIRE 16 - FARM 21 - MAIL CARRIER  
2 - TAXI 7 - BUS - INTERCITY 12 - MILITARY 17 - MOWING 99 - OTHER / UNKNOWN  
3 - ELECTRONIC RIDE SHARING 8 - BUS - SHUTTLE 13 - POLICE 18 - SNOW REMOVAL  
4 - SCHOOL TRANSPORT 9 - BUS - OTHER 14 - PUBLIC UTILITY 19 - TOWING  
5 - BUS - TRANSIT/COMMUTER 10 - AMBULANCE 15 - CONSTRUCTION EQUIPMENT 20 - SAFETY SERVICE PATROL

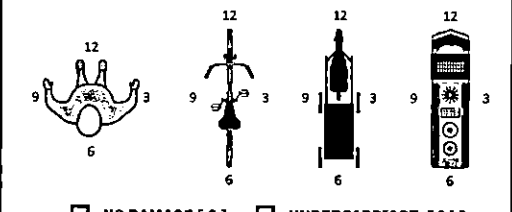

CARGO BODY TYPE  
**06**  
1 - NO CARGO BODY TYPE / NOT APPLICABLE 3 - VEHICLE TOWING ANOTHER VEHICLE 5 - INTERMODAL CONTAINER CHASSIS 8 - POLE 12 - CONCRETE MIXER  
2 - BUS 4 - LOGGING 6 - CARGO VAN/ENCLOSED BOX 9 - CARGO TANK 13 - AUTO TRANSPORTER  
7 - GRAIN/CHIPS/GRAVEL 11 - DUMP 10 - FLAT BED 14 - GARBAGE/REFUSE 99 - OTHER / UNKNOWN

- NO DAMAGE [ 0 ]  - UNDERCARRIAGE [ 14 ]  
 - TOP [ 13 ]  - ALL AREAS [ 15 ]  
 - UNIT NOT AT SCENE [ 16 ]

VEHICLE DEFECTS  
**03**  
1 - TURN SIGNALS 4 - BRAKES 7 - WORN OR SLICK TIRES 9 - MOTOR TROUBLE 99 - OTHER / UNKNOWN  
2 - HEAD LAMPS 5 - STEERING 8 - TRAILER EQUIPMENT DEFECTIVE 10 - DISABLED FROM PRIOR ACCIDENT  
3 - TAIL LAMPS 6 - TIRE BLOWOUT

NON-MOTORIST LOCATION AT IMPACT  
**03**  
1 - INTERSECTION - MARKED CROSSWALK 3 - INTERSECTION - OTHER 6 - BICYCLE LANE 9 - MEDIAN/CROSSING ISLAND 12 - FIRST RESPONDER AT INCIDENT SCENE  
2 - INTERSECTION - UNMARKED CROSSWALK 4 - MIDBLOCK - MARKED CROSSWALK 7 - SHOULDER / ROADSIDE 10 - DRIVEWAY ACCESS 99 - OTHER / UNKNOWN  
5 - TRAVEL LANE - OTHER LOCATION 8 - SIDEWALK 11 - SHARED USE PATHS OR TRAILS

INITIAL POINT OF CONTACT  
**12**  
0 - NO DAMAGE 14 - UNDERCARRIAGE  
1-12 - REFER TO UNIT DIAGRAM 15 - VEHICLE NOT AT SCENE  
99 - UNKNOWN  
13 - TOP

ACTION  
**03**  
1 - NON-CONTACT 1 - STRAIGHT AHEAD 7 - MAKING U-TURN 13 - NEGOTIATING A CURVE 18 - APPROACHING OR LEAVING VEHICLE  
2 - NON-COLLISION 2 - BACKING 8 - ENTERING TRAFFIC LANE 14 - ENTERING OR CROSSING SPECIFIED LOCATION 19 - STANDING  
3 - STRIKING 3 - CHANGING LANES 9 - LEAVING TRAFFIC LANE 15 - WALKING, RUNNING, JOGGING, PLAYING 20 - OTHER NON-MOTORIST  
4 - STRUCK PRE-CRASH ACTIONS 10 - PARKED 11 - SLOWING OR STOPPED IN TRAFFIC 16 - WORKING 21 - STANDING OUTSIDE DISABLED VEHICLE  
5 - BOTH STRIKING & STRUCK 6 - MAKING LEFT TURN 12 - DRIVERLESS 17 - PUSHING VEHICLE 99 - OTHER / UNKNOWN  
9 - OTHER / UNKNOWN

**TRAFFIC**  
TRAFFICWAY FLOW  
**2** 1 - ONE-WAY 2 - TWO-WAY  
TRAFFIC CONTROL  
**6** 1 - ROUNDABOUT 4 - STOP SIGN 2 - SIGNAL 5 - YIELD SIGN 3 - FLASHER 6 - NO CONTROL

CONTRIBUTING CIRCUMSTANCES  
**08**  
1 - NONE 7 - LEFT OF CENTER 13 - IMPROPER START FROM A PARKED POSITION 17 - VISION OBSTRUCTION 21 - LYING IN ROADWAY  
2 - FAILURE TO YIELD 8 - FOLLOWING TOO CLOSE / ACDA 14 - STOPPED OR PARKED ILLEGALLY 18 - OPERATING DEFECTIVE EQUIPMENT 22 - NOT DISCERNIBLE  
3 - RAN RED LIGHT 9 - IMPROPER LANE CHANGE 15 - SWERVING TO AVOID 19 - LOAD SHIFTING/FALLING/SPILLING 23 - OPENING DOOR INTO ROADWAY  
4 - RAN STOP SIGN 10 - IMPROPER PASSING 16 - WRONG WAY 20 - IMPROPER CROSSING 99 - OTHER IMPROPER ACTION  
5 - UNSAFE SPEED 11 - DROVE OFF ROAD 12 - IMPROPER BACKING

# OF THROUGH LANES ON ROAD **4**  
RAIL GRADE CROSSING  
**1** 1 - NOT INVOLVED 2 - INVOLVED-ACTIVE CROSSING 3 - INVOLVED-PASSIVE CROSSING

SEQUENCE OF EVENTS  
**120**  
1 - OVERTURN/ROLLOVER 6 - EQUIPMENT FAILURE 11 - CROSS CENTERLINE - OPPOSITE DIRECTION OF TRAVEL 16 - RAILWAY VEHICLE 22 - WORK ZONE MAINTENANCE EQUIPMENT  
2 - FIRE/EXPLOSION 7 - SEPARATION OF UNITS 12 - DOWNHILL RUNAWAY 17 - ANIMAL - FARM 23 - STRUCK BY FALLING, SHIFTING CARGO OR ANYTHING SET IN MOTION BY A MOTOR VEHICLE  
3 - IMMERSION 8 - RAN OFF ROAD RIGHT 13 - OTHER NON-COLLISION 18 - ANIMAL - DEER 24 - OTHER MOVABLE OBJECT  
4 - JACKKNIFE 9 - RAN OFF ROAD LEFT 14 - PEDESTRIAN 19 - ANIMAL - OTHER  
5 - CARGO / EQUIPMENT LOSS OR SHIFT 10 - CROSS MEDIAN 15 - PEDALCYCLE 20 - MOTOR VEHICLE IN TRANSPORT  
3 -

**UNIT / NON-MOTORIST DIRECTION**  
FROM **2** TO **1**  
1 - NORTH 5 - NORTHEAST 2 - SOUTH 6 - NORTHWEST 3 - EAST 7 - SOUTHEAST 4 - WEST 8 - SOUTHWEST 9 - OTHER / UNKNOWN

**COLLISION WITH FIXED OBJECT - STRUCK**  
**1** 25 - IMPACT ATTENUATOR / CRASH CUSHION 31 - GUARDRAIL END 37 - TRAFFIC SIGN POST 43 - CURB 50 - WORK ZONE MAINTENANCE EQUIPMENT  
**1** 26 - BRIDGE OVERHEAD STRUCTURE 32 - PORTABLE BARRIER 38 - OVERHEAD SIGN POST 44 - DITCH 51 - WALL  
**1** 27 - BRIDGE PIER OR ABUTMENT 33 - MEDIAN CABLE BARRIER 39 - LIGHT / LUMINARIES SUPPORT 45 - EMBANKMENT 52 - BUILDING  
**1** 28 - BRIDGE PARAPET 34 - MEDIAN GUARDRAIL BARRIER 40 - UTILITY POLE 46 - FENCE 53 - TUNNEL  
**1** 29 - BRIDGE RAIL 35 - MEDIAN CONCRETE BARRIER 41 - OTHER POST, POLE OR SUPPORT 47 - MAILBOX 54 - OTHER FIXED OBJECT  
**1** 30 - GUARDRAIL FACE 36 - MEDIAN OTHER BARRIER 42 - CULVERT 48 - TREE 99 - OTHER / UNKNOWN 49 - FIRE HYDRANT

UNIT SPEED **35**  
POSTED SPEED **35**  
DETECTED SPEED  
**1** 1 - STATED / ESTIMATED SPEED 2 - CALCULATED / EDR 3 - UNDETERMINED

**OWNER**

UNIT # 012 OWNER NAME: LAST, FIRST, MIDDLE (SAME AS DRIVER) OWNER PHONE: INCLUDE AREA CODE (SAME AS DRIVER)

OWNER ADDRESS: STREET, CITY, STATE, ZIP (SAME AS DRIVER)

COMMERCIAL CARRIER: NAME, ADDRESS, CITY, STATE, ZIP COMMERCIAL CARRIER PHONE: INCLUDE AREA CODE

**DAMAGE**

DAMAGE SCALE

1 - NONE 3 - FUNCTIONAL DAMAGE  
2 - MINOR DAMAGE 4 - DISABLING DAMAGE  
9 - UNKNOWN

4

LP STATE OH LICENSE PLATE # JJP6806 VEHICLE IDENTIFICATION # JN8AF5M13HT751421816 VEHICLE YEAR 2017 VEHICLE MAKE NISSAN

INSURANCE VERIFIED  INSURANCE COMPANY THE GENERAL INSURANCE POLICY # 920H3380072 COLOR BLUE VEHICLE MODEL JUKE

TYPE OF USE:  COMMERCIAL  GOVERNMENT  IN EMERGENCY RESPONSE

US DOT # \_\_\_\_\_ TOWED BY: COMPANY NAME FOX TOWING

HAZARDOUS MATERIAL:  MATERIAL RELEASED  PLACARD

DAMAGED AREA(S) INDICATE ALL THAT APPLY

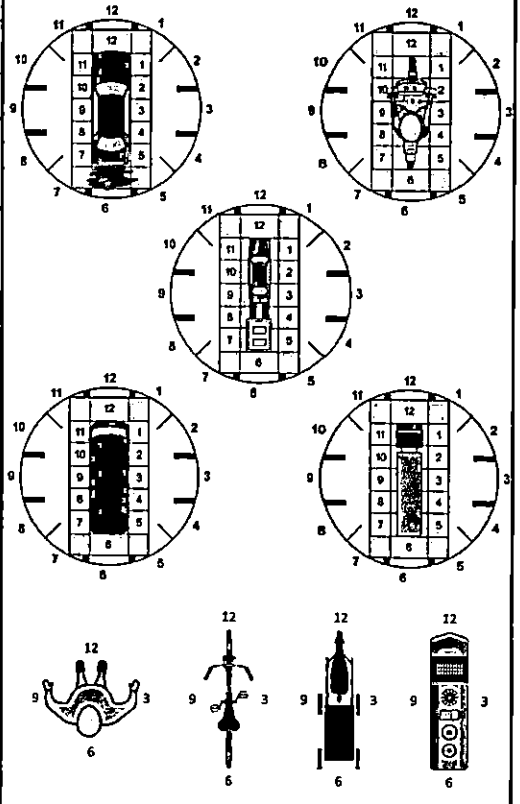

UNIT TYPE 03

1 - PASSENGER CAR 7 - MOTORCYCLE 2-WHEELED 12 - GOLF CART 18 - LIMO (LIVERY VEHICLE) 23 - PEDESTRIAN / SKATER  
2 - PASSENGER VAN (MINIVAN) 8 - MOTORCYCLE 3-WHEELED 13 - SNOWMOBILE 19 - BUS (16+ PASSENGERS) 24 - WHEELCHAIR (ANY TYPE)  
3 - SPORT UTILITY VEHICLE 9 - AUTOCYCLE 14 - SINGLE UNIT TRUCK 20 - OTHER VEHICLE 25 - OTHER NON-MOTORIST  
4 - PICK UP 10 - MOPED OR MOTORIZED BICYCLE 15 - SEMI-TRACTOR 21 - HEAVY EQUIPMENT 26 - BICYCLE  
5 - CARGO VAN 11 - ALL TERRAIN VEHICLE (ATV/UTV) 16 - FARM EQUIPMENT 22 - ANIMAL WITH RIDER OR ANIMAL-DRAWN VEHICLE 27 - TRAIN  
6 - VAN (9-15 SEATS) 99 - UNKNOWN OR HIT/SKIP

# OF TRAILING UNITS 0

WAS VEHICLE OPERATING IN AUTONOMOUS MODE WHEN CRASH OCCURRED? 0

1 - YES 2 - NO 9 - OTHER / UNKNOWN

AUTONOMOUS MODE LEVEL: 0 - NO AUTOMATION 1 - DRIVER ASSISTANCE 2 - PARTIAL AUTOMATION 3 - CONDITIONAL AUTOMATION 4 - HIGH AUTOMATION 5 - FULL AUTOMATION 9 - UNKNOWN

SPECIAL FUNCTION 01

1 - NONE 6 - BUS - CHARTER/TOUR 11 - FIRE 16 - FARM 21 - MAIL CARRIER  
2 - TAXI 7 - BUS - INTERCITY 12 - MILITARY 17 - MOWING 99 - OTHER / UNKNOWN  
3 - ELECTRONIC RIDE SHARING 8 - BUS - SHUTTLE 13 - POLICE 18 - SNOW REMOVAL  
4 - SCHOOL TRANSPORT 9 - BUS - OTHER 14 - PUBLIC UTILITY 19 - TOWING  
5 - BUS - TRANSIT/COMMUTER 10 - AMBULANCE 15 - CONSTRUCTION EQUIPMENT 20 - SAFETY SERVICE PATROL

CARGO BODY TYPE 01

1 - NO CARGO BODY TYPE / NOT APPLICABLE 3 - VEHICLE TOWING ANOTHER MOTOR VEHICLE 5 - INTERMODAL CONTAINER CHASSIS 8 - POLE 12 - CONCRETE MIXER  
2 - BUS 4 - LOGGING 6 - CARGO VAN/ENCLOSED BOX 9 - CARGO TANK 13 - AUTO TRANSPORTER  
7 - GRAIN/CHIPS/GRAVEL 10 - FLAT BED 14 - GARBAGE/REFUSE  
11 - DUMP 99 - OTHER / UNKNOWN

VEHICLE DEFECTS 01

1 - TURN SIGNALS 4 - BRAKES 7 - WORN OR SLICK TIRES 9 - MOTOR TROUBLE 99 - OTHER / UNKNOWN  
2 - HEAD LAMPS 5 - STEERING 8 - TRAILER EQUIPMENT DEFECTIVE 10 - DISABLED FROM PRIOR ACCIDENT  
3 - TAIL LAMPS 6 - TIRE BLOWOUT

- NO DAMAGE [ 0 ]  - UNDERCARRIAGE [ 14 ]  
 - TOP [ 13 ]  - ALL AREAS [ 15 ]  
 - UNIT NOT AT SCENE [ 16 ]

NON-MOTORIST LOCATION AT IMPACT

1 - INTERSECTION - MARKED CROSSWALK 3 - INTERSECTION - OTHER 6 - BICYCLE LANE 9 - MEDIA/CROSSING ISLAND 12 - FIRST RESPONDER AT INCIDENT SCENE  
2 - INTERSECTION - UNMARKED CROSSWALK 4 - MIDBLOCK - MARKED CROSSWALK 7 - SHOULDER / ROADSIDE 10 - DRIVEWAY ACCESS 15 - WALKING, RUNNING, JOGGING, PLAYING  
5 - TRAVEL LANE - OTHER LOCATION 8 - SIDEWALK 11 - SHARED USE PATHS OR TRAILS 16 - WORKING 17 - PUSHING VEHICLE 99 - OTHER / UNKNOWN

ACTION 04 PRE-CRASH ACTIONS 11

1 - NON-CONTACT 1 - STRAIGHT AHEAD 7 - MAKING U-TURN 13 - NEGOTIATING A CURVE 18 - APPROACHING OR LEAVING VEHICLE  
2 - NON-COLLISION 2 - BACKING 8 - ENTERING TRAFFIC LANE 14 - ENTERING OR CROSSING SPECIFIED LOCATION 19 - STANDING  
3 - STRIKING 3 - CHANGING LANES 9 - LEAVING TRAFFIC LANE 15 - WALKING, RUNNING, JOGGING, PLAYING 20 - OTHER NON-MOTORIST  
4 - STRUCK 4 - OVERTAKING/PASSING 10 - PARKED 16 - WORKING 21 - STANDING OUTSIDE DISABLED VEHICLE  
5 - BOTH STRIKING & STRUCK 5 - MAKING RIGHT TURN 11 - SLOWING OR STOPPED IN TRAFFIC 17 - PUSHING VEHICLE 99 - OTHER / UNKNOWN  
9 - OTHER / UNKNOWN 6 - MAKING LEFT TURN 12 - DRIVERLESS

INITIAL POINT OF CONTACT

0 - NO DAMAGE 14 - UNDERCARRIAGE  
1-12 - REFER TO UNIT DIAGRAM 15 - VEHICLE NOT AT SCENE  
13 - TOP 99 - UNKNOWN

CONTRIBUTING CIRCUMSTANCES 01

1 - NONE 7 - LEFT OF CENTER 13 - IMPROPER START FROM A PARKED POSITION 17 - VISION OBSTRUCTION 21 - LYING IN ROADWAY  
2 - FAILURE TO YIELD 8 - FOLLOWING TOO CLOSE / ACDA 14 - STOPPED OR PARKED ILLEGALLY 18 - OPERATING DEFECTIVE EQUIPMENT 22 - NOT DISCERNIBLE  
3 - RAN RED LIGHT 9 - IMPROPER LANE CHANGE 15 - SWERVING TO AVOID 19 - LOAD SHIFTING/FALLING/SPILLING 23 - OPENING DOOR INTO ROADWAY  
4 - RAN STOP SIGN 10 - IMPROPER PASSING 16 - WRONG WAY 20 - IMPROPER CROSSING 99 - OTHER IMPROPER ACTION  
5 - UNSAFE SPEED 11 - DROVE OFF ROAD 21 - PARKED MOTOR VEHICLE  
6 - IMPROPER TURN 12 - IMPROPER BACKING

TRAFFIC

TRAFFICWAY FLOW: 1 - ONE-WAY 2 - TWO-WAY 2

TRAFFIC CONTROL: 1 - ROUNDABOUT 4 - STOP SIGN 2 - SIGNAL 5 - YIELD SIGN 3 - FLASHER 6 - NO CONTROL 6

SEQUENCE OF EVENTS

1 20

1 - OVERTURN/ROLLOVER 6 - EQUIPMENT FAILURE 11 - CROSS CENTERLINE - OPPOSITE DIRECTION OF TRAVEL 16 - RAILWAY VEHICLE 22 - WORK ZONE MAINTENANCE EQUIPMENT  
2 - FIRE/EXPLOSION 7 - SEPARATION OF UNITS 12 - DOWNHILL RUNAWAY 17 - ANIMAL - FARM 23 - STRUCK BY FALLING, SHIFTING CARGO OR ANYTHING SET IN MOTION BY A MOTOR VEHICLE  
3 - IMMERSION 8 - RAN OFF ROAD RIGHT 13 - OTHER NON-COLLISION 18 - ANIMAL - DEER 24 - OTHER MOVABLE OBJECT  
4 - JACKKNIFE 9 - RAN OFF ROAD LEFT 14 - PEDESTRIAN 19 - ANIMAL - OTHER 20 - MOTOR VEHICLE IN TRANSPORT  
5 - CARGO / EQUIPMENT LOSS OR SHIFT 10 - CROSS MEDIAN 15 - PEDALCYCLE 21 - PARKED MOTOR VEHICLE

# OF THROUGH LANES ON ROAD 4

RAIL GRADE CROSSING: 1 - NOT INVOLVED 2 - INVOLVED-ACTIVE CROSSING 3 - INVOLVED-PASSIVE CROSSING 1

**COLLISION WITH FIXED OBJECT / STRUCK**

25 - IMPACT ATTENUATOR / CRASH CUSHION 31 - GUARDRAIL END 37 - TRAFFIC SIGN POST 43 - CURB 50 - WORK ZONE MAINTENANCE EQUIPMENT  
26 - BRIDGE OVERHEAD STRUCTURE 32 - PORTABLE BARRIER 38 - OVERHEAD SIGN POST 44 - DITCH 51 - WALL  
27 - BRIDGE PIER OR ABUTMENT 33 - MEDIAN CABLE BARRIER 39 - LIGHT / LUMINARIES SUPPORT 45 - EMBANKMENT 52 - BUILDING  
28 - BRIDGE PARAPET 34 - MEDIAN GUARDRAIL BARRIER 40 - UTILITY POLE 46 - FENCE 53 - TUNNEL  
29 - BRIDGE RAIL 35 - MEDIAN CONCRETE BARRIER 41 - OTHER POST, POLE OR SUPPORT 47 - MAILBOX 54 - OTHER FIXED OBJECT  
30 - GUARDRAIL FACE 36 - MEDIAN OTHER BARRIER 42 - CULVERT 48 - TREE 49 - FIRE HYDRANT 99 - OTHER / UNKNOWN

FIRST HARMFUL EVENT 1 MOST HARMFUL EVENT 1

UNIT / NON-MOTORIST DIRECTION

FROM 2 TO 1

1 - NORTH 5 - NORTHEAST 2 - SOUTH 6 - NORTHWEST 3 - EAST 7 - SOUTHEAST 4 - WEST 8 - SOUTHWEST 9 - OTHER / UNKNOWN

UNIT SPEED 0

POSTED SPEED 35

DETECTED SPEED: 1 - STATED / ESTIMATED SPEED 2 - CALCULATED / EDR 3 - UNDETERMINED 1



# MOTORIST / Non-MOTORIST

LOCAL REPORT NUMBER  
2 3 0 1 2 0 5 5

UNIT # 0 1	NAME: LAST, FIRST, MIDDLE ROUTH JR., JACK, RICHARD	DATE OF BIRTH 0 7 2 1 1 9 8 7	AGE 3 5	GENDER M
ADDRESS: STREET, CITY, STATE, ZIP 333 SHORT ST, LAWRENCEBURG, INDIANA, 47025		CONTACT PHONE - INCLUDE AREA CODE		

INJURIES 5	INJURED TAKEN BY	EMS AGENCY (NAME)	INJURED TAKEN TO: MEDICAL FACILITY (NAME, CITY)	SAFETY EQUIPMENT USED 0 4	<input type="checkbox"/> DOT-COMPLIANT MC HELMET	SEATING POSITION 0 1	AIR BAG USAGE 1	EJECTION 1	TRAPPED 1
OL STATE IN	OPERATOR LICENSE NUMBER	OFFENSE CHARGED 333.03A	LOCAL CODE <input checked="" type="checkbox"/>	OFFENSE DESCRIPTION ACDA	CITATION NUMBER 253562				
OL CLASS 1	ENDORSEMENT SELECT UP TO 2	RESTRICTION SELECT UP TO 3	DRIVER DISTRACTED BY 1	ALCOHOL / DRUG SUSPECTED <input type="checkbox"/> ALCOHOL <input type="checkbox"/> MARIJUANA <input type="checkbox"/> OTHER DRUG	CONDITION 1	ALCOHOL TEST STATUS TYPE VALUE 1 1			DRUG TEST(S) STATUS TYPE RESULT SELECT UP TO 4 1 1

UNIT # 0 2	NAME: LAST, FIRST, MIDDLE VANCLEAF, BRITTANY, D	DATE OF BIRTH 0 4 3 0 1 9 8 3	AGE 3 9	GENDER F
ADDRESS: STREET, CITY, STATE, ZIP 42 TODAY DRIVE, FAIRFIELD, OHIO, 45014		CONTACT PHONE - INCLUDE AREA CODE		

INJURIES 4	INJURED TAKEN BY 2	EMS AGENCY (NAME) FAIRFIELD EMS	INJURED TAKEN TO: MEDICAL FACILITY (NAME, CITY) MERCY HOSPITAL	SAFETY EQUIPMENT USED 0 4	<input type="checkbox"/> DOT-COMPLIANT MC HELMET	SEATING POSITION 0 1	AIR BAG USAGE 1	EJECTION 1	TRAPPED 1
OL STATE OH	OPERATOR LICENSE NUMBER	OFFENSE CHARGED	LOCAL CODE <input type="checkbox"/>	OFFENSE DESCRIPTION	CITATION NUMBER				
OL CLASS 4	ENDORSEMENT SELECT UP TO 2	RESTRICTION SELECT UP TO 3	DRIVER DISTRACTED BY 1	ALCOHOL / DRUG SUSPECTED <input type="checkbox"/> ALCOHOL <input type="checkbox"/> MARIJUANA <input type="checkbox"/> OTHER DRUG	CONDITION 1	ALCOHOL TEST STATUS TYPE VALUE 1 1			DRUG TEST(S) STATUS TYPE RESULT SELECT UP TO 4 1 1

UNIT #	NAME: LAST, FIRST, MIDDLE	DATE OF BIRTH	AGE 0	GENDER
ADDRESS: STREET, CITY, STATE, ZIP		CONTACT PHONE - INCLUDE AREA CODE		

INJURIES	INJURED TAKEN BY	EMS AGENCY (NAME)	INJURED TAKEN TO: MEDICAL FACILITY (NAME, CITY)	SAFETY EQUIPMENT USED	<input type="checkbox"/> DOT-COMPLIANT MC HELMET	SEATING POSITION	AIR BAG USAGE	EJECTION	TRAPPED
OL STATE	OPERATOR LICENSE NUMBER	OFFENSE CHARGED	LOCAL CODE <input type="checkbox"/>	OFFENSE DESCRIPTION	CITATION NUMBER				
OL CLASS	ENDORSEMENT SELECT UP TO 2	RESTRICTION SELECT UP TO 3	DRIVER DISTRACTED BY	ALCOHOL / DRUG SUSPECTED <input type="checkbox"/> ALCOHOL <input type="checkbox"/> MARIJUANA <input type="checkbox"/> OTHER DRUG	CONDITION	ALCOHOL TEST STATUS TYPE VALUE			DRUG TEST(S) STATUS TYPE RESULT SELECT UP TO 4

INJURIES	SEATING POSITION	AIR BAG	OL CLASS	OL RESTRICTION(S)	DRIVER DISTRACTION	TEST STATUS
1-FATAL	1-FRONT-LEFT SIDE (MOTORCYCLE DRIVER)	1-NOT DEPLOYED	1-CLASS A	1-ALCOHOL INTERLOCK DEVICE	1-NOT DISTRACTED	1-NONE GIVEN
2-SUSPECTED SERIOUS INJURY	2-FRONT-MIDDLE	2-DEPLOYED FRONT	2-CLASS B	2-COL INTRASTATE ONLY	2-MANUALLY OPERATING AN ELECTRONIC COMMUNICATION DEVICE (TEXTING, TYPING, DIALING)	2-TEST REFUSED
3-SUSPECTED MINOR INJURY	3-FRONT-RIGHT SIDE	3-DEPLOYED SIDE	3-CLASS C	3-CORRECTIVE LENSES	3-TALKING ON HANDS-FREE COMMUNICATION DEVICE	3-TEST GIVEN, CONTAMINATED SAMPLE / UNUSABLE
4-POSSIBLE INJURY	4-SECOND-LEFT SIDE (MOTORCYCLE PASSENGER)	4-DEPLOYED BOTH FRONT / SIDE	4-REGULAR CLASS (OHIO = D)	4-FARM WAIVER	4-TALKING ON HAND-HELD COMMUNICATION DEVICE	4-TEST GIVEN, RESULTS KNOWN
5-NO APPARENT INJURY	5-SECOND-MIDDLE	5-NOT APPLICABLE	5-M/C MOPED ONLY	5-EXCEPT CLASS A BUS & CLASS B BUS	5-OTHER ACTIVITY WITH AN ELECTRONIC DEVICE	5-TEST GIVEN, RESULTS UNKNOWN
<b>INJURED TAKEN BY</b>	6-SECOND-RIGHT SIDE	9-DEPLOYMENT UNKNOWN	6-NO VALID OL	7-EXCEPT TRACTOR-TRAILER	6-PASSENGER	<b>ALCOHOL TEST TYPE</b>
1-NOT TRANSPORTED / TREATED AT SCENE	7-THIRD-LEFT SIDE (MOTORCYCLE SIDE CAR)	<b>EJECTION</b>	<b>OL ENDORSEMENT</b>	8-INTERMEDIATE LICENSE RESTRICTIONS	7-OTHER DISTRACTION INSIDE THE VEHICLE	1-NONE
2-EMS	8-THIRD-MIDDLE	1-NOT EJECTED	H-HAZMAT	9-LEARNER'S PERMIT RESTRICTIONS	8-OTHER DISTRACTION OUTSIDE THE VEHICLE	2-BLOOD
3-POLICE	9-THIRD-RIGHT SIDE	2-PARTIALLY EJECTED	M-MOTORCYCLE	10-LIMITED TO DAYLIGHT ONLY	9-OTHER / UNKNOWN	3-URINE
9-OTHER / UNKNOWN	10-SLEEPER SECTION OF TRUCK CAB	3-TOTALLY EJECTED	P-PASSENGER	11-LIMITED TO EMPLOYMENT	<b>CONDITION</b>	4-BREATH
<b>SAFETY EQUIPMENT</b>	<b>TRAPPED</b>	4-NOT APPLICABLE	N-TANKER	12-LIMITED-OTHER	1-APPARENTLY NORMAL	5-OTHER
1-NONE USED	1-NOT TRAPPED	<b>TRAPPED</b>	Q-MOTOR SCOOTER	13-MECHANICAL DEVICES (SPECIAL BRAKES, HAND CONTROLS, OR OTHER ADAPTIVE DEVICES)	2-PHYSICAL IMPAIRMENT	<b>DRUG TEST TYPE</b>
2-SHOULDER BELT ONLY USED	2-EXTRICATED BY MECHANICAL MEANS	1-NOT TRAPPED	R-THREE-WHEEL MOTORCYCLE	14-MILITARY VEHICLES ONLY	3-EMOTIONAL (E.G. DEPRESSED, ANGRY, DISTURBED)	1-NONE
3-LAP BELT ONLY USED	3-FREED BY NON-MECHANICAL MEANS	2-EXTRICATED BY MECHANICAL MEANS	S-SCHOOL BUS	15-MOTOR VEHICLES WITHOUT AIR BRAKES	4-ILLNESS	2-BLOOD
4-SHOULDER & LAP BELT USED		3-FREED BY NON-MECHANICAL MEANS	T-DOUBLE & TRIPLE TRAILERS	16-OUTSIDE MIRROR	5-FELL ASLEEP, FAINTED, FATIGUED, ETC.	3-URINE
5-CHILD RESTRAINT SYSTEM - FORWARD FACING			X-TANKER / HAZMAT	17-PROSTHETIC AID	6-UNDER THE INFLUENCE OF MEDICATIONS / DRUGS / ALCOHOL	4-OTHER
6-CHILD RESTRAINT SYSTEM - REAR FACING			<b>GENDER</b>	18-OTHER	9-OTHER / UNKNOWN	<b>DRUG TEST RESULT(S)</b>
7-BOOSTER SEAT			F-FEMALE			1-AMPHETAMINES
8-HELMET USED			M-MALE			2-BARBITURATES
9-PROTECTIVE PADS USED (ELBOW, KNEES, ETC.)			U-OTHER / UNKNOWN			3-BENZODIAZEPINES
10-REFLECTIVE CLOTHING						4-CANNABINOIDS
11-LIGHTING - PEDESTRIAN / BICYCLE ONLY						5-COCAINE
99-OTHER / UNKNOWN						6-OPiates / OPIOIDS
						7-OTHER
						8-NEGATIVE RESULTS

LOCAL REPORT NUMBER <b>PD23012056</b>	REPORTING AGENCY <b>Fairfield Police Department</b>	DATE OF ACCIDENT <b>2/15/23</b>
--	--	------------------------------------

IN COUNTY OF <b>Butler</b>	ACCIDENT LOCATION <b>South Gilmore Road and Planet Drive</b>
-------------------------------	---

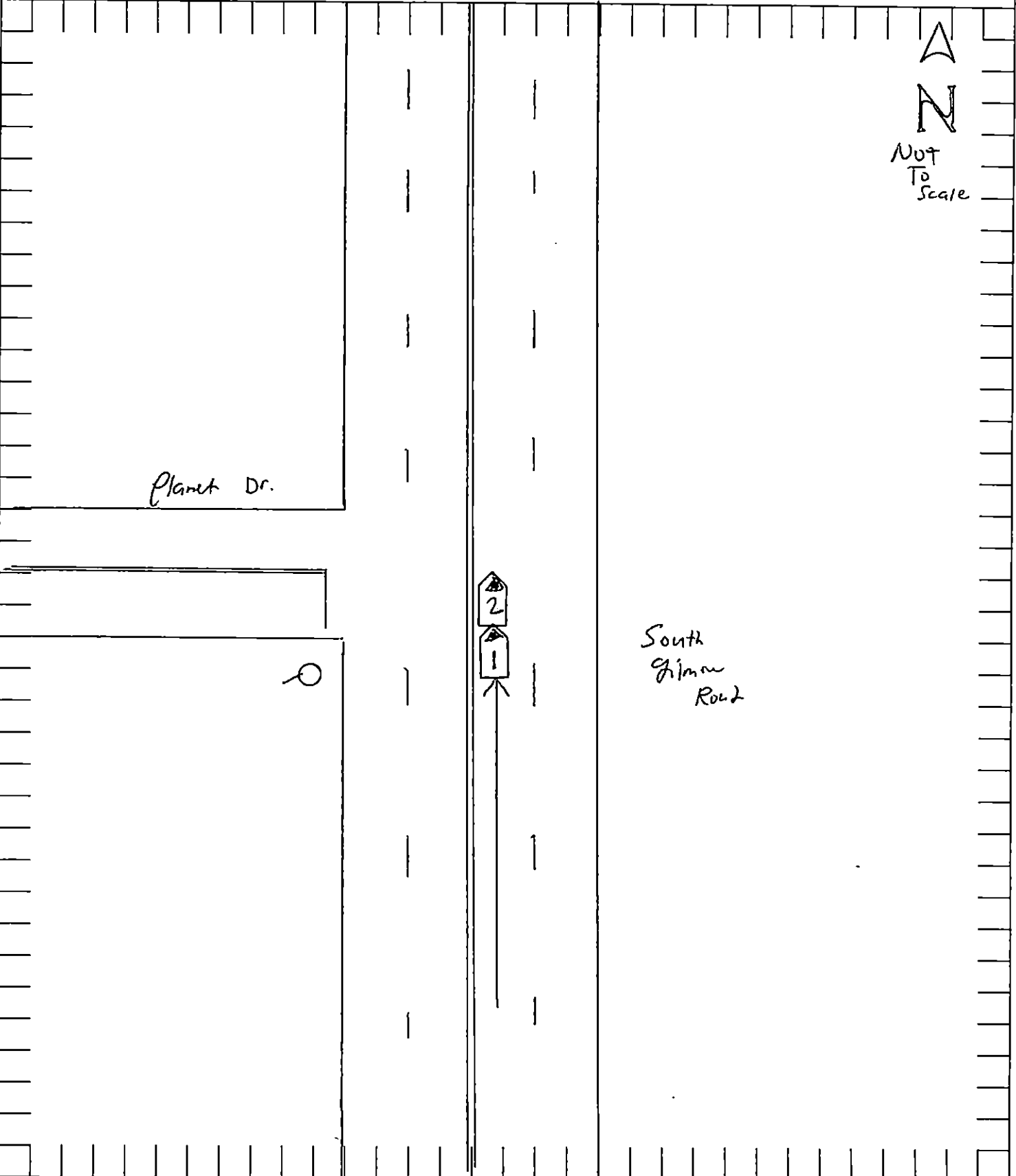

OFFICER'S SIGNATURE <b>C. Frazier</b>	BADGE NO. <b>158</b>
--	-------------------------