

<input checked="" type="checkbox"/> PHOTOS TAKEN	<input checked="" type="checkbox"/> OH-2	<input checked="" type="checkbox"/> OH-3	LOCAL INFORMATION	2, 3, 0, 1, 7, 7, 1, 5			
<input type="checkbox"/> SECONDARY CRASH	<input checked="" type="checkbox"/> OH-1P	<input type="checkbox"/> OTHER	REPORTING AGENCY NAME*	NCIC*	HIT/SKIP 1-SOLVED 2-UNSOLVED	NUMBER OF UNITS 0, 2	UNIT IN ERROR 98-ANIMAL 99-UNKNOWN
	<input type="checkbox"/> PRIVATE PROPERTY		Fairfield Police Department	0, 0, 9, 0, 1			0, 1

COUNTY* 0, 9	LOCALITY* 1-CITY 2-VILLAGE 3-TOWNSHIP	LOCATION: CITY, VILLAGE, TOWNSHIP* City of Fairfield	CRASH DATE / TIME* 03, 07, 20, 23, 18, 00	CRASH SEVERITY 1-FATAL 2-SERIOUS INJURY SUSPECTED 3-MINOR INJURY SUSPECTED 4-INJURY POSSIBLE 5-PROPERTY DAMAGE ONLY
-----------------	------------------------------------------------	---------------------------------------------------------	----------------------------------------------	------------------------------------------------------------------------------------------------------------------------------------

ROUTE TYPE	ROUTE NUMBER	PREFIX 1-NORTH 2-SOUTH 3-EAST 4-WEST	LOCATION ROAD NAME Nilles	ROAD TYPE R, D	LATITUDE DECIMAL DEGREES 39, 0, 3, 3, 6, 6, 4, 5
ROUTE TYPE	ROUTE NUMBER	PREFIX 1-NORTH 2-SOUTH 3-EAST 4-WEST	REFERENCE ROAD NAME (ROAD, MILEPOST, HOUSE #) 1111	ROAD TYPE	LONGITUDE DECIMAL DEGREES 84, 5, 4, 2, 2, 7, 3

REFERENCE POINT 1-INTERSECTION 2-MILE POST 3-HOUSE # 3	DIRECTION FROM REFERENCE 1-NORTH 2-SOUTH 3-EAST 4-WEST	ROUTE TYPE IR-INTERSTATE ROUTE (ITP) US-FEDERAL US ROUTE SR-STATE ROUTE CR-NUMBERED COUNTY ROUTE TR-NUMBERED TOWNSHIP ROUTE	ROAD TYPE AL-ALLEY AV-AVENUE BL-BOULEVARD CR-CIRCLE CT-COURT DR-DRIVE HE-HEIGHTS HW-HIGHWAY LA-LANE LA-MILEPOST MP-MILEPOST OV-OVAL PK-PARKWAY PL-PIKE PL-PLACE RD-ROAD SQ-SQUARE ST-STREET TE-TERRACE TR-TRAIL WA-WAY	INTERSECTION RELATED <input checked="" type="checkbox"/> WITHIN INTERSECTION OR ON APPROACH <input type="checkbox"/> WITHIN INTERCHANGE AREA NUMBER OF APPROACHES 4
DISTANCE FROM REFERENCE	DISTANCE UNIT OF MEASURE 1-MILES 2- FEET 3-YARDS			ROADWAY <input type="checkbox"/> ROADWAY DIVIDED

LOCATION OF FIRST HARMFUL EVENT 1-ON ROADWAY 2-ON SHOULDER 3-IN MEDIAN 4-ON ROADSIDE 5-ON GORE 6-OUTSIDE TRAFFIC WAY 7-ON RAMP 8-OFF RAMP 0, 1	9-CROSSOVER 10-DRIVEWAY/ALLEY ACCESS 11-RAILWAY GRADE CROSSING 12-SHARED USE PATHS OR TRAILS 13-BIKE LANE 14-TOLL BOOTH 99-OTHER / UNKNOWN	MANNER OF CRASH COLLISION/IMPACT 1-NOT COLLISION BETWEEN TWO MOTOR VEHICLES IN TRANSPORT 2-REAR-END 3-HEAD-ON 4-REAR-TO-REAR 5-BACKING 6-ANGLE 7-SIDESWIPE, SAME DIRECTION 8-SIDESWIPE, OPPOSITE DIRECTION 9-OTHER / UNKNOWN 6	DIRECTION OF TRAVEL 1-NORTH 2-SOUTH 3-EAST 4-WEST	MEDIAN TYPE 1-DIVIDED FLUSH MEDIAN (<4 FEET) 2-DIVIDED FLUSH MEDIAN (≥4 FEET) 3-DIVIDED, DEPRESSED MEDIAN 4-DIVIDED, RAISED MEDIAN (ANY TYPE) 9-OTHER/UNKNOWN
---------------------------------------------------------------------------------------------------------------------------------------------------------------------------	--------------------------------------------------------------------------------------------------------------------------------------------------------------	--------------------------------------------------------------------------------------------------------------------------------------------------------------------------------------------------------------------------------------------------------------	---------------------------------------------------------------	------------------------------------------------------------------------------------------------------------------------------------------------------------------------------

<input type="checkbox"/> WORK ZONE RELATED <input type="checkbox"/> WORKERS PRESENT <input type="checkbox"/> LAW ENFORCEMENT PRESENT <input type="checkbox"/> ACTIVE SCHOOL ZONE	WORK ZONE TYPE 1-LANE CLOSURE 2-LANE SHIFT/CROSSOVER 3-WORK ON SHOULDER OR MEDIAN 4-INTERMITTENT OR MOVING WORK 5-OTHER	LOCATION OF CRASH IN WORK ZONE 1-BEFORE THE 1ST WORK ZONE WARNING SIGN 2-ADVANCE WARNING AREA 3-TRANSITION AREA 4-ACTIVITY AREA 5-TERMINATION AREA	CONTOUR 1 1-STRAIGHT LEVEL 2-STRAIGHT GRADE 3-CURVE LEVEL 4-CURVE GRADE 9-OTHER/UNKNOWN	CONDITIONS 1 1-DRY 2-WET 3-SNOW 4-ICE 5-SAND, MUD, DIRT, OIL, GRAVEL 6-WATER (STANDING, MOVING) 7-SLUSH 9-OTHER/UNKNOWN	SURFACE 2 1-CONCRETE 2-BLACKTOP, BITUMINOUS, ASPHALT 3-BRICK/BLOCK 4-SLAG, GRAVEL, STONE 5-DIRT 9-OTHER/UNKNOWN
-------------------------------------------------------------------------------------------------------------------------------------------------------------------------------------------	----------------------------------------------------------------------------------------------------------------------------------------	-------------------------------------------------------------------------------------------------------------------------------------------------------------------	-----------------------------------------------------------------------------------------------------------	----------------------------------------------------------------------------------------------------------------------------------------------------	--------------------------------------------------------------------------------------------------------------------------------------

LIGHT CONDITION 1-DAYLIGHT 2-DAWN/DUSK 3-DARK - LIGHTED ROADWAY 4-DARK - ROADWAY NOT LIGHTED 5-DARK - UNKNOWN ROADWAY LIGHTING 9-OTHER / UNKNOWN 1	WEATHER 1-CLEAR 2-CLOUDY 3-FOG, SMOG, SMOKE 4-RAIN 5-SLEET, HAIL 6-SNOW 7-SEVERE CROSSWINDS 8-BLOWING SAND, SOIL, DIRT, SNOW 9-FREEZING RAIN OR FREEZING DRIZZLE 99-OTHER / UNKNOWN 0, 1
-------------------------------------------------------------------------------------------------------------------------------------------------------------------------	---------------------------------------------------------------------------------------------------------------------------------------------------------------------------------------------------------------------------

NARRATIVE On 3/7/23 at about 6:00 p.m. Unit 1 was traveling east on Nilles Rd. and when at 1111 failed to stop for the red light, striking Unit 2 which was entering Nilles Rd from this address.	SEE OH 2	Indicate the north direction with an "N" on the compass diagram.

CRASH REPORTED DATE / TIME 0, 3, 0, 7, 2, 0, 2, 3, 1, 8, 0, 0	DISPATCH DATE / TIME 0, 3, 0, 7, 2, 0, 2, 3, 1, 8, 0, 1	ARRIVAL DATE / TIME 0, 3, 0, 7, 2, 0, 2, 3, 1, 8, 0, 1	SCENE CLEARED DATE / TIME 0, 3, 0, 7, 2, 0, 2, 3, 1, 8, 2, 6	REPORT TAKEN BY <input checked="" type="checkbox"/> POLICE AGENCY <input type="checkbox"/> MOTORIST <input type="checkbox"/> SUPPLEMENT (CORRECTION OR ADDITION TO AN EXISTING REPORT SENT TO OOPS)
TOTAL TIME ROADWAY CLOSED 2, 5	OTHER INVESTIGATION TIME 0	TOTAL MINUTES 2, 5	OFFICER'S NAME* J. Sons OFFICER'S BADGE NUMBER* 1, 5, 0	CHECKED BY OFFICER'S NAME* Sgt. Aaron Meyer CHECKED BY OFFICER'S BADGE NUMBER* 1, 3, 2

OWNER

UNIT # 011 OWNER NAME: LAST, FIRST, MIDDLE (SAME AS DRIVER) OWNER PHONE: INCLUDE AREA CODE (SAME AS DRIVER)

OWNER ADDRESS: STREET, CITY, STATE, ZIP (SAME AS DRIVER)

COMMERCIAL CARRIER: NAME, ADDRESS, CITY, STATE, ZIP COMMERCIAL CARRIER PHONE: INCLUDE AREA CODE

DAMAGE

DAMAGE SCALE

1 - NONE 3 - FUNCTIONAL DAMAGE
 4 - MINOR DAMAGE 4 - DISABLING DAMAGE
 9 - UNKNOWN

LP STATE OH LICENSE PLATE # HXT8530 VEHICLE IDENTIFICATION # 2T3D1FR1E1V5G1W151317151216 VEHICLE YEAR 21016 VEHICLE MAKE Toyota

INSURANCE VERIFIED INSURANCE COMPANY Progressive INSURANCE POLICY # 904175978 COLOR Beige VEHICLE MODEL RAV4

DAMAGED AREA(S)
 INDICATE ALL THAT APPLY

TYPE OF USE: COMMERCIAL GOVERNMENT IN EMERGENCY RESPONSE

US DOT # _____ TOWED BY: COMPANY NAME FOX

HAZARDOUS MATERIAL: MATERIAL RELEASED PLACARD CLASS # _____ PLACARD ID # _____

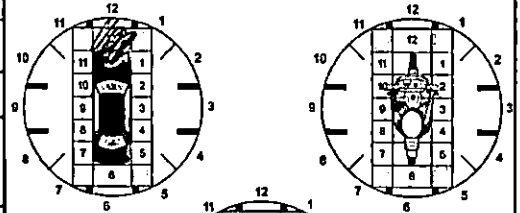

UNIT TYPE: 03

1 - PASSENGER CAR 7 - MOTORCYCLE 2-WHEELED 12 - GOLF CART 18 - LIMO (LIVERY VEHICLE) 23 - PEDESTRIAN / SKATER
 2 - PASSENGER VAN (MINIVAN) 8 - MOTORCYCLE 3-WHEELED 13 - SNOWMOBILE 19 - BUS (16+ PASSENGERS) 24 - WHEELCHAIR (ANY TYPE)
 3 - SPORT UTILITY VEHICLE 9 - AUTOCYCLE 14 - SINGLE UNIT TRUCK 20 - OTHER VEHICLE 25 - OTHER NON-MOTORIST
 4 - PICKUP 10 - MOPED OR MOTORIZED BICYCLE 15 - SEMI-TRACTOR 21 - HEAVY EQUIPMENT 26 - BICYCLE
 5 - CARGO VAN 11 - ALL TERRAIN VEHICLE (ATV/UTV) 16 - FARM EQUIPMENT 22 - ANIMAL WITH RIDER OR ANIMAL-DRAWN VEHICLE 27 - TRAIN
 6 - VAN (9-15 SEATS) 17 - MOTORHOME 99 - UNKNOWN OR HIT/SKIP

OF TRAILING UNITS 0

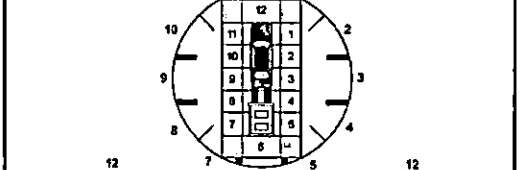

WAS VEHICLE OPERATING IN AUTONOMOUS MODE WHEN CRASH OCCURRED? 2

1 - YES 2 - NO 9 - OTHER / UNKNOWN

AUTONOMOUS MODE LEVEL: 0

0 - NO AUTOMATION 1 - DRIVER ASSISTANCE 2 - PARTIAL AUTOMATION 3 - CONDITIONAL AUTOMATION 4 - HIGH AUTOMATION 5 - FULL AUTOMATION 9 - UNKNOWN

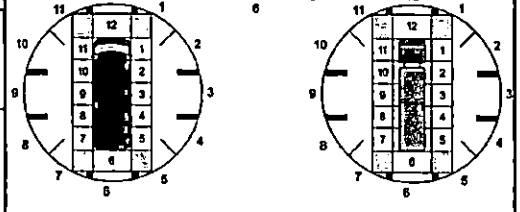

SPECIAL FUNCTION: 01

1 - NONE 2 - TAXI 3 - ELECTRONIC RIDE SHARING 4 - SCHOOL TRANSPORT 5 - BUS - TRANSIT/COMMUTER 6 - BUS - CHARTER/TOUR 7 - BUS - INTERCITY 8 - BUS - SHUTTLE 9 - BUS - OTHER 10 - AMBULANCE 11 - FIRE 12 - MILITARY 13 - POLICE 14 - PUBLIC UTILITY 15 - CONSTRUCTION EQUIPMENT 16 - FARM 17 - MOWING 18 - SNOW REMOVAL 19 - TOWING 20 - SAFETY SERVICE PATROL 21 - MAIL CARRIER 99 - OTHER / UNKNOWN

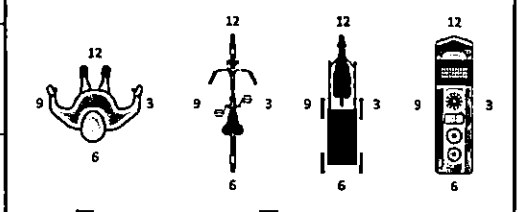

CARGO BODY TYPE: 01

1 - NO CARGO BODY TYPE / NOT APPLICABLE 2 - BUS 3 - VEHICLE TOWING ANOTHER MOTOR VEHICLE 4 - LOGGING 5 - INTERMODAL CONTAINER CHASSIS 6 - CARGO VAN/ENCLOSED BOX 7 - GRAINCHIPS/RAVEL 8 - POLE 9 - CARGO TANK 10 - FLAT BED 11 - DUMP 12 - CONCRETE MIXER 13 - AUTO TRANSPORTER 14 - GARBAGE/REFUSE 99 - OTHER / UNKNOWN

- NO DAMAGE [0] - UNDERCARRIAGE [14]
 - TOP [13] - ALL AREAS [15]
 - UNIT NOT AT SCENE [16]

VEHICLE DEFECTS: 01

1 - TURN SIGNALS 2 - HEAD LAMPS 3 - TAIL LAMPS 4 - BRAKES 5 - STEERING 6 - TIRE BLOWOUT 7 - WORN OR SLICK TIRES 8 - TRAILER EQUIPMENT DEFECTIVE 9 - MOTOR TROUBLE 10 - DISABLED FROM PRIOR ACCIDENT 99 - OTHER / UNKNOWN

NON-MOTORIST LOCATION AT IMPACT: 01

1 - INTERSECTION - MARKED CROSSWALK 2 - INTERSECTION - UNMARKED CROSSWALK 3 - INTERSECTION - OTHER 4 - MIDBLOCK - MARKED CROSSWALK 5 - TRAVEL LANE - OTHER LOCATION 6 - BICYCLE LANE 7 - SHOULDER / ROADSIDE 8 - SIDEWALK 9 - MEDIAN/CROSSING ISLAND 10 - DRIVEWAY ACCESS 11 - SHARED USE PATHS OR TRAILS 12 - FIRST RESPONDER AT INCIDENT SCENE 99 - OTHER / UNKNOWN

ACTION: 3

1 - NON-CONTACT 2 - NON-COLLISION 3 - STRIKING 4 - STRUCK 5 - BOTH STRIKING & STRUCK 9 - OTHER / UNKNOWN

PRE-CRASH ACTIONS: 01

1 - STRAIGHT AHEAD 2 - BACKING 3 - CHANGING LANES 4 - OVERTAKING/PASSING 5 - MAKING RIGHT TURN 6 - MAKING LEFT TURN 7 - MAKING U-TURN 8 - ENTERING TRAFFIC LANE 9 - LEAVING TRAFFIC LANE 10 - PARKED 11 - SLOWING OR STOPPED IN TRAFFIC 12 - DRIVERLESS 13 - NEGOTIATING A CURVE 14 - ENTERING OR CROSSING SPECIFIED LOCATION 15 - WALKING, RUNNING, JOGGING, PLAYING 16 - WORKING 17 - PUSHING VEHICLE 18 - APPROACHING OR LEAVING VEHICLE 19 - STANDING 20 - OTHER NON-MOTORIST 21 - STANDING OUTSIDE DISABLED VEHICLE 99 - OTHER / UNKNOWN

INITIAL POINT OF CONTACT

0 - NO DAMAGE 14 - UNDERCARRIAGE
 1-12 - REFER TO UNIT DIAGRAM 15 - VEHICLE NOT AT SCENE
 13 - TOP 99 - UNKNOWN

CONTRIBUTING CIRCUMSTANCES: 03

1 - NONE 2 - FAILURE TO YIELD 3 - RAN RED LIGHT 4 - RAN STOP SIGN 5 - UNSAFE SPEED 6 - IMPROPER TURN 7 - LEFT OF CENTER 8 - FOLLOWING TOO CLOSE / ACDA 9 - IMPROPER LANE CHANGE 10 - IMPROPER PASSING 11 - DROVE OFF ROAD 12 - IMPROPER BACKING 13 - IMPROPER START FROM A PARKED POSITION 14 - STOPPED OR PARKED ILLEGALLY 15 - SWERVING TO AVOID 16 - WRONG WAY 17 - VISION OBSTRUCTION 18 - OPERATING DEFECTIVE EQUIPMENT 19 - LOAD SHIFTING/FALLING/SPILLING 20 - IMPROPER CROSSING 21 - LYING IN ROADWAY 22 - NOT DISCERNIBLE 23 - OPENING DOOR INTO ROADWAY 99 - OTHER IMPROPER ACTION

TRAFFIC

TRAFFICWAY FLOW: 2

1 - ONE-WAY 2 - TWO-WAY

TRAFFIC CONTROL: 2

1 - ROUNDABOUT 2 - SIGNAL 3 - FLASHER 4 - STOP SIGN 5 - YIELD SIGN 6 - NO CONTROL

SEQUENCE OF EVENTS

1 20

1 - OVERTURN/ROLLOVER 2 - FIRE/EXPLOSION 3 - IMMERSION 4 - JACKKNIFE 5 - CARGO / EQUIPMENT LOSS OR SHIFT 6 - EQUIPMENT FAILURE 7 - SEPARATION OF UNITS 8 - RAN OFF ROAD RIGHT 9 - RAN OFF ROAD LEFT 10 - CROSS MEDIAN 11 - CROSS CENTERLINE - OPPOSITE DIRECTION OF TRAVEL 12 - DOWNHILL RUNAWAY 13 - OTHER NON-COLLISION 14 - PEDESTRIAN 15 - PEDALCYCLE 16 - RAILWAY VEHICLE 17 - ANIMAL - FARM 18 - ANIMAL - DEER 19 - ANIMAL - OTHER 20 - MOTOR VEHICLE IN TRANSPORT 21 - PARKED MOTOR VEHICLE 22 - WORK ZONE MAINTENANCE EQUIPMENT 23 - STRUCK BY FALLING, SHIFTING CARGO OR ANYTHING SET IN MOTION BY A MOTOR VEHICLE 24 - OTHER MOVABLE OBJECT

OF THROUGH LANES ON ROAD: 4

RAIL GRADE CROSSING: 1

1 - NOT INVOLVED 2 - INVOLVED-ACTIVE CROSSING 3 - INVOLVED-PASSIVE CROSSING

COLLISION WITH FIXED OBJECT: STRUCK

25 - IMPACT ATTENUATOR / CRASH CUSHION 26 - BRIDGE OVERHEAD STRUCTURE 27 - BRIDGE PIER OR ABUTMENT 28 - BRIDGE PARAPET 29 - BRIDGE RAIL 30 - GUARDRAIL FACE 31 - GUARDRAIL END 32 - PORTABLE BARRIER 33 - MEDIAN CABLE BARRIER 34 - MEDIAN GUARDRAIL BARRIER 35 - MEDIAN CONCRETE BARRIER 36 - MEDIAN OTHER BARRIER 37 - TRAFFIC SIGN POST 38 - OVERHEAD SIGN POST 39 - LIGHT / LUMINARIES SUPPORT 40 - UTILITY POLE 41 - OTHER POST, POLE OR SUPPORT 42 - CULVERT 43 - CURB 44 - DITCH 45 - EMBANKMENT 46 - FENCE 47 - MAILBOX 48 - TREE 49 - FIRE HYDRANT 50 - WORK ZONE MAINTENANCE EQUIPMENT 51 - WALL 52 - BUILDING 53 - TUNNEL 54 - OTHER FIXED OBJECT 99 - OTHER / UNKNOWN

FIRST HARMFUL EVENT: 1 MOST HARMFUL EVENT: 1

UNIT / NON-MOTORIST DIRECTION

FROM 4 TO 3

1 - NORTH 2 - SOUTH 3 - EAST 4 - WEST 5 - NORTHEAST 6 - NORTHWEST 7 - SOUTHEAST 8 - SOUTHWEST 9 - OTHER / UNKNOWN

UNIT SPEED: 30

POSTED SPEED: 35

DETECTED SPEED: 1

1 - STATED / ESTIMATED SPEED 2 - CALCULATED / EDR 3 - UNDETERMINED

OWNER

UNIT # 012 OWNER NAME: LAST, FIRST, MIDDLE (☒ SAME AS DRIVER)
 OWNER PHONE: INCLUDE AREA CODE (☒ SAME AS DRIVER)

OWNER ADDRESS: STREET, CITY, STATE, ZIP (☒ SAME AS DRIVER)

COMMERCIAL CARRIER: NAME, ADDRESS, CITY, STATE, ZIP
 COMMERCIAL CARRIER PHONE: INCLUDE AREA CODE

DAMAGE

DAMAGE SCALE

4 1 - NONE 3 - FUNCTIONAL DAMAGE
 2 - MINOR DAMAGE 4 - DISABLING DAMAGE
 9 - UNKNOWN

VEHICLE

LP STATE OH LICENSE PLATE # JKA7993 VEHICLE IDENTIFICATION # 1GNKRJE14B1J137253 VEHICLE YEAR 2011 VEHICLE MAKE Chevy

INSURANCE VERIFIED INSURANCE COMPANY Nationwide INSURANCE POLICY # 9234J074806 COLOR Orange VEHICLE MODEL Traverse

DAMAGED AREA(S)
 INDICATE ALL THAT APPLY

TYPE OF USE: COMMERCIAL GOVERNMENT IN EMERGENCY RESPONSE

US DOT # _____ TOWED BY: COMPANY NAME Waynes

HAZARDOUS MATERIAL: MATERIAL RELEASED PLACARD

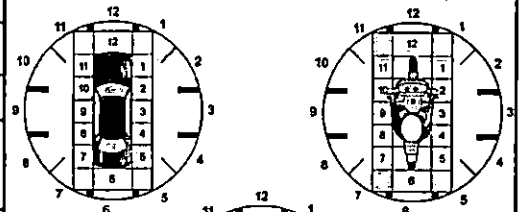

UNIT TYPE: 03

1 - PASSENGER CAR 7 - MOTORCYCLE 2-WHEELED 12 - GOLF CART 18 - LIMO (LIVERY VEHICLE) 23 - PEDESTRIAN / SKATER
 2 - PASSENGER VAN (MINIVAN) 8 - MOTORCYCLE 3-WHEELED 13 - SNOWMOBILE 19 - BUS (16+ PASSENGERS) 24 - WHEELCHAIR (ANY TYPE)
 3 - SPORT UTILITY VEHICLE 9 - AUTOCYCLE 14 - SINGLE UNIT TRUCK 20 - OTHER VEHICLE 25 - OTHER NON-MOTORIST
 4 - PICK UP 10 - MOPED OR MOTORIZED BICYCLE 15 - SEMI-TRACTOR 21 - HEAVY EQUIPMENT 26 - BICYCLE
 5 - CARGO VAN 11 - ALL TERRAIN VEHICLE (ATV/UTV) 16 - FARM EQUIPMENT 22 - ANIMAL WITH RIDER OR ANIMAL-DRAWN VEHICLE 27 - TRAIN
 6 - VAN (9-15 SEATS) 17 - MOTORHOME 99 - UNKNOWN OR HIT/SKIP

of TRAILING UNITS 0

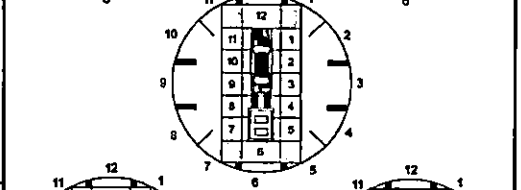

WAS VEHICLE OPERATING IN AUTONOMOUS MODE WHEN CRASH OCCURRED? 2

1 - YES 2 - NO 9 - OTHER / UNKNOWN

AUTONOMOUS MODE LEVEL: 0

0 - NO AUTOMATION 3 - CONDITIONAL AUTOMATION 9 - UNKNOWN
 1 - DRIVER ASSISTANCE 4 - HIGH AUTOMATION
 2 - PARTIAL AUTOMATION 5 - FULL AUTOMATION

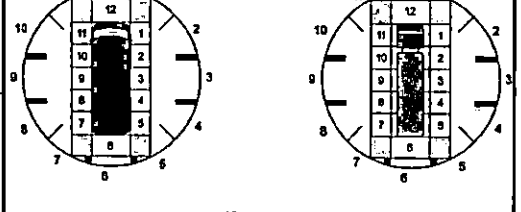

SPECIAL FUNCTION: 01

1 - NONE 6 - BUS - CHARTER/TOUR 11 - FIRE 16 - FARM 21 - MAIL CARRIER
 2 - TAXI 7 - BUS - INTERCITY 12 - MILITARY 17 - MOWING 99 - OTHER / UNKNOWN
 3 - ELECTRONIC RIDE SHARING 8 - BUS - SHUTTLE 13 - POLICE 18 - SNOW REMOVAL
 4 - SCHOOL TRANSPORT 9 - BUS - OTHER 14 - PUBLIC UTILITY 19 - TOWING
 5 - BUS - TRANSIT/COMMUTER 10 - AMBULANCE 15 - CONSTRUCTION EQUIPMENT 20 - SAFETY SERVICE PATROL

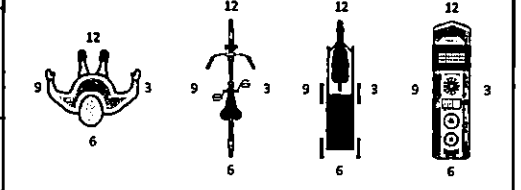

CARGO BODY TYPE: 01

1 - NO CARGO BODY TYPE / NOT APPLICABLE 3 - VEHICLE TOWING ANOTHER MOTOR VEHICLE 5 - INTERMODAL CONTAINER CHASSIS 8 - POLE 12 - CONCRETE MIXER
 2 - BUS 4 - LOGGING 6 - CARGO VAN/ENCLOSED BOX 10 - FLAT BED 13 - AUTOTRANSPORTER
 7 - GRAIN/CHIPS/GRAVEL 11 - DUMP 14 - CARGO BAG/REFUSE 99 - OTHER / UNKNOWN

- NO DAMAGE [0] - UNDERCARRIAGE [14]
 - TOP [13] - ALL AREAS [15]
 - UNIT NOT AT SCENE [16]

VEHICLE DEFECTS: 1

1 - TURN SIGNALS 4 - BRAKES 7 - WORN OR SLICK TIRES 9 - MOTOR TROUBLE 99 - OTHER / UNKNOWN
 2 - HEAD LAMPS 5 - STEERING 8 - TRAILER EQUIPMENT DEFECTIVE 10 - DISABLED FROM PRIOR ACCIDENT
 3 - TAIL LAMPS 6 - TIRE BLOWOUT

NON-MOTORIST LOCATION AT IMPACT: 1

1 - INTERSECTION - MARKED CROSSWALK 3 - INTERSECTION - OTHER 6 - BICYCLE LANE 9 - MEDIAN/CROSSING ISLAND 12 - FIRST RESPONDER AT INCIDENT SCENE
 2 - INTERSECTION - UNMARKED CROSSWALK 4 - MIDDLEBLOCK - MARKED CROSSWALK 7 - SHOULDER / ROADSIDE 10 - DRIVEWAY ACCESS 14 - UNDERCARRIAGE
 5 - TRAVEL LANE - OTHER LOCATION 8 - SIDEWALK 11 - SHARED USE PATHS OR TRAILS 15 - VEHICLE NOT AT SCENE DIAGRAM 99 - OTHER / UNKNOWN

INITIAL POINT OF CONTACT

0 - NO DAMAGE 14 - UNDERCARRIAGE
10 1-12 - REFER TO UNIT DIAGRAM 15 - VEHICLE NOT AT SCENE
 13 - TOP 99 - UNKNOWN

ACTION: 4

1 - NON-CONTACT 1 - STRAIGHT AHEAD 7 - MAKING U-TURN 13 - NEGOTIATING A CURVE 18 - APPROACHING OR LEAVING VEHICLE
 2 - NON-COLLISION 2 - BACKING 8 - ENTERING TRAFFIC LANE 14 - ENTERING OR CROSSING SPECIFIED LOCATION 19 - STANDING
 3 - STRIKING 06 3 - CHANGING LANES 9 - LEAVING TRAFFIC LANE 15 - WALKING, RUNNING, JOGGING, PLAYING 20 - OTHER NON-MOTORIST
 4 - STRUCK PRE-CRASH ACTIONS 4 - OVERTAKING/PASSING 10 - PARKED 16 - WORKING 21 - STANDING OUTSIDE DISABLED VEHICLE
 5 - BOTH STRIKING & STRUCK 5 - MAKING RIGHT TURN 11 - SLOWING OR STOPPED IN TRAFFIC 17 - PUSHING VEHICLE 99 - OTHER / UNKNOWN
 9 - OTHER / UNKNOWN 6 - MAKING LEFT TURN 12 - DRIVERLESS

CONTRIBUTING CIRCUMSTANCES: 01

1 - NONE 7 - LEFT OF CENTER 13 - IMPROPER START FROM A PARKED POSITION 17 - VISION OBSTRUCTION 21 - LYING IN ROADWAY
 2 - FAILURE TO YIELD 8 - FOLLOWING TOO CLOSE / ACCA 14 - STOPPED OR PARKED ILLEGALLY 18 - OPERATING DEFECTIVE EQUIPMENT 22 - NOT DISCERNIBLE
 3 - RAN RED LIGHT 9 - IMPROPER LANE CHANGE 15 - SWERVING TO AVOID 19 - LOAD SHIFTING/FALLING/SPILLING 23 - OPENING DOOR INTO ROADWAY
 4 - RAN STOP SIGN 10 - IMPROPER PASSING 16 - WRONG WAY 20 - IMPROPER CROSSING 99 - OTHER IMPROPER ACTION
 5 - UNSAFE SPEED 11 - DROVE OFF ROAD
 6 - IMPROPER TURN 12 - IMPROPER BACKING

TRAFFIC

TRAFFICWAY FLOW: 2

1 - ONE-WAY 2 - TWO-WAY

TRAFFIC CONTROL: 2

1 - ROUNDABOUT 4 - STOP SIGN
 2 - SIGNAL 5 - YIELD SIGN
 3 - FLASHER 6 - NO CONTROL

SEQUENCE OF EVENTS: 120

1 - OVERTURN/ROLLOVER 6 - EQUIPMENT FAILURE 11 - CROSS CENTERLINE - OPPOSITE DIRECTION OF TRAVEL 16 - RAILWAY VEHICLE 22 - WORK ZONE MAINTENANCE EQUIPMENT
 2 - FIRE/EXPLOSION 7 - SEPARATION OF UNITS 12 - DOWNHILL RUNAWAY 17 - ANIMAL - FARM 18 - ANIMAL - DEER 23 - STRUCK BY FALLING, SHIFTING CARGO OR ANYTHING SET IN MOTION BY A MOTOR VEHICLE
 3 - IMMERSION 8 - RAN OFF ROAD RIGHT 13 - OTHER NON-COLLISION 19 - ANIMAL - OTHER 20 - MOTOR VEHICLE IN TRANSPORT 24 - OTHER MOVABLE OBJECT
 4 - JACKKNIFE 9 - RAN OFF ROAD LEFT 14 - PEDESTRIAN 21 - PARKED MOTOR VEHICLE
 5 - CARGO/EQUIPMENT LOSS OR SHIFT 10 - CROSS MEDIAN 15 - PEDALCYCLE

OF THROUGH LANES ON ROAD: 4

RAIL GRADE CROSSING: 1

1 - NOT INVOLVED
 2 - INVOLVED-ACTIVE CROSSING
 3 - INVOLVED-PASSIVE CROSSING

COLLISION WITH FIXED OBJECT STRUCK

25 - IMPACT ATTENUATOR 31 - GUARDRAIL END 37 - TRAFFIC SIGN POST 43 - CURB 50 - WORK ZONE MAINTENANCE EQUIPMENT
 1 - CRASH CUSHION 32 - PORTABLE BARRIER 38 - OVERHEAD SIGN POST 44 - DITCH 51 - WALL
 26 - BRIDGE OVERHEAD STRUCTURE 33 - MEDIAN CABLE BARRIER 39 - LIGHT / LUMINARIES SUPPORT 45 - EMBANKMENT 52 - BUILDING
 27 - BRIDGE PIER OR ABUTMENT 34 - MEDIAN GUARDRAIL BARRIER 40 - UTILITY POLE 46 - FENCE 53 - TUNNEL
 28 - BRIDGE PARAPET 35 - MEDIAN CONCRETE BARRIER 41 - OTHER POST, POLE OR SUPPORT 47 - MAILBOX 54 - OTHER FIXED OBJECT
 29 - BRIDGE RAIL 36 - MEDIAN OTHER BARRIER 42 - CULVERT 48 - TREE 99 - OTHER / UNKNOWN
 30 - GUARDRAIL FACE

UNIT / NON-MOTORIST DIRECTION

FROM 2 TO 4

1 - NORTH 5 - NORTHEAST
 2 - SOUTH 6 - NORTHWEST
 3 - EAST 7 - SOUTHEAST
 4 - WEST 8 - SOUTHWEST
 9 - OTHER / UNKNOWN

FIRST HARMFUL EVENT: 1 MOST HARMFUL EVENT: 1

UNIT SPEED: 10

POSTED SPEED: 35

DETECTED SPEED: 1

1 - STATED / ESTIMATED SPEED
 2 - CALCULATED / EDR
 3 - UNDETERMINED



MOTORIST / Non-MOTORIST

LOCAL REPORT NUMBER
2 3 0 1 7 7 1 5

UNIT # 0 1	NAME: LAST, FIRST, MIDDLE Rosa, Elva	DATE OF BIRTH 0 9 0 7 1 9 6 1	AGE 6 1	GENDER F
ADDRESS: STREET, CITY, STATE, ZIP 2877 Wilson Ave. Cincinnati Oh 45251		CONTACT PHONE - INCLUDE AREA CODE		

INJURIES 4	INJURED TAKEN BY 2	EMS AGENCY (NAME) Fairfield FD	INJURED TAKEN TO: MEDICAL FACILITY (NAME, CITY) Mercy Fairfield	SAFETY EQUIPMENT USED 0 4	DOT-COMPLIANT MC HELMET <input type="checkbox"/>	SEATING POSITION 0 1	AIR BAG USAGE 1	EJECTION 1	TRAPPED 1
OL STATE OH	OPERATOR LICENSE NUMBER	OFFENSE CHARGED 313.01a	LOCAL CODE <input checked="" type="checkbox"/>	OFFENSE DESCRIPTION Traffic Control	CITATION NUMBER 253941				
OL CLASS 4	ENDORSEMENT SELECT UP TO 2	RESTRICTION SELECT UP TO 3	DRIVER DISTRACTED BY	ALCOHOL / DRUG SUSPECTED <input type="checkbox"/> ALCOHOL <input type="checkbox"/> MARIJUANA <input type="checkbox"/> OTHER DRUG	CONDITION 1	ALCOHOL TEST STATUS TYPE VALUE 1 1		DRUG TEST(S) STATUS TYPE RESULT SELECT UP TO 4 1 1	

UNIT # 0 2	NAME: LAST, FIRST, MIDDLE St Clair, Amanda	DATE OF BIRTH 0 9 2 2 1 9 7 8	AGE 4 4	GENDER F
ADDRESS: STREET, CITY, STATE, ZIP 710 Walter Ave. Fairfield, Oh 45014		CONTACT PHONE - INCLUDE AREA CODE		

INJURIES 5	INJURED TAKEN BY	EMS AGENCY (NAME)	INJURED TAKEN TO: MEDICAL FACILITY (NAME, CITY)	SAFETY EQUIPMENT USED 0 4	DOT-COMPLIANT MC HELMET <input type="checkbox"/>	SEATING POSITION 0 1	AIR BAG USAGE 1	EJECTION 1	TRAPPED 1
OL STATE OH	OPERATOR LICENSE NUMBER	OFFENSE CHARGED	LOCAL CODE <input type="checkbox"/>	OFFENSE DESCRIPTION	CITATION NUMBER				
OL CLASS 4	ENDORSEMENT SELECT UP TO 2	RESTRICTION SELECT UP TO 3	DRIVER DISTRACTED BY 1	ALCOHOL / DRUG SUSPECTED <input type="checkbox"/> ALCOHOL <input type="checkbox"/> MARIJUANA <input type="checkbox"/> OTHER DRUG	CONDITION 1	ALCOHOL TEST STATUS TYPE VALUE 1 1		DRUG TEST(S) STATUS TYPE RESULT SELECT UP TO 4 1 1	

UNIT #	NAME: LAST, FIRST, MIDDLE	DATE OF BIRTH	AGE 0	GENDER
ADDRESS: STREET, CITY, STATE, ZIP		CONTACT PHONE - INCLUDE AREA CODE		

INJURIES	INJURED TAKEN BY	EMS AGENCY (NAME)	INJURED TAKEN TO: MEDICAL FACILITY (NAME, CITY)	SAFETY EQUIPMENT USED	DOT-COMPLIANT MC HELMET <input type="checkbox"/>	SEATING POSITION	AIR BAG USAGE	EJECTION	TRAPPED
OL STATE	OPERATOR LICENSE NUMBER	OFFENSE CHARGED	LOCAL CODE <input type="checkbox"/>	OFFENSE DESCRIPTION	CITATION NUMBER				
OL CLASS	ENDORSEMENT SELECT UP TO 2	RESTRICTION SELECT UP TO 3	DRIVER DISTRACTED BY	ALCOHOL / DRUG SUSPECTED <input type="checkbox"/> ALCOHOL <input type="checkbox"/> MARIJUANA <input type="checkbox"/> OTHER DRUG	CONDITION	ALCOHOL TEST STATUS TYPE VALUE		DRUG TEST(S) STATUS TYPE RESULT SELECT UP TO 4	

INJURIES	SEATING POSITION	AIR BAG	OL CLASS	OL RESTRICTION(S)	DRIVER DISTRACTION	TEST STATUS
1-FATAL 2-SUSPECTED SERIOUS INJURY 3-SUSPECTED MINOR INJURY 4-POSSIBLE INJURY 5-NO APPARENT INJURY	1-FRONT-LEFT SIDE (MOTORCYCLE DRIVER) 2-FRONT-MIDDLE 3-FRONT-RIGHT SIDE 4-SECOND-LEFT SIDE (MOTORCYCLE PASSENGER) 5-SECOND-MIDDLE 6-SECOND-RIGHT SIDE 7-THIRD-LEFT SIDE (MOTORCYCLE SIDE CAR) 8-THIRD-MIDDLE 9-THIRD-RIGHT SIDE 10-SLEEPER SECTION OF TRUCK CAB	1-NOT DEPLOYED 2-DEPLOYED FRONT 3-DEPLOYED SIDE 4-DEPLOYED BOTH FRONT/SIDE 5-NOT APPLICABLE 9-DEPLOYMENT UNKNOWN	1-CLASS A 2-CLASS B 3-CLASS C 4-REGULAR CLASS (OHIO = D) 5-MC MOPED ONLY 6-NO VALID OL	1-ALCOHOL INTERLOCK DEVICE 2-COL INTRASTATE ONLY 3-CORRECTIVE LENSES 4-FARM WAIVER 5-EXCEPT CLASS A BUS 6-EXCEPT CLASS A & CLASS B BUS 7-EXCEPT TRACTOR-TRAILER 8-INTERMEDIATE LICENSE RESTRICTIONS 9-LEARNER'S PERMIT RESTRICTIONS 10-LIMITED TO DAYLIGHT ONLY 11-LIMITED TO EMPLOYMENT 12-LIMITED-OTHER 13-MECHANICAL DEVICES (SPECIAL BRAKES, HAND CONTROLS, OR OTHER ADAPTIVE DEVICES) 14-MILITARY VEHICLES ONLY 15-MOTOR VEHICLES WITHOUT AIR BRAKES 16-OUTSIDE MIRROR 17-PROSTHETIC AID 18-OTHER	1-NOT DISTRACTED 2-MANUALLY OPERATING AN ELECTRONIC COMMUNICATION DEVICE (TEXTING, TYPING, DIALING) 3-TALKING ON HANDS-FREE COMMUNICATION DEVICE 4-TALKING ON HAND-HELD COMMUNICATION DEVICE 5-OTHER ACTIVITY WITH AN ELECTRONIC DEVICE 6-PASSENGER 7-OTHER DISTRACTION INSIDE THE VEHICLE 8-OTHER DISTRACTION OUTSIDE THE VEHICLE 9-OTHER/UNKNOWN	1-NONE GIVEN 2-TEST REFUSED 3-TEST GIVEN, CONTAMINATED SAMPLE / UNUSABLE 4-TEST GIVEN, RESULTS KNOWN 5-TEST GIVEN, RESULTS UNKNOWN
INJURED TAKEN BY	EJECTION	OL ENDORSEMENT	TRAPPED	CONDITION	ALCOHOL TEST TYPE	DRUG TEST TYPE
1-NOT TRANSPORTED / TREATED AT SCENE 2-EMS 3-POLICE 9-OTHER/UNKNOWN	1-NOT EJECTED 2-PARTIALLY EJECTED 3-TOTALLY EJECTED 4-NOT APPLICABLE	H-HAZMAT M-MOTORCYCLE P-PASSENGER N-TANKER Q-MOTOR SCOOTER R-THREE-WHEEL MOTORCYCLE S-SCHOOL BUS T-DOUBLE & TRIPLE TRAILERS X-TANKER/HAZMAT	1-NOT TRAPPED 2-EXTRICATED BY MECHANICAL MEANS 3-FREED BY NON-MECHANICAL MEANS	1-APPARENTLY NORMAL 2-PHYSICAL IMPAIRMENT 3-EMOTIONAL (E.G., DEPRESSED, ANGRY, DISTURBED) 4-ILLNESS 5-FELL ASLEEP, FAINTED, FATIGUED, ETC. 6-UNDER THE INFLUENCE OF MEDICATIONS / DRUGS / ALCOHOL 9-OTHER / UNKNOWN	1-NONE 2-BLOOD 3-URINE 4-BREATH 5-OTHER	1-NONE 2-BLOOD 3-URINE 4-OTHER
SAFETY EQUIPMENT	TRAPPED	CONDITION	DRUG TEST RESULT(S)			
1-NONE USED 2-SHOULDER BELT ONLY USED 3-LAP BELT ONLY USED 4-SHOULDER & LAP BELT USED 5-CHILD RESTRAINT SYSTEM - FORWARD FACING 6-CHILD RESTRAINT SYSTEM - REAR FACING 7-BOOSTER SEAT 8-HELMET USED 9-PROTECTIVE PADS USED (ELBOW, KNEES, ETC.) 10-REFLECTIVE CLOTHING 11-LIGHTING - PEDESTRIAN / BICYCLE ONLY 99-OTHER/UNKNOWN	1-NOT TRAPPED 2-EXTRICATED BY MECHANICAL MEANS 3-FREED BY NON-MECHANICAL MEANS	1-APPARENTLY NORMAL 2-PHYSICAL IMPAIRMENT 3-EMOTIONAL (E.G., DEPRESSED, ANGRY, DISTURBED) 4-ILLNESS 5-FELL ASLEEP, FAINTED, FATIGUED, ETC. 6-UNDER THE INFLUENCE OF MEDICATIONS / DRUGS / ALCOHOL 9-OTHER / UNKNOWN	1-AMPHETAMINES 2-BARBITURATES 3-BENZODIAZEPINES 4-CANNABINOIDS 5-COCAINE 6-OPiates / OPioids 7-OTHER 8-NEGATIVE RESULTS			



OCCUPANT / WITNESS ADDENDUM

LOCAL REPORT NUMBER
2 3 0 1 7 7 1 5

OCCUPANT	UNIT #	NAME: LAST, FIRST, MIDDLE				DATE OF BIRTH		AGE	GENDER	
	ADDRESS: STREET, CITY, STATE, ZIP					CONTACT PHONE - INCLUDE AREA CODE				
	INJURIES	INJURED TAKEN BY	EMS AGENCY (NAME)	INJURED TAKEN TO: MEDICAL FACILITY (NAME, CITY)	SAFETY EQUIPMENT USED	<input type="checkbox"/> DOT-COMPLIANT MC HELMET	SEATING POSITION	AIR BAG USAGE	EJECTION	TRAPPED
OCCUPANT	UNIT #	NAME: LAST, FIRST, MIDDLE				DATE OF BIRTH		AGE	GENDER	
	ADDRESS: STREET, CITY, STATE, ZIP					CONTACT PHONE - INCLUDE AREA CODE				
	INJURIES	INJURED TAKEN BY	EMS AGENCY (NAME)	INJURED TAKEN TO: MEDICAL FACILITY (NAME, CITY)	SAFETY EQUIPMENT USED	<input type="checkbox"/> DOT-COMPLIANT MC HELMET	SEATING POSITION	AIR BAG USAGE	EJECTION	TRAPPED
OCCUPANT	UNIT #	NAME: LAST, FIRST, MIDDLE				DATE OF BIRTH		AGE	GENDER	
	ADDRESS: STREET, CITY, STATE, ZIP					CONTACT PHONE - INCLUDE AREA CODE				
	INJURIES	INJURED TAKEN BY	EMS AGENCY (NAME)	INJURED TAKEN TO: MEDICAL FACILITY (NAME, CITY)	SAFETY EQUIPMENT USED	<input type="checkbox"/> DOT-COMPLIANT MC HELMET	SEATING POSITION	AIR BAG USAGE	EJECTION	TRAPPED
OCCUPANT	UNIT #	NAME: LAST, FIRST, MIDDLE				DATE OF BIRTH		AGE	GENDER	
	ADDRESS: STREET, CITY, STATE, ZIP					CONTACT PHONE - INCLUDE AREA CODE				
	INJURIES	INJURED TAKEN BY	EMS AGENCY (NAME)	INJURED TAKEN TO: MEDICAL FACILITY (NAME, CITY)	SAFETY EQUIPMENT USED	<input type="checkbox"/> DOT-COMPLIANT MC HELMET	SEATING POSITION	AIR BAG USAGE	EJECTION	TRAPPED

INJURIES	SAFETY EQUIPMENT USED	SEATING POSITION	AIR BAG USAGE
1 - FATAL	1 - NONE USED - VEHICLE OCCUPANT	1 - FRONT - LEFT SIDE (MOTORCYCLE DRIVER)	1 - NOT DEPLOYED
2 - SUSPECTED SERIOUS INJURY	2 - SHOULDER BELT ONLY USED	2 - FRONT - MIDDLE	2 - DEPLOYED FRONT
3 - SUSPECTED MINOR INJURY	3 - LAP BELT ONLY USED	3 - FRONT - RIGHT SIDE	3 - DEPLOYED SIDE
4 - POSSIBLE INJURY	4 - SHOULDER & LAP BELT USED	4 - SECOND - LEFT SIDE (MOTORCYCLE PASSENGER)	4 - DEPLOYED BOTH FRONT/SIDE
5 - NO APPARENT INJURY	5 - CHILD RESTRAINT SYSTEM - FORWARD FACING	5 - SECOND - MIDDLE	5 - NOT APPLICABLE
INJURED TAKEN BY		6 - SECOND - RIGHT SIDE	9 - DEPLOYMENT UNKNOWN
1 - NOT TRANSPORTED / TREATED AT SCENE	6 - CHILD RESTRAINT SYSTEM - REAR FACING	7 - THIRD - LEFT SIDE (MOTORCYCLE SIDE CAR)	EJECTION
2 - EMS	7 - BOOSTER SEAT	8 - THIRD - MIDDLE	1 - NOT EJECTED
3 - POLICE	8 - HELMET USED	9 - THIRD - RIGHT SIDE	2 - PARTIALLY EJECTED
9 - OTHER / UNKNOWN	9 - PROTECTIVE PADS USED (ELBOW, KNEES, ETC.)	10 - SLEEPER SECTION OF TRUCK CAB	3 - TOTALLY EJECTED
GENDER		11 - PASSENGER IN OTHER ENCLOSED CARGO AREA (NON-TRAILING UNIT, BUS, PICK-UP WITH CAP)	4 - NOT APPLICABLE
F - FEMALE	10 - REFLECTIVE CLOTHING	12 - PASSENGER IN UNENCLOSED CARGO AREA	TRAPPED
M - MALE	11 - LIGHTING - PEDESTRIAN / BICYCLE ONLY	13 - TRAILING UNIT	1 - NOT TRAPPED
U - OTHER / UNKNOWN	99 - OTHER / UNKNOWN	14 - RIDING ON VEHICLE EXTERIOR (NON-TRAILING UNIT)	2 - EXTRICATED BY MECHANICAL MEANS
		15 - NON-MOTORIST	3 - FREED BY NON-MECHANICAL MEANS
		99 - OTHER / UNKNOWN	

WITNESS	NAME: LAST, FIRST, MIDDLE	DATE OF BIRTH		AGE	GENDER	
	Flores, Tiffany	0 9 2 3 1 9 7 6		4 6	F	
ADDRESS: STREET, CITY, STATE, ZIP					CONTACT PHONE - INCLUDE AREA CODE	
5306 Chateau Way, Fairfield, Oh 45014						
WITNESS	NAME: LAST, FIRST, MIDDLE	DATE OF BIRTH		AGE	GENDER	
				0		
ADDRESS: STREET, CITY, STATE, ZIP					CONTACT PHONE - INCLUDE AREA CODE	
WITNESS	NAME: LAST, FIRST, MIDDLE	DATE OF BIRTH		AGE	GENDER	
				0		
ADDRESS: STREET, CITY, STATE, ZIP					CONTACT PHONE - INCLUDE AREA CODE	

LOCAL REPORT NUMBER 23-017715	REPORTING AGENCY Fairfield Police Department	DATE OF ACCIDENT 3-7-23
IN COUNTY OF Butler	ACCIDENT LOCATION Nilles // Wittenburg	

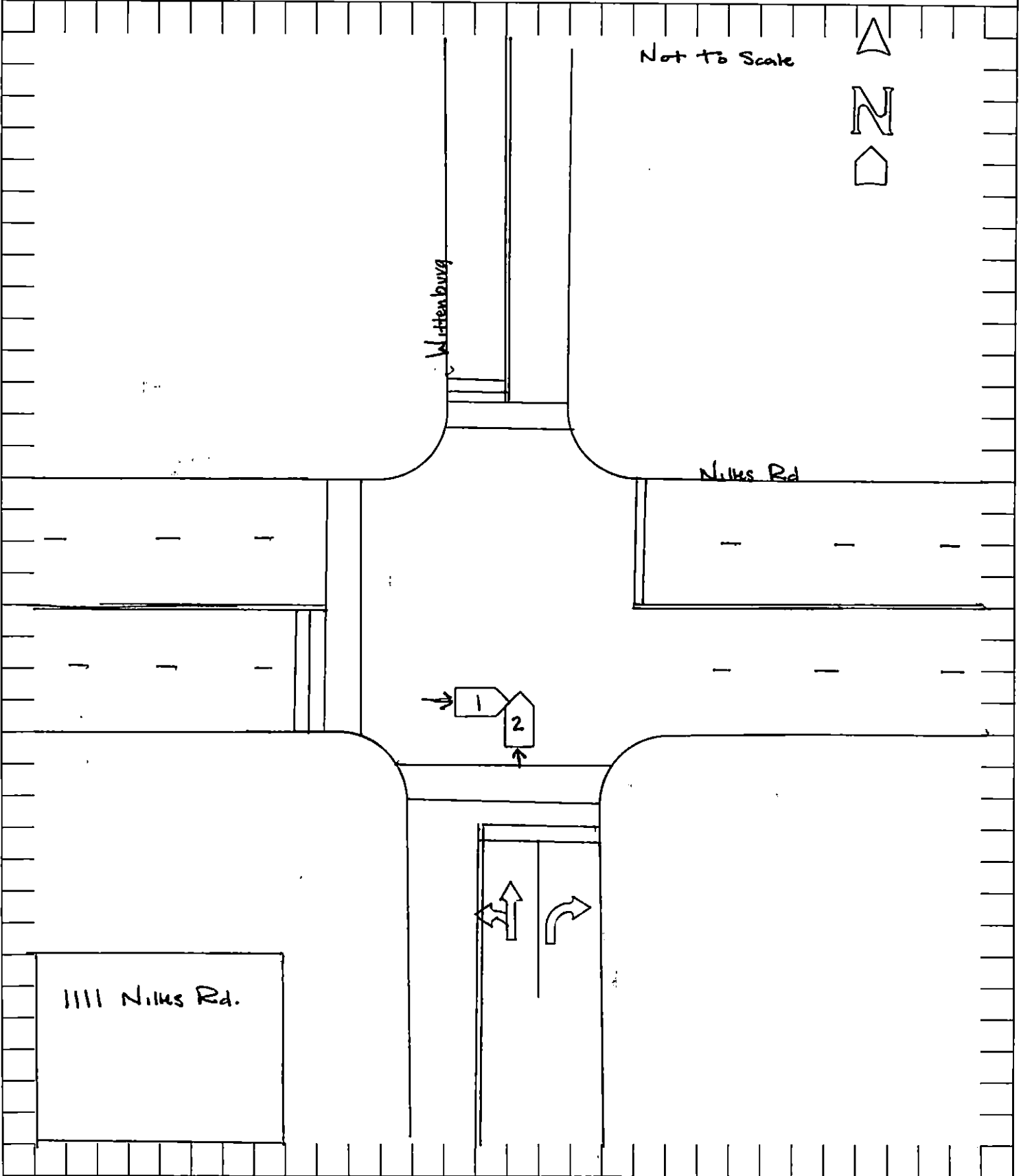

OFFICER'S SIGNATURE J. Sons	BADGE NO. 150
---------------------------------------	-------------------------