



TRAFFIC CRASH REPORT

*DENOTES MANDATORY FIELD FOR SUPPLEMENT REPORT

LOCAL REPORT NUMBER*

<input checked="" type="checkbox"/> PHOTOS TAKEN	<input type="checkbox"/> OH-2	<input type="checkbox"/> OH-3	LOCAL INFORMATION	2 3 0 2 2 6 3 5
<input type="checkbox"/> SECONDARY CRASH	<input type="checkbox"/> OH-1P	<input type="checkbox"/> OTHER	REPORTING AGENCY NAME*	NCIC*
<input type="checkbox"/> PRIVATE PROPERTY	Fairfield Police Department		0 0 9 0 1	HIT/SKIP 1 - SOLVED 2 - UNSOLVED
COUNTY* 0 9		LOCALITY* 1	LOCATION: CITY, VILLAGE, TOWNSHIP* City of Fairfield	NUMBER OF UNITS 0 1
ROUTE TYPE		PREFIX 1 - NORTH 2 - SOUTH 3 - EAST 4 - WEST	LOCATION ROAD NAME Vonderhaar	ROAD TYPE C T
ROUTE NUMBER		REFERENCE ROAD NAME (ROAD, MILEPOST, HOUSE #) 5488	ROAD TYPE	LATITUDE DECIMAL DEGREES 3 9 . 3 3 0 7 3 0
CRASH DATE / TIME* 0 3 2 7 2 0 2 3 0 9 2 5		CRASH SEVERITY 1 - FATAL 2 - SERIOUS INJURY SUSPECTED 3 - MINOR INJURY SUSPECTED 4 - INJURY POSSIBLE 5 - PROPERTY DAMAGE ONLY		UNIT IN ERROR 98 - ANIMAL 99 - UNKNOWN 0 1

REFERENCE POINT 1 - INTERSECTION 2 - MILE POST 3 - HOUSE # 3	DIRECTION FROM REFERENCE 1 - NORTH 2 - SOUTH 3 - EAST 4 - WEST	ROUTE TYPE IR - INTERSTATE ROUTE (TP) US - FEDERAL US ROUTE SR - STATE ROUTE CR - NUMBERED COUNTY ROUTE TR - NUMBERED TOWNSHIP ROUTE	ROAD TYPE AL - ALLEY AV - AVENUE BL - BOULEVARD CR - CIRCLE CT - COURT DR - DRIVE HE - HEIGHTS HW - HIGHWAY LA - LANE MP - MILEPOST OV - OVAL PK - PARKWAY PI - PIKE PL - PLACE RD - ROAD SQ - SQUARE ST - STREET TE - TERRACE TL - TRAIL WA - WAY	INTERSECTION RELATED <input type="checkbox"/> WITHIN INTERSECTION OR ON APPROACH <input type="checkbox"/> WITHIN INTERCHANGE AREA NUMBER OF APPROACHES
DISTANCE FROM REFERENCE	DISTANCE UNIT OF MEASURE 1 - MILES 2 - FEET 3 - YARDS	ROADWAY <input type="checkbox"/> ROADWAY DIVIDED		

LOCATION OF FIRST HARMFUL EVENT 1 - ON ROADWAY 2 - ON SHOULDER 3 - IN MEDIAN 4 - ON ROADSIDE 5 - ON GORE 6 - OUTSIDE TRAFFIC WAY 7 - ON RAMP 8 - OFF RAMP 0 6	9 - CROSSOVER 10 - DRIVEWAY/ALLEY ACCESS 11 - RAILWAY GRADE CROSSING 12 - SHARED USE PATHS OR TRAILS 13 - BIKE LANE 14 - TOLL BOOTH 99 - OTHER / UNKNOWN	MANNER OF CRASH COLLISION/IMPACT 1 - NOT COLLISION BETWEEN TWO MOTOR VEHICLES IN TRANSPORT 2 - REAR-END 3 - HEAD-ON 4 - REAR-TO-REAR 5 - BACKING 6 - ANGLE 7 - SIDESWIPE, SAME DIRECTION 8 - SIDESWIPE, OPPOSITE DIRECTION 9 - OTHER / UNKNOWN 1	DIRECTION OF TRAVEL 1 - NORTH 2 - SOUTH 3 - EAST 4 - WEST	MEDIAN TYPE 1 - DIVIDED FLUSH MEDIAN (<4 FEET) 2 - DIVIDED FLUSH MEDIAN (≥4 FEET) 3 - DIVIDED, DEPRESSED MEDIAN 4 - DIVIDED, RAISED MEDIAN (ANY TYPE) 9 - OTHER/UNKNOWN
--	--	--	---	--

<input type="checkbox"/> WORK ZONE RELATED <input type="checkbox"/> WORKERS PRESENT <input type="checkbox"/> LAW ENFORCEMENT PRESENT <input type="checkbox"/> ACTIVE SCHOOL ZONE	WORK ZONE TYPE 1 - LANE CLOSURE 2 - LANE SHIFT/CROSSOVER 3 - WORK ON SHOULDER OR MEDIAN 4 - INTERMITTENT OR MOVING WORK 5 - OTHER	LOCATION OF CRASH IN WORK ZONE 1 - BEFORE THE 1ST WORK ZONE WARNING SIGN 2 - ADVANCE WARNING AREA 3 - TRANSITION AREA 4 - ACTIVITY AREA 5 - TERMINATION AREA	CONTOUR 4	CONDITIONS 2	SURFACE 2
---	--	---	--------------	-----------------	--------------

LIGHT CONDITION 1 - DAYLIGHT 2 - DAWN/DUSK 3 - DARK - LIGHTED ROADWAY 4 - DARK - ROADWAY NOT LIGHTED 5 - DARK - UNKNOWN ROADWAY LIGHTING 9 - OTHER / UNKNOWN 1	WEATHER 1 - CLEAR 2 - CLOUDY 3 - FOG, SMOG, SMOKE 4 - RAIN 5 - SLEET, HAIL 6 - SNOW 7 - SEVERE CROSSWINDS 8 - BLOWING SAND, SOIL, DIRT, SNOW 9 - FREEZING RAIN OR FREEZING DRIZZLE 99 - OTHER / UNKNOWN 0 2	9 - OTHER/UNKNOWN 5 - SAND, MUD, DIRT, OIL, GRAVEL 6 - WATER (STANDING, MOVING) 7 - SLUSH 9 - OTHER/UNKNOWN
---	--	---

NARRATIVE

On March 27, 2023 at about 9:25 A.M. Unit #1 was parked on the street near 5488 Vonderhaar Court. The vehicle was parked on the east side of the roadway and was facing south. Unit #1 had a trailer attached with Ohio registration, STM-3165. Unit #1 then rolled over the curb and struck the residence at 5488 Vonderhaar Court.

The residence is the property of Dorjon and Reanna Burton
5488 Vonderhaar Court
Fairfield, Ohio 45014

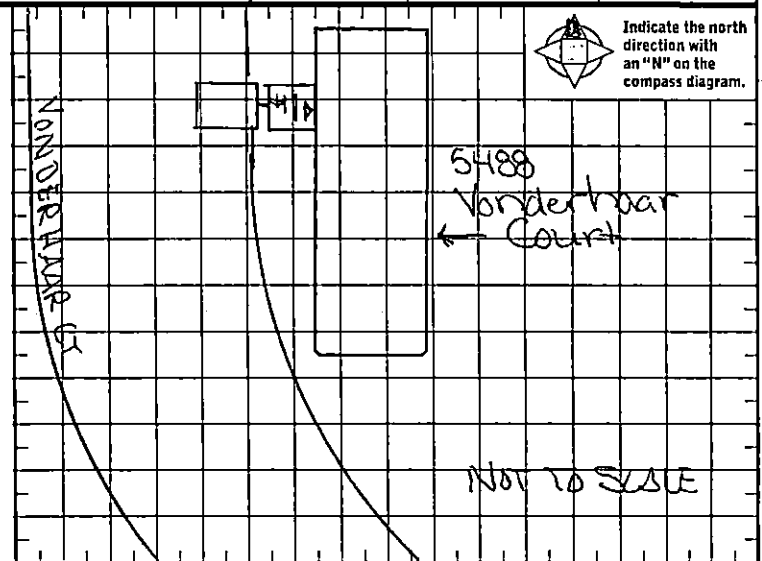

CRASH REPORTED DATE / TIME 0 3 2 7 2 0 2 3 0 9 3 0	DISPATCH DATE / TIME 0 3 2 7 2 0 2 3 0 9 3 3	ARRIVAL DATE / TIME 0 3 2 7 2 0 2 3 0 9 3 9	SCENE CLEARED DATE / TIME 0 3 2 7 2 0 2 3 1 0 2 8	REPORT TAKEN BY <input checked="" type="checkbox"/> POLICE AGENCY <input type="checkbox"/> MOTORIST
TOTAL TIME ROADWAY CLOSED 0	OTHER INVESTIGATION TIME 1 0	TOTAL MINUTES 6 5	OFFICER'S NAME* E. Knizner	CHECKED BY OFFICER'S NAME* <i>[Signature]</i>
			OFFICER'S BADGE NUMBER* 0 8 3	CHECKED BY OFFICER'S BADGE NUMBER* 8
				<input type="checkbox"/> SUPPLEMENT (CORRECTION OR ADDITION TO AN EXISTING REPORT SENT TO OOPS)

LOCAL REPORT NUMBER
 2 3 0 2 2 6 3 5

OWNER
 UNIT # 011 OWNER NAME: LAST, FIRST, MIDDLE (SAME AS DRIVER) RIETHMAIER, JOEY
 OWNER ADDRESS: STREET, CITY, STATE, ZIP (SAME AS DRIVER)
 3880 Hamilton Mason Road Hamilton, Ohio 45011
 COMMERCIAL CARRIER: NAME, ADDRESS, CITY, STATE, ZIP
 COMMERCIAL CARRIER PHONE: INCLUDE AREA CODE

DAMAGE
 DAMAGE SCALE
 1 - NONE
 2 - MINOR DAMAGE
 3 - FUNCTIONAL DAMAGE
 4 - DISABLING DAMAGE
 9 - UNKNOWN
3

VEHICLE
 LP STATE OH LICENSE PLATE # JAD9747 VEHICLE IDENTIFICATION # 1FDHF26HXVEA518438 VEHICLE YEAR 1997 VEHICLE MAKE Ford
 INSURANCE VERIFIED INSURANCE COMPANY Progressive Ins. INSURANCE POLICY # 02116575-0 COLOR Green VEHICLE MODEL F450

DAMAGED AREA(S)
 INDICATE ALL THAT APPLY

TYPE OF USE: COMMERCIAL GOVERNMENT IN EMERGENCY RESPONSE
 INTERLOCK DEVICE EQUIPPED HIT/SKIP UNIT #OCCUPANTS 00
 US DOT # _____ VEHICLE WEIGHT GVWR/GCWR
 1 - <10K LBS.
 2 - 10,001 - 26K LBS.
 3 - >26K LBS.
 TOWED BY: COMPANY NAME _____ HAZARDOUS MATERIAL
 MATERIAL CLASS # PLACARD ID #
 PLACARD

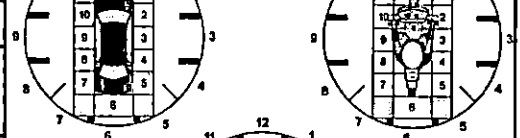

UNIT TYPE: 1 - PASSENGER CAR, 2 - PASSENGER VAN (MINIVAN), 3 - SPORT UTILITY VEHICLE, 4 - PICK UP, 5 - CARGO VAN, 6 - VAN (9-15 SEATS), 7 - MOTORCYCLE 2-WHEELED, 8 - MOTORCYCLE 3-WHEELED, 9 - AUTOCYCLE, 10 - MOPED OR MOTORIZED BICYCLE, 11 - ALL TERRAIN VEHICLE (ATV/UTV), 12 - GOLF CART, 13 - SNOWMOBILE, 14 - SINGLE UNIT TRUCK, 15 - SEMI-TRACTOR, 16 - FARM EQUIPMENT, 17 - MOTORHOME, 18 - LIMO (LIVERY VEHICLE), 19 - BUS (16+ PASSENGERS), 20 - OTHER VEHICLE, 21 - HEAVY EQUIPMENT, 22 - ANIMAL WITH RIDER OR ANIMAL-DRAWN VEHICLE, 23 - PEDESTRIAN / SKATER, 24 - WHEELCHAIR (ANY TYPE), 25 - OTHER NON-MOTORIST, 26 - BICYCLE, 99 - UNKNOWN OR HIT/SKIP
 # OF TRAILING UNITS 1

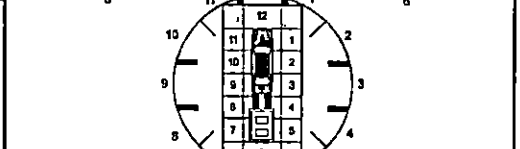

WAS VEHICLE OPERATING IN AUTONOMOUS MODE WHEN CRASH OCCURRED?
 1 - YES 2 - NO 9 - OTHER / UNKNOWN 2
 AUTONOMOUS MODE LEVEL
 0 - NO AUTOMATION 1 - DRIVER ASSISTANCE 2 - PARTIAL AUTOMATION 3 - CONDITIONAL AUTOMATION 4 - HIGH AUTOMATION 5 - FULL AUTOMATION 9 - UNKNOWN

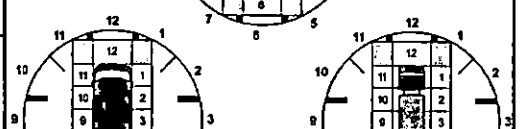

SPECIAL FUNCTION: 1 - NONE, 2 - TAXI, 3 - ELECTRONIC RIDE SHARING, 4 - SCHOOL TRANSPORT, 5 - BUS - TRANSIT/COMMUTER, 6 - BUS - CHARTER/TOUR, 7 - BUS - INTERCITY, 8 - BUS - SHUTTLE, 9 - BUS - OTHER, 10 - AMBULANCE, 11 - FIRE, 12 - MILITARY, 13 - POLICE, 14 - PUBLIC UTILITY, 15 - CONSTRUCTION EQUIPMENT, 16 - FARM, 17 - MOWING, 18 - SNOW REMOVAL, 19 - TOWING, 20 - SAFETY SERVICE PATROL, 21 - MAIL CARRIER, 99 - OTHER / UNKNOWN
1, 5



CARGO BODY TYPE: 1 - NO CARGO BODY TYPE / NOT APPLICABLE, 2 - BUS, 3 - VEHICLE TOWING ANOTHER MOTOR VEHICLE, 4 - LOGGING, 5 - INTERMODAL CONTAINER CHASSIS, 6 - CARGO VAN/ENCLOSED BOX, 7 - GRAINCHIPS/GRAVEL, 8 - POLE, 9 - CARGO TANK, 10 - FLAT BED, 11 - DUMP, 12 - CONCRETE MIXER, 13 - AUTOTRANSPORTER, 14 - GARBAGE/REFUSE, 99 - OTHER / UNKNOWN
0, 1

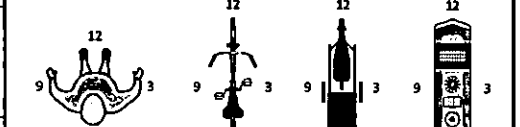

VEHICLE DEFECTS: 1 - TURN SIGNALS, 2 - HEAD LAMPS, 3 - TAIL LAMPS, 4 - BRAKES, 5 - STEERING, 6 - TIRE BLOWOUT, 7 - WORN OR SLICK TIRES, 8 - TRAILER EQUIPMENT DEFECTIVE, 9 - MOTOR TROUBLE, 10 - DISABLED FROM PRIOR ACCIDENT, 99 - OTHER / UNKNOWN
9, 9

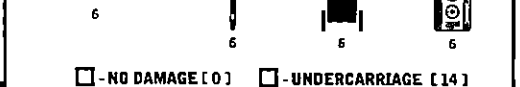

NON-MOTORIST LOCATION AT IMPACT: 1 - INTERSECTION - MARKED CROSSWALK, 2 - INTERSECTION - UNMARKED CROSSWALK, 3 - INTERSECTION - OTHER, 4 - MIDDLEBLOCK - MARKED CROSSWALK, 5 - TRAVEL LANE - OTHER LOCATION, 6 - BICYCLE LANE, 7 - SHOULDER / ROADSIDE, 8 - SIDEWALK, 9 - MEDIAN/CROSSING ISLAND, 10 - DRIVEWAY ACCESS, 11 - SHARED USE PATHS OR TRAILS, 12 - FIRST RESPONDER AT INCIDENT SCENE, 99 - OTHER / UNKNOWN
1

INITIAL POINT OF CONTACT: 0 - NO DAMAGE, 1-12 - REFER TO UNIT DIAGRAM, 13 - TOP, 14 - UNDERCARRIAGE, 15 - VEHICLE NOT AT SCENE, 99 - UNKNOWN
1, 2

ACTION: 1 - NON-CONTACT, 2 - NON-COLLISION, 3 - STRIKING, 4 - STRUCK, 5 - BOTH STRIKING & STRUCK, 9 - OTHER / UNKNOWN, 1 - STRAIGHT AHEAD, 2 - CHANGING LANES, 3 - OVERTAKING/PASSING, 4 - MAKING RIGHT TURN, 5 - MAKING LEFT TURN, 7 - MAKING U-TURN, 8 - ENTERING TRAFFIC LANE, 9 - LEAVING TRAFFIC LANE, 10 - PARKED, 11 - SLOWING OR STOPPED IN TRAFFIC, 12 - DRIVERLESS, 13 - NEGOTIATING A CURVE OR ENTERING OR CROSSING SPECIFIED LOCATION, 14 - WALKING, RUNNING, JOGGING, PLAYING, 15 - WORKING, 16 - PUSHING VEHICLE, 18 - APPROACHING OR LEAVING VEHICLE, 19 - STANDING, 20 - OTHER NON-MOTORIST, 21 - STANDING OUTSIDE DISABLED VEHICLE, 99 - OTHER / UNKNOWN
3

TRAFFIC: TRAFFICWAY FLOW: 1 - ONE-WAY, 2 - TWO-WAY 2, TRAFFIC CONTROL: 1 - ROUNDABOUT, 2 - SIGNAL, 3 - FLASHER, 4 - STOP SIGN, 5 - YIELD SIGN, 6 - NO CONTROL 6, # OF THROUGH LANES ON ROAD 2, RAIL GRADE CROSSING: 1 - NOT INVOLVED, 2 - INVOLVED-ACTIVE CROSSING, 3 - INVOLVED-PASSIVE CROSSING 1

CONTRIBUTING CIRCUMSTANCES: 1 - NONE, 2 - FAILURE TO YIELD, 3 - RAN RED LIGHT, 4 - RAN STOP SIGN, 5 - UNSAFE SPEED, 6 - IMPROPER TURN, 7 - LEFT OF CENTER, 8 - FOLLOWING TOO CLOSE / ACDA, 9 - IMPROPER LANE CHANGE, 10 - IMPROPER PASSING, 11 - DROVE OFF ROAD, 12 - IMPROPER BACKING, 13 - IMPROPER START FROM A PARKED POSITION, 14 - STOPPED OR PARKED ILLEGALLY, 15 - SWERVING TO AVOID, 16 - WRONG WAY, 17 - VISION OBSTRUCTION, 18 - OPERATING DEFECTIVE EQUIPMENT, 19 - LOAD SHIFTING/FALLING/SPILLING, 20 - IMPROPER CROSSING, 21 - LYING IN ROADWAY, 22 - NOT DISCERNIBLE, 23 - OPENING DOOR INTO ROADWAY, 99 - OTHER IMPROPER ACTION
2, 2

UNIT / NON-MOTORIST DIRECTION: FROM 4 TO 3, DETECTED SPEED: 1 - STATED / ESTIMATED SPEED, 2 - CALCULATED / EDR, 3 - UNDETERMINED 1

SEQUENCE OF EVENTS: 1 - OVERTURN/ROLLOVER, 2 - FIRE/EXPLOSION, 3 - IMMERSION, 4 - JACKKNIFE, 5 - CARGO / EQUIPMENT LOSS OR SHIFT, 6 - EQUIPMENT FAILURE, 7 - SEPARATION OF UNITS, 8 - RAN OFF ROAD RIGHT, 9 - RAN OFF ROAD LEFT, 10 - CROSS MEDIAN, 11 - CROSS CENTERLINE - OPPOSITE DIRECTION OF TRAVEL, 12 - DOWNHILL RUNAWAY, 13 - OTHER NON-COLLISION, 14 - PEDESTRIAN, 15 - PEDALCYCLE, 16 - RAILWAY VEHICLE, 17 - ANIMAL - FARM, 18 - ANIMAL - DEER, 19 - ANIMAL - OTHER, 20 - MOTOR VEHICLE IN TRANSPORT, 21 - PARKED MOTOR VEHICLE, 22 - WORK ZONE MAINTENANCE EQUIPMENT, 23 - STRUCK BY FALLING, SHIFTING CARGO OR ANYTHING SET IN MOTION BY A MOTOR VEHICLE, 24 - OTHER MOVABLE OBJECT
1, 4, 3
2, 0, 9
3, 5, 2

COLLISION WITH FIXED OBJECT: 25 - IMPACT ATTENUATOR / CRASH CUSHION, 26 - BRIDGE OVERHEAD STRUCTURE, 27 - BRIDGE PIER OR ABUTMENT, 28 - BRIDGE PARAPET, 29 - BRIDGE RAIL, 30 - GUARDRAIL FACE, 31 - GUARDRAIL END, 32 - PORTABLE BARRIER, 33 - MEDIUM CABLE BARRIER, 34 - MEDIUM GUARDRAIL BARRIER, 35 - MEDIUM CONCRETE BARRIER, 36 - MEDIUM OTHER BARRIER, 37 - TRAFFIC SIGN POST, 38 - OVERHEAD SIGN POST, 39 - LIGHT / LUMINARIES SUPPORT, 40 - UTILITY POLE, 41 - OTHER POST, POLE OR SUPPORT, 42 - CULVERT, 43 - CURB, 44 - DITCH, 45 - EMBANKMENT, 46 - FENCE, 47 - MAILBOX, 48 - TREE, 49 - FIRE HYDRANT, 50 - WORK ZONE MAINTENANCE EQUIPMENT, 51 - WALL, 52 - BUILDING, 53 - TUNNEL, 54 - OTHER FIXED OBJECT, 99 - OTHER / UNKNOWN
1 FIRST HARMFUL EVENT 3 MOST HARMFUL EVENT

UNIT SPEED: 5, POSTED SPEED: 2, 5