



# TRAFFIC CRASH REPORT

\*DENOTES MANDATORY FIELD FOR SUPPLEMENT REPORT

LOCAL REPORT NUMBER\*

<input checked="" type="checkbox"/> PHOTOSTAKEN	<input checked="" type="checkbox"/> OH-2	<input type="checkbox"/> OH-3	LOCAL INFORMATION		2 3 0 2 3 4 9 4		
<input type="checkbox"/> SECONDARY CRASH	<input type="checkbox"/> OH-1P	<input type="checkbox"/> OTHER	REPORTING AGENCY NAME*		NCIC*		HIT/SKIP 1 - SOLVED
<input type="checkbox"/> PRIVATE PROPERTY			Fairfield Police Department		0 0 9 0 1		NUMBER OF UNITS 0 2
						UNIT IN ERROR 98 - ANIMAL 0 1 99 - UNKNOWN	

COUNTY*	LOCALITY*	LOCATION: CITY, VILLAGE, TOWNSHIP*		CRASH DATE / TIME*	CRASH SEVERITY
0 9	1	City of Fairfield		03302023 2001	5

ROUTE TYPE	ROUTE NUMBER	PREFIX	LOCATION ROAD NAME	ROAD TYPE	LATITUDE DECIMAL DEGREES
			Winton	R d	39.306431
REFERENCE	ROUTE NUMBER	PREFIX	REFERENCE ROAD NAME (ROAD, MILEPOST, HOUSE #)	ROAD TYPE	LONGITUDE DECIMAL DEGREES
			John Gray	R d	-84.542381

REFERENCE POINT	DIRECTION FROM REFERENCE	ROUTE TYPE	ROAD TYPE	INTERSECTION RELATED
1 - INTERSECTION	1 - NORTH	IR - INTERSTATE ROUTE(TP)	AL - ALLEY	<input checked="" type="checkbox"/> WITHIN INTERSECTION OR ON APPROACH
2 - MILE POST	2 - SOUTH	US - FEDERAL US ROUTE	AV - AVENUE	<input type="checkbox"/> WITHIN INTERCHANGE AREA
3 - HOUSE #	3 - EAST	SR - STATE ROUTE	BL - BOULEVARD	NUMBER OF APPROACHES 3
DISTANCE FROM REFERENCE	DISTANCE UNIT OF MEASURE	CR - NUMBERED COUNTY ROUTE	MP - MILEPOST	ROADWAY
	1 - MILES	TR - NUMBERED TOWNSHIP ROUTE	OV - OVAL	<input type="checkbox"/> ROADWAY DIVIDED

LOCATION OF FIRST HARMFUL EVENT	MANNER OF CRASH COLLISION/IMPACT	DIRECTION OF TRAVEL	MEDIAN TYPE
1 - ON ROADWAY	1 - NOT COLLISION BETWEEN TWO MOTOR VEHICLES IN TRANSPORT	1 - NORTH	1 - DIVIDED FLUSH MEDIAN (<4 FEET)
2 - ON SHOULDER	2 - REAR-END	2 - SOUTH	2 - DIVIDED FLUSH MEDIAN (>4 FEET)
3 - IN MEDIAN	3 - HEAD-ON	3 - EAST	3 - DIVIDED, DEPRESSED MEDIAN
4 - ON ROADSIDE	4 - REAR-TO-REAR	4 - WEST	4 - DIVIDED, RAISED MEDIAN (ANY TYPE)
5 - ON GORE	5 - BACKING		9 - OTHER/UNKNOWN
6 - OUTSIDE TRAFFIC WAY	6 - ANGLE		
7 - ON RAMP	7 - SIDESWIPE, SAME DIRECTION		
8 - OFF RAMP	8 - SIDESWIPE, OPPOSITE DIRECTION		
9 - CROSSOVER	9 - OTHER / UNKNOWN		

WORK ZONE RELATED	WORK ZONE TYPE	LOCATION OF CRASH IN WORK ZONE	CONTOUR	CONDITIONS	SURFACE
<input type="checkbox"/>	1 - LANE CLOSURE	1 - BEFORE THE 1ST WORK ZONE WARNING SIGN	1	1 - DRY	1 - CONCRETE
<input type="checkbox"/>	2 - LANE SHIFT/CROSSOVER	2 - ADVANCE WARNING AREA	2 - STRAIGHT GRADE	2 - WET	2 - BLACKTOP, BITUMINOUS, ASPHALT
<input type="checkbox"/>	3 - WORK ON SHOULDER OR MEDIAN	3 - TRANSITION AREA	3 - CURVE LEVEL	3 - SNOW	3 - BRICK/BLOCK
<input type="checkbox"/>	4 - INTERMITTENT OR MOVING WORK	4 - ACTIVITY AREA	4 - CURVE GRADE	4 - ICE	4 - SLAG, GRAVEL, STONE
<input type="checkbox"/>	5 - OTHER	5 - TERMINATION AREA	9 - OTHER/UNKNOWN	5 - SAND, MUD, DIRT, OIL, GRAVEL	5 - DIRT
				6 - WATER (STANDING, MOVING)	9 - OTHER/UNKNOWN
				7 - SLUSH	
				9 - OTHER/UNKNOWN	

LIGHT CONDITION	WEATHER
1 - DAYLIGHT	1 - CLEAR
2 - DAWN/DUSK	2 - CLOUDY
3 - DARK - LIGHTED ROADWAY	3 - FOG, SMOG, SMOKE
4 - DARK - ROADWAY NOT LIGHTED	4 - RAIN
5 - DARK - UNKNOWN ROADWAY LIGHTING	5 - SLEET, HAIL
9 - OTHER / UNKNOWN	6 - SNOW
	7 - SEVERE CROSSWINDS
	8 - BLOWING SAND, SOIL, DIRT, SNOW
	9 - FREEZING RAIN OR FREEZING DRIZZLE
	99 - OTHER / UNKNOWN

NARRATIVE

On March 30, 2023, at 8:01 P.M., unit #2 was stopped for the posted traffic signal on Winton Road at John Gray Road. Unit #1 was on John Gray Road, turning left onto Winton Road, when they drove through marked lanes and struck unit #2 on the driver's side front bumper.

Indicate the north direction with an "N" on the compass diagram.

See OH-2

CRASH REPORTED DATE / TIME	DISPATCH DATE / TIME	ARRIVAL DATE / TIME	SCENE CLEARED DATE / TIME	REPORT TAKEN BY
03302023 2001	03302023 2003	03302023 2011	03302023 2035	<input checked="" type="checkbox"/> POLICE AGENCY
TOTAL TIME ROADWAY CLOSED	OTHER INVESTIGATION TIME	TOTAL MINUTES	OFFICER'S NAME*	<input type="checkbox"/> MOTORIST
3 0	6 2	1 7 5	P.O. Spradling	<input type="checkbox"/> SUPPLEMENT (CORRECTION OR ADDITION TO AN EXISTING REPORT SENT TO DPS)
			OFFICER'S BADGE NUMBER*	
			1 3 2	
			CHECKED BY OFFICER'S NAME*	
			Sgt. Aaron Meyer	
			CHECKED BY OFFICER'S BADGE NUMBER*	
			1 3 2	

LOCAL REPORT NUMBER  
 2 3 0 2 3 4 9 4

**OWNER**  
 UNIT # 01  
 OWNER NAME: LAST, FIRST, MIDDLE (SAME AS DRIVER)  
 OWNER ADDRESS: STREET, CITY, STATE, ZIP (SAME AS DRIVER)  
 COMMERCIAL CARRIER: NAME, ADDRESS, CITY, STATE, ZIP  
 OWNER PHONE: INCLUDE AREA CODE (SAME AS DRIVER)  
 COMMERCIAL CARRIER PHONE: INCLUDE AREA CODE

**DAMAGE**  
 DAMAGE SCALE  
 1 - NONE  
 2 - MINOR DAMAGE  
 3 - FUNCTIONAL DAMAGE  
 4 - DISABLING DAMAGE  
 9 - UNKNOWN

**VEHICLE**  
 LP STATE OH  
 LICENSE PLATE # HBE2658  
 VEHICLE IDENTIFICATION # 5TD1BZRFXHS3610093  
 VEHICLE YEAR 2017  
 VEHICLE MAKE TOYT  
 INSURANCE VERIFIED  
 INSURANCE COMPANY State Farm  
 INSURANCE POLICY # 024-9328-D25-35G  
 COLOR White  
 VEHICLE MODEL Highland

**DAMAGED AREA(S)**  
 INDICATE ALL THAT APPLY

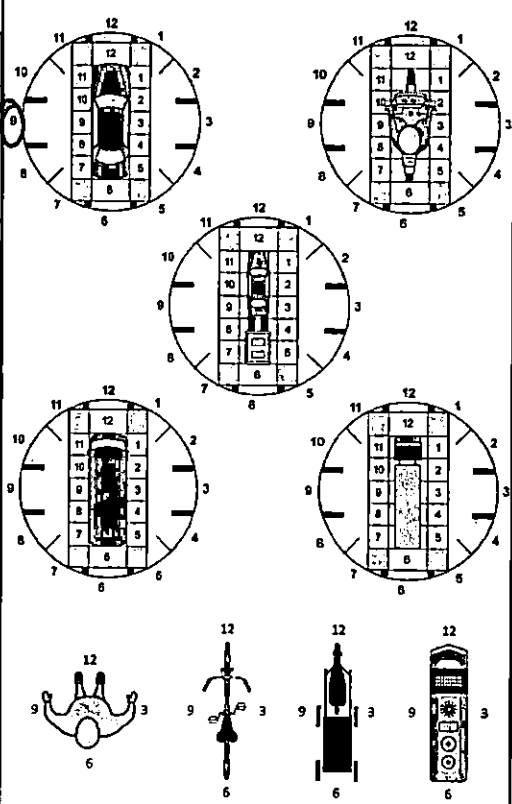

TYPE OF USE  
 COMMERCIAL  GOVERNMENT  IN EMERGENCY RESPONSE  
 INTERLOCK DEVICE EQUIPPED  HIT/SKIP UNIT  
 # OCCUPANTS 01  
 US DOT #  
 VEHICLE WEIGHT GVWR/GCWR  
 1 - <10K LBS.  
 2 - 10,001 - 26K LBS.  
 3 - >26K LBS.  
 TOWED BY: COMPANY NAME  
 HAZARDOUS MATERIAL CLASS # PLACARD ID #  
 MATERIAL RELEASED  
 PLACARD

UNIT TYPE  
 03  
 1 - PASSENGER CAR  
 2 - PASSENGER VAN (MINIVAN)  
 3 - SPORT UTILITY VEHICLE  
 4 - PICK UP  
 5 - CARGOVAN  
 6 - VAN (9-15 SEATS)  
 7 - MOTORCYCLE 2-WHEELED  
 8 - MOTORCYCLE 3-WHEELED  
 9 - AUTOCYCLE  
 10 - MOPED OR MOTORIZED BICYCLE  
 11 - ALL TERRAIN VEHICLE (ATV/UTV)  
 12 - GOLF CART  
 13 - SNOWMOBILE  
 14 - SINGLE UNIT TRUCK  
 15 - SEMI-TRACTOR  
 16 - FARM EQUIPMENT  
 17 - MOTORHOME  
 18 - LIMO (LIVERY VEHICLE)  
 19 - BUS (16+ PASSENGERS)  
 20 - OTHER VEHICLE  
 21 - HEAVY EQUIPMENT  
 22 - ANIMAL WITH RIDER OR ANIMAL-DRAWN VEHICLE  
 23 - PEDESTRIAN / SKATER  
 24 - WHEELCHAIR (ANY TYPE)  
 25 - OTHER NON-MOTORIST  
 26 - BICYCLE  
 27 - TRAIN  
 99 - UNKNOWN OR HIT/SKIP

WAS VEHICLE OPERATING IN AUTONOMOUS MODE WHEN CRASH OCCURRED?  
 2  
 1 - YES 2 - NO 9 - OTHER / UNKNOWN  
 AUTONOMOUS MODE LEVEL  
 0 - NO AUTOMATION  
 1 - DRIVER ASSISTANCE  
 2 - PARTIAL AUTOMATION  
 3 - CONDITIONAL AUTOMATION  
 4 - HIGH AUTOMATION  
 5 - FULL AUTOMATION  
 9 - UNKNOWN

SPECIAL FUNCTION  
 01  
 1 - NONE  
 2 - TAXI  
 3 - ELECTRONIC RIDE SHARING  
 4 - SCHOOL TRANSPORT  
 5 - BUS - TRANSIT/COMMUTER  
 6 - BUS - CHARTER/TOUR  
 7 - BUS - INTERCITY  
 8 - BUS - SHUTTLE  
 9 - BUS - OTHER  
 10 - AMBULANCE  
 11 - FIRE  
 12 - MILITARY  
 13 - POLICE  
 14 - PUBLIC UTILITY  
 15 - CONSTRUCTION EQUIPMENT  
 16 - FARM  
 17 - MOWING  
 18 - SNOW REMOVAL  
 19 - TOWING  
 20 - SAFETY SERVICE PATROL  
 21 - MAIL CARRIER  
 99 - OTHER / UNKNOWN

CARGO BODY TYPE  
 01  
 1 - NO CARGO BODY TYPE / NOT APPLICABLE  
 2 - BUS  
 3 - VEHICLE TOWING ANOTHER MOTOR VEHICLE  
 4 - LOGGING  
 5 - INTERMODAL CONTAINER CHASSIS  
 6 - CARGOVAN/ENCLOSED BOX  
 7 - GRAIN CHIPS/GRAVEL  
 8 - POLE  
 9 - CARGO TANK  
 10 - FLAT BED  
 11 - DUMP  
 12 - CONCRETE MIXER  
 13 - AUTO TRANSPORTER  
 14 - GARBAGE/REFUSE  
 99 - OTHER / UNKNOWN

VEHICLE DEFECTS  
 1 - TURN SIGNALS  
 2 - HEAD LAMPS  
 3 - TAIL LAMPS  
 4 - BRAKES  
 5 - STEERING  
 6 - TIRE BLOWOUT  
 7 - WORN OR SLICK TIRES  
 8 - TRAILER EQUIPMENT DEFECTIVE  
 9 - MOTOR TROUBLE  
 10 - DISABLED FROM PRIOR ACCIDENT  
 99 - OTHER / UNKNOWN

NON-MOTORIST LOCATION AT IMPACT  
 1 - INTERSECTION - MARKED CROSSWALK  
 2 - INTERSECTION - UNMARKED CROSSWALK  
 3 - INTERSECTION - OTHER  
 4 - MIDDLEBLOCK - MARKED CROSSWALK  
 5 - TRAVEL LANE - OTHER LOCATION  
 6 - BICYCLE LANE  
 7 - SHOULDER / ROADSIDE  
 8 - SIDEWALK  
 9 - MEDIAN/CROSSING ISLAND  
 10 - DRIVEWAY ACCESS  
 11 - SHARED USE PATHS OR TRAILS  
 12 - FIRST RESPONDER AT INCIDENT SCENE  
 99 - OTHER / UNKNOWN

ACTION  
 3  
 1 - NON-CONTACT  
 2 - NON-COLLISION  
 3 - STRIKING  
 4 - STRUCK  
 5 - BOTH STRIKING & STRUCK  
 9 - OTHER / UNKNOWN  
 6  
 1 - STRAIGHT AHEAD  
 2 - BACKING  
 3 - CHANGING LANES  
 4 - OVERTAKING/PASSING  
 5 - MAKING RIGHT TURN  
 6 - MAKING LEFT TURN  
 7 - MAKING U-TURN  
 8 - ENTERING TRAFFIC LANE  
 9 - LEAVING TRAFFIC LANE  
 10 - PARKED  
 11 - SLOWING OR STOPPED IN TRAFFIC  
 12 - DRIVERLESS  
 13 - NEGOTIATING A CURVE  
 14 - ENTERING OR CROSSING SPECIFIED LOCATION  
 15 - WALKING, RUNNING, JOGGING, PLAYING  
 16 - WORKING  
 17 - PUSHING VEHICLE  
 18 - APPROACHING OR LEAVING VEHICLE  
 19 - STANDING  
 20 - OTHER NON-MOTORIST  
 21 - STANDING OUTSIDE DISABLED VEHICLE  
 99 - OTHER / UNKNOWN

INITIAL POINT OF CONTACT  
 9  
 0 - NO DAMAGE  
 1-12 - REFER TO UNIT DIAGRAM  
 13 - TOP  
 14 - UNDERCARRIAGE  
 15 - VEHICLE NOT AT SCENE  
 99 - UNKNOWN

CONTRIBUTING CIRCUMSTANCES  
 06  
 1 - NONE  
 2 - FAILURE TO YIELD  
 3 - RAN RED LIGHT  
 4 - RAN STOP SIGN  
 5 - UNSAFE SPEED  
 6 - IMPROPER TURN  
 7 - LEFT OF CENTER  
 8 - FOLLOWING TOO CLOSE / ACDA  
 9 - IMPROPER LANE CHANGE  
 10 - IMPROPER PASSING  
 11 - DROVE OFF ROAD  
 12 - IMPROPER BACKING  
 13 - IMPROPER START FROM A PARKED POSITION  
 14 - STOPPED OR PARKED ILLEGALLY  
 15 - SWERVING TO AVOID  
 16 - WRONG WAY  
 17 - VISION OBSTRUCTION  
 18 - OPERATING DEFECTIVE EQUIPMENT  
 19 - LOAD SHIFTING/FALLING/SPILLING  
 20 - IMPROPER CROSSING  
 21 - LYING IN ROADWAY  
 22 - NOT DISCERNIBLE  
 23 - OPENING DOOR INTO ROADWAY  
 99 - OTHER IMPROPER ACTION

TRAFFIC  
 TRAFFICWAY FLOW  
 2  
 1 - ONE-WAY  
 2 - TWO-WAY  
 TRAFFIC CONTROL  
 2  
 1 - ROUNDABOUT  
 2 - SIGNAL  
 3 - FLASHER  
 4 - STOP SIGN  
 5 - YIELD SIGN  
 6 - NO CONTROL

SEQUENCE OF EVENTS  
 1  
 1 - OVERTURN/ROLLOVER  
 2 - FIRE/EXPLOSION  
 3 - IMMERSION  
 4 - JACKKNIFE  
 5 - CARGO/EQUIPMENT LOSS OR SHIFT  
 6  
 1 - EQUIPMENT FAILURE  
 7 - SEPARATION OF UNITS  
 8 - RAN OFF ROAD RIGHT  
 9 - RAN OFF ROAD LEFT  
 10 - CROSS MEDIAN  
 11 - CROSS CENTERLINE - OPPOSITE DIRECTION OF TRAVEL  
 12 - DOWNHILL RUNAWAY  
 13 - OTHER NON-COLLISION  
 14 - PEDESTRIAN  
 15 - PEDALCYCLE  
 16 - RAILWAY VEHICLE  
 17 - ANIMAL - FARM  
 18 - ANIMAL - DEER  
 19 - ANIMAL - OTHER  
 20 - MOTOR VEHICLE IN TRANSPORT  
 21 - PARKED MOTOR VEHICLE  
 22 - WORKZONE MAINTENANCE EQUIPMENT  
 23 - STRUCK BY FALLING, SHIFTING CARGO OR ANYTHING SET IN MOTION BY A MOTOR VEHICLE  
 24 - OTHER MOVABLE OBJECT

# OF THROUGH LANES ON ROAD 2  
 RAIL GRADE CROSSING 1  
 1 - NOT INVOLVED  
 2 - INVOLVED-ACTIVE CROSSING  
 3 - INVOLVED-PASSIVE CROSSING

COLLISION WITH FIXED OBJECT/STUCK  
 4  
 25 - IMPACT ATTENUATOR / CRASH CUSHION  
 26 - BRIDGE OVERHEAD STRUCTURE  
 27 - BRIDGE PIER OR ABUTMENT  
 28 - BRIDGE PARAPET  
 29 - BRIDGE RAIL  
 30 - GUARDRAIL FACE  
 31 - GUARDRAIL END  
 32 - PORTABLE BARRIER  
 33 - MEDIAN CABLE BARRIER  
 34 - MEDIAN GUARDRAIL BARRIER  
 35 - MEDIAN CONCRETE BARRIER  
 36 - MEDIAN OTHER BARRIER  
 37 - TRAFFIC SIGN POST  
 38 - OVERHEAD SIGN POST  
 39 - LIGHT / LUMINARIES SUPPORT  
 40 - UTILITY POLE  
 41 - OTHER POST, POLE OR SUPPORT  
 42 - CULVERT  
 43 - CURB  
 44 - DITCH  
 45 - EMBANKMENT  
 46 - FENCE  
 47 - MAILBOX  
 48 - TREE  
 49 - FIRE HYDRANT  
 50 - WORKZONE MAINTENANCE EQUIPMENT  
 51 - WALL  
 52 - BUILDING  
 53 - TUNNEL  
 54 - OTHER FIXED OBJECT  
 99 - OTHER / UNKNOWN

UNIT / NON-MOTORIST DIRECTION  
 FROM 4 TO 1  
 1 - NORTH  
 2 - SOUTH  
 3 - EAST  
 4 - WEST  
 5 - NORTHEAST  
 6 - NORTHWEST  
 7 - SOUTHEAST  
 8 - SOUTHWEST  
 9 - OTHER / UNKNOWN

FIRST HARMFUL EVENT 1 MOST HARMFUL EVENT 2

UNIT SPEED 15  
 POSTED SPEED 35  
 DETECTED SPEED 1  
 1 - STATED / ESTIMATED SPEED  
 2 - CALCULATED / EDR  
 3 - UNDETERMINED

OWNER	UNIT # 02	OWNER NAME: LAST, FIRST, MIDDLE (SAME AS DRIVER)	OWNER PHONE: INCLUDE AREA CODE (SAME AS DRIVER)
	OWNER ADDRESS: STREET, CITY, STATE, ZIP (SAME AS DRIVER)		
COMMERCIAL CARRIER: NAME, ADDRESS, CITY, STATE, ZIP		COMMERCIAL CARRIER PHONE: INCLUDE AREA CODE	
VEHICLE	LP STATE OH	LICENSE PLATE # FWQ8094	VEHICLE IDENTIFICATION # 1G11ZG15S11M1F054975
	INSURANCE VERIFIED	INSURANCE COMPANY State Farm	INSURANCE POLICY # 2263321-SFP-35
	TYPE OF USE <input type="checkbox"/> COMMERCIAL <input type="checkbox"/> GOVERNMENT <input type="checkbox"/> IN EMERGENCY RESPONSE	US DOT #	VEHICLE YEAR 2021
	INTERLOCK DEVICE EQUIPPED	HIT/SKIP UNIT	VEHICLE MAKE Chevy
	HAZARDOUS MATERIAL <input type="checkbox"/> MATERIAL RELEASED <input type="checkbox"/> PLACARD	VEHICLE WEIGHT GVWR/GCWR 1 - <10K LBS. 2 - 10,001 - 26K LBS. 3 - >26K LBS.	VEHICLE MODEL Malibu
	UNIT TYPE 01	# OF TRAILING UNITS 0	TOWED BY: COMPANY NAME
	1 - PASSENGER CAR 2 - PASSENGER VAN (MINIVAN) 3 - SPORT UTILITY VEHICLE 4 - PICK UP 5 - CARGO VAN 6 - VAN (19-15 SEATS)	7 - MOTORCYCLE 2-WHEELED 8 - MOTORCYCLE 3-WHEELED 9 - AUTOCYCLE 10 - MOPED OR MOTORIZED BICYCLE 11 - ALL TERRAIN VEHICLE (ATV/UTV)	12 - GOLF CART 13 - SNOWMOBILE 14 - SINGLE UNIT TRUCK 15 - SEMI-TRACTOR 16 - FARM EQUIPMENT 17 - MOTORHOME
	18 - LIMO (LIVERY VEHICLE) 19 - BUS (16+ PASSENGERS) 20 - OTHER VEHICLE 21 - HEAVY EQUIPMENT 22 - ANIMAL WITH RIDER OR ANIMAL-DRAWN VEHICLE	23 - PEDESTRIAN / SKATER 24 - WHEELCHAIR (ANY TYPE) 25 - OTHER NON-MOTORIST 26 - BICYCLE 27 - TRAIN 99 - UNKNOWN OR HIT/SKIP	
	WAS VEHICLE OPERATING IN AUTONOMOUS MODE WHEN CRASH OCCURRED? 2 - I-YES 2-NO 9-OTHER/UNKNOWN	AUTONOMOUS MODE LEVEL 0 - NO AUTOMATION 1 - DRIVER ASSISTANCE 2 - PARTIAL AUTOMATION 3 - CONDITIONAL AUTOMATION 4 - HIGH AUTOMATION 5 - FULL AUTOMATION 9 - UNKNOWN	
	SPECIAL FUNCTION 01	1 - NONE 2 - TAXI 3 - ELECTRONIC RIDE SHARING 4 - SCHOOL TRANSPORT 5 - BUS-TRANSIT/COMMUTER	6 - BUS-CHARTER/TOUR 7 - BUS-INTERCITY 8 - BUS-SHUTTLE 9 - BUS-OTHER 10 - AMBULANCE
CARGO BODY TYPE 01	1 - NO CARGO BODY TYPE /NOT APPLICABLE 2 - BUS	3 - VEHICLE TOWING ANOTHER MOTORVEHICLE 4 - LOGGING	
VEHICLE DEFECTS	1 - TURN SIGNALS 2 - HEAD LAMPS 3 - TAIL LAMPS	4 - BRAKES 5 - STEERING 6 - TIRE BLOWOUT	
NON-MOTORIST LOCATION AT IMPACT	1 - INTERSECTION - MARKED CROSSWALK 2 - INTERSECTION - UNMARKED CROSSWALK	3 - INTERSECTION - OTHER 4 - MIDBLOCK - MARKED CROSSWALK 5 - TRAVEL LANE - OTHER LOCATION	
ACTION 4	1 - NON-CONTACT 2 - NON-COLLISION 3 - STRIKING 4 - STRUCK 5 - BOTH STRIKING & STRUCK 9 - OTHER / UNKNOWN	1 - STRAIGHT AHEAD 2 - BACKING 3 - CHANGING LANES 4 - OVERTAKING/PASSING 5 - MAKING RIGHT TURN 6 - MAKING LEFT TURN	
CONTRIBUTING CIRCUMSTANCES 01	1 - NONE 2 - FAILURE TO YIELD 3 - RAN RED LIGHT 4 - RAN STOP SIGN 5 - UNSAFE SPEED 6 - IMPROPER TURN	7 - LEFT OF CENTER 8 - FOLLOWING TOO CLOSE /ACDA 9 - IMPROPER LANE CHANGE 10 - IMPROPER PASSING 11 - DROVE OFF ROAD 12 - IMPROPER BACKING	
SEQUENCE OF EVENTS 120	1 - OVERTURN/ROLLOVER 2 - FIRE/EXPLOSION 3 - IMMERSION 4 - JACKKNIFE 5 - CARGO/EQUIPMENT LOSS OR SHIFT	6 - EQUIPMENT FAILURE 7 - SEPARATION OF UNITS 8 - RAN OFF ROAD RIGHT 9 - RAN OFF ROAD LEFT 10 - CROSS MEDIAN	
COLLISION WITH FIXED OBJECT STRUCK	25 - IMPACT ATTENUATOR /CRASH CUSHION 26 - BRIDGE OVERHEAD STRUCTURE 27 - BRIDGE PIER OR ABUTMENT 28 - BRIDGE PARAPET 29 - BRIDGE RAIL 30 - GUARDRAIL FACE	31 - GUARDRAIL END 32 - PORTABLE BARRIER 33 - MEDIUM CABLE BARRIER 34 - MEDIUM GUARDRAIL BARRIER 35 - MEDIUM CONCRETE BARRIER 36 - MEDIUM OTHER BARRIER	
FIRST HARMFUL EVENT 1	MOST HARMFUL EVENT 1	11 - CROSS CENTERLINE - OPPOSITE DIRECTION OF TRAVEL 12 - DOWNHILL RUNAWAY 13 - OTHER NON-COLLISION 14 - PEDESTRIAN 15 - PEDALCYCLE	
		16 - RAILWAY VEHICLE 17 - ANIMAL - FARM 18 - ANIMAL - DEER 19 - ANIMAL - OTHER 20 - MOTORVEHICLE IN TRANSPORT 21 - PARKED MOTOR VEHICLE	
		22 - WORK ZONE MAINTENANCE EQUIPMENT 23 - STRUCK BY FALLING, SHIFTING CARGO OR ANYTHING SET IN MOTION BY A MOTORVEHICLE 24 - OTHER MOVABLE OBJECT	
		37 - TRAFFIC SIGN POST 38 - OVERHEAD SIGN POST 39 - LIGHT/LUMINARIES SUPPORT 40 - UTILITY POLE 41 - OTHER POST, POLE OR SUPPORT 42 - CULVERT	
		43 - CURB 44 - DITCH 45 - EMBANKMENT 46 - FENCE 47 - MAILBOX 48 - TREE 49 - FIRE HYDRANT	
		50 - WORK ZONE MAINTENANCE EQUIPMENT 51 - WALL 52 - BUILDING 53 - TUNNEL 54 - OTHER FIXED OBJECT 99 - OTHER / UNKNOWN	

LOCAL REPORT NUMBER 2, 3, 0, 2, 3, 4, 9, 4	
DAMAGE	
DAMAGE SCALE 2 - NONE 3 - MINOR DAMAGE 4 - FUNCTIONAL DAMAGE 9 - DISABLING DAMAGE 9 - UNKNOWN	
DAMAGED AREA(S) INDICATE ALL THAT APPLY	
<input type="checkbox"/> - NO DAMAGE [0] <input type="checkbox"/> - UNDERCARRIAGE [14] <input type="checkbox"/> - TOP [13] <input type="checkbox"/> - ALL AREAS [15] <input type="checkbox"/> - UNIT NOT AT SCENE [16]	
INITIAL POINT OF CONTACT 0 - NO DAMAGE 1-12 - REFER TO UNIT DIAGRAM 13 - TOP 14 - UNDERCARRIAGE 15 - VEHICLE NOT AT SCENE 99 - UNKNOWN	
TRAFFICWAY FLOW 2 - ONE-WAY 2 - TWO-WAY	TRAFFIC CONTROL 2 - ROUNDABOUT 2 - SIGNAL 3 - FLASHER 4 - STOP SIGN 5 - YIELD SIGN 6 - NO CONTROL
# OF THROUGH LANES ON ROAD 2	RAIL GRADE CROSSING 1 - NOT INVOLVED 2 - INVOLVED-ACTIVE CROSSING 3 - INVOLVED-PASSIVE CROSSING
UNIT / NON-MOTORIST DIRECTION FROM 1 TO 2 1 - NORTH 2 - SOUTH 3 - EAST 4 - WEST 5 - NORTHEAST 6 - NORTHWEST 7 - SOUTHEAST 8 - SOUTHWEST 9 - OTHER / UNKNOWN	
UNIT SPEED 0	DETECTED SPEED 1 - STATED / ESTIMATED SPEED 2 - CALCULATED / EDR 3 - UNDETERMINED
POSTED SPEED 3 5	



# MOTORIST / Non-MOTORIST

LOCAL REPORT NUMBER  
2 3 0 2 3 4 9 4

UNIT # 0 1	NAME: LAST, FIRST, MIDDLE Dinh, Teresa T	DATE OF BIRTH 0 6 1 8 1 9 6 7	AGE 5 5	GENDER F
ADDRESS: STREET, CITY, STATE, ZIP 6331 Lansing Court, Liberty Township, Ohio, 45011		CONTACT PHONE - INCLUDE AREA CODE		
INJURIES 5	INJURED TAKEN BY	EMS AGENCY (NAME)	INJURED TAKEN TO: MEDICAL FACILITY (NAME, CITY)	SAFETY EQUIPMENT USED 0 4
OL STATE OH	OPERATOR LICENSE NUMBER	OFFENSE CHARGED 331.08A1	LOCAL CODE <input checked="" type="checkbox"/>	OFFENSE DESCRIPTION Marked Lanes
OL CLASS 4	ENDORSEMENT SELECT UP TO 2	RESTRICTION SELECT UP TO 3	DRIVER DISTRACTED BY 1	ALCOHOL / DRUG SUSPECTED <input type="checkbox"/> ALCOHOL <input type="checkbox"/> MARIJUANA <input type="checkbox"/> OTHER DRUG
ALCOHOL TEST		DRUG TEST(S)		
STATUS 1	TYPE 1	VALUE	STATUS 1	TYPE 1

UNIT # 0 2	NAME: LAST, FIRST, MIDDLE Miefert, Mark C	DATE OF BIRTH 0 6 2 0 1 9 5 6	AGE 6 6	GENDER M
ADDRESS: STREET, CITY, STATE, ZIP 47 Dusk Court, Fairfield, OH, 45014		CONTACT PHONE - INCLUDE AREA CODE		
INJURIES 5	INJURED TAKEN BY	EMS AGENCY (NAME)	INJURED TAKEN TO: MEDICAL FACILITY (NAME, CITY)	SAFETY EQUIPMENT USED 0 4
OL STATE OH	OPERATOR LICENSE NUMBER	OFFENSE CHARGED	LOCAL CODE <input type="checkbox"/>	OFFENSE DESCRIPTION
OL CLASS 4	ENDORSEMENT SELECT UP TO 2	RESTRICTION SELECT UP TO 3	DRIVER DISTRACTED BY 1	ALCOHOL / DRUG SUSPECTED <input type="checkbox"/> ALCOHOL <input type="checkbox"/> MARIJUANA <input type="checkbox"/> OTHER DRUG
ALCOHOL TEST		DRUG TEST(S)		
STATUS 1	TYPE 1	VALUE	STATUS 1	TYPE 1

UNIT #	NAME: LAST, FIRST, MIDDLE	DATE OF BIRTH	AGE 0	GENDER
ADDRESS: STREET, CITY, STATE, ZIP		CONTACT PHONE - INCLUDE AREA CODE		
INJURIES	INJURED TAKEN BY	EMS AGENCY (NAME)	INJURED TAKEN TO: MEDICAL FACILITY (NAME, CITY)	SAFETY EQUIPMENT USED
OL STATE	OPERATOR LICENSE NUMBER	OFFENSE CHARGED	LOCAL CODE <input type="checkbox"/>	OFFENSE DESCRIPTION
OL CLASS	ENDORSEMENT SELECT UP TO 2	RESTRICTION SELECT UP TO 3	DRIVER DISTRACTED BY	ALCOHOL / DRUG SUSPECTED <input type="checkbox"/> ALCOHOL <input type="checkbox"/> MARIJUANA <input type="checkbox"/> OTHER DRUG
ALCOHOL TEST		DRUG TEST(S)		
STATUS	TYPE	VALUE	STATUS	TYPE

INJURIES	SEATING POSITION	AIR BAG	OL CLASS	OL RESTRICTION(S)	DRIVER DISTRACTION	TEST STATUS
1 - FATAL	1 - FRONT - LEFT SIDE (MOTORCYCLE DRIVER)	1 - NOT DEPLOYED	1 - CLASS A	1 - ALCOHOL INTERLOCK DEVICE	1 - NOT DISTRACTED	1 - NONE GIVEN
2 - SUSPECTED SERIOUS INJURY	2 - FRONT - MIDDLE	2 - DEPLOYED FRONT	2 - CLASS B	2 - COL INTRASTATE ONLY	2 - MANUALLY OPERATING AN ELECTRONIC COMMUNICATION DEVICE (TEXTING, TYPING, DIALING)	2 - TEST REFUSED
3 - SUSPECTED MINOR INJURY	3 - FRONT - RIGHT SIDE	3 - DEPLOYED SIDE	3 - CLASS C	3 - CORRECTIVE LENSES	3 - TALKING ON HANDS-FREE COMMUNICATION DEVICE	3 - TEST GIVEN, CONTAMINATED SAMPLE / UNUSABLE
4 - POSSIBLE INJURY	4 - SECOND - LEFT SIDE (MOTORCYCLE PASSENGER)	4 - DEPLOYED BOTH FRONT / SIDE	4 - REGULAR CLASS (OHIO - D)	4 - FARM WAIVER	4 - TALKING ON HAND-HELD COMMUNICATION DEVICE	4 - TEST GIVEN, RESULTS KNOWN
5 - NO APPARENT INJURY	5 - SECOND - MIDDLE	5 - NOT APPLICABLE	5 - MC MOPEO ONLY	5 - EXCEPT CLASS A BUS	5 - OTHER ACTIVITY WITH AN ELECTRONIC DEVICE	5 - TEST GIVEN, RESULTS UNKNOWN
<b>INJURED TAKEN BY</b>	6 - SECOND - RIGHT SIDE	9 - DEPLOYMENT UNKNOWN	6 - NO VALID OL	6 - EXCEPT CLASS A & CLASS B BUS	7 - EXCEPT TRACTOR-TRAILER	<b>ALCOHOL TEST TYPE</b>
1 - NOT TRANSPORTED / TREATED AT SCENE	7 - THIRD - LEFT SIDE (MOTORCYCLE SIDE CAR)	<b>EJECTION</b>	<b>OL ENDORSEMENT</b>	7 - EXCEPT TRACTOR-TRAILER	8 - INTERMEDIATE LICENSE RESTRICTIONS	1 - NONE
2 - EMS	8 - THIRD - MIDDLE	1 - NOT EJECTED	H - HAZMAT	8 - INTERMEDIATE LICENSE RESTRICTIONS	9 - LEARNER'S PERMIT RESTRICTIONS	2 - BLOOD
3 - POLICE	9 - THIRD - RIGHT SIDE	2 - PARTIALLY EJECTED	M - MOTORCYCLE	9 - LEARNER'S PERMIT RESTRICTIONS	10 - LIMITED TO DAYLIGHT ONLY	3 - URINE
9 - OTHER / UNKNOWN	10 - SLEEPER SECTION OF TRUCK CAB	3 - TOTALLY EJECTED	P - PASSENGER	10 - LIMITED TO DAYLIGHT ONLY	11 - LIMITED TO EMPLOYMENT	4 - BREATH
<b>SAFETY EQUIPMENT</b>	11 - PASSENGER IN OTHER ENCLOSED CARGO AREA (NON-TRAILING UNIT, BUS, PICK-UP WITH CAP)	4 - NOT APPLICABLE	N - TANKER	11 - LIMITED TO EMPLOYMENT	12 - LIMITED - OTHER	5 - OTHER
1 - NONE USED	12 - PASSENGER IN UNENCLOSED CARGO AREA	<b>TRAPPED</b>	Q - MOTOR SCOOTER	12 - LIMITED - OTHER	13 - MECHANICAL DEVICES (SPECIAL BRAKES, HAND CONTROLS, OR OTHER ADAPTIVE DEVICES)	<b>DRUG TEST TYPE</b>
2 - SHOULDER BELT ONLY USED	13 - TRAILING UNIT	1 - NOT TRAPPED	R - THREE-WHEEL MOTORCYCLE	13 - MECHANICAL DEVICES (SPECIAL BRAKES, HAND CONTROLS, OR OTHER ADAPTIVE DEVICES)	14 - MILITARY VEHICLES ONLY	1 - NONE
3 - LAP BELT ONLY USED	14 - RIDING ON VEHICLE EXTERIOR (NON-TRAILING UNIT)	2 - EXTRICATED BY MECHANICAL MEANS	S - SCHOOL BUS	14 - MILITARY VEHICLES ONLY	15 - MOTOR VEHICLES WITHOUT AIR BRAKES	2 - BLOOD
4 - SHOULDER & LAP BELT USED	15 - NON-MOTORIST	3 - FREED BY NON-MECHANICAL MEANS	T - DOUBLE & TRIPLE TRAILERS	15 - MOTOR VEHICLES WITHOUT AIR BRAKES	16 - OUTSIDE MIRROR	3 - URINE
5 - CHILD RESTRAINT SYSTEM - FORWARD FACING	99 - OTHER / UNKNOWN		X - TANKER / HAZMAT	16 - OUTSIDE MIRROR	17 - PROSTHETIC AID	4 - OTHER
6 - CHILD RESTRAINT SYSTEM - REAR FACING				17 - PROSTHETIC AID	18 - OTHER	<b>DRUG TEST RESULT(S)</b>
7 - BOOSTER SEAT			<b>GENDER</b>	18 - OTHER		1 - AMPHETAMINES
8 - HELMET USED			F - FEMALE			2 - BARBITURATES
9 - PROTECTIVE PADS USED (ELBOW, KNEES, ETC.)			M - MALE			3 - BENZODIAZEPINES
10 - REFLECTIVE CLOTHING			U - OTHER / UNKNOWN			4 - CANNABINOID
11 - LIGHTING - PEDESTRIAN / BICYCLE ONLY						5 - COCAINE
99 - OTHER / UNKNOWN						6 - OPIATES / OPIOIDS
						7 - OTHER
						8 - NEGATIVE RESULTS

LOCAL REPORT NUMBER 23-023494	REPORTING AGENCY Fairfield Police Department	DATE OF ACCIDENT 3/30/23
IN COUNTY OF Butler	ACCIDENT LOCATION Winton Rd/ John Gray Rd	

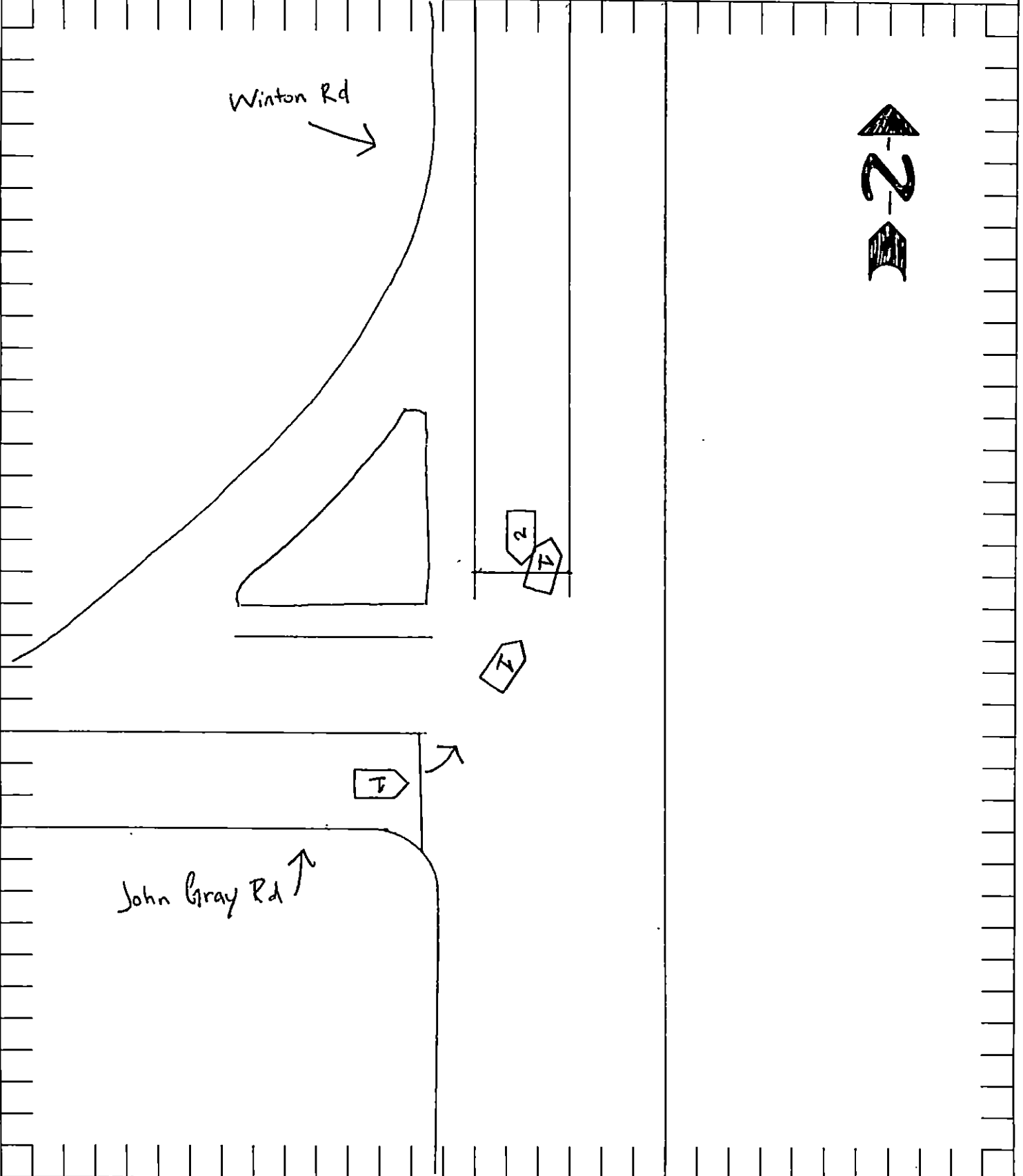

OFFICER'S SIGNATURE <i>Richard J. [Signature]</i>	BADGE NO. 175
--	------------------