



TRAFFIC CRASH REPORT

*DENOTES MANDATORY FIELD FOR SUPPLEMENT REPORT

LOCAL REPORT NUMBER*

<input checked="" type="checkbox"/> PHOTOS TAKEN	<input checked="" type="checkbox"/> OH-2	<input type="checkbox"/> OH-3	LOCAL INFORMATION	2 3 0 2 4 7 9 9
<input type="checkbox"/> SECONDARY CRASH	<input checked="" type="checkbox"/> OH-1P	<input type="checkbox"/> OTHER	REPORTING AGENCY NAME*	HITS/SKIP
<input type="checkbox"/> PRIVATE PROPERTY			Fairfield Police Department	1 - SOLVED
			NCIC* 0,0,9,0,1	2 - UNSOLVED
				NUMBER OF UNITS
				0, 2
				UNIT IN ERROR
				98 - ANIMAL
				99 - UNKNOWN

COUNTY* 0 9	LOCALITY* 1	LOCATION: CITY, VILLAGE, TOWNSHIP* City of Fairfield	CRASH DATE / TIME* 04 05 2023 14 22	CRASH SEVERITY 5
-------------	-------------	---	--	---------------------

ROUTE TYPE S R	ROUTE NUMBER 4	PREFIX 1 - NORTH 2 - SOUTH 3 - EAST 4 - WEST	LOCATION ROAD NAME	ROAD TYPE	LATITUDE DECIMAL DEGREES 39.335659	CRASH SEVERITY 1 - FATAL 2 - SERIOUS INJURY SUSPECTED 3 - MINOR INJURY SUSPECTED 4 - INJURY POSSIBLE 5 - PROPERTY DAMAGE ONLY
ROUTE TYPE	ROUTE NUMBER	PREFIX 1 - NORTH 2 - SOUTH 3 - EAST 4 - WEST	REFERENCE ROAD NAME (ROAD, MILEPOST, HOUSE #) 5410	ROAD TYPE	LONGITUDE DECIMAL DEGREES -84.527308	

REFERENCE POINT 1 - INTERSECTION 2 - MILE POST 3 - HOUSE # 3	DIRECTION FROM REFERENCE 1 - NORTH 2 - SOUTH 3 - EAST 4 - WEST	ROUTE TYPE IR - INTERSTATE ROUTE (TP) US - FEDERAL US ROUTE SR - STATE ROUTE CR - NUMBERED COUNTY ROUTE TR - NUMBERED TOWNSHIP ROUTE	ROAD TYPE AL - ALLEY AV - AVENUE BL - BOULEVARD CR - CIRCLE CT - COURT DR - DRIVE HE - HEIGHTS HW - HIGHWAY LA - LANE MP - MILEPOST OV - OVAL PK - PARKWAY PI - PIKE PL - PLACE RD - ROAD SQ - SQUARE ST - STREET TE - TERRACE TL - TRAIL WA - WAY	INTERSECTION RELATED <input type="checkbox"/> WITHIN INTERSECTION OR ON APPROACH <input type="checkbox"/> WITHIN INTERCHANGE AREA	NUMBER OF APPROACHES
DISTANCE FROM REFERENCE	DISTANCE UNIT OF MEASURE 1 - MILES 2 - FEET 3 - YARDS			ROADWAY <input type="checkbox"/> ROADWAY DIVIDED	

LOCATION OF FIRST HARMFUL EVENT 1 - ON ROADWAY 2 - ON SHOULDER 3 - IN MEDIAN 4 - ON ROADSIDE 5 - ON GORE 6 - OUTSIDE TRAFFIC WAY 7 - ON RAMP 8 - OFF RAMP 0 1	9 - CROSSOVER 10 - DRIVEWAY/ALLEY ACCESS 11 - RAILWAY GRADE CROSSING 12 - SHARED USE PATHS OR TRAILS 13 - BIKE LANE 14 - TOLL BOOTH 99 - OTHER / UNKNOWN	MANNER OF CRASH COLLISION/IMPACT 1 - NOT COLLISION BETWEEN TWO MOTOR VEHICLES IN TRANSPORT 2 - REAR-END 3 - HEAD-ON 4 - REAR-TO-REAR 5 - BACKING 6 - ANGLE 7 - SIDESWIPE, SAME DIRECTION 8 - SIDESWIPE, OPPOSITE DIRECTION 9 - OTHER / UNKNOWN 2	DIRECTION OF TRAVEL 1 - NORTH 2 - SOUTH 3 - EAST 4 - WEST	MEDIAN TYPE 1 - DIVIDED FLUSH MEDIAN (<4 FEET) 2 - DIVIDED FLUSH MEDIAN (≥4 FEET) 3 - DIVIDED, DEPRESSED MEDIAN 4 - DIVIDED, RAISED MEDIAN (ANY TYPE) 9 - OTHER/UNKNOWN
--	--	--	---	--

<input type="checkbox"/> WORK ZONE RELATED <input type="checkbox"/> WORKERS PRESENT <input type="checkbox"/> LAW ENFORCEMENT PRESENT <input type="checkbox"/> ACTIVE SCHOOL ZONE	WORK ZONE TYPE 1 - LANE CLOSURE 2 - LANE SHIFT/CROSSOVER 3 - WORK ON SHOULDER OR MEDIAN 4 - INTERMITTENT OR MOVING WORK 5 - OTHER	LOCATION OF CRASH IN WORK ZONE 1 - BEFORE THE 1ST WORK ZONE WARNING SIGN 2 - ADVANCE WARNING AREA 3 - TRANSITION AREA 4 - ACTIVITY AREA 5 - TERMINATION AREA	CONTOUR 1	CONDITIONS 2	SURFACE 2
---	--	---	--------------	-----------------	--------------

LIGHT CONDITION 1 - DAYLIGHT 2 - DAWN/DUSK 3 - DARK - LIGHTED ROADWAY 4 - DARK - ROADWAY NOT LIGHTED 5 - DARK - UNKNOWN ROADWAY LIGHTING 9 - OTHER / UNKNOWN 1	WEATHER 1 - CLEAR 2 - CLOUDY 3 - FOG, SMOG, SMOKE 4 - RAIN 5 - SLEET, HAIL 6 - SNOW 7 - SEVERE CROSSWINDS 8 - BLOWING SAND, SOIL, DIRT, SNOW 9 - FREEZING RAIN OR FREEZING DRIZZLE 99 - OTHER / UNKNOWN 0 2	1 - DRY 2 - WET 3 - SNOW 4 - ICE 5 - SAND, MUD, DIRT, OIL, GRAVEL 6 - WATER (STANDING, MOVING) 7 - SLUSH 9 - OTHER/UNKNOWN	1 - CONCRETE 2 - BLACKTOP, BITUMINOUS, ASPHALT 3 - BRICK/BLOCK 4 - SLAG, GRAVEL, STONE 5 - DIRT 9 - OTHER/UNKNOWN
---	--	---	--

NARRATIVE On 04/05/2023 at around 6:22 P.M., units 1 and 2 were traveling northbound on S.R.4 near 5410 S.R.4 (Dixie Hwy). Unit 1 failed to maintain a clear distance headed and collided with Unit 2, which was stopped in traffic.	Indicate the north direction with an "N" on the compass diagram.
SEE OH-2	

CRASH REPORTED DATE / TIME 0 4 0 5 2 0 2 3 1 4 2 2	DISPATCH DATE / TIME 0 4 0 5 2 0 2 3 1 4 2 5	ARRIVAL DATE / TIME 0 4 0 5 2 0 2 3 1 4 3 2	SCENE CLEARED DATE / TIME 0 4 0 5 2 0 2 3 1 4 5 9	REPORT TAKEN BY <input checked="" type="checkbox"/> POLICE AGENCY <input type="checkbox"/> MOTORIST
TOTAL TIME ROADWAY CLOSED 0 0 0	OTHER INVESTIGATION TIME 3 0	TOTAL MINUTES 6 4	OFFICER'S NAME* J. Mitchell	Checked by OFFICER'S NAME* D. Pott
			OFFICER'S BADGE NUMBER* 1 7 1	Checked by OFFICER'S BADGE NUMBER* 1 3 0
				<input type="checkbox"/> SUPPLEMENT (CORRECTION OR ADDITION TO AN EXISTING REPORT SENT TO OHS)

OWNER

UNIT # 01 OWNER NAME: LAST, FIRST, MIDDLE SAME AS DRIVER
 OWNER PHONE: INCLUDE AREA CODE SAME AS DRIVER
 OWNER ADDRESS: STREET, CITY, STATE, ZIP SAME AS DRIVER
 COMMERCIAL CARRIER: NAME, ADDRESS, CITY, STATE, ZIP
 COMMERCIAL CARRIER PHONE: INCLUDE AREA CODE

VEHICLE

LP STATE OH LICENSE PLATE # JFZ7858 VEHICLE IDENTIFICATION # 1NXB1R132E151Z14811783 VEHICLE YEAR 2005 VEHICLE MAKE Toyota
 INSURANCE VERIFIED INSURANCE COMPANY Progressive INSURANCE POLICY # 968172142 COLOR Silver VEHICLE MODEL Corolla
 COMMERCIAL GOVERNMENT IN EMERGENCY RESPONSE US DOT # _____ TOWED BY: COMPANY NAME Fox Towing
 INTERLOCK DEVICE EQUIPPED HIT/SKIP UNIT #OCCUPANTS 01 VEHICLE WEIGHT GVWR/GCWR 1 - <10K LBS. 2 - 10,001 - 26K LBS. 3 - >26K LBS. MATERIAL RELEASED PLACARD HAZARDOUS MATERIAL CLASS # PLACARD ID #

UNIT TYPE 01 # OF TRAILING UNITS 0

1 - PASSENGER CAR 7 - MOTORCYCLE 2-WHEELED 12 - GOLF CART 18 - LIMO (LIVERY VEHICLE) 23 - PEDESTRIAN / SKATER
 2 - PASSENGER VAN (MINIVAN) 8 - MOTORCYCLE 3-WHEELED 13 - SNOWMOBILE 19 - BUS (16+ PASSENGERS) 24 - WHEELCHAIR (ANY TYPE)
 3 - SPORT UTILITY VEHICLE 9 - AUTOCYCLE 14 - SINGLE UNIT TRUCK 20 - OTHER VEHICLE 25 - OTHER NON-MOTORIST
 4 - PICK UP 10 - MOPED OR MOTORIZED BICYCLE 15 - SEMI-TRACTOR 21 - HEAVY EQUIPMENT 26 - BICYCLE
 5 - CARGO VAN 11 - ALL TERRAIN VEHICLE (ATV/UTV) 16 - FARM EQUIPMENT 22 - ANIMAL WITH RIDER OR ANIMAL-DRAWN VEHICLE 27 - TRAIN
 6 - VAN (9-15 SEATS) 17 - MOTORHOME 99 - UNKNOWN OR HIT/SKIP

WAS VEHICLE OPERATING IN AUTONOMOUS MODE WHEN CRASH OCCURRED? 02 1 - YES 2 - NO 9 - OTHER / UNKNOWN AUTONOMOUS MODE LEVEL 0 0 - NO AUTOMATION 1 - DRIVER ASSISTANCE 2 - PARTIAL AUTOMATION 3 - CONDITIONAL AUTOMATION 4 - HIGH AUTOMATION 5 - FULL AUTOMATION 9 - UNKNOWN

SPECIAL FUNCTION 01

1 - NONE 2 - TAXI 3 - ELECTRONIC RIDE SHARING 4 - SCHOOL TRANSPORT 5 - BUS - TRANSIT/COMPUTER 6 - BUS - CHARTER/TOUR 7 - BUS - INTERCITY 8 - BUS - SHUTTLE 9 - BUS - OTHER 10 - AMBULANCE 11 - FIRE 12 - MILITARY 13 - POLICE 14 - PUBLIC UTILITY 15 - CONSTRUCTION EQUIPMENT 16 - FARM 17 - MOWING 18 - SNOW REMOVAL 19 - TOWING 20 - SAFETY SERVICE PATROL 21 - MAIL CARRIER 99 - OTHER / UNKNOWN

CARGO BODY TYPE 01

1 - NO CARGO BODY TYPE / NOT APPLICABLE 2 - BUS 3 - VEHICLE TOWING ANOTHER MOTORVEHICLE 4 - LOGGING 5 - INTERMODAL CONTAINER CHASSIS 6 - CARGO VAN/ENCLOSED BOX 7 - GRAIN/CHIPS/GRAVEL 8 - POLE 9 - CARGO TANK 10 - FLAT BED 11 - DUMP 12 - CONCRETE MIXER 13 - AUTO TRANSPORTER 14 - GARBAGE/REFUSE 99 - OTHER / UNKNOWN

VEHICLE DEFECTS 01

1 - TURN SIGNALS 2 - HEAD LAMPS 3 - TAIL LAMPS 4 - BRAKES 5 - STEERING 6 - TIRE BLOWOUT 7 - WORN OR SLICK TIRES 8 - TRAILER EQUIPMENT DEFECTIVE 9 - MOTOR TROUBLE 10 - DISABLED FROM PRIOR ACCIDENT 11 - WALKING, RUNNING, JOGGING, PLAYING 12 - PUSHING VEHICLE 13 - NEGOTIATING A CURVE 14 - ENTERING OR CROSSING SPECIFIED LOCATION 15 - WALKING, RUNNING, JOGGING, PLAYING 16 - WORKING 17 - PUSHING VEHICLE 18 - APPROACHING OR LEAVING VEHICLE 19 - STANDING 20 - OTHER NON-MOTORIST 21 - STANDING OUTSIDE DISABLED VEHICLE 99 - OTHER / UNKNOWN

NON-MOTORIST LOCATION AT IMPACT 03

1 - INTERSECTION - MARKED CROSSWALK 2 - INTERSECTION - UNMARKED CROSSWALK 3 - INTERSECTION - OTHER 4 - MIDBLOCK - MARKED CROSSWALK 5 - TRAVEL LANE - OTHER LOCATION 6 - BICYCLE LANE 7 - SHOULDER / ROADSIDE 8 - SIDEWALK 9 - MEDIAN/CROSSING ISLAND 10 - DRIVEWAY ACCESS 11 - SHARED USE PATHS OR TRAILS 12 - FIRST RESPONDER AT INCIDENT SCENE 99 - OTHER / UNKNOWN

ACTION 03 PRE-CRASH ACTIONS 01

1 - NON-CONTACT 2 - NON-COLLISION 3 - STRIKING 4 - STRUCK 5 - BOTH STRIKING & STRUCK 9 - OTHER / UNKNOWN 1 - STRAIGHT AHEAD 2 - BACKING 3 - CHANGING LANES 4 - OVERTAKING/PASSING 5 - MAKING RIGHT TURN 6 - MAKING LEFT TURN 7 - MAKING U-TURN 8 - ENTERING TRAFFIC LANE 9 - LEAVING TRAFFIC LANE 10 - PARKED 11 - SLOWING OR STOPPED IN TRAFFIC 12 - DRIVERLESS 13 - IMPROPER START FROM A PARKED POSITION 14 - STOPPED OR PARKED ILLEGALLY 15 - SWERVING TO AVOID 16 - WRONG WAY 17 - VISION OBSTRUCTION 18 - OPERATING DEFECTIVE EQUIPMENT 19 - LOAD SHIFTING/FALLING/SPILLING 20 - IMPROPER CROSSING 21 - LYING IN ROADWAY 22 - NOT DISCERNIBLE 23 - OPENING DOOR INTO ROADWAY 99 - OTHER IMPROPER ACTION

CONTRIBUTING CIRCUMSTANCES 08

1 - NONE 2 - FAILURE TO YIELD 3 - RAN RED LIGHT 4 - RAN STOP SIGN 5 - UNSAFE SPEED 6 - IMPROPER TURN 7 - LEFT OF CENTER 8 - FOLLOWING TOO CLOSE / ACDA 9 - IMPROPER LANE CHANGE 10 - IMPROPER PASSING 11 - DROVE OFF ROAD 12 - IMPROPER BACKING 13 - IMPROPER START FROM A PARKED POSITION 14 - STOPPED OR PARKED ILLEGALLY 15 - SWERVING TO AVOID 16 - WRONG WAY 17 - VISION OBSTRUCTION 18 - OPERATING DEFECTIVE EQUIPMENT 19 - LOAD SHIFTING/FALLING/SPILLING 20 - IMPROPER CROSSING 21 - LYING IN ROADWAY 22 - NOT DISCERNIBLE 23 - OPENING DOOR INTO ROADWAY 99 - OTHER IMPROPER ACTION

SEQUENCE OF EVENTS 120

1 - OVERTURN/ROLLOVER 2 - FIRE/EXPLOSION 3 - IMMERSION 4 - JACKKNIFE 5 - CARGO / EQUIPMENT LOSS OR SHIFT 6 - EQUIPMENT FAILURE 7 - SEPARATION OF UNITS 8 - RAN OFF ROAD RIGHT 9 - RAN OFF ROAD LEFT 10 - CROSS MEDIAN 11 - CROSS CENTERLINE - OPPOSITE DIRECTION OF TRAVEL 12 - DOWNHILL RUNAWAY 13 - OTHER NON-COLLISION 14 - PEDESTRIAN 15 - PEDALCYCLE 16 - RAILWAY VEHICLE 17 - ANIMAL - FARM 18 - ANIMAL - DEER 19 - ANIMAL - OTHER 20 - MOTOR VEHICLE IN TRANSPORT 21 - PARKED MOTOR VEHICLE 22 - WORK ZONE MAINTENANCE EQUIPMENT 23 - STRUCK BY FALLING, SHIFTING CARGO OR ANYTHING SET IN MOTION BY A MOTORVEHICLE 24 - OTHER MOVABLE OBJECT

COLLISION WITH FIXED OBJECT 1 STRUCK 1

25 - IMPACT ATTENUATOR / CRASH CUSHION 26 - BRIDGE OVERHEAD STRUCTURE 27 - BRIDGE PIER OR ABUTMENT 28 - BRIDGE PARAPET 29 - BRIDGE RAIL 30 - GUARDRAIL FACE 31 - GUARDRAIL END 32 - PORTABLE BARRIER 33 - MEDIAN CABLE BARRIER 34 - MEDIAN GUARDRAIL BARRIER 35 - MEDIAN CONCRETE BARRIER 36 - MEDIAN OTHER BARRIER 37 - TRAFFIC SIGN POST 38 - OVERHEAD SIGN POST 39 - LIGHT / LUMINARIES SUPPORT 40 - UTILITY POLE 41 - OTHER POST, POLE OR SUPPORT 42 - CULVERT 43 - CURB 44 - DITCH 45 - EMBANKMENT 46 - FENCE 47 - MAILBOX 48 - TREE 49 - FIRE HYDRANT 50 - WORK ZONE MAINTENANCE EQUIPMENT 51 - WALL 52 - BUILDING 53 - TUNNEL 54 - OTHER FIXED OBJECT 99 - OTHER / UNKNOWN

LOCAL REPORT NUMBER 23024799

DAMAGE

DAMAGE SCALE 4

1 - NONE 2 - MINOR DAMAGE 3 - FUNCTIONAL DAMAGE 4 - DISABLING DAMAGE 9 - UNKNOWN

DAMAGED AREA(S) INDICATE ALL THAT APPLY

- NO DAMAGE [0] - UNDERCARRIAGE [14]
 - TOP [13] - ALL AREAS [15]
 - UNIT NOT AT SCENE [16]

INITIAL POINT OF CONTACT 12

0 - NO DAMAGE 1 - 12 - REFER TO UNIT DIAGRAM 14 - UNDERCARRIAGE 15 - VEHICLE NOT AT SCENE 99 - UNKNOWN 13 - TOP

TRAFFIC

TRAFFICWAY FLOW 2 1 - ONE-WAY 2 - TWO-WAY

TRAFFIC CONTROL 6 1 - ROUNDABOUT 2 - SIGNAL 3 - FLASHER 4 - STOP SIGN 5 - YIELD SIGN 6 - NO CONTROL

OF THROUGH LANES ON ROAD 4

RAIL GRADE CROSSING 1 1 - NOT INVOLVED 2 - INVOLVED-ACTIVE CROSSING 3 - INVOLVED-PASSIVE CROSSING

UNIT / NON-MOTORIST DIRECTION FROM 2 TO 1

1 - NORTH 2 - SOUTH 3 - EAST 4 - WEST 5 - NORTHEAST 6 - NORTHWEST 7 - SOUTHEAST 8 - SOUTHWEST 9 - OTHER / UNKNOWN

UNIT SPEED 35

POSTED SPEED 35

DETECTED SPEED 1 1 - STATED / ESTIMATED SPEED 2 - CALCULATED / EOR 3 - UNDETERMINED

OWNER

UNIT # 012 OWNER NAME: LAST, FIRST, MIDDLE (SAME AS DRIVER)
Laboratory Corp of America

OWNER ADDRESS: STREET, CITY, STATE, ZIP (SAME AS DRIVER)
6324 Irelan Pl, Dublin OH 43016

COMMERCIAL CARRIER: NAME, ADDRESS, CITY, STATE, ZIP
Laboratory Corp of America 6324 Irelan Pl, Dublin, OH 43016

OWNER PHONE: (DIFF AREA CODE) (SAME AS DRIVER)

DAMAGE

DAMAGE SCALE

2 1 - NONE 3 - FUNCTIONAL DAMAGE
2 - MINOR DAMAGE 4 - DISABLING DAMAGE
9 - UNKNOWN

VEHICLE

LP STATE OH LICENSE PLATE # HSK1160 VEHICLE IDENTIFICATION # 4S4B1SA1FCXK1310108194 VEHICLE YEAR 2019 VEHICLE MAKE Subaru

INSURANCE VERIFIED INSURANCE COMPANY ACE American Ins INSURANCE POLICY # ISAH2591311 COLOR Gray VEHICLE MODEL Outback

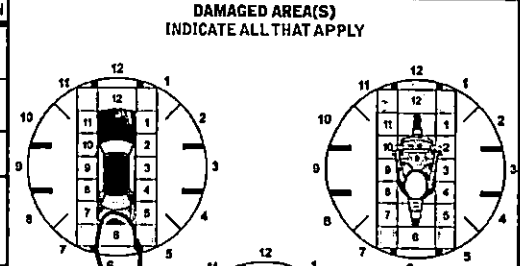

TYPE OF USE: COMMERCIAL GOVERNMENT IN EMERGENCY RESPONSE

US DOT # _____ TOWED BY: COMPANY NAME _____

INTERLOCK DEVICE EQUIPPED HIT/SKIP UNIT # 012 OCCUPANTS _____

VEHICLE WEIGHT GVWR/GCWR: 1 - <10K LBS., 2 - 10,001 - 26K LBS., 3 - >26K LBS.

HAZARDOUS MATERIAL: MATERIAL RELEASED PLACARD CLASS # _____ PLACARD ID # _____

UNIT TYPE 03

1 - PASSENGER CAR	7 - MOTORCYCLE 2-WHEELED	12 - GOLF CART	18 - LIMO (LIVERY VEHICLE)	23 - PEDESTRIAN / SKATER
2 - PASSENGER VAN (MINIVAN)	8 - MOTORCYCLE 3-WHEELED	13 - SNOWMOBILE	19 - BUS (16+ PASSENGERS)	24 - WHEELCHAIR (ANY TYPE)
3 - SPORT UTILITY VEHICLE	9 - AUTOCYCLE	14 - SINGLE UNIT TRUCK	20 - OTHER VEHICLE	25 - OTHER NON-MOTORIST
4 - PICK UP	10 - MOPED OR MOTORIZED BICYCLE	15 - SEMI-TRACTOR	21 - HEAVY EQUIPMENT	26 - BICYCLE
5 - CARGOVAN	11 - ALL TERRAIN VEHICLE (ATV / UTV)	16 - FARM EQUIPMENT	22 - ANIMAL WITH RIDER OR ANIMAL-DRAWN VEHICLE	27 - TRAIN
6 - VAN (9-15 SEATS)		17 - MOTORHOME		99 - UNKNOWN OR HIT/SKIP

of TRAILING UNITS 0

WAS VEHICLE OPERATING IN AUTONOMOUS MODE WHEN CRASH OCCURRED? 02

1 - YES 2 - NO 9 - OTHER / UNKNOWN

AUTONOMOUS MODE LEVEL 0

0 - NO AUTOMATION 1 - DRIVER ASSISTANCE 2 - PARTIAL AUTOMATION 3 - CONDITIONAL AUTOMATION 4 - HIGH AUTOMATION 5 - FULL AUTOMATION 9 - UNKNOWN

SPECIAL FUNCTION 01

1 - NONE	6 - BUS - CHARTER/TOUR	11 - FIRE	16 - FARM	21 - MAIL CARRIER
2 - TAXI	7 - BUS - INTERCITY	12 - MILITARY	17 - MOWING	99 - OTHER / UNKNOWN
3 - ELECTRONIC RIDE SHARING	8 - BUS - SHUTTLE	13 - POLICE	18 - SNOW REMOVAL	
4 - SCHOOL TRANSPORT	9 - BUS - OTHER	14 - PUBLIC UTILITY	19 - TOWING	
5 - BUS - TRANSIT/COMMUTER	10 - AMBULANCE	15 - CONSTRUCTION EQUIPMENT	20 - SAFETY SERVICE PATROL	

CARGO BODY TYPE 01

1 - NO CARGO BODY TYPE / NOT APPLICABLE	3 - VEHICLE TOWING ANOTHER MOTOR VEHICLE	5 - INTERMODAL CONTAINER CHASSIS	8 - POLE	12 - CONCRETE MIXER
2 - BUS	4 - LOGGING	6 - CARGO VAN/ENCLOSED BOX	9 - CARGO TANK	13 - AUTO TRANSPORTER
		7 - GRAIN/CHIPS/GRAVEL	10 - FLAT BED	14 - GARBAGE/REFUSE
			11 - DUMP	99 - OTHER / UNKNOWN

VEHICLE DEFECTS 01

1 - TURN SIGNALS	4 - BRAKES	7 - WORN OR SLICK TIRES	9 - MOTOR TROUBLE	99 - OTHER / UNKNOWN
2 - HEAD LAMPS	5 - STEERING	8 - TRAILER EQUIPMENT DEFECTIVE	10 - DISABLED FROM PRIOR ACCIDENT	
3 - TAIL LAMPS	6 - TIRE BLOWOUT			

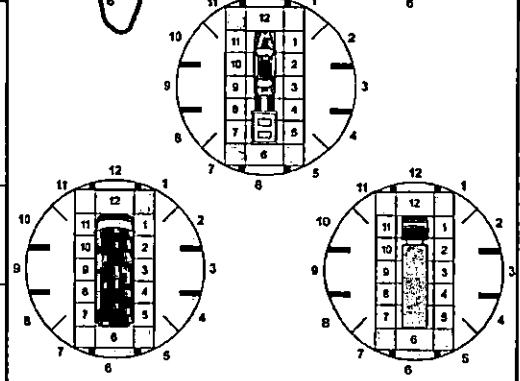

NO DAMAGE [0] UNDERCARRIAGE [14]

TOP [13] ALL AREAS [15]

UNIT NOT AT SCENE [16]

NON-MOTORIST LOCATION AT IMPACT 04

1 - INTERSECTION - MARKED CROSSWALK	3 - INTERSECTION - OTHER	6 - BICYCLE LANE	9 - MEDIAN/CROSSING ISLAND	12 - FIRST RESPONDER AT INCIDENT SCENE
2 - INTERSECTION - UNMARKED CROSSWALK	4 - MIDBLOCK - MARKED CROSSWALK	7 - SHOULDER / ROADSIDE	10 - DRIVEWAY ACCESS	99 - OTHER / UNKNOWN
	5 - TRAVEL LANE - OTHER LOCATION	8 - SIDEWALK	11 - SHARED USE PATHS OR TRAILS	

ACTION 04

1 - NON-CONTACT	1 - STRAIGHT AHEAD	7 - MAKING U-TURN	13 - NEGOTIATING A CURVE	18 - APPROACHING OR LEAVING VEHICLE
2 - NON-COLLISION	2 - BACKING	8 - ENTERING TRAFFIC LANE	14 - ENTERING OR CROSSING SPECIFIED LOCATION	19 - STANDING
3 - STRIKING	3 - CHANGING LANES	9 - LEAVING TRAFFIC LANE	15 - WALKING, RUNNING, JOGGING, PLAYING	20 - OTHER NON-MOTORIST
4 - STRUCK PRE-CRASH ACTIONS	4 - OVERTAKING/PASSING	10 - PARKED	16 - WORKING	21 - STANDING OUTSIDE DISABLED VEHICLE
5 - BOTH STRIKING & STRUCK	5 - MAKING RIGHT TURN	11 - SLOWING OR STOPPED IN TRAFFIC	17 - PUSHING VEHICLE	99 - OTHER / UNKNOWN
9 - OTHER / UNKNOWN	6 - MAKING LEFT TURN	12 - DRIVERLESS		

INITIAL POINT OF CONTACT 06

0 - NO DAMAGE	14 - UNDERCARRIAGE
1-12 - REFER TO UNIT DIAGRAM	15 - VEHICLE NOT AT SCENE
13 - TOP	99 - UNKNOWN

CONTRIBUTING CIRCUMSTANCES 01

1 - NONE	7 - LEFT OF CENTER	13 - IMPROPER START FROM A PARKED POSITION	17 - VISION OBSTRUCTION	21 - LYING IN ROADWAY
2 - FAILURE TO YIELD	8 - FOLLOWING TOO CLOSE / ACCA	14 - STOPPED OR PARKED ILLEGALLY	18 - NOT DISCERNIBLE EQUIPMENT	22 - NOT DISCERNIBLE EQUIPMENT
3 - RAN RED LIGHT	9 - IMPROPER LANE CHANGE	15 - SWERVING TO AVOID	19 - LOAD SHIFTING/FALLING/SPILLING	23 - OPENING DOOR INTO ROADWAY
4 - RAN STOP SIGN	10 - IMPROPER PASSING	16 - WRONG WAY	20 - IMPROPER CROSSING	99 - OTHER IMPROPER ACTION
5 - UNSAFE SPEED	11 - DROVE OFF ROAD			
6 - IMPROPER TURN	12 - IMPROPER BACKING			

TRAFFIC

TRAFFICWAY FLOW 2

1 - ONE-WAY 2 - TWO-WAY

TRAFFIC CONTROL 6

1 - ROUNDABOUT 2 - SIGNAL 3 - FLASHER 4 - STOP SIGN 5 - YIELD SIGN 6 - NO CONTROL

SEQUENCE OF EVENTS 120

NON-COLLISION

1 - OVERTURN/ROLLOVER	6 - EQUIPMENT FAILURE	11 - CROSS CENTERLINE - OPPOSITE DIRECTION OF TRAVEL	16 - RAILWAY VEHICLE	22 - WORK ZONE MAINTENANCE EQUIPMENT
2 - FIRE/EXPLOSION	7 - SEPARATION OF UNITS	12 - DOWNHILL RUNAWAY	17 - ANIMAL - FARM	23 - STRUCK BY FALLING, SHIFTING CARGO OR ANYTHING SET IN MOTION BY A MOTOR VEHICLE
3 - IMMERSION	8 - RAN OFF ROAD RIGHT	13 - OTHER NON-COLLISION	18 - ANIMAL - DEER	24 - OTHER MOVABLE OBJECT
4 - JACKKNIFE	9 - RAN OFF ROAD LEFT	14 - PEDESTRIAN	19 - ANIMAL - OTHER	
5 - CARGO / EQUIPMENT LOSS OR SHIFT	10 - CROSS MEDIAN	15 - PEDALCYCLE	20 - MOTOR VEHICLE IN TRANSPORT	
			21 - PARKED MOTOR VEHICLE	

OF THROUGH LANES ON ROAD 4

RAIL GRADE CROSSING 1

1 - NOT INVOLVED 2 - INVOLVED-ACTIVE CROSSING 3 - INVOLVED-PASSIVE CROSSING

COLLISION WITH FIXED OBJECT STRUCK

25 - IMPACT ATTENUATOR / CRASH CUSHION	31 - GUARDRAIL END	37 - TRAFFIC SIGN POST	43 - CURB	50 - WORK ZONE MAINTENANCE EQUIPMENT
26 - BRIDGE OVERHEAD STRUCTURE	32 - PORTABLE BARRIER	38 - OVERHEAD SIGN POST	44 - DITCH	51 - WALL
27 - BRIDGE PIER OR ABUTMENT	33 - MEDIAN CABLE BARRIER	39 - LIGHT / LUMINARIES SUPPORT	45 - EMBANKMENT	52 - BUILDING
28 - BRIDGE PARAPET	34 - MEDIAN GUARDRAIL BARRIER	40 - UTILITY POLE	46 - FENCE	53 - TUNNEL
29 - BRIDGE RAIL	35 - MEDIAN CONCRETE BARRIER	41 - OTHER POST, POLE OR SUPPORT	47 - MAILBOX	54 - OTHER FIXED OBJECT
30 - GUARDRAIL FACE	36 - MEDIAN OTHER BARRIER	42 - CULVERT	48 - TREE	99 - OTHER / UNKNOWN
			49 - FIRE HYDRANT	

FIRST HARMFUL EVENT 1 MOST HARMFUL EVENT 1

UNIT / NON-MOTORIST DIRECTION

FROM 2 TO 1

1 - NORTH 5 - NORTHEAST 2 - SOUTH 6 - NORTHWEST 3 - EAST 7 - SOUTHEAST 4 - WEST 8 - SOUTHWEST 9 - OTHER / UNKNOWN

UNIT SPEED 000

POSTED SPEED 35

DETECTED SPEED 1

1 - STATED / ESTIMATED SPEED 2 - CALCULATED / EDR 3 - UNDETERMINED



MOTORIST / Non-MOTORIST

LOCAL REPORT NUMBER
2 3 0 2 4 7 9 9

UNIT # 0 1	NAME: LAST, FIRST, MIDDLE Pun, Shishir	DATE OF BIRTH 0 2 0 2 1 9 9 7	AGE 2 6	GENDER M
---------------	---	----------------------------------	------------	-------------

ADDRESS: STREET, CITY, STATE, ZIP
20 Woodsfield Ct Apt A, Fairfield, OH 45014

CONTACT PHONE - INCLUDE AREA CODE

INJURIES 5	INJURED TAKEN BY	EMS AGENCY (NAME)	INJURED TAKEN TO: MEDICAL FACILITY (NAME, CITY)	SAFETY EQUIPMENT USED 0 4	<input type="checkbox"/> DOT-COMPLIANT MC HELMET	SEATING POSITION 0 1	AIR BAG USAGE 1	EJECTION 1	TRAPPED 1
DL STATE OH	OPERATOR LICENSE NUMBER		OFFENSE CHARGED 333.03A	LOCAL CODE <input checked="" type="checkbox"/>	OFFENSE DESCRIPTION ACDA		CITATION NUMBER 254065		
DL CLASS 4	ENDORSEMENT SELECT UP TO 2	RESTRICTION SELECT UP TO 3	DRIVER DISTRACTED BY 1	ALCOHOL / DRUG SUSPECTED <input type="checkbox"/> ALCOHOL <input type="checkbox"/> MARIJUANA <input type="checkbox"/> OTHER DRUG		CONDITION 1	ALCOHOL TEST STATUS TYPE VALUE 1 1		DRUG TEST(S) STATUS TYPE RESULT SELECT UP TO 4 1 1

UNIT # 0 2	NAME: LAST, FIRST, MIDDLE Nadeau, Christopher	DATE OF BIRTH 1 1 1 5 1 9 7 1	AGE 5 1	GENDER M
---------------	--	----------------------------------	------------	-------------

ADDRESS: STREET, CITY, STATE, ZIP
4823 East Blvd NW, Canton, OH 44718

CONTACT PHONE - INCLUDE AREA CODE

INJURIES 5	INJURED TAKEN BY	EMS AGENCY (NAME)	INJURED TAKEN TO: MEDICAL FACILITY (NAME, CITY)	SAFETY EQUIPMENT USED 0 4	<input type="checkbox"/> DOT-COMPLIANT MC HELMET	SEATING POSITION 0 1	AIR BAG USAGE 1	EJECTION 1	TRAPPED 1
DL STATE OH	OPERATOR LICENSE NUMBER		OFFENSE CHARGED	LOCAL CODE <input type="checkbox"/>	OFFENSE DESCRIPTION		CITATION NUMBER		
DL CLASS 4	ENDORSEMENT SELECT UP TO 2	RESTRICTION SELECT UP TO 3	DRIVER DISTRACTED BY 1	ALCOHOL / DRUG SUSPECTED <input type="checkbox"/> ALCOHOL <input type="checkbox"/> MARIJUANA <input type="checkbox"/> OTHER DRUG		CONDITION 1	ALCOHOL TEST STATUS TYPE VALUE 1 1		DRUG TEST(S) STATUS TYPE RESULT SELECT UP TO 4 1 1

UNIT #	NAME: LAST, FIRST, MIDDLE	DATE OF BIRTH	AGE 0	GENDER
--------	---------------------------	---------------	----------	--------

ADDRESS: STREET, CITY, STATE, ZIP

CONTACT PHONE - INCLUDE AREA CODE

INJURIES	INJURED TAKEN BY	EMS AGENCY (NAME)	INJURED TAKEN TO: MEDICAL FACILITY (NAME, CITY)	SAFETY EQUIPMENT USED	<input type="checkbox"/> DOT-COMPLIANT MC HELMET	SEATING POSITION	AIR BAG USAGE	EJECTION	TRAPPED
DL STATE	OPERATOR LICENSE NUMBER		OFFENSE CHARGED	LOCAL CODE <input type="checkbox"/>	OFFENSE DESCRIPTION		CITATION NUMBER		
DL CLASS	ENDORSEMENT SELECT UP TO 2	RESTRICTION SELECT UP TO 3	DRIVER DISTRACTED BY	ALCOHOL / DRUG SUSPECTED <input type="checkbox"/> ALCOHOL <input type="checkbox"/> MARIJUANA <input type="checkbox"/> OTHER DRUG		CONDITION	ALCOHOL TEST STATUS TYPE VALUE		DRUG TEST(S) STATUS TYPE RESULT SELECT UP TO 4

INJURIES	SEATING POSITION	AIR BAG	DL CLASS	DL RESTRICTION(S)	DRIVER DISTRACTION	TEST STATUS
1-FATAL 2-SUSPECTED SERIOUS INJURY 3-SUSPECTED MINOR INJURY 4-POSSIBLE INJURY 5-NO APPARENT INJURY	1-FRONT-LEFT SIDE (MOTORCYCLE DRIVER) 2-FRONT-MIDDLE 3-FRONT-RIGHT SIDE 4-SECOND-LEFT SIDE (MOTORCYCLE PASSENGER) 5-SECOND-MIDDLE 6-SECOND-RIGHT SIDE 7-THIRD-LEFT SIDE (MOTORCYCLE SIDE CAR) 8-THIRD-MIDDLE 9-THIRD-RIGHT SIDE 10-SLEEPER SECTION OF TRUCK CAB	1-NOT DEPLOYED 2-DEPLOYED FRONT 3-DEPLOYED SIDE 4-DEPLOYED BOTH FRONT/SIDE 5-NOT APPLICABLE 9-DEPLOYMENT UNKNOWN	1-CLASS A 2-CLASS B 3-CLASS C 4-REGULAR CLASS (OHIO=DI) 5-M/C MOPED ONLY 6-NO VALID DL	1-ALCOHOL INTERLOCK DEVICE 2-CDL INTRASTATE ONLY 3-CORRECTIVE LENSES 4-FARM WAIVER 5-EXCEPT CLASS A BUS 6-EXCEPT CLASS A & CLASS B BUS 7-EXCEPT TRACTOR-TRAILER 8-INTERMEDIATE LICENSE RESTRICTIONS 9-LEARNER'S PERMIT RESTRICTIONS 10-LIMITED TO DAYLIGHT ONLY 11-LIMITED TO EMPLOYMENT 12-LIMITED-OTHER 13-MECHANICAL DEVICES (SPECIAL BRAKES, HAND CONTROLS, OR OTHER ADAPTIVE DEVICES) 14-MILITARY VEHICLES ONLY 15-MOTOR VEHICLES WITHOUT AIR BRAKES 16-OUTSIDE MIRROR 17-PROSTHETIC AID 18-OTHER	1-NOT DISTRACTED 2-MANUALLY OPERATING AN ELECTRONIC COMMUNICATION DEVICE (TEXTING, TYPING, DIALING) 3-TALKING ON HANDS-FREE COMMUNICATION DEVICE 4-TALKING ON HAND-HELD COMMUNICATION DEVICE 5-OTHER ACTIVITY WITH AN ELECTRONIC DEVICE 6-PASSENGER 7-OTHER DISTRACTION INSIDE THE VEHICLE 8-OTHER DISTRACTION OUTSIDE THE VEHICLE 9-OTHER/UNKNOWN	1-NONE GIVEN 2-TEST REFUSED 3-TEST GIVEN, CONTAMINATED SAMPLE/UNUSABLE 4-TEST GIVEN, RESULTS KNOWN 5-TEST GIVEN, RESULTS UNKNOWN
INJURED TAKEN BY 1-NOT TRANSPORTED / TREATED AT SCENE 2-EMS 3-POLICE 9-OTHER/UNKNOWN	EJECTION 1-NOT EJECTED 2-PARTIALLY EJECTED 3-TOTALLY EJECTED 4-NOT APPLICABLE	TRAPPED 1-NOT TRAPPED 2-EXTRICATED BY MECHANICAL MEANS 3-FREED BY NON-MECHANICAL MEANS	DL ENDORSEMENT H-HAZMAT M-MOTORCYCLE P-PASSENGER N-TANKER Q-MOTOR SCOOTER R-THREE-WHEEL MOTORCYCLE S-SCHOOL BUS T-DOUBLE & TRIPLE TRAILERS X-TANKER/HAZMAT	CONDITION 1-APPARENTLY NORMAL 2-PHYSICAL IMPAIRMENT 3-EMOTIONAL (E.G., DEPRESSED, ANGRY, DISTURBED) 4-ILLNESS 5-FELL ASLEEP, FAINTED, FATIGUED, ETC. 6-UNDER THE INFLUENCE OF MEDICATIONS/DRUGS /ALCOHOL 9-OTHER/UNKNOWN	ALCOHOL TEST TYPE 1-NONE 2-BLOOD 3-URINE 4-BREATH 5-OTHER	DRUG TEST TYPE 1-NONE 2-BLOOD 3-URINE 4-OTHER
SAFETY EQUIPMENT 1-NONE USED 2-SHOULDER BELT ONLY USED 3-LAP BELT ONLY USED 4-SHOULDER & LAP BELT USED 5-CHILD RESTRAINT SYSTEM - FORWARD FACING 6-CHILD RESTRAINT SYSTEM - REAR FACING 7-BOOSTER SEAT 8-HELMET USED 9-PROTECTIVE PADS USED (ELBOW, KNEES, ETC.) 10-REFLECTIVE CLOTHING 11-LIGHTING - PEDESTRIAN / BICYCLE ONLY 99-OTHER/UNKNOWN	RESTRICTION SELECT UP TO 3 11-PASSENGER IN OTHER ENCLOSED CARGO AREA (NON-TRAILING UNIT, BUS, PICK-UP WITH CAP) 12-PASSENGER IN UNENCLOSED CARGO AREA 13-TRAILING UNIT 14-RIDING ON VEHICLE EXTERIOR (NON-TRAILING UNIT) 15-NON-MOTORIST 99-OTHER/UNKNOWN	ALCOHOL / DRUG SUSPECTED <input type="checkbox"/> ALCOHOL <input type="checkbox"/> MARIJUANA <input type="checkbox"/> OTHER DRUG	GENDER F-FEMALE M-MALE U-OTHER/UNKNOWN	DRUG TEST RESULT(S) 1-AMPHETAMINES 2-BARBITURATES 3-BENZODIAZEPINES 4-CANNABINOIDS 5-COCAINE 6-OPiates/OPIOIDS 7-OTHER 8-NEGATIVE RESULTS		



OCCUPANT / WITNESS ADDENDUM

LOCAL REPORT NUMBER									
2	3	0	2	4	7	9	9		

OCCUPANT	UNIT #	NAME: LAST, FIRST, MIDDLE							
	2	Vitale, Colleen							
	ADDRESS: STREET, CITY, STATE, ZIP								
3582 Dunlop Ct, Mason, OH 45040									
INJURIES	INJURED TAKEN BY	EMS AGENCY (NAME)	INJURED TAKEN TO: MEDICAL FACILITY (NAME, CITY)	SAFETY EQUIPMENT USED	DOT-COMPLIANT MC HELMET	SEATING POSITION	AIR BAG USAGE	EJECTION	TRAPPED
5				0 4	<input type="checkbox"/>	0 1	0 1	1	1

DATE OF BIRTH			AGE	GENDER
0	5	0	4	1
9	5	9	6	3
				F
CONTACT PHONE - INCLUDE AREA CODE				

OCCUPANT	UNIT #	NAME: LAST, FIRST, MIDDLE							
	ADDRESS: STREET, CITY, STATE, ZIP								
INJURIES	INJURED TAKEN BY	EMS AGENCY (NAME)	INJURED TAKEN TO: MEDICAL FACILITY (NAME, CITY)	SAFETY EQUIPMENT USED	DOT-COMPLIANT MC HELMET	SEATING POSITION	AIR BAG USAGE	EJECTION	TRAPPED
					<input type="checkbox"/>				

DATE OF BIRTH			AGE	GENDER
			0	
CONTACT PHONE - INCLUDE AREA CODE				

OCCUPANT	UNIT #	NAME: LAST, FIRST, MIDDLE							
	ADDRESS: STREET, CITY, STATE, ZIP								
INJURIES	INJURED TAKEN BY	EMS AGENCY (NAME)	INJURED TAKEN TO: MEDICAL FACILITY (NAME, CITY)	SAFETY EQUIPMENT USED	DOT-COMPLIANT MC HELMET	SEATING POSITION	AIR BAG USAGE	EJECTION	TRAPPED
					<input type="checkbox"/>				

DATE OF BIRTH			AGE	GENDER
			0	
CONTACT PHONE - INCLUDE AREA CODE				

OCCUPANT	UNIT #	NAME: LAST, FIRST, MIDDLE							
	ADDRESS: STREET, CITY, STATE, ZIP								
INJURIES	INJURED TAKEN BY	EMS AGENCY (NAME)	INJURED TAKEN TO: MEDICAL FACILITY (NAME, CITY)	SAFETY EQUIPMENT USED	DOT-COMPLIANT MC HELMET	SEATING POSITION	AIR BAG USAGE	EJECTION	TRAPPED
					<input type="checkbox"/>				

DATE OF BIRTH			AGE	GENDER
			0	
CONTACT PHONE - INCLUDE AREA CODE				

INJURIES	SAFETY EQUIPMENT USED	SEATING POSITION	AIR BAG USAGE
1 - FATAL	1 - NONE USED - VEHICLE OCCUPANT	1 - FRONT - LEFT SIDE (MOTORCYCLE DRIVER)	1 - NOT DEPLOYED
2 - SUSPECTED SERIOUS INJURY	2 - SHOULDER BELT ONLY USED	2 - FRONT - MIDDLE	2 - DEPLOYED FRONT
3 - SUSPECTED MINOR INJURY	3 - LAP BELT ONLY USED	3 - FRONT - RIGHT SIDE	3 - DEPLOYED SIDE
4 - POSSIBLE INJURY	4 - SHOULDER & LAP BELT USED	4 - SECOND - LEFT SIDE (MOTORCYCLE PASSENGER)	4 - DEPLOYED BOTH FRONT/SIDE
5 - NO APPARENT INJURY	5 - CHILD RESTRAINT SYSTEM - FORWARD FACING	5 - SECOND - MIDDLE	5 - NOT APPLICABLE
	6 - CHILD RESTRAINT SYSTEM - REAR FACING	6 - SECOND - RIGHT SIDE	9 - DEPLOYMENT UNKNOWN
	7 - BOOSTER SEAT	7 - THIRD - LEFT SIDE (MOTORCYCLE SIDE CAR)	
	8 - HELMET USED	8 - THIRD - MIDDLE	
	9 - PROTECTIVE PADS USED (ELBOW, KNEES, ETC.)	9 - THIRD - RIGHT SIDE	
	10 - REFLECTIVE CLOTHING	10 - SLEEPER SECTION OF TRUCK CAB	
	11 - LIGHTING - PEDESTRIAN / BICYCLE ONLY	11 - PASSENGER IN OTHER ENCLOSED CARGO AREA (NON-TRAILING UNIT, BUS, PICK-UP WITH CAP)	
	99 - OTHER / UNKNOWN	12 - PASSENGER IN UNENCLOSED CARGO AREA	
		13 - TRAILING UNIT	
		14 - RIDING ON VEHICLE EXTERIOR (NON-TRAILING UNIT)	
		15 - NON-MOTORIST	
		99 - OTHER / UNKNOWN	

WITNESS	NAME: LAST, FIRST, MIDDLE	DATE OF BIRTH			AGE	GENDER
					0	
	ADDRESS: STREET, CITY, STATE, ZIP					
CONTACT PHONE - INCLUDE AREA CODE						

DATE OF BIRTH			AGE	GENDER
			0	
CONTACT PHONE - INCLUDE AREA CODE				

WITNESS	NAME: LAST, FIRST, MIDDLE	DATE OF BIRTH			AGE	GENDER
					0	
	ADDRESS: STREET, CITY, STATE, ZIP					
CONTACT PHONE - INCLUDE AREA CODE						

DATE OF BIRTH			AGE	GENDER
			0	
CONTACT PHONE - INCLUDE AREA CODE				

WITNESS	NAME: LAST, FIRST, MIDDLE	DATE OF BIRTH			AGE	GENDER
					0	
	ADDRESS: STREET, CITY, STATE, ZIP					
CONTACT PHONE - INCLUDE AREA CODE						

DATE OF BIRTH			AGE	GENDER
			0	
CONTACT PHONE - INCLUDE AREA CODE				

LOCAL REPORT NUMBER PD-23-024799	REPORTING AGENCY Fairfield Police Department	DATE OF ACCIDENT 4/5/23
IN COUNTY OF Butler	ACCIDENT LOCATION 5410 S.R.4 (Dixie Hwy), Fairfield, OH 45014	

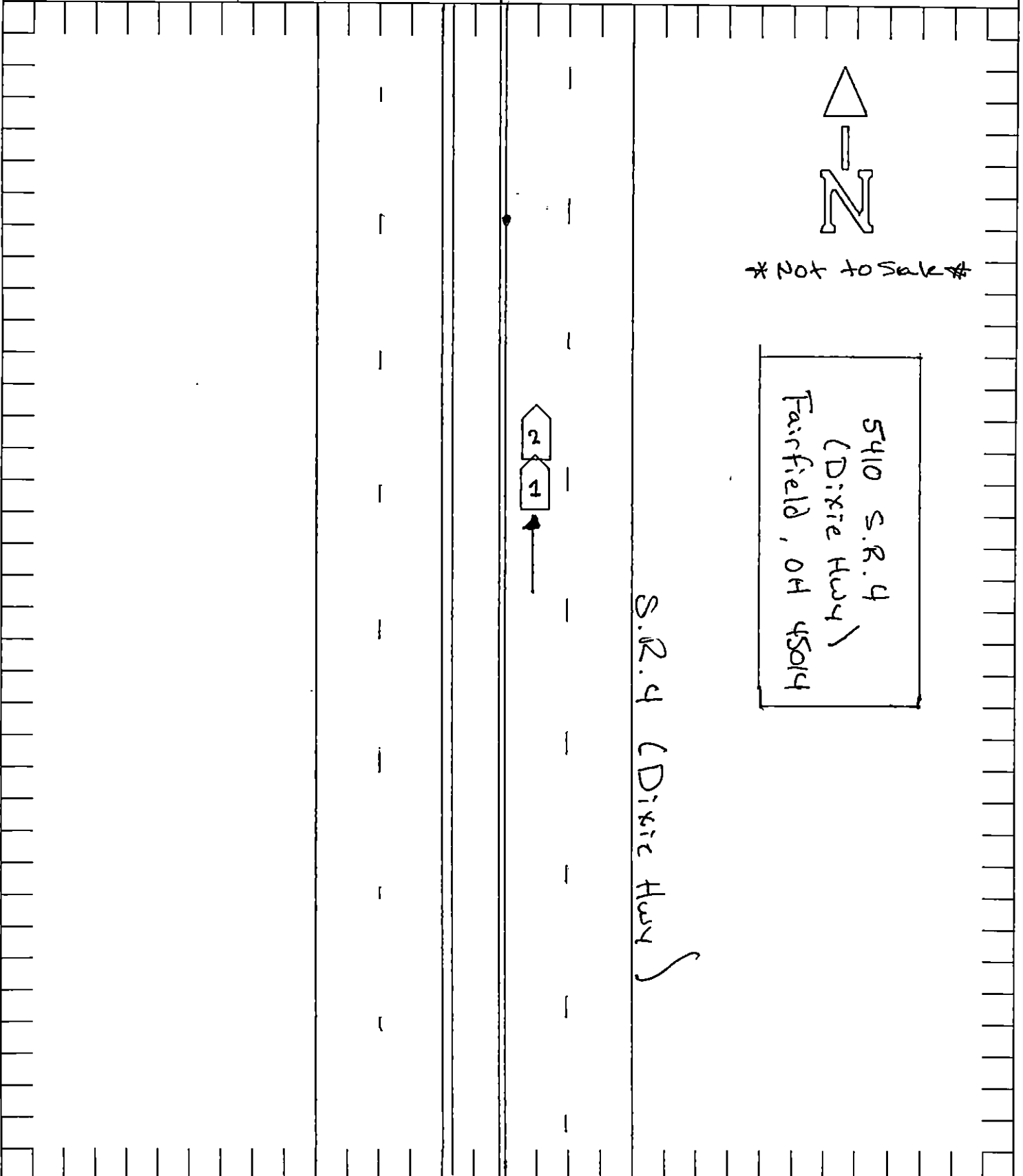

OFFICER'S SIGNATURE J.Mitchell	BADGE NO 171
-----------------------------------	-----------------