



TRAFFIC CRASH REPORT

*DENOTES MANDATORY FIELD FOR SUPPLEMENT REPORT

LOCAL REPORT NUMBER*

<input checked="" type="checkbox"/> PHOTOS TAKEN	<input checked="" type="checkbox"/> OH-2	<input type="checkbox"/> OH-3	LOCAL INFORMATION			2 3 0 2 6 4 6 5		
<input type="checkbox"/> SECONDARY CRASH	<input checked="" type="checkbox"/> OH-1P	<input type="checkbox"/> OTHER	REPORTING AGENCY NAME*			HITS/SKIP		
<input type="checkbox"/> PRIVATE PROPERTY			Fairfield Police Department			1 - SOLVED		
			NCIC*			2 - UNSOLVED		
			0 0 9 0 1			NUMBER OF UNITS		
						0 2		
						UNIT IN ERROR		
						98 - ANIMAL		
						99 - UNKNOWN		

COUNTY*	LOCALITY*	LOCATION: CITY, VILLAGE, TOWNSHIP*			CRASH DATE / TIME*			CRASH SEVERITY		
0 9	1	City of Fairfield			0 4 1 2 2 0 2 3 1 7 1 9			5		
								1 - FATAL		
								2 - SERIOUS INJURY SUSPECTED		
								3 - MINOR INJURY SUSPECTED		
								4 - INJURY POSSIBLE		
								5 - PROPERTY DAMAGE ONLY		

ROUTE TYPE	ROUTE NUMBER	PREFIX	1 - NORTH 2 - SOUTH 3 - EAST 4 - WEST	LOCATION ROAD NAME	ROAD TYPE	LATITUDE DECIMAL DEGREES		
				Nilles	R d	3 9 . 3 3 7 9 2 9		
ROUTE TYPE	ROUTE NUMBER	PREFIX	1 - NORTH 2 - SOUTH 3 - EAST 4 - WEST	REFERENCE ROAD NAME (ROAD, MILEPOST, HOUSE #)	ROAD TYPE	LONGITUDE DECIMAL DEGREES		
				River	R d	- 8 4 . 5 6 8 4 1 1		

REFERENCE POINT	DIRECTION FROM REFERENCE	ROUTE TYPE	ROAD TYPE	INTERSECTION RELATED		
1 - INTERSECTION	1 - NORTH	IR - INTERSTATE ROUTE (TP)	AL - ALLEY	<input checked="" type="checkbox"/> WITHIN INTERSECTION OR ON APPROACH		
2 - MILE POST	2 - SOUTH	US - FEDERAL US ROUTE	AV - AVENUE	<input type="checkbox"/> WITHIN INTERCHANGE AREA		
3 - HOUSE #	3 - EAST	SR - STATE ROUTE	BL - BOULEVARD	NUMBER OF APPROACHES		
	4 - WEST	CR - NUMBERED COUNTY ROUTE	MP - MILEPOST	4		
		TR - NUMBERED TOWNSHIP ROUTE	ST - STREET			
			OV - OVAL			
			PK - PARKWAY			
			TE - TERRACE			
			TL - TRAIL			
			WA - WAY			
			PL - PLACE			
				<input type="checkbox"/> ROADWAY DIVIDED		

LOCATION OF FIRST HARMFUL EVENT	MANNER OF CRASH COLLISION/IMPACT	DIRECTION OF TRAVEL	MEDIAN TYPE
0 1	6	1 - NORTH 2 - SOUTH 3 - EAST 4 - WEST	1 - DIVIDED FLUSH MEDIAN (<4 FEET) 2 - DIVIDED FLUSH MEDIAN (≥4 FEET) 3 - DIVIDED, DEPRESSED MEDIAN 4 - DIVIDED, RAISED MEDIAN (ANY TYPE) 9 - OTHER/UNKNOWN

<input type="checkbox"/> WORK ZONE RELATED	WORK ZONE TYPE	LOCATION OF CRASH IN WORK ZONE	CONTOUR	CONDITIONS	SURFACE
<input type="checkbox"/> WORKERS PRESENT	1 - LANE CLOSURE	1 - BEFORE THE 1ST WORK ZONE WARNING SIGN	1	1	2
<input type="checkbox"/> LAW ENFORCEMENT PRESENT	2 - LANE SHIFT/CROSSOVER	2 - ADVANCE WARNING AREA	2 - STRAIGHT GRADE	2 - WET	2 - BLACKTOP, BITUMINOUS, ASPHALT
<input type="checkbox"/> ACTIVE SCHOOL ZONE	3 - WORK ON SHOULDER OR MEDIAN	3 - TRANSITION AREA	3 - CURVE LEVEL	3 - SNOW	3 - BRICK/BLOCK
	4 - INTERMITTENT OR MOVING WORK	4 - ACTIVITY AREA	4 - CURVE GRADE	4 - ICE	4 - SLAG, GRAVEL, STONE
	5 - OTHER	5 - TERMINATION AREA	9 - OTHER/UNKNOWN	5 - SAND, MUD, DIRT, OIL, GRAVEL	5 - DIRT
				6 - WATER (STANDING, MOVING)	9 - OTHER/UNKNOWN
				7 - SLUSH	
				9 - OTHER/UNKNOWN	

LIGHT CONDITION	WEATHER
1	0 1

NARRATIVE

On 04-12-2023 at 5:19 PM. Unit 1 was traveling east on River Rd. and attempting to turn left onto River Rd. to continue north on River Rd. In so doing Unit 1 struck unit 2 who was traveling west on Nilles Rd. attempting to make a right hand turn on River Rd. to continue north on River Rd.

SEE OH-2

Indicate the north direction with an "N" on the compass diagram.

CRASH REPORTED DATE / TIME	DISPATCH DATE / TIME	ARRIVAL DATE / TIME	SCENE CLEARED DATE / TIME	REPORT TAKEN BY
0 4 1 2 2 0 2 3 1 7 1 9	0 4 1 2 2 0 2 3 1 7 2 2	0 4 1 2 2 0 2 3 1 7 3 0	0 4 1 2 2 0 2 3 1 7 4 7	<input checked="" type="checkbox"/> POLICE AGENCY
TOTAL TIME ROADWAY CLOSED	OTHER INVESTIGATION TIME	TOTAL MINUTES	OFFICER'S NAME*	<input type="checkbox"/> MOTORIST
	1 0	3 5	T. King	<input type="checkbox"/> SUPPLEMENT (CORRECTION OR ADDITION TO AN EXISTING REPORT SENT TO OHS)
			OFFICER'S BADGE NUMBER*	
			1 6 1	
			CHECKED BY OFFICER'S NAME*	
			D. Paul	
			CHECKED BY OFFICER'S BADGE NUMBER*	
			1 3 0	

LOCAL REPORT NUMBER
 2, 3, 0, 2, 6, 4, 6, 5

OWNER
 UNIT # 01 OWNER NAME: LAST, FIRST, MIDDLE (SAME AS DRIVER)
 OWNER PHONE: INCLUDE AREA CODE (SAME AS DRIVER)
 OWNER ADDRESS: STREET, CITY, STATE, ZIP (SAME AS DRIVER)
 COMMERCIAL CARRIER: NAME, ADDRESS, CITY, STATE, ZIP
 COMMERCIAL CARRIER PHONE: INCLUDE AREA CODE

DAMAGE
 DAMAGE SCALE
2 1 - NONE 3 - FUNCTIONAL DAMAGE
 2 - MINOR DAMAGE 4 - DISABLING DAMAGE
 9 - UNKNOWN

VEHICLE
 LP STATE OH LICENSE PLATE # JBE6144 VEHICLE IDENTIFICATION # 4S14WMAFD14L13145162142 VEHICLE YEAR 2020 VEHICLE MAKE Subaru
 INSURANCE VERIFIED INSURANCE COMPANY Allstate INSURANCE POLICY # 99216340 COLOR Gray VEHICLE MODEL Ascend

DAMAGED AREA(S)
 INDICATE ALL THAT APPLY

TYPE OF USE
 COMMERCIAL GOVERNMENT IN EMERGENCY RESPONSE
 INTERLOCK DEVICE EQUIPPED HIT/SKIP UNIT # OCCUPANTS 02
 US DOT # _____ TOWED BY: COMPANY NAME _____
 VEHICLE WEIGHT GVWR/GCWR
 1 - ≤10K LBS.
 2 - 10,001 - 26K LBS.
 3 - >26K LBS.
 HAZARDOUS MATERIAL
 MATERIAL RELEASED CLASS # _____ PLACARD ID # _____
 PLACARD _____

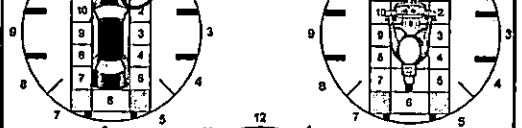

UNIT TYPE 03
 1 - PASSENGER CAR 7 - MOTORCYCLE 2-WHEELED 12 - GOLF CART 18 - LIMO (LIVERY VEHICLE) 23 - PEDESTRIAN / SKATER
 2 - PASSENGER VAN (MINIVAN) 8 - MOTORCYCLE 3-WHEELED 13 - SNOWMOBILE 19 - BUS (16+ PASSENGERS) 24 - WHEELCHAIR (ANY TYPE)
 3 - SPORT UTILITY VEHICLE 9 - AUTOCYCLE 14 - SINGLE UNIT TRUCK 20 - OTHER VEHICLE 25 - OTHER NON-MOTORIST
 4 - PICK UP 10 - MOPED OR MOTORIZED BICYCLE 15 - SEMI-TRACTOR 21 - HEAVY EQUIPMENT 26 - BICYCLE
 5 - CARGO VAN 11 - ALL TERRAIN VEHICLE (ATV / UTV) 16 - FARM EQUIPMENT 22 - ANIMAL WITH RIDER OR ANIMAL-DRAWN VEHICLE 27 - TRAIN
 6 - VAN (9-15 SEATS) 17 - MOTORHOME

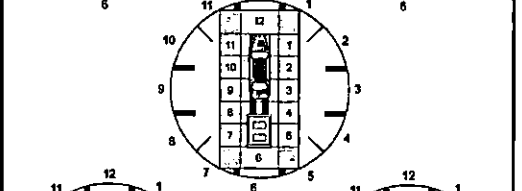

OF TRAILING UNITS 0
 WAS VEHICLE OPERATING IN AUTONOMOUS MODE WHEN CRASH OCCURRED?
02 1 - YES 2 - NO 9 - OTHER / UNKNOWN
 AUTONOMOUS MODE LEVEL
 0 - NO AUTOMATION 1 - DRIVER ASSISTANCE 2 - PARTIAL AUTOMATION 3 - CONDITIONAL AUTOMATION 4 - HIGH AUTOMATION 5 - FULL AUTOMATION 9 - UNKNOWN

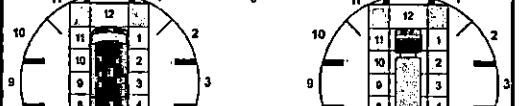

SPECIAL FUNCTION 01
 1 - NONE 6 - BUS - CHARTER/TOUR 11 - FIRE 16 - FARM 21 - MAIL CARRIER
 2 - TAXI 7 - BUS - INTERCITY 12 - MILITARY 17 - MOWING 99 - OTHER / UNKNOWN
 3 - ELECTRONIC RIDE SHARING 8 - BUS - SHUTTLE 13 - POLICE 18 - SNOW REMOVAL
 4 - SCHOOL TRANSPORT 9 - BUS - OTHER 14 - PUBLIC UTILITY 19 - TOWING
 5 - BUS - TRANSIT/COMMUTER 10 - AMBULANCE 15 - CONSTRUCTION EQUIPMENT 20 - SAFETY SERVICE PATROL

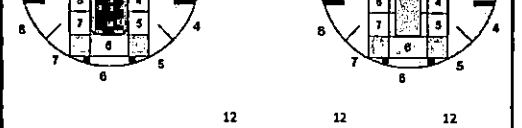

CARGO BODY TYPE 01
 1 - NO CARGO BODY TYPE / NOT APPLICABLE 3 - VEHICLE TOWING ANOTHER MOTOR VEHICLE 5 - INTERMODAL CONTAINER CHASSIS 8 - POLE 12 - CONCRETE MIXER
 2 - BUS 4 - LOGGING 6 - CARGO VAN/ENCLOSED BOX 10 - FLAT BED 14 - GARBAGE/REFUSE
 7 - GRAIN/WHIPS/GRAVEL 11 - DUMP 99 - OTHER / UNKNOWN



VEHICLE DEFECTS
 1 - TURN SIGNALS 4 - BRAKES 7 - WORN OR SLICK TIRES 9 - MOTOR TROUBLE 99 - OTHER / UNKNOWN
 2 - HEAD LAMPS 5 - STEERING 8 - TRAILER EQUIPMENT DEFECTIVE 10 - DISABLED FROM PRIOR ACCIDENT
 3 - TAIL LAMPS 6 - TIRE BLOWOUT



NON-MOTORIST LOCATION AT IMPACT
 1 - INTERSECTION - MARKED CROSSWALK 3 - INTERSECTION - OTHER 6 - BICYCLE LANE 9 - MEDIAN/CROSSING ISLAND 12 - FIRST RESPONDER AT INCIDENT SCENE
 2 - INTERSECTION - UNMARKED CROSSWALK 4 - MIDBLOCK - MARKED CROSSWALK 7 - SHOULDER / ROADSIDE 10 - DRIVEWAY ACCESS 11 - SHARED USE PATHS OR TRAILS 14 - UNDERCARRIAGE
 5 - TRAVEL LANE - OTHER LOCATION 8 - SIDEWALK 99 - OTHER / UNKNOWN

INITIAL POINT OF CONTACT
01 0 - NO DAMAGE 14 - UNDERCARRIAGE
 1-12 - REFER TO UNIT DIAGRAM 15 - VEHICLE NOT AT SCENE
 13 - TOP 99 - UNKNOWN

ACTION 03
 1 - NON-CONTACT 1 - STRAIGHT AHEAD 7 - MAKING U-TURN 13 - NEGOTIATING A CURVE 18 - APPROACHING OR LEAVING VEHICLE
 2 - NON-COLLISION 2 - BACKING 8 - ENTERING TRAFFIC LANE 14 - ENTERING OR CROSSING SPECIFIED LOCATION 19 - STANDING
 3 - STRIKING 06 3 - CHANGING LANES 9 - LEAVING TRAFFIC LANE 15 - WALKING, RUNNING, JOGGING, PLAYING 20 - OTHER NON-MOTORIST
 4 - STRUCK PRE-CRASH ACTIONS 5 - OVERTAKING/PASSING 10 - PARKED 16 - WORKING 21 - STANDING OUTSIDE DISABLED VEHICLE
 5 - BOTH STRIKING & STRUCK 5 - MAKING RIGHT TURN 11 - SLOWING OR STOPPED IN TRAFFIC 17 - PUSHING VEHICLE 99 - OTHER / UNKNOWN
 9 - OTHER / UNKNOWN 6 - MAKING LEFT TURN 12 - DRIVERLESS

TRAFFIC
 TRAFFICWAY FLOW 2 1 - ONE-WAY 2 - TWO-WAY
 TRAFFIC CONTROL 2 1 - ROUNDABOUT 4 - STOP SIGN 2 - SIGNAL 5 - YIELD SIGN 3 - FLASHER 6 - NO CONTROL

CONTRIBUTING CIRCUMSTANCES 02
 1 - NONE 7 - LEFT OF CENTER 13 - IMPROPER START FROM A PARKED POSITION 17 - VISION OBSTRUCTION 21 - LYING IN ROADWAY
 2 - FAILURE TO YIELD 8 - FOLLOWING TOO CLOSE / ACDA 14 - STOPPED OR PARKED ILLEGALLY 18 - OPERATING DEFECTIVE EQUIPMENT 22 - NOT DISCERNIBLE
 3 - RAN RED LIGHT 9 - IMPROPER LANE CHANGE 15 - SWERVING TO AVOID 19 - LOAD SHIFTING/FALLING/SPILLING 23 - OPENING DOOR INTO ROADWAY
 4 - RAN STOP SIGN 10 - IMPROPER PASSING 16 - WRONG WAY 20 - IMPROPER CROSSING 99 - OTHER IMPROPER ACTION
 5 - UNSAFE SPEED 11 - DROVE OFF ROAD 21 - IMPROPER BACKING
 6 - IMPROPER TURN 12 - IMPROPER BACKING

OF THROUGH LANES ON ROAD 3
 RAIL GRADE CROSSING 1 1 - NOT INVOLVED 2 - INVOLVED-ACTIVE CROSSING 3 - INVOLVED-PASSIVE CROSSING

SEQUENCE OF EVENTS
 1 20 1 - OVERTURN/ROLLOVER 6 - EQUIPMENT FAILURE 11 - CROSS CENTERLINE - OPPOSITE DIRECTION OF TRAVEL 16 - RAILWAY VEHICLE 22 - WORK ZONE MAINTENANCE EQUIPMENT
 2 _____ 2 - FIRE/EXPLOSION 7 - SEPARATION OF UNITS 12 - DOWNHILL RUNAWAY 17 - ANIMAL - FARM 23 - STRUCK BY FALLING, SHIFTING CARGO OR ANYTHING SET IN MOTION BY A MOTOR VEHICLE
 3 _____ 3 - IMMERSION 8 - RAN OFF ROAD RIGHT 13 - OTHER NON-COLLISION 18 - ANIMAL - DEER 24 - OTHER MOVABLE OBJECT
 4 _____ 4 - JACKKNIFE 9 - RAN OFF ROAD LEFT 14 - PEDESTRIAN 19 - ANIMAL - OTHER 20 - MOTOR VEHICLE IN TRANSPORT
 5 _____ 5 - CARGO / EQUIPMENT LOSS OR SHIFT 10 - CROSS MEDIAN 15 - PEDALCYCLE 21 - PARKED MOTOR VEHICLE

UNIT / NON-MOTORIST DIRECTION
 FROM 4 TO 1
 1 - NORTH 5 - NORTHEAST 2 - SOUTH 6 - NORTHWEST 3 - EAST 7 - SOUTHEAST 4 - WEST 8 - SOUTHWEST 9 - OTHER / UNKNOWN

COLLISION WITH FIXED OBJECT STRUCK
 25 - IMPACT ATTENUATOR / CRASH CUSHION 31 - GUARDRAIL END 37 - TRAFFIC SIGN POST 43 - CURB 50 - WORK ZONE MAINTENANCE EQUIPMENT
 26 - BRIDGE OVERHEAD STRUCTURE 32 - PORTABLE BARRIER 38 - OVERHEAD SIGN POST 44 - DITCH 51 - WALL
 27 - BRIDGE PIER OR ABUTMENT 33 - MEDIAN CABLE BARRIER 39 - LIGHT / LUMINARIES SUPPORT 45 - EMBANKMENT 52 - BUILDING
 28 - BRIDGE PARAPET 34 - MEDIAN GUARDRAIL BARRIER 40 - UTILITY POLE 46 - FENCE 53 - TUNNEL
 29 - BRIDGE RAIL 35 - MEDIAN CONCRETE BARRIER 41 - OTHER POST, POLE OR SUPPORT 47 - MAILBOX 54 - OTHER FIXED OBJECT
 30 - GUARDRAIL FACE 36 - MEDIAN OTHER BARRIER 42 - CULVERT 48 - TREE 99 - OTHER / UNKNOWN
 49 - FIRE HYDRANT

UNIT SPEED 25
 POSTED SPEED 35
 DETECTED SPEED 1 1 - STATED / ESTIMATED SPEED 2 - CALCULATED / EDR 3 - UNDETERMINED

FIRST HARMFUL EVENT 1 MOST HARMFUL EVENT 1

LOCAL REPORT NUMBER
 2, 3, 0, 2, 6, 4, 6, 5

OWNER

UNIT # 012 OWNER NAME: LAST, FIRST, MIDDLE (SAME AS DRIVER) _____
 OWNER PHONE: INCLUDE AREA CODE (SAME AS DRIVER) _____

OWNER ADDRESS: STREET, CITY, STATE, ZIP (SAME AS DRIVER) _____
 COMMERCIAL CARRIER: NAME, ADDRESS, CITY, STATE, ZIP _____
 COMMERCIAL CARRIER PHONE: INCLUDE AREA CODE _____

DAMAGE

DAMAGE SCALE
 1 - NONE 3 - FUNCTIONAL DAMAGE
 2 - MINOR DAMAGE 4 - DISABLING DAMAGE
 9 - UNKNOWN

2

VEHICLE

LP STATE OH LICENSE PLATE # HE209 VEHICLE IDENTIFICATION # JF2SJA R C 5 F H 5 2 3 9 6 9 VEHICLE YEAR 2015 VEHICLE MAKE Subaru

INSURANCE VERIFIED INSURANCE COMPANY USAA INSURANCE POLICY # 476888 COLOR Blue VEHICLE MODEL Forester

DAMAGED AREA(S)
 INDICATE ALL THAT APPLY

TYPE OF USE: COMMERCIAL GOVERNMENT IN EMERGENCY RESPONSE

US DOT # _____ TOWED BY: COMPANY NAME _____

HAZARDOUS MATERIAL: MATERIAL RELEASED CLASS # _____ PLACARD ID # _____

UNIT TYPE 03

1 - PASSENGER CAR	7 - MOTORCYCLE 2-WHEELED	12 - GOLF CART	18 - LIMO (LIVERY VEHICLE)	23 - PEDESTRIAN / SKATER
2 - PASSENGER VAN (MINIVAN)	8 - MOTORCYCLE 3-WHEELED	13 - SNOWMOBILE	19 - BUS (16+ PASSENGERS)	24 - WHEELCHAIR (ANY TYPE)
3 - SPORT UTILITY VEHICLE	9 - AUTOCYCLE	14 - SINGLE UNIT TRUCK	20 - OTHER VEHICLE	25 - OTHER NON-MOTORIST
4 - PICK UP	10 - HOPEL OR MOTORIZED BICYCLE	15 - SEMI-TRACTOR	21 - HEAVY EQUIPMENT	26 - BICYCLE
5 - CARGO VAN	11 - ALL TERRAIN VEHICLE (ATV / UTV)	16 - FARM EQUIPMENT	22 - ANIMAL WITH RIDER OR ANIMAL-DRAWN VEHICLE	27 - TRAIN
6 - VAN (9-15 SEATS)		17 - MOTORHOME		99 - UNKNOWN OR HIT/SKIP

OF TRAILING UNITS 0

WAS VEHICLE OPERATING IN AUTONOMOUS MODE WHEN CRASH OCCURRED?

02

1 - YES	2 - NO	9 - OTHER / UNKNOWN
---------	--------	---------------------

AUTONOMOUS MODE LEVEL 0

0 - NO AUTOMATION	3 - CONDITIONAL AUTOMATION	9 - UNKNOWN
1 - DRIVER ASSISTANCE	4 - HIGH AUTOMATION	
2 - PARTIAL AUTOMATION	5 - FULL AUTOMATION	

SPECIAL FUNCTION 01

1 - NONE	6 - BUS - CHARTER/TOUR	11 - FIRE	16 - FARM	21 - MAIL CARRIER
2 - TAXI	7 - BUS - INTERCITY	12 - MILITARY	17 - MOWING	99 - OTHER / UNKNOWN
3 - ELECTRONIC RIDE SHARING	8 - BUS - SHUTTLE	13 - POLICE	18 - SNOW REMOVAL	
4 - SCHOOL TRANSPORT	9 - BUS - OTHER	14 - PUBLIC UTILITY	19 - TOWING	
5 - BUS - TRANSIT/COMMUTER	10 - AMBULANCE	15 - CONSTRUCTION EQUIPMENT	20 - SAFETY SERVICE PATROL	

NO MOTORIST LOCATION AT IMPACT

1 - INTERSECTION - MARKED CROSSWALK	3 - INTERSECTION - OTHER	6 - BICYCLE LANE	9 - MEDIAN/CROSSING ISLAND	12 - FIRST RESPONDER AT INCIDENT SCENE
2 - INTERSECTION - UNMARKED CROSSWALK	4 - MIDBLOCK - MARKED CROSSWALK	7 - SHOULDER / ROADSIDE	10 - DRIVEWAY ACCESS	99 - OTHER / UNKNOWN
	5 - TRAVEL LANE - OTHER LOCATION	8 - SIDEWALK	11 - SHARED USE PATHS OR TRAILS	

CARGO BODY TYPE 01

1 - NO CARGO BODY TYPE / NOT APPLICABLE	3 - VEHICLE TOWING ANOTHER MOTOR VEHICLE	5 - INTERMODAL CONTAINER CHASSIS	8 - POLE	12 - CONCRETE MIXER
2 - BUS	4 - LOGGING	6 - CARGO VAN/ENCLOSED BOX	9 - CARGO TANK	13 - AUTOTRANSPORTER
		7 - GRAIN/CHIPS/GRAVEL	10 - FLAT BED	14 - GARBAGE/REFUSE
			11 - DUMP	99 - OTHER / UNKNOWN

VEHICLE DEFECTS

1 - TURN SIGNALS	4 - BRAKES	7 - WORN OR SLICK TIRES	9 - MOTOR TROUBLE	99 - OTHER / UNKNOWN
2 - HEAD LAMPS	5 - STEERING	8 - TRAILER EQUIPMENT DEFECTIVE	10 - DISABLED FROM PRIOR ACCIDENT	
3 - TAIL LAMPS	6 - TIRE BLOWOUT			

VEHICLE DEFECTS

1 - TURN SIGNALS	4 - BRAKES	7 - WORN OR SLICK TIRES	9 - MOTOR TROUBLE	99 - OTHER / UNKNOWN
2 - HEAD LAMPS	5 - STEERING	8 - TRAILER EQUIPMENT DEFECTIVE	10 - DISABLED FROM PRIOR ACCIDENT	
3 - TAIL LAMPS	6 - TIRE BLOWOUT			

INITIAL POINT OF CONTACT

0 - NO DAMAGE	14 - UNDERCARRIAGE
1-12 - REFER TO UNIT DIAGRAM	15 - VEHICLE NOT AT SCENE
13 - TOP	99 - UNKNOWN

ACTION 04

1 - NON-CONTACT	1 - STRAIGHT AHEAD	7 - MAKING U-TURN	13 - NEGOTIATING A CURVE	18 - APPROACHING OR LEAVING VEHICLE
2 - NON-COLLISION	2 - BACKING	8 - ENTERING TRAFFIC LANE	14 - ENTERING OR CROSSING SPECIFIED LOCATION	19 - STANDING
3 - STRIKING	3 - CHANGING LANES	9 - LEAVING TRAFFIC LANE	15 - WALKING, RUNNING, JOGGING, PLAYING	20 - OTHER NON-MOTORIST
4 - STRUCK	4 - OVERTAKING/PASSING	10 - PARKED	16 - WORKING	21 - STANDING OUTSIDE DISABLED VEHICLE
5 - BOTH STRIKING & STRUCK	5 - MAKING RIGHT TURN	11 - SLOWING OR STOPPED IN TRAFFIC	17 - PUSHING VEHICLE	99 - OTHER / UNKNOWN
9 - OTHER / UNKNOWN	6 - MAKING LEFT TURN	12 - DRIVERLESS		

TRAFFICWAY FLOW

2

TRAFFIC CONTROL

2

1 - ONE-WAY	1 - ROUNDABOUT	4 - STOP SIGN
2 - TWO-WAY	2 - SIGNAL	5 - YIELD SIGN
	3 - FLASHER	6 - NO CONTROL

CONTRIBUTING CIRCUMSTANCES 01

1 - NONE	7 - LEFT OF CENTER	13 - IMPROPER START FROM A PARKED POSITION	17 - VISION OBSTRUCTION	21 - LYING IN ROADWAY
2 - FAILURE TO YIELD	8 - FOLLOWING TOO CLOSE / ACDA	14 - STOPPED OR PARKED ILLEGALLY	18 - OPERATING DEFECTIVE EQUIPMENT	22 - NOT DISCERNIBLE
3 - RAN RED LIGHT	9 - IMPROPER LANE CHANGE	15 - SWERVING TO AVOID	19 - LOAD SHIFTING/FALLING/SPILLING	23 - OPENING DOOR INTO ROADWAY
4 - RAN STOP SIGN	10 - IMPROPER PASSING	16 - WRONG WAY	20 - IMPROPER CROSSING	99 - OTHER IMPROPER ACTION
5 - UNSAFE SPEED	11 - DROVE OFF ROAD			
6 - IMPROPER TURN	12 - IMPROPER BACKING			

OF THROUGH LANES ON ROAD 3

RAIL GRADE CROSSING 1

1 - NOT INVOLVED
2 - INVOLVED-ACTIVE CROSSING
3 - INVOLVED-PASSIVE CROSSING

SEQUENCE OF EVENTS

1 2 0

NON-COLLISION

1 - OVERTURN/ROLLOVER	6 - EQUIPMENT FAILURE	11 - CROSS CENTERLINE - OPPOSITE DIRECTION OF TRAVEL	16 - RAILWAY VEHICLE	22 - WORK ZONE MAINTENANCE EQUIPMENT
2 - FIRE/EXPLOSION	7 - SEPARATION OF UNITS	12 - DOWNHILL RUNAWAY	17 - ANIMAL - FARM	23 - STRUCK BY FALLING, SHIFTING CARGO OR ANYTHING SET IN MOTION BY A MOTOR VEHICLE
3 - IMMERSION	8 - RAN OFF ROAD RIGHT	13 - OTHER NON-COLLISION	18 - ANIMAL - DEER	24 - OTHER MOVABLE OBJECT
4 - JACKKNIFE	9 - RAN OFF ROAD LEFT	14 - PEDESTRIAN	19 - ANIMAL - OTHER	
5 - CARGO / EQUIPMENT LOSS OR SHIFT	10 - CROSS MEDIAN	15 - PEDALCYCLE	20 - MOTOR VEHICLE IN TRANSPORT	

UNIT / NON-MOTORIST DIRECTION

FROM 3 TO 1

1 - NORTH	5 - NORTHEAST
2 - SOUTH	6 - NORTHWEST
3 - EAST	7 - SOUTHEAST
4 - WEST	8 - SOUTHWEST
	9 - OTHER / UNKNOWN

SEQUENCE OF EVENTS

4 1

COLLISION WITH FIXED OBJECT

25 - IMPACT ATTENUATOR / CRASH CUSHION	31 - GUARDRAIL END	37 - TRAFFIC SIGN POST	43 - CURB	50 - WORK ZONE MAINTENANCE EQUIPMENT
26 - BRIDGE OVERHEAD STRUCTURE	32 - PORTABLE BARRIER	38 - OVERHEAD SIGN POST	44 - DITCH	51 - WALL
27 - BRIDGE PIER OR ABUTMENT	33 - MEDIUM CABLE BARRIER	39 - LIGHT / LUMINARIES SUPPORT	45 - EMBANKMENT	52 - BUILDING
28 - BRIDGE PARAPET	34 - MEDIUM GUARDRAIL BARRIER	40 - UTILITY POLE	46 - FENCE	53 - TUNNEL
29 - BRIDGE RAIL	35 - MEDIUM CONCRETE BARRIER	41 - OTHER POST, POLE OR SUPPORT	47 - MAILBOX	54 - OTHER FIXED OBJECT
30 - GUARDRAIL FACE	36 - MEDIUM OTHER BARRIER	42 - CULVERT	48 - TREE	99 - OTHER / UNKNOWN
			49 - FIRE HYDRANT	

UNIT SPEED 25

DETECTED SPEED 1

1 - STATED / ESTIMATED SPEED
2 - CALCULATED / EDR
3 - UNDETERMINED

FIRST HARMFUL EVENT 1 MOST HARMFUL EVENT 1



MOTORIST / Non-MOTORIST

LOCAL REPORT NUMBER
2 3 0 2 6 4 6 5

UNIT # 0 1	NAME: LAST, FIRST, MIDDLE Regan, Kimberle	DATE OF BIRTH 0 9 1 2 1 9 7 9	AGE 4 3	GENDER F
ADDRESS: STREET, CITY, STATE, ZIP 9416 Huntington Ct. Harrison OH 45030		CONTACT PHONE - INCLUDE AREA CODE		
INJURIES 5	INJURED TAKEN BY	EMS AGENCY (NAME)	INJURED TAKEN TO: MEDICAL FACILITY (NAME, CITY)	SAFETY EQUIPMENT USED 0 4
OL STATE OH	OPERATOR LICENSE NUMBER	OFFENSE CHARGED 331.17A	LOCAL CODE <input checked="" type="checkbox"/>	OFFENSE DESCRIPTION Failure to Yield
OL CLASS 4	ENDORSEMENT SELECT UP TO 2	RESTRICTION SELECT UP TO 3	DRIVER DISTRACTED BY 1	ALCOHOL / DRUG SUSPECTED <input type="checkbox"/> ALCOHOL <input type="checkbox"/> MARIJUANA <input type="checkbox"/> OTHER DRUG
ALCOHOL TEST		DRUG TEST(S)		
STATUS 1	TYPE 1	VALUE	STATUS 1	TYPE 1

UNIT # 0 2	NAME: LAST, FIRST, MIDDLE Eshbaugh, William	DATE OF BIRTH 0 5 0 1 1 9 3 6	AGE 8 6	GENDER M
ADDRESS: STREET, CITY, STATE, ZIP 209 Mckee Ave. Oxford, OH 45056		CONTACT PHONE - INCLUDE AREA CODE		
INJURIES 5	INJURED TAKEN BY	EMS AGENCY (NAME)	INJURED TAKEN TO: MEDICAL FACILITY (NAME, CITY)	SAFETY EQUIPMENT USED 0 4
OL STATE OH	OPERATOR LICENSE NUMBER	OFFENSE CHARGED	LOCAL CODE <input type="checkbox"/>	OFFENSE DESCRIPTION
OL CLASS 4	ENDORSEMENT SELECT UP TO 2	RESTRICTION SELECT UP TO 3	DRIVER DISTRACTED BY 1	ALCOHOL / DRUG SUSPECTED <input type="checkbox"/> ALCOHOL <input type="checkbox"/> MARIJUANA <input type="checkbox"/> OTHER DRUG
ALCOHOL TEST		DRUG TEST(S)		
STATUS 1	TYPE 1	VALUE	STATUS 1	TYPE 1

UNIT #	NAME: LAST, FIRST, MIDDLE	DATE OF BIRTH	AGE	GENDER
ADDRESS: STREET, CITY, STATE, ZIP		CONTACT PHONE - INCLUDE AREA CODE		
INJURIES	INJURED TAKEN BY	EMS AGENCY (NAME)	INJURED TAKEN TO: MEDICAL FACILITY (NAME, CITY)	SAFETY EQUIPMENT USED
OL STATE	OPERATOR LICENSE NUMBER	OFFENSE CHARGED	LOCAL CODE	OFFENSE DESCRIPTION
OL CLASS	ENDORSEMENT SELECT UP TO 2	RESTRICTION SELECT UP TO 3	DRIVER DISTRACTED BY	ALCOHOL / DRUG SUSPECTED
ALCOHOL TEST		DRUG TEST(S)		
STATUS	TYPE	VALUE	STATUS	TYPE

INJURIES	SEATING POSITION	AIR BAG	OL CLASS	OL RESTRICTION(S)	DRIVER DISTRACTION	TEST STATUS
1- FATAL	1- FRONT - LEFT SIDE (MOTORCYCLE DRIVER)	1- NOT DEPLOYED	1- CLASS A	1- ALCOHOL INTERLOCK DEVICE	1- NOT DISTRACTED	1- NONE GIVEN
2- SUSPECTED SERIOUS INJURY	2- FRONT - MIDDLE	2- DEPLOYED FRONT	2- CLASS B	2- CDL INTRASTATE ONLY	2- MANUALLY OPERATING AN ELECTRONIC COMMUNICATION DEVICE (TEXTING, TYPING, DIALING)	2- TEST REFUSED
3- SUSPECTED MINOR INJURY	3- FRONT - RIGHT SIDE	3- DEPLOYED SIDE	3- CLASS C	3- CORRECTIVE LENSES	3- TALKING ON HANDS-FREE COMMUNICATION DEVICE	3- TEST GIVEN; CONTAMINATED SAMPLE / UNUSABLE
4- POSSIBLE INJURY	4- SECOND - LEFT SIDE (MOTORCYCLE PASSENGER)	4- DEPLOYED BOTH FRONT / SIDE	4- REGULAR CLASS (OHIO = D)	4- FARM WAIVER	4- TALKING ON HAND-HELD COMMUNICATION DEVICE	4- TEST GIVEN; RESULTS KNOWN
5- NO APPARENT INJURY	5- SECOND - MIDDLE	5- NOT APPLICABLE	5- M/C MOPED ONLY	5- EXCEPT CLASS A BUS & CLASS B BUS	5- OTHER ACTIVITY WITH AN ELECTRONIC DEVICE	5- TEST GIVEN; RESULTS UNKNOWN
INJURED TAKEN BY	6- SECOND - RIGHT SIDE	9- DEPLOYMENT UNKNOWN	6- NO VALID OL	7- EXCEPT TRACTOR-TRAILER	7- OTHER DISTRACTION INSIDE THE VEHICLE	ALCOHOL TEST TYPE
1- NOT TRANSPORTED / TREATED AT SCENE	7- THIRD - LEFT SIDE (MOTORCYCLE SIDE CAR)	EJECTION	H- HAZMAT	8- INTERMEDIATE LICENSE RESTRICTIONS	8- OTHER DISTRACTION OUTSIDE THE VEHICLE	1- NONE
2- EMS	8- THIRD - MIDDLE	1- NOT EJECTED	M- MOTORCYCLE	9- LEARNER'S PERMIT RESTRICTIONS	9- OTHER / UNKNOWN	2- BLOOD
3- POLICE	9- THIRD - RIGHT SIDE	2- PARTIALLY EJECTED	P- PASSENGER	10- LIMITED TO DAYLIGHT ONLY	CONDITION	3- URINE
9- OTHER / UNKNOWN	10- SLEEPER SECTION OF TRUCK CAB	3- TOTALLY EJECTED	N- TANKER	11- LIMITED TO EMPLOYMENT	1- APPARENTLY NORMAL	4- BREATH
SAFETY EQUIPMENT	11- PASSENGER IN OTHER ENCLOSED CARGO AREA (NON-TRAILING UNIT, BUS, PICK-UP WITH CAP)	4- NOT APPLICABLE	Q- MOTOR SCOOTER	12- LIMITED - OTHER	2- PHYSICAL IMPAIRMENT	5- OTHER
1- NONE USED	12- PASSENGER IN UNENCLOSED CARGO AREA	TRAPPED	R- THREE-WHEEL MOTORCYCLE	13- MECHANICAL DEVICES (SPECIAL BRAKES, HAND CONTROLS, OR OTHER ADAPTIVE DEVICES)	3- EMOTIONAL (E.G. DEPRESSED, ANGRY, DISTURBED)	DRUG TEST TYPE
2- SHOULDER BELT ONLY USED	13- TRAILING UNIT	1- NOT TRAPPED	S- SCHOOL BUS	14- MILITARY VEHICLES ONLY	4- ILLNESS	1- NONE
3- LAP BELT ONLY USED	14- RIDING ON VEHICLE EXTERIOR (NON-TRAILING UNIT)	2- EXTRICATED BY MECHANICAL MEANS	T- DOUBLE & TRIPLE TRAILERS	15- MOTOR VEHICLES WITHOUT AIR BRAKES	5- FELL ASLEEP, FAINTED, FATIGUED, ETC.	2- BLOOD
4- SHOULDER & LAP BELT USED	15- NON-MOTORIST	3- FREED BY NON-MECHANICAL MEANS	X- TANKER / HAZMAT	16- OUTSIDE MIRROR	6- UNDER THE INFLUENCE OF MEDICATIONS / DRUGS / ALCOHOL	3- URINE
5- CHILD RESTRAINT SYSTEM FORWARD FACING	99- OTHER / UNKNOWN	GENDER		17- PROSTHETIC AID	9- OTHER / UNKNOWN	4- OTHER
6- CHILD RESTRAINT SYSTEM REAR FACING		F- FEMALE		18- OTHER		DRUG TEST RESULT(S)
7- BOOSTER SEAT		M- MALE				1- AMPHETAMINES
8- HELMET USED		U- OTHER / UNKNOWN				2- BARBITURATES
9- PROTECTIVE PADS USED (ELBOW, KNEES, ETC.)						3- BENZODIAZEPINES
10- REFLECTIVE CLOTHING						4- CANNABINOIDS
11- LIGHTING - PEDESTRIAN / BICYCLE ONLY						5- COCAINE
99- OTHER / UNKNOWN						6- OPIATES / OPIOIDS
						7- OTHER
						8- NEGATIVE RESULTS



OCCUPANT / WITNESS ADDENDUM

LOCAL REPORT NUMBER
2 3 0 2 6 4 6 5

OCCUPANT	UNIT # 1	NAME: LAST, FIRST, MIDDLE Regan, Kylee	DATE OF BIRTH 0 6 2 4 2 0 0 8	AGE 1 4	GENDER F
-----------------	-------------	---	----------------------------------	------------	-------------

ADDRESS: STREET, CITY, STATE, ZIP 9416 Huntington Ct. Harrison OH 45030			CONTACT PHONE - INCLUDE AREA CODE		
--	--	--	-----------------------------------	--	--

INJURIES 5	INJURED TAKEN BY	EMS AGENCY (NAME)	INJURED TAKEN TO: MEDICAL FACILITY (NAME, CITY)	SAFETY EQUIPMENT USED 0 4	<input type="checkbox"/> DOT-COMPLIANT MC HELMET	SEATING POSITION 0 3	AIR BAG USAGE 0 1	EJECTION 1	TRAPPED 1
---------------	------------------	-------------------	---	------------------------------	--	-------------------------	----------------------	---------------	--------------

UNIT #	NAME: LAST, FIRST, MIDDLE	DATE OF BIRTH	AGE	GENDER
--------	---------------------------	---------------	-----	--------

ADDRESS: STREET, CITY, STATE, ZIP			CONTACT PHONE - INCLUDE AREA CODE		
-----------------------------------	--	--	-----------------------------------	--	--

INJURIES	INJURED TAKEN BY	EMS AGENCY (NAME)	INJURED TAKEN TO: MEDICAL FACILITY (NAME, CITY)	SAFETY EQUIPMENT USED	<input type="checkbox"/> DOT-COMPLIANT MC HELMET	SEATING POSITION	AIR BAG USAGE	EJECTION	TRAPPED
----------	------------------	-------------------	---	-----------------------	--	------------------	---------------	----------	---------

UNIT #	NAME: LAST, FIRST, MIDDLE	DATE OF BIRTH	AGE	GENDER
--------	---------------------------	---------------	-----	--------

ADDRESS: STREET, CITY, STATE, ZIP			CONTACT PHONE - INCLUDE AREA CODE		
-----------------------------------	--	--	-----------------------------------	--	--

INJURIES	INJURED TAKEN BY	EMS AGENCY (NAME)	INJURED TAKEN TO: MEDICAL FACILITY (NAME, CITY)	SAFETY EQUIPMENT USED	<input type="checkbox"/> DOT-COMPLIANT MC HELMET	SEATING POSITION	AIR BAG USAGE	EJECTION	TRAPPED
----------	------------------	-------------------	---	-----------------------	--	------------------	---------------	----------	---------

UNIT #	NAME: LAST, FIRST, MIDDLE	DATE OF BIRTH	AGE	GENDER
--------	---------------------------	---------------	-----	--------

ADDRESS: STREET, CITY, STATE, ZIP			CONTACT PHONE - INCLUDE AREA CODE		
-----------------------------------	--	--	-----------------------------------	--	--

INJURIES	INJURED TAKEN BY	EMS AGENCY (NAME)	INJURED TAKEN TO: MEDICAL FACILITY (NAME, CITY)	SAFETY EQUIPMENT USED	<input type="checkbox"/> DOT-COMPLIANT MC HELMET	SEATING POSITION	AIR BAG USAGE	EJECTION	TRAPPED
----------	------------------	-------------------	---	-----------------------	--	------------------	---------------	----------	---------

INJURIES	SAFETY EQUIPMENT USED	SEATING POSITION	AIR BAG USAGE
1 - FATAL	1 - NONE USED - VEHICLE OCCUPANT	1 - FRONT - LEFT SIDE (MOTORCYCLE DRIVER)	1 - NOT DEPLOYED
2 - SUSPECTED SERIOUS INJURY	2 - SHOULDER BELT ONLY USED	2 - FRONT - MIDDLE	2 - DEPLOYED FRONT
3 - SUSPECTED MINOR INJURY	3 - LAP BELT ONLY USED	3 - FRONT - RIGHT SIDE	3 - DEPLOYED SIDE
4 - POSSIBLE INJURY	4 - SHOULDER & LAP BELT USED	4 - SECOND - LEFT SIDE (MOTORCYCLE PASSENGER)	4 - DEPLOYED BOTH FRONT/SIDE
5 - NO APPARENT INJURY	5 - CHILD RESTRAINT SYSTEM FORWARD FACING	5 - SECOND - MIDDLE	5 - NOT APPLICABLE
INJURED TAKEN BY		6 - SECOND - RIGHT SIDE	9 - DEPLOYMENT UNKNOWN
1 - NOT TRANSPORTED / TREATED AT SCENE	6 - CHILD RESTRAINT SYSTEM REAR FACING	7 - THIRD - LEFT SIDE (MOTORCYCLE SIDE/CAR)	EJECTION
2 - EMS	7 - BOOSTER SEAT	8 - THIRD - MIDDLE	1 - NOT EJECTED
3 - POLICE	8 - HELMET USED	9 - THIRD - RIGHT SIDE	2 - PARTIALLY EJECTED
9 - OTHER / UNKNOWN	9 - PROTECTIVE PADS USED (ELBOW, KNEES, ETC.)	10 - SLEEPER SECTION OF TRUCK CAB	3 - TOTALLY EJECTED
GENDER		11 - PASSENGER IN OTHER ENCLOSED CARGO AREA (NON-TRAILING UNIT, BUS, PICK-UP WITH CAP)	4 - NOT APPLICABLE
F - FEMALE	10 - REFLECTIVE CLOTHING	12 - PASSENGER IN UNENCLOSED CARGO AREA	TRAPPED
M - MALE	11 - LIGHTING - PEDESTRIAN / BICYCLE ONLY	13 - TRAILING UNIT	1 - NOT TRAPPED
U - OTHER / UNKNOWN	99 - OTHER / UNKNOWN	14 - RIDING ON VEHICLE EXTERIOR (NON-TRAILING UNIT)	2 - EXTRICATED BY MECHANICAL MEANS
		15 - NON-MOTORIST	3 - FREED BY NON-MECHANICAL MEANS
		99 - OTHER / UNKNOWN	

NAME: LAST, FIRST, MIDDLE	DATE OF BIRTH	AGE	GENDER
---------------------------	---------------	-----	--------

ADDRESS: STREET, CITY, STATE, ZIP			CONTACT PHONE - INCLUDE AREA CODE
-----------------------------------	--	--	-----------------------------------

NAME: LAST, FIRST, MIDDLE	DATE OF BIRTH	AGE	GENDER
---------------------------	---------------	-----	--------

ADDRESS: STREET, CITY, STATE, ZIP			CONTACT PHONE - INCLUDE AREA CODE
-----------------------------------	--	--	-----------------------------------

NAME: LAST, FIRST, MIDDLE	DATE OF BIRTH	AGE	GENDER
---------------------------	---------------	-----	--------

ADDRESS: STREET, CITY, STATE, ZIP			CONTACT PHONE - INCLUDE AREA CODE
-----------------------------------	--	--	-----------------------------------

OHIO TRAFFIC ACCIDENT - DIAGRAM / NARRATIVE CONTINUATION

OH-2 (Rev. 1/82)

LOCAL REPORT NUMBER PD-23-026465	REPORTING AGENCY Fairfield Police Department	DATE OF ACCIDENT 4/12/23
IN COUNTY OF Butler	ACCIDENT LOCATION Nilles Rd. // River Rd.	

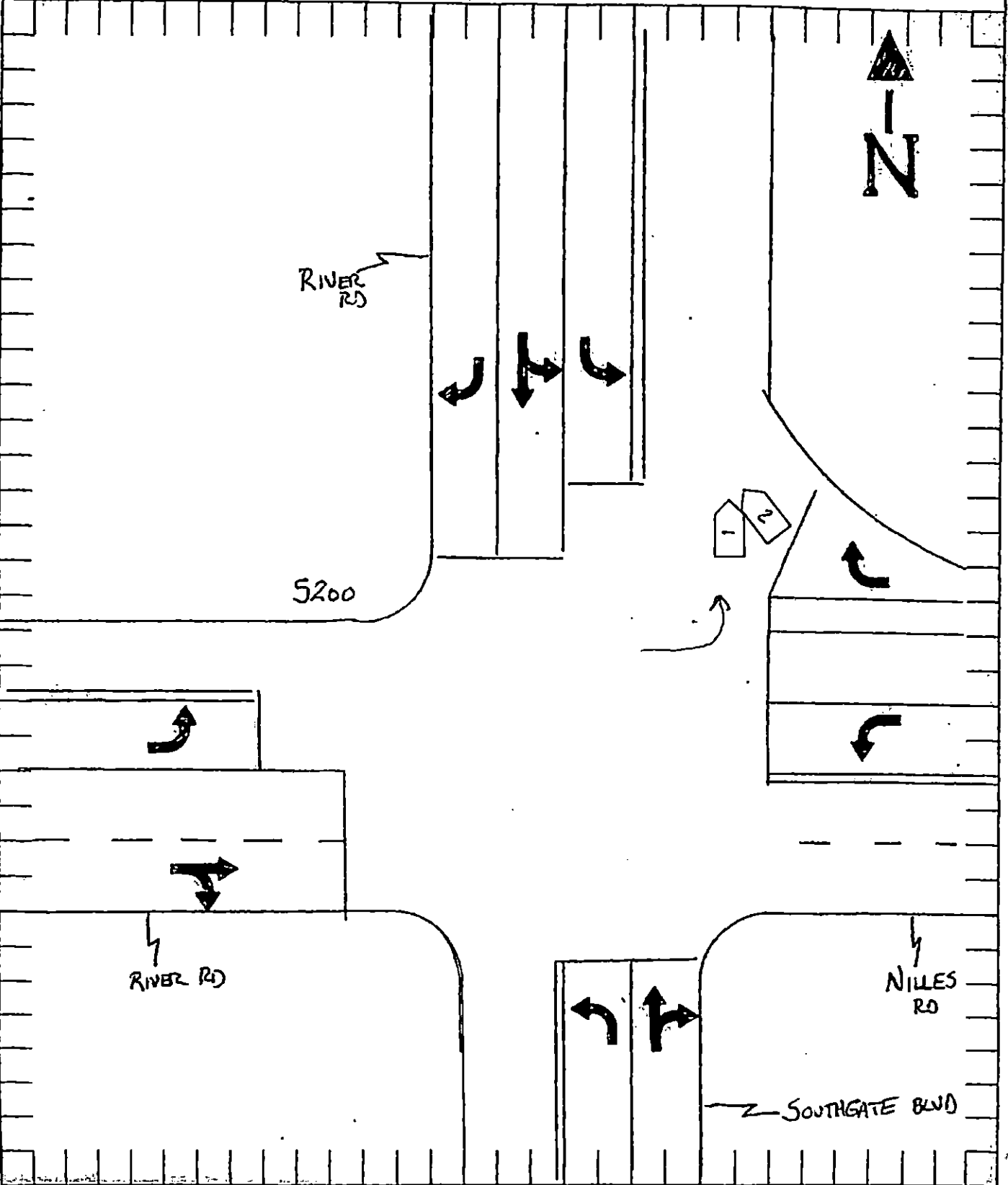

OFFICER'S SIGNATURE PO T.King	BADGE NO. 161
----------------------------------	------------------