



TRAFFIC CRASH REPORT

*DENOTES MANDATORY FIELD FOR SUPPLEMENT REPORT

LOCAL REPORT NUMBER*

<input checked="" type="checkbox"/> PHOTOS TAKEN	<input checked="" type="checkbox"/> OH-2	<input type="checkbox"/> OH-3	LOCAL INFORMATION			2 3 0 2 9 6 5 8			
<input type="checkbox"/> SECONDARY CRASH	<input type="checkbox"/> OH-1P	<input type="checkbox"/> OTHER	REPORTING AGENCY NAME*			HIT/SKIP		NUMBER OF UNITS	UNIT IN ERROR
<input checked="" type="checkbox"/> PRIVATE PROPERTY	Fairfield Police Department			NCIC*		1 - SOLVED		0 1	0 1
						2 - UNSOLVED			98 - ANIMAL
									99 - UNKNOWN

COUNTY*	LOCALITY*	LOCATION: CITY, VILLAGE, TOWNSHIP*			CRASH DATE / TIME*		CRASH SEVERITY	
0 9	1	City of Fairfield			0 4 2 6 2 0 2 3 1 2 5 4		5	

ROUTE TYPE	ROUTE NUMBER	PREFIX	1 - NORTH 2 - SOUTH 3 - EAST 4 - WEST	LOCATION ROAD NAME	ROAD TYPE	LATITUDE DECIMAL DEGREES	
				Nilles	R D	3 9 . 3 3 7 9 3 4	

ROUTE TYPE	ROUTE NUMBER	PREFIX	1 - NORTH 2 - SOUTH 3 - EAST 4 - WEST	REFERENCE ROAD NAME (ROAD, MILEPOST, HOUSE #)	ROAD TYPE	LONGITUDE DECIMAL DEGREES	
				1248		8 4 . 5 3 8 1 8 3	

REFERENCE POINT	DIRECTION FROM REFERENCE	ROUTE TYPE	ROAD TYPE	INTERSECTION RELATED	
1 - INTERSECTION	1 - NORTH	IR - INTERSTATE ROUTE(TP)	AL - ALLEY	<input type="checkbox"/> WITHIN INTERSECTION OR ON APPROACH	
2 - MILE POST	2 - SOUTH	US - FEDERAL US ROUTE	AV - AVENUE	<input type="checkbox"/> WITHIN INTERCHANGE AREA	
3 - HOUSE #	3 - EAST	SR - STATE ROUTE	BL - BOULEVARD	NUMBER OF APPROACHES	
	4 - WEST	CR - NUMBERED COUNTY ROUTE	MP - MILEPOST		
DISTANCE FROM REFERENCE	DISTANCE UNIT OF MEASURE	TR - NUMBERED TOWNSHIP ROUTE	CR - CIRCLE		
	1 - MILES		OV - OVAL		
	2 - FEET		CT - COURT		
	3 - YARDS		DR - DRIVE		
			HE - HEIGHTS		
			PL - PLACE		
				<input type="checkbox"/> ROADWAY DIVIDED	

LOCATION OF FIRST HARMFUL EVENT	MANNER OF CRASH COLLISION/IMPACT	DIRECTION OF TRAVEL	MEDIAN TYPE
1 - ON ROADWAY	1 - NOT COLLISION BETWEEN TWO MOTOR VEHICLES IN TRANSPORT	1 - NORTH	1 - DIVIDED FLUSH MEDIAN (<4 FEET)
2 - ON SHOULDER	2 - REAR-END	2 - SOUTH	2 - DIVIDED FLUSH MEDIAN (≥4 FEET)
3 - IN MEDIAN	3 - HEAD-ON	3 - EAST	3 - DIVIDED, DEPRESSED MEDIAN
4 - ON ROADSIDE	4 - REAR-TO-REAR	4 - WEST	4 - DIVIDED, RAISED MEDIAN (ANY TYPE)
5 - ON GORE	5 - BACKING		9 - OTHER/UNKNOWN
6 - OUTSIDE TRAFFIC WAY	6 - ANGLE		
7 - ON RAMP	7 - SIDESWIPE, SAME DIRECTION		
8 - OFF RAMP	8 - SIDESWIPE, OPPOSITE DIRECTION		
	9 - OTHER / UNKNOWN		

<input type="checkbox"/> WORK ZONE RELATED	WORK ZONE TYPE	LOCATION OF CRASH IN WORK ZONE	CONTOUR	CONDITIONS	SURFACE
<input type="checkbox"/> WORKERS PRESENT	1 - LANE CLOSURE	1 - BEFORE THE 1ST WORK ZONE WARNING SIGN	1	1 - DRY	1 - CONCRETE
<input type="checkbox"/> LAW ENFORCEMENT PRESENT	2 - LANE SHIFT/CROSSOVER	2 - ADVANCE WARNING AREA		2 - WET	2 - BLACKTOP, BITUMINOUS, ASPHALT
<input type="checkbox"/> ACTIVE SCHOOL ZONE	3 - WORK ON SHOULDER OR MEDIAN	3 - TRANSITION AREA		3 - SNOW	3 - BRICK/BLOCK
	4 - INTERMITTENT OR MOVING WORK	4 - ACTIVITY AREA		4 - ICE	4 - SLAG, GRAVEL, STONE
	5 - OTHER	5 - TERMINATION AREA		5 - SAND, MUD, DIRT, OIL, GRAVEL	5 - DIRT
				6 - WATER (STANDING, MOVING)	9 - OTHER/UNKNOWN
				7 - SLUSH	
				9 - OTHER/UNKNOWN	

LIGHT CONDITION	WEATHER
1 - DAYLIGHT	1 - CLEAR
2 - DAWN/DUSK	2 - CLOUDY
3 - DARK - LIGHTED ROADWAY	3 - FOG, SMOG, SMOKE
4 - DARK - ROADWAY NOT LIGHTED	4 - RAIN
5 - DARK - UNKNOWN ROADWAY LIGHTING	5 - SLEET, HAIL
9 - OTHER / UNKNOWN	6 - SNOW
	7 - SEVERE CROSSWINDS
	8 - BLOWING SAND, SOIL, DIRT, SNOW
	9 - FREEZING RAIN OR FREEZING DRIZZLE
	99 - OTHER / UNKNOWN

NARRATIVE	<p>On 04/26/2023 at 12:54 P.M. Unit 1 was changing parking spots in the parking lot of 1248 Nilles Rd. #8 Fairfield, OH 45014 and accidentally hit the gas pedal instead of the brake and collided with the building.</p> <p>The building belongs to:</p> <p>Michael Miller 2222 Rolling Hills Blvd. Fairfield, OH 45014</p>	<p>Indicate the north direction with an "N" on the compass diagram.</p>

CRASH REPORTED DATE / TIME	DISPATCH DATE / TIME	ARRIVAL DATE / TIME	SCENE CLEARED DATE / TIME	REPORT TAKEN BY
0 4 2 6 2 0 2 3 1 2 5 5	0 4 2 6 2 0 2 3 1 2 5 6	0 4 2 6 2 0 2 3 1 3 0 2	0 4 2 6 2 0 2 3 1 4 0 6	<input checked="" type="checkbox"/> POLICE AGENCY
TOTAL TIME ROADWAY CLOSED	OTHER INVESTIGATION TIME	TOTAL MINUTES	OFFICER'S NAME*	<input type="checkbox"/> MOTORIST
		7 0	P. O. C. Moore	<input type="checkbox"/> SUPPLEMENT (CORRECTION OR ADDITION TO AN EXISTING REPORT SENT TO OOSP)
		1 3 6	OFFICER'S BADGE NUMBER*	
			8 7	

LOCAL REPORT NUMBER
2, 3, 0, 2, 9, 6, 5, 8

OWNER
UNIT # 0, 1 OWNER NAME: LAST, FIRST, MIDDLE (SAME AS DRIVER)
Louderback, Robert
OWNER ADDRESS: STREET, CITY, STATE, ZIP (SAME AS DRIVER)
2801 Robers Ave. Cincinnati, OH 45239
COMMERCIAL CARRIER: NAME, ADDRESS, CITY, STATE, ZIP
COMMERCIAL CARRIER PHONE: INCLUDE AREA CODE

DAMAGE
DAMAGE SCALE
3 1 - NONE 3 - FUNCTIONAL DAMAGE
2 - MINOR DAMAGE 4 - DISABLING DAMAGE
9 - UNKNOWN

LP STATE OH LICENSE PLATE # DJ95JS VEHICLE IDENTIFICATION # 1G1C1S19E161811719377 VEHICLE YEAR 2008 VEHICLE MAKE Chevrolet
INSURANCE VERIFIED INSURANCE COMPANY Westfield Ins. INSURANCE POLICY # WNP7522469 COLOR Black VEHICLE MODEL Colorado
TYPE OF USE: COMMERCIAL GOVERNMENT IN EMERGENCY RESPONSE
US DOT # _____ TOWED BY: COMPANY NAME _____
HAZARDOUS MATERIAL: MATERIAL RELEASED CLASS # _____ PLACARD ID # _____
 INTERLOCK DEVICE EQUIPPED HIT/SKIP UNIT #OCCUPANTS 0, 1 VEHICLE WEIGHT GVWR/GCWR
1 - <10K LBS.
2 - 10,001 - 26K LBS.
3 - >26K LBS.

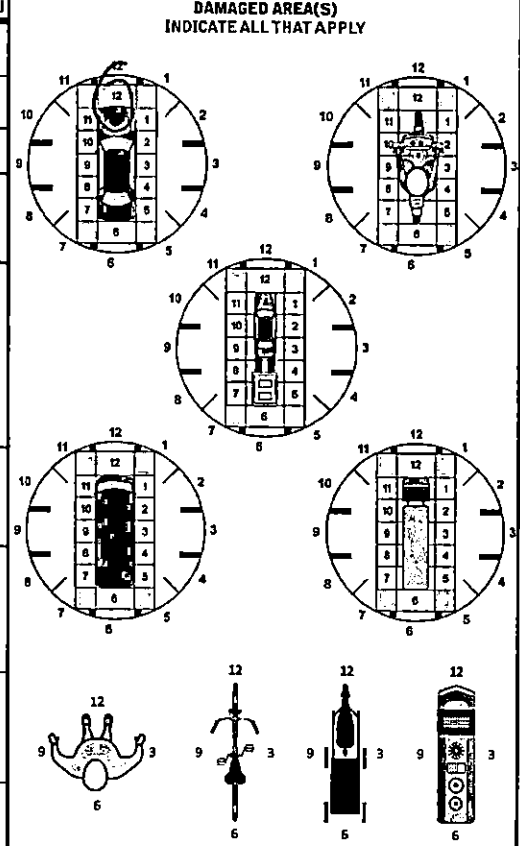

UNIT TYPE 0, 4
1 - PASSENGER CAR 7 - MOTORCYCLE 2-WHEELED 12 - GOLF CART 18 - LIMO (LIVERY VEHICLE) 23 - PEDESTRIAN / SKATER
2 - PASSENGER VAN (MINIVAN) 8 - MOTORCYCLE 3-WHEELED 13 - SNOWMOBILE 19 - BUS (16+ PASSENGERS) 24 - WHEELCHAIR (ANY TYPE)
3 - SPORT UTILITY VEHICLE 9 - AUTOCYCLE 14 - SINGLE UNIT TRUCK 20 - OTHER VEHICLE 25 - OTHER NON-MOTORIST
4 - PICK UP 10 - MOPED OR MOTORIZED BICYCLE 21 - HEAVY EQUIPMENT 26 - BICYCLE
5 - CARGOVAN 11 - ALL TERRAIN VEHICLE (ATV / UTV) 22 - ANIMAL WITH RIDER OR ANIMAL-DRAWN VEHICLE 27 - TRAIN
6 - VAN (9-15 SEATS) 99 - UNKNOWN OR HIT/SKIP
OF TRAILING UNITS _____

WAS VEHICLE OPERATING IN AUTONOMOUS MODE WHEN CRASH OCCURRED? 0, 2
1 - YES 2 - NO 9 - OTHER / UNKNOWN
AUTONOMOUS MODE LEVEL: 0
0 - NO AUTOMATION 1 - DRIVER ASSISTANCE 2 - PARTIAL AUTOMATION 3 - CONDITIONAL AUTOMATION 4 - HIGH AUTOMATION 5 - FULL AUTOMATION 9 - UNKNOWN

SPECIAL FUNCTION 0, 1
1 - NONE 6 - BUS - CHARTER/TOUR 11 - FIRE 16 - FARM 21 - MAIL CARRIER
2 - TAXI 7 - BUS - INTERCITY 12 - MILITARY 17 - MOWING 99 - OTHER / UNKNOWN
3 - ELECTRONIC RIDE SHARING 8 - BUS - SHUTTLE 13 - POLICE 18 - SNOW REMOVAL
4 - SCHOOL TRANSPORT 9 - BUS - OTHER 14 - PUBLIC UTILITY 19 - TOWING
5 - BUS - TRANSIT/COMMUTER 10 - AMBULANCE 15 - CONSTRUCTION EQUIPMENT 20 - SAFETY SERVICE PATROL

CARGO BODY TYPE 0, 1
1 - NO CARGO BODY TYPE / NOT APPLICABLE 3 - VEHICLE TOWING ANOTHER MOTOR VEHICLE 5 - INTERMODAL CONTAINER CHASSIS 8 - POLE 12 - CONCRETE MIXER
2 - BUS 4 - LOGGING 6 - CARGOVAN/ENCLOSED BOX 9 - CARGO TANK 13 - AUTO TRANSPORTER
7 - GRAIN/CHIPS/GRAVEL 10 - FLAT BED 14 - GARBAGE/REFUSE
11 - DUMP 99 - OTHER / UNKNOWN

VEHICLE DEFECTS
1 - TURN SIGNALS 4 - BRAKES 7 - WORN OR SLICK TIRES 9 - MOTOR TROUBLE 99 - OTHER / UNKNOWN
2 - HEAD LAMPS 5 - STEERING 8 - TRAILER EQUIPMENT DEFECTIVE 10 - DISABLED FROM PRIOR ACCIDENT
3 - TAIL LAMPS 6 - TIRE BLOWOUT

NON-MOTORIST LOCATION AT IMPACT
1 - INTERSECTION - MARKED CROSSWALK 3 - INTERSECTION - OTHER 6 - BICYCLE LANE 9 - MEDIAN/CROSSING ISLAND 12 - FIRST RESPONDER AT INCIDENT SCENE
2 - INTERSECTION - UNMARKED CROSSWALK 4 - MIDBLOCK - MARKED CROSSWALK 7 - SHOULDER / ROADSIDE 10 - DRIVEWAY ACCESS 99 - OTHER / UNKNOWN
5 - TRAVEL LANE - OTHER LOCATION 8 - SIDEWALK 11 - SHARED USE PATHS OR TRAILS

ACTION 0, 3
1 - NON-CONTACT 1 - STRAIGHT AHEAD 7 - MAKING U-TURN 13 - NEGOTIATING A CURVE 18 - APPROACHING OR LEAVING VEHICLE
2 - NON-COLLISION 2 - BACKING 8 - ENTERING TRAFFIC LANE 14 - ENTERING OR CROSSING SPECIFIED LOCATION 19 - STANDING
3 - STRIKING 0, 1 3 - CHANGING LANES 9 - LEAVING TRAFFIC LANE 15 - WALKING, RUNNING, JOGGING, PLAYING 20 - OTHER NON-MOTORIST
4 - STRUCK PRE-CRASH ACTIONS 4 - OVERTAKING/PASSING 10 - PARKED 16 - WORKING 21 - STANDING OUTSIDE DISABLED VEHICLE
5 - BOTH STRIKING & STRUCK 5 - MAKING RIGHT TURN 11 - SLOWING OR STOPPED IN TRAFFIC 17 - PUSHING VEHICLE 99 - OTHER / UNKNOWN
9 - OTHER / UNKNOWN 6 - MAKING LEFT TURN 12 - DRIVERLESS

CONTRIBUTING CIRCUMSTANCES 2, 2
1 - NONE 7 - LEFT OF CENTER 13 - IMPROPER START FROM A PARKED POSITION 17 - VISION OBSTRUCTION 21 - LYING IN ROADWAY
2 - FAILURE TO YIELD 8 - FOLLOWING TOO CLOSE / ACDA 14 - STOPPED OR PARKED ILLEGALLY 18 - OPERATING DEFECTIVE EQUIPMENT 22 - NOT DISCERNIBLE
3 - RAN RED LIGHT 9 - IMPROPER LANE CHANGE 15 - SWERVING TO AVOID 19 - LOAD SHIFTING/FALLING/SPILLING 23 - OPENING DOOR INTO ROADWAY
4 - RAN STOP SIGN 10 - IMPROPER PASSING 16 - WRONG WAY 20 - IMPROPER CROSSING 99 - OTHER IMPROPER ACTION
5 - UNSAFE SPEED 11 - DROVE OFF ROAD
6 - IMPROPER TURN 12 - IMPROPER BACKING

SEQUENCE OF EVENTS
1 5, 4 1 - OVERTURN/ROLLOVER 6 - EQUIPMENT FAILURE 11 - CROSS CENTERLINE - OPPOSITE DIRECTION OF TRAVEL 16 - RAILWAY VEHICLE 22 - WORK ZONE MAINTENANCE EQUIPMENT
2 5, 2 2 - FIRE/EXPLOSION 7 - SEPARATION OF UNITS 12 - DOWNHILL RUNAWAY 17 - ANIMAL - FARM 23 - STRUCK BY FALLING, SHIFTING CARGO OR ANYTHING SET IN MOTION BY A MOTOR VEHICLE
3 - IMMERSION 8 - RAN OFF ROAD RIGHT 13 - OTHER NON-COLLISION 18 - ANIMAL - DEER 24 - OTHER MOVABLE OBJECT
4 - JACKKNIFE 9 - RAN OFF ROAD LEFT 14 - PEDESTRIAN 19 - ANIMAL - OTHER 20 - MOTOR VEHICLE IN TRANSPORT
5 - CARGO / EQUIPMENT LOSS OR SHIFT 10 - CROSS MEDIAN 15 - PEDALCYCLE 21 - PARKED MOTOR VEHICLE

COLLISION WITH FIXED OBJECT STRUCK
25 - IMPACT ATTENUATOR / CRASH CUSHION 31 - GUARDRAIL END 37 - TRAFFIC SIGN POST 43 - CURB 50 - WORK ZONE MAINTENANCE EQUIPMENT
26 - BRIDGE OVERHEAD STRUCTURE 32 - PORTABLE BARRIER 38 - OVERHEAD SIGN POST 44 - DITCH 51 - WALL
27 - BRIDGE PIER OR ABUTMENT 33 - MEDIAN CABLE BARRIER 39 - LIGHT / LUMINARIES SUPPORT 45 - EMBANKMENT 52 - BUILDING
28 - BRIDGE PARAPET 34 - MEDIAN GUARDRAIL BARRIER 40 - UTILITY POLE 46 - FENCE 53 - TUNNEL
29 - BRIDGE RAIL 35 - MEDIAN CONCRETE BARRIER 41 - OTHER POST, POLE OR SUPPORT 47 - MAILBOX 54 - OTHER FIXED OBJECT
30 - GUARDRAIL FACE 36 - MEDIAN OTHER BARRIER 42 - CULVERT 48 - TREE 99 - OTHER / UNKNOWN
49 - FIRE HYDRANT

FIRST HARMFUL EVENT 1 MOST HARMFUL EVENT 2

TRAFFIC
TRAFFICWAY FLOW: 2 1 - ONE-WAY 2 - TWO-WAY
TRAFFIC CONTROL: 6 1 - ROUNDABOUT 4 - STOP SIGN 2 - SIGNAL 5 - YIELD SIGN 3 - FLASHER 6 - NO CONTROL

OF THROUGH LANES ON ROAD _____ RAIL GRADE CROSSING: 1
1 - NOT INVOLVED 2 - INVOLVED-ACTIVE CROSSING 3 - INVOLVED-PASSIVE CROSSING

UNIT / NON-MOTORIST DIRECTION
FROM 2 TO 1
1 - NORTH 5 - NORTHEAST 2 - SOUTH 6 - NORTHWEST 3 - EAST 7 - SOUTHEAST 4 - WEST 8 - SOUTHWEST 9 - OTHER / UNKNOWN

UNIT SPEED: 1, 0 DETECTED SPEED: 1
1 - STATED / ESTIMATED SPEED 2 - CALCULATED / EDR 3 - UNDETERMINED
POSTED SPEED: _____



MOTORIST / Non-MOTORIST

LOCAL REPORT NUMBER
2 3 0 2 9 6 5 8

UNIT # 0 1	NAME: LAST, FIRST, MIDDLE Louderback, Robert	DATE OF BIRTH 1 1 0 4 1 9 3 3	AGE 8 9	GENDER M
---------------	---	----------------------------------	------------	-------------

ADDRESS: STREET, CITY, STATE, ZIP
2801 Robers Ave. Cincinnati, OH 45239

CONTACT PHONE - INCLUDE AREA CODE

INJURIES 5	INJURED TAKEN BY 1	EMS AGENCY (NAME) Fairfield EMS	INJURED TAKEN TO: MEDICAL FACILITY (NAME, CITY)	SAFETY EQUIPMENT USED 0 4	<input type="checkbox"/> DOT-COMPLIANT MC HELMET	SEATING POSITION 0 1	AIR BAG USAGE 1	EJECTION 1	TRAPPED 1	
OL STATE OH	OPERATOR LICENSE NUMBER		OFFENSE CHARGED	LOCAL CODE <input type="checkbox"/>	OFFENSE DESCRIPTION		CITATION NUMBER			
OL CLASS 04	ENDORSEMENT SELECT UP TO 2	RESTRICTION SELECT UP TO 3 0 3	DRIVER DISTRACTED BY 1	ALCOHOL / DRUG SUSPECTED <input type="checkbox"/> ALCOHOL <input type="checkbox"/> MARIJUANA <input type="checkbox"/> OTHER DRUG		CONDITION 01	ALCOHOL TEST STATUS TYPE VALUE		DRUG TEST(S) STATUS TYPE RESULT SELECT UP TO 4	

UNIT #	NAME: LAST, FIRST, MIDDLE	DATE OF BIRTH	AGE	GENDER
--------	---------------------------	---------------	-----	--------

ADDRESS: STREET, CITY, STATE, ZIP

CONTACT PHONE - INCLUDE AREA CODE

INJURIES	INJURED TAKEN BY	EMS AGENCY (NAME)	INJURED TAKEN TO: MEDICAL FACILITY (NAME, CITY)	SAFETY EQUIPMENT USED	<input type="checkbox"/> DOT-COMPLIANT MC HELMET	SEATING POSITION	AIR BAG USAGE	EJECTION	TRAPPED	
OL STATE	OPERATOR LICENSE NUMBER		OFFENSE CHARGED	LOCAL CODE <input type="checkbox"/>	OFFENSE DESCRIPTION		CITATION NUMBER			
OL CLASS	ENDORSEMENT SELECT UP TO 2	RESTRICTION SELECT UP TO 3	DRIVER DISTRACTED BY	ALCOHOL / DRUG SUSPECTED <input type="checkbox"/> ALCOHOL <input type="checkbox"/> MARIJUANA <input type="checkbox"/> OTHER DRUG		CONDITION	ALCOHOL TEST STATUS TYPE VALUE		DRUG TEST(S) STATUS TYPE RESULT SELECT UP TO 4	

UNIT #	NAME: LAST, FIRST, MIDDLE	DATE OF BIRTH	AGE	GENDER
--------	---------------------------	---------------	-----	--------

ADDRESS: STREET, CITY, STATE, ZIP

CONTACT PHONE - INCLUDE AREA CODE

INJURIES	INJURED TAKEN BY	EMS AGENCY (NAME)	INJURED TAKEN TO: MEDICAL FACILITY (NAME, CITY)	SAFETY EQUIPMENT USED	<input type="checkbox"/> DOT-COMPLIANT MC HELMET	SEATING POSITION	AIR BAG USAGE	EJECTION	TRAPPED	
OL STATE	OPERATOR LICENSE NUMBER		OFFENSE CHARGED	LOCAL CODE <input type="checkbox"/>	OFFENSE DESCRIPTION		CITATION NUMBER			
OL CLASS	ENDORSEMENT SELECT UP TO 2	RESTRICTION SELECT UP TO 3	DRIVER DISTRACTED BY	ALCOHOL / DRUG SUSPECTED <input type="checkbox"/> ALCOHOL <input type="checkbox"/> MARIJUANA <input type="checkbox"/> OTHER DRUG		CONDITION	ALCOHOL TEST STATUS TYPE VALUE		DRUG TEST(S) STATUS TYPE RESULT SELECT UP TO 4	

INJURIES	SEATING POSITION	AIR BAG	OL CLASS	OL RESTRICTION(S)	DRIVER DISTRACTION	TEST STATUS
1-FATAL	1-FRONT-LEFT SIDE (MOTORCYCLE DRIVER)	1-NOT DEPLOYED	1-CLASS A	1-ALCOHOL INTERLOCK DEVICE	1-NOT DISTRACTED	1-NONE GIVEN
2-SUSPECTED SERIOUS INJURY	2-FRONT-MIDDLE	2-DEPLOYED FRONT	2-CLASS B	2-CDL INTRASTATE ONLY	2-MANUALLY OPERATING AN ELECTRONIC COMMUNICATION DEVICE (TEXTING, TYPING, DIALING)	2-TEST REFUSED
3-SUSPECTED MINOR INJURY	3-FRONT-RIGHT SIDE	3-DEPLOYED SIDE	3-CLASS C	3-CORRECTIVE LENSES	3-TALKING ON HANDS-FREE COMMUNICATION DEVICE	3-TEST GIVEN, CONTAMINATED SAMPLE / UNUSABLE
4-POSSIBLE INJURY	4-SECOND-LEFT SIDE (MOTORCYCLE PASSENGER)	4-DEPLOYED BOTH FRONT / SIDE	4-REGULAR CLASS (OHIO-D)	4-FARM WAIVER	4-TALKING ON HAND-HELD COMMUNICATION DEVICE	4-TEST GIVEN, RESULTS KNOWN
5-NO APPARENT INJURY	5-SECOND-MIDDLE	5-NOT APPLICABLE	5-M/C MOPEO ONLY	5-EXCEPT CLASS A BUS	5-OTHER ACTIVITY WITH AN ELECTRONIC DEVICE	5-TEST GIVEN, RESULTS UNKNOWN
	6-SECOND-RIGHT SIDE	9-DEPLOYMENT UNKNOWN	6-INVALID DL	6-EXCEPT CLASS A & CLASS B BUS	6-PASSENGER	
INJURED TAKEN BY	7-THIRD-LEFT SIDE (MOTORCYCLE SIDE CAR)			7-EXCEPT TRACTOR-TRAILER	7-OTHER DISTRACTION INSIDE THE VEHICLE	ALCOHOL TEST TYPE
1-NOT TRANSPORTED / TREATED AT SCENE	8-THIRD-MIDDLE	EJECTION	OL ENDORSEMENT	8-INTERMEDIATE LICENSE RESTRICTIONS	8-OTHER DISTRACTION OUTSIDE THE VEHICLE	1-NONE
2-EMS	9-THIRD-RIGHT SIDE	1-NOT EJECTED	H-HAZMAT	9-LEARNER'S PERMIT RESTRICTIONS	9-OTHER / UNKNOWN	2-BLOOD
3-POLICE	10-SLEEPER SECTION OF TRUCK CAB	2-PARTIALLY EJECTED	M-MOTORCYCLE	10-LIMITED TO DAYLIGHT ONLY		3-URINE
9-OTHER / UNKNOWN	11-PASSENGER IN OTHER ENCLOSED CARGO AREA (NON-TRAILING UNIT, BUS, PICK-UP WITH CAP)	3-TOTALLY EJECTED	P-PASSENGER	11-LIMITED TO EMPLOYMENT	CONDITION	4-BREATH
SAFETY EQUIPMENT	12-PASSENGER IN UNENCLOSED CARGO AREA	4-NOT APPLICABLE	N-TANKER	12-LIMITED-OTHER	1-APPARENTLY NORMAL	5-OTHER
1-NONE USED	13-TRAILING UNIT	TRAPPED	Q-MOTOR SCOOTER	13-MECHANICAL DEVICES (SPECIAL BRAKES, HAND CONTROLS, OR OTHER ADAPTIVE DEVICES)	2-PHYSICAL IMPAIRMENT	DRUG TEST TYPE
2-SHOULDER BELT ONLY USED	14-RIDING ON VEHICLE EXTERIOR (NON-TRAILING UNIT)	1-NOT TRAPPED	R-THREE-WHEEL MOTORCYCLE	14-MILITARY VEHICLES ONLY	3-EMOTIONAL (E.G., DEPRESSED, ANGRY, DISTURBED)	1-NONE
3-LAP BELT ONLY USED		2-EXTRICATED BY MECHANICAL MEANS	S-SCHOOL BUS	15-MOTOR VEHICLES WITHOUT AIR BRAKES	4-ILLNESS	2-BLOOD
4-SHOULDER & LAP BELT USED		3-FREED BY NON-MECHANICAL MEANS	T-DOUBLE & TRIPLE TRAILERS	16-OUTSIDE MIRROR	5-FELL ASLEEP, FAINTED, FATIGUED, ETC.	3-URINE
5-CHILD RESTRAINT SYSTEM-FORWARD FACING			X-TANKER/HAZMAT	17-PROSTHETIC AID	6-UNDER THE INFLUENCE OF MEDICATIONS / DRUGS / ALCOHOL	4-OTHER
6-CHILD RESTRAINT SYSTEM-REAR FACING			GENDER	18-OTHER	9-OTHER / UNKNOWN	DRUG TEST RESULT(S)
7-BOOSTER SEAT			F-FEMALE			1-AMPHETAMINES
8-HELMET USED			M-MALE			2-BARBITURATES
9-PROTECTIVE PADS USED (ELBOW, KNEES, ETC.)			U-OTHER / UNKNOWN			3-BENZODIAZEPINES
10-REFLECTIVE CLOTHING						4-CANNABINOIDS
11-LIGHTING-PEDESTRIAN / BICYCLE ONLY						5-COCAINE
99-OTHER / UNKNOWN						6-OPIATES / OPIOIDS
						7-OTHER
						8-NEGATIVE RESULTS

LOCAL REPORT NUMBER PD-23-029658	REPORTING AGENCY Fairfield Police Department	DATE OF ACCIDENT 4/26/23
IN COUNTY OF Butler	ACCIDENT LOCATION 1248 Nilles Rd. # 8 Fairfield, OH 45014	

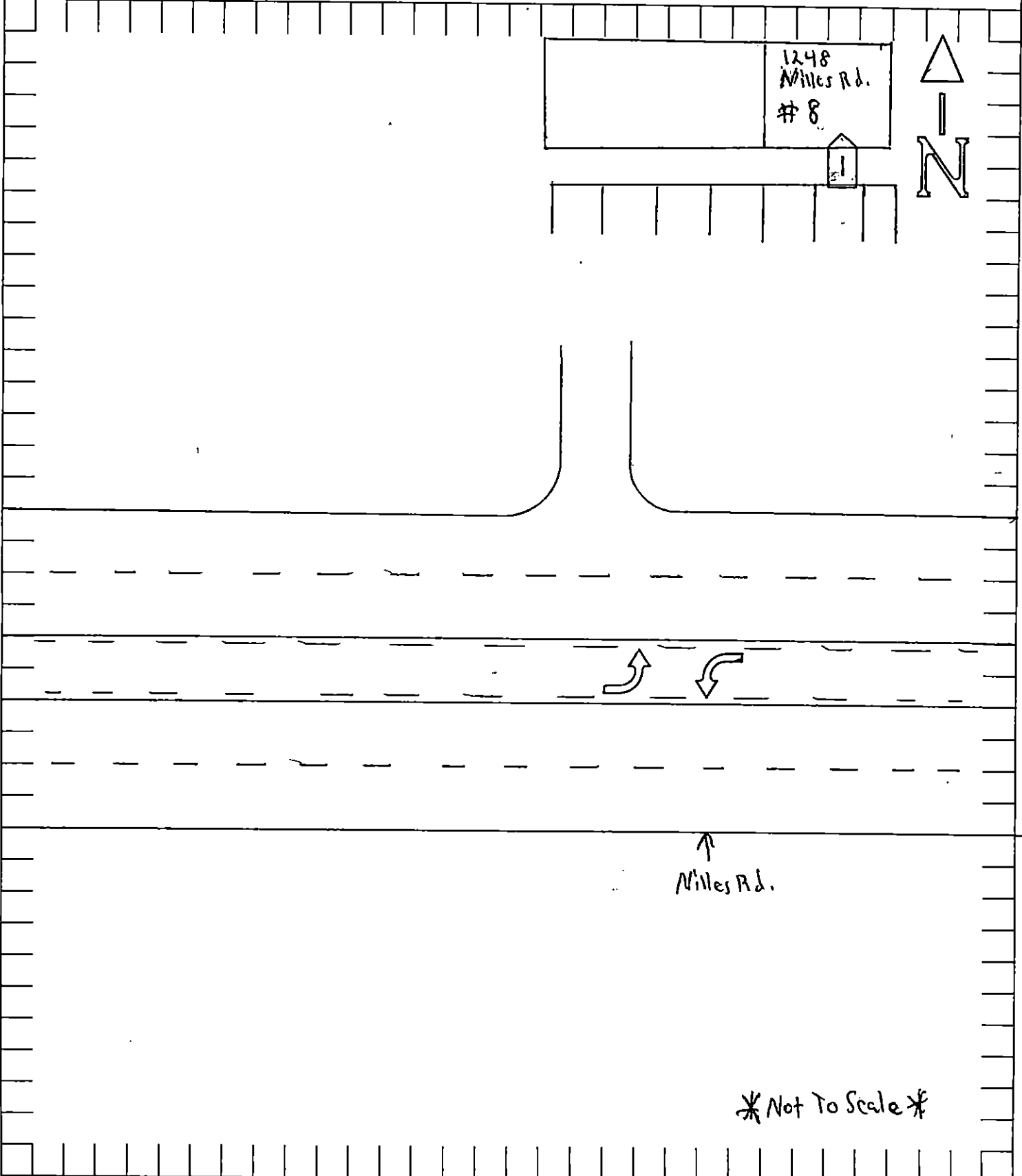

OFFICER'S SIGNATURE P.O. C. Moore	BADGE NO. 136
---	-------------------------