

# TRAFFIC CRASH REPORT

\*DENOTES MANDATORY FIELD FOR SUPPLEMENT REPORT

LOCAL REPORT NUMBER\*

<input checked="" type="checkbox"/> PHOTOS TAKEN <input type="checkbox"/> SECONDARY CRASH		<input checked="" type="checkbox"/> OH-2 <input type="checkbox"/> PRIVATE PROPERTY		<input type="checkbox"/> OH-3 <input type="checkbox"/> OTHER		LOCAL INFORMATION REPORTING AGENCY NAME* Fairfield Police Department		NCIC* 00901		2 3 0 3 4 7 9 9	
COUNTY* 09		LOCALITY* 1 CITY City of Fairfield		LOCATION: CITY, VILLAGE, TOWNSHIP* City of Fairfield		CRASH DATE/TIME* 05172023 1529		HIT/SKIP 1-SOLVED 2-UNSOLVED 0 2		NUMBER OF UNITS 0 1 98-ANIMAL 99-UNKNOWN	
ROUTE TYPE LOCATION ROAD NAME South Gilmore		PREFIX 1-NORTH 2-SOUTH 3-EAST 4-WEST		LOCATION ROAD NAME South Gilmore		ROAD TYPE R D		LATITUDE DECIMAL DEGREES 39.307413		CRASH SEVERITY 1-FATAL 2-SERIOUS INJURY SUSPECTED 3-MINOR INJURY SUSPECTED 4-INJURY POSSIBLE 5-PROPERTY DAMAGE ONLY	
ROUTE TYPE REFERENCE ROAD NAME (ROAD, MILEPOST, HOUSE #) Cincinnati Financial		PREFIX 1-NORTH 2-SOUTH 3-EAST 4-WEST		REFERENCE ROAD NAME (ROAD, MILEPOST, HOUSE #) Cincinnati Financial		ROAD TYPE D R		LONGITUDE DECIMAL DEGREES -84.523247			
REFERENCE POINT 1-INTERSECTION 2-MILE POST 3-HOUSE # 1		DIRECTION FROM REFERENCE 1-NORTH 2-SOUTH 3-EAST 4-WEST		ROUTE TYPE IR-INTERSTATE ROUTE(TP) US-FEDERAL US ROUTE SR-STATE ROUTE CR-NUMBERED COUNTY ROUTE TR-NUMBERED TOWNSHIP ROUTE		ROAD TYPE AL-ALLEY AV-AVENUE BL-BOULEVARD CR-CIRCLE CT-COURT DR-DRIVE HE-HEIGHTS HW-HIGHWAY LA-LANE LA-LANE MP-MILEPOST OV-OVAL PK-PARKWAY PI-PIKE PL-PLACE RD-ROAD SQ-SQUARE ST-STREET TE-TERRACE TL-TRAIL WA-WAY		INTERSECTION RELATED <input checked="" type="checkbox"/> WITHIN INTERSECTION OR ON APPROACH <input type="checkbox"/> WITHIN INTERCHANGE AREA NUMBER OF APPROACHES 6		ROADWAY <input type="checkbox"/> ROADWAY DIVIDED	
LOCATION OF FIRST HARMFUL EVENT 1-ON ROADWAY 2-ON SHOULDER 3-IN MEDIAN 4-ON ROADSIDE 5-ON GORE 6-OUTSIDE TRAFFIC WAY 7-ON RAMP 8-OFF RAMP 01		MANNER OF CRASH COLLISION/IMPACT 1-NOT COLLISION BETWEEN TWO MOTOR VEHICLES IN TRANSPORT 2-REAR-END 3-HEAD-ON 4-REAR-TO-REAR 5-BACKING 6-ANGLE 7-SIDESWIPE, SAME DIRECTION 8-SIDESWIPE, OPPOSITE DIRECTION 9-OTHER / UNKNOWN 6		DIRECTION OF TRAVEL 1-NORTH 2-SOUTH 3-EAST 4-WEST		MEDIAN TYPE 1-DIVIDED FLUSH MEDIAN (<4 FEET) 2-DIVIDED FLUSH MEDIAN (≥4 FEET) 3-DIVIDED, DEPRESSED MEDIAN 4-DIVIDED, RAISED MEDIAN (ANY TYPE) 9-OTHER/UNKNOWN					
<input type="checkbox"/> WORK ZONE RELATED <input type="checkbox"/> WORKERS PRESENT <input type="checkbox"/> LAW ENFORCEMENT PRESENT <input type="checkbox"/> ACTIVE SCHOOL ZONE		WORK ZONE TYPE 1-LANE CLOSURE 2-LANE SHIFT/CROSSOVER 3-WORK ON SHOULDER OR MEDIAN 4-INTERMITTENT OR MOVING WORK 5-OTHER		LOCATION OF CRASH IN WORK ZONE 1-BEFORE THE 1ST WORK ZONE WARNING SIGN 2-ADVANCE WARNING AREA 3-TRANSITION AREA 4-ACTIVITY AREA 5-TERMINATION AREA		CONTOUR 1 1-STRAIGHT LEVEL 2-STRAIGHT GRADE 3-CURVE LEVEL 4-CURVE GRADE 9-OTHER/UNKNOWN		CONDITIONS 1 1-DRY 2-WET 3-SNOW 4-ICE 5-SAND, MUD, DIRT, OIL, GRAVEL 6-WATER (STANDING, MOVING) 7-SLUSH 9-OTHER/UNKNOWN		SURFACE 2 1-CONCRETE 2-BLACKTOP, BITUMINOUS, ASPHALT 3-BRICK/BLOCK 4-SLAG, GRAVEL, STONE 5-DIRT 9-OTHER/UNKNOWN	
LIGHT CONDITION 1-DAYLIGHT 2-DAWN/DUSK 3-DARK - LIGHTED ROADWAY 4-DARK - ROADWAY NOT LIGHTED 5-DARK - UNKNOWN ROADWAY LIGHTING 9-OTHER / UNKNOWN 1		WEATHER 1-CLEAR 2-CLOUDY 3-FOG, SMOG, SMOKE 4-RAIN 5-SLEET, HAIL 6-SNOW 7-SEVERE CROSSWINDS 8-BLOWING SAND, SOIL, DIRT, SNOW 9-FREEZING RAIN OR FREEZING DRIZZLE 99-OTHER / UNKNOWN 01		NARRATIVE On May 17th, 2023 at 3:29 p.m. Unit 1 struck Unit 2. Unit 1 was northbound on S. Gilmore Road. Unit 2 was beginning to make a westbound turn off of Cincinnati Financial Drive. Unit 1 merged into the right turn lane and then ran a red light and struck Unit 2.		SEE OH-2.		Indicate the north direction with an "N" on the compass diagram.			
CRASH REPORTED DATE / TIME 05172023 1529		DISPATCH DATE / TIME 05172023 1531		ARRIVAL DATE / TIME 05172023 1535		SCENE CLEARED DATE / TIME 05172023 1632		REPORT TAKEN BY <input checked="" type="checkbox"/> POLICE AGENCY <input type="checkbox"/> MOTORIST		<input type="checkbox"/> SUPPLEMENT (CORRECTION OR ADDITION TO AN EXISTING REPORT SENT TO OOPS)	
TOTAL TIME ROADWAY CLOSED 3 0		OTHER INVESTIGATION TIME 9 1		OFFICER'S NAME* PO A. Hatcher		CHECKED BY OFFICER'S NAME* 103		OFFICER'S BADGE NUMBER* 1 7 4		CHECKED BY OFFICER'S BADGE NUMBER*	

LOCAL REPORT NUMBER  
2 3 0 3 4 7 9 9

**OWNER**

UNIT # 01 OWNER NAME: LAST, FIRST, MIDDLE  SAME AS DRIVER  
OWNER PHONE: INCLUDE AREA CODE  SAME AS DRIVER

OWNER ADDRESS: STREET, CITY, STATE, ZIP  SAME AS DRIVER

COMMERCIAL CARRIER: NAME, ADDRESS, CITY, STATE, ZIP  
COMMERCIAL CARRIER PHONE: INCLUDE AREA CODE

**DAMAGE**

**DAMAGE SCALE**

4 1 - NONE 3 - FUNCTIONAL DAMAGE  
2 - MINOR DAMAGE 4 - DISABLING DAMAGE  
9 - UNKNOWN

**VEHICLE**

LP STATE OH LICENSE PLATE # 878ZOF VEHICLE IDENTIFICATION # 1GCEC14HX1Z177592 VEHICLE YEAR 1995 VEHICLE MAKE Chevrolet

INSURANCE VERIFIED INSURANCE COMPANY INSURANCE POLICY # COLOR Black VEHICLE MODEL Silverado

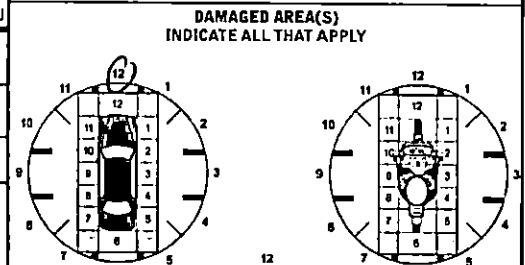

COMMERCIAL  GOVERNMENT  IN EMERGENCY RESPONSE

TYPE OF USE  INTERLOCK DEVICE EQUIPPED  HIT/SKIP UNIT

US DOT # \_\_\_\_\_ TOWED BY: COMPANY NAME Fox

HAZARDOUS MATERIAL CLASS # \_\_\_\_\_ PLACARD ID # \_\_\_\_\_

**UNIT TYPE**

04 1 - PASSENGER CAR 7 - MOTORCYCLE 2-WHEELED 12 - GOLF CART 18 - LIMO (LIVERY VEHICLE) 23 - PEDESTRIAN/SKATER  
2 - PASSENGER VAN (MINIVAN) 8 - MOTORCYCLE 3-WHEELED 13 - SNOWMOBILE 19 - BUS (6+ PASSENGERS) 24 - WHEELCHAIR (ANY TYPE)  
3 - SPORT UTILITY VEHICLE 9 - AUTOCYCLE 14 - SINGLE UNIT TRUCK 20 - OTHER VEHICLE 25 - OTHER NON-MOTORIST  
4 - PICK UP 10 - MOPED OR MOTORIZED BICYCLE 15 - SEMI-TRACTOR 21 - HEAVY EQUIPMENT 26 - BICYCLE  
5 - CARGO VAN 11 - ALL-TERRAIN VEHICLE (ATV / UTV) 16 - FARM EQUIPMENT 22 - ANIMAL WITH RIDER OR ANIMAL-DRAWN VEHICLE 27 - TRAIN  
6 - VAN (9-15 SEATS) 17 - MOTORHOME

0 # OF TRAILING UNITS

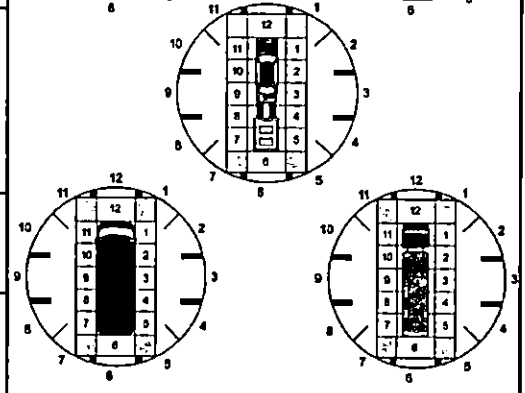

WAS VEHICLE OPERATING IN AUTONOMOUS MODE WHEN CRASH OCCURRED? 2

1 - YES 2 - NO 9 - OTHER / UNKNOWN

AUTONOMOUS MODE LEVEL 0

0 - NO AUTOMATION 1 - DRIVER ASSISTANCE 2 - PARTIAL AUTOMATION 3 - CONDITIONAL AUTOMATION 4 - HIGH AUTOMATION 5 - FULL AUTOMATION 9 - UNKNOWN

**SPECIAL FUNCTION**

1 1 - NONE 6 - BUS - CHARTER/TOUR 11 - FIRE 16 - FARM 21 - MAIL CARRIER  
2 - TAXI 7 - BUS - INTERCITY 12 - MILITARY 17 - MOWING 99 - OTHER / UNKNOWN  
3 - ELECTRONIC RIDE SHARING 8 - BUS - SHUTTLE 13 - POLICE 18 - SNOW REMOVAL  
4 - SCHOOL TRANSPORT 9 - BUS - OTHER 14 - PUBLIC UTILITY 19 - TOWING  
5 - BUS - TRANSIT/COMMUTER 10 - AMBULANCE 15 - CONSTRUCTION EQUIPMENT 20 - SAFETY SERVICE PATROL

**CARGO BODY TYPE**

01 1 - NO CARGO BODY TYPE /NOT APPLICABLE 3 - VEHICLE TOWING ANOTHER MOTORVEHICLE 5 - INTERMODAL CONTAINER CHASSIS 8 - POLE 12 - CONCRETE MIXER  
2 - BUS 4 - LOGGING 6 - CARGO VAN/ENCLOSED BOX 10 - FLAT BED 13 - AUTO TRANSPORTER  
7 - GRAIN/CHIPS/GRAVEL 11 - DUMP 14 - GARBAGE/REFUSE 99 - OTHER / UNKNOWN

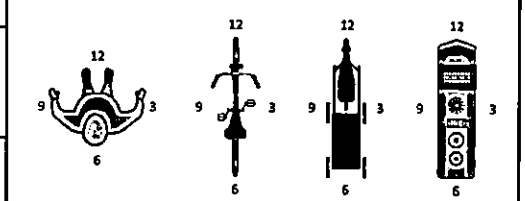

**VEHICLE DEFECTS**

1 1 - TURN SIGNALS 4 - BRAKES 7 - WORN OR SLICK TIRES 9 - MOTOR TROUBLE 99 - OTHER / UNKNOWN  
2 - HEAD LAMPS 5 - STEERING 8 - TRAILER EQUIPMENT DEFECTIVE 10 - DISABLED FROM PRIOR ACCIDENT  
3 - TAIL LAMPS 6 - TIRE BLOWOUT

NO DAMAGE [ 0 ]  UNDERCARRIAGE [ 14 ]  
 TOP [ 13 ]  ALL AREAS [ 15 ]  
 UNIT NOT AT SCENE [ 16 ]

**NON-MOTORIST LOCATION AT IMPACT**

1 1 - INTERSECTION - MARKED CROSSWALK 3 - INTERSECTION - OTHER 6 - BICYCLE LANE 9 - MEDIAN/CROSSING ISLAND 12 - FIRST RESPONDER AT INCIDENT SCENE  
2 - INTERSECTION - UNMARKED CROSSWALK 4 - MIDBLOCK - MARKED CROSSWALK 7 - SHOULDER /ROADSIDE 10 - DRIVEWAY ACCESS 13 - AUTO TRANSPORTER  
5 - TRAVEL LANE - OTHER LOCATION 8 - SIDEWALK 11 - SHARED USE PATHS OR TRAILS 14 - GARBAGE/REFUSE 15 - YIELD SIGN  
99 - OTHER / UNKNOWN

**ACTION**

3 1 - NON-CONTACT 1 - STRAIGHT AHEAD 7 - MAKING U-TURN 13 - NEGOTIATING A CURVE 18 - APPROACHING OR LEAVING VEHICLE  
2 - NON-COLLISION 2 - BACKING 8 - ENTERING TRAFFIC LANE 14 - ENTERING OR CROSSING SPECIFIED LOCATION 19 - STANDING  
3 - STRIKING 01 3 - CHANGING LANES 9 - LEAVING TRAFFIC LANE 15 - WALKING, RUNNING, JOGGING, PLAYING 20 - OTHER NON-MOTORIST  
4 - STRUCK PRE-CRASH ACTIONS 4 - OVERTAKING/PASSING 10 - PARKED 16 - WORKING 21 - STANDING OUTSIDE DISABLED VEHICLE  
5 - BOTH STRIKING & STRUCK 5 - MAKING RIGHT TURN 11 - SLOWING OR STOPPED IN TRAFFIC 17 - PUSHING VEHICLE 99 - OTHER / UNKNOWN  
9 - OTHER / UNKNOWN 6 - MAKING LEFT TURN 12 - DRIVERLESS

**INITIAL POINT OF CONTACT**

12 0 - NO DAMAGE 14 - UNDERCARRIAGE  
1-12 - REFER TO UNIT DIAGRAM 15 - VEHICLE NOT AT SCENE  
99 - UNKNOWN  
13 - TOP

**CONTRIBUTING CIRCUMSTANCES**

03 1 - NONE 7 - LEFT OF CENTER 13 - IMPROPER START FROM A PARKED POSITION 17 - VISION OBSTRUCTION 21 - LYING IN ROADWAY  
2 - FAILURE TO YIELD 8 - FOLLOWING TOO CLOSE /ACDA 14 - STOPPED OR PARKED ILLEGALLY 18 - OPERATING DEFECTIVE EQUIPMENT 22 - NOT DISCERNIBLE  
3 - RAN RED LIGHT 9 - IMPROPER LANE CHANGE 15 - SWERVING TO AVOID 19 - LOAD SHIFTING/FALLING/ SPILLING 23 - OPENING DOOR INTO ROADWAY  
4 - RAN STOP SIGN 11 - DROVE OFF ROAD 16 - WRONG WAY 20 - IMPROPER CROSSING 99 - OTHER IMPROPER ACTION  
5 - UNSAFE SPEED 12 - IMPROPER BACKING

**TRAFFIC**

**TRAFFICWAY FLOW**  
2 1 - ONE-WAY  
2 - TWO-WAY

**TRAFFIC CONTROL**  
2 1 - ROUNDABOUT 4 - STOP SIGN  
2 - SIGNAL 5 - YIELD SIGN  
3 - FLASHER 6 - NO CONTROL

**SEQUENCE OF EVENTS**

13 1 - OVERTURN/ROLLOVER 6 - EQUIPMENT FAILURE **NON-COLLISION** 11 - CROSS CENTERLINE - OPPOSITE DIRECTION OF TRAVEL 16 - RAILWAY VEHICLE  
20 2 - FIRE/EXPLOSION 7 - SEPARATION OF UNITS 12 - DOWNHILL RUNAWAY 17 - ANIMAL - FARM 22 - WORK ZONE MAINTENANCE EQUIPMENT  
3 - IMMERSION 8 - RAN OFF ROAD RIGHT 13 - OTHER NON-COLLISION 18 - ANIMAL - DEER 23 - STRUCK BY FALLING OR SHIFTING CARGO OR ANYTHING SET IN MOTION BY A MOTORVEHICLE  
4 - JACKKNIFE 9 - RAN OFF ROAD LEFT 14 - PEDESTRIAN 19 - ANIMAL - OTHER 24 - OTHER MOVABLE OBJECT  
5 - CARGO /EQUIPMENT LOSS OR SHIFT 10 - CROSS MEDIAN 15 - PEDAL CYCLE 20 - MOTORVEHICLE IN TRANSPORT

**# OF THROUGH LANES ON ROAD**  
6

**RAIL GRADE CROSSING**  
1 1 - NOT INVOLVED  
2 - INVOLVED-ACTIVE CROSSING  
3 - INVOLVED-PASSIVE CROSSING

**FIRST HARMFUL EVENT** 1 **MOST HARMFUL EVENT** 1

25 - IMPACT ATTENUATOR /CRASH CUSHION 31 - GUARDRAIL END 37 - TRAFFIC SIGN POST 43 - CURB 50 - WORK ZONE MAINTENANCE EQUIPMENT  
26 - BRIDGE OVERHEAD STRUCTURE 32 - PORTABLE BARRIER 38 - OVERHEAD SIGN POST 44 - DITCH 51 - WALL  
27 - BRIDGE PIER OR ABUTMENT 33 - MEDIAN CABLE BARRIER 39 - LIGHT /LUMINARIES SUPPORT 45 - EMBANKMENT 52 - BUILDING  
28 - BRIDGE PARAPET 34 - MEDIAN GUARDRAIL BARRIER 40 - UTILITY POLE 46 - FENCE 53 - TUNNEL  
29 - BRIDGE RAIL 35 - MEDIAN CONCRETE BARRIER 41 - OTHER POST, POLE OR SUPPORT 47 - MAILBOX 54 - OTHER FIXED OBJECT  
30 - GUARDRAIL FACE 36 - MEDIAN OTHER BARRIER 42 - CULVERT 48 - TREE 99 - OTHER / UNKNOWN  
49 - FIRE HYDRANT

**UNIT / NON-MOTORIST DIRECTION**

FROM 2 TO 1

1 - NORTH 5 - NORTHEAST  
2 - SOUTH 6 - NORTHWEST  
3 - EAST 7 - SOUTHEAST  
4 - WEST 8 - SOUTHWEST  
9 - OTHER / UNKNOWN

**UNIT SPEED**  
3

**POSTED SPEED**  
3 5

**DETECTED SPEED**  
3 1 - STATED / ESTIMATED SPEED  
2 - CALCULATED / EDR  
3 - UNDETERMINED

**OWNER**

UNIT # 0 2 OWNER NAME: LAST, FIRST, MIDDLE  SAME AS DRIVER  
OWNER PHONE: INCLUDE AREA CODE  SAME AS DRIVER

OWNER ADDRESS: STREET, CITY, STATE, ZIP  SAME AS DRIVER

COMMERCIAL CARRIER: NAME, ADDRESS, CITY, STATE, ZIP  
COMMERCIAL CARRIER PHONE: INCLUDE AREA CODE

**DAMAGE**

DAMAGE SCALE

4 1 - NONE 3 - FUNCTIONAL DAMAGE  
2 - MINOR DAMAGE 4 - DISABLING DAMAGE  
9 - UNKNOWN

**VEHICLE**

LP STATE OH LICENSE PLATE # GCX4201 VEHICLE IDENTIFICATION # 4T1B1D1E1D1U016232 VEHICLE YEAR 2013 VEHICLE MAKE Toyota

INSURANCE VERIFIED INSURANCE COMPANY Geico INSURANCE POLICY # 4207759335 COLOR Maroon VEHICLE MODEL Avalon

COMMERCIAL  GOVERNMENT  IN EMERGENCY RESPONSE TYPE OF USE  
#OCCUPANTS 0 1 TOWED BY: COMPANY NAME

INTERLOCK DEVICE EQUIPPED  HIT/SKIP UNIT HAZARDOUS MATERIAL  
 MATERIAL RELEASED CLASS # PLACARD ID #  
 PLACARD

**DAMAGED AREA(S)**  
INDICATE ALL THAT APPLY

UNIT TYPE 0 1

1 - PASSENGER CAR 7 - MOTORCYCLE 2-WHEELED 12 - GOLF CART 18 - LIMO (LIVERY VEHICLE) 23 - PEDESTRIAN / SKATER  
2 - PASSENGER VAN (MINIVAN) 8 - MOTORCYCLE 3-WHEELED 13 - SNOWMOBILE 19 - BUS (16+ PASSENGERS) 24 - WHEELCHAIR (ANY TYPE)  
3 - SPORT UTILITY VEHICLE 9 - AUTOCYCLE 14 - SINGLE UNIT TRUCK 20 - OTHER VEHICLE 25 - OTHER NON-MOTORIST  
4 - PICK UP 10 - MOPED OR MOTORIZED BICYCLE 15 - SEMI-TRACTOR 21 - HEAVY EQUIPMENT 26 - BICYCLE  
5 - CARGO VAN 11 - ALL TERRAIN VEHICLE (ATV / UTV) 16 - FARM EQUIPMENT 22 - ANIMAL WITH RIDER OR ANIMAL-DRAWN VEHICLE 27 - TRAIN  
6 - VAN (9-15 SEATS) 17 - MOTORHOME 99 - UNKNOWN OR HIT/SKIP

# OF TRAILING UNITS

WAS VEHICLE OPERATING IN AUTONOMOUS MODE WHEN CRASH OCCURRED? 2

1 - YES 2 - NO 9 - OTHER / UNKNOWN

AUTONOMOUS MODE LEVEL 0

0 - NO AUTOMATION 1 - DRIVER ASSISTANCE 2 - PARTIAL AUTOMATION 3 - CONDITIONAL AUTOMATION 4 - HIGH AUTOMATION 5 - FULL AUTOMATION 9 - UNKNOWN

SPECIAL FUNCTION 0 1

1 - NONE 2 - TAXI 3 - ELECTRONIC RIDE SHARING 4 - SCHOOL TRANSPORT 5 - BUS - TRANSIT/COMMUTER 6 - BUS - CHARTER/TOUR 7 - BUS - INTERCITY 8 - BUS - SHUTTLE 9 - BUS - OTHER 10 - AMBULANCE 11 - FIRE 12 - MILITARY 13 - POLICE 14 - PUBLIC UTILITY 15 - CONSTRUCTION EQUIPMENT 16 - FARM 17 - MOWING 18 - SNOW REMOVAL 19 - TOWING 20 - SAFETY SERVICE PATROL 21 - MAIL CARRIER 99 - OTHER / UNKNOWN

CARGO BODY TYPE 0 1

1 - NO CARGO BODY TYPE /NOT APPLICABLE 2 - BUS 3 - VEHICLE TOWING ANOTHER MOTOR VEHICLE 4 - LOGGING 5 - INTERMODAL CONTAINER CHASSIS 6 - CARGO VAN/ENCLOSED BOX 7 - GRAIN/CHIPS/GRAVEL 8 - POLE 9 - CARGO TANK 10 - FLAT BED 11 - DUMP 12 - CONCRETE MIXER 13 - AUTO TRANSPORTER 14 - GARBAGE/REFUSE 99 - OTHER / UNKNOWN

VEHICLE DEFECTS

1 - TURN SIGNALS 2 - HEAD LAMPS 3 - TAIL LAMPS 4 - BRAKES 5 - STEERING 6 - TIRE BLOWOUT 7 - WORN OR SLICK TIRES 8 - TRAILER EQUIPMENT DEFECTIVE 9 - MOTOR TROUBLE 10 - DISABLED FROM PRIOR ACCIDENT 99 - OTHER / UNKNOWN

- NO DAMAGE [ 0 ]  - UNDERCARRIAGE [ 14 ]  
 - TOP [ 13 ]  - ALL AREAS [ 15 ]  
 - UNIT NOT AT SCENE [ 16 ]

NON-MOTORIST LOCATION AT IMPACT

1 - INTERSECTION - MARKED CROSSWALK 2 - INTERSECTION - UNMARKED CROSSWALK 3 - INTERSECTION - OTHER 4 - MIDDLEBLOCK - MARKED CROSSWALK 5 - TRAVEL LANE - OTHER LOCATION 6 - BICYCLE LANE 7 - SHOULDER / ROADSIDE 8 - SIDEWALK 9 - MEDIUM CROSSING ISLAND 10 - DRIVEWAY ACCESS 11 - SHARED USE PATHS OR TRAILS 12 - FIRST RESPONDER AT INCIDENT SCENE 99 - OTHER / UNKNOWN

ACTION 4 PRE-CRASH ACTIONS 0 1

1 - NON-CONTACT 2 - NON-COLLISION 3 - STRIKING 4 - STRUCK 5 - BOTH STRIKING & STRUCK 9 - OTHER / UNKNOWN 1 - STRAIGHT AHEAD 2 - BACKING 3 - CHANGING LANES 4 - OVERTAKING/PASSING 5 - MAKING RIGHT TURN 6 - MAKING LEFT TURN 7 - MAKING U-TURN 8 - ENTERING TRAFFIC LANE 9 - LEAVING TRAFFIC LANE 10 - PARKED 11 - SLOWING OR STOPPED IN TRAFFIC 12 - DRIVERLESS 13 - NEGOTIATING A CURVE 14 - ENTERING OR CROSSING SPECIFIED LOCATION 15 - WALKING, RUNNING, JOGGING, PLAYING 16 - WORKING 17 - PUSHING VEHICLE 18 - APPROACHING OR LEAVING VEHICLE 19 - STANDING 20 - OTHER NON-MOTORIST 21 - STANDING OUTSIDE DISABLED VEHICLE 99 - OTHER / UNKNOWN

INITIAL POINT OF CONTACT

1 2 0 - NO DAMAGE 13 - TOP 14 - UNDERCARRIAGE 15 - VEHICLE NOT AT SCENE DIAGRAM 99 - UNKNOWN

CONTRIBUTING CIRCUMSTANCES 0 1

1 - NONE 2 - FAILURE TO YIELD 3 - RAN RED LIGHT 4 - RAN STOP SIGN 5 - UNSAFE SPEED 6 - IMPROPER TURN 7 - LEFT OF CENTER 8 - FOLLOWING TOO CLOSE / ACDA 9 - IMPROPER LANE CHANGE 10 - IMPROPER PASSING 11 - DROVE OFF ROAD 12 - IMPROPER BACKING 13 - IMPROPER START FROM A PARKED POSITION 14 - STOPPED OR PARKED ILLEGALLY 15 - SWERVING TO AVOID 16 - WRONG WAY 17 - VISION OBSTRUCTION 18 - OPERATING DEFECTIVE EQUIPMENT 19 - LOAD SHIFTING/FALLING/ SPILLING 20 - IMPROPER CROSSING 21 - LYING IN ROADWAY 22 - NOT DISCERNIBLE 23 - OPENING DOOR INTO ROADWAY 99 - OTHER IMPROPER ACTION

**TRAFFIC**

TRAFFICWAY FLOW 2

1 - ONE-WAY 2 - TWO-WAY

TRAFFIC CONTROL 2

1 - ROUNDABOUT 2 - SIGNAL 3 - FLASHER 4 - STOP SIGN 5 - YIELD SIGN 6 - NO CONTROL

SEQUENCE OF EVENTS

1 2 0 1 - OVERTURN/ROLLOVER 2 - FIRE/EXPLOSION 3 - IMMERSION 4 - JACKKNIFE 5 - CARGO/EQUIPMENT LOSS OR SHIFT 6 - EQUIPMENT FAILURE 7 - SEPARATION OF UNITS 8 - RAN OFF ROAD RIGHT 9 - RAN OFF ROAD LEFT 10 - CROSS MEDIAN 11 - CROSS CENTERLINE - OPPOSITE DIRECTION OF TRAVEL 12 - DOWNHILL RUNAWAY 13 - OTHER NON-COLLISION 14 - PEDESTRIAN 15 - PEDALCYCLE 16 - RAILWAY VEHICLE 17 - ANIMAL - FARM 18 - ANIMAL - DEER 19 - ANIMAL - OTHER 20 - MOTOR VEHICLE IN TRANSPORT 21 - PARKED MOTOR VEHICLE 22 - WORK ZONE MAINTENANCE EQUIPMENT 23 - STRUCK BY FALLING, SHIFTING CARGO OR ANYTHING SET IN MOTION BY A MOTOR VEHICLE 24 - OTHER MOVABLE OBJECT

# OF THROUGH LANES ON ROAD 6

RAIL GRADE CROSSING 1

1 - NOT INVOLVED 2 - INVOLVED-ACTIVE CROSSING 3 - INVOLVED-PASSIVE CROSSING

**COLLISION WITH FIXED OBJECT - STRUCK**

4 25 - IMPACT ATTENUATOR / CRASH CUSHION 26 - BRIDGE OVERHEAD STRUCTURE 27 - BRIDGE PIER OR ABUTMENT 28 - BRIDGE PARAPET 29 - BRIDGE RAIL 30 - GUARDRAIL FACE 31 - GUARDRAIL END 32 - PORTABLE BARRIER 33 - MEDIAN CABLE BARRIER 34 - MEDIAN GUARDRAIL BARRIER 35 - MEDIAN CONCRETE BARRIER 36 - MEDIAN OTHER BARRIER 37 - TRAFFIC SIGN POST 38 - OVERHEAD SIGN POST 39 - LIGHT / LUMINARIES SUPPORT 40 - UTILITY POLE 41 - OTHER POST, POLE OR SUPPORT 42 - CULVERT 43 - CURB 44 - DITCH 45 - EMBANKMENT 46 - FENCE 47 - MAILBOX 48 - TREE 49 - FIRE HYDRANT 50 - WORK ZONE MAINTENANCE EQUIPMENT 51 - WALL 52 - BUILDING 53 - TUNNEL 54 - OTHER FIXED OBJECT 99 - OTHER / UNKNOWN

FIRST HARMFUL EVENT 1 MOST HARMFUL EVENT 1

**UNIT / NON-MOTORIST DIRECTION**

FROM 3 TO 4

1 - NORTH 2 - SOUTH 3 - EAST 4 - WEST 5 - NORTHEAST 6 - NORTHWEST 7 - SOUTHEAST 8 - SOUTHWEST 9 - OTHER / UNKNOWN

UNIT SPEED 5

POSTED SPEED 3 5

DETECTED SPEED 1

1 - STATED / ESTIMATED SPEED 2 - CALCULATED / EDR 3 - UNDETERMINED



# MOTORIST / Non-MOTORIST

LOCAL REPORT NUMBER  
2 3 0 3 4 7 9 9

<b>UNIT #</b> 0 1	<b>NAME: LAST, FIRST, MIDDLE</b> Schott, Kenneth James			<b>DATE OF BIRTH</b> 0 4 3 0 1 9 5 4		<b>AGE</b> 6 9	<b>GENDER</b> M			
<b>ADDRESS: STREET, CITY, STATE, ZIP</b> 9115 Zoellner Drive, Cincinnati OH 45251				<b>CONTACT PHONE - INCLUDE AREA CODE</b>						
<b>INJURIES</b> 3	<b>INJURED TAKEN BY</b> 2	<b>EMS AGENCY (NAME)</b> City of Fairfield	<b>INJURED TAKEN TO: MEDICAL FACILITY (NAME, CITY)</b> Mercy Fairfield	<b>SAFETY EQUIPMENT USED</b> 9 9	<input type="checkbox"/> DOT-COMPLIANT MC HELMET	<b>SEATING POSITION</b> 0 1	<b>AIR BAG USAGE</b> 1	<b>EJECTION</b> 1	<b>TRAPPED</b> 1	
<b>OL STATE</b> OH	<b>OPERATOR LICENSE NUMBER</b>		<b>OFFENSE CHARGED</b> 313.01a	<b>LOCAL CODE</b> <input checked="" type="checkbox"/>	<b>OFFENSE DESCRIPTION</b> Traffic Control Device		<b>CITATION NUMBER</b> 253997			
<b>OL CLASS</b> 4	<b>ENDORSEMENT SELECT UP TO 2</b>	<b>RESTRICTION SELECT UP TO 3</b>	<b>DRIVER DISTRACTED BY</b> 1	<b>ALCOHOL / DRUG SUSPECTED</b> <input type="checkbox"/> ALCOHOL <input type="checkbox"/> MARIJUANA <input type="checkbox"/> OTHER DRUG		<b>CONDITION</b> 1	<b>ALCOHOL TEST</b> STATUS TYPE VALUE		<b>DRUG TEST(S)</b> STATUS TYPE RESULT SELECT UP TO 4	

<b>UNIT #</b> 0 2	<b>NAME: LAST, FIRST, MIDDLE</b> Wang, Hsien-Ping Ernie			<b>DATE OF BIRTH</b> 0 6 1 2 1 9 6 8		<b>AGE</b> 5 4	<b>GENDER</b> M			
<b>ADDRESS: STREET, CITY, STATE, ZIP</b> 937 London Court, Cincinnati, OH 45245				<b>CONTACT PHONE - INCLUDE AREA CODE</b>						
<b>INJURIES</b> 4	<b>INJURED TAKEN BY</b> 2	<b>EMS AGENCY (NAME)</b> Forest Park	<b>INJURED TAKEN TO: MEDICAL FACILITY (NAME, CITY)</b> Mercy Fairfield	<b>SAFETY EQUIPMENT USED</b> 0 4	<input type="checkbox"/> DOT-COMPLIANT MC HELMET	<b>SEATING POSITION</b> 0 1	<b>AIR BAG USAGE</b> 1	<b>EJECTION</b> 1	<b>TRAPPED</b> 1	
<b>OL STATE</b> OH	<b>OPERATOR LICENSE NUMBER</b>		<b>OFFENSE CHARGED</b>	<b>LOCAL CODE</b> <input type="checkbox"/>	<b>OFFENSE DESCRIPTION</b>		<b>CITATION NUMBER</b>			
<b>OL CLASS</b> 4	<b>ENDORSEMENT SELECT UP TO 2</b>	<b>RESTRICTION SELECT UP TO 3</b>	<b>DRIVER DISTRACTED BY</b> 1	<b>ALCOHOL / DRUG SUSPECTED</b> <input type="checkbox"/> ALCOHOL <input type="checkbox"/> MARIJUANA <input type="checkbox"/> OTHER DRUG		<b>CONDITION</b> 1	<b>ALCOHOL TEST</b> STATUS TYPE VALUE		<b>DRUG TEST(S)</b> STATUS TYPE RESULT SELECT UP TO 4	

<b>UNIT #</b>	<b>NAME: LAST, FIRST, MIDDLE</b>			<b>DATE OF BIRTH</b>		<b>AGE</b> 0	<b>GENDER</b>			
<b>ADDRESS: STREET, CITY, STATE, ZIP</b>				<b>CONTACT PHONE - INCLUDE AREA CODE</b>						
<b>INJURIES</b>	<b>INJURED TAKEN BY</b>	<b>EMS AGENCY (NAME)</b>	<b>INJURED TAKEN TO: MEDICAL FACILITY (NAME, CITY)</b>	<b>SAFETY EQUIPMENT USED</b>	<input type="checkbox"/> DOT-COMPLIANT MC HELMET	<b>SEATING POSITION</b>	<b>AIR BAG USAGE</b>	<b>EJECTION</b>	<b>TRAPPED</b>	
<b>OL STATE</b>	<b>OPERATOR LICENSE NUMBER</b>		<b>OFFENSE CHARGED</b>	<b>LOCAL CODE</b> <input type="checkbox"/>	<b>OFFENSE DESCRIPTION</b>		<b>CITATION NUMBER</b>			
<b>OL CLASS</b>	<b>ENDORSEMENT SELECT UP TO 2</b>	<b>RESTRICTION SELECT UP TO 3</b>	<b>DRIVER DISTRACTED BY</b>	<b>ALCOHOL / DRUG SUSPECTED</b> <input type="checkbox"/> ALCOHOL <input type="checkbox"/> MARIJUANA <input type="checkbox"/> OTHER DRUG		<b>CONDITION</b>	<b>ALCOHOL TEST</b> STATUS TYPE VALUE		<b>DRUG TEST(S)</b> STATUS TYPE RESULT SELECT UP TO 4	

INJURIES	SEATING POSITION	AIR BAG	OL CLASS	OL RESTRICTION(S)	DRIVER DISTRACTION	TEST STATUS
1 - FATAL 2 - SUSPECTED SERIOUS INJURY 3 - SUSPECTED MINOR INJURY 4 - POSSIBLE INJURY 5 - NO APPARENT INJURY	1 - FRONT - LEFT SIDE (MOTORCYCLE DRIVER) 2 - FRONT - MIDDLE 3 - FRONT - RIGHT SIDE 4 - SECOND - LEFT SIDE (MOTORCYCLE PASSENGER) 5 - SECOND - MIDDLE 6 - SECOND - RIGHT SIDE 7 - THIRD - LEFT SIDE (MOTORCYCLE SIDE CAR) 8 - THIRD - MIDDLE 9 - THIRD - RIGHT SIDE 10 - SLEEPER SECTION OF TRUCK CAB	1 - NOT DEPLOYED 2 - DEPLOYED FRONT 3 - DEPLOYED SIDE 4 - DEPLOYED BOTH FRONT / SIDE 5 - NOT APPLICABLE 9 - DEPLOYMENT UNKNOWN	1 - CLASS A 2 - CLASS B 3 - CLASS C 4 - REGULAR CLASS (OHIO = D) 5 - MC MOPED ONLY 6 - NO VALID OL	1 - ALCOHOL INTERLOCK DEVICE 2 - CDL INTRASTATE ONLY 3 - CORRECTIVE LENSES 4 - FARM WAIVER 5 - EXCEPT CLASS A BUS 6 - EXCEPT CLASS A & CLASS B BUS 7 - EXCEPT TRACTOR-TRAILER 8 - INTERMEDIATE LICENSE 9 - LEARNER'S PERMIT RESTRICTIONS 10 - LIMITED TO DAYLIGHT ONLY 11 - LIMITED TO EMPLOYMENT 12 - LIMITED - OTHER 13 - MECHANICAL DEVICES (SPECIAL BRAKES, HAND CONTROLS, OR OTHER ADAPTIVE DEVICES) 14 - MILITARY VEHICLES ONLY 15 - MOTOR VEHICLES WITHOUT AIR BRAKES 16 - OUTSIDE MIRROR 17 - PROSTHETIC AID 18 - OTHER	1 - NOT DISTRACTED 2 - MANUALLY OPERATING AN ELECTRONIC COMMUNICATION DEVICE (TEXTING, TYPING, DIALING) 3 - TALKING ON HANDS-FREE COMMUNICATION DEVICE 4 - TALKING ON HAND-HELD COMMUNICATION DEVICE 5 - OTHER ACTIVITY WITH AN ELECTRONIC DEVICE 6 - PASSENGER 7 - OTHER DISTRACTION INSIDE THE VEHICLE 8 - OTHER DISTRACTION OUTSIDE THE VEHICLE 9 - OTHER / UNKNOWN	1 - NONE GIVEN 2 - TEST REFUSED 3 - TEST GIVEN, CONTAMINATED SAMPLE / UNUSABLE 4 - TEST GIVEN, RESULTS KNOWN 5 - TEST GIVEN, RESULTS UNKNOWN
<b>INJURED TAKEN BY</b> 1 - NOT TRANSPORTED / TREATED AT SCENE 2 - EMS 3 - POLICE 9 - OTHER / UNKNOWN		<b>EJECTION</b> 1 - NOT EJECTED 2 - PARTIALLY EJECTED 3 - TOTALLY EJECTED 4 - NOT APPLICABLE	<b>OL ENDORSEMENT</b> H - HAZMAT M - MOTORCYCLE P - PASSENGER N - TANKER Q - MOTOR SCOOTER R - THREE-WHEEL MOTORCYCLE S - SCHOOL BUS T - DOUBLE & TRIPLE TRAILERS X - TANKER / HAZMAT			<b>ALCOHOL TEST TYPE</b> 1 - NONE 2 - BLOOD 3 - URINE 4 - BREATH 5 - OTHER
<b>SAFETY EQUIPMENT</b> 1 - NONE USED 2 - SHOULDER BELT ONLY USED 3 - LAP BELT ONLY USED 4 - SHOULDER & LAP BELT USED 5 - CHILD RESTRAINT SYSTEM FORWARD FACING 6 - CHILD RESTRAINT SYSTEM - REAR FACING 7 - BOOSTER SEAT 8 - HELMET USED 9 - PROTECTIVE PADS USED (ELBOW, KNEES, ETC.) 10 - REFLECTIVE CLOTHING 11 - LIGHTING - PEDESTRIAN / BICYCLE ONLY 99 - OTHER / UNKNOWN	11 - PASSENGER IN OTHER ENCLOSED CARGO AREA (NON-TRAILING UNIT, BUS, PICK-UP WITH CAP) 12 - PASSENGER IN UNENCLOSED CARGO AREA 13 - TRAILING UNIT 14 - RIDING ON VEHICLE EXTERIOR (NON-TRAILING UNIT) 15 - NON-MOTORIST 99 - OTHER / UNKNOWN	<b>TRAPPED</b> 1 - NOT TRAPPED 2 - EXTRICATED BY MECHANICAL MEANS 3 - FREED BY NON-MECHANICAL MEANS	<b>GENDER</b> F - FEMALE M - MALE U - OTHER / UNKNOWN			<b>DRUG TEST TYPE</b> 1 - NONE 2 - BLOOD 3 - URINE 4 - OTHER
					<b>CONDITION</b> 1 - APPARENTLY NORMAL 2 - PHYSICAL IMPAIRMENT 3 - EMOTIONAL (E.G. DEPRESSED, ANGRY, DISTURBED) 4 - ILLNESS 5 - FELL ASLEEP, FAINTED, FATIGUED, ETC. 6 - UNDER THE INFLUENCE OF MEDICATIONS / DRUGS / ALCOHOL 9 - OTHER / UNKNOWN	<b>DRUG TEST RESULT(S)</b> 1 - AMPHETAMINES 2 - BARBITURATES 3 - BENZODIAZEPINES 4 - CANNABINOIDS 5 - COCAINE 6 - OPIATES / OPIODS 7 - OTHER 8 - NEGATIVE RESULTS

LOCAL REPORT NUMBER 2303.4799	REPORTING AGENCY Fairfield Police Department	DATE OF ACCIDENT 5/17/23
IN COUNTY OF Butler	ACCIDENT LOCATION South Gilmore Rd. @ Cincinnati Financial Dr.	

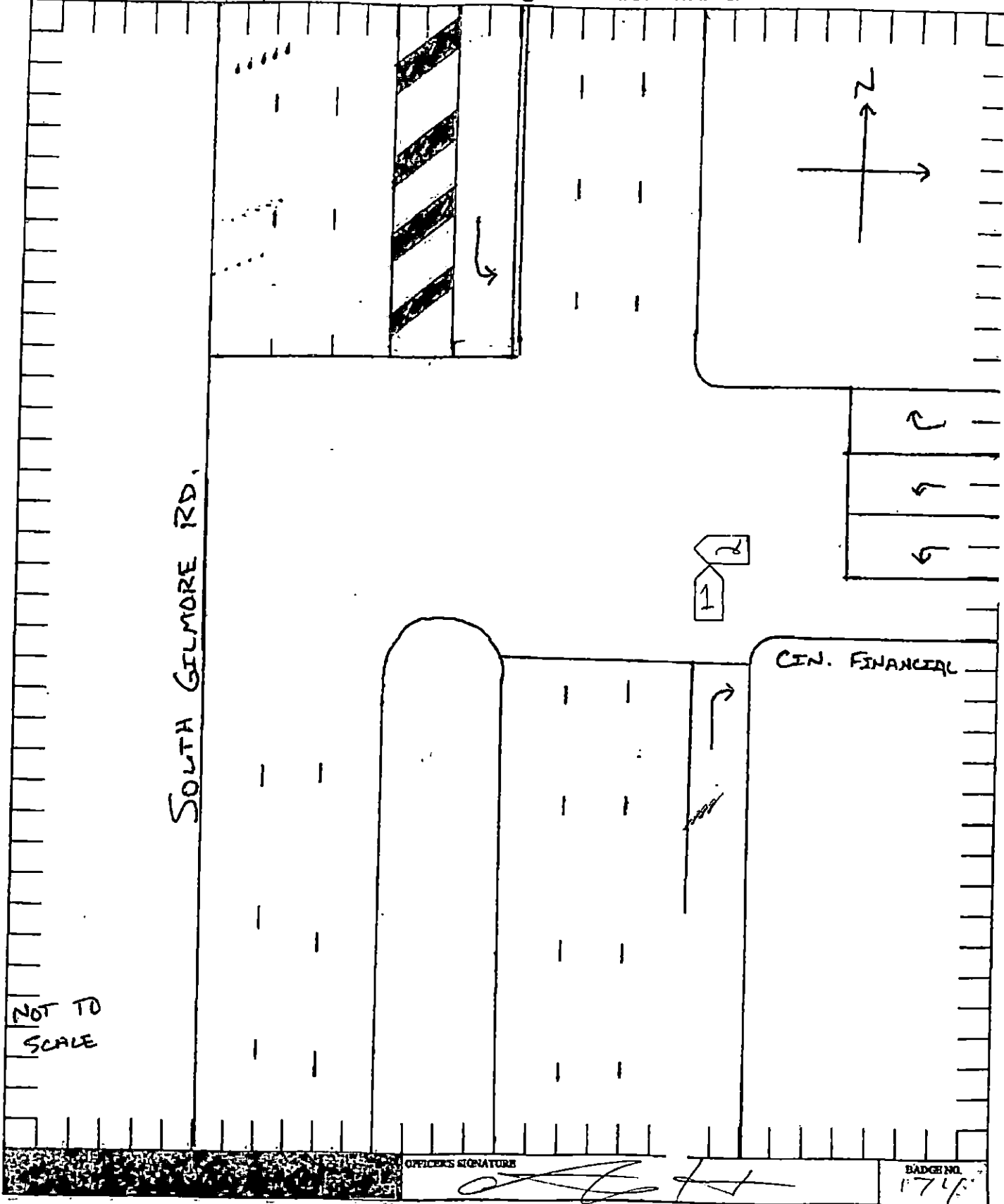

NOT TO SCALE

OFFICER'S SIGNATURE *[Signature]*

BADGE NO. 174