



TRAFFIC CRASH REPORT

*DENOTES MANDATORY FIELD FOR SUPPLEMENT REPORT

LOCAL REPORT NUMBER*

<input checked="" type="checkbox"/> PHOTOS TAKEN <input type="checkbox"/> SECONDARY CRASH		<input checked="" type="checkbox"/> OH-2 <input type="checkbox"/> OH-1P <input type="checkbox"/> OTHER <input type="checkbox"/> PRIVATE PROPERTY		LOCAL INFORMATION		2 2 0 0 8 3 5 0	
REPORTING AGENCY NAME* Fairfield Police Department				NCIC* 0 0 9 0 1		HIT/SKIP 1 - SOLVED 2 - UNSOLVED	
COUNTY* 0 9		LOCALITY* 1 - CITY 2 - VILLAGE 3 - TOWNSHIP		LOCATION: CITY, VILLAGE, TOWNSHIP* City of Fairfield		CRASH DATE / TIME* 02 05 2022 13 56	
ROUTE TYPE 1 - NORTH 2 - SOUTH 3 - EAST 4 - WEST		ROUTE NUMBER 1 - NORTH 2 - SOUTH 3 - EAST 4 - WEST		LOCATION ROAD NAME South Gilmore		ROAD TYPE R D	
REFERENCE ROAD NAME (ROAD, MILEPOST, HOUSE #) Resor		ROAD TYPE R D		LATITUDE DECIMAL DEGREES 39.31823		CRASH SEVERITY 1 - FATAL 2 - SERIOUS INJURY SUSPECTED 3 - MINOR INJURY SUSPECTED 4 - INJURY POSSIBLE 5 - PROPERTY DAMAGE ONLY	
REFERENCE POINT 1 - INTERSECTION 2 - MILE POST 3 - HOUSE #		DIRECTION FROM REFERENCE 1 - NORTH 2 - SOUTH 3 - EAST 4 - WEST		ROUTE TYPE IR - INTERSTATE ROUTE(TP) US - FEDERAL US ROUTE SR - STATE ROUTE CR - NUMBERED COUNTY ROUTE TR - NUMBERED TOWNSHIP ROUTE		ROAD TYPE AL - ALLEY AV - AVENUE BL - BOULEVARD CR - CIRCLE CT - COURT DR - DRIVE HE - HEIGHTS HW - HIGHWAY LA - LANE MP - MILEPOST OV - OVAL PK - PARKWAY PI - PIKE PL - PLACE RD - ROAD SQ - SQUARE ST - STREET TE - TERRACE TL - TRAIL WA - WAY	
DISTANCE FROM REFERENCE 2 0		DISTANCE UNIT OF MEASURE 1 - MILES 2 - FEET 3 - YARDS		INTERSECTION RELATED <input type="checkbox"/> WITHIN INTERSECTION OR ON APPROACH <input type="checkbox"/> WITHIN INTERCHANGE AREA		NUMBER OF APPROACHES	
LOCATION OF FIRST HARMFUL EVENT 1 - ON ROADWAY 2 - ON SHOULDER 3 - IN MEDIAN 4 - ON ROADSIDE 5 - ON GORE 6 - OUTSIDE TRAFFIC WAY 7 - ON RAMP 8 - OFF RAMP		MANNER OF CRASH COLLISION/IMPACT 1 - NOT COLLISION BETWEEN TWO MOTOR VEHICLES IN TRANSPORT 2 - REAR-END 3 - HEAD-ON 4 - REAR-TO-REAR 5 - BACKING 6 - ANGLE 7 - SIDESWIPE, SAME DIRECTION 8 - SIDESWIPE, OPPOSITE DIRECTION 9 - OTHER / UNKNOWN		DIRECTION OF TRAVEL 1 - NORTH 2 - SOUTH 3 - EAST 4 - WEST		MEDIAN TYPE 1 - DIVIDED FLUSH MEDIAN (<4 FEET) 2 - DIVIDED FLUSH MEDIAN (>4 FEET) 3 - DIVIDED, DEPRESSED MEDIAN 4 - DIVIDED, RAISED MEDIAN (ANY TYPE) 9 - OTHER/UNKNOWN	
WORK ZONE RELATED <input type="checkbox"/> WORKERS PRESENT <input type="checkbox"/> LAW ENFORCEMENT PRESENT <input type="checkbox"/> ACTIVE SCHOOL ZONE		WORK ZONE TYPE 1 - LANE CLOSURE 2 - LANE SHIFT/CROSSOVER 3 - WORK ON SHOULDER OR MEDIAN 4 - INTERMITTENT OR MOVING WORK 5 - OTHER		LOCATION OF CRASH IN WORK ZONE 1 - BEFORE THE 1ST WORK ZONE WARNING SIGN 2 - ADVANCE WARNING AREA 3 - TRANSITION AREA 4 - ACTIVITY AREA 5 - TERMINATION AREA		CONTOUR 2 1 - STRAIGHT LEVEL 2 - STRAIGHT GRADE 3 - CURVE LEVEL 4 - CURVE GRADE 9 - OTHER/UNKNOWN	
LIGHT CONDITION 1 - DAYLIGHT 2 - DAWN/DUSK 3 - DARK - LIGHTED ROADWAY 4 - DARK - ROADWAY NOT LIGHTED 5 - DARK - UNKNOWN ROADWAY LIGHTING 9 - OTHER / UNKNOWN		WEATHER 1 - CLEAR 2 - CLOUDY 3 - FOG, SMOG, SMOKE 4 - RAIN 5 - SLEET, HAIL 6 - SNOW 7 - SEVERE CROSSWINDS 8 - BLOWING SAND, SOIL, DIRT, SNOW 9 - FREEZING RAIN OR FREEZING DRIZZLE 99 - OTHER / UNKNOWN		CONDITIONS 1 1 - DRY 2 - WET 3 - SNOW 4 - ICE 5 - SAND, MUD, DIRT, OIL, GRAVEL 6 - WATER (STANDING, MOVING) 7 - SLUSH 9 - OTHER/UNKNOWN		SURFACE 2 1 - CONCRETE 2 - BLACKTOP, BITUMINOUS, ASPHALT 3 - BRICK/BLOCK 4 - SLAG, GRAVEL, STONE 5 - DIRT 9 - OTHER/UNKNOWN	
NARRATIVE On 02/05/2022 at approximately 1:56 P.M. Unit #2 was stopped in traffic in the left through lane of northbound South Gilmore Rd. at Resor Rd. Unit #1 was northbound on South Gilmore Rd. in the left through lane of travel. The driver of Unit #1 failed to maintain assured clear distance and collided into the rear of Unit #2.				See OH-2			
CRASH REPORTED DATE / TIME 02 05 2022 13 56		DISPATCH DATE / TIME 02 05 2022 13 57		ARRIVAL DATE / TIME 02 05 2022 14 04		SCENE CLEARED DATE / TIME 02 05 2022 14 38	
TOTAL TIME ROADWAY CLOSED 4 1		OTHER INVESTIGATION TIME		OFFICER'S NAME* Doug Day		REPORT TAKEN BY <input checked="" type="checkbox"/> POLICE AGENCY <input type="checkbox"/> MOTORIST	
TOTAL MINUTES		OFFICER'S BADGE NUMBER* 7 6		CHECKED BY OFFICER'S NAME* 67		SUPPLEMENT (CORRECTION OR ADDITION TO AN EXISTING REPORT SENT TO ODPIS)	

OWNER	UNIT #	OWNER NAME: LAST, FIRST, MIDDLE <input checked="" type="checkbox"/> SAME AS DRIVER		OWNER PHONE: INCLUDE AREA CODE <input checked="" type="checkbox"/> SAME AS DRIVER	
	01				
OWNER ADDRESS: STREET, CITY, STATE, ZIP <input checked="" type="checkbox"/> SAME AS DRIVER					
COMMERCIAL CARRIER: NAME, ADDRESS, CITY, STATE, ZIP					
COMMERCIAL CARRIER PHONE: INCLUDE AREA CODE					
VEHICLE	LP STATE	LICENSE PLATE #	VEHICLE IDENTIFICATION #		VEHICLE YEAR
	OH	GWP1567	2GKFLNE39G6107636		2016
	<input checked="" type="checkbox"/> INSURANCE VERIFIED	INSURANCE COMPANY State Farm		INSURANCE POLICY # 914-5572-E21-35	COLOR Black
	TYPE OF USE		US DOT #	TOWED BY: COMPANY NAME Waynes	
	<input type="checkbox"/> COMMERCIAL <input type="checkbox"/> GOVERNMENT <input type="checkbox"/> IN EMERGENCY RESPONSE				
	<input type="checkbox"/> INTERLOCK DEVICE EQUIPPED <input type="checkbox"/> HIT/SKIP UNIT	#OCCUPANTS 02	VEHICLE WEIGHT GVWR/GCWR 1 - ≤10K LBS. 2 - 10,001 - 26K LBS. 3 - >26K LBS.		HAZARDOUS MATERIAL <input type="checkbox"/> MATERIAL RELEASED <input type="checkbox"/> PLACARD CLASS # PLACARD ID #
	UNIT TYPE				
	1 - PASSENGER CAR 7 - MOTORCYCLE 2-WHEELED 12 - GOLF CART 18 - LIMO (LIVERY VEHICLE) 23 - PEDESTRIAN / SKATER 2 - PASSENGER VAN (MINIVAN) 8 - MOTORCYCLE 3-WHEELED 13 - SNOWMOBILE 19 - BUS (16+ PASSENGERS) 24 - WHEELCHAIR (ANY TYPE) 3 - SPORT UTILITY VEHICLE 9 - AUTOCYCLE 14 - SINGLE UNIT TRUCK 20 - OTHER VEHICLE 25 - OTHER NON-MOTORIST 4 - PICK UP 10 - MOPED OR MOTORIZED BICYCLE 15 - SEMI-TRACTOR 21 - HEAVY EQUIPMENT 26 - BICYCLE 5 - CARGO VAN 11 - ALL TERRAIN VEHICLE (ATV / UTV) 16 - FARM EQUIPMENT 22 - ANIMAL WITH RIDER OR ANIMAL-DRAWN VEHICLE 27 - TRAIN 6 - VAN (9-15 SEATS) 17 - MOTORHOME 99 - UNKNOWN OR HIT/SKIP				
	# OF TRAILING UNITS				
	2				
EVENT(S)	WAS VEHICLE OPERATING IN AUTONOMOUS MODE WHEN CRASH OCCURRED?				
	1 - YES 2 - NO 9 - OTHER / UNKNOWN				
	AUTONOMOUS MODE LEVEL				
	1 - NONE 6 - BUS - CHARTER/TOUR 11 - FIRE 16 - FARM 21 - MAIL CARRIER 2 - TAXI 7 - BUS - INTERCITY 12 - MILITARY 17 - MOWING 99 - OTHER / UNKNOWN 3 - ELECTRONIC RIDE SHARING 8 - BUS - SHUTTLE 13 - POLICE 18 - SNOW REMOVAL 4 - SCHOOL TRANSPORT 9 - BUS - OTHER 14 - PUBLIC UTILITY 19 - TOWING 5 - BUS - TRANSIT/COMMUTER 10 - AMBULANCE 15 - CONSTRUCTION EQUIPMENT 20 - SAFETY SERVICE PATROL				
	CARGO BODY TYPE				
	1 - NO CARGO BODY TYPE / NOT APPLICABLE 3 - VEHICLE TOWING ANOTHER MOTOR VEHICLE 5 - INTERMODAL CONTAINER CHASSIS 8 - POLE 12 - CONCRETE MIXER 2 - BUS 4 - LOGGING 6 - CARGO VAN/ENCLOSED BOX 10 - FLAT BED 14 - GARBAGE/REFUSE 7 - GRAIN/CHIPS/GRAVEL 11 - DUMP 99 - OTHER / UNKNOWN				
	VEHICLE DEFECTS				
	1 - TURN SIGNALS 4 - BRAKES 7 - WORN OR SLICK TIRES 9 - MOTOR TROUBLE 99 - OTHER / UNKNOWN 2 - HEAD LAMPS 5 - STEERING 8 - TRAILER EQUIPMENT DEFECTIVE 10 - DISABLED FROM PRIOR ACCIDENT 3 - TAIL LAMPS 6 - TIRE BLOWOUT				
	NON-MOTORIST LOCATION AT IMPACT				
	1 - INTERSECTION - MARKED CROSSWALK 3 - INTERSECTION - OTHER 6 - BICYCLE LANE 9 - MEDIAN/CROSSING ISLAND 12 - FIRST RESPONDER AT INCIDENT SCENE 2 - INTERSECTION - UNMARKED CROSSWALK 4 - MIDBLOCK - MARKED CROSSWALK 7 - SHOULDER / ROADSIDE 10 - DRIVEWAY ACCESS 99 - OTHER / UNKNOWN 5 - TRAVEL LANE - OTHER LOCATION 8 - SIDEWALK 11 - SHARED USE PATHS OR TRAILS				
ACTION					
1 - NON-CONTACT 1 - STRAIGHT AHEAD 7 - MAKING U-TURN 13 - NEGOTIATING A CURVE 18 - APPROACHING OR LEAVING VEHICLE 2 - NON-COLLISION 2 - BACKING 8 - ENTERING TRAFFIC LANE 14 - ENTERING OR CROSSING SPECIFIED LOCATION 19 - STANDING 3 - STRIKING 3 - CHANGING LANES 9 - LEAVING TRAFFIC LANE 15 - WALKING, RUNNING, JOGGING, PLAYING 20 - OTHER NON-MOTORIST 4 - STRUCK PRE-CRASH ACTIONS 5 - MAKING RIGHT TURN 10 - PARKED 11 - SLOWING OR STOPPED IN TRAFFIC 21 - STANDING OUTSIDE DISABLED VEHICLE 5 - BOTH STRIKING & STRUCK 6 - MAKING LEFT TURN 12 - DRIVERLESS 17 - PUSHING VEHICLE 99 - OTHER / UNKNOWN 9 - OTHER / UNKNOWN					
CONTRIBUTING CIRCUMSTANCES					
1 - NONE 7 - LEFT OF CENTER 13 - IMPROPER START FROM A PARKED POSITION 17 - VISION OBSTRUCTION 21 - LYING IN ROADWAY 2 - FAILURE TO YIELD 8 - FOLLOWING TOO CLOSE / ACDA 14 - STOPPED OR PARKED ILLEGALLY 18 - OPERATING DEFECTIVE EQUIPMENT 22 - NOT DISCERNIBLE 3 - RAN RED LIGHT 9 - IMPROPER LANE CHANGE 15 - SWERVING TO AVOID 19 - LOAD SHIFTING/FALLING/SPILLING 23 - OPENING DOOR INTO ROADWAY 4 - RAN STOP SIGN 10 - IMPROPER PASSING 16 - WRONG WAY 20 - IMPROPER CROSSING 99 - OTHER IMPROPER ACTION 5 - UNSAFE SPEED 11 - DROVE OFF ROAD 21 - PARKED MOTOR VEHICLE 6 - IMPROPER TURN 12 - IMPROPER BACKING					
SEQUENCE OF EVENTS					
1 - OVERTURN/ROLLOVER 6 - EQUIPMENT FAILURE 11 - CROSS CENTERLINE - OPPOSITE DIRECTION OF TRAVEL 16 - RAILWAY VEHICLE 22 - WORK ZONE MAINTENANCE EQUIPMENT 2 - FIRE/EXPLOSION 7 - SEPARATION OF UNITS 12 - DOWNHILL RUNAWAY 17 - ANIMAL - FARM 23 - STRUCK BY FALLING, SHIFTING CARGO OR ANYTHING SET IN MOTION BY A MOTOR VEHICLE 3 - IMMERSION 8 - RAN OFF ROAD RIGHT 13 - OTHER NON-COLLISION 18 - ANIMAL - DEER 24 - OTHER MOVABLE OBJECT 4 - JACKKNIFE 9 - RAN OFF ROAD LEFT 14 - PEDESTRIAN 19 - ANIMAL - OTHER 20 - MOTOR VEHICLE IN TRANSPORT 5 - CARGO / EQUIPMENT LOSS OR SHIFT 10 - CROSS MEDIAN 15 - PEDALCYCLE 21 - PARKED MOTOR VEHICLE					
COLLISION WITH FIXED OBJECT - STRUCK					
25 - IMPACT ATTENUATOR / CRASH CUSHION 31 - GUARDRAIL END 37 - TRAFFIC SIGN POST 43 - CURB 50 - WORK ZONE MAINTENANCE EQUIPMENT 26 - BRIDGE OVERHEAD STRUCTURE 32 - PORTABLE BARRIER 38 - OVERHEAD SIGN POST 44 - DITCH 51 - WALL 27 - BRIDGE PIER OR ABUTMENT 33 - MEDIAN CABLE BARRIER 39 - LIGHT / LUMINARIES SUPPORT 45 - EMBANKMENT 52 - BUILDING 28 - BRIDGE PARAPET 34 - MEDIAN GUARDRAIL BARRIER 40 - UTILITY POLE 46 - FENCE 53 - TUNNEL 29 - BRIDGE RAIL 35 - MEDIAN CONCRETE BARRIER 41 - OTHER POST, POLE OR SUPPORT 47 - MAILBOX 54 - OTHER FIXED OBJECT 30 - GUARDRAIL FACE 36 - MEDIAN OTHER BARRIER 42 - CULVERT 48 - TREE 49 - FIRE HYDRANT 99 - OTHER / UNKNOWN					
FIRST HARMFUL EVENT 1 MOST HARMFUL EVENT					

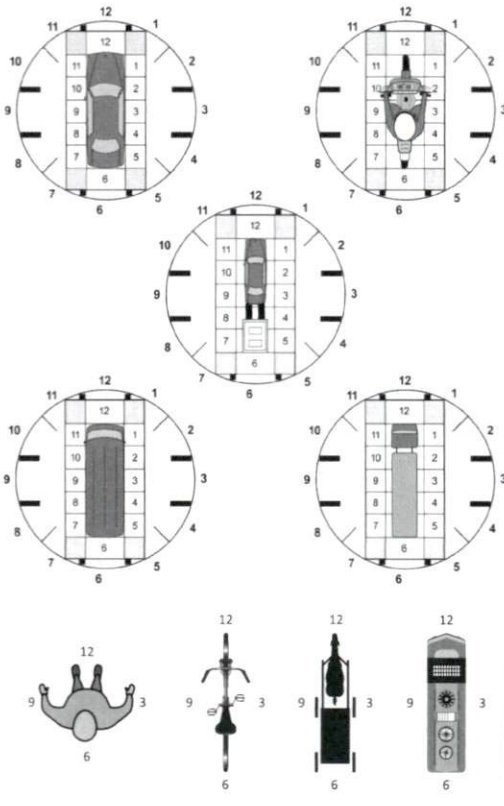
LOCAL REPORT NUMBER 2 2 0 0 8 3 5 0	
DAMAGE	
DAMAGE SCALE	
1 - NONE 3 - FUNCTIONAL DAMAGE 2 - MINOR DAMAGE 4 - DISABLING DAMAGE 9 - UNKNOWN	
DAMAGED AREA(S) INDICATE ALL THAT APPLY	
	
<input type="checkbox"/> - NO DAMAGE [0] <input type="checkbox"/> - UNDERCARRIAGE [14] <input type="checkbox"/> - TOP [13] <input type="checkbox"/> - ALL AREAS [15] <input type="checkbox"/> - UNIT NOT AT SCENE [16]	
INITIAL POINT OF CONTACT	
0 - NO DAMAGE 14 - UNDERCARRIAGE 1-12 - REFER TO UNIT DIAGRAM 15 - VEHICLE NOT AT SCENE 13 - TOP 99 - UNKNOWN	
TRAFFIC	
TRAFFICWAY FLOW	TRAFFIC CONTROL
1 - ONE-WAY 2 - TWO-WAY	1 - ROUNDABOUT 4 - STOP SIGN 2 - SIGNAL 5 - YIELD SIGN 3 - FLASHER 6 - NO CONTROL
# OF THROUGH LANES ON ROAD 3	RAIL GRADE CROSSING 1 - NOT INVOLVED 2 - INVOLVED-ACTIVE CROSSING 3 - INVOLVED-PASSIVE CROSSING
UNIT / NON-MOTORIST DIRECTION	
1 - NORTH 5 - NORTHEAST 2 - SOUTH 6 - NORTHWEST 3 - EAST 7 - SOUTHEAST 4 - WEST 8 - SOUTHWEST 9 - OTHER / UNKNOWN	
UNIT SPEED 25	DETECTED SPEED 1 - STATED / ESTIMATED SPEED 2 - CALCULATED / EDR 3 - UNDETERMINED
POSTED SPEED 35	

OWNER	UNIT # 012	OWNER NAME: LAST, FIRST, MIDDLE (X SAME AS DRIVER)	OWNER PHONE: INCLUDE AREA CODE (X SAME AS DRIVER)
	OWNER ADDRESS: STREET, CITY, STATE, ZIP (X SAME AS DRIVER)		
VEHICLE	COMMERCIAL CARRIER: NAME, ADDRESS, CITY, STATE, ZIP		COMMERCIAL CARRIER PHONE: INCLUDE AREA CODE
	LP STATE OH	LICENSE PLATE # 118YVG	VEHICLE IDENTIFICATION # 19UUA161228A039075
EVENT(S)	INSURANCE VERIFIED X	INSURANCE COMPANY Geico	INSURANCE POLICY # 4500822152
	TYPE OF USE <input type="checkbox"/> COMMERCIAL <input type="checkbox"/> GOVERNMENT <input type="checkbox"/> IN EMERGENCY RESPONSE	US DOT #	VEHICLE YEAR 2008
VEHICLE	HAZARDOUS MATERIAL <input type="checkbox"/> MATERIAL RELEASED <input type="checkbox"/> PLACARD	VEHICLE MAKE Acura	VEHICLE MODEL TL
	HAZARDOUS MATERIAL CLASS # PLACARD ID #		
VEHICLE	UNIT TYPE 01	VEHICLE WEIGHT GVWR/GCWR 1 - <10K LBS. 2 - 10,001 - 26K LBS. 3 - >26K LBS.	
	SPECIAL FUNCTION 01	HAZARDOUS MATERIAL CLASS # PLACARD ID #	
VEHICLE	CARGO BODY TYPE 01	HAZARDOUS MATERIAL CLASS # PLACARD ID #	
	VEHICLE DEFECTS	HAZARDOUS MATERIAL CLASS # PLACARD ID #	
EVENT(S)	NON-MOTORIST LOCATION AT IMPACT 4	HAZARDOUS MATERIAL CLASS # PLACARD ID #	
	ACTION 4	HAZARDOUS MATERIAL CLASS # PLACARD ID #	
EVENT(S)	CONTRIBUTING CIRCUMSTANCES 01	HAZARDOUS MATERIAL CLASS # PLACARD ID #	
	SEQUENCE OF EVENTS 1	HAZARDOUS MATERIAL CLASS # PLACARD ID #	
EVENT(S)	FIRST HARMFUL EVENT 1	HAZARDOUS MATERIAL CLASS # PLACARD ID #	
	MOST HARMFUL EVENT 1	HAZARDOUS MATERIAL CLASS # PLACARD ID #	

LOCAL REPORT NUMBER 22008350	
DAMAGE DAMAGE SCALE 3 1 - NONE 3 - FUNCTIONAL DAMAGE 2 - MINOR DAMAGE 4 - DISABLING DAMAGE 9 - UNKNOWN	
DAMAGED AREA(S) INDICATE ALL THAT APPLY	
<input type="checkbox"/> NO DAMAGE [0] <input type="checkbox"/> UNDERCARRIAGE [14] <input type="checkbox"/> TOP [13] <input type="checkbox"/> ALL AREAS [15] <input type="checkbox"/> UNIT NOT AT SCENE [16]	
INITIAL POINT OF CONTACT 0 - NO DAMAGE 14 - UNDERCARRIAGE 1-12 - REFER TO UNIT DIAGRAM 15 - VEHICLE NOT AT SCENE 13 - TOP 99 - UNKNOWN	
TRAFFIC TRAFFICWAY FLOW 2 1 - ONE-WAY 2 - TWO-WAY # OF THROUGH LANES ON ROAD 3 RAIL GRADE CROSSING 1 1 - NOT INVOLVED 2 - INVOLVED-ACTIVE CROSSING 3 - INVOLVED-PASSIVE CROSSING	
UNIT / NON-MOTORIST DIRECTION FROM 2 TO 1 1 - NORTH 5 - NORTHEAST 2 - SOUTH 6 - NORTHWEST 3 - EAST 7 - SOUTHEAST 4 - WEST 8 - SOUTHWEST 9 - OTHER / UNKNOWN	
UNIT SPEED 0 POSTED SPEED 35 DETECTED SPEED 1 1 - STATED / ESTIMATED SPEED 2 - CALCULATED / EDR 3 - UNDETERMINED	



MOTORIST / Non-MOTORIST

LOCAL REPORT NUMBER
2 2 0 0 8 3 5 0

MOTORIST / NON-MOTORIST	UNIT # 0 1	NAME: LAST, FIRST, MIDDLE Benson, Larry				DATE OF BIRTH 0 9 1 3 1 9 5 3		AGE 6 8	GENDER M																																																																																																																																																																																																																																															
	ADDRESS: STREET, CITY, STATE, ZIP 6239 Spring Lake Dr. Fairfield Township, Ohio 45011					CONTACT PHONE - INCLUDE AREA CODE																																																																																																																																																																																																																																																		
	INJURIES 5	INJURED TAKEN BY	EMS AGENCY (NAME)	INJURED TAKEN TO: MEDICAL FACILITY (NAME, CITY)	SAFETY EQUIPMENT USED 0 4	<input type="checkbox"/> DOT-COMPLIANT MC HELMET	SEATING POSITION 0 1	AIR BAG USAGE 1	EJECTION 1	TRAPPED 1																																																																																																																																																																																																																																														
	OL STATE O H	OPERATOR LICENSE NUMBER		OFFENSE CHARGED 333.03A	LOCAL CODE <input checked="" type="checkbox"/>	OFFENSE DESCRIPTION ACDA		CITATION NUMBER 250262																																																																																																																																																																																																																																																
MOTORIST / NON-MOTORIST	OL CLASS 4	ENDORSEMENT SELECT UP TO 2	RESTRICTION SELECT UP TO 3	DRIVER DISTRACTED BY 1	ALCOHOL / DRUG SUSPECTED <input type="checkbox"/> ALCOHOL <input type="checkbox"/> MARIJUANA <input type="checkbox"/> OTHER DRUG		CONDITION 1	ALCOHOL TEST STATUS TYPE VALUE 1 1 .		DRUG TEST(S) STATUS TYPE RESULT SELECT UP TO 4 1 1																																																																																																																																																																																																																																														
	UNIT # 0 2	NAME: LAST, FIRST, MIDDLE Lee, Jonathan				DATE OF BIRTH 1 0 2 6 1 9 8 3		AGE 3 8	GENDER M																																																																																																																																																																																																																																															
	ADDRESS: STREET, CITY, STATE, ZIP 12158 Hitchcock Dr. Cincinnati, Ohio 45240					CONTACT PHONE - INCLUDE AREA CODE																																																																																																																																																																																																																																																		
	INJURIES 5	INJURED TAKEN BY	EMS AGENCY (NAME)	INJURED TAKEN TO: MEDICAL FACILITY (NAME, CITY)	SAFETY EQUIPMENT USED 0 4	<input type="checkbox"/> DOT-COMPLIANT MC HELMET	SEATING POSITION 0 1	AIR BAG USAGE 1	EJECTION 1	TRAPPED 1																																																																																																																																																																																																																																														
MOTORIST / NON-MOTORIST	OL STATE O H	OPERATOR LICENSE NUMBER		OFFENSE CHARGED	LOCAL CODE <input type="checkbox"/>	OFFENSE DESCRIPTION		CITATION NUMBER																																																																																																																																																																																																																																																
	OL CLASS 4	ENDORSEMENT SELECT UP TO 2	RESTRICTION SELECT UP TO 3	DRIVER DISTRACTED BY 1	ALCOHOL / DRUG SUSPECTED <input type="checkbox"/> ALCOHOL <input type="checkbox"/> MARIJUANA <input type="checkbox"/> OTHER DRUG		CONDITION 1	ALCOHOL TEST STATUS TYPE VALUE 1 1 .		DRUG TEST(S) STATUS TYPE RESULT SELECT UP TO 4 1 1																																																																																																																																																																																																																																														
	UNIT #	NAME: LAST, FIRST, MIDDLE				DATE OF BIRTH		AGE 0	GENDER																																																																																																																																																																																																																																															
	ADDRESS: STREET, CITY, STATE, ZIP					CONTACT PHONE - INCLUDE AREA CODE																																																																																																																																																																																																																																																		
MOTORIST / NON-MOTORIST	INJURIES	INJURED TAKEN BY	EMS AGENCY (NAME)	INJURED TAKEN TO: MEDICAL FACILITY (NAME, CITY)	SAFETY EQUIPMENT USED	<input type="checkbox"/> DOT-COMPLIANT MC HELMET	SEATING POSITION	AIR BAG USAGE	EJECTION	TRAPPED																																																																																																																																																																																																																																														
	OL STATE	OPERATOR LICENSE NUMBER		OFFENSE CHARGED	LOCAL CODE <input type="checkbox"/>	OFFENSE DESCRIPTION		CITATION NUMBER																																																																																																																																																																																																																																																
	OL CLASS	ENDORSEMENT SELECT UP TO 2	RESTRICTION SELECT UP TO 3	DRIVER DISTRACTED BY	ALCOHOL / DRUG SUSPECTED <input type="checkbox"/> ALCOHOL <input type="checkbox"/> MARIJUANA <input type="checkbox"/> OTHER DRUG		CONDITION	ALCOHOL TEST STATUS TYPE VALUE		DRUG TEST(S) STATUS TYPE RESULT SELECT UP TO 4																																																																																																																																																																																																																																														
<table border="1"><thead><tr><th>INJURIES</th><th>SEATING POSITION</th><th>AIR BAG</th><th>OL CLASS</th><th>OL RESTRICTION(S)</th><th>DRIVER DISTRACTION</th><th>TEST STATUS</th></tr></thead><tbody><tr><td>1 - FATAL</td><td>1 - FRONT - LEFT SIDE (MOTORCYCLE DRIVER)</td><td>1 - NOT DEPLOYED</td><td>1 - CLASS A</td><td>1 - ALCOHOL INTERLOCK DEVICE</td><td>1 - NOT DISTRACTED</td><td>1 - NONE GIVEN</td></tr><tr><td>2 - SUSPECTED SERIOUS INJURY</td><td>2 - FRONT - MIDDLE</td><td>2 - DEPLOYED FRONT</td><td>2 - CLASS B</td><td>2 - CDL INTRASTATE ONLY</td><td>2 - MANUALLY OPERATING AN ELECTRONIC COMMUNICATION DEVICE (TEXTING, TYPING, DIALING)</td><td>2 - TEST REFUSED</td></tr><tr><td>3 - SUSPECTED MINOR INJURY</td><td>3 - FRONT - RIGHT SIDE</td><td>3 - DEPLOYED SIDE</td><td>3 - CLASS C</td><td>3 - CORRECTIVE LENSES</td><td>3 - TALKING ON HANDS-FREE COMMUNICATION DEVICE</td><td>3 - TEST GIVEN, CONTAMINATED SAMPLE / UNUSABLE</td></tr><tr><td>4 - POSSIBLE INJURY</td><td>4 - SECOND - LEFT SIDE (MOTORCYCLE PASSENGER)</td><td>4 - DEPLOYED BOTH FRONT / SIDE</td><td>4 - REGULAR CLASS (OHIO = D)</td><td>4 - FARM WAIVER</td><td>4 - TALKING ON HAND-HELD COMMUNICATION DEVICE</td><td>4 - TEST GIVEN, RESULTS KNOWN</td></tr><tr><td>5 - NO APPARENT INJURY</td><td>5 - SECOND - MIDDLE</td><td>5 - NOT APPLICABLE</td><td>5 - M/C MOPED ONLY</td><td>5 - EXCEPT CLASS A & CLASS B BUS</td><td>5 - OTHER ACTIVITY WITH AN ELECTRONIC DEVICE</td><td>5 - TEST GIVEN, RESULTS UNKNOWN</td></tr><tr><td colspan="3">INJURED TAKEN BY</td><td colspan="2">EJECTION</td><td colspan="2">ALCOHOL TEST TYPE</td></tr><tr><td colspan="3">1 - NOT TRANSPORTED / TREATED AT SCENE</td><td colspan="2">1 - NOT EJECTED</td><td colspan="2">1 - NONE</td></tr><tr><td colspan="3">2 - EMS</td><td colspan="2">2 - PARTIALLY EJECTED</td><td colspan="2">2 - BLOOD</td></tr><tr><td colspan="3">3 - POLICE</td><td colspan="2">3 - TOTALLY EJECTED</td><td colspan="2">3 - URINE</td></tr><tr><td colspan="3">9 - OTHER / UNKNOWN</td><td colspan="2">4 - NOT APPLICABLE</td><td colspan="2">4 - BREATH</td></tr><tr><td colspan="3">SAFETY EQUIPMENT</td><td colspan="2">TRAPPED</td><td colspan="2">5 - OTHER</td></tr><tr><td colspan="3">1 - NONE USED</td><td colspan="2">1 - NOT TRAPPED</td><td colspan="2">DRUG TEST TYPE</td></tr><tr><td colspan="3">2 - SHOULDER BELT ONLY USED</td><td colspan="2">2 - EXTRICATED BY MECHANICAL MEANS</td><td colspan="2">1 - NONE</td></tr><tr><td colspan="3">3 - LAP BELT ONLY USED</td><td colspan="2">3 - FREED BY NON-MECHANICAL MEANS</td><td colspan="2">2 - BLOOD</td></tr><tr><td colspan="3">4 - SHOULDER & LAP BELT USED</td><td colspan="2"></td><td colspan="2">3 - URINE</td></tr><tr><td colspan="3">5 - CHILD RESTRAINT SYSTEM - FORWARD FACING</td><td colspan="2"></td><td colspan="2">4 - OTHER</td></tr><tr><td colspan="3">6 - CHILD RESTRAINT SYSTEM - REAR FACING</td><td colspan="2"></td><td colspan="2">CONDITION</td></tr><tr><td colspan="3">7 - BOOSTER SEAT</td><td colspan="2"></td><td colspan="2">1 - APPARENTLY NORMAL</td></tr><tr><td colspan="3">8 - HELMET USED</td><td colspan="2"></td><td colspan="2">2 - PHYSICAL IMPAIRMENT</td></tr><tr><td colspan="3">9 - PROTECTIVE PADS USED (ELBOW, KNEES, ETC.)</td><td colspan="2"></td><td colspan="2">3 - EMOTIONAL (E.G., DEPRESSED, ANGRY, DISTURBED)</td></tr><tr><td colspan="3">10 - REFLECTIVE CLOTHING</td><td colspan="2"></td><td colspan="2">4 - ILLNESS</td></tr><tr><td colspan="3">11 - LIGHTING - PEDESTRIAN / BICYCLE ONLY</td><td colspan="2"></td><td colspan="2">5 - FELL ASLEEP, FAINTED, FATIGUED, ETC.</td></tr><tr><td colspan="3">99 - OTHER / UNKNOWN</td><td colspan="2"></td><td colspan="2">6 - UNDER THE INFLUENCE OF MEDICATIONS / DRUGS / ALCOHOL</td></tr><tr><td colspan="3"></td><td colspan="2"></td><td colspan="2">7 - OTHER / UNKNOWN</td></tr><tr><td colspan="3"></td><td colspan="2"></td><td colspan="2">DRUG TEST RESULT(S)</td></tr><tr><td colspan="3"></td><td colspan="2"></td><td colspan="2">1 - AMPHETAMINES</td></tr><tr><td colspan="3"></td><td colspan="2"></td><td colspan="2">2 - BARBITURATES</td></tr><tr><td colspan="3"></td><td colspan="2"></td><td colspan="2">3 - BENZODIAZEPINES</td></tr><tr><td colspan="3"></td><td colspan="2"></td><td colspan="2">4 - CANNABINOIDS</td></tr><tr><td colspan="3"></td><td colspan="2"></td><td colspan="2">5 - COCAINE</td></tr><tr><td colspan="3"></td><td colspan="2"></td><td colspan="2">6 - OPIATES / OPIOIDS</td></tr><tr><td colspan="3"></td><td colspan="2"></td><td colspan="2">7 - OTHER</td></tr><tr><td colspan="3"></td><td colspan="2"></td><td colspan="2">8 - NEGATIVE RESULTS</td></tr></tbody></table>											INJURIES	SEATING POSITION	AIR BAG	OL CLASS	OL RESTRICTION(S)	DRIVER DISTRACTION	TEST STATUS	1 - FATAL	1 - FRONT - LEFT SIDE (MOTORCYCLE DRIVER)	1 - NOT DEPLOYED	1 - CLASS A	1 - ALCOHOL INTERLOCK DEVICE	1 - NOT DISTRACTED	1 - NONE GIVEN	2 - SUSPECTED SERIOUS INJURY	2 - FRONT - MIDDLE	2 - DEPLOYED FRONT	2 - CLASS B	2 - CDL INTRASTATE ONLY	2 - MANUALLY OPERATING AN ELECTRONIC COMMUNICATION DEVICE (TEXTING, TYPING, DIALING)	2 - TEST REFUSED	3 - SUSPECTED MINOR INJURY	3 - FRONT - RIGHT SIDE	3 - DEPLOYED SIDE	3 - CLASS C	3 - CORRECTIVE LENSES	3 - TALKING ON HANDS-FREE COMMUNICATION DEVICE	3 - TEST GIVEN, CONTAMINATED SAMPLE / UNUSABLE	4 - POSSIBLE INJURY	4 - SECOND - LEFT SIDE (MOTORCYCLE PASSENGER)	4 - DEPLOYED BOTH FRONT / SIDE	4 - REGULAR CLASS (OHIO = D)	4 - FARM WAIVER	4 - TALKING ON HAND-HELD COMMUNICATION DEVICE	4 - TEST GIVEN, RESULTS KNOWN	5 - NO APPARENT INJURY	5 - SECOND - MIDDLE	5 - NOT APPLICABLE	5 - M/C MOPED ONLY	5 - EXCEPT CLASS A & CLASS B BUS	5 - OTHER ACTIVITY WITH AN ELECTRONIC DEVICE	5 - TEST GIVEN, RESULTS UNKNOWN	INJURED TAKEN BY			EJECTION		ALCOHOL TEST TYPE		1 - NOT TRANSPORTED / TREATED AT SCENE			1 - NOT EJECTED		1 - NONE		2 - EMS			2 - PARTIALLY EJECTED		2 - BLOOD		3 - POLICE			3 - TOTALLY EJECTED		3 - URINE		9 - OTHER / UNKNOWN			4 - NOT APPLICABLE		4 - BREATH		SAFETY EQUIPMENT			TRAPPED		5 - OTHER		1 - NONE USED			1 - NOT TRAPPED		DRUG TEST TYPE		2 - SHOULDER BELT ONLY USED			2 - EXTRICATED BY MECHANICAL MEANS		1 - NONE		3 - LAP BELT ONLY USED			3 - FREED BY NON-MECHANICAL MEANS		2 - BLOOD		4 - SHOULDER & LAP BELT USED					3 - URINE		5 - CHILD RESTRAINT SYSTEM - FORWARD FACING					4 - OTHER		6 - CHILD RESTRAINT SYSTEM - REAR FACING					CONDITION		7 - BOOSTER SEAT					1 - APPARENTLY NORMAL		8 - HELMET USED					2 - PHYSICAL IMPAIRMENT		9 - PROTECTIVE PADS USED (ELBOW, KNEES, ETC.)					3 - EMOTIONAL (E.G., DEPRESSED, ANGRY, DISTURBED)		10 - REFLECTIVE CLOTHING					4 - ILLNESS		11 - LIGHTING - PEDESTRIAN / BICYCLE ONLY					5 - FELL ASLEEP, FAINTED, FATIGUED, ETC.		99 - OTHER / UNKNOWN					6 - UNDER THE INFLUENCE OF MEDICATIONS / DRUGS / ALCOHOL							7 - OTHER / UNKNOWN							DRUG TEST RESULT(S)							1 - AMPHETAMINES							2 - BARBITURATES							3 - BENZODIAZEPINES							4 - CANNABINOIDS							5 - COCAINE							6 - OPIATES / OPIOIDS							7 - OTHER							8 - NEGATIVE RESULTS	
INJURIES	SEATING POSITION	AIR BAG	OL CLASS	OL RESTRICTION(S)	DRIVER DISTRACTION	TEST STATUS																																																																																																																																																																																																																																																		
1 - FATAL	1 - FRONT - LEFT SIDE (MOTORCYCLE DRIVER)	1 - NOT DEPLOYED	1 - CLASS A	1 - ALCOHOL INTERLOCK DEVICE	1 - NOT DISTRACTED	1 - NONE GIVEN																																																																																																																																																																																																																																																		
2 - SUSPECTED SERIOUS INJURY	2 - FRONT - MIDDLE	2 - DEPLOYED FRONT	2 - CLASS B	2 - CDL INTRASTATE ONLY	2 - MANUALLY OPERATING AN ELECTRONIC COMMUNICATION DEVICE (TEXTING, TYPING, DIALING)	2 - TEST REFUSED																																																																																																																																																																																																																																																		
3 - SUSPECTED MINOR INJURY	3 - FRONT - RIGHT SIDE	3 - DEPLOYED SIDE	3 - CLASS C	3 - CORRECTIVE LENSES	3 - TALKING ON HANDS-FREE COMMUNICATION DEVICE	3 - TEST GIVEN, CONTAMINATED SAMPLE / UNUSABLE																																																																																																																																																																																																																																																		
4 - POSSIBLE INJURY	4 - SECOND - LEFT SIDE (MOTORCYCLE PASSENGER)	4 - DEPLOYED BOTH FRONT / SIDE	4 - REGULAR CLASS (OHIO = D)	4 - FARM WAIVER	4 - TALKING ON HAND-HELD COMMUNICATION DEVICE	4 - TEST GIVEN, RESULTS KNOWN																																																																																																																																																																																																																																																		
5 - NO APPARENT INJURY	5 - SECOND - MIDDLE	5 - NOT APPLICABLE	5 - M/C MOPED ONLY	5 - EXCEPT CLASS A & CLASS B BUS	5 - OTHER ACTIVITY WITH AN ELECTRONIC DEVICE	5 - TEST GIVEN, RESULTS UNKNOWN																																																																																																																																																																																																																																																		
INJURED TAKEN BY			EJECTION		ALCOHOL TEST TYPE																																																																																																																																																																																																																																																			
1 - NOT TRANSPORTED / TREATED AT SCENE			1 - NOT EJECTED		1 - NONE																																																																																																																																																																																																																																																			
2 - EMS			2 - PARTIALLY EJECTED		2 - BLOOD																																																																																																																																																																																																																																																			
3 - POLICE			3 - TOTALLY EJECTED		3 - URINE																																																																																																																																																																																																																																																			
9 - OTHER / UNKNOWN			4 - NOT APPLICABLE		4 - BREATH																																																																																																																																																																																																																																																			
SAFETY EQUIPMENT			TRAPPED		5 - OTHER																																																																																																																																																																																																																																																			
1 - NONE USED			1 - NOT TRAPPED		DRUG TEST TYPE																																																																																																																																																																																																																																																			
2 - SHOULDER BELT ONLY USED			2 - EXTRICATED BY MECHANICAL MEANS		1 - NONE																																																																																																																																																																																																																																																			
3 - LAP BELT ONLY USED			3 - FREED BY NON-MECHANICAL MEANS		2 - BLOOD																																																																																																																																																																																																																																																			
4 - SHOULDER & LAP BELT USED					3 - URINE																																																																																																																																																																																																																																																			
5 - CHILD RESTRAINT SYSTEM - FORWARD FACING					4 - OTHER																																																																																																																																																																																																																																																			
6 - CHILD RESTRAINT SYSTEM - REAR FACING					CONDITION																																																																																																																																																																																																																																																			
7 - BOOSTER SEAT					1 - APPARENTLY NORMAL																																																																																																																																																																																																																																																			
8 - HELMET USED					2 - PHYSICAL IMPAIRMENT																																																																																																																																																																																																																																																			
9 - PROTECTIVE PADS USED (ELBOW, KNEES, ETC.)					3 - EMOTIONAL (E.G., DEPRESSED, ANGRY, DISTURBED)																																																																																																																																																																																																																																																			
10 - REFLECTIVE CLOTHING					4 - ILLNESS																																																																																																																																																																																																																																																			
11 - LIGHTING - PEDESTRIAN / BICYCLE ONLY					5 - FELL ASLEEP, FAINTED, FATIGUED, ETC.																																																																																																																																																																																																																																																			
99 - OTHER / UNKNOWN					6 - UNDER THE INFLUENCE OF MEDICATIONS / DRUGS / ALCOHOL																																																																																																																																																																																																																																																			
					7 - OTHER / UNKNOWN																																																																																																																																																																																																																																																			
					DRUG TEST RESULT(S)																																																																																																																																																																																																																																																			
					1 - AMPHETAMINES																																																																																																																																																																																																																																																			
					2 - BARBITURATES																																																																																																																																																																																																																																																			
					3 - BENZODIAZEPINES																																																																																																																																																																																																																																																			
					4 - CANNABINOIDS																																																																																																																																																																																																																																																			
					5 - COCAINE																																																																																																																																																																																																																																																			
					6 - OPIATES / OPIOIDS																																																																																																																																																																																																																																																			
					7 - OTHER																																																																																																																																																																																																																																																			
					8 - NEGATIVE RESULTS																																																																																																																																																																																																																																																			



OCCUPANT / WITNESS ADDENDUM

						LOCAL REPORT NUMBER																																																																								
						2 2 0 0 8 3 5 0																																																																								
OCCUPANT	UNIT #	NAME: LAST, FIRST, MIDDLE				DATE OF BIRTH		AGE	GENDER																																																																					
	1	Benson, Pamela				0 9 2 0 1 9 6 0		6 1	F																																																																					
	ADDRESS: STREET, CITY, STATE, ZIP					CONTACT PHONE - INCLUDE AREA CODE																																																																								
	6239 Spring Lake Dr. Fairfield Township, Ohio 45011																																																																													
OCCUPANT	INJURIES	INJURED TAKEN BY	EMS AGENCY (NAME)	INJURED TAKEN TO: MEDICAL FACILITY (NAME, CITY)	SAFETY EQUIPMENT USED	<input type="checkbox"/> DOT-COMPLIANT MC HELMET	SEATING POSITION	AIR BAG USAGE	EJECTION	TRAPPED																																																																				
	5				0 4		0 3	0 1	1	1																																																																				
	ADDRESS: STREET, CITY, STATE, ZIP					CONTACT PHONE - INCLUDE AREA CODE																																																																								
	12158 Hitchcock Dr. Cincinnati, Ohio 45240																																																																													
OCCUPANT	UNIT #	NAME: LAST, FIRST, MIDDLE				DATE OF BIRTH		AGE	GENDER																																																																					
	2	Lee, Christina				1 0 1 0 2 0 1 7		4	F																																																																					
	ADDRESS: STREET, CITY, STATE, ZIP					CONTACT PHONE - INCLUDE AREA CODE																																																																								
	12158 Hitchcock Dr. Cincinnati, Ohio 45240																																																																													
OCCUPANT	INJURIES	INJURED TAKEN BY	EMS AGENCY (NAME)	INJURED TAKEN TO: MEDICAL FACILITY (NAME, CITY)	SAFETY EQUIPMENT USED	<input type="checkbox"/> DOT-COMPLIANT MC HELMET	SEATING POSITION	AIR BAG USAGE	EJECTION	TRAPPED																																																																				
	5				0 4		0 6	0 1	1	1																																																																				
	ADDRESS: STREET, CITY, STATE, ZIP					CONTACT PHONE - INCLUDE AREA CODE																																																																								
	12158 Hitchcock Dr. Cincinnati, Ohio 45240																																																																													
OCCUPANT	UNIT #	NAME: LAST, FIRST, MIDDLE				DATE OF BIRTH		AGE	GENDER																																																																					
	2	Lee, Jonny				0 3 1 0 2 0 1 3		8	M																																																																					
	ADDRESS: STREET, CITY, STATE, ZIP					CONTACT PHONE - INCLUDE AREA CODE																																																																								
	12158 Hitchcock Dr. Cincinnati, Ohio 45240																																																																													
OCCUPANT	INJURIES	INJURED TAKEN BY	EMS AGENCY (NAME)	INJURED TAKEN TO: MEDICAL FACILITY (NAME, CITY)	SAFETY EQUIPMENT USED	<input type="checkbox"/> DOT-COMPLIANT MC HELMET	SEATING POSITION	AIR BAG USAGE	EJECTION	TRAPPED																																																																				
	5				0 4		0 5	0 1	1	1																																																																				
	ADDRESS: STREET, CITY, STATE, ZIP					CONTACT PHONE - INCLUDE AREA CODE																																																																								
<table border="1"><thead><tr><th>INJURIES</th><th>SAFETY EQUIPMENT USED</th><th>SEATING POSITION</th><th>AIR BAG USAGE</th></tr></thead><tbody><tr><td>1 - FATAL</td><td>1 - NONE USED - VEHICLE OCCUPANT</td><td>1 - FRONT - LEFT SIDE (MOTORCYCLE DRIVER)</td><td>1 - NOT DEPLOYED</td></tr><tr><td>2 - SUSPECTED SERIOUS INJURY</td><td>2 - SHOULDER BELT ONLY USED</td><td>2 - FRONT - MIDDLE</td><td>2 - DEPLOYED FRONT</td></tr><tr><td>3 - SUSPECTED MINOR INJURY</td><td>3 - LAP BELT ONLY USED</td><td>3 - FRONT - RIGHT SIDE</td><td>3 - DEPLOYED SIDE</td></tr><tr><td>4 - POSSIBLE INJURY</td><td>4 - SHOULDER & LAP BELT USED</td><td>4 - SECOND - LEFT SIDE (MOTORCYCLE PASSENGER)</td><td>4 - DEPLOYED BOTH FRONT/SIDE</td></tr><tr><td>5 - NO APPARENT INJURY</td><td>5 - CHILD RESTRAINT SYSTEM - FORWARD FACING</td><td>5 - SECOND - MIDDLE</td><td>5 - NOT APPLICABLE</td></tr><tr><td></td><td>6 - CHILD RESTRAINT SYSTEM - REAR FACING</td><td>6 - SECOND - RIGHT SIDE</td><td>9 - DEPLOYMENT UNKNOWN</td></tr><tr><td></td><td>7 - BOOSTER SEAT</td><td>7 - THIRD - LEFT SIDE (MOTORCYCLE SIDE CAR)</td><td></td></tr><tr><td></td><td>8 - HELMET USED</td><td>8 - THIRD - MIDDLE</td><td></td></tr><tr><td></td><td>9 - PROTECTIVE PADS USED (ELBOW, KNEES, ETC.)</td><td>9 - THIRD - RIGHT SIDE</td><td></td></tr><tr><td></td><td>10 - REFLECTIVE CLOTHING</td><td>10 - SLEEPER SECTION OF TRUCK CAB</td><td></td></tr><tr><td></td><td>11 - LIGHTING - PEDESTRIAN / BICYCLE ONLY</td><td>11 - PASSENGER IN OTHER ENCLOSED CARGO AREA (NON-TRAILING UNIT, BUS, PICK-UP WITH CAP)</td><td></td></tr><tr><td></td><td>99 - OTHER / UNKNOWN</td><td>12 - PASSENGER IN UNENCLOSED CARGO AREA</td><td></td></tr><tr><td></td><td></td><td>13 - TRAILING UNIT</td><td></td></tr><tr><td></td><td></td><td>14 - RIDING ON VEHICLE EXTERIOR (NON-TRAILING UNIT)</td><td></td></tr><tr><td></td><td></td><td>15 - NON-MOTORIST</td><td></td></tr><tr><td></td><td></td><td>99 - OTHER / UNKNOWN</td><td></td></tr></tbody></table>											INJURIES	SAFETY EQUIPMENT USED	SEATING POSITION	AIR BAG USAGE	1 - FATAL	1 - NONE USED - VEHICLE OCCUPANT	1 - FRONT - LEFT SIDE (MOTORCYCLE DRIVER)	1 - NOT DEPLOYED	2 - SUSPECTED SERIOUS INJURY	2 - SHOULDER BELT ONLY USED	2 - FRONT - MIDDLE	2 - DEPLOYED FRONT	3 - SUSPECTED MINOR INJURY	3 - LAP BELT ONLY USED	3 - FRONT - RIGHT SIDE	3 - DEPLOYED SIDE	4 - POSSIBLE INJURY	4 - SHOULDER & LAP BELT USED	4 - SECOND - LEFT SIDE (MOTORCYCLE PASSENGER)	4 - DEPLOYED BOTH FRONT/SIDE	5 - NO APPARENT INJURY	5 - CHILD RESTRAINT SYSTEM - FORWARD FACING	5 - SECOND - MIDDLE	5 - NOT APPLICABLE		6 - CHILD RESTRAINT SYSTEM - REAR FACING	6 - SECOND - RIGHT SIDE	9 - DEPLOYMENT UNKNOWN		7 - BOOSTER SEAT	7 - THIRD - LEFT SIDE (MOTORCYCLE SIDE CAR)			8 - HELMET USED	8 - THIRD - MIDDLE			9 - PROTECTIVE PADS USED (ELBOW, KNEES, ETC.)	9 - THIRD - RIGHT SIDE			10 - REFLECTIVE CLOTHING	10 - SLEEPER SECTION OF TRUCK CAB			11 - LIGHTING - PEDESTRIAN / BICYCLE ONLY	11 - PASSENGER IN OTHER ENCLOSED CARGO AREA (NON-TRAILING UNIT, BUS, PICK-UP WITH CAP)			99 - OTHER / UNKNOWN	12 - PASSENGER IN UNENCLOSED CARGO AREA				13 - TRAILING UNIT				14 - RIDING ON VEHICLE EXTERIOR (NON-TRAILING UNIT)				15 - NON-MOTORIST				99 - OTHER / UNKNOWN	
INJURIES	SAFETY EQUIPMENT USED	SEATING POSITION	AIR BAG USAGE																																																																											
1 - FATAL	1 - NONE USED - VEHICLE OCCUPANT	1 - FRONT - LEFT SIDE (MOTORCYCLE DRIVER)	1 - NOT DEPLOYED																																																																											
2 - SUSPECTED SERIOUS INJURY	2 - SHOULDER BELT ONLY USED	2 - FRONT - MIDDLE	2 - DEPLOYED FRONT																																																																											
3 - SUSPECTED MINOR INJURY	3 - LAP BELT ONLY USED	3 - FRONT - RIGHT SIDE	3 - DEPLOYED SIDE																																																																											
4 - POSSIBLE INJURY	4 - SHOULDER & LAP BELT USED	4 - SECOND - LEFT SIDE (MOTORCYCLE PASSENGER)	4 - DEPLOYED BOTH FRONT/SIDE																																																																											
5 - NO APPARENT INJURY	5 - CHILD RESTRAINT SYSTEM - FORWARD FACING	5 - SECOND - MIDDLE	5 - NOT APPLICABLE																																																																											
	6 - CHILD RESTRAINT SYSTEM - REAR FACING	6 - SECOND - RIGHT SIDE	9 - DEPLOYMENT UNKNOWN																																																																											
	7 - BOOSTER SEAT	7 - THIRD - LEFT SIDE (MOTORCYCLE SIDE CAR)																																																																												
	8 - HELMET USED	8 - THIRD - MIDDLE																																																																												
	9 - PROTECTIVE PADS USED (ELBOW, KNEES, ETC.)	9 - THIRD - RIGHT SIDE																																																																												
	10 - REFLECTIVE CLOTHING	10 - SLEEPER SECTION OF TRUCK CAB																																																																												
	11 - LIGHTING - PEDESTRIAN / BICYCLE ONLY	11 - PASSENGER IN OTHER ENCLOSED CARGO AREA (NON-TRAILING UNIT, BUS, PICK-UP WITH CAP)																																																																												
	99 - OTHER / UNKNOWN	12 - PASSENGER IN UNENCLOSED CARGO AREA																																																																												
		13 - TRAILING UNIT																																																																												
		14 - RIDING ON VEHICLE EXTERIOR (NON-TRAILING UNIT)																																																																												
		15 - NON-MOTORIST																																																																												
		99 - OTHER / UNKNOWN																																																																												
WITNESS	NAME: LAST, FIRST, MIDDLE					DATE OF BIRTH		AGE	GENDER																																																																					
	ADDRESS: STREET, CITY, STATE, ZIP					CONTACT PHONE - INCLUDE AREA CODE																																																																								
	NAME: LAST, FIRST, MIDDLE					DATE OF BIRTH		AGE	GENDER																																																																					
	ADDRESS: STREET, CITY, STATE, ZIP					CONTACT PHONE - INCLUDE AREA CODE																																																																								
WITNESS	NAME: LAST, FIRST, MIDDLE					DATE OF BIRTH		AGE	GENDER																																																																					
	ADDRESS: STREET, CITY, STATE, ZIP					CONTACT PHONE - INCLUDE AREA CODE																																																																								
	NAME: LAST, FIRST, MIDDLE					DATE OF BIRTH		AGE	GENDER																																																																					
	ADDRESS: STREET, CITY, STATE, ZIP					CONTACT PHONE - INCLUDE AREA CODE																																																																								

LOCAL
REPORT
NUMBER 22-008350

REPORTING
AGENCY

FAIRFIELD P.D. 00901

DATE OF ACCIDENT
M 02 10 05 Y 22

IN COUNTY OF
BUTLER

ACCIDENT
LOCATION
SOUTH GILMORE RD AT RESOR RD

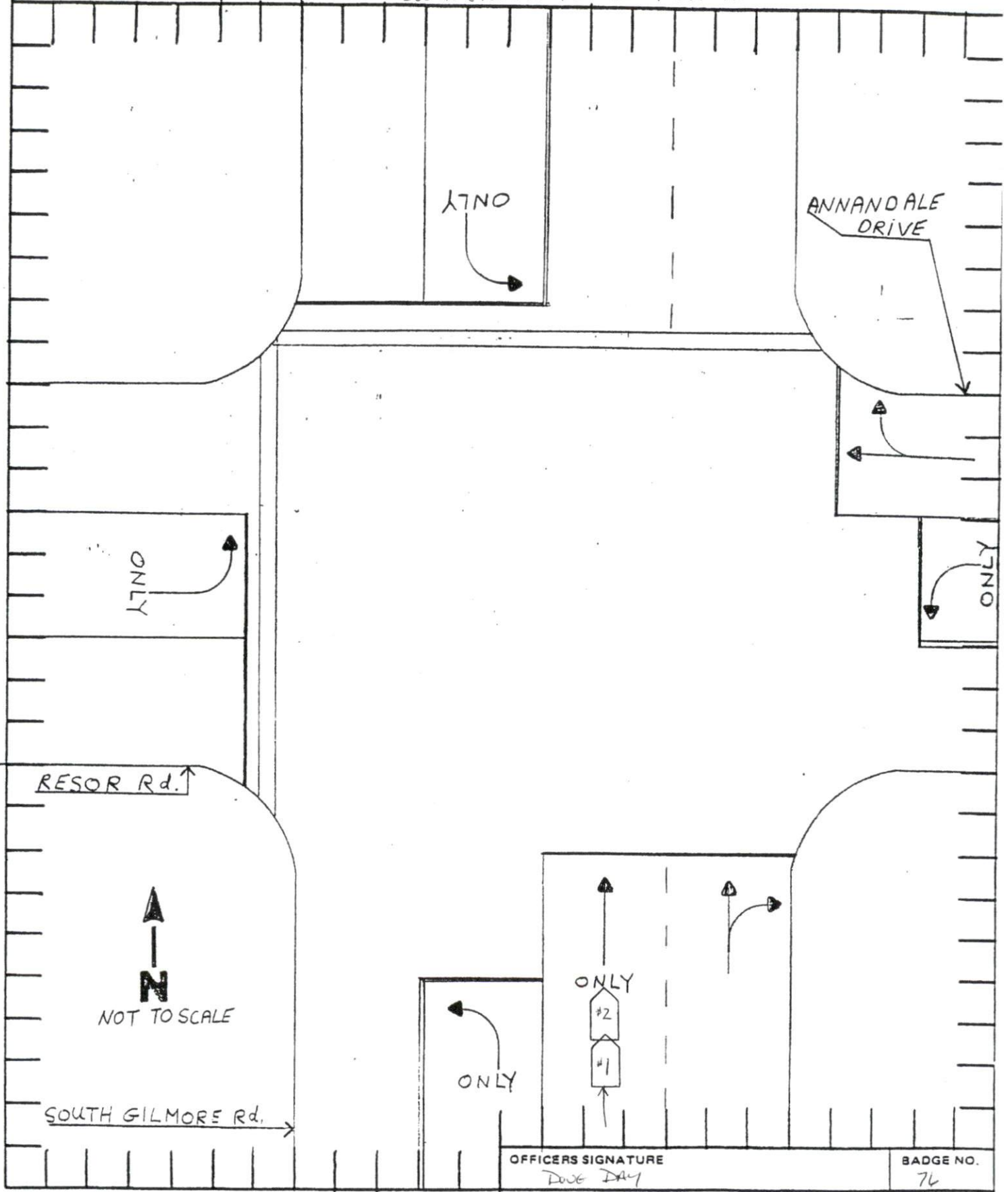

OFFICERS SIGNATURE
DOUG DAY

BADGE NO.
76