



TRAFFIC CRASH REPORT

*DENOTES MANDATORY FIELD FOR SUPPLEMENT REPORT

LOCAL REPORT NUMBER*

<input checked="" type="checkbox"/> PHOTOS TAKEN <input type="checkbox"/> SECONDARY CRASH		<input checked="" type="checkbox"/> OH-2 <input type="checkbox"/> OH-1P <input type="checkbox"/> OTHER <input type="checkbox"/> PRIVATE PROPERTY		LOCAL INFORMATION		2 2 0 1 2 2 5 2	
REPORTING AGENCY NAME* Fairfield Police Department				NCIC* 0 0 9 0 1		HIT/SKIP 1 - SOLVED 2 - UNSOLVED	
COUNTY* 0 9		LOCALITY* 1 - CITY 2 - VILLAGE 3 - TOWNSHIP 1		LOCATION: CITY, VILLAGE, TOWNSHIP* City of Fairfield		CRASH DATE / TIME* 0 2 1 9 2 0 2 2 1 9 2 5	
ROUTE TYPE 1 - NORTH 2 - SOUTH 3 - EAST 4 - WEST		ROUTE NUMBER 1 - NORTH 2 - SOUTH 3 - EAST 4 - WEST		LOCATION ROAD NAME RESOR		ROAD TYPE R D	
REFERENCE ROAD NAME (ROAD, MILEPOST, HOUSE #) S. GILMORE		ROAD TYPE R D		LATITUDE DECIMAL DEGREES 3 9 . 3 1 8 3 6 3		LONGITUDE DECIMAL DEGREES - 8 4 . 5 2 2 3 9 0	
REFERENCE POINT 1 - INTERSECTION 2 - MILE POST 3 - HOUSE # 1		DIRECTION FROM REFERENCE 1 - NORTH 2 - SOUTH 3 - EAST 4 - WEST		ROUTE TYPE IR - INTERSTATE ROUTE (TP) US - FEDERAL US ROUTE SR - STATE ROUTE CR - NUMBERED COUNTY ROUTE TR - NUMBERED TOWNSHIP ROUTE		ROAD TYPE AL - ALLEY AV - AVENUE BL - BOULEVARD CR - CIRCLE CT - COURT DR - DRIVE HE - HEIGHTS HW - HIGHWAY LA - LANE MP - MILEPOST OV - OVAL PK - PARKWAY PI - PIKE PL - PLACE RD - ROAD SQ - SQUARE ST - STREET TE - TERRACE TL - TRAIL WA - WAY	
DISTANCE FROM REFERENCE 1 - MILES 2 - FEET 3 - YARDS		DISTANCE UNIT OF MEASURE 1 - MILES 2 - FEET 3 - YARDS		INTERSECTION RELATED <input checked="" type="checkbox"/> WITHIN INTERSECTION OR ON APPROACH <input type="checkbox"/> WITHIN INTERCHANGE AREA NUMBER OF APPROACHES 0 4		ROADWAY <input type="checkbox"/> ROADWAY DIVIDED	
LOCATION OF FIRST HARMFUL EVENT 1 - ON ROADWAY 2 - ON SHOULDER 3 - IN MEDIAN 4 - ON ROADSIDE 5 - ON GORE 6 - OUTSIDE TRAFFIC WAY 7 - ON RAMP 8 - OFF RAMP 0 1		MANNER OF CRASH COLLISION/IMPACT 1 - NOT COLLISION BETWEEN TWO MOTOR VEHICLES IN TRANSPORT 2 - REAR-END 3 - HEAD-ON 4 - REAR-TO-REAR 5 - BACKING 6 - ANGLE 7 - SIDESWIPE, SAME DIRECTION 8 - SIDESWIPE, OPPOSITE DIRECTION 9 - OTHER / UNKNOWN 6		DIRECTION OF TRAVEL 1 - NORTH 2 - SOUTH 3 - EAST 4 - WEST		MEDIAN TYPE 1 - DIVIDED FLUSH MEDIAN (<4 FEET) 2 - DIVIDED FLUSH MEDIAN (>4 FEET) 3 - DIVIDED, DEPRESSED MEDIAN 4 - DIVIDED, RAISED MEDIAN (ANY TYPE) 9 - OTHER/UNKNOWN	
WORK ZONE RELATED WORKERS PRESENT LAW ENFORCEMENT PRESENT ACTIVE SCHOOL ZONE		WORK ZONE TYPE 1 - LANE CLOSURE 2 - LANE SHIFT/CROSSOVER 3 - WORK ON SHOULDER OR MEDIAN 4 - INTERMITTENT OR MOVING WORK 5 - OTHER		LOCATION OF CRASH IN WORK ZONE 1 - BEFORE THE 1ST WORK ZONE WARNING SIGN 2 - ADVANCE WARNING AREA 3 - TRANSITION AREA 4 - ACTIVITY AREA 5 - TERMINATION AREA		CONTOUR 1 - STRAIGHT LEVEL 2 - STRAIGHT GRADE 3 - CURVE LEVEL 4 - CURVE GRADE 9 - OTHER/UNKNOWN 2	
LIGHT CONDITION 1 - DAYLIGHT 2 - DAWN/DUSK 3 - DARK - LIGHTED ROADWAY 4 - DARK - ROADWAY NOT LIGHTED 5 - DARK - UNKNOWN ROADWAY LIGHTING 9 - OTHER / UNKNOWN 3		WEATHER 1 - CLEAR 2 - CLOUDY 3 - FOG, SMOG, SMOKE 4 - RAIN 5 - SLEET, HAIL 6 - SNOW 7 - SEVERE CROSSWINDS 8 - BLOWING SAND, SOIL, DIRT, SNOW 9 - FREEZING RAIN OR FREEZING DRIZZLE 99 - OTHER / UNKNOWN 0 1		CONDITIONS 1 - DRY 2 - WET 3 - SNOW 4 - ICE 5 - SAND, MUD, DIRT, OIL, GRAVEL 6 - WATER (STANDING, MOVING) 7 - SLUSH 9 - OTHER/UNKNOWN 1		SURFACE 1 - CONCRETE 2 - BLACKTOP, BITUMINOUS, ASPHALT 3 - BRICK/BLOCK 4 - SLAG, GRAVEL, STONE 5 - DIRT 9 - OTHER/UNKNOWN 2	
NARRATIVE On February 19, 2022 at 7:25 PM, Unit 2 was traveling westbound from Annandale Drive across S. Gilmore Road onto Resor Road. Unit 1 was traveling eastbound on Resor Road approaching S. Gilmore Road. Unit 1 then initiated a left turn onto S. Gilmore Road, failed to yield to Unit 2, and was struck by it. Unit 1 then fled the scene. Unit 1 was described as a navy blue square SUV.						Indicate the north direction with an "N" on the compass diagram. SEE OH-2	
CRASH REPORTED DATE / TIME 0 2 1 9 2 0 2 2 1 9 2 5		DISPATCH DATE / TIME 0 2 1 9 2 0 2 2 1 9 3 4		ARRIVAL DATE / TIME 0 2 1 9 2 0 2 2 1 9 3 9		SCENE CLEARED DATE / TIME 0 2 1 9 2 0 2 2 2 0 1 3	
TOTAL TIME ROADWAY CLOSED 0		OTHER INVESTIGATION TIME 3 0		TOTAL MINUTES 6 9		OFFICER'S NAME* A. ROUSH	
OFFICER'S BADGE NUMBER* 1 7 0		CHECKED BY OFFICER'S NAME* S. [Signature]		CHECKED BY OFFICER'S BADGE NUMBER* 8 7		REPORT TAKEN BY <input checked="" type="checkbox"/> POLICE AGENCY <input type="checkbox"/> MOTORIST <input type="checkbox"/> SUPPLEMENT (CORRECTION OR ADDITION TO AN EXISTING REPORT SENT TO USPS)	

UNIT #		OWNER NAME: LAST, FIRST, MIDDLE () SAME AS DRIVER		OWNER PHONE: INCLUDE AREA CODE () SAME AS DRIVER	
01					
OWNER ADDRESS: STREET, CITY, STATE, ZIP () SAME AS DRIVER					
COMMERCIAL CARRIER: NAME, ADDRESS, CITY, STATE, ZIP		COMMERCIAL CARRIER PHONE: INCLUDE AREA CODE			
LP STATE	LICENSE PLATE #	VEHICLE IDENTIFICATION #		VEHICLE YEAR	VEHICLE MAKE
<input type="checkbox"/> INSURANCE VERIFIED	INSURANCE COMPANY	INSURANCE POLICY #		COLOR	VEHICLE MODEL
TYPE OF USE <input type="checkbox"/> COMMERCIAL <input type="checkbox"/> GOVERNMENT <input type="checkbox"/> IN EMERGENCY RESPONSE		US DOT #		TOWED BY: COMPANY NAME	
<input type="checkbox"/> INTERLOCK DEVICE EQUIPPED <input checked="" type="checkbox"/> HIT/SKIP UNIT		#OCCUPANTS		HAZARDOUS MATERIAL <input type="checkbox"/> MATERIAL RELEASED <input type="checkbox"/> PLACARD	
VEHICLE WEIGHT GVWR/GCWR 1 - <10K LBS. 2 - 10,001 - 26K LBS. 3 - >26K LBS.		CLASS # PLACARD ID #			
UNIT TYPE 1 - PASSENGER CAR 2 - PASSENGER VAN (MINIVAN) 3 - SPORT UTILITY VEHICLE 4 - PICK UP 5 - CARGO VAN 6 - VAN (9-15 SEATS) 7 - MOTORCYCLE 2-WHEELED 8 - MOTORCYCLE 3-WHEELED 9 - AUTOCYCLE 10 - MOPED OR MOTORIZED BICYCLE 11 - ALL TERRAIN VEHICLE (ATV / UTV) 12 - GOLF CART 13 - SNOWMOBILE 14 - SINGLE UNIT TRUCK 15 - SEMI-TRACTOR 16 - FARM EQUIPMENT 17 - MOTORHOME 18 - LIMO (LIVERY VEHICLE) 19 - BUS (16+ PASSENGERS) 20 - OTHER VEHICLE 21 - HEAVY EQUIPMENT 22 - ANIMAL WITH RIDER OR ANIMAL-DRAWN VEHICLE 23 - PEDESTRIAN / SKATER 24 - WHEELCHAIR (ANY TYPE) 25 - OTHER NON-MOTORIST 26 - BICYCLE 27 - TRAIN 99 - UNKNOWN OR HIT/SKIP		# OF TRAILING UNITS			
WAS VEHICLE OPERATING IN AUTONOMOUS MODE WHEN CRASH OCCURRED? 1 - YES 2 - NO 9 - OTHER / UNKNOWN		AUTONOMOUS MODE LEVEL 0 - NO AUTOMATION 1 - DRIVER ASSISTANCE 2 - PARTIAL AUTOMATION 3 - CONDITIONAL AUTOMATION 4 - HIGH AUTOMATION 5 - FULL AUTOMATION 9 - UNKNOWN			
SPECIAL FUNCTION 1 - NONE 2 - TAXI 3 - ELECTRONIC RIDE SHARING 4 - SCHOOL TRANSPORT 5 - BUS - TRANSIT/COMMUTER 6 - BUS - CHARTER/TOUR 7 - BUS - INTERCITY 8 - BUS - SHUTTLE 9 - BUS - OTHER 10 - AMBULANCE 11 - FIRE 12 - MILITARY 13 - POLICE 14 - PUBLIC UTILITY 15 - CONSTRUCTION EQUIPMENT 16 - FARM 17 - MOWING 18 - SNOW REMOVAL 19 - TOWING 20 - SAFETY SERVICE PATROL 21 - MAIL CARRIER 99 - OTHER / UNKNOWN		CARGO BODY TYPE 1 - NO CARGO BODY TYPE / NOT APPLICABLE 2 - BUS 3 - VEHICLE TOWING ANOTHER MOTOR VEHICLE 4 - LOGGING 5 - INTERMODAL CONTAINER CHASSIS 6 - CARGO VAN/ENCLOSED BOX 7 - GRAIN/CHIPS/GRAVEL 8 - POLE 9 - CARGO TANK 10 - FLAT BED 11 - DUMP 12 - CONCRETE MIXER 13 - AUTO TRANSPORTER 14 - GARBAGE/REFUSE 99 - OTHER / UNKNOWN			
VEHICLE DEFECTS 1 - TURN SIGNALS 2 - HEAD LAMPS 3 - TAIL LAMPS 4 - BRAKES 5 - STEERING 6 - TIRE BLOWOUT 7 - WORN OR SLICK TIRES 8 - TRAILER EQUIPMENT DEFECTIVE 9 - MOTOR TROUBLE 10 - DISABLED FROM PRIOR ACCIDENT 99 - OTHER / UNKNOWN		NON-MOTORIST LOCATION AT IMPACT 1 - INTERSECTION - MARKED CROSSWALK 2 - INTERSECTION - UNMARKED CROSSWALK 3 - INTERSECTION - OTHER 4 - MIDBLOCK - MARKED CROSSWALK 5 - TRAVEL LANE - OTHER LOCATION 6 - BICYCLE LANE 7 - SHOULDER / ROADSIDE 8 - SIDEWALK 9 - MEDIAN/CROSSING ISLAND 10 - DRIVEWAY ACCESS 11 - SHARED USE PATHS OR TRAILS 12 - FIRST RESPONDER AT INCIDENT SCENE 99 - OTHER / UNKNOWN			
ACTION 1 - NON-CONTACT 2 - NON-COLLISION 3 - STRIKING 4 - STRUCK 5 - BOTH STRIKING & STRUCK 9 - OTHER / UNKNOWN PRE-CRASH ACTIONS 1 - STRAIGHT AHEAD 2 - BACKING 3 - CHANGING LANES 4 - OVERTAKING/PASSING 5 - MAKING RIGHT TURN 6 - MAKING LEFT TURN 7 - MAKING U-TURN 8 - ENTERING TRAFFIC LANE 9 - LEAVING TRAFFIC LANE 10 - PARKED 11 - SLOWING OR STOPPED IN TRAFFIC 12 - DRIVERLESS 13 - NEGOTIATING A CURVE 14 - ENTERING OR CROSSING SPECIFIED LOCATION 15 - WALKING, RUNNING, JOGGING, PLAYING 16 - WORKING 17 - PUSHING VEHICLE 18 - APPROACHING OR LEAVING VEHICLE 19 - STANDING 20 - OTHER NON-MOTORIST 21 - STANDING OUTSIDE DISABLED VEHICLE 99 - OTHER / UNKNOWN		INITIAL POINT OF CONTACT 0 - NO DAMAGE 1-12 - REFER TO UNIT DIAGRAM 13 - TOP 14 - UNDERCARRIAGE 15 - VEHICLE NOT AT SCENE 99 - UNKNOWN			
CONTRIBUTING CIRCUMSTANCES 1 - NONE 2 - FAILURE TO YIELD 3 - RAN RED LIGHT 4 - RAN STOP SIGN 5 - UNSAFE SPEED 6 - IMPROPER TURN 7 - LEFT OF CENTER 8 - FOLLOWING TOO CLOSE / ACDA 9 - IMPROPER LANE CHANGE 10 - IMPROPER PASSING 11 - DROVE OFF ROAD 12 - IMPROPER BACKING 13 - IMPROPER START FROM A PARKED POSITION 14 - STOPPED OR PARKED ILLEGALLY 15 - SWERVING TO AVOID 16 - WRONG WAY 17 - VISION OBSTRUCTION 18 - OPERATING DEFECTIVE EQUIPMENT 19 - LOAD SHIFTING/FALLING/ SPILLING 20 - IMPROPER CROSSING 21 - LYING IN ROADWAY 22 - NOT DISCERNIBLE 23 - OPENING DOOR INTO ROADWAY 99 - OTHER IMPROPER ACTION		TRAFFIC TRAFFICWAY FLOW 1 - ONE-WAY 2 - TWO-WAY TRAFFIC CONTROL 1 - ROUNDABOUT 4 - STOP SIGN 2 - SIGNAL 5 - YIELD SIGN 3 - FLASHER 6 - NO CONTROL			
SEQUENCE OF EVENTS 1 - OVERTURN/ROLLOVER 2 - FIRE/EXPLOSION 3 - IMMERSION 4 - JACKKNIFE 5 - CARGO / EQUIPMENT LOSS OR SHIFT 6 - EQUIPMENT FAILURE 7 - SEPARATION OF UNITS 8 - RAN OFF ROAD RIGHT 9 - RAN OFF ROAD LEFT 10 - CROSS MEDIAN 11 - CROSS CENTERLINE - OPPOSITE DIRECTION OF TRAVEL 12 - DOWNHILL RUNAWAY 13 - OTHER NON-COLLISION 14 - PEDESTRIAN 15 - PEDAL CYCLE 16 - RAILWAY VEHICLE 17 - ANIMAL - FARM 18 - ANIMAL - DEER 19 - ANIMAL - OTHER 20 - MOTOR VEHICLE IN TRANSPORT 21 - PARKED MOTOR VEHICLE 22 - WORK ZONE MAINTENANCE EQUIPMENT 23 - STRUCK BY FALLING, SHIFTING CARGO OR ANYTHING SET IN MOTION BY A MOTOR VEHICLE 24 - OTHER MOVABLE OBJECT		UNIT / NON-MOTORIST DIRECTION FROM 4 TO 1 1 - NORTH 5 - NORTHEAST 2 - SOUTH 6 - NORTHWEST 3 - EAST 7 - SOUTHEAST 4 - WEST 8 - SOUTHWEST 9 - OTHER / UNKNOWN			
COLLISION WITH FIXED OBJECT - STRUCK 25 - IMPACT ATTENUATOR / CRASH CUSHION 26 - BRIDGE OVERHEAD STRUCTURE 27 - BRIDGE PIER OR ABUTMENT 28 - BRIDGE PARAPET 29 - BRIDGE RAIL 30 - GUARDRAIL FACE 31 - GUARDRAIL END 32 - PORTABLE BARRIER 33 - MEDIAN CABLE BARRIER 34 - MEDIAN GUARDRAIL BARRIER 35 - MEDIAN CONCRETE BARRIER 36 - MEDIAN OTHER BARRIER 37 - TRAFFIC SIGN POST 38 - OVERHEAD SIGN POST 39 - LIGHT / LUMINARIES SUPPORT 40 - UTILITY POLE 41 - OTHER POST, POLE OR SUPPORT 42 - CULVERT 43 - CURB 44 - DITCH 45 - EMBANKMENT 46 - FENCE 47 - MAILBOX 48 - TREE 49 - FIRE HYDRANT 50 - WORK ZONE MAINTENANCE EQUIPMENT 51 - WALL 52 - BUILDING 53 - TUNNEL 54 - OTHER FIXED OBJECT 99 - OTHER / UNKNOWN		UNIT SPEED 1 5 POSTED SPEED 2 5			
FIRST HARMFUL EVENT 1 MOST HARMFUL EVENT		DETECTED SPEED 1 - STATED / ESTIMATED SPEED 2 - CALCULATED / EDR 3 - UNDETERMINED			

LOCAL REPORT NUMBER
2 2 0 1 2 2 5 2

DAMAGE
DAMAGE SCALE
1 - NONE 3 - FUNCTIONAL DAMAGE
2 - MINOR DAMAGE 4 - DISABLING DAMAGE
9 - UNKNOWN

DAMAGED AREA(S)
INDICATE ALL THAT APPLY

☐ - NO DAMAGE [0] ☐ - UNDERCARRIAGE [14]
☐ - TOP [13] ☐ - ALL AREAS [15]
☒ - UNIT NOT AT SCENE [16]

INITIAL POINT OF CONTACT
0 - NO DAMAGE 14 - UNDERCARRIAGE
1-12 - REFER TO UNIT DIAGRAM 15 - VEHICLE NOT AT SCENE
13 - TOP 99 - UNKNOWN

TRAFFIC
TRAFFICWAY FLOW
1 - ONE-WAY
2 - TWO-WAY
TRAFFIC CONTROL
1 - ROUNDABOUT 4 - STOP SIGN
2 - SIGNAL 5 - YIELD SIGN
3 - FLASHER 6 - NO CONTROL

OF THROUGH LANES ON ROAD
2

RAIL GRADE CROSSING
1 - NOT INVOLVED
2 - INVOLVED-ACTIVE CROSSING
3 - INVOLVED-PASSIVE CROSSING

UNIT / NON-MOTORIST DIRECTION
FROM 4 TO 1
1 - NORTH 5 - NORTHEAST
2 - SOUTH 6 - NORTHWEST
3 - EAST 7 - SOUTHEAST
4 - WEST 8 - SOUTHWEST
9 - OTHER / UNKNOWN

UNIT SPEED
1 5
POSTED SPEED
2 5

DETECTED SPEED
1 - STATED / ESTIMATED SPEED
2 - CALCULATED / EDR
3 - UNDETERMINED

OWNER	UNIT # 02	OWNER NAME: LAST, FIRST, MIDDLE (SAME AS DRIVER) JEFF WYLER FAIRFIELD INC	OWNER PHONE: INCLUDE AREA CODE (SAME AS DRIVER) L		
	OWNER ADDRESS: STREET, CITY, STATE, ZIP (SAME AS DRIVER) 5801 DIXIE HWY, FAIRFIELD, OH 45014		COMMERCIAL CARRIER PHONE: INCLUDE AREA CODE		
VEHICLE	LP STATE OH	LICENSE PLATE # HGR9950	VEHICLE IDENTIFICATION # 1N4BL4BV9LC267551	VEHICLE YEAR 2020	VEHICLE MAKE NISSAN
	<input checked="" type="checkbox"/> INSURANCE VERIFIED	INSURANCE COMPANY GEICO	INSURANCE POLICY # 6086360838	COLOR SILVER	VEHICLE MODEL ALTIMA
	<input type="checkbox"/> COMMERCIAL	<input type="checkbox"/> GOVERNMENT	<input type="checkbox"/> IN EMERGENCY RESPONSE	US DOT #	
	<input type="checkbox"/> INTERLOCK DEVICE EQUIPPED	<input type="checkbox"/> HIT/SKIP UNIT	#OCCUPANTS 01	VEHICLE WEIGHT GVWR/GCWR 1 - <10K LBS. 2 - 10,001 - 26K LBS. 3 - >26K LBS.	
	TYPE OF USE		TOWED BY: COMPANY NAME WAYNE'S TOWING		
			HAZARDOUS MATERIAL <input type="checkbox"/> MATERIAL RELEASED <input type="checkbox"/> PLACARD		
	UNIT TYPE		CLASS # PLACARD ID #		
	01		1 - PASSENGER CAR 7 - MOTORCYCLE 2-WHEELED 12 - GOLF CART 18 - LIMO (LIVERY VEHICLE) 23 - PEDESTRIAN / SKATER 2 - PASSENGER VAN (MINIVAN) 8 - MOTORCYCLE 3-WHEELED 13 - SNOWMOBILE 19 - BUS (16+ PASSENGERS) 24 - WHEELCHAIR (ANY TYPE) 3 - SPORT UTILITY VEHICLE 9 - AUTOCYCLE 14 - SINGLE UNIT TRUCK 20 - OTHER VEHICLE 25 - OTHER NON-MOTORIST 4 - PICK UP 10 - MOPED OR MOTORIZED BICYCLE 15 - SEMI-TRACTOR 21 - HEAVY EQUIPMENT 26 - BICYCLE 5 - CARGO VAN 11 - ALL TERRAIN VEHICLE (ATV / UTV) 16 - FARM EQUIPMENT 22 - ANIMAL WITH RIDER OR ANIMAL-DRAWN VEHICLE 27 - TRAIN 6 - VAN (9-15 SEATS) 17 - MOTORHOME 99 - UNKNOWN OR HIT/SKIP		
	00		# OF TRAILING UNITS		
	02		WAS VEHICLE OPERATING IN AUTONOMOUS MODE WHEN CRASH OCCURRED? 1 - YES 2 - NO 9 - OTHER / UNKNOWN		
01		AUTONOMOUS MODE LEVEL 0 - NO AUTOMATION 1 - DRIVER ASSISTANCE 3 - CONDITIONAL AUTOMATION 9 - UNKNOWN 1 - YES 2 - NO 9 - OTHER / UNKNOWN 2 - PARTIAL AUTOMATION 4 - HIGH AUTOMATION 5 - FULL AUTOMATION			
01		SPECIAL FUNCTION 1 - NONE 6 - BUS - CHARTER/TOUR 11 - FIRE 16 - FARM 21 - MAIL CARRIER 2 - TAXI 7 - BUS - INTERCITY 12 - MILITARY 17 - MOWING 99 - OTHER / UNKNOWN 3 - ELECTRONIC RIDE SHARING 8 - BUS - SHUTTLE 13 - POLICE 18 - SNOW REMOVAL 4 - SCHOOL TRANSPORT 9 - BUS - OTHER 14 - PUBLIC UTILITY 19 - TOWING 5 - BUS - TRANSIT/COMMUTER 10 - AMBULANCE 15 - CONSTRUCTION EQUIPMENT 20 - SAFETY SERVICE PATROL			
01		CARGO BODY TYPE 1 - NO CARGO BODY TYPE / NOT APPLICABLE 3 - VEHICLE TOWING ANOTHER MOTOR VEHICLE 5 - INTERMODAL CONTAINER CHASSIS 8 - POLE 12 - CONCRETE MIXER 2 - BUS 4 - LOGGING 6 - CARGO VAN/ENCLOSED BOX 9 - CARGO TANK 13 - AUTO TRANSPORTER 7 - GRAIN/CHIPS/GRAVEL 10 - FLAT BED 14 - GARBAGE/REFUSE 11 - DUMP 99 - OTHER / UNKNOWN			
01		VEHICLE DEFECTS 1 - TURN SIGNALS 4 - BRAKES 7 - WORN OR SLICK TIRES 9 - MOTOR TROUBLE 99 - OTHER / UNKNOWN 2 - HEAD LAMPS 5 - STEERING 8 - TRAILER EQUIPMENT DEFECTIVE 10 - DISABLED FROM PRIOR ACCIDENT 3 - TAIL LAMPS 6 - TIRE BLOWOUT			
01		NON-MOTORIST LOCATION AT IMPACT 1 - INTERSECTION - MARKED CROSSWALK 3 - INTERSECTION - OTHER 6 - BICYCLE LANE 9 - MEDIAN/CROSSING ISLAND 12 - FIRST RESPONDER AT INCIDENT SCENE 2 - INTERSECTION - UNMARKED CROSSWALK 4 - MIDBLOCK - MARKED CROSSWALK 7 - SHOULDER / ROADSIDE 10 - DRIVEWAY ACCESS 15 - VEHICLE NOT AT SCENE 5 - TRAVEL LANE - OTHER LOCATION 8 - SIDEWALK 11 - SHARED USE PATHS OR TRAILS 99 - OTHER / UNKNOWN			
03		ACTION 1 - NON-CONTACT 1 - STRAIGHT AHEAD 7 - MAKING U-TURN 13 - NEGOTIATING A CURVE 18 - APPROACHING OR LEAVING VEHICLE 2 - NON-COLLISION 2 - BACKING 8 - ENTERING TRAFFIC LANE 14 - ENTERING OR CROSSING SPECIFIED LOCATION 19 - STANDING 3 - STRIKING 3 - CHANGING LANES 9 - LEAVING TRAFFIC LANE 15 - WALKING, RUNNING, JOGGING, PLAYING 20 - OTHER NON-MOTORIST 4 - STRUCK PRE-CRASH ACTIONS 5 - MAKING RIGHT TURN 11 - SLOWING OR STOPPED IN TRAFFIC 16 - WORKING 21 - STANDING OUTSIDE DISABLED VEHICLE 5 - BOTH STRIKING & STRUCK 6 - MAKING LEFT TURN 12 - DRIVERLESS 17 - PUSHING VEHICLE 99 - OTHER / UNKNOWN 9 - OTHER / UNKNOWN			
01		CONTRIBUTING CIRCUMSTANCES 1 - NONE 7 - LEFT OF CENTER 13 - IMPROPER START FROM A PARKED POSITION 17 - VISION OBSTRUCTION 21 - LYING IN ROADWAY 2 - FAILURE TO YIELD 8 - FOLLOWING TOO CLOSE / ACDA 14 - STOPPED OR PARKED ILLEGALLY 18 - OPERATING DEFECTIVE EQUIPMENT 22 - NOT DISCERNIBLE 3 - RAN RED LIGHT 9 - IMPROPER LANE CHANGE 15 - SWERVING TO AVOID 19 - LOAD SHIFTING/FALLING/SPILLING 23 - OPENING DOOR INTO ROADWAY 4 - RAN STOP SIGN 10 - IMPROPER PASSING 16 - WRONG WAY 20 - IMPROPER CROSSING 99 - OTHER IMPROPER ACTION 5 - UNSAFE SPEED 11 - DROVE OFF ROAD 17 - VISION OBSTRUCTION 21 - LYING IN ROADWAY 6 - IMPROPER TURN 12 - IMPROPER BACKING			
01		SEQUENCE OF EVENTS 1 - OVERTURN/ROLLOVER 6 - EQUIPMENT FAILURE 11 - CROSS CENTERLINE - OPPOSITE DIRECTION OF TRAVEL 16 - RAILWAY VEHICLE 22 - WORK ZONE MAINTENANCE EQUIPMENT 2 - FIRE/EXPLOSION 7 - SEPARATION OF UNITS 12 - DOWNHILL RUNAWAY 17 - ANIMAL - FARM 23 - STRUCK BY FALLING, SHIFTING CARGO OR ANYTHING SET IN MOTION BY A MOTOR VEHICLE 3 - IMMERSION 8 - RAN OFF ROAD RIGHT 13 - OTHER NON-COLLISION 18 - ANIMAL - DEER 24 - OTHER MOVABLE OBJECT 4 - JACKKNIFE 9 - RAN OFF ROAD LEFT 14 - PEDESTRIAN 19 - ANIMAL - OTHER 20 - MOTOR VEHICLE IN TRANSPORT 5 - CARGO / EQUIPMENT LOSS OR SHIFT 10 - CROSS MEDIAN 15 - PEDALCYCLE 21 - PARKED MOTOR VEHICLE			
01		COLLISION WITH FIXED OBJECT - STRUCK 25 - IMPACT ATTENUATOR / CRASH CUSHION 31 - GUARDRAIL END 37 - TRAFFIC SIGN POST 43 - CURB 50 - WORK ZONE MAINTENANCE EQUIPMENT 26 - BRIDGE OVERHEAD STRUCTURE 32 - PORTABLE BARRIER 38 - OVERHEAD SIGN POST 44 - DITCH 51 - WALL 27 - BRIDGE PIER OR ABUTMENT 33 - MEDIAN CABLE BARRIER 39 - LIGHT / LUMINARIES SUPPORT 45 - EMBANKMENT 52 - BUILDING 28 - BRIDGE PARAPET 34 - MEDIAN GUARDRAIL BARRIER 40 - UTILITY POLE 46 - FENCE 53 - TUNNEL 29 - BRIDGE RAIL 35 - MEDIAN CONCRETE BARRIER 41 - OTHER POST, POLE OR SUPPORT 47 - MAILBOX 54 - OTHER FIXED OBJECT 30 - GUARDRAIL FACE 36 - MEDIAN OTHER BARRIER 42 - CULVERT 48 - TREE 55 - OTHER / UNKNOWN 49 - FIRE HYDRANT			
1		FIRST HARMFUL EVENT			
1		MOST HARMFUL EVENT			

LOCAL REPORT NUMBER 2 2 0 1 2 2 5 2	
DAMAGE DAMAGE SCALE 1 - NONE 3 - FUNCTIONAL DAMAGE 2 - MINOR DAMAGE 4 - DISABLING DAMAGE 9 - UNKNOWN	
DAMAGED AREA(S) INDICATE ALL THAT APPLY	
<input type="checkbox"/> NO DAMAGE [0] <input type="checkbox"/> UNDERCARRIAGE [14] <input type="checkbox"/> TOP [13] <input type="checkbox"/> ALL AREAS [15] <input type="checkbox"/> UNIT NOT AT SCENE [16]	
INITIAL POINT OF CONTACT 0 - NO DAMAGE 14 - UNDERCARRIAGE 1-12 - REFER TO UNIT DIAGRAM 15 - VEHICLE NOT AT SCENE 13 - TOP 99 - UNKNOWN	
TRAFFIC TRAFFICWAY FLOW 1 - ONE-WAY 2 - TWO-WAY # OF THROUGH LANES ON ROAD 2 RAIL GRADE CROSSING 1 - NOT INVOLVED 2 - INVOLVED-ACTIVE CROSSING 3 - INVOLVED-PASSIVE CROSSING	
UNIT / NON-MOTORIST DIRECTION FROM 3 TO 4 1 - NORTH 5 - NORTHEAST 2 - SOUTH 6 - NORTHWEST 3 - EAST 7 - SOUTHEAST 4 - WEST 8 - SOUTHWEST 9 - OTHER / UNKNOWN	
UNIT SPEED 2 0 POSTED SPEED 2 5 DETECTED SPEED 1 - STATED / ESTIMATED SPEED 2 - CALCULATED / EDR 3 - UNDETERMINED	

Motorist / Non-Motorist

LOCAL REPORT NUMBER													
2 2 0 1 2 2 5 2													
UNIT # 0 1		NAME: LAST, FIRST, MIDDLE				DATE OF BIRTH		AGE 0	GENDER				
ADDRESS: STREET, CITY, STATE, ZIP						CONTACT PHONE - INCLUDE AREA CODE							
INJURIES	INJURED TAKEN BY	EMS AGENCY (NAME)		INJURED TAKEN TO: MEDICAL FACILITY (NAME, CITY)		SAFETY EQUIPMENT USED 9 9	<input type="checkbox"/> DOT-COMPLIANT MC HELMET	SEATING POSITION 0 1	AIR BAG USAGE 9	EJECTION 1	TRAPPED 1		
OL STATE	OPERATOR LICENSE NUMBER			OFFENSE CHARGED		LOCAL CODE <input type="checkbox"/>	OFFENSE DESCRIPTION		CITATION NUMBER				
OL CLASS	ENDORSEMENT SELECT UP TO 2	RESTRICTION SELECT UP TO 3		DRIVER DISTRACTED BY 9	ALCOHOL / DRUG SUSPECTED <input type="checkbox"/> ALCOHOL <input type="checkbox"/> MARIJUANA <input type="checkbox"/> OTHER DRUG		CONDITION 9	ALCOHOL TEST STATUS TYPE VALUE 1 1		DRUG TEST(S) STATUS TYPE RESULT SELECT UP TO 4 1 1			
UNIT # 0 2		NAME: LAST, FIRST, MIDDLE ODUBOLA, KEAILA LOVE				DATE OF BIRTH		AGE 23	GENDER F				
ADDRESS: STREET, CITY, STATE, ZIP 100 BENT TREE DR APT 3D, FAIRFIELD, OH 45014						CONTACT PHONE - INCLUDE AREA CODE							
INJURIES 5	INJURED TAKEN BY	EMS AGENCY (NAME)		INJURED TAKEN TO: MEDICAL FACILITY (NAME, CITY)		SAFETY EQUIPMENT USED 0 4	<input type="checkbox"/> DOT-COMPLIANT MC HELMET	SEATING POSITION 0 1	AIR BAG USAGE 1	EJECTION 1	TRAPPED 1		
OL STATE OH	OPERATOR LICENSE NUMBER			OFFENSE CHARGED		LOCAL CODE <input type="checkbox"/>	OFFENSE DESCRIPTION		CITATION NUMBER				
OL CLASS 4	ENDORSEMENT SELECT UP TO 2	RESTRICTION SELECT UP TO 3 0 3		DRIVER DISTRACTED BY 1	ALCOHOL / DRUG SUSPECTED <input type="checkbox"/> ALCOHOL <input type="checkbox"/> MARIJUANA <input type="checkbox"/> OTHER DRUG		CONDITION 1	ALCOHOL TEST STATUS TYPE VALUE 1 1		DRUG TEST(S) STATUS TYPE RESULT SELECT UP TO 4 1 1			
UNIT #		NAME: LAST, FIRST, MIDDLE				DATE OF BIRTH		AGE	GENDER				
ADDRESS: STREET, CITY, STATE, ZIP						CONTACT PHONE - INCLUDE AREA CODE							
INJURIES	INJURED TAKEN BY	EMS AGENCY (NAME)		INJURED TAKEN TO: MEDICAL FACILITY (NAME, CITY)		SAFETY EQUIPMENT USED	<input type="checkbox"/> DOT-COMPLIANT MC HELMET	SEATING POSITION	AIR BAG USAGE	EJECTION	TRAPPED		
OL STATE	OPERATOR LICENSE NUMBER			OFFENSE CHARGED		LOCAL CODE <input type="checkbox"/>	OFFENSE DESCRIPTION		CITATION NUMBER				
OL CLASS	ENDORSEMENT SELECT UP TO 2	RESTRICTION SELECT UP TO 3		DRIVER DISTRACTED BY	ALCOHOL / DRUG SUSPECTED <input type="checkbox"/> ALCOHOL <input type="checkbox"/> MARIJUANA <input type="checkbox"/> OTHER DRUG		CONDITION	ALCOHOL TEST STATUS TYPE VALUE		DRUG TEST(S) STATUS TYPE RESULT SELECT UP TO 4			
INJURIES		SEATING POSITION		AIR BAG		OL CLASS		OL RESTRICTION(S)		DRIVER DISTRACTION		TEST STATUS	
1 - FATAL		1 - FRONT - LEFT SIDE (MOTORCYCLE DRIVER)		1 - NOT DEPLOYED		1 - CLASS A		1 - ALCOHOL INTERLOCK DEVICE		1 - NOT DISTRACTED		1 - NONE GIVEN	
2 - SUSPECTED SERIOUS INJURY		2 - FRONT - MIDDLE		2 - DEPLOYED FRONT		2 - CLASS B		2 - CDL INTRASTATE ONLY		2 - MANUALLY OPERATING AN ELECTRONIC COMMUNICATION DEVICE (TEXTING, TYPING, DIALING)		2 - TEST REFUSED	
3 - SUSPECTED MINOR INJURY		3 - FRONT - RIGHT SIDE		3 - DEPLOYED SIDE		3 - CLASS C		3 - CORRECTIVE LENSES		3 - TALKING ON HANDS-FREE COMMUNICATION DEVICE		3 - TEST GIVEN, CONTAMINATED SAMPLE / UNUSABLE	
4 - POSSIBLE INJURY		4 - SECOND - LEFT SIDE (MOTORCYCLE PASSENGER)		4 - DEPLOYED BOTH FRONT / SIDE		4 - REGULAR CLASS (OHIO = D)		4 - FARM WAIVER		4 - TALKING ON HAND-HELD COMMUNICATION DEVICE		4 - TEST GIVEN, RESULTS KNOWN	
5 - NO APPARENT INJURY		5 - SECOND - MIDDLE		5 - NOT APPLICABLE		5 - M/C MOPED ONLY		5 - EXCEPT CLASS A BUS & CLASS B BUS		5 - OTHER ACTIVITY WITH AN ELECTRONIC DEVICE		5 - TEST GIVEN, RESULTS UNKNOWN	
INJURED TAKEN BY		6 - SECOND - RIGHT SIDE		9 - DEPLOYMENT UNKNOWN		6 - NO VALID OL		6 - EXCEPT CLASS A & CLASS B BUS		6 - PASSENGER		ALCOHOL TEST TYPE	
1 - NOT TRANSPORTED /TREATED AT SCENE		7 - THIRD - LEFT SIDE (MOTORCYCLE SIDE CAR)		EJECTION		7 - EXCEPT TRACTOR-TRAILER		7 - EXCEPT TRACTOR-TRAILER		7 - OTHER DISTRACTION INSIDE THE VEHICLE		1 - NONE	
2 - EMS		8 - THIRD - MIDDLE		1 - NOT EJECTED		8 - INTERMEDIATE LICENSE RESTRICTIONS		8 - INTERMEDIATE LICENSE RESTRICTIONS		8 - OTHER DISTRACTION OUTSIDE THE VEHICLE		2 - BLOOD	
3 - POLICE		9 - THIRD - RIGHT SIDE		2 - PARTIALLY EJECTED		9 - LEARNER'S PERMIT RESTRICTIONS		9 - LEARNER'S PERMIT RESTRICTIONS		9 - OTHER / UNKNOWN		3 - URINE	
9 - OTHER / UNKNOWN		10 - SLEEPER SECTION OF TRUCK CAB		3 - TOTALLY EJECTED		10 - LIMITED TO DAYLIGHT ONLY		10 - LIMITED TO DAYLIGHT ONLY		10 - LIMITED TO DAYLIGHT ONLY		4 - BREATH	
SAFETY EQUIPMENT		11 - PASSENGER IN OTHER ENCLOSED CARGO AREA (NON-TRAILING UNIT, BUS, PICK-UP WITH CAP)		4 - NOT APPLICABLE		11 - LIMITED TO EMPLOYMENT		11 - LIMITED TO EMPLOYMENT		11 - LIMITED TO EMPLOYMENT		5 - OTHER	
1 - NONE USED		12 - PASSENGER IN UNENCLOSED CARGO AREA		TRAPPED		12 - LIMITED - OTHER		12 - LIMITED - OTHER		12 - LIMITED - OTHER		DRUG TEST TYPE	
2 - SHOULDER BELT ONLY USED		13 - TRAILING UNIT		1 - NOT TRAPPED		13 - MECHANICAL DEVICES (SPECIAL BRAKES, HAND CONTROLS, OR OTHER ADAPTIVE DEVICES)		13 - MECHANICAL DEVICES (SPECIAL BRAKES, HAND CONTROLS, OR OTHER ADAPTIVE DEVICES)		13 - MECHANICAL DEVICES (SPECIAL BRAKES, HAND CONTROLS, OR OTHER ADAPTIVE DEVICES)		1 - NONE	
3 - LAP BELT ONLY USED		14 - RIDING ON VEHICLE EXTERIOR (NON-TRAILING UNIT)		2 - EXTRICATED BY MECHANICAL MEANS		14 - MILITARY VEHICLES ONLY		14 - MILITARY VEHICLES ONLY		14 - MILITARY VEHICLES ONLY		2 - BLOOD	
4 - SHOULDER & LAP BELT USED		15 - NON-MOTORIST		3 - FREED BY NON-MECHANICAL MEANS		15 - MOTOR VEHICLES WITHOUT AIR BRAKES		15 - MOTOR VEHICLES WITHOUT AIR BRAKES		15 - MOTOR VEHICLES WITHOUT AIR BRAKES		3 - URINE	
5 - CHILD RESTRAINT SYSTEM - FORWARD FACING		99 - OTHER / UNKNOWN		GENDER		16 - OUTSIDE MIRROR		16 - OUTSIDE MIRROR		16 - OUTSIDE MIRROR		4 - OTHER	
6 - CHILD RESTRAINT SYSTEM - REAR FACING				F - FEMALE		17 - PROSTHETIC AID		17 - PROSTHETIC AID		17 - PROSTHETIC AID			
7 - BOOSTER SEAT				M - MALE		18 - OTHER		18 - OTHER		18 - OTHER			
8 - HELMET USED				U - OTHER / UNKNOWN									
9 - PROTECTIVE PADS USED (ELBOW, KNEES, ETC.)													
10 - REFLECTIVE CLOTHING													
11 - LIGHTING - PEDESTRIAN / BICYCLE ONLY													
99 - OTHER / UNKNOWN													
												DRUG TEST RESULT(S)	
												1 - AMPHETAMINES	
												2 - BARBITURATES	
												3 - BENZODIAZEPINES	
												4 - CANNABINOIDS	
												5 - COCAINE	
												6 - OPIATES / OPIOIDS	
												7 - OTHER	
												8 - NEGATIVE RESULTS	

LOCAL
REPORT
NUMBER 22012252

REPORTING
AGENCY FAIRFIELD P.D. 00901

DATE OF ACCIDENT
M 02 10 19 1Y 22

IN COUNTY OF BUTLER

ACCIDENT
LOCATION Resor Rd. / S. Gilmore Rd.

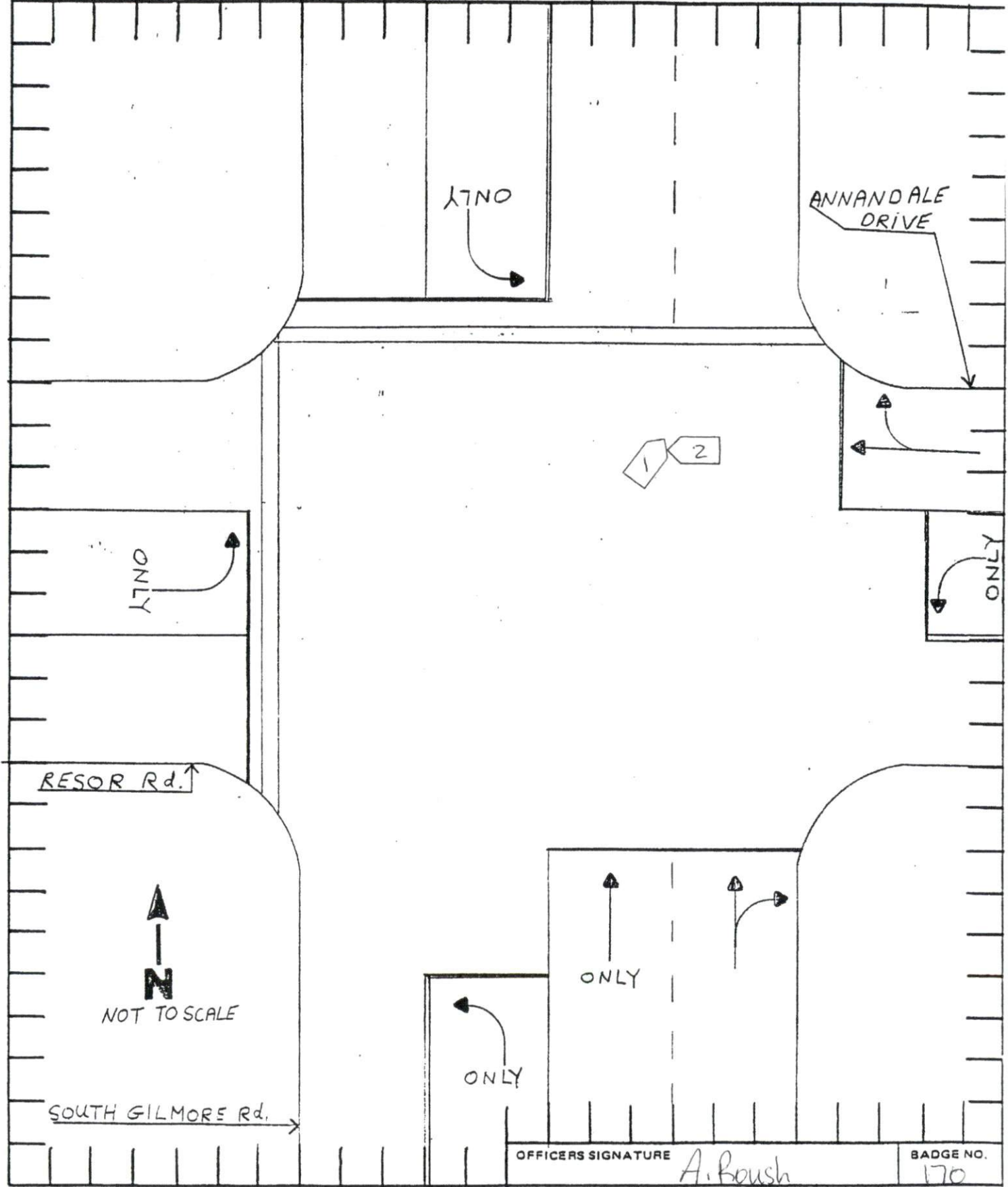

OFFICERS SIGNATURE A. Boush

BADGE NO. 170