



# TRAFFIC CRASH REPORT

\*DENOTES MANDATORY FIELD FOR SUPPLEMENT REPORT

<input checked="" type="checkbox"/> PHOTOS TAKEN <input type="checkbox"/> SECONDARY CRASH		<input checked="" type="checkbox"/> OH-2 <input type="checkbox"/> OH-1P <input type="checkbox"/> OTHER <input type="checkbox"/> PRIVATE PROPERTY	LOCAL INFORMATION REPORTING AGENCY NAME* Fairfield Police Department		NCIC* 00901	LOCAL REPORT NUMBER* 22012614	
COUNTY* 09	LOCALITY* 1-CITY 2-VILLAGE 3-TOWNSHIP 1	LOCATION: CITY, VILLAGE, TOWNSHIP* City of Fairfield		CRASH DATE / TIME* 02212022 0850		CRASH SEVERITY 1-FATAL 2-SERIOUS INJURY SUSPECTED 3-MINOR INJURY SUSPECTED 4-INJURY POSSIBLE 5-PROPERTY DAMAGE ONLY 3	
ROUTE TYPE U S	ROUTE NUMBER 127	PREFIX 1-NORTH 2-SOUTH 3-EAST 4-WEST	LOCATION ROAD NAME CITY OF FAIRFIELD	ROAD TYPE	LATITUDE DECIMAL DEGREES 39.323052	CRASH SEVERITY 1-FATAL 2-SERIOUS INJURY SUSPECTED 3-MINOR INJURY SUSPECTED 4-INJURY POSSIBLE 5-PROPERTY DAMAGE ONLY 3	
ROUTE TYPE	ROUTE NUMBER	PREFIX 1-NORTH 2-SOUTH 3-EAST 4-WEST	REFERENCE ROAD NAME (ROAD, MILEPOST, HOUSE #) EMERALD LAKE	ROAD TYPE D R	LONGITUDE DECIMAL DEGREES -84.561265	CRASH SEVERITY 1-FATAL 2-SERIOUS INJURY SUSPECTED 3-MINOR INJURY SUSPECTED 4-INJURY POSSIBLE 5-PROPERTY DAMAGE ONLY 3	
REFERENCE POINT 1-INTERSECTION 2-MILE POST 3-HOUSE # 1	DIRECTION FROM REFERENCE 1-NORTH 2-SOUTH 3-EAST 4-WEST 1	ROUTE TYPE IR-INTERSTATE ROUTE(TP) US-FEDERAL US ROUTE SR-STATE ROUTE CR-NUMBERED COUNTY ROUTE TR-NUMBERED TOWNSHIP ROUTE	ROAD TYPE AL-ALLEY AV-AVENUE BL-BOULEVARD CR-CIRCLE CT-COURT DR-DRIVE HE-HEIGHTS HW-HIGHWAY LA-LANE MP-MILEPOST OV-OVAL PK-PARKWAY PI-PIKE PL-PLACE RD-ROAD SQ-SQUARE ST-STREET TE-TERRACE TL-TRAIL WA-WAY	INTERSECTION RELATED <input checked="" type="checkbox"/> WITHIN INTERSECTION OR ON APPROACH <input type="checkbox"/> WITHIN INTERCHANGE AREA NUMBER OF APPROACHES 04			
DISTANCE FROM REFERENCE 20	DISTANCE UNIT OF MEASURE 1-MILES 2-Feet 3-YARDS 2	MANNER OF CRASH COLLISION/IMPACT 1-NOT COLLISION BETWEEN TWO MOTOR VEHICLES IN TRANSPORT 2-REAR-END 3-HEAD-ON 4-REAR-TO-REAR 5-BACKING 6-ANGLE 7-SIDESWIPE, SAME DIRECTION 8-SIDESWIPE, OPPOSITE DIRECTION 9-OTHER / UNKNOWN 2		DIRECTION OF TRAVEL 1-NORTH 2-SOUTH 3-EAST 4-WEST 1			
LOCATION OF FIRST HARMFUL EVENT 1-ON ROADWAY 2-ON SHOULDER 3-IN MEDIAN 4-ON ROADSIDE 5-ON GORE 6-OUTSIDE TRAFFIC WAY 7-ON RAMP 8-OFF RAMP 01		MANNER OF CRASH COLLISION/IMPACT 1-NOT COLLISION BETWEEN TWO MOTOR VEHICLES IN TRANSPORT 2-REAR-END 3-HEAD-ON 4-REAR-TO-REAR 5-BACKING 6-ANGLE 7-SIDESWIPE, SAME DIRECTION 8-SIDESWIPE, OPPOSITE DIRECTION 9-OTHER / UNKNOWN 2		MEDIAN TYPE 1-DIVIDED FLUSH MEDIAN (<4 FEET) 2-DIVIDED FLUSH MEDIAN (>4 FEET) 3-DIVIDED, DEPRESSED MEDIAN 4-DIVIDED, RAISED MEDIAN (ANY TYPE) 9-OTHER/UNKNOWN 2			
<input type="checkbox"/> WORK ZONE RELATED <input type="checkbox"/> WORKERS PRESENT <input type="checkbox"/> LAW ENFORCEMENT PRESENT <input type="checkbox"/> ACTIVE SCHOOL ZONE		WORK ZONE TYPE 1-LANE CLOSURE 2-LANE SHIFT/CROSSOVER 3-WORK ON SHOULDER OR MEDIAN 4-INTERMITTENT OR MOVING WORK 5-OTHER		LOCATION OF CRASH IN WORK ZONE 1-BEFORE THE 1ST WORK ZONE WARNING SIGN 2-ADVANCE WARNING AREA 3-TRANSITION AREA 4-ACTIVITY AREA 5-TERMINATION AREA		CONTOUR 1 1- STRAIGHT LEVEL 2- STRAIGHT GRADE 3- CURVE LEVEL 4- CURVE GRADE 9- OTHER/UNKNOWN	
LIGHT CONDITION 1-DAYLIGHT 2-DAWN/DUSK 3-DARK - LIGHTED ROADWAY 4-DARK - ROADWAY NOT LIGHTED 5-DARK - UNKNOWN ROADWAY LIGHTING 9-OTHER / UNKNOWN 1		WEATHER 1-CLEAR 2-CLOUDY 3-FOG, SMOG, SMOKE 4-RAIN 5-SLEET, HAIL 6-SNOW 7-SEVERE CROSSWINDS 8-BLOWING SAND, SOIL, DIRT, SNOW 9-FREEZING RAIN OR FREEZING DRIZZLE 99-OTHER / UNKNOWN 01		CONDITIONS 1 1-DRY 2-WET 3-SNOW 4-ICE 5-SAND, MUD, DIRT, OIL, GRAVEL 6-WATER (STANDING, MOVING) 7-SLUSH 9-OTHER/UNKNOWN			
SURFACE 1-CONCRETE 2-BLACKTOP, BITUMINOUS, ASPHALT 3-BRICK/BLOCK 4-SLAG, GRAVEL, STONE 5-DIRT 9-OTHER/UNKNOWN 2		NARRATIVE On 02-21-22 at 8:50 a.m., Unit 2 was stopped in traffic in the straight through lane of southbound US 127 (Pleasant Ave). Unit 1 was traveling south on US 127 (Pleasant Ave) in the straight through lane. Unit 1 drove into the rear of Unit 2.  SEE OH-2					
CRASH REPORTED DATE / TIME 02212022 0851		DISPATCH DATE / TIME 02212022 0853		ARRIVAL DATE / TIME 02212022 0855		SCENE CLEARED DATE / TIME 02212022 0923	
TOTAL TIME ROADWAY CLOSED 20	OTHER INVESTIGATION TIME 30	TOTAL MINUTES 60	OFFICER'S NAME* P.O. J. DRAKE	OFFICER'S BADGE NUMBER* 88		CHECKED BY OFFICER'S NAME* Sgt. J Sprague	
					CHECKED BY OFFICER'S BADGE NUMBER* 84		
REPORT TAKEN BY <input checked="" type="checkbox"/> POLICE AGENCY <input type="checkbox"/> MOTORIST <input type="checkbox"/> SUPPLEMENT (CORRECTION OR ADDITION TO AN EXISTING REPORT SENT TO ODPS)							

OWNER	UNIT #	OWNER NAME: LAST, FIRST, MIDDLE (☐ SAME AS DRIVER)		OWNER PHONE: INCLUDE AREA CODE (☐ SAME AS DRIVER)	
	01	MWGH LLC DBA METALWORKING GROUP		L	
	OWNER ADDRESS: STREET, CITY, STATE, ZIP (☐ SAME AS DRIVER)				
	9070 PIPPIN RD CINCINNATI OH 45251				
COMMERCIAL CARRIER: NAME, ADDRESS, CITY, STATE, ZIP					COMMERCIAL CARRIER PHONE
MWGH LLC DBA METALWORKING GROUP, 9070 PIPPIN RD CINCINNATI, OH 45251					
VEHICLE	LP STATE	LICENSE PLATE #	VEHICLE IDENTIFICATION #		VEHICLE YEAR
	OH	PLB5686	2N1P2HM6X19M1744484		2021
	INSURANCE VERIFIED	INSURANCE COMPANY	INSURANCE POLICY #		COLOR
	☑	CINCINNATI CASUALTY	BPP0347615		WHITE
	TYPE OF USE		US DOT #		TOWED BY: COMPANY NAME
	☑ COMMERCIAL ☐ GOVERNMENT ☐ IN EMERGENCY RESPONSE		1 2 2 1 1 3 4		
	INTERLOCK DEVICE EQUIPPED	HIT/SKIP UNIT	#OCCUPANTS		HAZARDOUS MATERIAL
	☐	☐	01		☐ MATERIAL RELEASED ☐ PLACARD
	VEHICLE WEIGHT GVWR/GCWR		CLASS # PLACARD ID #		
	1 - <10K LBS. 2 - 10,001 - 26K LBS. 3 - >26K LBS.				
UNIT TYPE					
1 - PASSENGER CAR 7 - MOTORCYCLE 2-WHEELED 12 - GOLF CART 18 - LIMO (LIVERY VEHICLE) 23 - PEDESTRIAN / SKATER					
2 - PASSENGER VAN (MINIVAN) 8 - MOTORCYCLE 3-WHEELED 13 - SNOWMOBILE 19 - BUS (16+ PASSENGERS) 24 - WHEELCHAIR (ANY TYPE)					
3 - SPORT UTILITY VEHICLE 9 - AUTOCYCLE 14 - SINGLE UNIT TRUCK 20 - OTHER VEHICLE 25 - OTHER NON-MOTORIST					
4 - PICK UP 10 - MOPED OR MOTORIZED BICYCLE 15 - SEMI-TRACTOR 21 - HEAVY EQUIPMENT 26 - BICYCLE					
5 - CARGO VAN 11 - ALL TERRAIN VEHICLE (ATV / UTV) 16 - FARM EQUIPMENT 22 - ANIMAL WITH RIDER OR ANIMAL-DRAWN VEHICLE 27 - TRAIN					
6 - VAN (9-15 SEATS) 17 - MOTORHOME 99 - UNKNOWN OR HIT/SKIP					
# OF TRAILING UNITS					
00					
WAS VEHICLE OPERATING IN AUTONOMOUS MODE WHEN CRASH OCCURRED?					
1 - YES 2 - NO 9 - OTHER / UNKNOWN					
AUTONOMOUS MODE LEVEL					
1 - NONE 6 - BUS - CHARTER/TOUR 11 - FIRE 16 - FARM 21 - MAIL CARRIER					
2 - TAXI 7 - BUS - INTERCITY 12 - MILITARY 17 - MOWING 99 - OTHER / UNKNOWN					
3 - ELECTRONIC RIDE SHARING 8 - BUS - SHUTTLE 13 - POLICE 18 - SNOW REMOVAL					
4 - SCHOOL TRANSPORT 9 - BUS - OTHER 14 - PUBLIC UTILITY 19 - TOWING					
5 - BUS - TRANSIT/COMMUTER 10 - AMBULANCE 15 - CONSTRUCTION EQUIPMENT 20 - SAFETY SERVICE PATROL					
CARGO BODY TYPE					
1 - NO CARGO BODY TYPE / NOT APPLICABLE 3 - VEHICLE TOWING ANOTHER MOTOR VEHICLE 5 - INTERMODAL CONTAINER CHASSIS 8 - POLE 12 - CONCRETE MIXER					
2 - BUS 4 - LOGGING 6 - CARGO VAN/ENCLOSED BOX 9 - CARGO TANK 13 - AUTO TRANSPORTER					
7 - GRAIN/CHIPS/GRAVEL 10 - FLAT BED 14 - GARBAGE/REFUSE 99 - OTHER / UNKNOWN					
11 - DUMP					
VEHICLE DEFECTS					
1 - TURN SIGNALS 4 - BRAKES 7 - WORN OR SLICK TIRES 9 - MOTOR TROUBLE 99 - OTHER / UNKNOWN					
2 - HEAD LAMPS 5 - STEERING 8 - TRAILER EQUIPMENT DEFECTIVE 10 - DISABLED FROM PRIOR ACCIDENT					
3 - TAIL LAMPS 6 - TIRE BLOWOUT					
NON-MOTORIST LOCATION AT IMPACT					
1 - INTERSECTION - MARKED CROSSWALK 3 - INTERSECTION - OTHER 6 - BICYCLE LANE 9 - MEDIAN/CROSSING ISLAND 12 - FIRST RESPONDER AT INCIDENT SCENE					
2 - INTERSECTION - UNMARKED CROSSWALK 4 - MIDBLOCK - MARKED CROSSWALK 7 - SHOULDER / ROADSIDE 10 - DRIVEWAY ACCESS 13 - POLICE 14 - ENTERING OR CROSSING SPECIFIED LOCATION 15 - WALKING, RUNNING, JOGGING, PLAYING 16 - WORKING 17 - PUSHING VEHICLE 18 - APPROACHING OR LEAVING VEHICLE 19 - STANDING 20 - OTHER NON-MOTORIST 21 - STANDING OUTSIDE DISABLED VEHICLE 22 - OTHER MOVABLE OBJECT 23 - STRUCK BY FALLING, SHIFTING CARGO OR ANYTHING SET IN MOTION BY A MOTOR VEHICLE 24 - OTHER MOVABLE OBJECT					
ACTION					
1 - NON-CONTACT 1 - STRAIGHT AHEAD 7 - MAKING U-TURN 13 - NEGOTIATING A CURVE 18 - APPROACHING OR LEAVING VEHICLE 19 - STANDING 20 - OTHER NON-MOTORIST 21 - STANDING OUTSIDE DISABLED VEHICLE 22 - OTHER MOVABLE OBJECT 23 - STRUCK BY FALLING, SHIFTING CARGO OR ANYTHING SET IN MOTION BY A MOTOR VEHICLE 24 - OTHER MOVABLE OBJECT					
2 - NON-COLLISION 2 - BACKING 8 - ENTERING TRAFFIC LANE 14 - ENTERING OR CROSSING SPECIFIED LOCATION 15 - WALKING, RUNNING, JOGGING, PLAYING 16 - WORKING 17 - PUSHING VEHICLE 18 - APPROACHING OR LEAVING VEHICLE 19 - STANDING 20 - OTHER NON-MOTORIST 21 - STANDING OUTSIDE DISABLED VEHICLE 22 - OTHER MOVABLE OBJECT 23 - STRUCK BY FALLING, SHIFTING CARGO OR ANYTHING SET IN MOTION BY A MOTOR VEHICLE 24 - OTHER MOVABLE OBJECT					
3 - STRIKING 3 - CHANGING LANES 9 - LEAVING TRAFFIC LANE 10 - PARKED 11 - SLOWING OR STOPPED IN TRAFFIC 12 - DRIVERLESS 13 - NEGOTIATING A CURVE 14 - ENTERING OR CROSSING SPECIFIED LOCATION 15 - WALKING, RUNNING, JOGGING, PLAYING 16 - WORKING 17 - PUSHING VEHICLE 18 - APPROACHING OR LEAVING VEHICLE 19 - STANDING 20 - OTHER NON-MOTORIST 21 - STANDING OUTSIDE DISABLED VEHICLE 22 - OTHER MOVABLE OBJECT 23 - STRUCK BY FALLING, SHIFTING CARGO OR ANYTHING SET IN MOTION BY A MOTOR VEHICLE 24 - OTHER MOVABLE OBJECT					
4 - STRUCK 4 - OVERTAKING/PASSING 5 - MAKING RIGHT TURN 6 - MAKING LEFT TURN 7 - MAKING U-TURN 8 - ENTERING TRAFFIC LANE 9 - LEAVING TRAFFIC LANE 10 - PARKED 11 - SLOWING OR STOPPED IN TRAFFIC 12 - DRIVERLESS 13 - NEGOTIATING A CURVE 14 - ENTERING OR CROSSING SPECIFIED LOCATION 15 - WALKING, RUNNING, JOGGING, PLAYING 16 - WORKING 17 - PUSHING VEHICLE 18 - APPROACHING OR LEAVING VEHICLE 19 - STANDING 20 - OTHER NON-MOTORIST 21 - STANDING OUTSIDE DISABLED VEHICLE 22 - OTHER MOVABLE OBJECT 23 - STRUCK BY FALLING, SHIFTING CARGO OR ANYTHING SET IN MOTION BY A MOTOR VEHICLE 24 - OTHER MOVABLE OBJECT					
5 - BOTH STRIKING & STRUCK 5 - MAKING RIGHT TURN 6 - MAKING LEFT TURN 7 - MAKING U-TURN 8 - ENTERING TRAFFIC LANE 9 - LEAVING TRAFFIC LANE 10 - PARKED 11 - SLOWING OR STOPPED IN TRAFFIC 12 - DRIVERLESS 13 - NEGOTIATING A CURVE 14 - ENTERING OR CROSSING SPECIFIED LOCATION 15 - WALKING, RUNNING, JOGGING, PLAYING 16 - WORKING 17 - PUSHING VEHICLE 18 - APPROACHING OR LEAVING VEHICLE 19 - STANDING 20 - OTHER NON-MOTORIST 21 - STANDING OUTSIDE DISABLED VEHICLE 22 - OTHER MOVABLE OBJECT 23 - STRUCK BY FALLING, SHIFTING CARGO OR ANYTHING SET IN MOTION BY A MOTOR VEHICLE 24 - OTHER MOVABLE OBJECT					
9 - OTHER / UNKNOWN					
CONTRIBUTING CIRCUMSTANCES					
1 - NONE 7 - LEFT OF CENTER 13 - IMPROPER START FROM A PARKED POSITION 17 - VISION OBSTRUCTION 21 - LYING IN ROADWAY 22 - NOT DISCERNIBLE 23 - OPENING DOOR INTO ROADWAY 99 - OTHER IMPROPER ACTION					
2 - FAILURE TO YIELD 8 - FOLLOWING TOO CLOSE / ACDA 14 - STOPPED OR PARKED ILLEGALLY 18 - OPERATING DEFECTIVE EQUIPMENT 22 - NOT DISCERNIBLE 23 - OPENING DOOR INTO ROADWAY 99 - OTHER IMPROPER ACTION					
3 - RAN RED LIGHT 9 - IMPROPER LANE CHANGE 15 - SWERVING TO AVOID 19 - LOAD SHIFTING/FALLING/ SPILLING 23 - OPENING DOOR INTO ROADWAY 99 - OTHER IMPROPER ACTION					
4 - RAN STOP SIGN 10 - IMPROPER PASSING 16 - WRONG WAY 20 - IMPROPER CROSSING					
5 - UNSAFE SPEED 11 - DROVE OFF ROAD					
6 - IMPROPER TURN 12 - IMPROPER BACKING					
SEQUENCE OF EVENTS					
1 2 0 1 - OVERTURN/ROLLOVER 6 - EQUIPMENT FAILURE 11 - CROSS CENTERLINE - OPPOSITE DIRECTION OF TRAVEL 16 - RAILWAY VEHICLE 22 - WORK ZONE MAINTENANCE EQUIPMENT					
2 1 - FIRE/EXPLOSION 7 - SEPARATION OF UNITS 12 - DOWNHILL RUNAWAY 17 - ANIMAL - FARM 23 - STRUCK BY FALLING, SHIFTING CARGO OR ANYTHING SET IN MOTION BY A MOTOR VEHICLE 24 - OTHER MOVABLE OBJECT					
3 1 - IMMERSION 8 - RAN OFF ROAD RIGHT 13 - OTHER NON-COLLISION 18 - ANIMAL - DEER 20 - MOTOR VEHICLE IN TRANSPORT					
4 1 - JACKKNIFE 9 - RAN OFF ROAD LEFT 14 - PEDESTRIAN 19 - ANIMAL - OTHER 21 - PARKED MOTOR VEHICLE					
5 1 - CARGO / EQUIPMENT LOSS OR SHIFT 10 - CROSS MEDIAN 15 - PEDALCYCLE 22 - WORK ZONE MAINTENANCE EQUIPMENT					
6 1 - IMPACT ATTENUATOR / CRASH CUSHION 31 - GUARDRAIL END 37 - TRAFFIC SIGN POST 43 - CURB 50 - WORK ZONE MAINTENANCE EQUIPMENT					
7 1 - BRIDGE OVERHEAD STRUCTURE 32 - PORTABLE BARRIER 38 - OVERHEAD SIGN POST 44 - DITCH 51 - WALL					
8 1 - BRIDGE PIER OR ABUTMENT 33 - MEDIAN CABLE BARRIER 39 - LIGHT / LUMINARIES SUPPORT 45 - EMBANKMENT 52 - BUILDING					
9 1 - BRIDGE PARAPET 34 - MEDIAN GUARDRAIL BARRIER 40 - UTILITY POLE 46 - FENCE 53 - TUNNEL					
10 1 - BRIDGE RAIL 35 - MEDIAN CONCRETE BARRIER 41 - OTHER POST, POLE OR SUPPORT 47 - MAILBOX 54 - OTHER FIXED OBJECT					
11 1 - GUARDRAIL FACE 36 - MEDIAN OTHER BARRIER 42 - CULVERT 48 - TREE 55 - OTHER / UNKNOWN					
12 1 - GUARDRAIL FACE 36 - MEDIAN OTHER BARRIER 42 - CULVERT 48 - TREE 55 - OTHER / UNKNOWN					
13 1 - GUARDRAIL FACE 36 - MEDIAN OTHER BARRIER 42 - CULVERT 48 - TREE 55 - OTHER / UNKNOWN					
14 1 - GUARDRAIL FACE 36 - MEDIAN OTHER BARRIER 42 - CULVERT 48 - TREE 55 - OTHER / UNKNOWN					
15 1 - GUARDRAIL FACE 36 - MEDIAN OTHER BARRIER 42 - CULVERT 48 - TREE 55 - OTHER / UNKNOWN					
16 1 - GUARDRAIL FACE 36 - MEDIAN OTHER BARRIER 42 - CULVERT 48 - TREE 55 - OTHER / UNKNOWN					
17 1 - GUARDRAIL FACE 36 - MEDIAN OTHER BARRIER 42 - CULVERT 48 - TREE 55 - OTHER / UNKNOWN					
18 1 - GUARDRAIL FACE 36 - MEDIAN OTHER BARRIER 42 - CULVERT 48 - TREE 55 - OTHER / UNKNOWN					
19 1 - GUARDRAIL FACE 36 - MEDIAN OTHER BARRIER 42 - CULVERT 48 - TREE 55 - OTHER / UNKNOWN					
20 1 - GUARDRAIL FACE 36 - MEDIAN OTHER BARRIER 42 - CULVERT 48 - TREE 55 - OTHER / UNKNOWN					
21 1 - GUARDRAIL FACE 36 - MEDIAN OTHER BARRIER 42 - CULVERT 48 - TREE 55 - OTHER / UNKNOWN					
22 1 - GUARDRAIL FACE 36 - MEDIAN OTHER BARRIER 42 - CULVERT 48 - TREE 55 - OTHER / UNKNOWN					
23 1 - GUARDRAIL FACE 36 - MEDIAN OTHER BARRIER 42 - CULVERT 48 - TREE 55 - OTHER / UNKNOWN					
24 1 - GUARDRAIL FACE 36 - MEDIAN OTHER BARRIER 42 - CULVERT 48 - TREE 55 - OTHER / UNKNOWN					
25 1 - GUARDRAIL FACE 36 - MEDIAN OTHER BARRIER 42 - CULVERT 48 - TREE 55 - OTHER / UNKNOWN					
26 1 - GUARDRAIL FACE 36 - MEDIAN OTHER BARRIER 42 - CULVERT 48 - TREE 55 - OTHER / UNKNOWN					
27 1 - GUARDRAIL FACE 36 - MEDIAN OTHER BARRIER 42 - CULVERT 48 - TREE 55 - OTHER / UNKNOWN					
28 1 - GUARDRAIL FACE 36 - MEDIAN OTHER BARRIER 42 - CULVERT 48 - TREE 55 - OTHER / UNKNOWN					
29 1 - GUARDRAIL FACE 36 - MEDIAN OTHER BARRIER 42 - CULVERT 48 - TREE 55 - OTHER / UNKNOWN					
30 1 - GUARDRAIL FACE 36 - MEDIAN OTHER BARRIER 42 - CULVERT 48 - TREE 55 - OTHER / UNKNOWN					
31 1 - GUARDRAIL FACE 36 - MEDIAN OTHER BARRIER 42 - CULVERT 48 - TREE 55 - OTHER / UNKNOWN					
32 1 - GUARDRAIL FACE 36 - MEDIAN OTHER BARRIER 42 - CULVERT 48 - TREE 55 - OTHER / UNKNOWN					
33 1 - GUARDRAIL FACE 36 - MEDIAN OTHER BARRIER 42 - CULVERT 48 - TREE 55 - OTHER / UNKNOWN					
34 1 - GUARDRAIL FACE 36 - MEDIAN OTHER BARRIER 42 - CULVERT 48 - TREE 55 - OTHER / UNKNOWN					
35 1 - GUARDRAIL FACE 36 - MEDIAN OTHER BARRIER 42 - CULVERT 48 - TREE 55 - OTHER / UNKNOWN					
36 1 - GUARDRAIL FACE 36 - MEDIAN OTHER BARRIER 42 - CULVERT 48 - TREE 55 - OTHER / UNKNOWN					
37 1 - GUARDRAIL FACE 36 - MEDIAN OTHER BARRIER 42 - CULVERT 48 - TREE 55 - OTHER / UNKNOWN					
38 1 - GUARDRAIL FACE 36 - MEDIAN OTHER BARRIER 42 - CULVERT 48 - TREE 55 - OTHER / UNKNOWN					
39 1 - GUARDRAIL FACE 36 - MEDIAN OTHER BARRIER 42 - CULVERT 48 - TREE 55 - OTHER / UNKNOWN					
40 1 - GUARDRAIL FACE 36 - MEDIAN OTHER BARRIER 42 - CULVERT 48 - TREE 55 - OTHER / UNKNOWN					
41 1 - GUARDRAIL FACE 36 - MEDIAN OTHER BARRIER 42 - CULVERT 48 - TREE 55 - OTHER / UNKNOWN					
42 1 - GUARDRAIL FACE 36 - MEDIAN OTHER BARRIER 42 - CULVERT 48 - TREE 55 - OTHER / UNKNOWN					
43 1 - GUARDRAIL FACE 36 - MEDIAN OTHER BARRIER 42 - CULVERT 48 - TREE 55 - OTHER / UNKNOWN					
44 1 - GUARDRAIL FACE 36 - MEDIAN OTHER BARRIER 42 - CULVERT 48 - TREE 55 - OTHER / UNKNOWN					
45 1 - GUARDRAIL FACE 36 - MEDIAN OTHER BARRIER 42 - CULVERT 48 - TREE 55 - OTHER / UNKNOWN					
46 1 - GUARDRAIL FACE 36 - MEDIAN OTHER BARRIER 42 - CULVERT 48 - TREE 55 - OTHER / UNKNOWN					
47 1 - GUARDRAIL FACE 36 - MEDIAN OTHER BARRIER 42 - CULVERT 48 - TREE 55 - OTHER / UNKNOWN					
48 1 - GUARDRAIL FACE 36 - MEDIAN OTHER BARRIER 42 - CULVERT 48 - TREE 55 - OTHER / UNKNOWN					
49 1 - GUARDRAIL FACE 36 - MEDIAN OTHER BARRIER 42 - CULVERT 48 - TREE 55 - OTHER / UNKNOWN					
50 1 - GUARDRAIL FACE 36 - MEDIAN OTHER BARRIER 42 - CULVERT 48 - TREE 55 - OTHER / UNKNOWN					
51 1 - GUARDRAIL FACE 36 - MEDIAN OTHER BARRIER 42 - CULVERT 48 - TREE 55 - OTHER / UNKNOWN					
52 1 - GUARDRAIL FACE 36 - MEDIAN OTHER BARRIER 42 - CULVERT 48 - TREE 55 - OTHER / UNKNOWN					
53 1 - GUARDRAIL FACE 36 - MEDIAN OTHER BARRIER 42 - CULVERT 48 - TREE 55 - OTHER / UNKNOWN					
54 1 - GUARDRAIL FACE 36 - MEDIAN OTHER BARRIER 42 - CULVERT 48 - TREE 55 - OTHER / UNKNOWN					
55 1 - GUARDRAIL FACE 36 - MEDIAN OTHER BARRIER 42 - CULVERT 48 - TREE 55 - OTHER / UNKNOWN					
56 1 - GUARDRAIL FACE 36 - MEDIAN OTHER BARRIER 42 - CULVERT 48 - TREE 55 - OTHER / UNKNOWN					
57 1 - GUARDRAIL FACE 36 - MEDIAN OTHER BARRIER 42 - CULVERT 48 - TREE 55 - OTHER / UNKNOWN					
58 1 - GUARDRAIL FACE 36 - MEDIAN OTHER BARRIER 42 - CULVERT 48 - TREE 55 - OTHER / UNKNOWN					
59 1 - GUARDRAIL FACE 36 - MEDIAN OTHER BARRIER 42 - CULVERT 48 - TREE 55 - OTHER / UNKNOWN					
60 1 - GUARDRAIL FACE 36 - MEDIAN OTHER BARRIER 42 - CULVERT 48 - TREE 55 - OTHER / UNKNOWN					
61 1 - GUARDRAIL FACE 36 - MEDIAN OTHER BARRIER 42 - CULVERT 48 - TREE 55 - OTHER / UNKNOWN					
62 1 - GUARDRAIL FACE 36 - MEDIAN OTHER BARRIER 42 - CULVERT 48 - TREE 55 - OTHER / UNKNOWN					
63 1 - GUARDRAIL FACE 36 - MEDIAN OTHER BARRIER 42 - CULVERT 48 - TREE 55 - OTHER / UNKNOWN					
64 1 - GUARDRAIL FACE 36 - MEDIAN OTHER BARRIER 42 - CULVERT 48 - TREE 55 - OTHER / UNKNOWN					
65 1 - GUARDRAIL FACE 36 - MEDIAN OTHER BARRIER 42 - CULVERT 48 - TREE 55 - OTHER / UNKNOWN					
66 1 - GUARDRAIL FACE 36 - MEDIAN OTHER BARRIER 42 - CULVERT 48 - TREE 55 - OTHER / UNKNOWN					
67 1 - GUARDRAIL FACE 36 - MEDIAN OTHER BARRIER 42 - CULVERT 48 - TREE 55 - OTHER / UNKNOWN					
68 1 - GUARDRAIL FACE 36 - MEDIAN OTHER BARRIER 42 - CULVERT 48 - TREE 55 - OTHER / UNKNOWN					
69 1 - GUARDRAIL FACE 36 - MEDIAN OTHER BARRIER 42 - CULVERT 48 - TREE 55 - OTHER / UNKNOWN					
70 1 - GUARDRAIL FACE 36 - MEDIAN OTHER BARRIER 42 - CULVERT 48 - TREE 55 - OTHER / UNKNOWN					
71 1 - GUARDRAIL FACE 36 - MEDIAN OTHER BARRIER 42 - CULVERT 48 - TREE 55 - OTHER / UNKNOWN					
72 1 - GUARDRAIL FACE 36 - MEDIAN OTHER BARRIER 42 - CULVERT 48 - TREE 55 - OTHER / UNKNOWN					
73 1 - GUARDRAIL FACE 36 - MEDIAN OTHER BARRIER 42 - CULVERT 48 - TREE 55 - OTHER / UNKNOWN					
74 1 - GUARDRAIL FACE 36 - MEDIAN OTHER BARRIER 42 - CULVERT 48 - TREE 55 - OTHER / UNKNOWN					
75 1 - GUARDRAIL FACE 36 - MEDIAN OTHER BARRIER 42 - CULVERT 48 - TREE 55 - OTHER / UNKNOWN					
76 1 - GUARDRAIL FACE 36 - MEDIAN OTHER BARRIER 42 - CULVERT 48 - TREE 55 - OTHER / UNKNOWN					
77 1 - GUARDRAIL FACE 36 - MEDIAN OTHER BARRIER 42 - CULVERT 48 - TREE 55 - OTHER / UNKNOWN					
78 1 - GUARDRAIL FACE 36 - MEDIAN OTHER BARRIER 42 - CULVERT 48 - TREE 55 - OTHER / UNKNOWN					
79 1 - GUARDRAIL FACE 36 - MEDIAN OTHER BARRIER 42 - CULVERT 48 - TREE 55 - OTHER / UNKNOWN					
80 1 - GUARDRAIL FACE 36 - MEDIAN OTHER BARRIER 42 - CULVERT 48 - TREE 55 - OTHER / UNKNOWN					
81 1 - GUARDRAIL FACE 36 - MEDIAN OTHER BARRIER 42 - CULVERT 48 - TREE 55 - OTHER / UNKNOWN					
82 1 - GUARDRAIL FACE 36 - MEDIAN OTHER BARRIER 42 - CULVERT 48 - TREE 55 - OTHER / UNKNOWN					
83 1 - GUARDRAIL FACE 36 - MEDIAN OTHER BARRIER 42 - CULVERT 48 - TREE 55 - OTHER / UNKNOWN					
84 1 - GUARDRAIL FACE 36 - MEDIAN OTHER BARRIER 42 - CULVERT 48 - TREE 55 - OTHER / UNKNOWN					
85 1 - GUARDRAIL FACE 36 - MEDIAN OTHER BARRIER 42 - CULVERT 48 - TREE 55 - OTHER / UNKNOWN					
86 1 - GUARDRAIL FACE 36 - MEDIAN OTHER BARRIER 42 - CULVERT 48 - TREE 55 - OTHER / UNKNOWN					
87 1 - GUARDRAIL FACE 36 - MEDIAN OTHER BARRIER 42 - CULVERT 48 - TREE 55 - OTHER / UNKNOWN					
88 1 - GUARDRAIL FACE 36 - MEDIAN OTHER BARRIER 42 - CULVERT 48 - TREE 55 - OTHER / UNKNOWN					
89 1 - GUARDRAIL FACE 36 - MEDIAN OTHER BARRIER 42 - CULVERT 48 - TREE 55 - OTHER / UNKNOWN					
90 1 - GUARDRAIL FACE 36 - MEDIAN OTHER BARRIER 42 - CULVERT 48 - TREE 55 - OTHER / UNKNOWN					
91 1 - GUARDRAIL FACE 36 - MEDIAN OTHER BARRIER 42 - CULVERT 48 - TREE 55 - OTHER / UNKNOWN					
92 1 - GUARDRAIL FACE 36 - MEDIAN OTHER BARRIER 42 - CULVERT 48 - TREE 55 - OTHER / UNKNOWN					
93 1 - GUARDRAIL FACE 36 - MEDIAN OTHER BARRIER 42 - CULVERT 48 - TREE 55 - OTHER / UNKNOWN					
94 1 - GUARDRAIL FACE 36 - MEDIAN OTHER BARRIER 42 - CULVERT 48 - TREE 55 - OTHER / UNKNOWN					
95 1 - GUARDRAIL FACE 36 - MEDIAN OTHER BARRIER 42 - CULVERT 48 - TREE 55 - OTHER / UNKNOWN					
96 1 - GUARDRAIL FACE 36 - MEDIAN OTHER BARRIER 42 - CULVERT 48 - TREE 55 - OTHER / UNKNOWN					
97 1 - GUARDRAIL FACE 36 - MEDIAN OTHER BARRIER 42 - CULVERT 48 - TREE 55 - OTHER / UNKNOWN					
98 1 - GUARDRAIL FACE 36 - MEDIAN OTHER BARRIER 42 - CULVERT 48 - TREE 55 - OTHER / UNKNOWN					
99 1 - GUARDRAIL FACE 36 - MEDIAN OTHER BARRIER 42 - CULVERT 48 - TREE 55 - OTHER / UNKNOWN					
100 1 - GUARDRAIL FACE 36 - MEDIAN OTHER BARRIER 42 - CULVERT 48 - TREE 55 - OTHER / UNKNOWN					
101 1 - GUARDRAIL FACE 36 - MEDIAN OTHER BARRIER 42 - CULVERT 48 - TREE 55 - OTHER / UNKNOWN					
102 1 - GUARDRAIL FACE 36 - MEDIAN OTHER BARRIER 42 - CULVERT 48 - TREE 55 - OTHER / UNKNOWN					
103 1 - GUARDRAIL FACE 36 - MEDIAN OTHER BARRIER 42 - CULVERT 48 - TREE 55 - OTHER / UNKNOWN					
104 1 - GUARDRAIL FACE 36 - MEDIAN OTHER BARRIER 42 - CULVERT 48 - TREE 55 - OTHER / UNKNOWN					
105 1 - GUARDRAIL FACE 36 - MEDIAN OTHER BARRIER 42 - CULVERT 48 - TREE 55 - OTHER / UNKNOWN					
106 1 - GUARDRAIL FACE 36 - MEDIAN OTHER BARRIER 42 - CULVERT 48 - TREE 55 - OTHER / UNKNOWN					
107 1 - GUARDRAIL FACE 36 - MEDIAN OTHER BARRIER 42 - CULVERT 48 - TREE 55 - OTHER / UNKNOWN					
108 1 - GUARDRAIL FACE 36 - MEDIAN OTHER BARRIER 42 - CULVERT 48 - TREE 55 - OTHER / UNKNOWN					
109 1 - GUARDRAIL FACE 36 - MEDIAN OTHER BARRIER 42 - CULVERT 48 - TREE 55 - OTHER / UNKNOWN					
110 1 - GUARDRAIL FACE 36 - MEDIAN OTHER BARRIER 42 - CULVERT 48 - TREE 55 - OTHER / UNKNOWN					
111 1 - GUARDRAIL FACE 36 - MEDIAN OTHER BARRIER 42 - CULVERT 48 - TREE 55 - OTHER / UNKNOWN					
112 1 - GUARDRAIL FACE 36 - MEDIAN OTHER BARRIER 42 - CULVERT 48 - TREE 55 - OTHER / UNKNOWN					
113 1 - GUARDRAIL FACE 36 - MEDIAN OTHER BARRIER 42 - CULVERT 48 - TREE 55 - OTHER / UNKNOWN					
114 1 - GUARDRAIL FACE 36 - MEDIAN OTHER BARRIER 42 - CULVERT 48 - TREE 55 - OTHER / UNKNOWN					
115 1 - GUARDRAIL FACE 36 - MEDIAN OTHER BARRIER 42 - CULVERT 48 - TREE 55 - OTHER / UNKNOWN					
116 1 - GUARDRAIL FACE 36 - MEDIAN OTHER BARRIER 42 - CULVERT 48 - TREE 55 - OTHER / UNKNOWN					
117 1 - GUARDRAIL FACE 36 - MEDIAN OTHER BARRIER 42 - CULVERT 48 - TREE 55 - OTHER / UNKNOWN					
118 1 - GUARDRAIL FACE 36 - MEDIAN OTHER BARRIER 42 - CULVERT 48 - TREE 55 - OTHER / UNKNOWN					
119 1 - GUARDRAIL FACE 36 - MEDIAN OTHER BARRIER 42 - CULVERT 48 - TREE 55 - OTHER / UNKNOWN					
120 1 - GUARDRAIL FACE 36 - MEDIAN OTHER BARRIER 42 - CULVERT 48 - TREE 55 - OTHER / UNKNOWN					
121 1 - GUARDRAIL FACE 36 - MEDIAN OTHER BARRIER 42 - CULVERT 48 - TREE 55 - OTHER / UNKNOWN					
122 1 - GUARDRAIL FACE 36 - MEDIAN OTHER BARRIER 42 - CULVERT 48 - TREE 55 - OTHER / UNKNOWN					
123 1 - GUARDRAIL FACE 36 - MEDIAN OTHER BARRIER 42 - CULVERT 48 - TREE 55 - OTHER / UNKNOWN					
124 1 - GUARDRAIL FACE 36 - MEDIAN OTHER BARRIER 42 - CULVERT 48 - TREE 55 - OTHER / UNKNOWN					
125 1 - GUARDRAIL FACE 36 - MEDIAN OTHER BARRIER 42 - CULVERT 48 - TREE 55 - OTHER / UNKNOWN					
126 1 - GUARDRAIL FACE 36 - MEDIAN OTHER BARRIER 42 - CULVERT 48 - TREE 55 - OTHER / UNKNOWN					
127 1 - GUARDRAIL FACE 36 - MEDIAN OTHER BARRIER 42 - CULVERT 48 - TREE 55 - OTHER / UNKNOWN					
128 1 - GUARDRAIL FACE 36 - MEDIAN OTHER BARRIER 42 - CULVERT 48 - TREE 55 - OTHER / UNKNOWN					
129 1 - GUARDRAIL FACE 36 - MEDIAN OTHER BARRIER 42 - CULVERT 48 - TREE 55 - OTHER / UNKNOWN					
130 1 - GUARDRAIL FACE 36 - MEDIAN OTHER BARRIER 42 - CULVERT 48 - TREE 55 - OTHER / UNKNOWN					
131 1 - GUARDRAIL FACE 36 - MEDIAN OTHER BARRIER 42 - CULVERT 48 - TREE 55 - OTHER / UNKNOWN					
132 1 - GUARDRAIL FACE 36 - MEDIAN OTHER BARRIER 42 - CULVERT 48 - TREE 55 - OTHER / UNKNOWN					
133 1 - GUARDRAIL FACE 36 - MEDIAN OTHER BARRIER 42 - CULVERT 48 - TREE 55 - OTHER / UNKNOWN					
134 1 - GUARDRAIL FACE 36 - MEDIAN OTHER BARRIER 42 - CULVERT 48 - TREE 55 - OTHER / UNKNOWN					
135 1 - GUARDRAIL FACE 36 - MEDIAN OTHER BARRIER 42 - CULVERT 48 - TREE 55 - OTHER / UNKNOWN					
136 1 - GUARDRAIL FACE 36 - MEDIAN OTHER BARRIER 42 - CULVERT 48 - TREE 55 - OTHER / UNKNOWN					
137 1 - GUARDRAIL FACE 36 - MEDIAN OTHER BARRIER 42 - CULVERT 48 - TREE 55 - OTHER / UNKNOWN					
138 1 - GUARDRAIL FACE 36 - MEDIAN OTHER BARRIER 42 - CULVERT 48 - TREE 55 - OTHER / UNKNOWN					
139 1 - GUARDRAIL FACE 36 - MEDIAN OTHER BARRIER 42 - CULVERT 48 - TREE 55 - OTHER / UNKNOWN					
140 1 - GUARDRAIL FACE 36 - MEDIAN OTHER BARRIER 42 - CULVERT 48 - TREE 55 - OTHER / UNKNOWN					
141 1 - GUARDRAIL FACE 36 - MEDIAN OTHER BARRIER 42 - CULVERT 48 - TREE 55 - OTHER / UNKNOWN					
142 1 - GUARDRAIL FACE 36 - MEDIAN OTHER BARRIER 42 - CULVERT 48 - TREE 55 - OTHER / UNKNOWN					
143 1 - GUARDRAIL FACE 36 - MEDIAN OTHER BARRIER 42 - CULVERT 48 - TREE 55 - OTHER / UNKNOWN					
144 1 - GUARDRAIL FACE 36 - MEDIAN OTHER BARRIER 42 - CULVERT 48 - TREE 55 - OTHER / UNKNOWN					
145 1 - GUARDRAIL FACE 36 - MEDIAN OTHER BARRIER 42 - CULVERT 48 - TREE 55 - OTHER / UNKNOWN					
146 1 - GUARDRAIL FACE 36 - MEDIAN OTHER BARRIER 42 - CULVERT 48 - TREE 55 - OTHER / UNKNOWN					
147 1 - GUARDRAIL FACE 36 - MEDIAN OTHER BARRIER 42 - CULVERT 48 - TREE 55 - OTHER / UNKNOWN					
148 1 - GUARDRAIL FACE 36 - MEDIAN OTHER BARRIER 42 - CULVERT 48 - TREE 55 - OTHER / UNKNOWN					
149 1 - GUARDRAIL FACE 36 - MEDIAN OTHER BARRIER 42 - CULVERT 48 - TREE 55 - OTHER / UNKNOWN					
150 1 - GUARDRAIL FACE 36 - MEDIAN OTHER BARRIER 42 - CULVERT 48 - TREE 55 - OTHER / UNKNOWN					
151 1 - GUARDRAIL FACE 36 - MEDIAN OTHER BARRIER 42 - CULVERT 48 - TREE 55 - OTHER / UNKNOWN					
152 1 - GUARDRAIL FACE 36 - MEDIAN OTHER BARRIER 42 - CULVERT 48 - TREE 55 - OTHER / UNKNOWN					
153 1 - GUARDRAIL FACE 36 - MEDIAN OTHER BARRIER 42 - CULVERT 48 - TREE 55 - OTHER / UNKNOWN					
154 1 - GUARDRAIL FACE 36 - MEDIAN OTHER BARRIER 42 - CULVERT 48 - TREE 55 - OTHER / UNKNOWN					
155 1 - GUARDRAIL FACE 36 - MEDIAN OTHER BARRIER 42 - CULVERT 48 - TREE 55 - OTHER / UNKNOWN					
156 1 - GUARDRAIL FACE 36 - MEDIAN OTHER BARRIER 42 - CULVERT 48 - TREE 55 - OTHER / UNKNOWN					
157 1 - GUARDRAIL FACE 36 - MEDIAN OTHER BARRIER 42 - CULVERT 48 - TREE 55 - OTHER / UNKNOWN					
158 1 - GUARDRAIL FACE 36 - MEDIAN OTHER BARRIER 42 - CULVERT 48 - TREE 55 - OTHER / UNKNOWN					
159 1 - GUARDRAIL FACE 36 - MEDIAN OTHER BARRIER 42 - CULVERT 48 - TREE 55 - OTHER / UNKNOWN					
160 1 - GUARDRAIL FACE 36 - MEDIAN OTHER BARRIER 42 - CULVERT 48 - TREE 55 - OTHER / UNKNOWN					
161 1 - GUARDRAIL FACE 36 - MEDIAN OTHER BARRIER 42 - CULVERT 48 - TREE 55 - OTHER / UNKNOWN					
162 1 - GUARDRAIL FACE 36 - MEDIAN OTHER BARRIER 42 - CULVERT 48 - TREE 55 - OTHER / UNKNOWN					
163 1 - GUARDRAIL FACE 36 - MEDIAN OTHER BARRIER 42 - CULVERT 48 - TREE 55 - OTHER / UNKNOWN					
164 1 - GUARDRAIL FACE 36 - MEDIAN OTHER BARRIER 42 - CULVERT 48 - TREE 55 - OTHER / UNKNOWN					
165 1 - GUARDRAIL FACE 36 - MEDIAN OTHER BARRIER 42 - CULVERT 48 - TREE 55 - OTHER / UNKNOWN					
166 1 - GUARDRAIL FACE 36 - MEDIAN OTHER BARRIER 42 - CULVERT 48 - TREE 55 - OTHER / UNKNOWN					
167 1 - GUARDRAIL FACE 36 - MEDIAN OTHER BARRIER 42 - CULVERT 48 - TREE 55 - OTHER / UNKNOWN					
168 1 - GUARDRAIL FACE 36 - MEDIAN OTHER BARRIER 42 - CULVERT 48 - TREE 55 - OTHER / UNKNOWN					
169 1 - GUARDRAIL FACE 36 - MEDIAN OTHER BARRIER 42 - CULVERT 48 - TREE 55 - OTHER / UNKNOWN					
170 1 - GUARDRAIL FACE 36 - MEDIAN OTHER BARRIER 42 - CULVERT 48 - TREE 55 - OTHER / UNKNOWN					
171 1 - GUARDRAIL FACE 36 - MEDIAN OTHER BARRIER 42 - CULVERT 48 - TREE 55 - OTHER / UNKNOWN					
172 1 - GUARDRAIL FACE 36 - MEDIAN OTHER BARRIER 42 - CULVERT 48 - TREE 55 - OTHER / UNKNOWN					
173 1 - GUARDRAIL FACE 36 - MEDIAN OTHER BARRIER 42 - CULVERT 48 - TREE 55 - OTHER / UNKNOWN					
174 1 - GUARDRAIL FACE 36 - MEDIAN OTHER BARRIER 42 - CULVERT 48 - TREE 55 - OTHER / UNKNOWN					
175 1 - GUARDRAIL FACE 36 - MEDIAN OTHER BARRIER 42 - CULVERT 48 - TREE 55 - OTHER / UNKNOWN					
176 1 - GUARDRAIL FACE 36 - MEDIAN OTHER BARRIER 42 - CULVERT 48 - TREE					

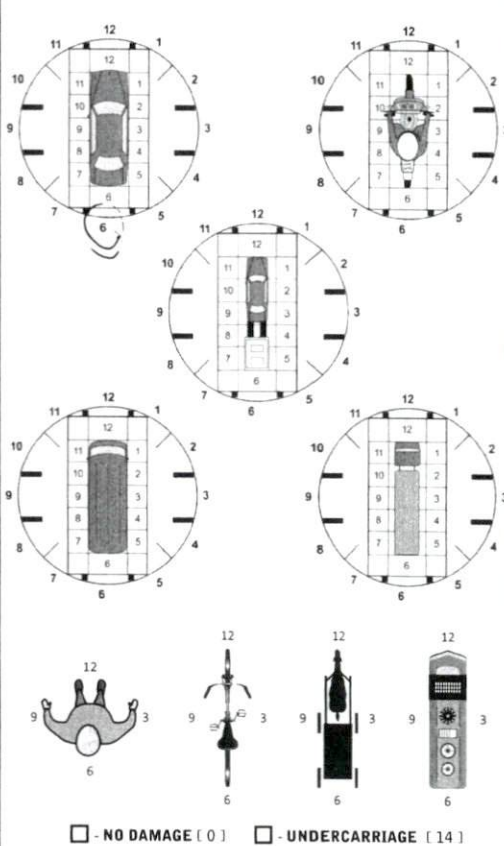

OWNER	UNIT # 02	OWNER NAME: LAST, FIRST, MIDDLE (X SAME AS DRIVER)	OWNER PHONE: INCLUDE AREA CODE (X SAME AS DRIVER)		
	OWNER ADDRESS: STREET, CITY, STATE, ZIP (X SAME AS DRIVER)				
COMMERCIAL CARRIER: NAME, ADDRESS, CITY, STATE, ZIP		COMMERCIAL CARRIER PHONE: INCLUDE AREA CODE			
VEHICLE	LP STATE OH	LICENSE PLATE # FKH3496	VEHICLE IDENTIFICATION # 4T1B11HK9JU505526	VEHICLE YEAR 2018	VEHICLE MAKE TOYOTA
	<input checked="" type="checkbox"/> INSURANCE VERIFIED	INSURANCE COMPANY PROGRESSIVE	INSURANCE POLICY # 942862019	COLOR BLUE	VEHICLE MODEL CAMRY
	<input type="checkbox"/> COMMERCIAL	TYPE OF USE <input type="checkbox"/> GOVERNMENT <input type="checkbox"/> IN EMERGENCY RESPONSE	US DOT #	TOWED BY: COMPANY NAME MARCELL'S	
	<input type="checkbox"/> INTERLOCK DEVICE EQUIPPED	<input type="checkbox"/> HIT/SKIP UNIT	#OCCUPANTS 01	HAZARDOUS MATERIAL <input type="checkbox"/> MATERIAL RELEASED <input type="checkbox"/> PLACARD	
	VEHICLE WEIGHT GVWR/GCWR 1 - <10K LBS. 2 - 10,001 - 26K LBS. 3 - >26K LBS.				
	UNIT TYPE 01				
	# OF TRAILING UNITS 00				
	WAS VEHICLE OPERATING IN AUTONOMOUS MODE WHEN CRASH OCCURRED? 0 - NO AUTOMATION 1 - DRIVER ASSISTANCE 2 - PARTIAL AUTOMATION 3 - CONDITIONAL AUTOMATION 4 - HIGH AUTOMATION 5 - FULL AUTOMATION 9 - UNKNOWN				
	SPECIAL FUNCTION 01				
	CARGO BODY TYPE 01				
VEHICLE DEFECTS					
NON-MOTORIST LOCATION AT IMPACT					
ACTION 04					
CONTRIBUTING CIRCUMSTANCES 01					
SEQUENCE OF EVENTS					
FIRST HARMFUL EVENT 1		MOST HARMFUL EVENT 1			

LOCAL REPORT NUMBER 22012614	
DAMAGE	
DAMAGE SCALE 4 1 - NONE 3 - FUNCTIONAL DAMAGE 2 - MINOR DAMAGE 4 - DISABLING DAMAGE 9 - UNKNOWN	
DAMAGED AREA(S) INDICATE ALL THAT APPLY	
	
<input type="checkbox"/> - NO DAMAGE [0] <input type="checkbox"/> - UNDERCARRIAGE [14] <input type="checkbox"/> - TOP [13] <input type="checkbox"/> - ALL AREAS [15] <input type="checkbox"/> - UNIT NOT AT SCENE [16]	
INITIAL POINT OF CONTACT 0 - NO DAMAGE 14 - UNDERCARRIAGE 1-12 - REFER TO UNIT DIAGRAM 15 - VEHICLE NOT AT SCENE 99 - UNKNOWN 13 - TOP	
TRAFFIC	
TRAFFICWAY FLOW 2 1 - ONE-WAY 2 2 - TWO-WAY	TRAFFIC CONTROL 6 1 - ROUNDABOUT 4 - STOP SIGN 2 - SIGNAL 5 - YIELD SIGN 3 - FLASHER 6 - NO CONTROL
# OF THROUGH LANES ON ROAD 2	RAIL GRADE CROSSING 1 1 - NOT INVOLVED 2 - INVOLVED-ACTIVE CROSSING 3 - INVOLVED-PASSIVE CROSSING
UNIT / NON-MOTORIST DIRECTION FROM 1 TO 2	
UNIT SPEED 00	DETECTED SPEED 1 1 - STATED / ESTIMATED SPEED 2 - CALCULATED / EDR 3 - UNDETERMINED
POSTED SPEED 35	



# MOTORIST / Non-MOTORIST

LOCAL REPORT NUMBER  
2 2 0 1 2 6 1 4

MOTORIST / NON-MOTORIST	UNIT # 0 1	NAME: LAST, FIRST, MIDDLE HILL, ELRACIO F	DATE OF BIRTH 0 2 2 3 1 9 8 5		AGE 3 6	GENDER M							
	ADDRESS: STREET, CITY, STATE, ZIP 8847 CABOT DR CINCINNATI OH 45231		CONTACT PHONE - INCLUDE AREA CODE										
	INJURIES 5	INJURED TAKEN BY	EMS AGENCY (NAME)	INJURED TAKEN TO: MEDICAL FACILITY (NAME, CITY)	SAFETY EQUIPMENT USED 0 4	<input type="checkbox"/> DOT-COMPLIANT MC HELMET	SEATING POSITION 0 1	AIR BAG USAGE 1	EJECTION 1	TRAPPED 1			
	OL STATE O H	OPERATOR LICENSE NUMBER		OFFENSE CHARGED 333.03A	LOCAL CODE <input checked="" type="checkbox"/>	OFFENSE DESCRIPTION ACDA		CITATION NUMBER 249624					
OL CLASS 4	ENDORSEMENT SELECT UP TO 2	RESTRICTION SELECT UP TO 3		DRIVER DISTRACTED BY 1	ALCOHOL / DRUG SUSPECTED <input type="checkbox"/> ALCOHOL <input type="checkbox"/> MARIJUANA <input type="checkbox"/> OTHER DRUG		CONDITION 01	ALCOHOL TEST STATUS TYPE VALUE 1 1 .		DRUG TEST(S) STATUS TYPE RESULT SELECT UP TO 4 1 1			
MOTORIST / NON-MOTORIST	UNIT # 0 2	NAME: LAST, FIRST, MIDDLE LESTER, PENNY A	DATE OF BIRTH 1 1 2 3 1 9 6 4		AGE 5 7	GENDER F							
	ADDRESS: STREET, CITY, STATE, ZIP 10568 MILL FARM CT CINCINNATI OH 45231		CONTACT PHONE - INCLUDE AREA CODE										
	INJURIES 3	INJURED TAKEN BY 2	EMS AGENCY (NAME) FAIRFIELD SQUAD	INJURED TAKEN TO: MEDICAL FACILITY (NAME, CITY) BETHESDA BUTLER	SAFETY EQUIPMENT USED 0 4	<input type="checkbox"/> DOT-COMPLIANT MC HELMET	SEATING POSITION 0 1	AIR BAG USAGE 1	EJECTION 1	TRAPPED 1			
	OL STATE O H	OPERATOR LICENSE NUMBER		OFFENSE CHARGED	LOCAL CODE <input type="checkbox"/>	OFFENSE DESCRIPTION		CITATION NUMBER					
OL CLASS 4	ENDORSEMENT SELECT UP TO 2	RESTRICTION SELECT UP TO 3		DRIVER DISTRACTED BY 1	ALCOHOL / DRUG SUSPECTED <input type="checkbox"/> ALCOHOL <input type="checkbox"/> MARIJUANA <input type="checkbox"/> OTHER DRUG		CONDITION 01	ALCOHOL TEST STATUS TYPE VALUE 1 1 .		DRUG TEST(S) STATUS TYPE RESULT SELECT UP TO 4 1 1			
MOTORIST / NON-MOTORIST	UNIT #	NAME: LAST, FIRST, MIDDLE	DATE OF BIRTH		AGE	GENDER							
	ADDRESS: STREET, CITY, STATE, ZIP		CONTACT PHONE - INCLUDE AREA CODE										
	INJURIES	INJURED TAKEN BY	EMS AGENCY (NAME)	INJURED TAKEN TO: MEDICAL FACILITY (NAME, CITY)	SAFETY EQUIPMENT USED	<input type="checkbox"/> DOT-COMPLIANT MC HELMET	SEATING POSITION	AIR BAG USAGE	EJECTION	TRAPPED			
	OL STATE	OPERATOR LICENSE NUMBER		OFFENSE CHARGED	LOCAL CODE <input type="checkbox"/>	OFFENSE DESCRIPTION		CITATION NUMBER					
OL CLASS	ENDORSEMENT SELECT UP TO 2	RESTRICTION SELECT UP TO 3		DRIVER DISTRACTED BY	ALCOHOL / DRUG SUSPECTED <input type="checkbox"/> ALCOHOL <input type="checkbox"/> MARIJUANA <input type="checkbox"/> OTHER DRUG		CONDITION	ALCOHOL TEST STATUS TYPE VALUE		DRUG TEST(S) STATUS TYPE RESULT SELECT UP TO 4			
INJURIES		SEATING POSITION		AIR BAG		OL CLASS		OL RESTRICTION(S)		DRIVER DISTRACTION		TEST STATUS	
1 - FATAL		1 - FRONT - LEFT SIDE (MOTORCYCLE DRIVER)		1 - NOT DEPLOYED		1 - CLASS A		1 - ALCOHOL INTERLOCK DEVICE		1 - NOT DISTRACTED		1 - NONE GIVEN	
2 - SUSPECTED SERIOUS INJURY		2 - FRONT - MIDDLE		2 - DEPLOYED FRONT		2 - CLASS B		2 - CDL INTRASTATE ONLY		2 - MANUALLY OPERATING AN ELECTRONIC COMMUNICATION DEVICE (TEXTING, TYPING, DIALING)		2 - TEST REFUSED	
3 - SUSPECTED MINOR INJURY		3 - FRONT - RIGHT SIDE		3 - DEPLOYED SIDE		3 - CLASS C		3 - CORRECTIVE LENSES		3 - TALKING ON HANDS-FREE COMMUNICATION DEVICE		3 - TEST GIVEN, CONTAMINATED SAMPLE / UNUSABLE	
4 - POSSIBLE INJURY		4 - SECOND - LEFT SIDE (MOTORCYCLE PASSENGER)		4 - DEPLOYED BOTH FRONT / SIDE		4 - REGULAR CLASS (OHIO = D)		4 - FARM WAIVER		4 - TALKING ON HAND-HELD COMMUNICATION DEVICE		4 - TEST GIVEN, RESULTS KNOWN	
5 - NO APPARENT INJURY		5 - SECOND - MIDDLE		5 - NOT APPLICABLE		5 - M/C MOPED ONLY		5 - EXCEPT CLASS A BUS		5 - OTHER ACTIVITY WITH AN ELECTRONIC DEVICE		5 - TEST GIVEN, RESULTS UNKNOWN	
INJURED TAKEN BY		6 - SECOND - RIGHT SIDE		9 - DEPLOYMENT UNKNOWN		6 - NO VALID OL		6 - EXCEPT CLASS A & CLASS B BUS		6 - PASSENGER		ALCOHOL TEST TYPE	
1 - NOT TRANSPORTED / TREATED AT SCENE		7 - THIRD - LEFT SIDE (MOTORCYCLE SIDE CAR)		EJECTION		H - HAZMAT		7 - EXCEPT TRACTOR-TRAILER		7 - OTHER DISTRACTION INSIDE THE VEHICLE		1 - NONE	
2 - EMS		8 - THIRD - MIDDLE		1 - NOT EJECTED		M - MOTORCYCLE		8 - INTERMEDIATE LICENSE RESTRICTIONS		8 - OTHER DISTRACTION OUTSIDE THE VEHICLE		2 - BLOOD	
3 - POLICE		9 - THIRD - RIGHT SIDE		2 - PARTIALLY EJECTED		P - PASSENGER		9 - LEARNER'S PERMIT RESTRICTIONS		9 - OTHER / UNKNOWN		3 - URINE	
9 - OTHER / UNKNOWN		10 - SLEEPER SECTION OF TRUCK CAB		3 - TOTALLY EJECTED		N - TANKER		10 - LIMITED TO DAYLIGHT ONLY		10 - LIMITED TO EMPLOYMENT		4 - BREATH	
SAFETY EQUIPMENT		11 - PASSENGER IN OTHER ENCLOSED CARGO AREA (NON-TRAILING UNIT, BUS, PICK-UP WITH CAP)		4 - NOT APPLICABLE		Q - MOTOR SCOOTER		11 - LIMITED - OTHER		12 - LIMITED - OTHER		5 - OTHER	
1 - NONE USED		12 - PASSENGER IN UNENCLOSED CARGO AREA		TRAPPED		R - THREE-WHEEL MOTORCYCLE		12 - MECHANICAL DEVICES (SPECIAL BRAKES, HAND CONTROLS, OR OTHER ADAPTIVE DEVICES)		13 - MOTOR VEHICLES WITHOUT AIR BRAKES		DRUG TEST TYPE	
2 - SHOULDER BELT ONLY USED		13 - TRAILING UNIT		1 - NOT TRAPPED		S - SCHOOL BUS		14 - MILITARY VEHICLES ONLY		1 - APPARENTLY NORMAL		1 - NONE	
3 - LAP BELT ONLY USED		14 - RIDING ON VEHICLE EXTERIOR (NON-TRAILING UNIT)		2 - EXTRICATED BY MECHANICAL MEANS		T - DOUBLE & TRIPLE TRAILERS		15 - OUTSIDE MIRROR		2 - PHYSICAL IMPAIRMENT		2 - BLOOD	
4 - SHOULDER & LAP BELT USED		15 - NON-MOTORIST		3 - FREED BY NON-MECHANICAL MEANS		X - TANKER / HAZMAT		17 - PROSTHETIC AID		3 - EMOTIONAL (E.G. DEPRESSED, ANGRY, DISTURBED)		3 - URINE	
5 - CHILD RESTRAINT SYSTEM - FORWARD FACING		99 - OTHER / UNKNOWN		GENDER		F - FEMALE		18 - OTHER		4 - ILLNESS		4 - OTHER	
6 - CHILD RESTRAINT SYSTEM - REAR FACING				M - MALE						5 - FELL ASLEEP, FAINTED, FATIGUED, ETC.		DRUG TEST RESULT(S)	
7 - BOOSTER SEAT				U - OTHER / UNKNOWN						6 - UNDER THE INFLUENCE OF MEDICATIONS / DRUGS / ALCOHOL		1 - AMPHETAMINES	
8 - HELMET USED										9 - OTHER / UNKNOWN		2 - BARBITURATES	
9 - PROTECTIVE PADS USED (ELBOW, KNEES, ETC.)												3 - BENZODIAZEPINES	
10 - REFLECTIVE CLOTHING												4 - CANNABINOIDS	
11 - LIGHTING - PEDESTRIAN / BICYCLE ONLY												5 - COCAINE	
99 - OTHER / UNKNOWN												6 - OPIATES / OPIOIDS	
												7 - OTHER	
												8 - NEGATIVE RESULTS	



IN COUNTY OF

BUTLER

ACCIDENT  
LOCATION

US 127 (PLEASANT AVE) - 20 FT NORTH OF EMERALD LAKE DRIVE

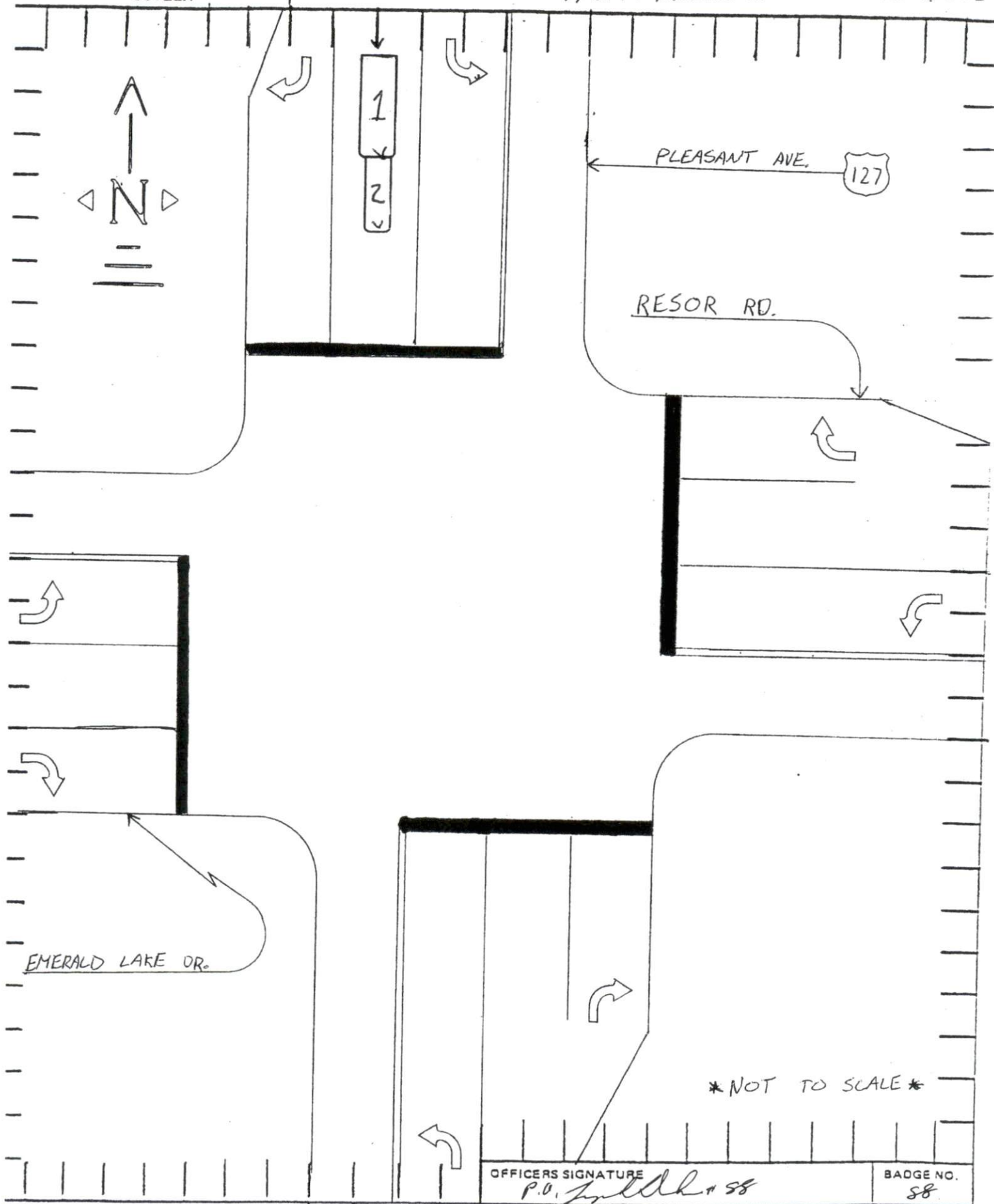

OFFICERS SIGNATURE

P.O. *[Signature]* # 58

BADGE NO.

58