



TRAFFIC CRASH REPORT

*DENOTES MANDATORY FIELD FOR SUPPLEMENT REPORT

LOCAL REPORT NUMBER*

<input checked="" type="checkbox"/> PHOTOS TAKEN <input type="checkbox"/> SECONDARY CRASH		<input checked="" type="checkbox"/> OH-2 <input type="checkbox"/> OH-1P <input type="checkbox"/> PRIVATE PROPERTY	LOCAL INFORMATION		2 2 0 5 1 3 5 3			
REPORTING AGENCY NAME* Fairfield Police Department		NCIC* 0 0 9 0 1		HIT/SKIP 1 - SOLVED 2 - UNSOLVED	NUMBER OF UNITS 0 2	UNIT IN ERROR 98 - ANIMAL 99 - UNKNOWN 0 1		
COUNTY* 0 9	LOCALITY* 1 - CITY 2 - VILLAGE 3 - TOWNSHIP 1	LOCATION: CITY, VILLAGE, TOWNSHIP* City of Fairfield		CRASH DATE / TIME* 0 7 1 8 2 0 2 2 1 6 4 7		CRASH SEVERITY 1 - FATAL 2 - SERIOUS INJURY SUSPECTED 3 - MINOR INJURY SUSPECTED 4 - INJURY POSSIBLE 5 - PROPERTY DAMAGE ONLY 5		
ROUTE TYPE 1 - NORTH 2 - SOUTH 3 - EAST 4 - WEST	ROUTE NUMBER	PREFIX	LOCATION ROAD NAME SEWARD	ROAD TYPE R D	LATITUDE DECIMAL DEGREES 3 9 . 3 4 0 9 3 8	CRASH SEVERITY 1 - FATAL 2 - SERIOUS INJURY SUSPECTED 3 - MINOR INJURY SUSPECTED 4 - INJURY POSSIBLE 5 - PROPERTY DAMAGE ONLY		
ROUTE TYPE 1 - NORTH 2 - SOUTH 3 - EAST 4 - WEST	ROUTE NUMBER	PREFIX	REFERENCE ROAD NAME (ROAD, MILEPOST, HOUSE #) UNION CENTRE	ROAD TYPE B L	LONGITUDE DECIMAL DEGREES - 8 4 . 4 9 1 8 0 6			
REFERENCE POINT 1 - INTERSECTION 2 - MILE POST 3 - HOUSE # 1	DIRECTION FROM REFERENCE 1 - NORTH 2 - SOUTH 3 - EAST 4 - WEST 3	ROUTE TYPE IR - INTERSTATE ROUTE(TP) US - FEDERAL US ROUTE SR - STATE ROUTE CR - NUMBERED COUNTY ROUTE TR - NUMBERED TOWNSHIP ROUTE	ROAD TYPE AL - ALLEY AV - AVENUE BL - BOULEVARD CR - CIRCLE CT - COURT DR - DRIVE HE - HEIGHTS PL - PLACE	ROAD TYPE HW - HIGHWAY LA - LANE MP - MILEPOST OV - OVAL PK - PARKWAY PI - PIKE WA - WAY	INTERSECTION RELATED <input type="checkbox"/> WITHIN INTERSECTION OR ON APPROACH <input type="checkbox"/> WITHIN INTERCHANGE AREA NUMBER OF APPROACHES ROADWAY <input type="checkbox"/> ROADWAY DIVIDED			
LOCATION OF FIRST HARMFUL EVENT 1 - ON ROADWAY 2 - ON SHOULDER 3 - IN MEDIAN 4 - ON ROADSIDE 5 - ON GORE 6 - OUTSIDE TRAFFIC WAY 7 - ON RAMP 8 - OFF RAMP 0 1		MANNER OF CRASH COLLISION/IMPACT 1 - NOT COLLISION BETWEEN TWO MOTOR VEHICLES IN TRANSPORT 2 - REAR-END 3 - HEAD-ON 4 - REAR-TO-REAR 5 - BACKING 6 - ANGLE 7 - SIDESWIPE, SAME DIRECTION 8 - SIDESWIPE, OPPOSITE DIRECTION 9 - OTHER / UNKNOWN 2		DIRECTION OF TRAVEL 1 - NORTH 2 - SOUTH 3 - EAST 4 - WEST		MEDIAN TYPE 1 - DIVIDED FLUSH MEDIAN (<4 FEET) 2 - DIVIDED FLUSH MEDIAN (≥4 FEET) 3 - DIVIDED, DEPRESSED MEDIAN 4 - DIVIDED, RAISED MEDIAN (ANY TYPE) 9 - OTHER/UNKNOWN		
<input type="checkbox"/> WORK ZONE RELATED <input type="checkbox"/> WORKERS PRESENT <input type="checkbox"/> LAW ENFORCEMENT PRESENT <input type="checkbox"/> ACTIVE SCHOOL ZONE		WORK ZONE TYPE 1 - LANE CLOSURE 2 - LANE SHIFT/CROSSOVER 3 - WORK ON SHOULDER OR MEDIAN 4 - INTERMITTENT OR MOVING WORK 5 - OTHER		LOCATION OF CRASH IN WORK ZONE 1 - BEFORE THE 1ST WORK ZONE WARNING SIGN 2 - ADVANCE WARNING AREA 3 - TRANSITION AREA 4 - ACTIVITY AREA 5 - TERMINATION AREA		CONTOUR 1 1 - STRAIGHT LEVEL 2 - STRAIGHT GRADE 3 - CURVE LEVEL 4 - CURVE GRADE 9 - OTHER/UNKNOWN	CONDITIONS 1 1 - DRY 2 - WET 3 - SNOW 4 - ICE 5 - SAND, MUD, DIRT, OIL, GRAVEL 6 - WATER (STANDING, MOVING) 7 - SLUSH 9 - OTHER/UNKNOWN	SURFACE 2 1 - CONCRETE 2 - BLACKTOP, BITUMINOUS, ASPHALT 3 - BRICK/BLOCK 4 - SLAG, GRAVEL, STONE 5 - DIRT 9 - OTHER/UNKNOWN
LIGHT CONDITION 1 - DAYLIGHT 2 - DAWN/DUSK 3 - DARK - LIGHTED ROADWAY 4 - DARK - ROADWAY NOT LIGHTED 5 - DARK - UNKNOWN ROADWAY LIGHTING 9 - OTHER / UNKNOWN 1		WEATHER 1 - CLEAR 2 - CLOUDY 3 - FOG, SMOG, SMOKE 4 - RAIN 5 - SLEET, HAIL 6 - SNOW 7 - SEVERE CROSSWINDS 8 - BLOWING SAND, SOIL, DIRT, SNOW 9 - FREEZING RAIN OR FREEZING DRIZZLE 99 - OTHER / UNKNOWN 0 1		NARRATIVE On July 18, 2022 at approximately 4:47 PM, Units 1 and 2 were traveling northbound on Seward Road approaching Union Centre Boulevard. Unit 2 was stopped in traffic. Unit 1 then rear-ended Unit 2. SEE OH-2				
CRASH REPORTED DATE / TIME 0 7 1 8 2 0 2 2 1 6 4 7		DISPATCH DATE / TIME 0 7 1 8 2 0 2 2 1 6 4 8		ARRIVAL DATE / TIME 0 7 1 8 2 0 2 2 1 6 5 1		SCENE CLEARED DATE / TIME 0 7 1 8 2 0 2 2 1 7 1 3		REPORT TAKEN BY <input checked="" type="checkbox"/> POLICE AGENCY <input type="checkbox"/> MOTORIST <input type="checkbox"/> SUPPLEMENT (CORRECTION OR ADDITION TO AN EXISTING REPORT SENT TO SOPS)
TOTAL TIME ROADWAY CLOSED 0	OTHER INVESTIGATION TIME 3 0	TOTAL MINUTES 5 5	OFFICER'S NAME* A. ROUSH	OFFICER'S BADGE NUMBER* 1 7 0	CHECKED BY OFFICER'S NAME* Sgt. Aaron Meyer	CHECKED BY OFFICER'S BADGE NUMBER* 1 3 2		



Indicate the north direction with an "N" on the compass diagram.

OWNER	UNIT #	OWNER NAME: LAST, FIRST, MIDDLE (☐ SAME AS DRIVER)		OWNER PHONE: INCLUDE AREA CODE (☐ SAME AS DRIVER)	
	01				
VEHICLE	OWNER ADDRESS: STREET, CITY, STATE, ZIP (☐ SAME AS DRIVER)				
EVENT(S)	COMMERCIAL CARRIER: NAME, ADDRESS, CITY, STATE, ZIP				
VEHICLE	LP STATE	LICENSE PLATE #	VEHICLE IDENTIFICATION #	VEHICLE YEAR	VEHICLE MAKE
	OH	JNL3727	1GCUYEED2M1Z1916159	2021	CHEVROLET
VEHICLE	INSURANCE VERIFIED	INSURANCE COMPANY	INSURANCE POLICY #	COLOR	VEHICLE MODEL
	☑	HANOVER INSURANCE	ANWD543592	BLACK	SILVERAD
VEHICLE	TYPE OF USE		US DOT #	TOWED BY: COMPANY NAME	
	☐ COMMERCIAL ☐ GOVERNMENT ☐ IN EMERGENCY RESPONSE				
VEHICLE	INTERLOCK DEVICE EQUIPPED	HIT/SKIP UNIT	#OCCUPANTS	HAZARDOUS MATERIAL	
	☐	☐	01	CLASS # PLACARD ID #	
VEHICLE	VEHICLE WEIGHT GVWR/GCWR		HAZARDOUS MATERIAL		
	1 - ≤10K LBS. 2 - 10,001 - 26K LBS. 3 - >26K LBS.		CLASS # PLACARD ID #		
VEHICLE	UNIT TYPE		HAZARDOUS MATERIAL		
	04		CLASS # PLACARD ID #		
VEHICLE	# OF TRAILING UNITS		HAZARDOUS MATERIAL		
	00		CLASS # PLACARD ID #		
VEHICLE	WAS VEHICLE OPERATING IN AUTONOMOUS MODE WHEN CRASH OCCURRED?		HAZARDOUS MATERIAL		
	02		CLASS # PLACARD ID #		
VEHICLE	SPECIAL FUNCTION		HAZARDOUS MATERIAL		
	01		CLASS # PLACARD ID #		
VEHICLE	CARGO BODY TYPE		HAZARDOUS MATERIAL		
	01		CLASS # PLACARD ID #		
VEHICLE	VEHICLE DEFECTS		HAZARDOUS MATERIAL		
	01		CLASS # PLACARD ID #		
VEHICLE	NON-MOTORIST LOCATION AT IMPACT		HAZARDOUS MATERIAL		
	01		CLASS # PLACARD ID #		
VEHICLE	ACTION		HAZARDOUS MATERIAL		
	03		CLASS # PLACARD ID #		
VEHICLE	CONTRIBUTING CIRCUMSTANCES		HAZARDOUS MATERIAL		
	08		CLASS # PLACARD ID #		
VEHICLE	SEQUENCE OF EVENTS		HAZARDOUS MATERIAL		
	120		CLASS # PLACARD ID #		
VEHICLE	NON-COLLISION		HAZARDOUS MATERIAL		
	120		CLASS # PLACARD ID #		
VEHICLE	COLLISION WITH FIXED OBJECT - STRUCK		HAZARDOUS MATERIAL		
	120		CLASS # PLACARD ID #		
VEHICLE	FIRST HARMFUL EVENT		HAZARDOUS MATERIAL		
	1		CLASS # PLACARD ID #		
VEHICLE	MOST HARMFUL EVENT		HAZARDOUS MATERIAL		
	1		CLASS # PLACARD ID #		

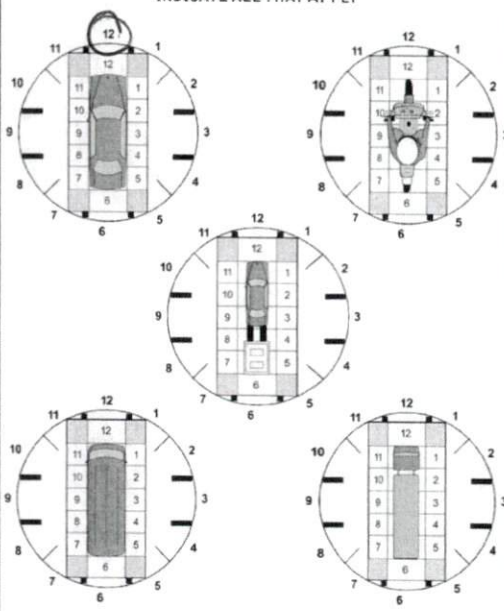
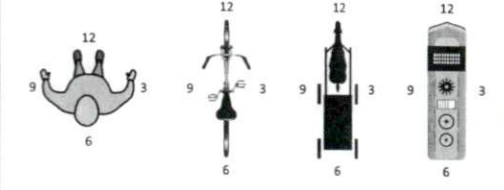
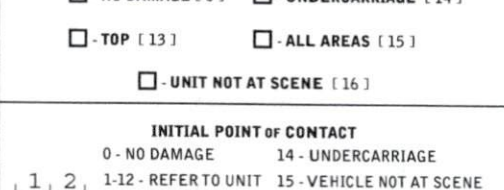
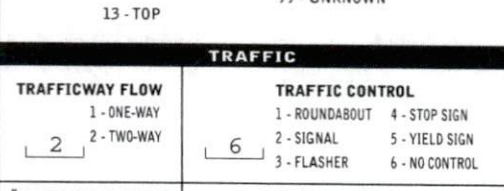
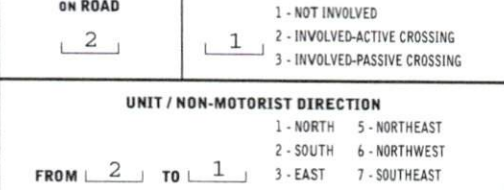
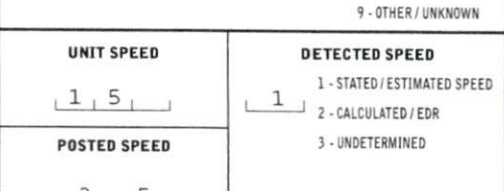
LOCAL REPORT NUMBER	
22051353	
DAMAGE	
DAMAGE SCALE	
2 1 - NONE 3 - FUNCTIONAL DAMAGE	
2 2 - MINOR DAMAGE 4 - DISABLING DAMAGE	
9 - UNKNOWN	
DAMAGED AREA(S)	
INDICATE ALL THAT APPLY	
	
	
	
	
	
	
☐ - NO DAMAGE [0] ☐ - UNDERCARRIAGE [14]	
☐ - TOP [13] ☐ - ALL AREAS [15]	
☐ - UNIT NOT AT SCENE [16]	
INITIAL POINT OF CONTACT	
0 - NO DAMAGE 14 - UNDERCARRIAGE	
12 1-12 - REFER TO UNIT DIAGRAM 15 - VEHICLE NOT AT SCENE	
13 - TOP 99 - UNKNOWN	
TRAFFIC	
TRAFFICWAY FLOW	TRAFFIC CONTROL
1 - ONE-WAY	1 - ROUNDABOUT 4 - STOP SIGN
2 - TWO-WAY	2 - SIGNAL 5 - YIELD SIGN
	3 - FLASHER 6 - NO CONTROL
# OF THROUGH LANES ON ROAD	RAIL GRADE CROSSING
2	1 - NOT INVOLVED
	2 - INVOLVED-ACTIVE CROSSING
	3 - INVOLVED-PASSIVE CROSSING
UNIT / NON-MOTORIST DIRECTION	
1 - NORTH 5 - NORTHEAST	
2 - SOUTH 6 - NORTHWEST	
3 - EAST 7 - SOUTHEAST	
4 - WEST 8 - SOUTHWEST	
9 - OTHER / UNKNOWN	
UNIT SPEED	DETECTED SPEED
15	1 - STATED / ESTIMATED SPEED
	2 - CALCULATED / EDR
	3 - UNDETERMINED
POSTED SPEED	
35	

OWNER	UNIT # 02	OWNER NAME: LAST, FIRST, MIDDLE (SAME AS DRIVER)	OWNER PHONE: INCLUDE AREA CODE (SAME AS DRIVER)
	OWNER ADDRESS: STREET, CITY, STATE, ZIP (SAME AS DRIVER)		
COMMERCIAL CARRIER: NAME, ADDRESS, CITY, STATE, ZIP		COMMERCIAL CARRIER PHONE: INCLUDE AREA CODE	
VEHICLE	LP STATE OH	LICENSE PLATE # JLM9400	VEHICLE IDENTIFICATION # 3GNA XJEV6JL11210455
	INSURANCE VERIFIED	INSURANCE COMPANY TRAVELERS	INSURANCE POLICY # 6100151562031
	TYPE OF USE <input type="checkbox"/> COMMERCIAL <input type="checkbox"/> GOVERNMENT <input type="checkbox"/> IN EMERGENCY RESPONSE	US DOT #	TOWED BY: COMPANY NAME
	INTERLOCK DEVICE EQUIPPED	HIT/SKIP UNIT	HAZARDOUS MATERIAL CLASS # PLACARD ID #
	UNIT TYPE 03	# OF TRAILING UNITS 00	VEHICLE WEIGHT GVWR/GCWR 1 - ≤10K LBS. 2 - 10,001 - 26K LBS. 3 - >26K LBS.
	1 - PASSENGER CAR 7 - MOTORCYCLE 2-WHEELED 12 - GOLF CART 18 - LIMO (LIVERY VEHICLE) 23 - PEDESTRIAN / SKATER 2 - PASSENGER VAN (MINIVAN) 8 - MOTORCYCLE 3-WHEELED 13 - SNOWMOBILE 19 - BUS (16+ PASSENGERS) 24 - WHEELCHAIR (ANY TYPE) 3 - SPORT UTILITY VEHICLE 9 - AUTOCYCLE 14 - SINGLE UNIT TRUCK 20 - OTHER VEHICLE 25 - OTHER NON-MOTORIST 4 - PICK UP 10 - MOPED OR MOTORIZED BICYCLE 15 - SEMI-TRACTOR 21 - HEAVY EQUIPMENT 26 - BICYCLE 5 - CARGO VAN 11 - ALL TERRAIN VEHICLE (ATV / UTV) 16 - FARM EQUIPMENT 22 - ANIMAL WITH RIDER OR ANIMAL-DRAWN VEHICLE 27 - TRAIN 6 - VAN (9-15 SEATS) 17 - MOTORHOME 99 - UNKNOWN OR HIT/SKIP		
	WAS VEHICLE OPERATING IN AUTONOMOUS MODE WHEN CRASH OCCURRED? 0 - NO AUTOMATION 1 - DRIVER ASSISTANCE 3 - CONDITIONAL AUTOMATION 9 - UNKNOWN 1 - YES 2 - NO 9 - OTHER / UNKNOWN 2 - PARTIAL AUTOMATION 5 - FULL AUTOMATION		
	SPECIAL FUNCTION 01		
	CARGO BODY TYPE 01		
	VEHICLE DEFECTS		
EVENT(S)	NON-MOTORIST LOCATION AT IMPACT		
	ACTION 04		
	CONTRIBUTING CIRCUMSTANCES 01		
	SEQUENCE OF EVENTS		
	NON-COLLISION		
	COLLISION WITH FIXED OBJECT - STRUCK		
	FIRST HARMFUL EVENT		
	MOST HARMFUL EVENT		

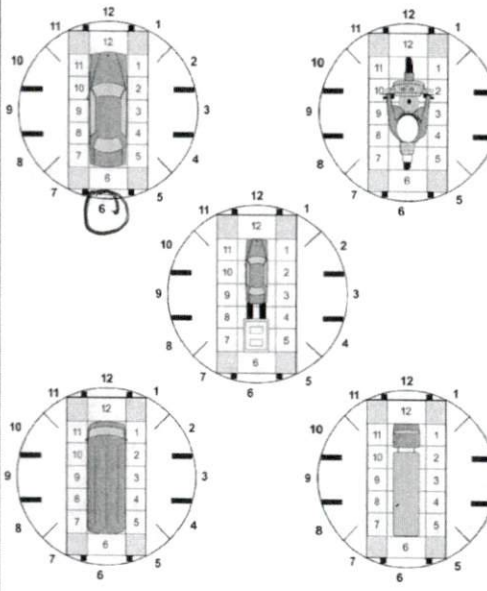
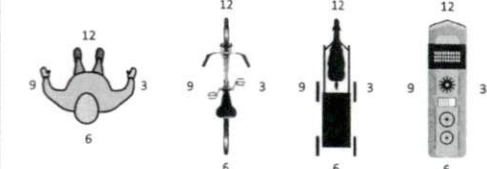
LOCAL REPORT NUMBER 2 2 0 5 1 3 5 3	
DAMAGE	
DAMAGE SCALE 3 1 - NONE 3 - FUNCTIONAL DAMAGE 2 - MINOR DAMAGE 4 - DISABLING DAMAGE 9 - UNKNOWN	
DAMAGED AREA(S) INDICATE ALL THAT APPLY	
	
	
<input type="checkbox"/> - NO DAMAGE [0] <input type="checkbox"/> - UNDERCARRIAGE [14] <input type="checkbox"/> - TOP [13] <input type="checkbox"/> - ALL AREAS [15] <input type="checkbox"/> - UNIT NOT AT SCENE [16]	
INITIAL POINT OF CONTACT 0 - NO DAMAGE 14 - UNDERCARRIAGE 1-12 - REFER TO UNIT DIAGRAM 15 - VEHICLE NOT AT SCENE 13 - TOP 99 - UNKNOWN	
TRAFFICWAY FLOW 2 1 - ONE-WAY 2 - TWO-WAY	TRAFFIC CONTROL 6 1 - ROUNDABOUT 4 - STOP SIGN 2 - SIGNAL 5 - YIELD SIGN 3 - FLASHER 6 - NO CONTROL
# OF THROUGH LANES ON ROAD 2	RAIL GRADE CROSSING 1 1 - NOT INVOLVED 2 - INVOLVED-ACTIVE CROSSING 3 - INVOLVED-PASSIVE CROSSING
UNIT / NON-MOTORIST DIRECTION FROM 2 TO 1 1 - NORTH 5 - NORTHEAST 2 - SOUTH 6 - NORTHWEST 3 - EAST 7 - SOUTHEAST 4 - WEST 8 - SOUTHWEST 9 - OTHER / UNKNOWN	
UNIT SPEED 0	DETECTED SPEED 1 1 - STATED / ESTIMATED SPEED 2 - CALCULATED / EDR 3 - UNDETERMINED
POSTED SPEED 3 5	



MOTORIST / Non-MOTORIST

LOCAL REPORT NUMBER									
2	2	0	5	1	3	5	3		

MOTORIST / Non-MOTORIST	UNIT # 0 1	NAME: LAST, FIRST, MIDDLE HAYES, MICHAEL TIMOTHY					DATE OF BIRTH 0 4 1 4 1 9 7 8			AGE 4 4	GENDER M
	ADDRESS: STREET, CITY, STATE, ZIP 403 CRANEWOOD DR, TRENTON, OH 45067						CONTACT PHONE - INCLUDE AREA CODE				
	INJURIES 5	INJURED TAKEN BY	EMS AGENCY (NAME)	INJURED TAKEN TO	MEDICAL FACILITY (NAME, CITY)	SAFETY EQUIPMENT USED 0 4	<input type="checkbox"/> DOT-COMPLIANT MC HELMET	SEATING POSITION 0 1	AIR BAG USAGE 1	EJECTION 1	TRAPPED 1
	OL STATE O H	OPERATOR LICENSE NUMBER		OFFENSE CHARGED 333.03a		LOCAL CODE <input checked="" type="checkbox"/>	OFFENSE DESCRIPTION ACDA		CITATION NUMBER 252010		
	OL CLASS 1	ENDORSEMENT SELECT UP TO 2	RESTRICTION SELECT UP TO 3		DRIVER DISTRACTED BY 1	ALCOHOL / DRUG SUSPECTED <input type="checkbox"/> ALCOHOL <input type="checkbox"/> MARIJUANA <input type="checkbox"/> OTHER DRUG		CONDITION 1	ALCOHOL TEST STATUS TYPE VALUE 1 1 .		DRUG TEST(S) STATUS TYPE RESULT SELECT UP TO 4 1 1

MOTORIST / Non-MOTORIST	UNIT # 0 2	NAME: LAST, FIRST, MIDDLE WEST, BLAINE NICOLE					DATE OF BIRTH 0 7 1 2 1 9 9 4			AGE 2 8	GENDER F
	ADDRESS: STREET, CITY, STATE, ZIP 102 DAY PL, TRENTON, OH 45067						CONTACT PHONE - INCLUDE AREA CODE				
	INJURIES 5	INJURED TAKEN BY	EMS AGENCY (NAME)	INJURED TAKEN TO	MEDICAL FACILITY (NAME, CITY)	SAFETY EQUIPMENT USED 0 4	<input type="checkbox"/> DOT-COMPLIANT MC HELMET	SEATING POSITION 0 1	AIR BAG USAGE 1	EJECTION 1	TRAPPED 1
	OL STATE O H	OPERATOR LICENSE NUMBER		OFFENSE CHARGED		LOCAL CODE <input type="checkbox"/>	OFFENSE DESCRIPTION		CITATION NUMBER		
	OL CLASS 4	ENDORSEMENT SELECT UP TO 2	RESTRICTION SELECT UP TO 3		DRIVER DISTRACTED BY 1	ALCOHOL / DRUG SUSPECTED <input type="checkbox"/> ALCOHOL <input type="checkbox"/> MARIJUANA <input type="checkbox"/> OTHER DRUG		CONDITION 1	ALCOHOL TEST STATUS TYPE VALUE 1 1 .		DRUG TEST(S) STATUS TYPE RESULT SELECT UP TO 4 1 1

MOTORIST / Non-MOTORIST	UNIT #	NAME: LAST, FIRST, MIDDLE					DATE OF BIRTH			AGE 0	GENDER
	ADDRESS: STREET, CITY, STATE, ZIP						CONTACT PHONE - INCLUDE AREA CODE				
	INJURIES	INJURED TAKEN BY	EMS AGENCY (NAME)	INJURED TAKEN TO	MEDICAL FACILITY (NAME, CITY)	SAFETY EQUIPMENT USED	<input type="checkbox"/> DOT-COMPLIANT MC HELMET	SEATING POSITION	AIR BAG USAGE	EJECTION	TRAPPED
	OL STATE	OPERATOR LICENSE NUMBER		OFFENSE CHARGED		LOCAL CODE <input type="checkbox"/>	OFFENSE DESCRIPTION		CITATION NUMBER		
	OL CLASS	ENDORSEMENT SELECT UP TO 2	RESTRICTION SELECT UP TO 3		DRIVER DISTRACTED BY	ALCOHOL / DRUG SUSPECTED <input type="checkbox"/> ALCOHOL <input type="checkbox"/> MARIJUANA <input type="checkbox"/> OTHER DRUG		CONDITION	ALCOHOL TEST STATUS TYPE VALUE		DRUG TEST(S) STATUS TYPE RESULT SELECT UP TO 4

INJURIES	SEATING POSITION	AIR BAG	OL CLASS	OL RESTRICTION(S)	DRIVER DISTRACTION	TEST STATUS
1 - FATAL 2 - SUSPECTED SERIOUS INJURY 3 - SUSPECTED MINOR INJURY 4 - POSSIBLE INJURY 5 - NO APPARENT INJURY	1 - FRONT - LEFT SIDE (MOTORCYCLE DRIVER) 2 - FRONT - MIDDLE 3 - FRONT - RIGHT SIDE 4 - SECOND - LEFT SIDE (MOTORCYCLE PASSENGER) 5 - SECOND - MIDDLE 6 - SECOND - RIGHT SIDE 7 - THIRD - LEFT SIDE (MOTORCYCLE SIDE CAR) 8 - THIRD - MIDDLE 9 - THIRD - RIGHT SIDE 10 - SLEEPER SECTION OF TRUCK CAB 11 - PASSENGER IN OTHER ENCLOSED CARGO AREA (NON-TRAILING UNIT, BUS, PICK-UP WITH CAP) 12 - PASSENGER IN UNENCLOSED CARGO AREA 13 - TRAILING UNIT 14 - RIDING ON VEHICLE EXTERIOR (NON-TRAILING UNIT) 15 - NON-MOTORIST 99 - OTHER / UNKNOWN	1 - NOT DEPLOYED 2 - DEPLOYED FRONT 3 - DEPLOYED SIDE 4 - DEPLOYED BOTH FRONT / SIDE 5 - NOT APPLICABLE 9 - DEPLOYMENT UNKNOWN	1 - CLASS A 2 - CLASS B 3 - CLASS C 4 - REGULAR CLASS (OHIO = D) 5 - MIC MOPED ONLY 6 - NO VALID OL	1 - ALCOHOL INTERLOCK DEVICE 2 - CDL INTRASTATE ONLY 3 - CORRECTIVE LENSES 4 - FARM WAIVER 5 - EXCEPT CLASS A BUS 6 - EXCEPT CLASS A & CLASS B BUS 7 - EXCEPT TRACTOR-TRAILER 8 - INTERMEDIATE LICENSE RESTRICTIONS 9 - LEARNER'S PERMIT RESTRICTIONS 10 - LIMITED TO DAYLIGHT ONLY 11 - LIMITED TO EMPLOYMENT 12 - LIMITED - OTHER 13 - MECHANICAL DEVICES (SPECIAL BRAKES, HAND CONTROLS, OR OTHER ADAPTIVE DEVICES) 14 - MILITARY VEHICLES ONLY 15 - MOTOR VEHICLES WITHOUT AIR BRAKES 16 - OUTSIDE MIRROR 17 - PROSTHETIC AID 18 - OTHER	1 - NOT DISTRACTED 2 - MANUALLY OPERATING AN ELECTRONIC COMMUNICATION DEVICE (TEXTING, TYPING, DIALING) 3 - TALKING ON HANDS-FREE COMMUNICATION DEVICE 4 - TALKING ON HAND-HELD COMMUNICATION DEVICE 5 - OTHER ACTIVITY WITH AN ELECTRONIC DEVICE 6 - PASSENGER 7 - OTHER DISTRACTION INSIDE THE VEHICLE 8 - OTHER DISTRACTION OUTSIDE THE VEHICLE 9 - OTHER / UNKNOWN	1 - NONE GIVEN 2 - TEST REFUSED 3 - TEST GIVEN, CONTAMINATED SAMPLE / UNUSABLE 4 - TEST GIVEN, RESULTS KNOWN 5 - TEST GIVEN, RESULTS UNKNOWN
INJURED TAKEN BY	EJECTION	OL ENDORSEMENT	TRAPPED	CONDITION	DRUG TEST TYPE	DRUG TEST RESULT(S)
1 - NOT TRANSPORTED / TREATED AT SCENE 2 - EMS 3 - POLICE 9 - OTHER / UNKNOWN	1 - NOT EJECTED 2 - PARTIALLY EJECTED 3 - TOTALLY EJECTED 4 - NOT APPLICABLE	H - HAZMAT M - MOTORCYCLE P - PASSENGER N - TANKER Q - MOTOR SCOOTER R - THREE-WHEEL MOTORCYCLE S - SCHOOL BUS T - DOUBLE & TRIPLE TRAILERS X - TANKER / HAZMAT	1 - NOT TRAPPED 2 - EXTRICATED BY MECHANICAL MEANS 3 - FREED BY NON-MECHANICAL MEANS	1 - APPARENTLY NORMAL 2 - PHYSICAL IMPAIRMENT 3 - EMOTIONAL (E.G., DEPRESSED, ANGRY, DISTURBED) 4 - ILLNESS 5 - FELL ASLEEP, FAINTED, FATIGUED, ETC. 6 - UNDER THE INFLUENCE OF MEDICATIONS / DRUGS / ALCOHOL 9 - OTHER / UNKNOWN	1 - NONE 2 - BLOOD 3 - URINE 4 - BREATH 5 - OTHER	1 - AMPHETAMINES 2 - BARBITURATES 3 - BENZODIAZEPINES 4 - CANNABINOIDS 5 - COCAINE 6 - OPIATES / OPIOIDS 7 - OTHER 8 - NEGATIVE RESULTS
SAFETY EQUIPMENT	TRAPPED	CONDITION	DRUG TEST TYPE	DRUG TEST RESULT(S)		
1 - NONE USED 2 - SHOULDER BELT ONLY USED 3 - LAP BELT ONLY USED 4 - SHOULDER & LAP BELT USED 5 - CHILD RESTRAINT SYSTEM - FORWARD FACING 6 - CHILD RESTRAINT SYSTEM - REAR FACING 7 - BOOSTER SEAT 8 - HELMET USED 9 - PROTECTIVE PADS USED (ELBOW, KNEES, ETC.) 10 - REFLECTIVE CLOTHING 11 - LIGHTING - PEDESTRIAN / BICYCLE ONLY 99 - OTHER / UNKNOWN	1 - NOT TRAPPED 2 - EXTRICATED BY MECHANICAL MEANS 3 - FREED BY NON-MECHANICAL MEANS	1 - APPARENTLY NORMAL 2 - PHYSICAL IMPAIRMENT 3 - EMOTIONAL (E.G., DEPRESSED, ANGRY, DISTURBED) 4 - ILLNESS 5 - FELL ASLEEP, FAINTED, FATIGUED, ETC. 6 - UNDER THE INFLUENCE OF MEDICATIONS / DRUGS / ALCOHOL 9 - OTHER / UNKNOWN	1 - NONE 2 - BLOOD 3 - URINE 4 - BREATH 5 - OTHER	1 - AMPHETAMINES 2 - BARBITURATES 3 - BENZODIAZEPINES 4 - CANNABINOIDS 5 - COCAINE 6 - OPIATES / OPIOIDS 7 - OTHER 8 - NEGATIVE RESULTS		

REPORT
NUMBER 22-051353

AGENCY

FAIRFIELD P.D. 00901

DATE OF ACCIDENT
M 07 10 18 Y 22

IN COUNTY OF BUTLER

ACCIDENT
LOCATION

Seward Rd / Union Center Blvd.

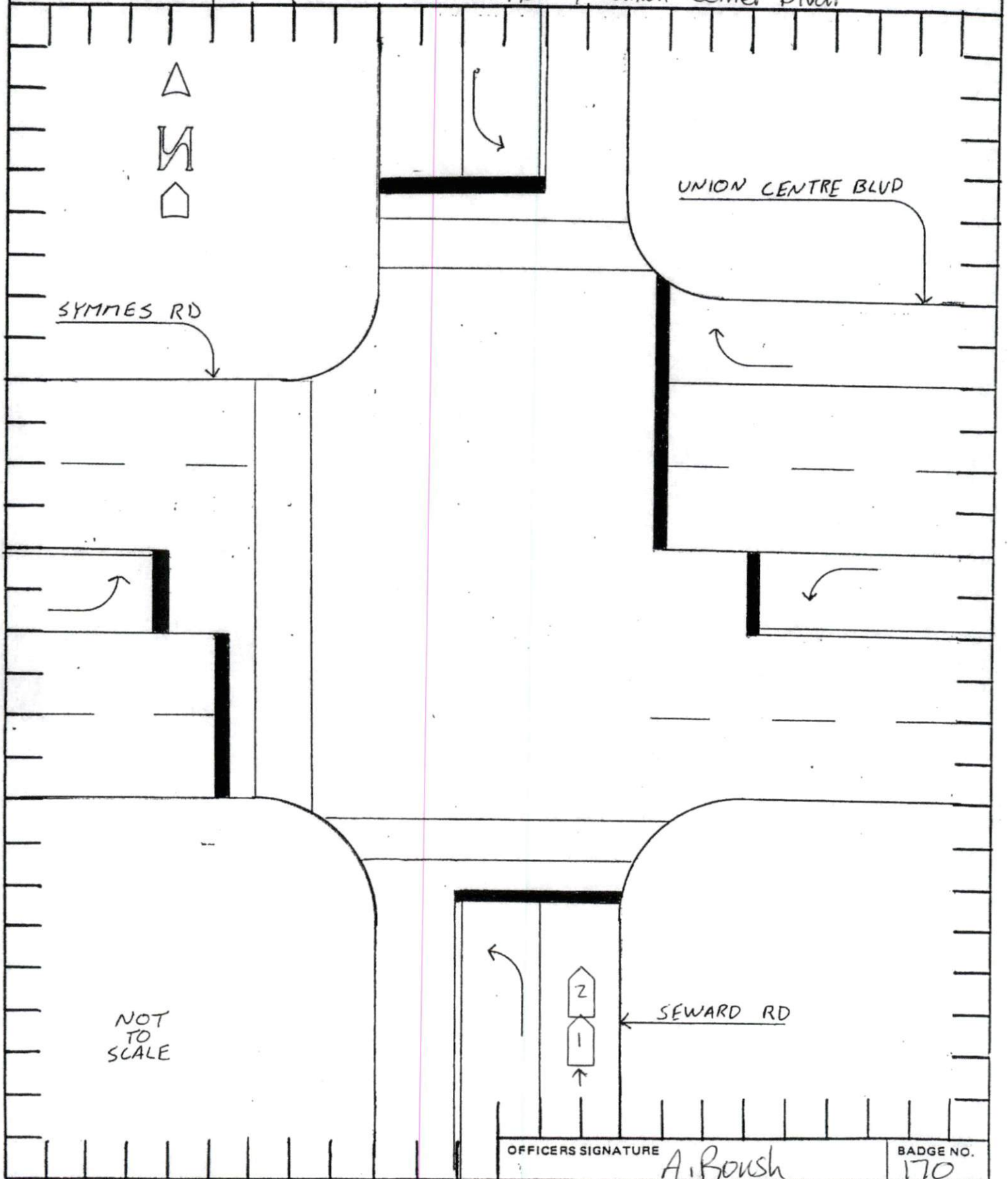

OFFICERS SIGNATURE

A. Boush

BADGE NO.

170