



TRAFFIC CRASH REPORT

*DENOTES MANDATORY FIELD FOR SUPPLEMENT REPORT

LOCAL REPORT NUMBER*

<input checked="" type="checkbox"/> PHOTOS TAKEN <input type="checkbox"/> SECONDARY CRASH		<input checked="" type="checkbox"/> OH-2 <input type="checkbox"/> OH-1P <input type="checkbox"/> OTHER <input type="checkbox"/> PRIVATE PROPERTY		LOCAL INFORMATION		2 2 0 5 1 8 7 2	
REPORTING AGENCY NAME* Fairfield Police Department				NCIC* 0 0 9 0 1		HIT/SKIP 1 - SOLVED 2 - UNSOLVED	
COUNTY* 0 9		LOCALITY* 1 - CITY 2 - VILLAGE 3 - TOWNSHIP		LOCATION: CITY, VILLAGE, TOWNSHIP* City of Fairfield		CRASH DATE / TIME* 0 7 2 0 2 0 2 2 1 8 4 9	
ROUTE TYPE S R		ROUTE NUMBER 4		PREFIX 1 - NORTH 2 - SOUTH 3 - EAST 4 - WEST		LOCATION ROAD NAME South Gilmore	
ROUTE TYPE S R		ROUTE NUMBER 4		PREFIX 1 - NORTH 2 - SOUTH 3 - EAST 4 - WEST		REFERENCE ROAD NAME (ROAD, MILEPOST, HOUSE #) South Gilmore	
ROUTE TYPE S R		ROUTE NUMBER 4		PREFIX 1 - NORTH 2 - SOUTH 3 - EAST 4 - WEST		REFERENCE ROAD NAME (ROAD, MILEPOST, HOUSE #) South Gilmore	
REFERENCE POINT 1 - INTERSECTION 2 - MILE POST 3 - HOUSE #		DIRECTION FROM REFERENCE 1 - NORTH 2 - SOUTH 3 - EAST 4 - WEST		ROUTE TYPE IR - INTERSTATE ROUTE(TP) US - FEDERAL US ROUTE SR - STATE ROUTE CR - NUMBERED COUNTY ROUTE TR - NUMBERED TOWNSHIP ROUTE		ROAD TYPE AL - ALLEY AV - AVENUE BL - BOULEVARD CR - CIRCLE CT - COURT DR - DRIVE HE - HEIGHTS HW - HIGHWAY LA - LANE MP - MILEPOST OV - OVAL PK - PARKWAY PI - PIKE PL - PLACE RD - ROAD SQ - SQUARE ST - STREET TE - TERRACE TL - TRAIL WA - WAY	
DISTANCE FROM REFERENCE 5 0		DISTANCE UNIT OF MEASURE 1 - MILES 2 - FEET 3 - YARDS		MANNER OF CRASH COLLISION/IMPACT 1 - NOT COLLISION BETWEEN TWO MOTOR VEHICLES IN TRANSPORT 2 - REAR-END 3 - HEAD-ON 4 - REAR-TO-REAR 5 - BACKING 6 - ANGLE 7 - SIDESWIPE, SAME DIRECTION 8 - SIDESWIPE, OPPOSITE DIRECTION 9 - OTHER / UNKNOWN		DIRECTION OF TRAVEL 1 - NORTH 2 - SOUTH 3 - EAST 4 - WEST	
LOCATION OF FIRST HARMFUL EVENT 1 - ON ROADWAY 2 - ON SHOULDER 3 - IN MEDIAN 4 - ON ROADSIDE 5 - ON GORE 6 - OUTSIDE TRAFFIC WAY 7 - ON RAMP 8 - OFF RAMP 9 - CROSSOVER 10 - DRIVEWAY/ALLEY ACCESS 11 - RAILWAY GRADE CROSSING 12 - SHARED USE PATHS OR TRAILS 13 - BIKE LANE 14 - TOLL BOOTH 99 - OTHER / UNKNOWN		WORK ZONE TYPE 1 - LANE CLOSURE 2 - LANE SHIFT/CROSSOVER 3 - WORK ON SHOULDER OR MEDIAN 4 - INTERMITTENT OR MOVING WORK 5 - OTHER		LOCATION OF CRASH IN WORK ZONE 1 - BEFORE THE 1ST WORK ZONE WARNING SIGN 2 - ADVANCE WARNING AREA 3 - TRANSITION AREA 4 - ACTIVITY AREA 5 - TERMINATION AREA		CONTOUR 1 - STRAIGHT LEVEL 2 - STRAIGHT GRADE 3 - CURVE LEVEL 4 - CURVE GRADE 9 - OTHER/UNKNOWN	
LIGHT CONDITION 1 - DAYLIGHT 2 - DAWN/DUSK 3 - DARK - LIGHTED ROADWAY 4 - DARK - ROADWAY NOT LIGHTED 5 - DARK - UNKNOWN ROADWAY LIGHTING 9 - OTHER / UNKNOWN		WEATHER 1 - CLEAR 2 - CLOUDY 3 - FOG, SMOG, SMOKE 4 - RAIN 5 - SLEET, HAIL 6 - SNOW 7 - SEVERE CROSSWINDS 8 - BLOWING SAND, SOIL, DIRT, SNOW 9 - FREEZING RAIN OR FREEZING DRIZZLE 99 - OTHER / UNKNOWN		CONDITIONS 1 - DRY 2 - WET 3 - SNOW 4 - ICE 5 - SAND, MUD, DIRT, OIL, GRAVEL 6 - WATER (STANDING, MOVING) 7 - SLUSH 9 - OTHER/UNKNOWN		SURFACE 1 - CONCRETE 2 - BLACKTOP, BITUMINOUS, ASPHALT 3 - BRICK/BLOCK 4 - SLAG, GRAVEL, STONE 5 - DIRT 9 - OTHER/UNKNOWN	
NARRATIVE On 07/20/22 at 6:49 P.M. Unit 1 was traveling north east on South Gilmore Rd. Unit 1 failed to assure clear distance ahead and rear ended Unit 2, who was stopped at a traffic light.						Indicate the north direction with an "N" on the compass diagram.	
CRASH REPORTED DATE / TIME 0 7 2 0 2 0 2 2 1 8 4 9						DISPATCH DATE / TIME 0 7 2 0 2 0 2 2 1 8 5 1	
ARRIVAL DATE / TIME 0 7 2 0 2 0 2 2 1 8 5 5						SCENE CLEARED DATE / TIME 0 7 2 0 2 0 2 2 1 9 5 5	
TOTAL TIME ROADWAY CLOSED 1 0		OTHER INVESTIGATION TIME 3 0		TOTAL MINUTES 9 4		OFFICER'S NAME* D. Miller	
TOTAL TIME ROADWAY CLOSED 1 0		OTHER INVESTIGATION TIME 3 0		TOTAL MINUTES 9 4		OFFICER'S BADGE NUMBER* 1 6 7	
TOTAL TIME ROADWAY CLOSED 1 0		OTHER INVESTIGATION TIME 3 0		TOTAL MINUTES 9 4		CHECKED BY OFFICER'S NAME* Sgt. Aaron Meyer	
TOTAL TIME ROADWAY CLOSED 1 0		OTHER INVESTIGATION TIME 3 0		TOTAL MINUTES 9 4		CHECKED BY OFFICER'S BADGE NUMBER* 1 3 2	
REPORT TAKEN BY <input checked="" type="checkbox"/> POLICE AGENCY <input type="checkbox"/> MOTORIST <input type="checkbox"/> SUPPLEMENT (CORRECTION OR ADDITION TO AN EXISTING REPORT SENT TO ODPs)							

OWNER	UNIT # 011	OWNER NAME: LAST, FIRST, MIDDLE (☐ SAME AS DRIVER) Sau, Jolie	OWNER PHONE: INCLUDE AREA CODE (☐ SAME AS DRIVER) 4098 Fairfield Falls Ct. Liberty Twp. OH 45011		
	COMMERCIAL CARRIER: NAME, ADDRESS, CITY, STATE, ZIP COMMERCIAL CARRIER PHONE: INCLUDE AREA CODE				
VEHICLE	LP STATE OH	LICENSE PLATE # JMU1964	VEHICLE IDENTIFICATION # 1F1TYR12CM3HKA511558	VEHICLE YEAR 2017	VEHICLE MAKE Ford
	INSURANCE VERIFIED Founders	INSURANCE POLICY # ITOH279545	COLOR White	VEHICLE MODEL Transit	
VEHICLE	TYPE OF USE <input type="checkbox"/> COMMERCIAL <input type="checkbox"/> GOVERNMENT <input type="checkbox"/> IN EMERGENCY RESPONSE		US DOT #	TOWED BY: COMPANY NAME	
	INTERLOCK DEVICE EQUIPPED HIT/SKIP UNIT		VEHICLE WEIGHT GVWR/GCWR 1 - ≤10K LBS. 2 - 10,001 - 26K LBS. 3 - >26K LBS.	HAZARDOUS MATERIAL CLASS # PLACARD ID #	
VEHICLE	UNIT TYPE 05		1 - PASSENGER CAR 7 - MOTORCYCLE 2-WHEELED 12 - GOLF CART 18 - LIMO (LIVERY VEHICLE) 23 - PEDESTRIAN / SKATER 2 - PASSENGER VAN (MINIVAN) 8 - MOTORCYCLE 3-WHEELED 13 - SNOWMOBILE 19 - BUS (16+ PASSENGERS) 24 - WHEELCHAIR (ANY TYPE) 3 - SPORT UTILITY VEHICLE 9 - AUTOCYCLE 14 - SINGLE UNIT TRUCK 20 - OTHER VEHICLE 25 - OTHER NON-MOTORIST 4 - PICK UP 10 - MOPED OR MOTORIZED BICYCLE 15 - SEMI-TRACTOR 21 - HEAVY EQUIPMENT 26 - BICYCLE 5 - CARGO VAN 11 - ALL TERRAIN VEHICLE (ATV / UTV) 16 - FARM EQUIPMENT 22 - ANIMAL WITH RIDER OR ANIMAL-DRAWN VEHICLE 27 - TRAIN 6 - VAN (9-15 SEATS)		
	# OF TRAILING UNITS 0		WAS VEHICLE OPERATING IN AUTONOMOUS MODE WHEN CRASH OCCURRED? 1 - YES 2 - NO 9 - OTHER / UNKNOWN		
VEHICLE	SPECIAL FUNCTION 01		1 - NONE 6 - BUS - CHARTER/TOUR 11 - FIRE 16 - FARM 21 - MAIL CARRIER 2 - TAXI 7 - BUS - INTERCITY 12 - MILITARY 17 - MOWING 99 - OTHER / UNKNOWN 3 - ELECTRONIC RIDE SHARING 8 - BUS - SHUTTLE 13 - POLICE 18 - SNOW REMOVAL 4 - SCHOOL TRANSPORT 9 - BUS - OTHER 14 - PUBLIC UTILITY 19 - TOWING 5 - BUS - TRANSIT/COMMUTER 10 - AMBULANCE 15 - CONSTRUCTION EQUIPMENT 20 - SAFETY SERVICE PATROL		
	CARGO BODY TYPE 01		1 - NO CARGO BODY TYPE / NOT APPLICABLE 3 - VEHICLE TOWING ANOTHER MOTOR VEHICLE 5 - INTERMODAL CONTAINER CHASSIS 8 - POLE 12 - CONCRETE MIXER 2 - BUS 4 - LOGGING 6 - CARGO VAN/ENCLOSED BOX 9 - CARGO TANK 13 - AUTO TRANSPORTER 7 - GRAINCHIPS/GRAVEL 10 - FLAT BED 14 - GARBAGE/REFUSE 11 - DUMP 99 - OTHER / UNKNOWN		
VEHICLE	VEHICLE DEFECTS 01		1 - TURN SIGNALS 4 - BRAKES 7 - WORN OR SLICK TIRES 9 - MOTOR TROUBLE 99 - OTHER / UNKNOWN 2 - HEAD LAMPS 5 - STEERING 8 - TRAILER EQUIPMENT DEFECTIVE 10 - DISABLED FROM PRIOR ACCIDENT 3 - TAIL LAMPS 6 - TIRE BLOWOUT		
	NON-MOTORIST LOCATION AT IMPACT 01		1 - INTERSECTION - MARKED CROSSWALK 3 - INTERSECTION - OTHER 6 - BICYCLE LANE 9 - MEDIAN/CROSSING ISLAND 12 - FIRST RESPONDER AT INCIDENT SCENE 2 - INTERSECTION - UNMARKED CROSSWALK 4 - MIDDLEBLOCK - MARKED CROSSWALK 7 - SHOULDER / ROADSIDE 10 - DRIVEWAY ACCESS 13 - STANDING 5 - TRAVEL LANE - OTHER LOCATION 8 - SIDEWALK 11 - SHARED USE PATHS OR TRAILS 14 - ENTERING OR CROSSING SPECIFIED LOCATION 15 - WALKING, RUNNING, JOGGING, PLAYING 9 - OTHER / UNKNOWN 12 - DRIVERLESS 16 - WORKING 17 - PUSHING VEHICLE 18 - APPROACHING OR LEAVING VEHICLE 19 - STANDING 20 - OTHER NON-MOTORIST 21 - STANDING OUTSIDE DISABLED VEHICLE 22 - OTHER MOVABLE OBJECT		
VEHICLE	ACTION 01		1 - NON-CONTACT 1 - STRAIGHT AHEAD 7 - MAKING U-TURN 13 - NEGOTIATING A CURVE 18 - APPROACHING OR LEAVING VEHICLE 2 - NON-COLLISION 2 - BACKING 8 - ENTERING TRAFFIC LANE 14 - ENTERING OR CROSSING SPECIFIED LOCATION 19 - STANDING 3 - STRIKING 3 - CHANGING LANES 9 - LEAVING TRAFFIC LANE 15 - WALKING, RUNNING, JOGGING, PLAYING 20 - OTHER NON-MOTORIST 4 - STRUCK 4 - OVERTAKING/PASSING 10 - PARKED 16 - WORKING 21 - STANDING OUTSIDE DISABLED VEHICLE 5 - BOTH STRIKING & STRUCK 5 - MAKING RIGHT TURN 11 - SLOWING OR STOPPED IN TRAFFIC 17 - PUSHING VEHICLE 18 - APPROACHING OR LEAVING VEHICLE 9 - OTHER / UNKNOWN 6 - MAKING LEFT TURN 12 - DRIVERLESS 19 - LOAD SHIFTING/FALLING/SPILLING 22 - OTHER MOVABLE OBJECT		
	CONTRIBUTING CIRCUMSTANCES 08		1 - NONE 7 - LEFT OF CENTER 13 - IMPROPER START FROM A PARKED POSITION 17 - VISION OBSTRUCTION 21 - LYING IN ROADWAY 2 - FAILURE TO YIELD 8 - FOLLOWING TOO CLOSE / ACDA 14 - STOPPED OR PARKED ILLEGALLY 18 - OPERATING DEFECTIVE EQUIPMENT 22 - NOT DISCERNIBLE 3 - RAN RED LIGHT 9 - IMPROPER LANE CHANGE 15 - SWERVING TO AVOID 19 - LOAD SHIFTING/FALLING/SPILLING 23 - OPENING DOOR INTO ROADWAY 4 - RAN STOP SIGN 10 - IMPROPER PASSING 16 - WRONG WAY 20 - IMPROPER CROSSING 99 - OTHER IMPROPER ACTION 5 - UNSAFE SPEED 11 - DROVE OFF ROAD 17 - VISION OBSTRUCTION 18 - OPERATING DEFECTIVE EQUIPMENT 22 - NOT DISCERNIBLE 6 - IMPROPER TURN 12 - IMPROPER BACKING 19 - LOAD SHIFTING/FALLING/SPILLING 20 - IMPROPER CROSSING 23 - OPENING DOOR INTO ROADWAY 99 - OTHER IMPROPER ACTION		
EVENT(S)	SEQUENCE OF EVENTS 120		1 - OVERTURN/ROLLOVER 6 - EQUIPMENT FAILURE 11 - CROSS CENTERLINE - OPPOSITE DIRECTION OF TRAVEL 16 - RAILWAY VEHICLE 22 - WORK ZONE MAINTENANCE EQUIPMENT 2 - FIRE/EXPLOSION 7 - SEPARATION OF UNITS 12 - DOWNHILL RUNAWAY 17 - ANIMAL - FARM 23 - STRUCK BY FALLING, SHIFTING CARGO OR ANYTHING SET IN MOTION BY A MOTOR VEHICLE 3 - IMMERSION 8 - RAN OFF ROAD RIGHT 13 - OTHER NON-COLLISION 18 - ANIMAL - DEER 24 - OTHER MOVABLE OBJECT 4 - JACKKNIFE 9 - RAN OFF ROAD LEFT 14 - PEDESTRIAN 19 - ANIMAL - OTHER 25 - STRUCK BY FALLING, SHIFTING CARGO OR ANYTHING SET IN MOTION BY A MOTOR VEHICLE 5 - CARGO / EQUIPMENT LOSS OR SHIFT 10 - CROSS MEDIAN 15 - PEDALCYCLE 20 - MOTOR VEHICLE IN TRANSPORT 26 - OTHER MOVABLE OBJECT 6 - IMPROPER TURN 11 - DROVE OFF ROAD 16 - WRONG WAY 21 - PARKED MOTOR VEHICLE		
	COLLISION WITH FIXED OBJECT - STRUCK 1		25 - IMPACT ATTENUATOR / CRASH CUSHION 31 - GUARDRAIL END 37 - TRAFFIC SIGN POST 43 - CURB 50 - WORK ZONE MAINTENANCE EQUIPMENT 26 - BRIDGE OVERHEAD STRUCTURE 32 - PORTABLE BARRIER 38 - OVERHEAD SIGN POST 44 - DITCH 51 - WALL 27 - BRIDGE PIER OR ABUTMENT 33 - MEDIAN CABLE BARRIER 39 - LIGHT / LUMINARIES SUPPORT 45 - EMBANKMENT 52 - BUILDING 28 - BRIDGE PARAPET 34 - MEDIAN GUARDRAIL BARRIER 40 - UTILITY POLE 46 - FENCE 53 - TUNNEL 29 - BRIDGE RAIL 35 - MEDIAN CONCRETE BARRIER 41 - OTHER POST, POLE OR SUPPORT 47 - MAILBOX 54 - OTHER FIXED OBJECT 30 - GUARDRAIL FACE 36 - MEDIAN OTHER BARRIER 42 - CULVERT 48 - TREE 99 - OTHER / UNKNOWN 49 - FIRE HYDRANT		
FIRST HARMFUL EVENT 1		MOST HARMFUL EVENT 1			

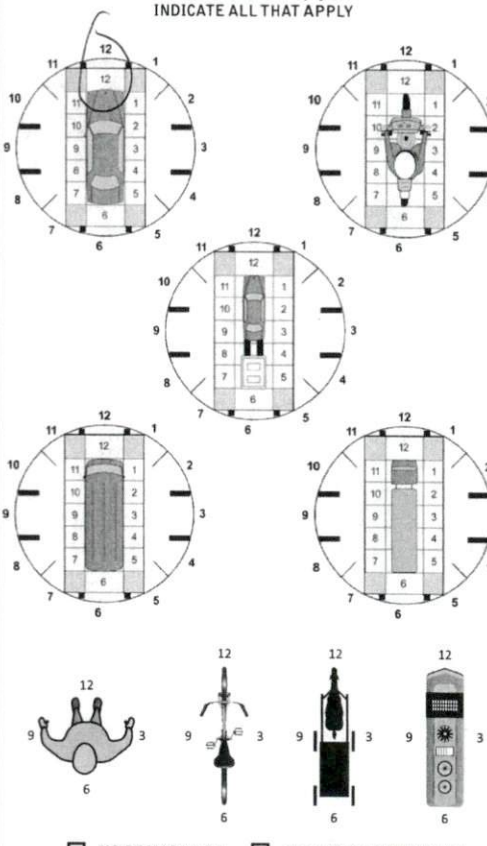
LOCAL REPORT NUMBER 2, 2, 0, 5, 1, 8, 7, 2	
DAMAGE DAMAGE SCALE 2 1 - NONE 3 - FUNCTIONAL DAMAGE 2 2 - MINOR DAMAGE 4 - DISABLING DAMAGE 9 - UNKNOWN	
DAMAGED AREA(S) INDICATE ALL THAT APPLY 	
INITIAL POINT OF CONTACT 0 - NO DAMAGE 14 - UNDERCARRIAGE 1-12 - REFER TO UNIT DIAGRAM 15 - VEHICLE NOT AT SCENE 13 - TOP 99 - UNKNOWN	
TRAFFIC TRAFFICWAY FLOW 2 1 - ONE-WAY 2 - TWO-WAY TRAFFIC CONTROL 2 1 - ROUNDABOUT 4 - STOP SIGN 2 - SIGNAL 5 - YIELD SIGN 3 - FLASHER 6 - NO CONTROL	
# OF THROUGH LANES ON ROAD 4	
RAIL GRADE CROSSING 1 1 - NOT INVOLVED 2 - INVOLVED-ACTIVE CROSSING 3 - INVOLVED-PASSIVE CROSSING	
UNIT / NON-MOTORIST DIRECTION FROM 8 TO 5 1 - NORTH 5 - NORTHEAST 2 - SOUTH 6 - NORTHWEST 3 - EAST 7 - SOUTHEAST 4 - WEST 8 - SOUTHWEST 9 - OTHER / UNKNOWN	
UNIT SPEED 1 0 POSTED SPEED 3 5	
DETECTED SPEED 1 1 - STATED / ESTIMATED SPEED 2 - CALCULATED / EDR 3 - UNDETERMINED	

OWNER	UNIT # 012	OWNER NAME: LAST, FIRST, MIDDLE (X SAME AS DRIVER)	OWNER PHONE: INCLUDE AREA CODE (X SAME AS DRIVER)
	OWNER ADDRESS: STREET, CITY, STATE, ZIP (X SAME AS DRIVER)		
VEHICLE	COMMERCIAL CARRIER: NAME, ADDRESS, CITY, STATE, ZIP		COMMERCIAL CARRIER PHONE: INCLUDE AREA CODE
	LP STATE OH	LICENSE PLATE # FYY1776	VEHICLE IDENTIFICATION # JTIDKN3DU5C5500266
EVENT(S)	INSURANCE VERIFIED X	INSURANCE COMPANY Liberty Mutual	INSURANCE POLICY # AOV-281-507336-7029
	TYPE OF USE COMMERCIAL <input type="checkbox"/> GOVERNMENT <input type="checkbox"/> IN EMERGENCY RESPONSE <input type="checkbox"/>	US DOT #	VEHICLE YEAR 2011
VEHICLE	INTERLOCK DEVICE EQUIPPED <input type="checkbox"/>	HIT/SKIP UNIT <input type="checkbox"/>	VEHICLE MAKE Toyota
	#OCCUPANTS 02	VEHICLE WEIGHT GVWR/GCWR 1 - <10K LBS. 2 - 10,001 - 26K LBS. 3 - >26K LBS.	VEHICLE MODEL Prius
VEHICLE	UNIT TYPE 01	HAZARDOUS MATERIAL CLASS #	PLACARD ID #
	# OF TRAILING UNITS 0	WAS VEHICLE OPERATING IN AUTONOMOUS MODE WHEN CRASH OCCURRED? 1 - YES 2 - NO 9 - OTHER / UNKNOWN	0 - NO AUTOMATION 1 - DRIVER ASSISTANCE 2 - PARTIAL AUTOMATION 3 - CONDITIONAL AUTOMATION 4 - HIGH AUTOMATION 5 - FULL AUTOMATION 9 - UNKNOWN
VEHICLE	SPECIAL FUNCTION 01	1 - NONE 2 - TAXI 3 - ELECTRONIC RIDE SHARING 4 - SCHOOL TRANSPORT 5 - BUS - TRANSIT/COMMUTER	6 - BUS - CHARTER/TOUR 7 - BUS - INTERCITY 8 - BUS - SHUTTLE 9 - BUS - OTHER 10 - AMBULANCE
	CARGO BODY TYPE 01	1 - NO CARGO BODY TYPE / NOT APPLICABLE 2 - BUS	3 - VEHICLE TOWING ANOTHER MOTOR VEHICLE 4 - LOGGING 5 - INTERMODAL CONTAINER CHASSIS 6 - CARGO VAN/ENCLOSED BOX 7 - GRAIN/CHIPS/GRAVEL
VEHICLE	VEHICLE DEFECTS 1 - TURN SIGNALS 2 - HEAD LAMPS 3 - TAIL LAMPS	4 - BRAKES 5 - STEERING 6 - TIRE BLOWOUT	7 - WORN OR SLICK TIRES 8 - TRAILER EQUIPMENT DEFECTIVE 9 - MOTOR TROUBLE 10 - DISABLED FROM PRIOR ACCIDENT 99 - OTHER / UNKNOWN
	NON-MOTORIST LOCATION AT IMPACT 1 - INTERSECTION - MARKED CROSSWALK 2 - INTERSECTION - UNMARKED CROSSWALK	3 - INTERSECTION - OTHER 4 - MIDBLOCK - MARKED CROSSWALK 5 - TRAVEL LANE - OTHER LOCATION	6 - BICYCLE LANE 7 - SHOULDER / ROADSIDE 8 - SIDEWALK 9 - MEDIAN/CROSSING ISLAND 10 - DRIVEWAY ACCESS 11 - SHARED USE PATHS OR TRAILS
VEHICLE	ACTION 4	1 - NON-CONTACT 2 - NON-COLLISION 3 - STRIKING 4 - STRUCK 5 - BOTH STRIKING & STRUCK 9 - OTHER / UNKNOWN	1 - STRAIGHT AHEAD 2 - BACKING 3 - CHANGING LANES 4 - OVERTAKING/PASSING 5 - MAKING RIGHT TURN 6 - MAKING LEFT TURN 7 - MAKING U-TURN 8 - ENTERING TRAFFIC LANE 9 - LEAVING TRAFFIC LANE 10 - PARKED 11 - SLOWING OR STOPPED IN TRAFFIC 12 - DRIVERLESS
	CONTRIBUTING CIRCUMSTANCES 01	1 - NONE 2 - FAILURE TO YIELD 3 - RAN RED LIGHT 4 - RAN STOP SIGN 5 - UNSAFE SPEED 6 - IMPROPER TURN	7 - LEFT OF CENTER 8 - FOLLOWING TOO CLOSE / ACDA 9 - IMPROPER LANE CHANGE 10 - IMPROPER PASSING 11 - DROVE OFF ROAD 12 - IMPROPER BACKING
VEHICLE	SEQUENCE OF EVENTS 1 2 0	1 - OVERTURN/ROLLOVER 2 - FIRE/EXPLOSION 3 - IMMERSION 4 - JACKKNIFE 5 - CARGO / EQUIPMENT LOSS OR SHIFT	6 - EQUIPMENT FAILURE 7 - SEPARATION OF UNITS 8 - RAN OFF ROAD RIGHT 9 - RAN OFF ROAD LEFT 10 - CROSS MEDIAN
	COLLISION WITH FIXED OBJECT - STRUCK 4	25 - IMPACT ATTENUATOR / CRASH CUSHION 26 - BRIDGE OVERHEAD STRUCTURE 27 - BRIDGE PIER OR ABUTMENT 28 - BRIDGE PARAPET 29 - BRIDGE RAIL 30 - GUARDRAIL FACE	31 - GUARDRAIL END 32 - PORTABLE BARRIER 33 - MEDIAN CABLE BARRIER 34 - MEDIAN GUARDRAIL BARRIER 35 - MEDIAN CONCRETE BARRIER 36 - MEDIAN OTHER BARRIER
VEHICLE	NON-COLLISION 1	11 - CROSS CENTERLINE - OPPOSITE DIRECTION OF TRAVEL 12 - DOWNHILL RUNAWAY 13 - OTHER NON-COLLISION 14 - PEDESTRIAN 15 - PEDAL CYCLE	16 - RAILWAY VEHICLE 17 - ANIMAL - FARM 18 - ANIMAL - DEER 19 - ANIMAL - OTHER 20 - MOTOR VEHICLE IN TRANSPORT 21 - PARKED MOTOR VEHICLE
	WORK ZONE MAINTENANCE EQUIPMENT 50	51 - WALL 52 - BUILDING 53 - TUNNEL 54 - OTHER FIXED OBJECT 99 - OTHER / UNKNOWN	
VEHICLE	FIRST HARMFUL EVENT 1	MOST HARMFUL EVENT 1	

LOCAL REPORT NUMBER 2 2 0 5 1 8 7 2	
DAMAGE DAMAGE SCALE 2 1 - NONE 3 - FUNCTIONAL DAMAGE 2 - MINOR DAMAGE 4 - DISABLING DAMAGE 9 - UNKNOWN	
DAMAGED AREA(S) INDICATE ALL THAT APPLY	
<input type="checkbox"/> - NO DAMAGE [0] <input type="checkbox"/> - UNDERCARRIAGE [14] <input type="checkbox"/> - TOP [13] <input type="checkbox"/> - ALL AREAS [15] <input type="checkbox"/> - UNIT NOT AT SCENE [16]	
INITIAL POINT OF CONTACT 0 - NO DAMAGE 14 - UNDERCARRIAGE 1-12 - REFER TO UNIT DIAGRAM 15 - VEHICLE NOT AT SCENE 13 - TOP 99 - UNKNOWN	
TRAFFICWAY FLOW 2 2 - ONE-WAY 2 - TWO-WAY	TRAFFIC CONTROL 1 - ROUNDABOUT 4 - STOP SIGN 2 - SIGNAL 5 - YIELD SIGN 3 - FLASHER 6 - NO CONTROL
# OF THROUGH LANES ON ROAD 4	RAIL GRADE CROSSING 1 - NOT INVOLVED 2 - INVOLVED-ACTIVE CROSSING 3 - INVOLVED-PASSIVE CROSSING
UNIT / NON-MOTORIST DIRECTION FROM 8 TO 5 1 - NORTH 5 - NORTHEAST 2 - SOUTH 6 - NORTHWEST 3 - EAST 7 - SOUTHEAST 4 - WEST 8 - SOUTHWEST 9 - OTHER / UNKNOWN	
UNIT SPEED 0	DETECTED SPEED 1 1 - STATED / ESTIMATED SPEED 2 - CALCULATED / EDR 3 - UNDETERMINED
POSTED SPEED 3 5	



MOTORIST / Non-MOTORIST

LOCAL REPORT NUMBER
2 2 0 5 1 8 7 2

MOTORIST / NON-MOTORIST	UNIT # 0 1	NAME: LAST, FIRST, MIDDLE Kanga, Noel				DATE OF BIRTH 1 2 2 5 1 9 7 0				AGE 5 1	GENDER M																																																																																																																																																																																																																																																																		
	ADDRESS: STREET, CITY, STATE, ZIP 6836 Lakeside Dr. Apt 202C, West Chester, OH 45069					CONTACT PHONE - INCLUDE AREA CODE																																																																																																																																																																																																																																																																							
	INJURIES 5	INJURED TAKEN BY	EMS AGENCY (NAME)	INJURED TAKEN TO: MEDICAL FACILITY (NAME, CITY)	SAFETY EQUIPMENT USED 0 4	<input type="checkbox"/> DOT-COMPLIANT MC HELMET	SEATING POSITION 0 1	AIR BAG USAGE 1	EJECTION 1	TRAPPED 1																																																																																																																																																																																																																																																																			
	OL STATE O H	OPERATOR LICENSE NUMBER		OFFENSE CHARGED 333.03 A	LOCAL CODE <input checked="" type="checkbox"/>	OFFENSE DESCRIPTION ACDA		CITATION NUMBER 251761																																																																																																																																																																																																																																																																					
OL CLASS 4	ENDORSEMENT SELECT UP TO 2	RESTRICTION SELECT UP TO 3		DRIVER DISTRACTED BY 1	ALCOHOL / DRUG SUSPECTED <input type="checkbox"/> ALCOHOL <input type="checkbox"/> MARIJUANA <input type="checkbox"/> OTHER DRUG		CONDITION 1	ALCOHOL TEST STATUS TYPE VALUE 1 1 .		DRUG TEST(S) STATUS TYPE RESULT SELECT UP TO 4 1 1																																																																																																																																																																																																																																																																			
MOTORIST / NON-MOTORIST	UNIT # 0 2	NAME: LAST, FIRST, MIDDLE Yater, Michael				DATE OF BIRTH 0 8 1 8 1 9 8 5				AGE 3 6	GENDER M																																																																																																																																																																																																																																																																		
	ADDRESS: STREET, CITY, STATE, ZIP 1116 Hayes Ave. Hamilton, OH 45015					CONTACT PHONE - INCLUDE AREA CODE																																																																																																																																																																																																																																																																							
	INJURIES 4	INJURED TAKEN BY 2	EMS AGENCY (NAME) Fairfield	INJURED TAKEN TO: MEDICAL FACILITY (NAME, CITY) Fort Hamilton	SAFETY EQUIPMENT USED 0 4	<input type="checkbox"/> DOT-COMPLIANT MC HELMET	SEATING POSITION 0 1	AIR BAG USAGE 1	EJECTION 1	TRAPPED 1																																																																																																																																																																																																																																																																			
	OL STATE O H	OPERATOR LICENSE NUMBER		OFFENSE CHARGED	LOCAL CODE <input type="checkbox"/>	OFFENSE DESCRIPTION		CITATION NUMBER																																																																																																																																																																																																																																																																					
OL CLASS 4	ENDORSEMENT SELECT UP TO 2	RESTRICTION SELECT UP TO 3		DRIVER DISTRACTED BY 1	ALCOHOL / DRUG SUSPECTED <input type="checkbox"/> ALCOHOL <input type="checkbox"/> MARIJUANA <input type="checkbox"/> OTHER DRUG		CONDITION 1	ALCOHOL TEST STATUS TYPE VALUE 1 1 .		DRUG TEST(S) STATUS TYPE RESULT SELECT UP TO 4 1 1																																																																																																																																																																																																																																																																			
MOTORIST / NON-MOTORIST	UNIT #	NAME: LAST, FIRST, MIDDLE				DATE OF BIRTH				AGE 0	GENDER																																																																																																																																																																																																																																																																		
	ADDRESS: STREET, CITY, STATE, ZIP					CONTACT PHONE - INCLUDE AREA CODE																																																																																																																																																																																																																																																																							
	INJURIES	INJURED TAKEN BY	EMS AGENCY (NAME)	INJURED TAKEN TO: MEDICAL FACILITY (NAME, CITY)	SAFETY EQUIPMENT USED	<input type="checkbox"/> DOT-COMPLIANT MC HELMET	SEATING POSITION	AIR BAG USAGE	EJECTION	TRAPPED																																																																																																																																																																																																																																																																			
	OL STATE	OPERATOR LICENSE NUMBER		OFFENSE CHARGED	LOCAL CODE <input type="checkbox"/>	OFFENSE DESCRIPTION		CITATION NUMBER																																																																																																																																																																																																																																																																					
OL CLASS	ENDORSEMENT SELECT UP TO 2	RESTRICTION SELECT UP TO 3		DRIVER DISTRACTED BY	ALCOHOL / DRUG SUSPECTED <input type="checkbox"/> ALCOHOL <input type="checkbox"/> MARIJUANA <input type="checkbox"/> OTHER DRUG		CONDITION	ALCOHOL TEST STATUS TYPE VALUE		DRUG TEST(S) STATUS TYPE RESULT SELECT UP TO 4																																																																																																																																																																																																																																																																			
<table border="1"><thead><tr><th>INJURIES</th><th>SEATING POSITION</th><th>AIR BAG</th><th>OL CLASS</th><th>OL RESTRICTION(S)</th><th>DRIVER DISTRACTION</th><th>TEST STATUS</th></tr></thead><tbody><tr><td>1 - FATAL</td><td>1 - FRONT - LEFT SIDE (MOTORCYCLE DRIVER)</td><td>1 - NOT DEPLOYED</td><td>1 - CLASS A</td><td>1 - ALCOHOL INTERLOCK DEVICE</td><td>1 - NOT DISTRACTED</td><td>1 - NONE GIVEN</td></tr><tr><td>2 - SUSPECTED SERIOUS INJURY</td><td>2 - FRONT - MIDDLE</td><td>2 - DEPLOYED FRONT</td><td>2 - CLASS B</td><td>2 - CDL INTRASTATE ONLY</td><td>2 - MANUALLY OPERATING AN ELECTRONIC COMMUNICATION DEVICE (TEXTING, TYPING, DIALING)</td><td>2 - TEST REFUSED</td></tr><tr><td>3 - SUSPECTED MINOR INJURY</td><td>3 - FRONT - RIGHT SIDE</td><td>3 - DEPLOYED SIDE</td><td>3 - CLASS C</td><td>3 - CORRECTIVE LENSES</td><td>3 - TALKING ON HANDS-FREE COMMUNICATION DEVICE</td><td>3 - TEST GIVEN, CONTAMINATED SAMPLE / UNUSABLE</td></tr><tr><td>4 - POSSIBLE INJURY</td><td>4 - SECOND - LEFT SIDE (MOTORCYCLE PASSENGER)</td><td>4 - DEPLOYED BOTH FRONT / SIDE</td><td>4 - REGULAR CLASS (OHIO = D)</td><td>4 - FARM WAIVER</td><td>4 - TALKING ON HAND-HELD COMMUNICATION DEVICE</td><td>4 - TEST GIVEN, RESULTS KNOWN</td></tr><tr><td>5 - NO APPARENT INJURY</td><td>5 - SECOND - MIDDLE</td><td>5 - NOT APPLICABLE</td><td>5 - M/C MOPED ONLY</td><td>5 - EXCEPT CLASS A BUS</td><td>5 - OTHER ACTIVITY WITH AN ELECTRONIC DEVICE</td><td>5 - TEST GIVEN, RESULTS UNKNOWN</td></tr><tr><td></td><td>6 - SECOND - RIGHT SIDE</td><td>9 - DEPLOYMENT UNKNOWN</td><td>6 - NO VALID OL</td><td>6 - EXCEPT CLASS A & CLASS B BUS</td><td>6 - PASSENGER</td><td></td></tr><tr><td colspan="3">INJURED TAKEN BY</td><td colspan="3">EJECTION</td><td>ALCOHOL TEST TYPE</td></tr><tr><td colspan="3">1 - NOT TRANSPORTED / TREATED AT SCENE</td><td colspan="3">1 - NOT EJECTED</td><td>1 - NONE</td></tr><tr><td colspan="3">2 - EMS</td><td colspan="3">2 - PARTIALLY EJECTED</td><td>2 - BLOOD</td></tr><tr><td colspan="3">3 - POLICE</td><td colspan="3">3 - TOTALLY EJECTED</td><td>3 - URINE</td></tr><tr><td colspan="3">9 - OTHER / UNKNOWN</td><td colspan="3">4 - NOT APPLICABLE</td><td>4 - BREATH</td></tr><tr><td colspan="3">SAFETY EQUIPMENT</td><td colspan="3">TRAPPED</td><td>5 - OTHER</td></tr><tr><td colspan="3">1 - NONE USED</td><td colspan="3">1 - NOT TRAPPED</td><td>DRUG TEST TYPE</td></tr><tr><td colspan="3">2 - SHOULDER BELT ONLY USED</td><td colspan="3">2 - EXTRICATED BY MECHANICAL MEANS</td><td>1 - NONE</td></tr><tr><td colspan="3">3 - LAP BELT ONLY USED</td><td colspan="3">3 - FREED BY NON-MECHANICAL MEANS</td><td>2 - BLOOD</td></tr><tr><td colspan="3">4 - SHOULDER & LAP BELT USED</td><td colspan="3"></td><td>3 - URINE</td></tr><tr><td colspan="3">5 - CHILD RESTRAINT SYSTEM - FORWARD FACING</td><td colspan="3"></td><td>4 - BREATH</td></tr><tr><td colspan="3">6 - CHILD RESTRAINT SYSTEM - REAR FACING</td><td colspan="3"></td><td>5 - OTHER</td></tr><tr><td colspan="3">7 - BOOSTER SEAT</td><td colspan="3"></td><td></td></tr><tr><td colspan="3">8 - HELMET USED</td><td colspan="3"></td><td>CONDITION</td></tr><tr><td colspan="3">9 - PROTECTIVE PADS USED (ELBOW, KNEES, ETC.)</td><td colspan="3"></td><td>1 - APPARENTLY NORMAL</td></tr><tr><td colspan="3">10 - REFLECTIVE CLOTHING</td><td colspan="3"></td><td>2 - PHYSICAL IMPAIRMENT</td></tr><tr><td colspan="3">11 - LIGHTING - PEDESTRIAN / BICYCLE ONLY</td><td colspan="3"></td><td>3 - EMOTIONAL (E.G. DEPRESSED, ANGRY, DISTURBED)</td></tr><tr><td colspan="3">99 - OTHER / UNKNOWN</td><td colspan="3"></td><td>4 - ILLNESS</td></tr><tr><td colspan="3"></td><td colspan="3"></td><td>5 - FELL ASLEEP, FAINTED, FATIGUED, ETC.</td></tr><tr><td colspan="3"></td><td colspan="3"></td><td>6 - UNDER THE INFLUENCE OF MEDICATIONS / DRUGS / ALCOHOL</td></tr><tr><td colspan="3"></td><td colspan="3"></td><td>9 - OTHER / UNKNOWN</td></tr><tr><td colspan="3"></td><td colspan="3"></td><td>DRUG TEST RESULT(S)</td></tr><tr><td colspan="3"></td><td colspan="3"></td><td>1 - AMPHETAMINES</td></tr><tr><td colspan="3"></td><td colspan="3"></td><td>2 - BARBITURATES</td></tr><tr><td colspan="3"></td><td colspan="3"></td><td>3 - BENZODIAZEPINES</td></tr><tr><td colspan="3"></td><td colspan="3"></td><td>4 - CANNABINOIDS</td></tr><tr><td colspan="3"></td><td colspan="3"></td><td>5 - COCAINE</td></tr><tr><td colspan="3"></td><td colspan="3"></td><td>6 - OPIATES / OPIOIDS</td></tr><tr><td colspan="3"></td><td colspan="3"></td><td>7 - OTHER</td></tr><tr><td colspan="3"></td><td colspan="3"></td><td>8 - NEGATIVE RESULTS</td></tr></tbody></table>											INJURIES	SEATING POSITION	AIR BAG	OL CLASS	OL RESTRICTION(S)	DRIVER DISTRACTION	TEST STATUS	1 - FATAL	1 - FRONT - LEFT SIDE (MOTORCYCLE DRIVER)	1 - NOT DEPLOYED	1 - CLASS A	1 - ALCOHOL INTERLOCK DEVICE	1 - NOT DISTRACTED	1 - NONE GIVEN	2 - SUSPECTED SERIOUS INJURY	2 - FRONT - MIDDLE	2 - DEPLOYED FRONT	2 - CLASS B	2 - CDL INTRASTATE ONLY	2 - MANUALLY OPERATING AN ELECTRONIC COMMUNICATION DEVICE (TEXTING, TYPING, DIALING)	2 - TEST REFUSED	3 - SUSPECTED MINOR INJURY	3 - FRONT - RIGHT SIDE	3 - DEPLOYED SIDE	3 - CLASS C	3 - CORRECTIVE LENSES	3 - TALKING ON HANDS-FREE COMMUNICATION DEVICE	3 - TEST GIVEN, CONTAMINATED SAMPLE / UNUSABLE	4 - POSSIBLE INJURY	4 - SECOND - LEFT SIDE (MOTORCYCLE PASSENGER)	4 - DEPLOYED BOTH FRONT / SIDE	4 - REGULAR CLASS (OHIO = D)	4 - FARM WAIVER	4 - TALKING ON HAND-HELD COMMUNICATION DEVICE	4 - TEST GIVEN, RESULTS KNOWN	5 - NO APPARENT INJURY	5 - SECOND - MIDDLE	5 - NOT APPLICABLE	5 - M/C MOPED ONLY	5 - EXCEPT CLASS A BUS	5 - OTHER ACTIVITY WITH AN ELECTRONIC DEVICE	5 - TEST GIVEN, RESULTS UNKNOWN		6 - SECOND - RIGHT SIDE	9 - DEPLOYMENT UNKNOWN	6 - NO VALID OL	6 - EXCEPT CLASS A & CLASS B BUS	6 - PASSENGER		INJURED TAKEN BY			EJECTION			ALCOHOL TEST TYPE	1 - NOT TRANSPORTED / TREATED AT SCENE			1 - NOT EJECTED			1 - NONE	2 - EMS			2 - PARTIALLY EJECTED			2 - BLOOD	3 - POLICE			3 - TOTALLY EJECTED			3 - URINE	9 - OTHER / UNKNOWN			4 - NOT APPLICABLE			4 - BREATH	SAFETY EQUIPMENT			TRAPPED			5 - OTHER	1 - NONE USED			1 - NOT TRAPPED			DRUG TEST TYPE	2 - SHOULDER BELT ONLY USED			2 - EXTRICATED BY MECHANICAL MEANS			1 - NONE	3 - LAP BELT ONLY USED			3 - FREED BY NON-MECHANICAL MEANS			2 - BLOOD	4 - SHOULDER & LAP BELT USED						3 - URINE	5 - CHILD RESTRAINT SYSTEM - FORWARD FACING						4 - BREATH	6 - CHILD RESTRAINT SYSTEM - REAR FACING						5 - OTHER	7 - BOOSTER SEAT							8 - HELMET USED						CONDITION	9 - PROTECTIVE PADS USED (ELBOW, KNEES, ETC.)						1 - APPARENTLY NORMAL	10 - REFLECTIVE CLOTHING						2 - PHYSICAL IMPAIRMENT	11 - LIGHTING - PEDESTRIAN / BICYCLE ONLY						3 - EMOTIONAL (E.G. DEPRESSED, ANGRY, DISTURBED)	99 - OTHER / UNKNOWN						4 - ILLNESS							5 - FELL ASLEEP, FAINTED, FATIGUED, ETC.							6 - UNDER THE INFLUENCE OF MEDICATIONS / DRUGS / ALCOHOL							9 - OTHER / UNKNOWN							DRUG TEST RESULT(S)							1 - AMPHETAMINES							2 - BARBITURATES							3 - BENZODIAZEPINES							4 - CANNABINOIDS							5 - COCAINE							6 - OPIATES / OPIOIDS							7 - OTHER							8 - NEGATIVE RESULTS
INJURIES	SEATING POSITION	AIR BAG	OL CLASS	OL RESTRICTION(S)	DRIVER DISTRACTION	TEST STATUS																																																																																																																																																																																																																																																																							
1 - FATAL	1 - FRONT - LEFT SIDE (MOTORCYCLE DRIVER)	1 - NOT DEPLOYED	1 - CLASS A	1 - ALCOHOL INTERLOCK DEVICE	1 - NOT DISTRACTED	1 - NONE GIVEN																																																																																																																																																																																																																																																																							
2 - SUSPECTED SERIOUS INJURY	2 - FRONT - MIDDLE	2 - DEPLOYED FRONT	2 - CLASS B	2 - CDL INTRASTATE ONLY	2 - MANUALLY OPERATING AN ELECTRONIC COMMUNICATION DEVICE (TEXTING, TYPING, DIALING)	2 - TEST REFUSED																																																																																																																																																																																																																																																																							
3 - SUSPECTED MINOR INJURY	3 - FRONT - RIGHT SIDE	3 - DEPLOYED SIDE	3 - CLASS C	3 - CORRECTIVE LENSES	3 - TALKING ON HANDS-FREE COMMUNICATION DEVICE	3 - TEST GIVEN, CONTAMINATED SAMPLE / UNUSABLE																																																																																																																																																																																																																																																																							
4 - POSSIBLE INJURY	4 - SECOND - LEFT SIDE (MOTORCYCLE PASSENGER)	4 - DEPLOYED BOTH FRONT / SIDE	4 - REGULAR CLASS (OHIO = D)	4 - FARM WAIVER	4 - TALKING ON HAND-HELD COMMUNICATION DEVICE	4 - TEST GIVEN, RESULTS KNOWN																																																																																																																																																																																																																																																																							
5 - NO APPARENT INJURY	5 - SECOND - MIDDLE	5 - NOT APPLICABLE	5 - M/C MOPED ONLY	5 - EXCEPT CLASS A BUS	5 - OTHER ACTIVITY WITH AN ELECTRONIC DEVICE	5 - TEST GIVEN, RESULTS UNKNOWN																																																																																																																																																																																																																																																																							
	6 - SECOND - RIGHT SIDE	9 - DEPLOYMENT UNKNOWN	6 - NO VALID OL	6 - EXCEPT CLASS A & CLASS B BUS	6 - PASSENGER																																																																																																																																																																																																																																																																								
INJURED TAKEN BY			EJECTION			ALCOHOL TEST TYPE																																																																																																																																																																																																																																																																							
1 - NOT TRANSPORTED / TREATED AT SCENE			1 - NOT EJECTED			1 - NONE																																																																																																																																																																																																																																																																							
2 - EMS			2 - PARTIALLY EJECTED			2 - BLOOD																																																																																																																																																																																																																																																																							
3 - POLICE			3 - TOTALLY EJECTED			3 - URINE																																																																																																																																																																																																																																																																							
9 - OTHER / UNKNOWN			4 - NOT APPLICABLE			4 - BREATH																																																																																																																																																																																																																																																																							
SAFETY EQUIPMENT			TRAPPED			5 - OTHER																																																																																																																																																																																																																																																																							
1 - NONE USED			1 - NOT TRAPPED			DRUG TEST TYPE																																																																																																																																																																																																																																																																							
2 - SHOULDER BELT ONLY USED			2 - EXTRICATED BY MECHANICAL MEANS			1 - NONE																																																																																																																																																																																																																																																																							
3 - LAP BELT ONLY USED			3 - FREED BY NON-MECHANICAL MEANS			2 - BLOOD																																																																																																																																																																																																																																																																							
4 - SHOULDER & LAP BELT USED						3 - URINE																																																																																																																																																																																																																																																																							
5 - CHILD RESTRAINT SYSTEM - FORWARD FACING						4 - BREATH																																																																																																																																																																																																																																																																							
6 - CHILD RESTRAINT SYSTEM - REAR FACING						5 - OTHER																																																																																																																																																																																																																																																																							
7 - BOOSTER SEAT																																																																																																																																																																																																																																																																													
8 - HELMET USED						CONDITION																																																																																																																																																																																																																																																																							
9 - PROTECTIVE PADS USED (ELBOW, KNEES, ETC.)						1 - APPARENTLY NORMAL																																																																																																																																																																																																																																																																							
10 - REFLECTIVE CLOTHING						2 - PHYSICAL IMPAIRMENT																																																																																																																																																																																																																																																																							
11 - LIGHTING - PEDESTRIAN / BICYCLE ONLY						3 - EMOTIONAL (E.G. DEPRESSED, ANGRY, DISTURBED)																																																																																																																																																																																																																																																																							
99 - OTHER / UNKNOWN						4 - ILLNESS																																																																																																																																																																																																																																																																							
						5 - FELL ASLEEP, FAINTED, FATIGUED, ETC.																																																																																																																																																																																																																																																																							
						6 - UNDER THE INFLUENCE OF MEDICATIONS / DRUGS / ALCOHOL																																																																																																																																																																																																																																																																							
						9 - OTHER / UNKNOWN																																																																																																																																																																																																																																																																							
						DRUG TEST RESULT(S)																																																																																																																																																																																																																																																																							
						1 - AMPHETAMINES																																																																																																																																																																																																																																																																							
						2 - BARBITURATES																																																																																																																																																																																																																																																																							
						3 - BENZODIAZEPINES																																																																																																																																																																																																																																																																							
						4 - CANNABINOIDS																																																																																																																																																																																																																																																																							
						5 - COCAINE																																																																																																																																																																																																																																																																							
						6 - OPIATES / OPIOIDS																																																																																																																																																																																																																																																																							
						7 - OTHER																																																																																																																																																																																																																																																																							
						8 - NEGATIVE RESULTS																																																																																																																																																																																																																																																																							



OCCUPANT / WITNESS ADDENDUM

LOCAL REPORT NUMBER
2 2 0 5 1 8 7 2

OCCUPANT	UNIT # 1	NAME: LAST, FIRST, MIDDLE Sau, David	DATE OF BIRTH 0 9 0 5 1 9 6 9		AGE 5 2	GENDER M			
	ADDRESS: STREET, CITY, STATE, ZIP 4098 Fairfield Falls Ct. Liberty Twp. OH 45011		CONTACT PHONE - INCLUDE AREA CODE						
	INJURIES 5	INJURED TAKEN BY	EMS AGENCY (NAME)	INJURED TAKEN TO: MEDICAL FACILITY (NAME, CITY)	SAFETY EQUIPMENT USED 0 4	<input type="checkbox"/> DOT-COMPLIANT MC HELMET	SEATING POSITION 0 3	AIR BAG USAGE 0 1	EJECTION 1

OCCUPANT	UNIT # 2	NAME: LAST, FIRST, MIDDLE Yater, Sophia	DATE OF BIRTH 1 1 0 3 2 0 1 2		AGE 9	GENDER F			
	ADDRESS: STREET, CITY, STATE, ZIP 1116 Hayes Ave. Hamilton, OH 45015		CONTACT PHONE - INCLUDE AREA CODE						
	INJURIES 5	INJURED TAKEN BY	EMS AGENCY (NAME)	INJURED TAKEN TO: MEDICAL FACILITY (NAME, CITY)	SAFETY EQUIPMENT USED 0 4	<input type="checkbox"/> DOT-COMPLIANT MC HELMET	SEATING POSITION 0 6	AIR BAG USAGE 0 1	EJECTION 1

OCCUPANT	UNIT #	NAME: LAST, FIRST, MIDDLE	DATE OF BIRTH		AGE 0	GENDER			
	ADDRESS: STREET, CITY, STATE, ZIP		CONTACT PHONE - INCLUDE AREA CODE						
	INJURIES	INJURED TAKEN BY	EMS AGENCY (NAME)	INJURED TAKEN TO: MEDICAL FACILITY (NAME, CITY)	SAFETY EQUIPMENT USED	<input type="checkbox"/> DOT-COMPLIANT MC HELMET	SEATING POSITION	AIR BAG USAGE	EJECTION

OCCUPANT	UNIT #	NAME: LAST, FIRST, MIDDLE	DATE OF BIRTH		AGE 0	GENDER			
	ADDRESS: STREET, CITY, STATE, ZIP		CONTACT PHONE - INCLUDE AREA CODE						
	INJURIES	INJURED TAKEN BY	EMS AGENCY (NAME)	INJURED TAKEN TO: MEDICAL FACILITY (NAME, CITY)	SAFETY EQUIPMENT USED	<input type="checkbox"/> DOT-COMPLIANT MC HELMET	SEATING POSITION	AIR BAG USAGE	EJECTION

INJURIES	SAFETY EQUIPMENT USED	SEATING POSITION	AIR BAG USAGE
1 - FATAL	1 - NONE USED - VEHICLE OCCUPANT	1 - FRONT - LEFT SIDE (MOTORCYCLE DRIVER)	1 - NOT DEPLOYED
2 - SUSPECTED SERIOUS INJURY	2 - SHOULDER BELT ONLY USED	2 - FRONT - MIDDLE	2 - DEPLOYED FRONT
3 - SUSPECTED MINOR INJURY	3 - LAP BELT ONLY USED	3 - FRONT - RIGHT SIDE	3 - DEPLOYED SIDE
4 - POSSIBLE INJURY	4 - SHOULDER & LAP BELT USED	4 - SECOND - LEFT SIDE (MOTORCYCLE PASSENGER)	4 - DEPLOYED BOTH FRONT/SIDE
5 - NO APPARENT INJURY	5 - CHILD RESTRAINT SYSTEM - FORWARD FACING	5 - SECOND - MIDDLE	5 - NOT APPLICABLE
	6 - CHILD RESTRAINT SYSTEM - REAR FACING	6 - SECOND - RIGHT SIDE	9 - DEPLOYMENT UNKNOWN
	7 - BOOSTER SEAT	7 - THIRD - LEFT SIDE (MOTORCYCLE SIDE CAR)	
	8 - HELMET USED	8 - THIRD - MIDDLE	
	9 - PROTECTIVE PADS USED (ELBOW, KNEES, ETC.)	9 - THIRD - RIGHT SIDE	
	10 - REFLECTIVE CLOTHING	10 - SLEEPER SECTION OF TRUCK CAB	
	11 - LIGHTING - PEDESTRIAN / BICYCLE ONLY	11 - PASSENGER IN OTHER ENCLOSED CARGO AREA (NON-TRAILING UNIT, BUS, PICK-UP WITH CAP)	
	99 - OTHER / UNKNOWN	12 - PASSENGER IN UNENCLOSED CARGO AREA	
		13 - TRAILING UNIT	
		14 - RIDING ON VEHICLE EXTERIOR (NON-TRAILING UNIT)	
		15 - NON-MOTORIST	
		99 - OTHER / UNKNOWN	

INJURED TAKEN BY	EJECTION
1 - NOT TRANSPORTED / TREATED AT SCENE	1 - NOT EJECTED
2 - EMS	2 - PARTIALLY EJECTED
3 - POLICE	3 - TOTALLY EJECTED
9 - OTHER / UNKNOWN	4 - NOT APPLICABLE

GENDER	TRAPPED
F - FEMALE	1 - NOT TRAPPED
M - MALE	2 - EXTRICATED BY MECHANICAL MEANS
U - OTHER / UNKNOWN	3 - FREED BY NON-MECHANICAL MEANS

WITNESS	NAME: LAST, FIRST, MIDDLE	DATE OF BIRTH	AGE 0	GENDER
	ADDRESS: STREET, CITY, STATE, ZIP	CONTACT PHONE - INCLUDE AREA CODE		

WITNESS	NAME: LAST, FIRST, MIDDLE	DATE OF BIRTH	AGE 0	GENDER
	ADDRESS: STREET, CITY, STATE, ZIP	CONTACT PHONE - INCLUDE AREA CODE		

WITNESS	NAME: LAST, FIRST, MIDDLE	DATE OF BIRTH	AGE 0	GENDER
	ADDRESS: STREET, CITY, STATE, ZIP	CONTACT PHONE - INCLUDE AREA CODE		

LOCAL REPORT NUMBER PD-22-051872	REPORTING AGENCY FAIRFIELD P.D.	DATE OF CRASH M 7 D 20 Y 2022
IN COUNTY OF BUTLER	CRASH LOCATION South Gilmore Rd. // Dixie Hwy	

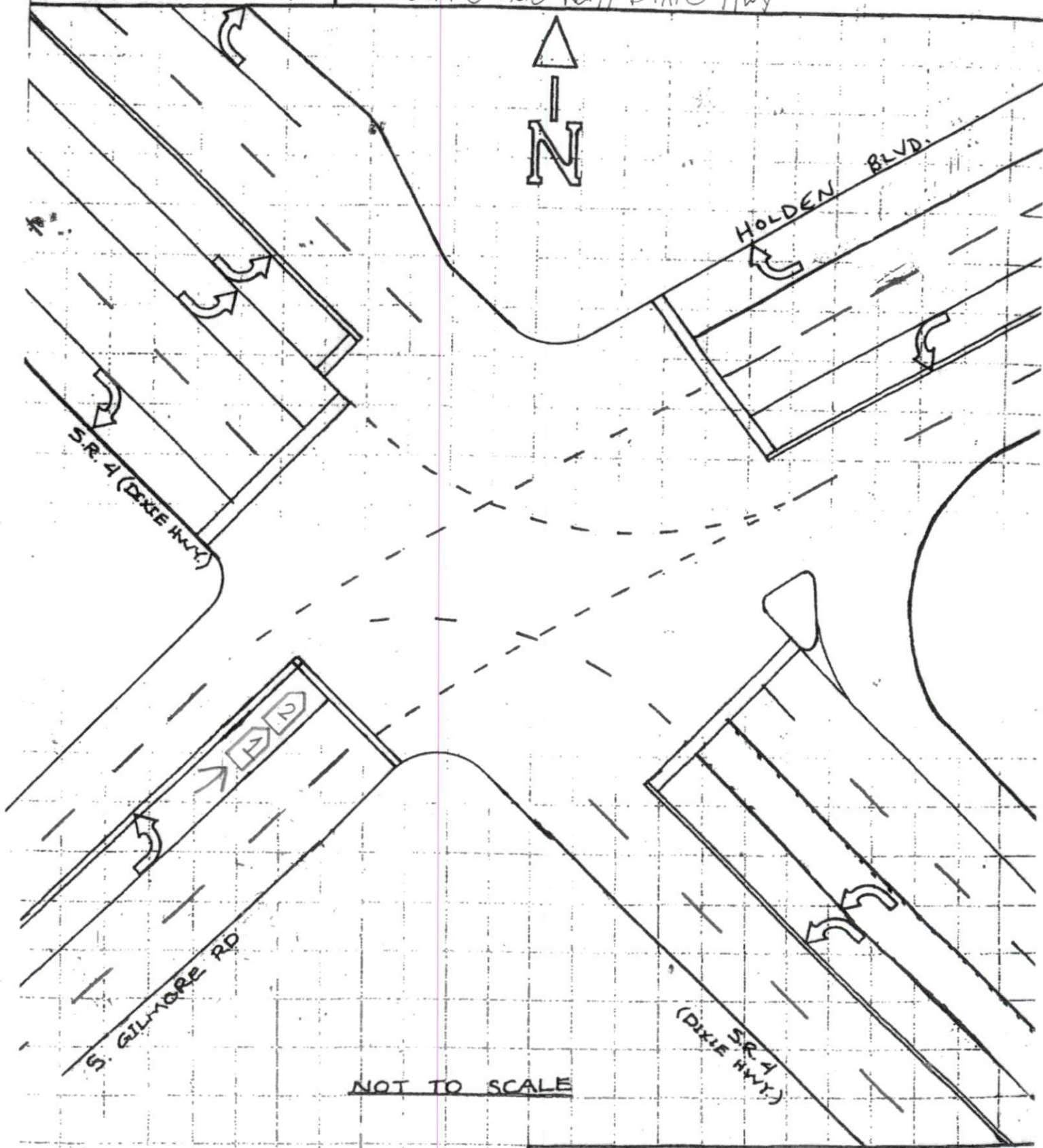

OFFICER'S SIGNATURE X PO [Signature]	BADGE NUMBER 167
---	---------------------