



TRAFFIC CRASH REPORT

*DENOTES MANDATORY FIELD FOR SUPPLEMENT REPORT

LOCAL REPORT NUMBER*

<input checked="" type="checkbox"/> PHOTOS TAKEN <input type="checkbox"/> SECONDARY CRASH		<input checked="" type="checkbox"/> OH-2 <input type="checkbox"/> OH-1P <input type="checkbox"/> OTHER <input type="checkbox"/> PRIVATE PROPERTY		LOCAL INFORMATION		2 2 0 5 7 2 3 0					
REPORTING AGENCY NAME* Fairfield Police Department				NCIC* 0 0 9 0 1		HIT/SKIP 1 - SOLVED 2 - UNSOLVED		NUMBER OF UNITS 0 2		UNIT IN ERROR 98 - ANIMAL 99 - UNKNOWN	
COUNTY* 0 9		LOCALITY* 1 - CITY 2 - VILLAGE 3 - TOWNSHIP 1		LOCATION: CITY, VILLAGE, TOWNSHIP* City of Fairfield				CRASH DATE / TIME* 08102022 1503		CRASH SEVERITY 1 - FATAL 2 - SERIOUS INJURY SUSPECTED 3 - MINOR INJURY SUSPECTED 4 - INJURY POSSIBLE 5 - PROPERTY DAMAGE ONLY	
ROUTE TYPE 1 - NORTH 2 - SOUTH 3 - EAST 4 - WEST		ROUTE NUMBER 1		PREFIX 1 - NORTH 2 - SOUTH 3 - EAST 4 - WEST		LOCATION ROAD NAME Resor		ROAD TYPE R D		LATITUDE DECIMAL DEGREES 39.322860	
ROUTE TYPE 1 - NORTH 2 - SOUTH 3 - EAST 4 - WEST		ROUTE NUMBER 1		PREFIX 1 - NORTH 2 - SOUTH 3 - EAST 4 - WEST		REFERENCE ROAD NAME (ROAD, MILEPOST, HOUSE #) Pleasant		ROAD TYPE A V		LONGITUDE DECIMAL DEGREES -84.561116	
REFERENCE POINT 1 - INTERSECTION 2 - MILE POST 3 - HOUSE # 1		DIRECTION FROM REFERENCE 1 - NORTH 2 - SOUTH 3 - EAST 4 - WEST 3		ROUTE TYPE IR - INTERSTATE ROUTE (TP) US - FEDERAL US ROUTE SR - STATE ROUTE CR - NUMBERED COUNTY ROUTE TR - NUMBERED TOWNSHIP ROUTE		ROAD TYPE AL - ALLEY AV - AVENUE BL - BOULEVARD CR - CIRCLE CT - COURT DR - DRIVE HE - HEIGHTS HW - HIGHWAY LA - LANE MP - MILEPOST OV - OVAL PK - PARKWAY PI - PIKE PL - PLACE RD - ROAD SQ - SQUARE ST - STREET TE - TERRACE TL - TRAIL WA - WAY		INTERSECTION RELATED <input checked="" type="checkbox"/> WITHIN INTERSECTION OR ON APPROACH <input type="checkbox"/> WITHIN INTERCHANGE AREA		NUMBER OF APPROACHES 4	
DISTANCE FROM REFERENCE 1 0		DISTANCE UNIT OF MEASURE 1 - MILES 2 - FEET 3 - YARDS 2		LOCATION OF FIRST HARMFUL EVENT 1 - ON ROADWAY 2 - ON SHOULDER 3 - IN MEDIAN 4 - ON ROADSIDE 5 - ON GORE 6 - OUTSIDE TRAFFIC WAY 7 - ON RAMP 8 - OFF RAMP 0 1		MANNER OF CRASH COLLISION/IMPACT 1 - NOT COLLISION BETWEEN TWO MOTOR VEHICLES IN TRANSPORT 2 - REAR-END 3 - HEAD-ON 4 - REAR-TO-REAR 5 - BACKING 6 - ANGLE 7 - SIDESWIPE, SAME DIRECTION 8 - SIDESWIPE, OPPOSITE DIRECTION 9 - OTHER / UNKNOWN 2		DIRECTION OF TRAVEL 1 - NORTH 2 - SOUTH 3 - EAST 4 - WEST		MEDIAN TYPE 1 - DIVIDED FLUSH MEDIAN (<4 FEET) 2 - DIVIDED FLUSH MEDIAN (≥4 FEET) 3 - DIVIDED, DEPRESSION MEDIAN 4 - DIVIDED, RAISED MEDIAN (ANY TYPE) 9 - OTHER/UNKNOWN	
<input type="checkbox"/> WORK ZONE RELATED <input type="checkbox"/> WORKERS PRESENT <input type="checkbox"/> LAW ENFORCEMENT PRESENT <input type="checkbox"/> ACTIVE SCHOOL ZONE		WORK ZONE TYPE 1 - LANE CLOSURE 2 - LANE SHIFT/CROSSOVER 3 - WORK ON SHOULDER OR MEDIAN 4 - INTERMITTENT OR MOVING WORK 5 - OTHER		LOCATION OF CRASH IN WORK ZONE 1 - BEFORE THE 1ST WORK ZONE WARNING SIGN 2 - ADVANCE WARNING AREA 3 - TRANSITION AREA 4 - ACTIVITY AREA 5 - TERMINATION AREA		CONTOUR 1 1 - STRAIGHT LEVEL 2 - STRAIGHT GRADE 3 - CURVE LEVEL 4 - CURVE GRADE 9 - OTHER/UNKNOWN		CONDITIONS 1 1 - DRY 2 - WET 3 - SNOW 4 - ICE 5 - SAND, MUD, DIRT, OIL, GRAVEL 6 - WATER (STANDING, MOVING) 7 - SLUSH 9 - OTHER/UNKNOWN		SURFACE 2 1 - CONCRETE 2 - BLACKTOP, BITUMINOUS, ASPHALT 3 - BRICK/BLOCK 4 - SLAG, GRAVEL, STONE 5 - DIRT 9 - OTHER/UNKNOWN	
LIGHT CONDITION 1 - DAYLIGHT 2 - DAWN/DUSK 3 - DARK - LIGHTED ROADWAY 4 - DARK - ROADWAY NOT LIGHTED 5 - DARK - UNKNOWN ROADWAY LIGHTING 9 - OTHER / UNKNOWN 1		WEATHER 1 - CLEAR 2 - CLOUDY 3 - FOG, SMOG, SMOKE 4 - RAIN 5 - SLEET, HAIL 6 - SNOW 7 - SEVERE CROSSWINDS 8 - BLOWING SAND, SOIL, DIRT, SNOW 9 - FREEZING RAIN OR FREEZING DRIZZLE 99 - OTHER / UNKNOWN 0 1		NARRATIVE On 08/10/2022 at about 3:03 PM, Unit 1 was traveling westbound on Resor Road and, when at Pleasant Ave, failed to stop within the assured clear distance ahead and collided with Unit 2, which was also westbound and was stopped for the red traffic signal at Pleasant Ave. See OH-2							
CRASH REPORTED DATE / TIME 08102022 1503		DISPATCH DATE / TIME 08102022 1508		ARRIVAL DATE / TIME 08102022 1508		SCENE CLEARED DATE / TIME 08102022 1539		REPORT TAKEN BY <input checked="" type="checkbox"/> POLICE AGENCY <input type="checkbox"/> MOTORIST <input type="checkbox"/> SUPPLEMENT (CORRECTION OR ADDITION TO AN EXISTING REPORT SENT TO JOPS)			
TOTAL TIME ROADWAY CLOSED 0		OTHER INVESTIGATION TIME 3 0		TOTAL MINUTES 6 1		OFFICER'S NAME* J. Mitchell		CHECKED BY OFFICER'S NAME* D. Pott		CHECKED BY OFFICER'S BADGE NUMBER* 1 3 0	

OWNER	UNIT # 01	OWNER NAME: LAST, FIRST, MIDDLE (X SAME AS DRIVER)	OWNER PHONE: INCLUDE AREA CODE (X SAME AS DRIVER)			
	OWNER ADDRESS: STREET, CITY, STATE, ZIP (X SAME AS DRIVER)					
COMMERCIAL CARRIER: NAME, ADDRESS, CITY, STATE, ZIP		COMMERCIAL CARRIER PHONE: INCLUDE AREA CODE				
VEHICLE	LP STATE OH	LICENSE PLATE # JMU2451	VEHICLE IDENTIFICATION # 1F1M5K181D184H1G131514721	VEHICLE YEAR 2017	VEHICLE MAKE Ford	
	INSURANCE VERIFIED	INSURANCE COMPANY	INSURANCE POLICY #	COLOR Blue	VEHICLE MODEL Explorer	
	TYPE OF USE <input type="checkbox"/> COMMERCIAL <input type="checkbox"/> GOVERNMENT <input type="checkbox"/> IN EMERGENCY RESPONSE		US DOT #	TOWED BY: COMPANY NAME		
	INTERLOCK DEVICE EQUIPPED	HIT/SKIP UNIT	#OCCUPANTS 01	VEHICLE WEIGHT GVWR/GCWR 1 - <10K LBS. 2 - 10,001 - 26K LBS. 3 - >26K LBS.	HAZARDOUS MATERIAL <input type="checkbox"/> MATERIAL RELEASED <input type="checkbox"/> PLACARD CLASS # PLACARD ID #	
	UNIT TYPE 03		1 - PASSENGER CAR 7 - MOTORCYCLE 2-WHEELED 12 - GOLF CART 18 - LIMO (LIVERY VEHICLE) 23 - PEDESTRIAN / SKATER 2 - PASSENGER VAN (MINIVAN) 8 - MOTORCYCLE 3-WHEELED 13 - SNOWMOBILE 19 - BUS (16+ PASSENGERS) 24 - WHEELCHAIR (ANY TYPE) 3 - SPORT UTILITY VEHICLE 9 - AUTOCYCLE 14 - SINGLE UNIT TRUCK 20 - OTHER VEHICLE 25 - OTHER NON-MOTORIST 4 - PICK UP 10 - MOPED OR MOTORIZED BICYCLE 15 - SEMI-TRACTOR 21 - HEAVY EQUIPMENT 26 - BICYCLE 5 - CARGO VAN 11 - ALL TERRAIN VEHICLE (ATV / UTV) 16 - FARM EQUIPMENT 22 - ANIMAL WITH RIDER OR ANIMAL-DRAWN VEHICLE 27 - TRAIN 6 - VAN (9-15 SEATS) 17 - MOTORHOME			
	# of TRAILING UNITS 0		WAS VEHICLE OPERATING IN AUTONOMOUS MODE WHEN CRASH OCCURRED? 0 1-YES 2-NO 9-OTHER / UNKNOWN AUTONOMOUS MODE LEVEL 0 1- NO AUTOMATION 3- CONDITIONAL AUTOMATION 9- UNKNOWN 2- PARTIAL AUTOMATION 5- FULL AUTOMATION			
	SPECIAL FUNCTION 01		1 - NONE 6 - BUS - CHARTER/TOUR 11 - FIRE 16 - FARM 21 - MAIL CARRIER 2 - TAXI 7 - BUS - INTERCITY 12 - MILITARY 17 - MOWING 99 - OTHER / UNKNOWN 3 - ELECTRONIC RIDE SHARING 8 - BUS - SHUTTLE 13 - POLICE 18 - SNOW REMOVAL 4 - SCHOOL TRANSPORT 9 - BUS - OTHER 14 - PUBLIC UTILITY 19 - TOWING 5 - BUS - TRANSIT/COMMUTER 10 - AMBULANCE 15 - CONSTRUCTION EQUIPMENT 20 - SAFETY SERVICE PATROL			
	CARGO BODY TYPE 01		1 - NO CARGO BODY TYPE / NOT APPLICABLE 3 - VEHICLE TOWING ANOTHER MOTOR VEHICLE 5 - INTERMODAL CONTAINER CHASSIS 8 - POLE 12 - CONCRETE MIXER 2 - BUS 4 - LOGGING 6 - CARGO VAN/ENCLOSED BOX 9 - CARGO TANK 13 - AUTO TRANSPORTER 7 - GRAIN/CHIPS/GRAVEL 10 - FLAT BED 14 - GARBAGE/REFUSE 11 - DUMP 99 - OTHER / UNKNOWN			
	VEHICLE DEFECTS		1 - TURN SIGNALS 4 - BRAKES 7 - WORN OR SLICK TIRES 9 - MOTOR TROUBLE 99 - OTHER / UNKNOWN 2 - HEAD LAMPS 5 - STEERING 8 - TRAILER EQUIPMENT DEFECTIVE 10 - DISABLED FROM PRIOR ACCIDENT 3 - TAIL LAMPS 6 - TIRE BLOWOUT			
	NON-MOTORIST LOCATION AT IMPACT		1 - INTERSECTION - MARKED CROSSWALK 3 - INTERSECTION - OTHER 6 - BICYCLE LANE 9 - MEDIAN/CROSSING ISLAND 12 - FIRST RESPONDER AT INCIDENT SCENE 2 - INTERSECTION - UNMARKED CROSSWALK 4 - MIDBLOCK - MARKED CROSSWALK 7 - SHOULDER / ROADSIDE 10 - DRIVEWAY ACCESS 99 - OTHER / UNKNOWN 5 - TRAVEL LANE - OTHER LOCATION 8 - SIDEWALK 11 - SHARED USE PATHS OR TRAILS			
ACTION 03		1 - NON-CONTACT 1 - STRAIGHT AHEAD 7 - MAKING U-TURN 13 - NEGOTIATING A CURVE 18 - APPROACHING OR LEAVING VEHICLE 2 - NON-COLLISION 2 - BACKING 8 - ENTERING TRAFFIC LANE 14 - ENTERING OR CROSSING SPECIFIED LOCATION 19 - STANDING 3 - STRIKING 01 3 - CHANGING LANES 9 - LEAVING TRAFFIC LANE 15 - WALKING, RUNNING, JOGGING, PLAYING 20 - OTHER NON-MOTORIST 4 - STRUCK PRE-CRASH ACTIONS 10 - PARKED 16 - WORKING 21 - STANDING OUTSIDE DISABLED VEHICLE 5 - BOTH STRIKING & STRUCK 5 - MAKING RIGHT TURN 11 - SLOWING OR STOPPED IN TRAFFIC 22 - OTHER IMPROPER ACTION 9 - OTHER / UNKNOWN 6 - MAKING LEFT TURN 12 - DRIVERLESS 17 - PUSHING VEHICLE 99 - OTHER / UNKNOWN				
CONTRIBUTING CIRCUMSTANCES 08		1 - NONE 7 - LEFT OF CENTER 13 - IMPROPER START FROM A PARKED POSITION 17 - VISION OBSTRUCTION 21 - LYING IN ROADWAY 2 - FAILURE TO YIELD 8 - FOLLOWING TOO CLOSE / ACDA 14 - STOPPED OR PARKED ILLEGALLY 18 - OPERATING DEFECTIVE EQUIPMENT 22 - NOT DISCERNIBLE 3 - RAN RED LIGHT 9 - IMPROPER LANE CHANGE 15 - SWERVING TO AVOID 19 - LOAD SHIFTING/FALLING/ SPILLING 23 - OPENING DOOR INTO ROADWAY 4 - RAN STOP SIGN 10 - IMPROPER PASSING 16 - WRONG WAY 20 - IMPROPER CROSSING 99 - OTHER IMPROPER ACTION 5 - CARGO / EQUIPMENT LOSS OR SHIFT 11 - DROVE OFF ROAD 6 - IMPROPER TURN 12 - IMPROPER BACKING				
SEQUENCE OF EVENTS		NON-COLLISION 1 - OVERTURN/ROLLOVER 6 - EQUIPMENT FAILURE 11 - CROSS CENTERLINE - OPPOSITE DIRECTION OF TRAVEL 16 - RAILWAY VEHICLE 22 - WORK ZONE MAINTENANCE EQUIPMENT 2 - FIRE/EXPLOSION 7 - SEPARATION OF UNITS 12 - DOWNHILL RUNAWAY 17 - ANIMAL - FARM 23 - STRUCK BY FALLING, SHIFTING CARGO OR ANYTHING SET IN MOTION BY A MOTOR VEHICLE 3 - IMMERSION 8 - RAN OFF ROAD RIGHT 13 - OTHER NON-COLLISION 18 - ANIMAL - DEER 24 - OTHER MOVABLE OBJECT 4 - JACKKNIFE 9 - RAN OFF ROAD LEFT 14 - PEDESTRIAN 19 - ANIMAL - OTHER 20 - MOTOR VEHICLE IN TRANSPORT 5 - CARGO / EQUIPMENT LOSS OR SHIFT 10 - CROSS MEDIAN 15 - PEDALCYCLE 21 - PARKED MOTOR VEHICLE 6 - IMPROPER TURN 11 - DROVE OFF ROAD 12 - DRIVERLESS 17 - PUSHING VEHICLE 99 - OTHER / UNKNOWN				
COLLISION WITH FIXED OBJECT - STRUCK		25 - IMPACT ATTENUATOR / CRASH CUSHION 31 - GUARDRAIL END 37 - TRAFFIC SIGN POST 43 - CURB 50 - WORK ZONE MAINTENANCE EQUIPMENT 26 - BRIDGE OVERHEAD STRUCTURE 32 - PORTABLE BARRIER 38 - OVERHEAD SIGN POST 44 - DITCH 51 - WALL 27 - BRIDGE PIER OR ABUTMENT 33 - MEDIAN CABLE BARRIER 39 - LIGHT / LUMINARIES SUPPORT 45 - EMBANKMENT 52 - BUILDING 28 - BRIDGE PARAPET 34 - MEDIAN GUARDRAIL BARRIER 40 - UTILITY POLE 46 - FENCE 53 - TUNNEL 29 - BRIDGE RAIL 35 - MEDIAN CONCRETE BARRIER 41 - OTHER POST, POLE OR SUPPORT 47 - MAILBOX 54 - OTHER FIXED OBJECT 30 - GUARDRAIL FACE 36 - MEDIAN OTHER BARRIER 42 - CULVERT 48 - TREE 99 - OTHER / UNKNOWN 49 - FIRE HYDRANT				
FIRST HARMFUL EVENT 1 MOST HARMFUL EVENT 1						

LOCAL REPORT NUMBER 2 2 0 5 7 2 3 0	
DAMAGE DAMAGE SCALE 1 - NONE 3 - FUNCTIONAL DAMAGE 2 - MINOR DAMAGE 4 - DISABLING DAMAGE 9 - UNKNOWN	
DAMAGED AREA(S) INDICATE ALL THAT APPLY	
<input type="checkbox"/> - NO DAMAGE [0] <input type="checkbox"/> - UNDERCARRIAGE [14] <input type="checkbox"/> - TOP [13] <input type="checkbox"/> - ALL AREAS [15] <input type="checkbox"/> - UNIT NOT AT SCENE [16]	
INITIAL POINT OF CONTACT 0 - NO DAMAGE 14 - UNDERCARRIAGE 1-12 - REFER TO UNIT DIAGRAM 15 - VEHICLE NOT AT SCENE 13 - TOP 99 - UNKNOWN	
TRAFFICWAY FLOW 1 - ONE-WAY 2 - TWO-WAY	TRAFFIC CONTROL 1 - ROUNDABOUT 4 - STOP SIGN 2 - SIGNAL 5 - YIELD SIGN 3 - FLASHER 6 - NO CONTROL
# of THROUGH LANES ON ROAD 2	RAIL GRADE CROSSING 1 - NOT INVOLVED 2 - INVOLVED-ACTIVE CROSSING 3 - INVOLVED-PASSIVE CROSSING
UNIT / NON-MOTORIST DIRECTION FROM 3 TO 4 1 - NORTH 5 - NORTHEAST 2 - SOUTH 6 - NORTHWEST 3 - EAST 7 - SOUTHEAST 4 - WEST 8 - SOUTHWEST 9 - OTHER / UNKNOWN	
UNIT SPEED 1 0	DETECTED SPEED 1 - STATED / ESTIMATED SPEED 2 - CALCULATED / EDR 3 - UNDETERMINED
POSTED SPEED 2 5	

OWNER	UNIT # 02	OWNER NAME: LAST, FIRST, MIDDLE (X SAME AS DRIVER)	OWNER PHONE: INCLUDE AREA CODE (X SAME AS DRIVER)
	OWNER ADDRESS: STREET, CITY, STATE, ZIP (X SAME AS DRIVER)		
VEHICLE	COMMERCIAL CARRIER: NAME, ADDRESS, CITY, STATE, ZIP		COMMERCIAL CARRIER PHONE: INCLUDE AREA CODE
	LP STATE OH	LICENSE PLATE # GQY1475	VEHICLE IDENTIFICATION # 3V V 1 2 B 1 7 A X 0 K M 1 3 7 7 2 4
EVENT(S)	INSURANCE VERIFIED X	INSURANCE COMPANY Geico	INSURANCE POLICY # 4282258013
	TYPE OF USE <input type="checkbox"/> COMMERCIAL <input type="checkbox"/> GOVERNMENT <input type="checkbox"/> IN EMERGENCY RESPONSE	US DOT #	TOWED BY: COMPANY NAME
	INTERLOCK DEVICE EQUIPPED <input type="checkbox"/>	HIT/SKIP UNIT <input type="checkbox"/>	#OCCUPANTS 02
	VEHICLE WEIGHT GVWR/GCWR 1 - <10K LBS. 2 - 10,001 - 26K LBS. 3 - >26K LBS.		
	HAZARDOUS MATERIAL <input type="checkbox"/> MATERIAL RELEASED <input type="checkbox"/> PLACARD		
	UNIT TYPE 03		
	# OF TRAILING UNITS 0		
	WAS VEHICLE OPERATING IN AUTONOMOUS MODE WHEN CRASH OCCURRED? 0		
	AUTONOMOUS MODE LEVEL 0		
	SPECIAL FUNCTION 01		
CARGO BODY TYPE 01			
VEHICLE DEFECTS			
NON-MOTORIST LOCATION AT IMPACT			
ACTION 04			
CONTRIBUTING CIRCUMSTANCES 01			
SEQUENCE OF EVENTS			
FIRST HARMFUL EVENT 1			
MOST HARMFUL EVENT 1			

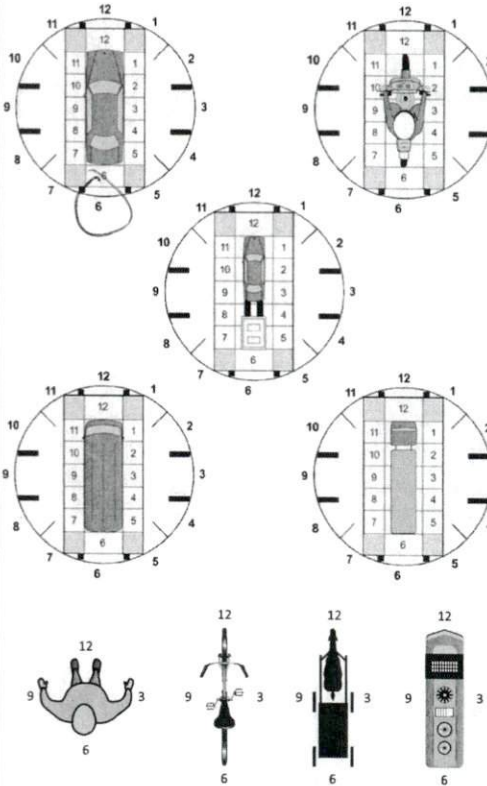
LOCAL REPORT NUMBER 2 2 0 5 7 2 3 0	
DAMAGE	
DAMAGE SCALE 2 1 - NONE 3 - FUNCTIONAL DAMAGE 2 - MINOR DAMAGE 4 - DISABLING DAMAGE 9 - UNKNOWN	
DAMAGED AREA(S) INDICATE ALL THAT APPLY	
	
<input type="checkbox"/> - NO DAMAGE [0] <input type="checkbox"/> - UNDERCARRIAGE [14] <input type="checkbox"/> - TOP [13] <input type="checkbox"/> - ALL AREAS [15] <input type="checkbox"/> - UNIT NOT AT SCENE [16]	
INITIAL POINT OF CONTACT 0 - NO DAMAGE 14 - UNDERCARRIAGE 1-12 - REFER TO UNIT DIAGRAM 15 - VEHICLE NOT AT SCENE 13 - TOP 99 - UNKNOWN	
TRAFFIC	
TRAFFICWAY FLOW 2 1 - ONE-WAY 2 2 - TWO-WAY	TRAFFIC CONTROL 2 1 - ROUNDABOUT 4 - STOP SIGN 2 - SIGNAL 5 - YIELD SIGN 3 - FLASHER 6 - NO CONTROL
# OF THROUGH LANES ON ROAD 2	RAIL GRADE CROSSING 1 - NOT INVOLVED 2 - INVOLVED-ACTIVE CROSSING 3 - INVOLVED-PASSIVE CROSSING
UNIT / NON-MOTORIST DIRECTION FROM 3 TO 4	
UNIT SPEED 0	DETECTED SPEED 1 1 - STATED / ESTIMATED SPEED 2 - CALCULATED / EDR 3 - UNDETERMINED
POSTED SPEED 2 5	

MOTORIST / Non-MOTORIST

LOCAL REPORT NUMBER																																																																																																																																																																																																
2 2 0 5 7 2 3 0																																																																																																																																																																																																
UNIT #	NAME: LAST, FIRST, MIDDLE				DATE OF BIRTH		AGE	GENDER																																																																																																																																																																																								
0 1	Smith, Sierra				0 7 1 5 1 9 9 3		2 9	F																																																																																																																																																																																								
ADDRESS: STREET, CITY, STATE, ZIP					CONTACT PHONE - INCLUDE AREA CODE																																																																																																																																																																																											
2585 Augusta Blvd, Fairfield, OH 45014																																																																																																																																																																																																
INJURIES	INJURED TAKEN BY	EMS AGENCY (NAME)	INJURED TAKEN TO:	MEDICAL FACILITY (NAME, CITY)	SAFETY EQUIPMENT USED	DOT-COMPLIANT MC HELMET	SEATING POSITION	AIR BAG USAGE	EJECTION	TRAPPED																																																																																																																																																																																						
5					0 4	<input type="checkbox"/>	0 1	1	1	1																																																																																																																																																																																						
OL STATE	OPERATOR LICENSE NUMBER		OFFENSE CHARGED	LOCAL CODE	OFFENSE DESCRIPTION		CITATION NUMBER																																																																																																																																																																																									
O H			333.03A	<input checked="" type="checkbox"/>	ACDA		255232																																																																																																																																																																																									
OL CLASS	ENDORSEMENT SELECT UP TO 2	RESTRICTION SELECT UP TO 3	DRIVER DISTRACTED BY	ALCOHOL / DRUG SUSPECTED	CONDITION	ALCOHOL TEST		DRUG TEST(S)																																																																																																																																																																																								
4			1	<input type="checkbox"/> ALCOHOL <input type="checkbox"/> MARIJUANA <input type="checkbox"/> OTHER DRUG	1	STATUS	TYPE	VALUE	STATUS	TYPE																																																																																																																																																																																						
						1	1		1	1																																																																																																																																																																																						
UNIT #	NAME: LAST, FIRST, MIDDLE				DATE OF BIRTH		AGE	GENDER																																																																																																																																																																																								
0 2	Geraci, Karen				0 6 0 1 1 9 7 4		4 8	F																																																																																																																																																																																								
ADDRESS: STREET, CITY, STATE, ZIP					CONTACT PHONE - INCLUDE AREA CODE																																																																																																																																																																																											
5879 Kingsmont Drive, Fairfield, OH 45014																																																																																																																																																																																																
INJURIES	INJURED TAKEN BY	EMS AGENCY (NAME)	INJURED TAKEN TO:	MEDICAL FACILITY (NAME, CITY)	SAFETY EQUIPMENT USED	DOT-COMPLIANT MC HELMET	SEATING POSITION	AIR BAG USAGE	EJECTION	TRAPPED																																																																																																																																																																																						
5					0 4	<input type="checkbox"/>	0 1	1	1	1																																																																																																																																																																																						
OL STATE	OPERATOR LICENSE NUMBER		OFFENSE CHARGED	LOCAL CODE	OFFENSE DESCRIPTION		CITATION NUMBER																																																																																																																																																																																									
O H				<input type="checkbox"/>																																																																																																																																																																																												
OL CLASS	ENDORSEMENT SELECT UP TO 2	RESTRICTION SELECT UP TO 3	DRIVER DISTRACTED BY	ALCOHOL / DRUG SUSPECTED	CONDITION	ALCOHOL TEST		DRUG TEST(S)																																																																																																																																																																																								
4			1	<input type="checkbox"/> ALCOHOL <input type="checkbox"/> MARIJUANA <input type="checkbox"/> OTHER DRUG	1	STATUS	TYPE	VALUE	STATUS	TYPE																																																																																																																																																																																						
						1	1		1	1																																																																																																																																																																																						
UNIT #	NAME: LAST, FIRST, MIDDLE				DATE OF BIRTH		AGE	GENDER																																																																																																																																																																																								
							0																																																																																																																																																																																									
ADDRESS: STREET, CITY, STATE, ZIP					CONTACT PHONE - INCLUDE AREA CODE																																																																																																																																																																																											
INJURIES	INJURED TAKEN BY	EMS AGENCY (NAME)	INJURED TAKEN TO:	MEDICAL FACILITY (NAME, CITY)	SAFETY EQUIPMENT USED	DOT-COMPLIANT MC HELMET	SEATING POSITION	AIR BAG USAGE	EJECTION	TRAPPED																																																																																																																																																																																						
						<input type="checkbox"/>																																																																																																																																																																																										
OL STATE	OPERATOR LICENSE NUMBER		OFFENSE CHARGED	LOCAL CODE	OFFENSE DESCRIPTION		CITATION NUMBER																																																																																																																																																																																									
				<input type="checkbox"/>																																																																																																																																																																																												
OL CLASS	ENDORSEMENT SELECT UP TO 2	RESTRICTION SELECT UP TO 3	DRIVER DISTRACTED BY	ALCOHOL / DRUG SUSPECTED	CONDITION	ALCOHOL TEST		DRUG TEST(S)																																																																																																																																																																																								
				<input type="checkbox"/> ALCOHOL <input type="checkbox"/> MARIJUANA <input type="checkbox"/> OTHER DRUG		STATUS	TYPE	VALUE	STATUS	TYPE																																																																																																																																																																																						
<table border="1"><thead><tr><th>INJURIES</th><th>SEATING POSITION</th><th>AIR BAG</th><th>OL CLASS</th><th>OL RESTRICTION(S)</th><th>DRIVER DISTRACTION</th><th>TEST STATUS</th></tr></thead><tbody><tr><td>1 - FATAL</td><td>1 - FRONT - LEFT SIDE (MOTORCYCLE DRIVER)</td><td>1 - NOT DEPLOYED</td><td>1 - CLASS A</td><td>1 - ALCOHOL INTERLOCK DEVICE</td><td>1 - NOT DISTRACTED</td><td>1 - NONE GIVEN</td></tr><tr><td>2 - SUSPECTED SERIOUS INJURY</td><td>2 - FRONT - MIDDLE</td><td>2 - DEPLOYED FRONT</td><td>2 - CLASS B</td><td>2 - CDL INTRASTATE ONLY</td><td>2 - MANUALLY OPERATING AN ELECTRONIC COMMUNICATION DEVICE (TEXTING, TYPING, DIALING)</td><td>2 - TEST REFUSED</td></tr><tr><td>3 - SUSPECTED MINOR INJURY</td><td>3 - FRONT - RIGHT SIDE</td><td>3 - DEPLOYED SIDE</td><td>3 - CLASS C</td><td>3 - CORRECTIVE LENSES</td><td>3 - TALKING ON HANDS-FREE COMMUNICATION DEVICE</td><td>3 - TEST GIVEN, CONTAMINATED SAMPLE / UNUSABLE</td></tr><tr><td>4 - POSSIBLE INJURY</td><td>4 - SECOND - LEFT SIDE (MOTORCYCLE PASSENGER)</td><td>4 - DEPLOYED BOTH FRONT / SIDE</td><td>4 - REGULAR CLASS (OHIO = D)</td><td>4 - FARM WAIVER</td><td>4 - TALKING ON HAND-HELD COMMUNICATION DEVICE</td><td>4 - TEST GIVEN, RESULTS KNOWN</td></tr><tr><td>5 - NO APPARENT INJURY</td><td>5 - SECOND - MIDDLE</td><td>5 - NOT APPLICABLE</td><td>5 - MIC MOPED ONLY</td><td>5 - EXCEPT CLASS A BUS</td><td>5 - OTHER ACTIVITY WITH AN ELECTRONIC DEVICE</td><td>5 - TEST GIVEN, RESULTS UNKNOWN</td></tr><tr><td>INJURED TAKEN BY</td><td>6 - SECOND - RIGHT SIDE</td><td>9 - DEPLOYMENT UNKNOWN</td><td>6 - NO VALID OL</td><td>6 - EXCEPT CLASS A & CLASS B BUS</td><td>6 - PASSENGER</td><td>ALCOHOL TEST TYPE</td></tr><tr><td>1 - NOT TRANSPORTED / TREATED AT SCENE</td><td>7 - THIRD - LEFT SIDE (MOTORCYCLE SIDE CAR)</td><td>EJECTION</td><td>OL ENDORSEMENT</td><td>7 - EXCEPT TRACTOR-TRAILER</td><td>7 - OTHER DISTRACTION INSIDE THE VEHICLE</td><td>1 - NONE</td></tr><tr><td>2 - EMS</td><td>8 - THIRD - MIDDLE</td><td>1 - NOT EJECTED</td><td>H - HAZMAT</td><td>8 - INTERMEDIATE LICENSE RESTRICTIONS</td><td>8 - OTHER DISTRACTION OUTSIDE THE VEHICLE</td><td>2 - BLOOD</td></tr><tr><td>3 - POLICE</td><td>9 - THIRD - RIGHT SIDE</td><td>2 - PARTIALLY EJECTED</td><td>M - MOTORCYCLE</td><td>9 - LEARNER'S PERMIT RESTRICTIONS</td><td>9 - OTHER / UNKNOWN</td><td>3 - URINE</td></tr><tr><td>9 - OTHER / UNKNOWN</td><td>10 - SLEEPER SECTION OF TRUCK CAB</td><td>3 - TOTALLY EJECTED</td><td>P - PASSENGER</td><td>10 - LIMITED TO DAYLIGHT ONLY</td><td>CONDITION</td><td>4 - BREATH</td></tr><tr><td>SAFETY EQUIPMENT</td><td>11 - PASSENGER IN OTHER ENCLOSED CARGO AREA (NON-TRAILING UNIT, BUS, PICK-UP WITH CAP)</td><td>4 - NOT APPLICABLE</td><td>N - TANKER</td><td>11 - LIMITED TO EMPLOYMENT</td><td>1 - APPARENTLY NORMAL</td><td>5 - OTHER</td></tr><tr><td>1 - NONE USED</td><td>12 - PASSENGER IN UNENCLOSED CARGO AREA</td><td>TRAPPED</td><td>Q - MOTOR SCOOTER</td><td>12 - LIMITED - OTHER</td><td>2 - PHYSICAL IMPAIRMENT</td><td>DRUG TEST TYPE</td></tr><tr><td>2 - SHOULDER BELT ONLY USED</td><td>13 - TRAILING UNIT</td><td>1 - NOT TRAPPED</td><td>R - THREE-WHEEL MOTORCYCLE</td><td>13 - MECHANICAL DEVICES (SPECIAL BRAKES, HAND CONTROLS, OR OTHER ADAPTIVE DEVICES)</td><td>3 - EMOTIONAL (E.G. DEPRESSED, ANGRY, DISTURBED)</td><td>1 - NONE</td></tr><tr><td>3 - LAP BELT ONLY USED</td><td>14 - RIDING ON VEHICLE EXTERIOR (NON-TRAILING UNIT)</td><td>2 - EXTRICATED BY MECHANICAL MEANS</td><td>S - SCHOOL BUS</td><td>14 - MILITARY VEHICLES ONLY</td><td>4 - ILLNESS</td><td>2 - BLOOD</td></tr><tr><td>4 - SHOULDER & LAP BELT USED</td><td>15 - NON-MOTORIST</td><td>3 - FREED BY NON-MECHANICAL MEANS</td><td>T - DOUBLE & TRIPLE TRAILERS</td><td>15 - MOTOR VEHICLES WITHOUT AIR BRAKES</td><td>5 - FELL ASLEEP, FAINTED, FATIGUED, ETC.</td><td>3 - URINE</td></tr><tr><td>5 - CHILD RESTRAINT SYSTEM - FORWARD FACING</td><td>99 - OTHER / UNKNOWN</td><td>GENDER</td><td>X - TANKER / HAZMAT</td><td>16 - OUTSIDE MIRROR</td><td>6 - UNDER THE INFLUENCE OF MEDICATIONS / DRUGS / ALCOHOL</td><td>4 - OTHER</td></tr><tr><td>6 - CHILD RESTRAINT SYSTEM - REAR FACING</td><td></td><td>F - FEMALE</td><td></td><td>17 - PROSTHETIC AID</td><td>9 - OTHER / UNKNOWN</td><td>DRUG TEST RESULT(S)</td></tr><tr><td>7 - BOOSTER SEAT</td><td></td><td>M - MALE</td><td></td><td>18 - OTHER</td><td></td><td>1 - AMPHETAMINES</td></tr><tr><td>8 - HELMET USED</td><td></td><td>U - OTHER / UNKNOWN</td><td></td><td></td><td></td><td>2 - BARBITURATES</td></tr><tr><td>9 - PROTECTIVE PADS USED (ELBOW, KNEES, ETC.)</td><td></td><td></td><td></td><td></td><td></td><td>3 - BENZODIAZEPINES</td></tr><tr><td>10 - REFLECTIVE CLOTHING</td><td></td><td></td><td></td><td></td><td></td><td>4 - CANNABINOIDS</td></tr><tr><td>11 - LIGHTING - PEDESTRIAN / BICYCLE ONLY</td><td></td><td></td><td></td><td></td><td></td><td>5 - COCAINE</td></tr><tr><td>99 - OTHER / UNKNOWN</td><td></td><td></td><td></td><td></td><td></td><td>6 - OPIATES / OPIOIDS</td></tr><tr><td></td><td></td><td></td><td></td><td></td><td></td><td>7 - OTHER</td></tr><tr><td></td><td></td><td></td><td></td><td></td><td></td><td>8 - NEGATIVE RESULTS</td></tr></tbody></table>											INJURIES	SEATING POSITION	AIR BAG	OL CLASS	OL RESTRICTION(S)	DRIVER DISTRACTION	TEST STATUS	1 - FATAL	1 - FRONT - LEFT SIDE (MOTORCYCLE DRIVER)	1 - NOT DEPLOYED	1 - CLASS A	1 - ALCOHOL INTERLOCK DEVICE	1 - NOT DISTRACTED	1 - NONE GIVEN	2 - SUSPECTED SERIOUS INJURY	2 - FRONT - MIDDLE	2 - DEPLOYED FRONT	2 - CLASS B	2 - CDL INTRASTATE ONLY	2 - MANUALLY OPERATING AN ELECTRONIC COMMUNICATION DEVICE (TEXTING, TYPING, DIALING)	2 - TEST REFUSED	3 - SUSPECTED MINOR INJURY	3 - FRONT - RIGHT SIDE	3 - DEPLOYED SIDE	3 - CLASS C	3 - CORRECTIVE LENSES	3 - TALKING ON HANDS-FREE COMMUNICATION DEVICE	3 - TEST GIVEN, CONTAMINATED SAMPLE / UNUSABLE	4 - POSSIBLE INJURY	4 - SECOND - LEFT SIDE (MOTORCYCLE PASSENGER)	4 - DEPLOYED BOTH FRONT / SIDE	4 - REGULAR CLASS (OHIO = D)	4 - FARM WAIVER	4 - TALKING ON HAND-HELD COMMUNICATION DEVICE	4 - TEST GIVEN, RESULTS KNOWN	5 - NO APPARENT INJURY	5 - SECOND - MIDDLE	5 - NOT APPLICABLE	5 - MIC MOPED ONLY	5 - EXCEPT CLASS A BUS	5 - OTHER ACTIVITY WITH AN ELECTRONIC DEVICE	5 - TEST GIVEN, RESULTS UNKNOWN	INJURED TAKEN BY	6 - SECOND - RIGHT SIDE	9 - DEPLOYMENT UNKNOWN	6 - NO VALID OL	6 - EXCEPT CLASS A & CLASS B BUS	6 - PASSENGER	ALCOHOL TEST TYPE	1 - NOT TRANSPORTED / TREATED AT SCENE	7 - THIRD - LEFT SIDE (MOTORCYCLE SIDE CAR)	EJECTION	OL ENDORSEMENT	7 - EXCEPT TRACTOR-TRAILER	7 - OTHER DISTRACTION INSIDE THE VEHICLE	1 - NONE	2 - EMS	8 - THIRD - MIDDLE	1 - NOT EJECTED	H - HAZMAT	8 - INTERMEDIATE LICENSE RESTRICTIONS	8 - OTHER DISTRACTION OUTSIDE THE VEHICLE	2 - BLOOD	3 - POLICE	9 - THIRD - RIGHT SIDE	2 - PARTIALLY EJECTED	M - MOTORCYCLE	9 - LEARNER'S PERMIT RESTRICTIONS	9 - OTHER / UNKNOWN	3 - URINE	9 - OTHER / UNKNOWN	10 - SLEEPER SECTION OF TRUCK CAB	3 - TOTALLY EJECTED	P - PASSENGER	10 - LIMITED TO DAYLIGHT ONLY	CONDITION	4 - BREATH	SAFETY EQUIPMENT	11 - PASSENGER IN OTHER ENCLOSED CARGO AREA (NON-TRAILING UNIT, BUS, PICK-UP WITH CAP)	4 - NOT APPLICABLE	N - TANKER	11 - LIMITED TO EMPLOYMENT	1 - APPARENTLY NORMAL	5 - OTHER	1 - NONE USED	12 - PASSENGER IN UNENCLOSED CARGO AREA	TRAPPED	Q - MOTOR SCOOTER	12 - LIMITED - OTHER	2 - PHYSICAL IMPAIRMENT	DRUG TEST TYPE	2 - SHOULDER BELT ONLY USED	13 - TRAILING UNIT	1 - NOT TRAPPED	R - THREE-WHEEL MOTORCYCLE	13 - MECHANICAL DEVICES (SPECIAL BRAKES, HAND CONTROLS, OR OTHER ADAPTIVE DEVICES)	3 - EMOTIONAL (E.G. DEPRESSED, ANGRY, DISTURBED)	1 - NONE	3 - LAP BELT ONLY USED	14 - RIDING ON VEHICLE EXTERIOR (NON-TRAILING UNIT)	2 - EXTRICATED BY MECHANICAL MEANS	S - SCHOOL BUS	14 - MILITARY VEHICLES ONLY	4 - ILLNESS	2 - BLOOD	4 - SHOULDER & LAP BELT USED	15 - NON-MOTORIST	3 - FREED BY NON-MECHANICAL MEANS	T - DOUBLE & TRIPLE TRAILERS	15 - MOTOR VEHICLES WITHOUT AIR BRAKES	5 - FELL ASLEEP, FAINTED, FATIGUED, ETC.	3 - URINE	5 - CHILD RESTRAINT SYSTEM - FORWARD FACING	99 - OTHER / UNKNOWN	GENDER	X - TANKER / HAZMAT	16 - OUTSIDE MIRROR	6 - UNDER THE INFLUENCE OF MEDICATIONS / DRUGS / ALCOHOL	4 - OTHER	6 - CHILD RESTRAINT SYSTEM - REAR FACING		F - FEMALE		17 - PROSTHETIC AID	9 - OTHER / UNKNOWN	DRUG TEST RESULT(S)	7 - BOOSTER SEAT		M - MALE		18 - OTHER		1 - AMPHETAMINES	8 - HELMET USED		U - OTHER / UNKNOWN				2 - BARBITURATES	9 - PROTECTIVE PADS USED (ELBOW, KNEES, ETC.)						3 - BENZODIAZEPINES	10 - REFLECTIVE CLOTHING						4 - CANNABINOIDS	11 - LIGHTING - PEDESTRIAN / BICYCLE ONLY						5 - COCAINE	99 - OTHER / UNKNOWN						6 - OPIATES / OPIOIDS							7 - OTHER							8 - NEGATIVE RESULTS
INJURIES	SEATING POSITION	AIR BAG	OL CLASS	OL RESTRICTION(S)	DRIVER DISTRACTION	TEST STATUS																																																																																																																																																																																										
1 - FATAL	1 - FRONT - LEFT SIDE (MOTORCYCLE DRIVER)	1 - NOT DEPLOYED	1 - CLASS A	1 - ALCOHOL INTERLOCK DEVICE	1 - NOT DISTRACTED	1 - NONE GIVEN																																																																																																																																																																																										
2 - SUSPECTED SERIOUS INJURY	2 - FRONT - MIDDLE	2 - DEPLOYED FRONT	2 - CLASS B	2 - CDL INTRASTATE ONLY	2 - MANUALLY OPERATING AN ELECTRONIC COMMUNICATION DEVICE (TEXTING, TYPING, DIALING)	2 - TEST REFUSED																																																																																																																																																																																										
3 - SUSPECTED MINOR INJURY	3 - FRONT - RIGHT SIDE	3 - DEPLOYED SIDE	3 - CLASS C	3 - CORRECTIVE LENSES	3 - TALKING ON HANDS-FREE COMMUNICATION DEVICE	3 - TEST GIVEN, CONTAMINATED SAMPLE / UNUSABLE																																																																																																																																																																																										
4 - POSSIBLE INJURY	4 - SECOND - LEFT SIDE (MOTORCYCLE PASSENGER)	4 - DEPLOYED BOTH FRONT / SIDE	4 - REGULAR CLASS (OHIO = D)	4 - FARM WAIVER	4 - TALKING ON HAND-HELD COMMUNICATION DEVICE	4 - TEST GIVEN, RESULTS KNOWN																																																																																																																																																																																										
5 - NO APPARENT INJURY	5 - SECOND - MIDDLE	5 - NOT APPLICABLE	5 - MIC MOPED ONLY	5 - EXCEPT CLASS A BUS	5 - OTHER ACTIVITY WITH AN ELECTRONIC DEVICE	5 - TEST GIVEN, RESULTS UNKNOWN																																																																																																																																																																																										
INJURED TAKEN BY	6 - SECOND - RIGHT SIDE	9 - DEPLOYMENT UNKNOWN	6 - NO VALID OL	6 - EXCEPT CLASS A & CLASS B BUS	6 - PASSENGER	ALCOHOL TEST TYPE																																																																																																																																																																																										
1 - NOT TRANSPORTED / TREATED AT SCENE	7 - THIRD - LEFT SIDE (MOTORCYCLE SIDE CAR)	EJECTION	OL ENDORSEMENT	7 - EXCEPT TRACTOR-TRAILER	7 - OTHER DISTRACTION INSIDE THE VEHICLE	1 - NONE																																																																																																																																																																																										
2 - EMS	8 - THIRD - MIDDLE	1 - NOT EJECTED	H - HAZMAT	8 - INTERMEDIATE LICENSE RESTRICTIONS	8 - OTHER DISTRACTION OUTSIDE THE VEHICLE	2 - BLOOD																																																																																																																																																																																										
3 - POLICE	9 - THIRD - RIGHT SIDE	2 - PARTIALLY EJECTED	M - MOTORCYCLE	9 - LEARNER'S PERMIT RESTRICTIONS	9 - OTHER / UNKNOWN	3 - URINE																																																																																																																																																																																										
9 - OTHER / UNKNOWN	10 - SLEEPER SECTION OF TRUCK CAB	3 - TOTALLY EJECTED	P - PASSENGER	10 - LIMITED TO DAYLIGHT ONLY	CONDITION	4 - BREATH																																																																																																																																																																																										
SAFETY EQUIPMENT	11 - PASSENGER IN OTHER ENCLOSED CARGO AREA (NON-TRAILING UNIT, BUS, PICK-UP WITH CAP)	4 - NOT APPLICABLE	N - TANKER	11 - LIMITED TO EMPLOYMENT	1 - APPARENTLY NORMAL	5 - OTHER																																																																																																																																																																																										
1 - NONE USED	12 - PASSENGER IN UNENCLOSED CARGO AREA	TRAPPED	Q - MOTOR SCOOTER	12 - LIMITED - OTHER	2 - PHYSICAL IMPAIRMENT	DRUG TEST TYPE																																																																																																																																																																																										
2 - SHOULDER BELT ONLY USED	13 - TRAILING UNIT	1 - NOT TRAPPED	R - THREE-WHEEL MOTORCYCLE	13 - MECHANICAL DEVICES (SPECIAL BRAKES, HAND CONTROLS, OR OTHER ADAPTIVE DEVICES)	3 - EMOTIONAL (E.G. DEPRESSED, ANGRY, DISTURBED)	1 - NONE																																																																																																																																																																																										
3 - LAP BELT ONLY USED	14 - RIDING ON VEHICLE EXTERIOR (NON-TRAILING UNIT)	2 - EXTRICATED BY MECHANICAL MEANS	S - SCHOOL BUS	14 - MILITARY VEHICLES ONLY	4 - ILLNESS	2 - BLOOD																																																																																																																																																																																										
4 - SHOULDER & LAP BELT USED	15 - NON-MOTORIST	3 - FREED BY NON-MECHANICAL MEANS	T - DOUBLE & TRIPLE TRAILERS	15 - MOTOR VEHICLES WITHOUT AIR BRAKES	5 - FELL ASLEEP, FAINTED, FATIGUED, ETC.	3 - URINE																																																																																																																																																																																										
5 - CHILD RESTRAINT SYSTEM - FORWARD FACING	99 - OTHER / UNKNOWN	GENDER	X - TANKER / HAZMAT	16 - OUTSIDE MIRROR	6 - UNDER THE INFLUENCE OF MEDICATIONS / DRUGS / ALCOHOL	4 - OTHER																																																																																																																																																																																										
6 - CHILD RESTRAINT SYSTEM - REAR FACING		F - FEMALE		17 - PROSTHETIC AID	9 - OTHER / UNKNOWN	DRUG TEST RESULT(S)																																																																																																																																																																																										
7 - BOOSTER SEAT		M - MALE		18 - OTHER		1 - AMPHETAMINES																																																																																																																																																																																										
8 - HELMET USED		U - OTHER / UNKNOWN				2 - BARBITURATES																																																																																																																																																																																										
9 - PROTECTIVE PADS USED (ELBOW, KNEES, ETC.)						3 - BENZODIAZEPINES																																																																																																																																																																																										
10 - REFLECTIVE CLOTHING						4 - CANNABINOIDS																																																																																																																																																																																										
11 - LIGHTING - PEDESTRIAN / BICYCLE ONLY						5 - COCAINE																																																																																																																																																																																										
99 - OTHER / UNKNOWN						6 - OPIATES / OPIOIDS																																																																																																																																																																																										
						7 - OTHER																																																																																																																																																																																										
						8 - NEGATIVE RESULTS																																																																																																																																																																																										

OCCUPANT / WITNESS ADDENDUM

LOCAL REPORT NUMBER									
2	2	0	5	7	2	3	0		

OCCUPANT	UNIT # 2	NAME: LAST, FIRST, MIDDLE Lightfield, Ian			DATE OF BIRTH 1 1 2 2 2 0 1 0		AGE 1 1	GENDER M	
	ADDRESS: STREET, CITY, STATE, ZIP 5879 Kingsmont Drive, Fairfield, OH 45014				CONTACT PHONE - INCLUDE AREA CODE				
	INJURIES 5	INJURED TAKEN BY	EMS AGENCY (NAME)	INJURED TAKEN TO: MEDICAL FACILITY (NAME, CITY)	SAFETY EQUIPMENT USED 0 4	<input type="checkbox"/> DOT-COMPLIANT MC HELMET	SEATING POSITION 0 3	AIR BAG USAGE 0 1	EJECTION 1

OCCUPANT	UNIT #	NAME: LAST, FIRST, MIDDLE			DATE OF BIRTH		AGE 0	GENDER	
	ADDRESS: STREET, CITY, STATE, ZIP				CONTACT PHONE - INCLUDE AREA CODE				
	INJURIES	INJURED TAKEN BY	EMS AGENCY (NAME)	INJURED TAKEN TO: MEDICAL FACILITY (NAME, CITY)	SAFETY EQUIPMENT USED	<input type="checkbox"/> DOT-COMPLIANT MC HELMET	SEATING POSITION	AIR BAG USAGE	EJECTION

OCCUPANT	UNIT #	NAME: LAST, FIRST, MIDDLE			DATE OF BIRTH		AGE 0	GENDER	
	ADDRESS: STREET, CITY, STATE, ZIP				CONTACT PHONE - INCLUDE AREA CODE				
	INJURIES	INJURED TAKEN BY	EMS AGENCY (NAME)	INJURED TAKEN TO: MEDICAL FACILITY (NAME, CITY)	SAFETY EQUIPMENT USED	<input type="checkbox"/> DOT-COMPLIANT MC HELMET	SEATING POSITION	AIR BAG USAGE	EJECTION

OCCUPANT	UNIT #	NAME: LAST, FIRST, MIDDLE			DATE OF BIRTH		AGE 0	GENDER	
	ADDRESS: STREET, CITY, STATE, ZIP				CONTACT PHONE - INCLUDE AREA CODE				
	INJURIES	INJURED TAKEN BY	EMS AGENCY (NAME)	INJURED TAKEN TO: MEDICAL FACILITY (NAME, CITY)	SAFETY EQUIPMENT USED	<input type="checkbox"/> DOT-COMPLIANT MC HELMET	SEATING POSITION	AIR BAG USAGE	EJECTION

INJURIES	SAFETY EQUIPMENT USED	SEATING POSITION	AIR BAG USAGE
1 - FATAL	1 - NONE USED - VEHICLE OCCUPANT	1 - FRONT - LEFT SIDE (MOTORCYCLE DRIVER)	1 - NOT DEPLOYED
2 - SUSPECTED SERIOUS INJURY	2 - SHOULDER BELT ONLY USED	2 - FRONT - MIDDLE	2 - DEPLOYED FRONT
3 - SUSPECTED MINOR INJURY	3 - LAP BELT ONLY USED	3 - FRONT - RIGHT SIDE	3 - DEPLOYED SIDE
4 - POSSIBLE INJURY	4 - SHOULDER & LAP BELT USED	4 - SECOND - LEFT SIDE (MOTORCYCLE PASSENGER)	4 - DEPLOYED BOTH FRONT/SIDE
5 - NO APPARENT INJURY	5 - CHILD RESTRAINT SYSTEM - FORWARD FACING	5 - SECOND - MIDDLE	5 - NOT APPLICABLE
	6 - CHILD RESTRAINT SYSTEM - REAR FACING	6 - SECOND - RIGHT SIDE	9 - DEPLOYMENT UNKNOWN
INJURED TAKEN BY	7 - BOOSTER SEAT	7 - THIRD - LEFT SIDE (MOTORCYCLE SIDE CAR)	
1 - NOT TRANSPORTED / TREATED AT SCENE	8 - HELMET USED	8 - THIRD - MIDDLE	EJECTION
2 - EMS	9 - PROTECTIVE PADS USED (ELBOW, KNEES, ETC.)	9 - THIRD - RIGHT SIDE	1 - NOT EJECTED
3 - POLICE	10 - REFLECTIVE CLOTHING	10 - SLEEPER SECTION OF TRUCK CAB	2 - PARTIALLY EJECTED
9 - OTHER / UNKNOWN	11 - LIGHTING - PEDESTRIAN / BICYCLE ONLY	11 - PASSENGER IN OTHER ENCLOSED CARGO AREA (NON-TRAILING UNIT, BUS, PICK-UP WITH CAP)	3 - TOTALLY EJECTED
GENDER	99 - OTHER / UNKNOWN	12 - PASSENGER IN UNENCLOSED CARGO AREA	4 - NOT APPLICABLE
F - FEMALE		13 - TRAILING UNIT	TRAPPED
M - MALE		14 - RIDING ON VEHICLE EXTERIOR (NON-TRAILING UNIT)	1 - NOT TRAPPED
U - OTHER / UNKNOWN		15 - NON-MOTORIST	2 - EXTRICATED BY MECHANICAL MEANS
		99 - OTHER / UNKNOWN	3 - FREED BY NON-MECHANICAL MEANS

WITNESS	NAME: LAST, FIRST, MIDDLE	DATE OF BIRTH		AGE 0	GENDER
	ADDRESS: STREET, CITY, STATE, ZIP				CONTACT PHONE - INCLUDE AREA CODE

WITNESS	NAME: LAST, FIRST, MIDDLE	DATE OF BIRTH		AGE 0	GENDER
	ADDRESS: STREET, CITY, STATE, ZIP				CONTACT PHONE - INCLUDE AREA CODE

WITNESS	NAME: LAST, FIRST, MIDDLE	DATE OF BIRTH		AGE 0	GENDER
	ADDRESS: STREET, CITY, STATE, ZIP				CONTACT PHONE - INCLUDE AREA CODE

NUMBER PD-22-057230

FAIRFIELD P.D. 00901

M 08 10 10 14 22

IN COUNTY OF

BUTLER

ACCIDENT
LOCATION

Resor Rd // Pleasant Ave

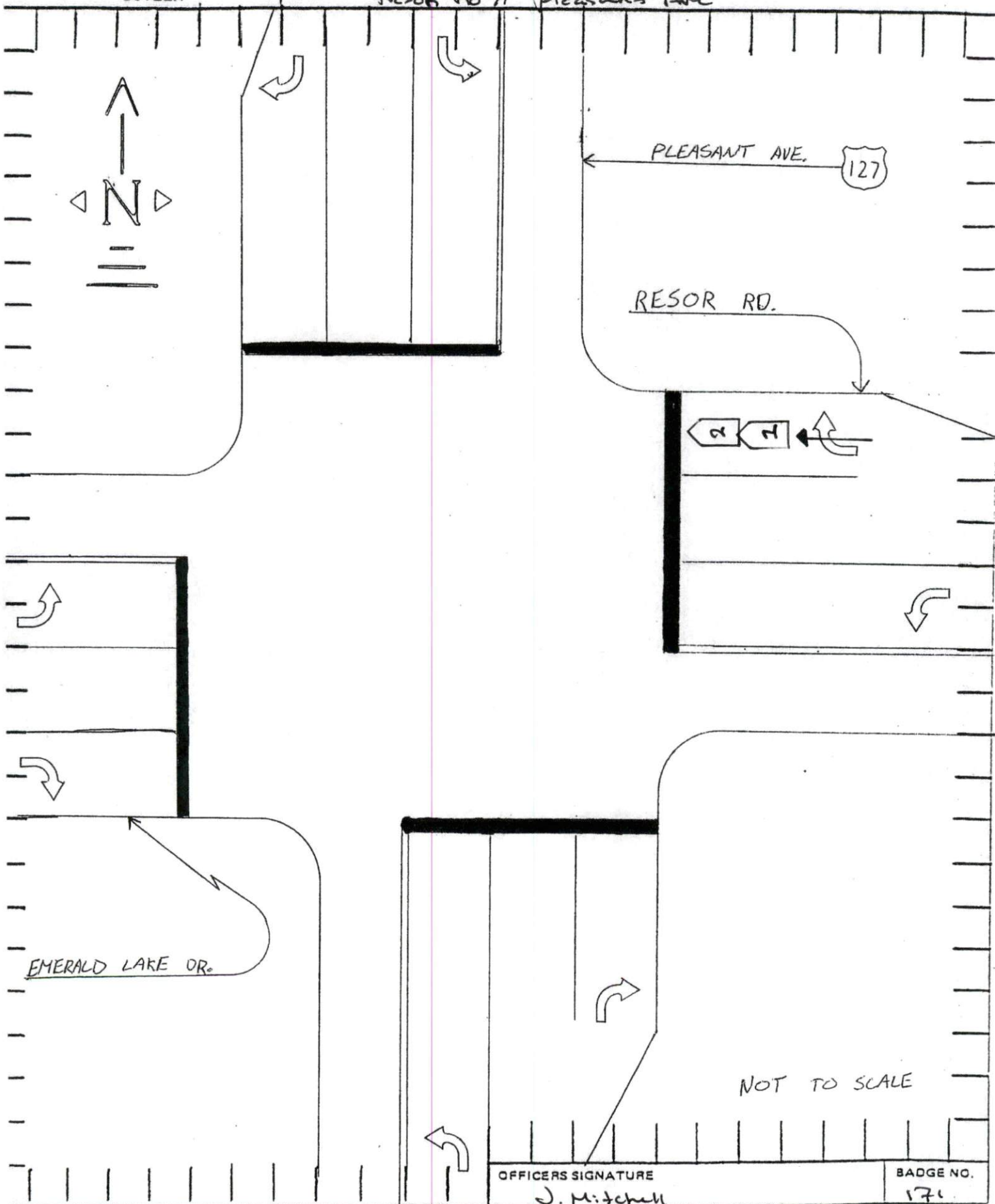

OFFICERS SIGNATURE

J. Mitchell

BADGE NO.

171