

**Exterior Door Identification**

DATE: 05/13/2020

SCALE: NONE

FILE: 2020-041.DWG

Street B

Street A

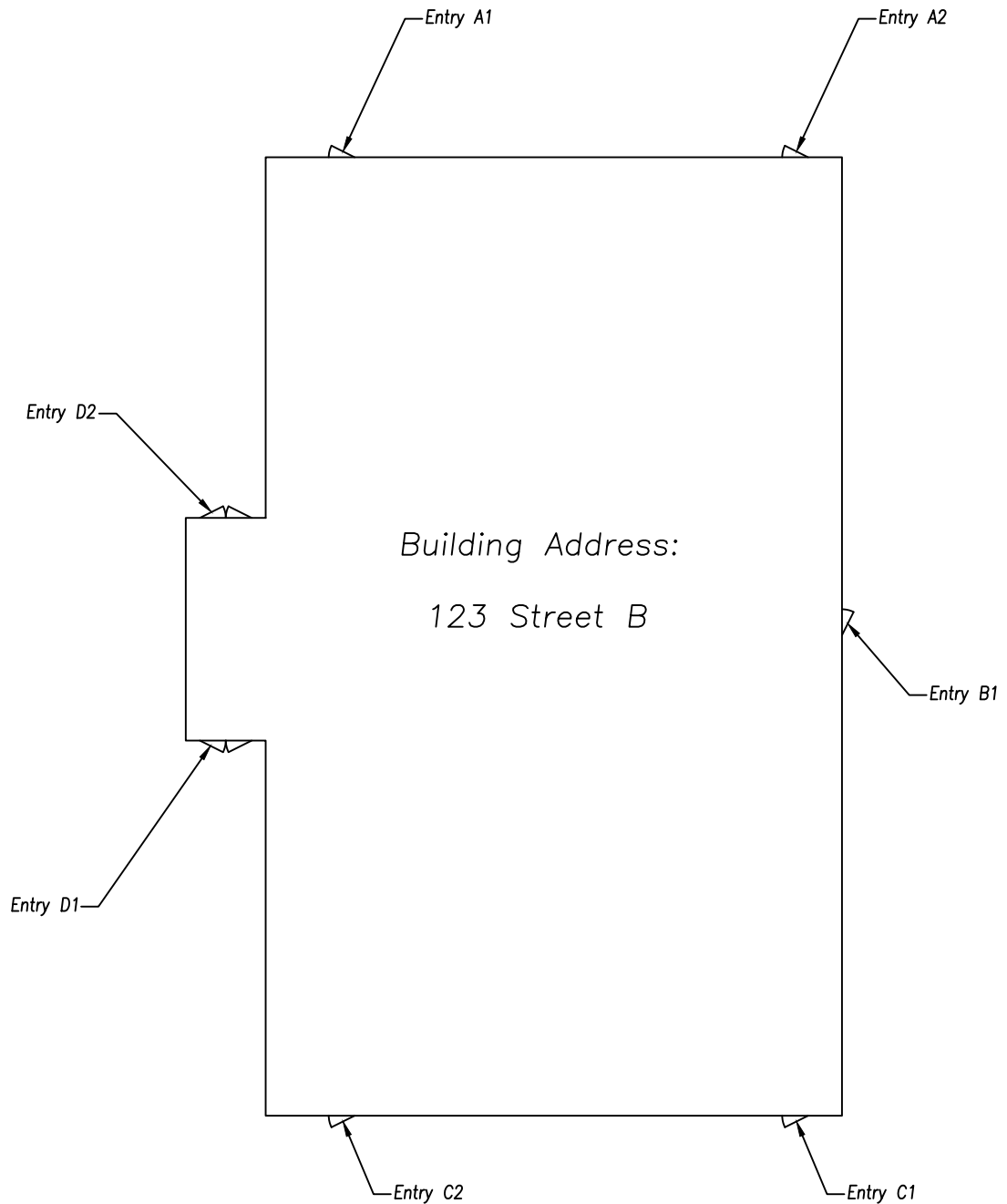

**Notes:**

1. Exterior door identification may be requested or required by Fairfield Police or Fire Departments.
2. All exterior doors (personnel, overhead, etc.) shall receive a unique alpha-numeric designation. The alphabetic character signifies the side of the building while the numeric character signifies the door number.
3. The "A" side of the building shall be the side that faces the street matching the building address. "B", "C", and "D" sides of the building shall be named sequentially in a clockwise manner. Door numbering on any given side shall increase in a clockwise direction.
4. Characters labeling each door are recommended to be 6" or greater.